

OWNERS MANUAL

Congratulations on your purchase of this weather station set, WD633 + WT260H. Please take the time to read and understand this manual so you can begin to enjoy the convenience and features this product has to offer.

FEATURES

Main Display Unit WD633:
 * dual clock and dual alarm
 * calendar (day/month/year)
 * local temperature display
 * receives and displays temperature and humidity from up to 4 remote transmitters via RF technology of 433MHz
 * maximum/minimum temperature records
 * temperature and humidity trend indicator
 * weather report symbols
 * moon phase symbols
 * user-selectable C or F
 * battery type: 2 x AA size

Remote Transmitter WT260H:
 * drip-proof design with LCD
 * temperature display in user-selectable C or F
 * humidity display
 * transmission range: up to 40 meters in open area
 * battery type: 2 x AAA size

WD633 + WT260H Wireless Weather Station

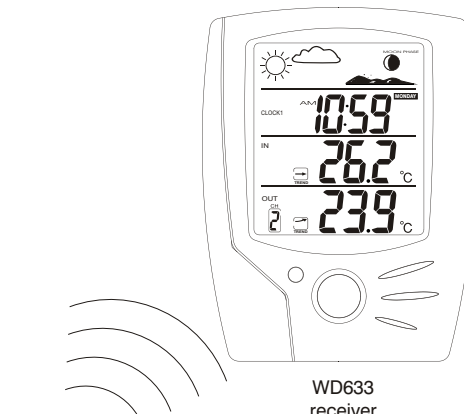

WD633 receiver

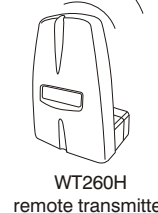

WT260H remote transmitter

GETTING STARTED

- MODE/SNOOZE:** scrolls through Clock 1 & 2, Alarm 1 & 2, Date & Year, and Temperature Alarm (high & low) mode; snooze for alarm
- HOUR/+ /MAX:** shows maximum temperature; adjusts clock, alarm, date & year and temperature alarm values
- MINUTE/-/MIN:** shows minimum temperature; adjusts clock, alarm, date & year and temperature alarm values
- ALARM/(C/F):** toggles between Cand F, 12 and 24 hour format, Alarm 1 & 2 on and off; disables (resets) high & low temperature alarms
- CHN:** scrolls through remote channels (1 to 4); scrolls through local and remote channels (1 to 4) in (high & low) temperature alarm mode
- SET:** changes channel and house code; toggle between C and F
- RESET:** resets channel and house code
- Battery compartment
- LCD display

button placement

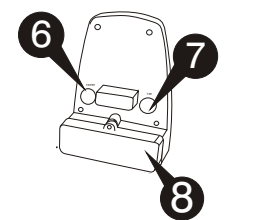
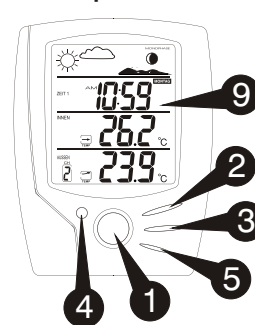

GETTING STARTED

- remove battery cover
- 2 AA size batteries (WD633)
- 2 AAA size batteries (WT260H) (included)
- Insert between terminals observing proper polarity then replace cover

battery installation

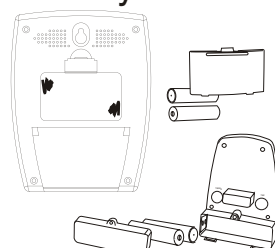

LOW BATTERY INDICATION:

Receiver: Low battery indicator will flash continuously when batteries need replacing
 Remote transmitter: **Lo bat** will appear on transmitter's LCD along with a low battery indication next to the corresponding channel on the receiver's LCD

setting remote transmitters

- Press **RESET** to start
- House code will flash for 10 seconds
- Select house code (1-15) by pressing **SET**
Remote transmitters for each receiver must be set to the same house code.
- Channel will flash for 10 seconds
- Select channel (1-4) by pressing **SET**

* Use a different house code if your weather station detects other signals from neighboring sources
 * Factory default: house code = 01 and channel = 01

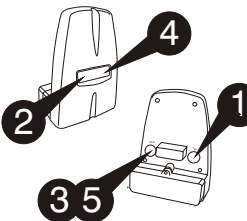

SETUP

Automatic Learn Function:

- Learn function executes automatically and runs for approximately 3 minutes when batteries are first installed in the receiver.
- Within these 3 minutes, receiver picks up the temperature & humidity signals from remote transmitter and displays the readings.

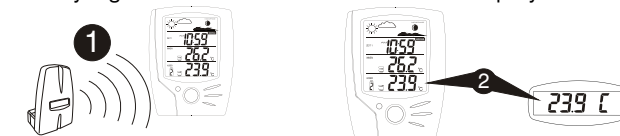

Manual-Learn (Searching for Remote Signals):

If a new remote transmitter is added or if signal is lost (outdoor display blinking), learn function must be executed again.

- Press and hold **CHN** for 3 seconds to start
- Beep sound indicates that learn function has started
- 'Channel' symbol will flash and unit will beep as each remote transmitter is detected
- Temperature & humidity readings of remote transmitter displays on the receiver.

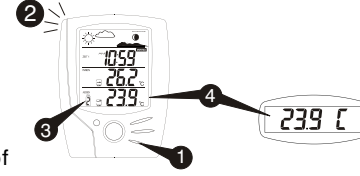

CLOCK SETTING

Clock 1 Setting:

- Press and hold **MODE** for 3 seconds to enter the clock setting mode (the **CLOCK 1** symbol appears and the time will flash)
- Press **HOUR** to set the hour and **MINUTE** to set the minute;
- Press **ALARM/(C/F)** during clock setting, to change between 12 and 24 hour display. This also will end clock setting.
- Press **MODE** or do not press any key for 1 minute to finish clock setting.

Clock 2 Setting:

- Scroll to Clock 2 mode using **MODE**
- Press + or - key to change the hour (in one hour increments/decrements relative to Clock 1)

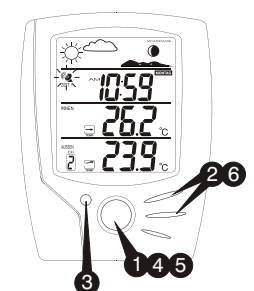

DATE, YEAR & ALARM SETTING

Date Setting:

- Scroll to date mode using **MODE**
- Press **HOUR/+ /MAX** to set month
- Press **MINUTE/-/MIN** to set date
- Weekday is automatically determined from the year/month/day setting

February will have either 28 or 29 days depending on the year setting

Year Setting

- Scroll to **YEAR** mode using **MODE**
- Press + or - key to adjust year

Alarm 1 and Alarm 2 Setting

- Scroll to Alarm 1 mode (Alarm 2 mode) using **MODE**
- Press **HOUR** to set hour
- Press **MINUTE** to set minute
- Press **ALARM** to toggle alarm on and off
- When the alarm is set ON, the 'on' symbol will appear

When Alarm Sounds

- 1 or 2 will flash
- Press **SNOOZE** to snooze the alarm for 5 minutes. After that the alarm will sound again.
- Press ANY other key will shut off the alarm. Without interruption, alarm will shut off automatically after one minute.

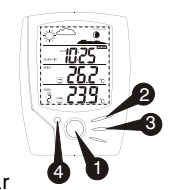
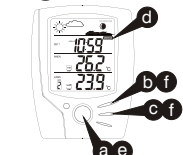

MOON PHASE

The moon phase is automatically updated according to the year/month/day.

Moon Phase Display

- New Moon
- Young Crescent
- First Quarter
- Waxing Gibbous
- Full Moon
- Waning Gibbous
- Last Quarter
- Old Crescent
- New Moon

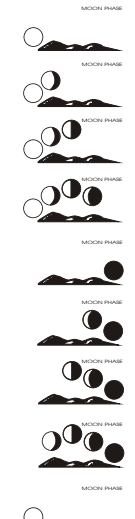

WEATHER DISPLAY

Check Local Temperature

* Local temperature displays instantly after batteries are inserted.

Check Remote Temperature & Humidity

A Press **CHN** to toggle between Channel 1, 2, 3 and 4. Temperature and humidity readings will alternate on the receiver.

C or F Temperature Display

B Toggle between C and F by pressing **C/F** in either Clock 1 or Clock 2 mode.

Min and Max Temperature & Humidity

C Press **MIN** in Clock 1 mode to display minimum temperature and humidity
 D Press **MAX** in Clock 1 mode to display maximum temperature and humidity

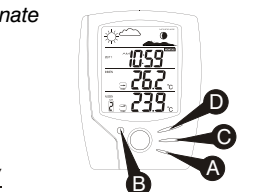

Note:
 Min/Max readings are automatically cleared daily at 00:00

WEATHER DISPLAY

temperature & humidity trend

The trend indicator shows the trend of temperature and humidity determined by the particular transmitter in the past half-hour interval.

Arrow Indicator			
Trend	Rising	Steady	Falling

weather report symbols

	Sunny	Cloudy	Raining	Snowing	Freeze Warning
Weather Indicator					

About Freeze Warning

- * Snow symbol will flash to warn of 'freezing'.
 - * Activated when Channel 1's temperature is between -1.9 C and +2.9 C
 - * Snow will appear solid if and when Channel 1's temperature falls below -1.9 C.
- Note:**
 * Initially, the weather will be cloudy
 * Remote transmitter Channel 1 will be used for weather indication.
 * If Channel 1 is empty, then weather will always be cloudy.
 * If Channel 1 has no humidity data, weather indication will always be cloudy, but freeze warning and snow indication will be available.

TEMPERATURE ALARM

You can set up to 5 high temperature alarms - one local and one for each of the four remote channels

- Scroll to high temperature alarm mode using **MODE**
- X** and **-** or existing preset will flash
- Select local channel or remote channel (1 to 4) using **CHN**
- Press + or - key to set the high temperature limit value
 * To disable particular alarm, press **ALARM**; dashes = alarm disabled
- Press **MODE** to finish
- Repeat steps 1 to 5 for all other channels if desired

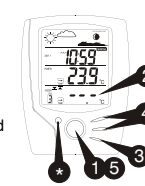

You can set up to 5 low temperature alarms - one local and one for each of the four remote channels

- Scroll to low temperature alarm mode using **MODE**
- X** and **-** or existing preset will flash
- Select local channel or remote channel (1 to 4) using **CHN**
- Press + or - key to set the low temperature limit value
 * To disable particular alarm, press **ALARM**; dashes = alarm disabled
- Press **MODE** to finish
- Repeat steps 1 to 5 for all other channels if desired



when temperature alarm sounds

- * It is to alert that the temperature has exceeded the preset temperature limit.
- a Press any key to stop temperature alarm; or
- b If no key is pressed, the temperature alarm will automatically stop itself after one minute.
- c Once triggered, temperature alarm comes on as a distinctive sound, different to that of Alarm 1 and Alarm 2.

TROUBLESHOOTING

i The temperature measurement of remote transmitter and receiver does not match

ii Temperature reading of the outdoor remote transmitter seems too high.

iii Receiver is no longer receiving remote transmitter signals or display

solution

i Re-synchronize receiver by holding **CHN** for 3 seconds until a beep is heard.

ii Ensure the remote transmitter is out of direct sunlight, and away from sources of heat.

iii Repeat the learning procedures.
 - Temperature may be below -30C.
 - Batteries in remote transmitter may need changing.
 - Move remote transmitter closer to the receiver.
 - Make sure remote transmitter is away from sources of electrical disturbance.

SPECIFICATIONS

Weather Station Receiver WD633
 - Battery Type: 2 X 1.5V AA batteries
 - Operation Temp: -5 C to +50 C
 - Temp. Range: -9.9 C to +55 C
 - Measurement Accuracy: Max. +/- 1 C within measuring range of 0 to 40 C
 - Resolution: 0.1C

Weather Station Transmitter WT260H
 - Battery Type: 2 X 1.5V AAA batteries
 - Operation Temp.: -20 C to +60 C
 - Temp. Range: -30C to +70C
 - Temperature Resolution: 0.1 C for above -10 C / 1 C for below -10 C
 - Measurement Accuracy: Max. +/- 1 C within measuring range of 0 to 40 C
 - Humidity Range: 25% to 90% RH (resolution 0.5%)
 - Transmission Frequency: 433.92 MHz
 - Transmission Range: up to 40 meters in open area

NOTICE

This equipment has been tested and found to comply with the limits for a Class B digital device, pursuant to Part 15 of the FCC Rules. These limits are designed to provide reasonable protection against harmful interference in a residential installation. This equipment generates, uses and can radiate radio frequency energy and, if not installed and used in accordance with the instructions, may cause harmful interference to radio communications. However, there is no guarantee that interference will not occur in a particular installation. If this equipment does cause harmful interference to radio or television reception, which can be determined by turning the equipment off and on, the user is encouraged to try to correct the interference by one or more of the following measures:

- Reorient or relocate the receiving antenna.
- Increase the separation between the equipment and receiver.
- Connect the equipment into an outlet on a circuit different from that to which the receiver is connected.
- Consult the dealer or an experienced radio/TV technician for help.

Warning:

Changes or modifications made to this equipment not expressly approved by the manufacturer may void the FCC authorization to operate this equipment.