



SYSTEM DESIGN GUIDE

Multi room audio and home theater control like you've never experienced.



MRC-6430



*Auriel*TM

Includes:

Auriel System Applications

Multi Room Applications

Overview of products powered by Auriel

VERSION 1 - FALL 2014

Table of Contents

INTRODUCTION

How to use this Design Guide.	3
Overview: MRC-6430	4
MRC-6430 Chassis Connections	6
Overview: Keypads & Touchscreens	8
Overview: nHR200 Remote Control.	9
Overview: nKP7 Keypad	10
Overview: nTP7 Touchscreen	11

APPLICATIONS

Stand Alone MRC-6430 Multi Room Amplifier with System Integration Amplifier for Outside Zones	12
Whole Home Audio with an Extender Chassis and System Integration Amplifier for Outside Zones	16
MRC-6430 Multi Room Amplifier Integrated With a Home Theater System for Unified Control	20
Overview: DBI-2 Doorbell Interface.	24
DBI-2 and MRC-6430 Doorbell System	26

REFERENCE

Frequently Asked Questions	28
Additional Information	31

How to use this Design Guide

Application

Section provides you with detailed info for a specific application.

Do This First

Installation instructions on what you need to know before you begin.

What does this Application Do?

Description of Application.

Key Considerations

Important information that you need to consider when planning your design.

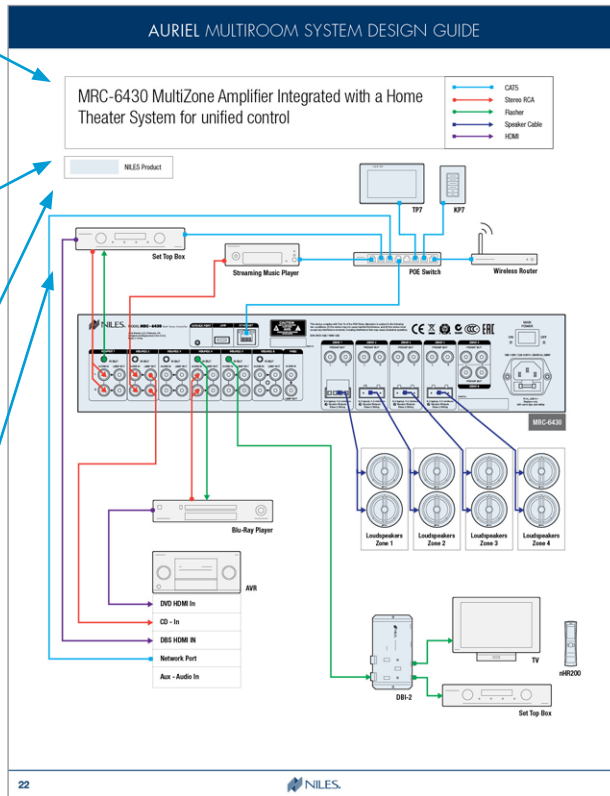

Each chapter in the System Design Guide is divided into sections to make comprehension easier. Each section contains specific information that is presented with graphic examples to further aid in understanding. Below is a description of what information is contained within each section.

The Cable Diagram

Section shows all connection points with color coded line connections.

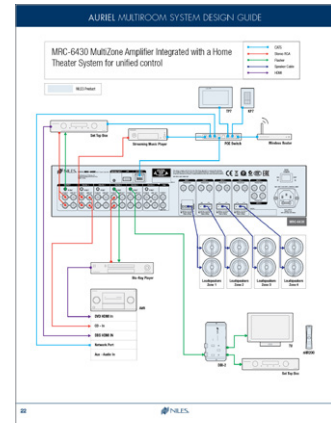

Customer Benefits

What this application does for your customer.

Installation Benefits

What the application does for you.

Installation Requirements

Specific installation details that you need to know.

Critical Knowledge

These are the "must know" details regarding installation.

AURIEL MULTIRoom SYSTEM DESIGN GUIDE

Cable Schedule

Source Connections to MRC-6430

QTY	CABLE	SIGNAL	FROM	TO
1	Stereo RCA	Audio	Set-top box audio output	MRC-6430 Source 1 Audio In
1	HDMI	HDMI	Set-top box HDMI output	MRC-6430 Source 1 HDMI Input
1	Stereo RCA	Audio	MRC-6430 Source 2 Loop Out	Home Theater CD Audio Input
1	Stereo RCA	Audio	Media Player audio output	MRC-6430 Source 2 Audio In
1	Stereo RCA	Audio	DVD Changer audio output	MRC-6430 Source 4 Audio In
1	HDMI	HDMI	DVD HDMI output	Home Theater AVR HDMI Input
1	Flasher	Infrared	MRC-6430 Source 1 IR Out	Set-top Box
1	CATS	Network	Music Player	Local Area Network Switch
1	Flasher	Infrared	MRC-6430 Source 4 IR Out	DVD Changer
1	3.5 mm w Flying leads	Infrared	MRC-6430 Source 5 IR Out	IR Sensor Input of MSU-140

Room Connections (needed for each area that accesses the audio sources)

QTY	CABLE	SIGNAL	FROM	TO
1	Speaker	Audio	MRC-6430 Zone Amplifier Output	Speakers
1	CATS	Data	Local Area Network PoE Switch	Keypad or Touchscreen

Other Connections

QTY	CABLE	SIGNAL	FROM	TO
1	CATS	Network	Local Area Network Switch	MRC-6430 ETHERNET Connection
1	CATS	Network	Local Area Network Switch	Home Theater AVR Network connection
1	Flasher	Infrared	Flasher Port of MSU-140	Theater Set-top box
1	Flasher	Infrared	Flasher Port of MSU-140	Theater TV

The Cable Schedule

Section lists all cables used in cabling diagrams (sometimes shown on application page).

AURIEL MULTIRoom SYSTEM DESIGN GUIDE

Cable Schedule

Source Connections to MRC-6430

QTY	CABLE	SIGNAL	FROM	TO
1	Stereo RCA	Audio	Set-top box audio output	MRC-6430 Source 1 Audio In
1	HDMI	HDMI	Set-top box HDMI output	MRC-6430 Source 1 HDMI Input
1	Stereo RCA	Audio	MRC-6430 Source 2 Loop Out	Home Theater CD Audio Input
1	Stereo RCA	Audio	Media Player audio output	MRC-6430 Source 2 Audio In
1	Stereo RCA	Audio	DVD Changer audio output	MRC-6430 Source 4 Audio In
1	HDMI	HDMI	DVD HDMI output	Home Theater AVR HDMI Input
1	Flasher	Infrared	MRC-6430 Source 1 IR Out	Set-top Box
1	CATS	Network	Music Player	Local Area Network Switch
1	Flasher	Infrared	MRC-6430 Source 4 IR Out	DVD Changer
1	3.5 mm w Flying leads	Infrared	MRC-6430 Source 5 IR Out	IR Sensor Input of MSU-140

Room Connections (needed for each area that accesses the audio sources)

QTY	CABLE	SIGNAL	FROM	TO
1	Speaker	Audio	MRC-6430 Zone Amplifier Output	Speakers
1	CATS	Data	Local Area Network PoE Switch	Keypad or Touchscreen

Other Connections

QTY	CABLE	SIGNAL	FROM	TO
1	CATS	Network	Local Area Network Switch	MRC-6430 ETHERNET Connection
1	CATS	Network	Local Area Network Switch	Home Theater AVR Network connection
1	Flasher	Infrared	Flasher Port of MSU-140	Theater Set-top box
1	Flasher	Infrared	Flasher Port of MSU-140	Theater TV

OVERVIEW: MRC-6430 & The Auriel Ecosystem

Niles MRC-6430 Multi-Room Audio Controller

The Niles MRC-6430 multi-room audio controller delivers amazing sound throughout the home using a simple, intuitive user interface with options that include a handheld remote, a seven-button keypad pre-programmed for zones, and a choice of touch panel devices. The MRC-6430 may also be managed from a variety of mobile devices like the iPhone®, iPad®, Android® phone & tablets, plus Windows® or Mac®-based computers, that provide not only control but display metadata such as playlists and album art—even station information.* The intuitive interface renders identically across devices enabling simple and convenient control by all.

The Auriel Ecosystem

The Auriel ecosystem centers around the MRC-6430 controller which uses Niles keypads, touch panels, remotes, virtually all current Apple and Android phones and tablets, providing users with multiple wired and wireless interface options.



*Auriel*TM



OVERVIEW: MRC-6430 Features

Leading Features:

Chassis Control: Six unique zones with six distinct input sources. The Niles MRC-6430 is the leading solution for multi-room audio integrating automation and AV control.

Source Control: Two-way metadata*, IP and IR control of a variety of popular devices. Auriel™ includes an extensive pre-defined IR database.

Home Theater Control: Manage audio and video components effortlessly and turn any home into an enviable oasis.

Easy Configuration: Tablet-based configuration eliminates hours of complicated programming. The Niles MRC-6430 wizard easily configures macros, user interfaces and end user favorites in just minutes.

Mobile App: iOS and Android applications control the Niles MRC-6430 to queue up soothing sounds at a moment's notice.

Best-in-Class Software Platform: Niles Auriel™ software platform scales for feature expansion including lighting control and climate/thermostat control.

TCP/IP: A simple backbone for control with no proprietary wiring.

Meta Data: When connected to compatible devices*, Niles Auriel™ delivers metadata to the industry's widest selection of user interfaces.

Preamp Outputs: Connect an external amplifier to provide more power for a large area such as a patio, or for a zone where higher than normal volume levels are desired. The preamp outputs can be switched for fixed or variable levels.

Paging Inputs: Connect a telephone system and/or doorbell to provide paging throughout the home. Overrides all other inputs and can be configured to work in any number of zones

Whole House Mode: The Whole House Mode turns on all zones (or a pre-configured number of zones) to play the same source of music, instantly filling the house with music.

Extended Features:

Expandable to 12 Zones: Simply add another Niles Auriel MRC-6430 Controller to create a system with twelve zones.

8-CH High-Performance Digital Amplifier: The advanced digital amplifiers deliver 30 watts per channel to each zone. Low impedance capability (4Ω stable) provides speaker connection flexibility.

Custom Tailored Sound: Independent bass, treble, and loudness controls enable the customization of each zone to optimize performance.

*The level of Metadata feedback is limited to the source and service.

MRC-6430

CHASSIS CONNECTIONS

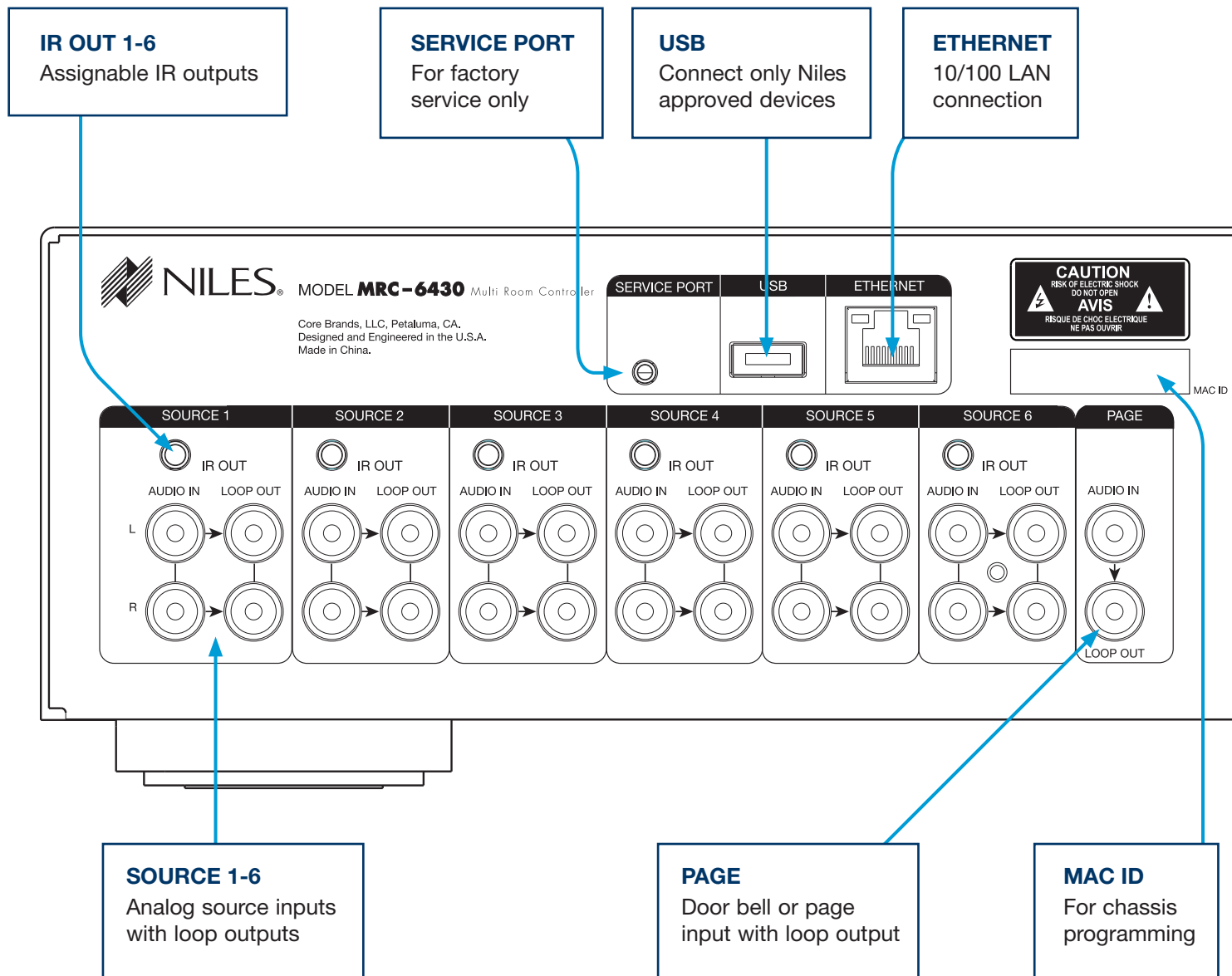

PREAMP OUTPUT ZONE 1-6

Analog stereo Preamp level outputs for each zone

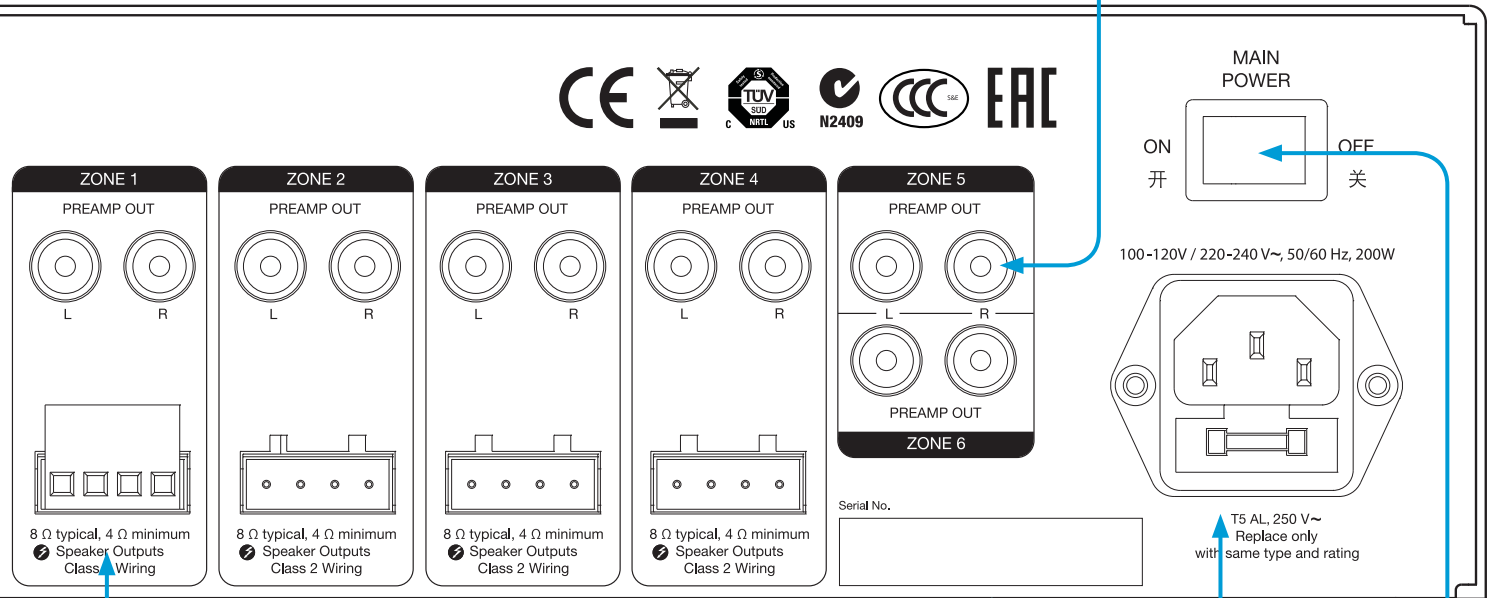

AMPLIFIED OUTPUT ZONES 1-4
Quick connect / disconnect speaker terminal for zones 1-4

AC Power Connection

Main Power

OVERVIEW: Keypads & Touchscreens

Intuitive Tablet and Smartphone Interface

iOS, Android, Windows and Mac OS X applications control the Niles MRC-6430 to queue up soothing sounds at a moment's notice.



The nHR200 Home Theater and whole house Wi-Fi Remote Control is a sleek extension of the intuitive Niles Auriel system. The nHR200 features all of the function of a touchscreen packaged in the contemporary styled remote control. A stylish charging base is included and keeps the nHR200 ready to grab-and-go.

The nKP7, 7 Button keypad, delivers a simple interface that the end user to easily select their favorite sources, adjust volume, and turn off the system - all at the touch of a button. This next-gen keypad is simple to use and easy to navigate.



The nTP7, 7" high-resolution touchscreen, is wall-mountable in either portrait or landscape orientation to best suit the needs of the room. The nTP7 features a proximity sensor to wake it from sleep without any touch required and provides a dedicated Niles Auriel user interface for a more customized experience.

OVERVIEW: nHR200 Wi-Fi Remote Control

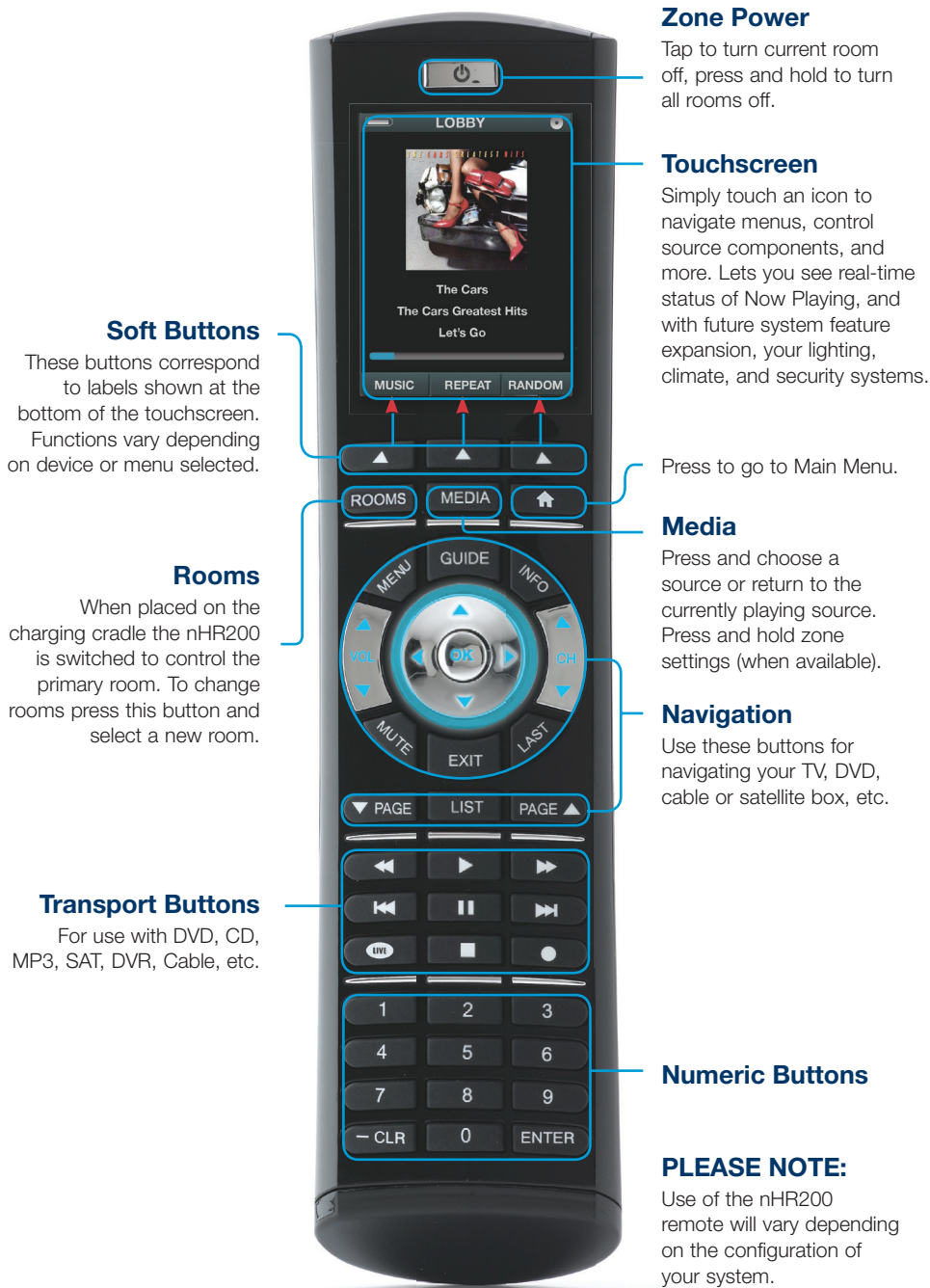

OVERVIEW: nKP7 Keypad

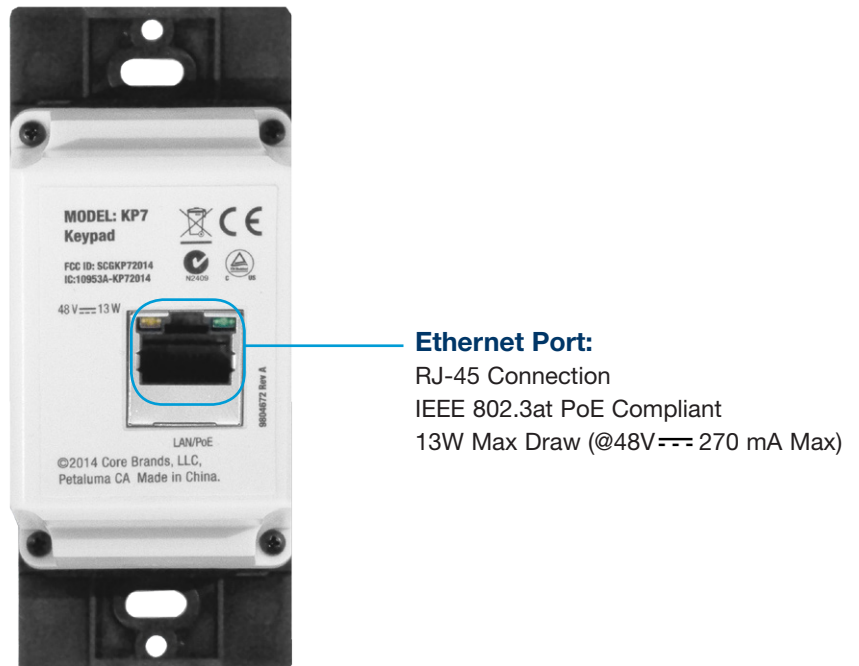
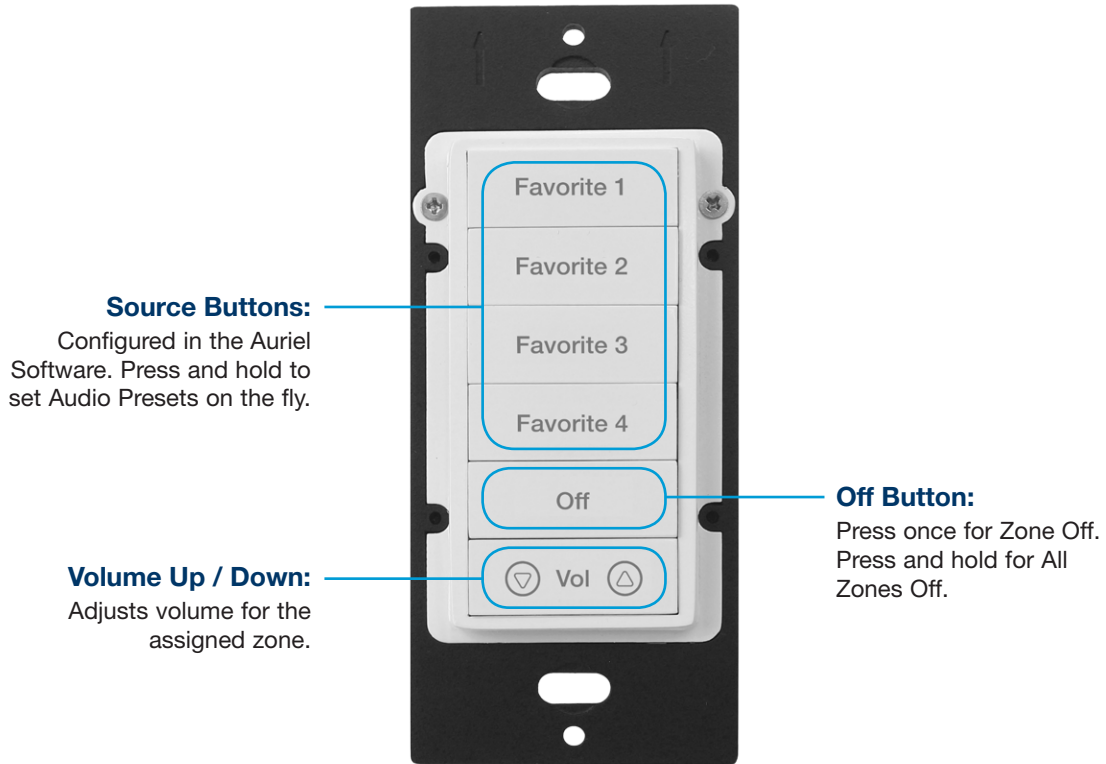

OVERVIEW: nTP7 Touchscreen

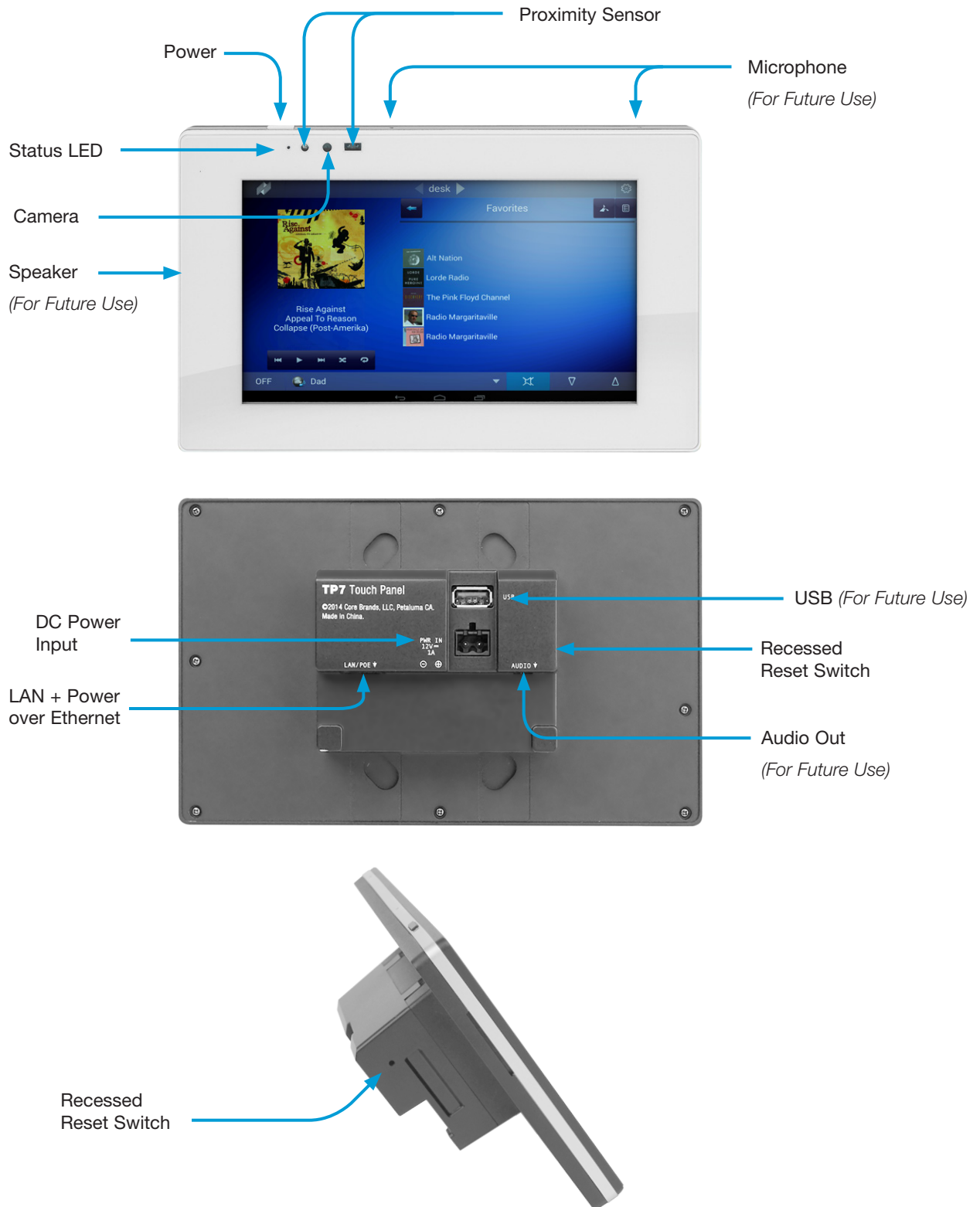

APPLICATION: Stand Alone MRC-6430 Multi Room Amplifier including System Integration Amplifier for Outside zones

DO THIS FIRST : [Review the MRC-6430 & Auriel Overview](#)

What does this Application do?

This application covers the use of a MRC-6430 amplifier to distribute six audio sources to six zones. Zones 5 & 6 are shown integrated with a Niles 12 Channel amplifier, allowing sub-zoning and more power for those areas that need it. This application utilizes two infrared controllable sources and one IP controllable source.

Key Considerations

Global Features Include:

Whole House Mode (WHM) - End-users can fill the house with music from an easy to use settings screen

All Zones Off - Pressing the OFF button from any zone allows for just that zone or for all zones to be turned off.

Paging - Allows front and rear door doorbell chimes from the DBI-2 or paging from a phone system, or both, to be heard through the speakers in pre-configured zones. The zones of the MRC-6430 that are on will mute so the doorbell/page can be heard. The zones that were off will turn on so the doorbell/ page can be heard. When the page is completed, zones that were on will automatically begin playing music again and the zones that were off will again turn off.

Zone Features Include:

Volume Turn-On, Source Level < Bass, Treble, and Variable Loudness - Each zone can have its own custom tailored sound.

Zone Control Recommendations:

Light Usage Rooms - nKP7 7-button keypad recommended – Provides basic system control, including One Touch to Entertainment and play-lists or streaming services. nKP7 provides simple preset access to preferred content on four channels, plus the ability to raise and lower the volume and power down a zone or the system.

Medium Usage Rooms - nKP7 or Mobile device control: iOS and Android applications control the Niles MRC-6430 to queue up soothing sounds at a moment's notice.

Heavy Usage Rooms - nTP7 7" touchscreen recommended – Provides easy-to-read control through a color touchscreen. Additionally, the nTP7 can access and control other zones.

Customer Benefits

The MRC-6430 offers your customer a cost-effective Multi Room audio control that allows One Touch to Entertainment from an easy-to-learn keypad or touchscreen. They get complete control of their music enjoyment through a recognizable user interface from any location in the house.

Installation Benefits

The MRC-6430 is a scalable Multi Room controller with a desirable feature set that includes touchscreen support, preamp outputs, 4-ohm stable digital amplifier, and paging ability. Most importantly, the MRC-6430 is able to control all sources connected to it through its built-in IR Library or an array of two-way feedback capable IP drivers.

Installation Requirements

All CAT-5 wiring must be terminated using the T568A or T568B wiring convention. The following steps are required to configure a MRC-6430 for operation:





1. Connect to the Local Area Network (LAN)
2. Configure unit through mobile device, touchscreen or PC/MAC viewer on the same LAN
3. Configure the MRC-6430 chassis
4. Configure system for all connected sources
5. Set source level, turn-on volume options, bass, treble, variable loudness.
6. Configure all connected user interfaces

Critical Knowledge

- The MRC-6430 must be connected to the local area network (LAN).
- The MRC-6430 is defaulted to DHCP and will get an IP address from the LAN router, Touchscreens and mobile devices will essentially “Plug and Play” when communicating through the same LAN that the MRC-6430 is connected to.
- Most PoE network switches have a number of ports for power insertion and some ports with no power insertion. Make sure that the MRC-6430 is plugged into a non-powered port and that the nKP7 is plugged into a powered port.
- The nTP7 can also be plugged into a powered port, OR it can be powered by an external power supply.
- Most IP controllable sources require that they be changed from DHCP to a static IP address Refer to the source's owners manual for proper static IP address settings.

AURIEL MULTI ROOM SYSTEM DESIGN GUIDE

Stand Alone MRC-6430 Multi Room Amplifier including System Integration Amplifier for Outside zones

-  CAT5
-  Stereo RCA
-  Flasher
-  Speaker Cable

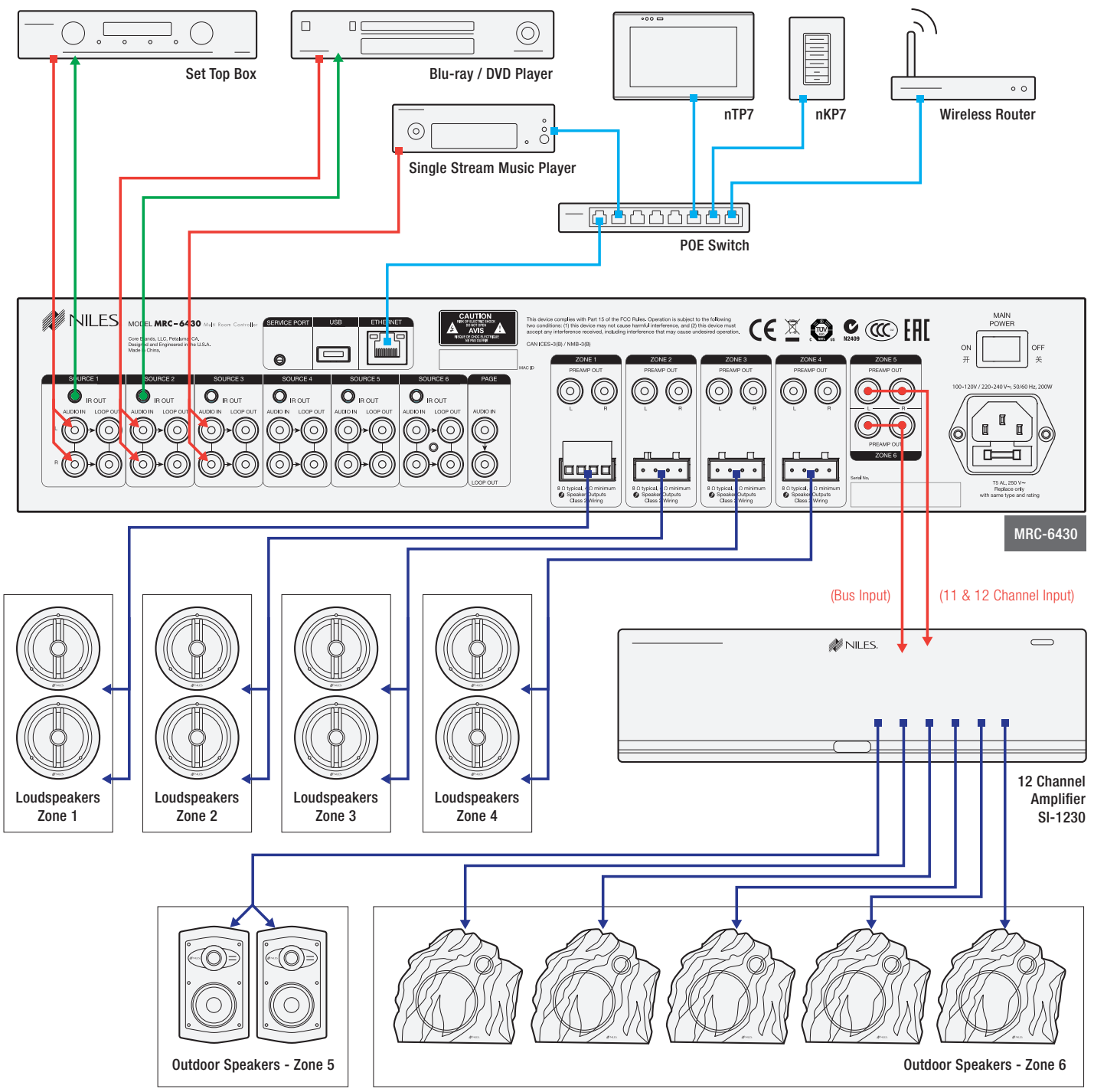

Cable Schedule

Source Connections to MRC-6430

QTY	CABLE	SIGNAL	FROM	TO
1	Stereo RCA	Audio	Set-top box audio output	MRC-6430 Source 1 Audio In
1	Stereo RCA	Audio	Blu-Ray/ DVD Player audio output	MRC-6430 Source 2 Audio In
1	Stereo RCA	Audio	Media player changer audio output	MRC-6430 Source 3 Audio In
1	Flasher	Infrared	MRC-6430 Source 1 IR Out	Set-top Box IR Window
1	CAT5	Network	Music Player	Local Area Network Switch
1	Flasher	Infrared	MRC-6430 Source 2 IR Out	Blu-Ray/ DVD Player IR window

Room Connections (needed for each area that accesses the audio sources)

QTY	CABLE	SIGNAL	FROM	TO
1	Speaker	Audio	MRC-6430 Zone Amplifier Output	Speakers
1	CAT5	Data	Local Area Network PoE Switch	Keypad or Touchscreen
1	Speaker	Audio	SI-1230 Amplifier Output	Zone 5 Speakers
1	Speaker	Audio	SI-1230 Amplifier Output	Zone 6 Speakers

Other Connections

QTY	CABLE	SIGNAL	FROM	TO
1	Stereo RCA	Audio	MRC-6430 Zone 5 PREAMP OUT	SI-1230 Audio Input 11&12
1	Stereo RCA	Audio	MRC-6430 Zone 6 PREAMP OUT	SI-1230 BUS Input
1	CAT5	Network	Local Area Network Switch	MRC-6430 ETHERNET Connection

APPLICATION: Whole Home Audio with an Extender Chassis (12 zones) and System Integration Amplifier for Outside zones

DO THIS FIRST : [Review the MRC-6430 & Auriel Overview](#)

What does this Application do?

This application covers the use of a MRC-6430 Multi Room Amplifier to distribute audio to 12 zones, as well as using a System Integration Amplifier to power outdoor zones. Sources in this application are examples of sources that use infrared control and a multiple stream music player using IP control.

Key Considerations

Global Features Include:

Whole House Mode (WHM) - End-users can fill the house with music from an easy to use settings screen

All Zones Off - Pressing the OFF button from any zone allows for just that zone or for all zones to be turned off.

Paging - Allows front and rear door doorbell chimes from the DBI-2 or paging from a phone system, or both, to be heard through the speakers in pre-configured zones. The zones of the MRC-6430 that are on will mute so the doorbell/page can be heard. The zones that were off will turn on so the doorbell/ page can be heard. When the page is completed, zones that were on will automatically begin playing music again and the zones that were off will again turn off.

Zone Features Include:

Volume Turn-On, Source Level < Bass, Treble, and Variable Loudness - Each zone can have its own custom tailored sound.

Powering Outdoor Areas: The amplifier power of the MRC-6430 is sufficient for indoor applications, but outdoor applications may require a more powerful amplifier. A Niles System Integration Amplifier is recommended when more power is needed. The MRC-6430 has preamp outputs. Each one provides an audio signal to the amplifier that can be switched between variable level (volume level controlled by keypad) or fixed level (volume level controlled by a separate volume control).

Zone Control:

Light Usage Rooms - nKP7 7-button keypad recommended – Provides basic system control, including One Touch to Entertainment and play-lists or streaming services. nKP7 provides simple preset access to preferred content on four channels, plus the ability to raise and lower the volume and power down a zone or the system.

Medium Usage Rooms - nKP7 or Mobile device control: iOS and Android applications control the Niles MRC-6430 to queue up soothing sounds at a moment's notice.

Heavy Usage Rooms - nTP7 7" touchscreen recommended – Provides easy-to-read control through a color touchscreen. Additionally, the nTP7 can access and control other zones.

Multichassis Configuration: When using two MRC-6430's you have access to these features and capabilities:

- Global features such as Party Mode
- All Zones Off
- All other sources are shared between the chassis (maximum of 6)

Customer Benefits

The MRC-6430 offers your customer a cost-effective Multi Room audio controller that allows One Touch to Entertainment from an easy-to-learn keypad or touchscreen. They get complete control of the whole house audio system through a recognizable user interface from any location in the house.

Installation Benefits

The MRC-6430 is a scalable Multi Room controller with a desirable feature set that includes touchscreen support, preamp outputs, 4-ohm stable digital amplifier, and paging ability. Most importantly, the MRC-6430 is able to control all sources connected to it through its built-in IR Library or an array of two-way feedback capable IP drivers. The SI-1230 II amplifier is used in this application because it can be configured to 12 channel mode or adjacent channels can be bridged for higher output power for those speakers and areas that need it.

Installation Requirements





All CAT-5 wiring must be terminated using the T568A or T568B wiring convention. The following steps are required to configure a MRC-6430 for operation:

1. Connect to the Local Area Network (LAN)
2. Configure unit through mobile device, touchscreen or PC/MAC viewer on the same LAN
3. Configure the MRC-6430 chassis
4. Configure system for all connected sources
5. Set source level, turn-on volume options, bass, treble, variable loudness.
6. Configure all connected user interfaces.

Critical Knowledge

- Both MRC-6430 chassis must be connected to the local area network (LAN).
- The MRC-6430 is defaulted to DHCP and will get an IP address from the LAN router. Touchscreens and mobile devices will essentially “Plug and Play” when communicating through the same LAN that the MRC-6430 is connected to.
- Most PoE network switches have a number of ports for power insertion and some ports with no power insertion. Make sure that the MRC-6430 is plugged into a non-powered port and that the nKP7 is plugged into a powered port.
- The nTP7 can also be plugged into a powered port, OR it can be powered by an external power supply.
- Most IP controllable sources require that they be changed from DHCP to a static IP address Refer to the source's owners manual for proper static IP address settings.

Whole Home Audio with a Extender Chassis (12 zones) and Systems Integration Amplifier for Outside zones

-  CAT5
-  Stereo RCA
-  Flasher
-  Speaker Cable

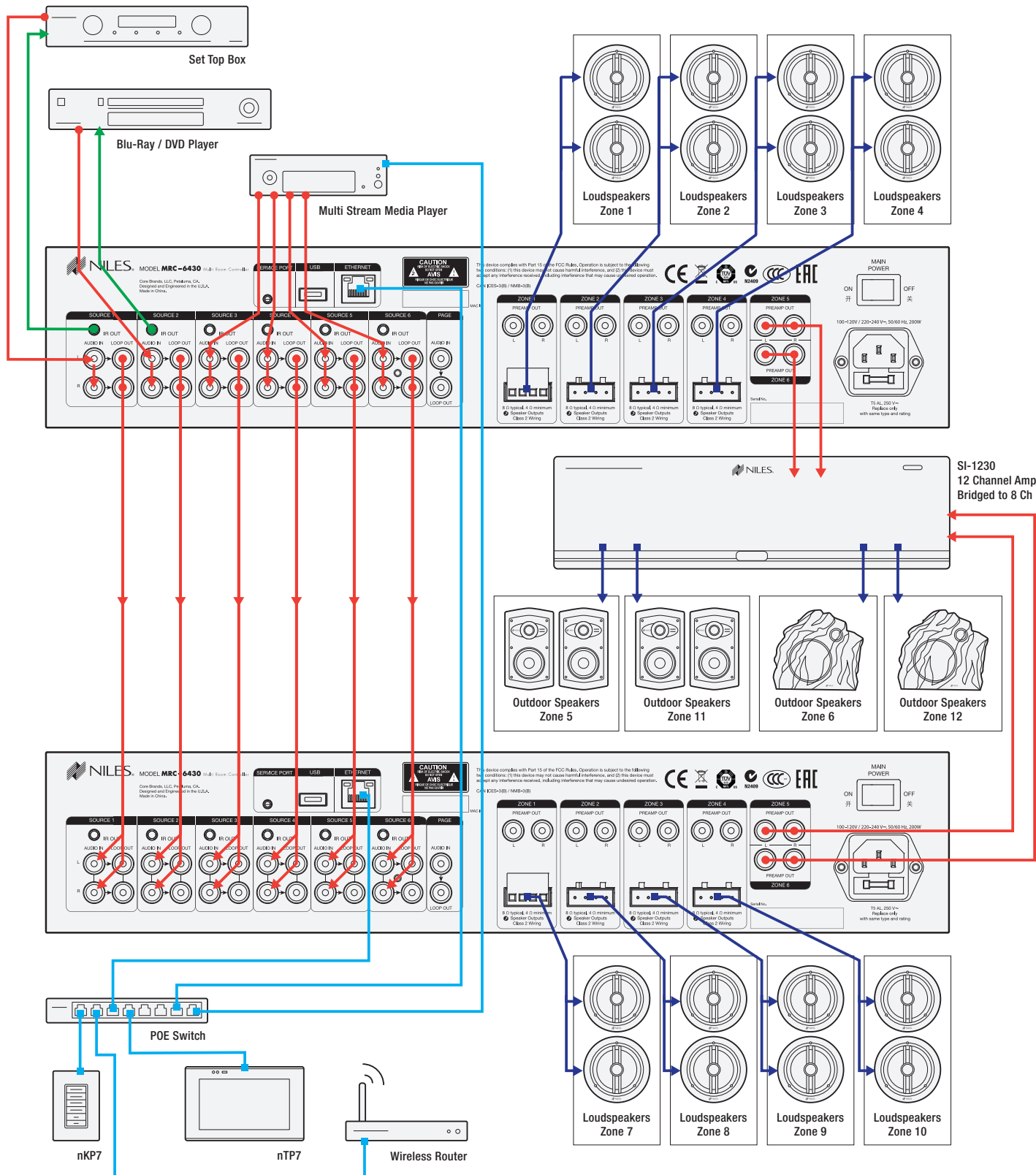

Cable Schedule

Source Connections to MRC-6430

QTY	CABLE	SIGNAL	FROM	TO
1	Stereo RCA	Audio	Set-top box audio output	Master MRC-6430 Source 1 Audio In
1	Stereo RCA	Audio	DVD changer 4 audio output	Master MRC-6430 Source 2 Audio In
1	Stereo RCA	Audio	Media Player Stream 1 audio output	Master MRC-6430 Source 3 Audio In
1	Stereo RCA	Audio	Media Player Stream 2 audio output	Master MRC-6430 Source 4 Audio In
1	Stereo RCA	Audio	Media Player Stream 3 audio output	Master MRC-6430 Source 5 Audio In
1	Stereo RCA	Audio	Media Stream 4 audio output	Master MRC-6430 Source 6 Audio In
1	Flasher	Infrared	MRC-6430 Source 1 IR Out	Set-top box IR window
1	CAT5	Network	Music Player	Local Area Network Switch
1	Flasher	Infrared	MRC-6430 Source 2 IR Out	DVD changer IR window
1	Stereo RCA	Audio	Master MRC-6430 Source 1 Loop Out	Extender MRC-6430 Source 1 Audio In
1	Stereo RCA	Audio	Master MRC-6430 Source 2 Loop Out	Extender MRC-6430 Source 2 Audio In
1	Stereo RCA	Audio	Master MRC-6430 Source 3 Loop Out	Extender MRC-6430 Source 3 Audio In
1	Stereo RCA	Audio	Master MRC-6430 Source 4 Loop Out	Extender MRC-6430 Source 4 Audio In
1	Stereo RCA	Audio	Master MRC-6430 Source 5 Loop Out	Extender MRC-6430 Source 5 Audio In
1	Stereo RCA	Audio	Master MRC-6430 Source 6 Loop Out	Extender MRC-6430 Source 6 Audio In

Room Connections (needed for each area that accesses the audio sources)

QTY	CABLE	SIGNAL	FROM	TO
1	Speaker	Audio	MRC-6430 Zone Amplifier Output	Speakers
1	CAT5	Data	Local Area Network PoE Switch	Keypad or Touchscreen
1	Speaker	Audio	SI-1230 Amplifier Output	Zone 5 Speakers
1	Speaker	Audio	SI-1230 Amplifier Output	Zone 6 Speakers
1	Speaker	Audio	SI-1230 Amplifier Output	Zone 11 Speakers
1	Speaker	Audio	SI-1230 Amplifier Output	Zone 12 Speakers

Other Connections

QTY	CABLE	SIGNAL	FROM	TO
1	Stereo RCA	Audio	Master MRC-6430 Zone 5 PREAMP OUT	SI-1230 Audio Input 7&8
1	Stereo RCA	Audio	Master MRC-6430 Zone 6 PREAMP OUT	SI-1230 Audio Input 10&12
1	Stereo RCA	Audio	Extender MRC-6430 Zone 5 PREAMP OUT	SI-1230 Audio Input 1&2
1	Stereo RCA	Audio	Extender MRC-6430 Zone 6 PREAMP OUT	SI-1230 Audio Input 4&6
1	CAT5	Network	Local Area Network Switch	Master MRC-6430 ETHERNET Connection
1	CAT5	Network	Local Area Network Switch	Extender MRC-6430 ETHERNET Connection

APPLICATION: MRC-6430 Multi Room Amplifier Integrated with a Home Theater System for unified control

DO THIS FIRST : [Review the MRC-6430 & Auriel Overview](#)

What does this Application do?

This application covers the integration of a MRC-6430 Multi Room Amplifier and a home theater receiver with shared sources between the two.

Key Considerations

Global Features Include:

Whole House Mode (WHM) - End-users can fill the house with music from an easy to use settings screen

All Zones Off - Pressing the OFF button from any zone allows for just that zone or for all zones to be turned off.

Paging - Allows front and rear door doorbell chimes from the DBI-2 or paging from a phone system, or both, to be heard through the speakers in pre-configured zones. The zones of the MRC-6430 that are on will mute so the doorbell/page can be heard. The zones that were off will turn on so the doorbell/ page can be heard. When the page is completed, zones that were on will automatically begin playing music again and the zones that were off will again turn off.

Zone Features Include:

Volume Turn-On, Source Level < Bass, Treble, and Variable Loudness - Each zone can have its own custom tailored sound.

Powering Outdoor Areas: The amplifier power of the MRC-6430 is sufficient for indoor applications, but outdoor applications may require a more powerful amplifier. A Niles System Integration Amplifier is recommended when more power is needed. The MRC-6430 has preamp outputs. Each one provides an audio signal to the amplifier that can be switched between variable level (volume level controlled by keypad) or fixed level (volume level controlled by a separate volume control).

Zone Control:

Light Usage Rooms - nKP7 7-button keypad recommended – Provides basic system control, including One Touch to Entertainment and play-lists or streaming services. nKP7 provides simple preset access to preferred content on four channels, plus the ability to raise and lower the volume and power down a zone or the system.

Medium Usage Rooms - nKP7 or Mobile device control: iOS and Android applications control the Niles MRC-6430 to queue up soothing sounds at a moment's notice.

Heavy Usage Rooms - nTP7 7" touchscreen recommended – Provides easy-to-read control through a color touchscreen. Additionally, the nTP7 can access and control other zones.

Multichassis Configuration: When using two MRC-6430's you have access to these features and capabilities:

- Global features such as Party Mode
- All Zones Off

Customer Benefits

The MRC-6430 offers your customer a cost-effective Multi Room audio control that allows One Touch to Entertainment from an easy-to-learn keypad, handheld remote, or touch panel. They get complete control of their music enjoyment through a recognizable user interface from any location in the house.

The nHR200 provides a dedicated hard button/touchscreen interface that is both elegant and easy to use.

Installation Benefits

The MRC-6430 is a scalable Multi Room controller with a desirable feature set that includes touchscreen support, preamp outputs, 4-ohm stable digital amplifier, and paging ability. Most importantly, the MRC-6430 is able to control all sources connected to it through its built-in IR Library or an array of two-way feedback capable IP drivers.

Installation Requirements

- 1) The MRC-6430 and Home Theater receiver must be connected to the same Local Area Network (LAN)
- 2) When nHR200 Wi-Fi Remote Control is desired for Home Theater and Whole House Audio control, the MRC-6430 and Home Theater Receiver must be set for independent static IP addresses. Use the Project Documentation Worksheet (supplied with the MRC-6430) to document all system connections and IP addresses.
- 3) Most IP controllable sources require that they be changed from DHCP to a static IP address. Refer to the sources owners manual for proper static IP address settings

Critical Knowledge

- A static IP address must be set on the MRC-6430 to use the nHR200 Wi-Fi remote Control.
- Most PoE network switches have a number of ports for power insertion and some ports with no power insertion. Make sure that the MRC-6430 is plugged into a non-powered port and that the nKP7 is plugged into a powered port.
- The nTP7 can also be plugged into a powered port, OR it can be powered by an external power supply.
- Additionally if more than 6 IR Flasher ports are needed, then you can connect one of the IR outputs to a Niles IR Main System Unit (MSU) to provide additional un-routed IR Flasher ports.

MRC-6430 Multi Room Amplifier Integrated with a Home Theater System for unified control

- CAT5
- Stereo RCA
- Flasher
- Speaker Cable
- HDMI

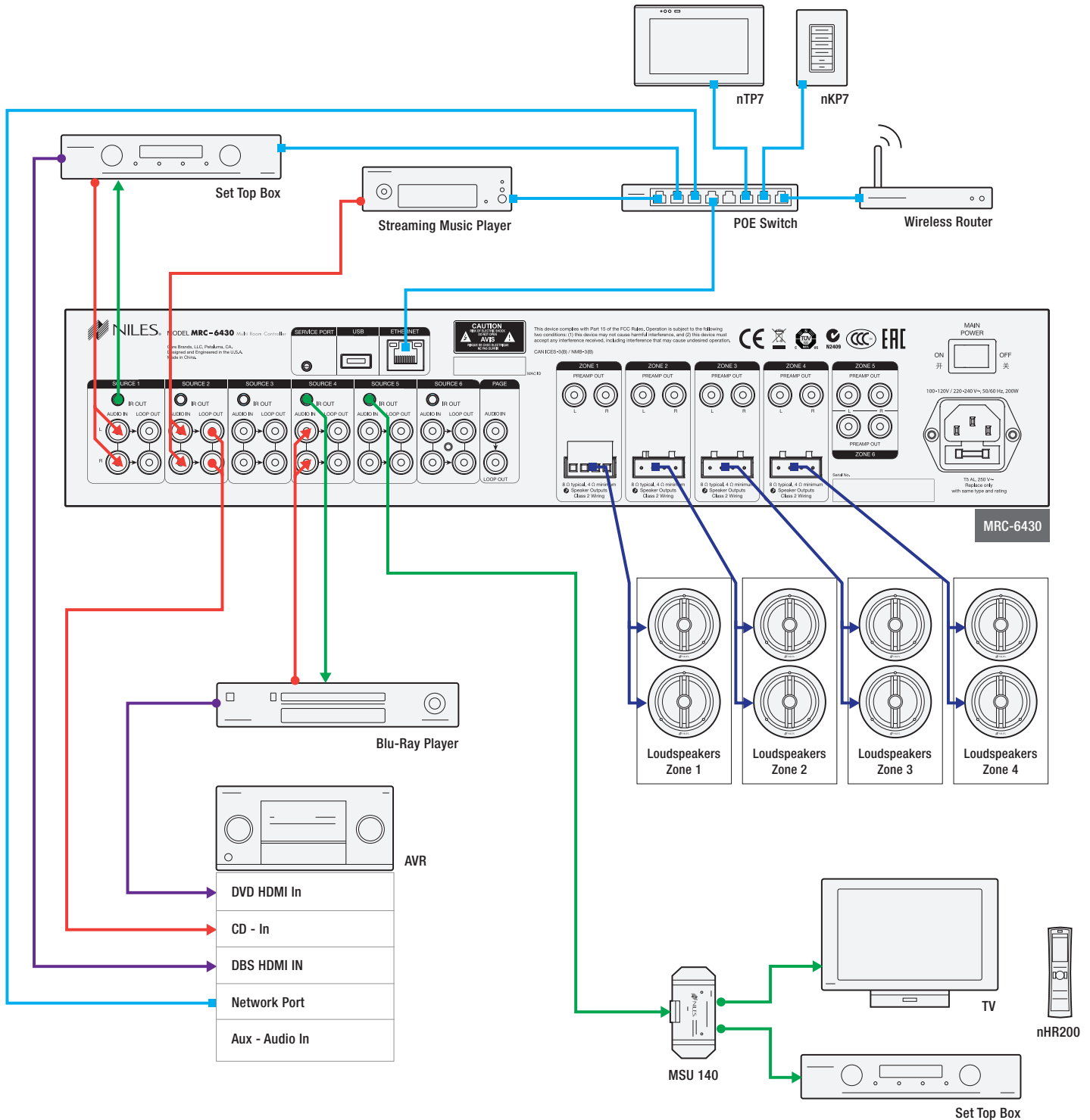

Cable Schedule

Source Connections to MRC-6430

QTY	CABLE	SIGNAL	FROM	TO
1	Stereo RCA	Audio	Set-top box audio output	MRC-6430 Source 1 Audio In
1	HDMI	HDMI	Set-top box HDMI output	Home Theater AVR DBS HDMI input
1	Stereo RCA	Audio	MRC-6430 Source 2 Loop Out	Home Theater CD Audio input
1	Stereo RCA	Audio	Media Player audio output	MRC-6430 Source 2 Audio In
1	Stereo RCA	Audio	Blu-Ray audio output	MRC-6430 Source 4 Audio In
1	HDMI	HDMI	Blu-Ray HDMI output	Home Theater AVR DVD HDMI input
1	Flasher	Infrared	MRC-6430 Source 1 IR Out	Set-top Box
1	CAT5	Network	Music Player	Local Area Network Switch
1	Flasher	Infrared	MRC-6430 Source 4 IR Out	Blu-Ray IR Window
1	3.5 mm w Flying leads	Infrared	MRC-6430 Source 5 IR Out	IR Sensor Input of MSU-140

Room Connections (needed for each area that accesses the audio sources)

QTY	CABLE	SIGNAL	FROM	TO
1	Speaker	Audio	MRC-6430 Zone Amplifier Output	Speakers
1	CAT5	Data	Local Area Network PoE Switch	Keypad or Touchscreen

Other Connections

QTY	CABLE	SIGNAL	FROM	TO
1	CAT5	Network	Local Area Network Switch	MRC-6430 ETHERNET Connection
1	CAT5	Network	Local Area Network Switch	Home Theater AVR Network connection
1	Flasher	Infrared	Flasher Port of MSU-140	Theater Set-top box
1	Flasher	Infrared	Flasher Port of MSU-140	Theater TV

OVERVIEW: DBI-2 Doorbell Interface

DO THIS FIRST : [Review the MRC-6430 & Auriel Overview](#)

The DBI-2 Doorbell Interface (FG01613) provides doorbell chimes that play throughout the home when installed with a Niles Multi Room system. It is equipped with four different doorbell sounds, two user recorded sound options, and the ability to play different sounds for the front and rear doors. Also included is an audio input that can be connected to the audio output of any standard telephone paging system. The MRC-6430 can be configured to play the DBI-2's doorbell sounds and telephone system pages through all, or any number of zones which are selected during configuration of the Auriel-Powered Multi Room System.

Customized Doorbell Sounds

The DBI-2 includes four different doorbell sounds: two versions of the standard doorbell chime sound plus two versions of the Westminster chime. Chime selection is made via four DIP switches. Also, the delay time between when a chime is triggered and when the sound is actually generated is adjustable from zero to four seconds via a similar set of DIP switches. If you prefer, a custom chime sound can be created. An audio source (microphone mixer, CD player, preamplifier, etc.) can be connected to the DBI-2's audio input and then recorded to the digital memory.

Dual Doorbell Triggers

The two doorbell inputs, one for the front door and the other for the rear, are connected using simple two-conductor wire. They can be triggered either by contact closure or by 3V-30V voltage. Native Support For Illuminated Doorbell Buttons - Adds Convenience And Security.

Audio Paging Input

An audio input is supplied to connect to the audio output of a telephone paging system. To ensure that their volume levels are the same, the DBI-2 is equipped with separate adjustable output level controls for both the chimes and the telephone system page.

Audio Paging Output

Use a standard audio cable with male RCA plugs to connect the DBI-2 to the paging input of a Nile Multi Room System.

Chime and Audio Level Adjustments

The sound volume for the chimes and the audio paging are adjustable so they can be set to the same output level.

Features

- Provides doorbell chimes to Niles Multi Room controllers
- Four selectable preprogrammed chimes and one user recorded sound option
- Two Doorbell Inputs, both with button illumination support, triggered by either voltage or contact closure via screwless two piece connector
- Separate level adjustments provided for chime and page pass through
- One gold-plated mono audio sensing input jack
- One gold-plated mono audio output jack
- UL-listed in-line power supply with universal voltage capability

Specifications:

Dimensions: 7-7/8" wide x 1-1/8" high x 4-1/8" deep (20cm wide x 2.9cm high x 10.5cm deep)

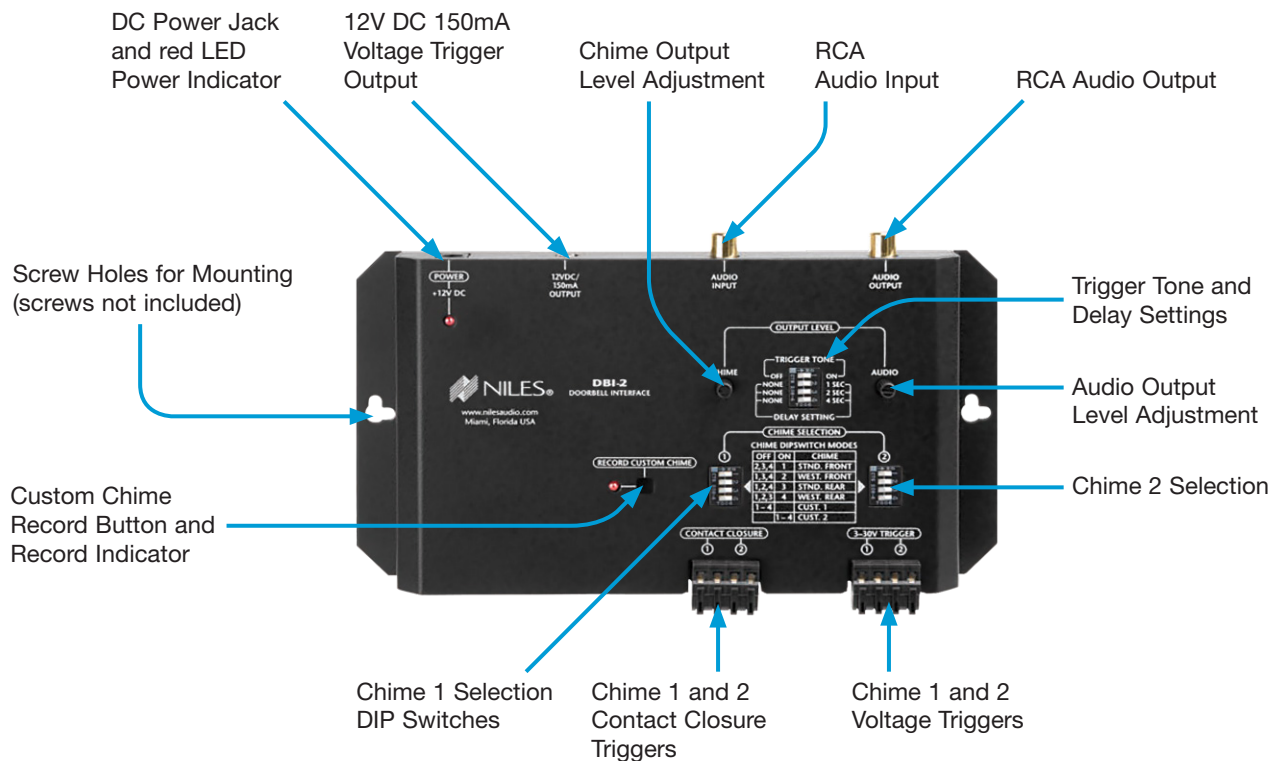

APPLICATION: DBI-2 Doorbell Interface

DO THIS FIRST : [Review the MRC-6430 & Auriel Overview](#)

What does this Application do?

This application covers the use of a DBI-2 to add doorbell chimes to a Niles Multi Room Amplifier system. The DBI-2 is a MultiZone accessory that combines both doorbell alerts and traditional phone paging together over one connection to the MRC-6430. This application allows the end-user to enjoy music throughout the house but not miss any visitor or internal telephone page, the configured zones that are on will mute and play the doorbell chime /page, the configured zones to turn on and play the doorbell chime/page and when concluded the configured zones revert to their original state

Key Considerations

The DBI-2 has two doorbell contact closures that can activate one of the six available chimes (four built-in and two recordable). The unit includes voltage on the doorbell to allow a lighted switch and independent level adjustments for the built-in and recordable chimes, as well as adjustable delays.

The unit also features 3-30V DC input triggers, and provides a 12V DC output when triggered.

The DBI-2 can be located at the doorbell cabling home run location, and its audio output run through a CAT-5 back to the MRC-6430 Multi Room amplifier using two C5-A2 baluns and/or a C5-A2WM wall mounted balun.

Customer Benefits

The DBI-2 allows the doorbell to be heard from multiple locations within a house instead of one location, making it easier to hear. Also, the built-in chimes are more distinguished than the basic doorbell chime found in many houses, which many customers prefer. Finally, a custom door chime can be recorded into the unit if so desired.

Installation Benefits

This easy add-on to any MRC-6430 system requires very little wiring and adds a desirable feature to the Multi Room system. Additionally, it adds a feature that is difficult for competitors to replicate, which makes your system design hard to copy.

Critical Knowledge



The DBI-2 is capable of integrating with lighted doorbell buttons. Please consult the installation guide for more details on how to wire and setup this feature.

The DBI-2 is needed when door chime over the whole house audio speakers is desired, or when integrating both doorbell and paging into the single Page Input on the rear panel of the MRC-6430.

The DBI-2 is not needed if only integrating the paging feature from a telephone system into the Page Input on the rear panel of the MRC-6430.

AURIEL MULTI ROOM SYSTEM DESIGN GUIDE

MRC-6430 Multi Room Amplifier Integrated with a Doorbell Alert System

-  CAT5
-  Mono RCA
-  Speaker Cable

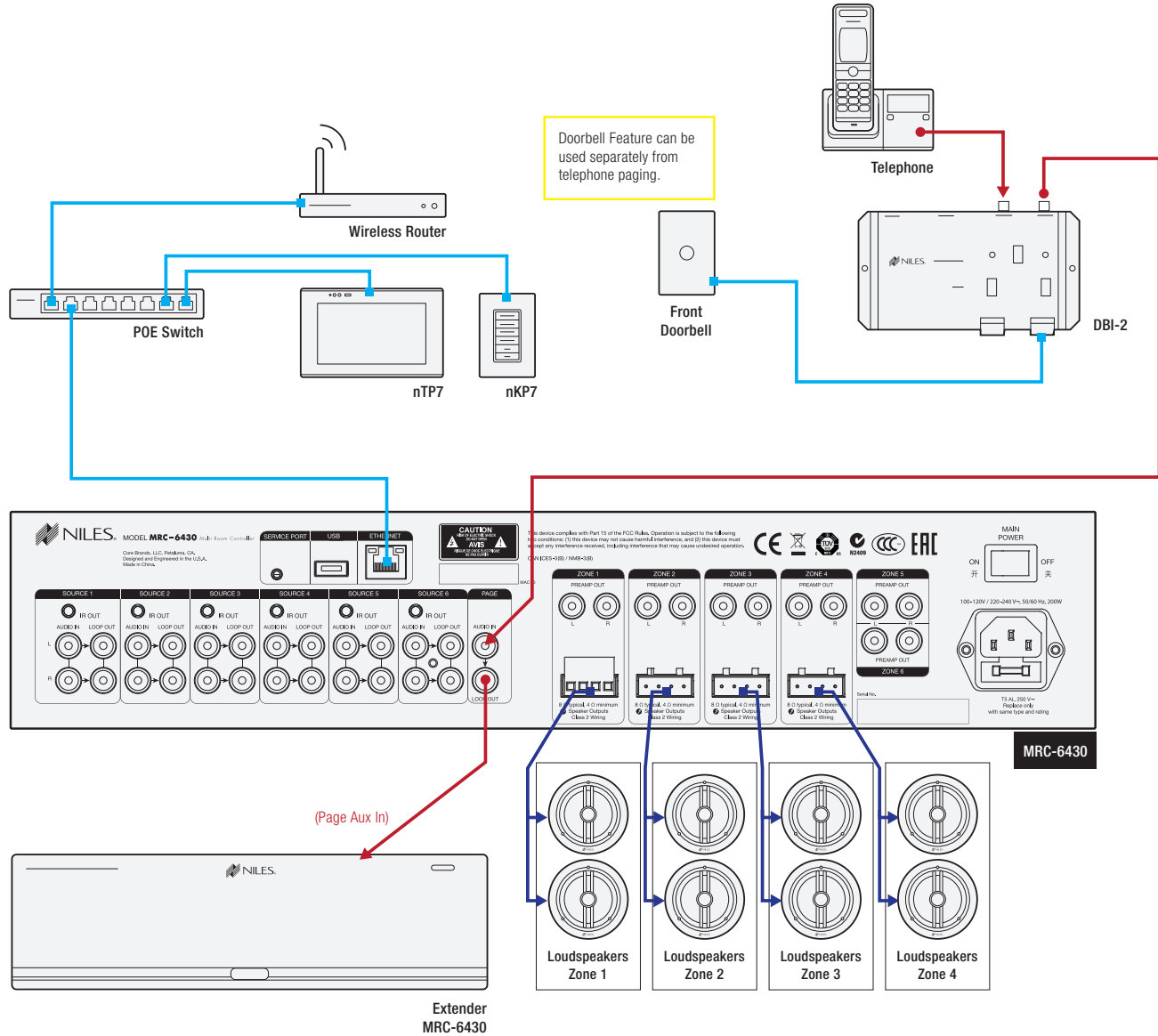

Cable Schedule

Doorbell Interface Connections

QTY	CABLE	SIGNAL	FROM	TO
1	Mono RCA	Audio	Telephone KSU Page Output	DBI-2 Audio Input
1	Mono RCA	Audio	DBI-2 Audio Output	Master MRC-6430: PAGE AUDIO IN
1	Mono RCA	Audio	Master MRC-6430: PAGE AUDIO OUT	Extender MRC-6430: PAGE AUDIO IN
1	CAT5	Trigger	Doorbell	DBI-2 Contact Closure #1

General System FAQs

Why are there no keypad connections on the rear of the MRC-6430?

The MRC-6430 is an IP based system and as such has no keypad connections on the rear. All user interfaces use internet protocol to communicate with the MRC-6430 system through the local area network (LAN), either hard-wired or via Wi-Fi. The MRC-6430 and all user interfaces must be connected to the same local area network (LAN).

What is the amplification of the MRC-6430?

The MRC-6430's built in amplification is 30 watts per channel into an 8 ohm load, 45 watts per channel into a 4 ohm load. Most distributed audio loudspeakers are 8 ohm compatible, however some are 6 or 4 ohms for greater output. The MRC-6430 internal amplifier can safely run loudspeakers that are 6 or 4 ohms.

Why or when should I use external amplifiers on the MRC-6430?

An external amplifier should be used to expand the MRC-6430 system. The MRC-6430 has pre-amp outputs for every zone for this purpose. An external amplifier should be used on zones 1-4 if the 30 watts per channel is not enough to run the desired in zone loudspeakers, or if you wish to run more loudspeakers in that zone (i.e. outdoor area). The MRC-6430 preamp outputs can be set for fixed or variable output depending on system design. On zones 1-4 the speaker outputs and pre-amp outputs can be used at the same time. An example of such usage could be to cover a patio and outdoor area as one large zone. This example would have the MRC-6430's zone 4 speaker outputs going to a pair of Niles OS (Outdoor series) loudspeakers under the eave of the patio and zone 4's variable pre-amp output going to a Niles SI-1230 amplifier (bridged or un-bridged) to run a number of Niles Weatherproof Rock loudspeakers scattered throughout the outdoor area. All loudspeakers in this area would play the same music source and go up and down together with the touch of a button on the zone's user interface. Use the Niles Online Impedance Calculator to calculate impedance on zones where more than one pair of speakers is being used <http://www.nilesaudio.com/techsupport/calculator/index.php>

Why or when should I use an additional MRC-6430?

An additional MRC-6430 should be used when more than 6 zones are needed in a project, expanding the basic 6 source 6 zone system architecture. A maximum of 2 (two) MRC-6430's can be used to create a 6 source by 12 zone system design. Please see the system design starting on page 16 in this guide for more information.

How do I configure the MRC-6430 system?

The MRC-6430 is an IP based Multi Room Controller and as such configuration of the system is done through the local area network router using either the nTP7 Touch Panel, 7 inch or larger mobile device (iPad or Android) communicating through Wi-Fi on the same local area network or using the PC or MAC viewer software. Set-up (Configuration) is integrator-friendly through the Auriel Software Wizard and, the installer is whisked through simple decisions that quickly configure the system for sources, zone preferences, user interface customization and home theater control. The Auriel Wizard configuration screens are safely protected behind a password protected hidden screen.

Can I change the password for configuring the MRC-6430 and HR200?

The MRC-6430 and nHR200 (Wi-Fi remote) use the same password to gain access their configuration screen, this is a fixed password (cannot be changed) for ease of memory and should not be given to the end-user.

How is the system wired?

The MRC-6430 system is wired using the same custom installation cables as previous Niles Multi Room/MultiZone systems and are not included. Keypads and touch panels are wired using CAT5 or higher custom installation cabling. The nKP7 7-button keypads are connected using CAT5 or higher cable to a PoE (Power over Ethernet) network switch only. The nTP7 Touchpanel can be connected using CAT5 or higher cable to the same PoE switch or can be powered locally (local powering requires additional 2 conductor power cabling) The MRC-6430 is wired to the network switch or router using CAT5 cabling. Sources are connected using line-level RCA cables for source audio and IR flasher cables (for control of IR sources) as needed. Streaming music sources must also be connected to the network switch or router for control (with compatible built-in drivers) and streaming services. The MRC-6430 connects to your speakers using 2-conductor speaker wire. For most applications, we recommend you use 16 or 18 gauge wire. For speaker wiring runs longer than 80 feet we recommend 14 gauge wire.

How do I update the system for newer product integration?

The MRC-6430 system and user interfaces such as the keypad and touchscreen use the Auriel Software. The Auriel Software is essentially the operating system and is pre-loaded at the factory. Based on production cycles and inventory stocking it is possible that the Auriel Software on the MRC-6430 should be updated. Updating the Auriel Software can be accomplished by downloading the latest version from the Niles Audio support site, then connecting the PC laptop to the Local Area Network (LAN) that the MRC-6430 system is connected to, using a CAT5 cable and running the self-executing software update.

How do I integrate a Home Theater system?

The MRC-6430 is a Multi Room Controller that can integrate a Home theater system one of two ways;

- 1) The Theater system is a separate zone (from the 6 built-in zones of the MRC-6430)
 - a. All sources connected to the AVR can be shared with the Whole House Music capability of the MRC6430 using the zone 2 output of the AVR and an IP built-in driver with compatible AVR's
 - b. Any Whole house sources connected to the MRC-6430 can be shared with the AVR by using the LOOP Output line level jacks of the MRC-6430 connected to a source input of the AVR
- 2) The Theater system can be a zone on the MRC-6430 by utilizing a zone pre-amp output of the MRC-6430. An example would be the Zone Pre-amp out of zone 5 can be run to a single audio input of the Home Theater AVR, thus sharing all of the house-wide audio sources of the MRC-6430 through one audio input of the AVR.

How many AVRs can I have?

The Auriel Software will allow for one Home Theater to be integrated.

Source FAQs

Are there any sources built into the MRC-6430?

No, there are no sources built-in to the MRC-6430. There are 6 source Line Level inputs that will accommodate many different types of sources.

What sources can I integrate into the MRC-6430 system?

The six source inputs are line level and can accommodate many different types of sources. Line level audio from any source can be brought into the MRC-6430 even if the source is not IR controllable, examples of these would be legacy devices such as tape decks, basic iPod docks, CD players, computer audio, even phonographs (using a phono-preamp).

Sources that can be controlled from a MRC-6430 user interface are separated into two categories; IR controllable and IP controllable.

The MRC-6430 has a built-in IR database of codes to control sources from around the world! The IR database is cloud-based and is updated frequently. IR controllable sources are items like Cable or Satellite set-top boxes, Outboard AM/FM tuners, CD/DVD or BluRay Players, Media players like Apple TV and Roku, Game Systems and iPod docks.

The MRC-6430 has built-in drivers for controlling sources via Internet Protocol (IP). These drivers are built-in, tested and allow two-way feedback and control of sources like Tuners\Internet Tuners built into AVR receivers from many third-party manufacturers. There are also two-way feedback drivers built-in to control media player sources such as Sonos, Autonomics, Yamaha Aventure and Logitech Music Service (LMS) based media players such as Fusion Research and S1Digital. The two-way feedback include various levels of Metadata and album art to be shown on the Auriel based user interfaces. The level of Metadata feedback is limited to the media player and music service.

How do I integrate an iPod into the system?

iPods as a source can be integrated two ways

An iPod can be a simple audio source with no control by taking the audio from the iPod and connecting it to the MRC-6430 source audio input RCA connectors. The connection from the iPod can be from the headphone jack or from a dock line level audio output.

Secondly, there are several IR controllable iPod Docks that are listed in the IR Database that provide basic control such as Play, Stop, Track\playlist skip forward and back. iPod Docks with Auriel IR control have no metadata feedback.

How do I integrate streaming music services into the MRC-6430?

The MRC-6430 does not have any music services built-in, music services are provided by third-party media players.

Media streaming services such as Spotify, TuneIn, Pandora and Rhapsody are subject to your country and media player availability. All IP controllable media players have support pages that detail the services available for their customers, additionally not all services are available world-wide. Niles has a Technical Resource Dealer Website that has Integration Guides that detail some of the specifics for supported and unsupported features for the media players we have drivers for. It is recommended to always read these Integration Guides before selling/integrating a music service for a client.

How do I control more than 6 IR controllable sources?

The IR outputs on the back of the MRC-6430 are available to be used with IR control sources and Home Theater TVs. There are 6 IR outputs that are completely assignable even though they are placed near the source audio inputs. This means the IR output located next to Source Input 1 can be used to control source 1 or can be re-assigned to control another source or the home theater TV (if needed). Use the Auriel configuration screens to assign multiple sources or the Home Theater TV/sources to the same IR output of the MRC-6430. Connect a Niles dual headed MicroFlasher™ to control two devices from the single IR output. Alternatively connect a Niles IR Main System Unit (MSU) to allow more than one IR Flasher to be utilized from any of the single IR output connections. Please refer to the system design on page 22 for reference and further details.

How do I add to/change the IR library?

The Cloud Based IR library is a very large collection of IR codes that Niles has gathered, vetted, and verified to contain the largest amount of devices that are likely to be used with the MRC-6430 system. The IR database has been captured so that function keys/buttons for sources are automatically mapped to interface templates to simplify the configuration process, and as such every device has been vetted and verified and is a representation of current and legacy devices from around the world. The database includes Domestic and International manufacturers in such categories as Media Management, Set-top Boxes (Cable and Satellite), CD players, DVD and Blu-ray players, Tuners, TVs/projectors, iPod docks and Gaming systems. Each category of source devices/TV/projectors has many manufacturers and service providers, including OEM manufacturers so the device you are looking for is likely to be in the IR database. The Niles MRC-6430 technical support-only website has a list of devices in the IR cloud database, however if you should find that a device that you need isn't in the library, a code is miss mapped, a code is missing, or a code doesn't function (for the latest model) there is an IR request form that can be filled out and submitted to Niles Technical Support for addition/amending of the Cloud based IR Database. Once submitted these request are evaluated and the Database is amended. Once the Cloud database is amended then all the installer needs to do is remove the IR controlled device in question, power cycle the MRC-6430 (while it is connected to the customer's network, with outside/internet connection), the MRC-6430 then re-pings the "IR Cloud" to update the IR library, the IR controlled device can be re-added to the configuration and changes will be applied. The Niles Auriel IR Cloud Database is updated regularly and the list of said devices is updated with when the last changes have been made.

User Interface FAQs

What are the available options for the customer to control the MRC-6430 system?

The MRC-6430 has many options for the end-user to operate the system, from the nHR200, a hand-held Wi-Fi remote control, the nKP7, a 7 button one-gang wall mounted keypad, the nTP7, a 7 inch portrait or landscaped mounted touch screen, a PC or MAC computer viewer, to mobile device control like iPhone, iPad, Android phone or tablets. Please refer to the section of this design guide on page 8 for more information.

How are the keypads and touch screens powered?

The nKP7 requires the use of a PoE (Power over Ethernet) injecting device. The PoE device must adhere to the IEEE 802.3at standard, 13w maximum draw (@48 V 270mA max). The nTP7 may be powered locally or with a PoE (Power over Ethernet) injecting device. When powering locally a 12v 1A power supply will need to be used. When powering the nTP7 with a PoE switch, or PoE injector, the device must adhere to the IEEE 802.3at standard, 13w maximum draw (@48 V 270mA max). There are a wide arrange of 3rd party PoE switches and injectors available to accommodate the system application.

Does the MRC-6430 support more than one HR200?

Currently the Auriel Software driven MRC-6430 supports only one nHR200 hand-held Wi-Fi remote. This remote control was designed to integrate both whole house music and home theater control into one remote that operates the same way the touch screen and mobile device control works, so your client needs to learn only one intuitive interface and he can use any of them!

Why do I see blank/unused buttons on my IR controllable source interface in the Auriel Viewer?

The MRC-6430 was designed to be very easy to configure/set-up with the built-in wizard Auriel software. The Auriel configuration wizard screens auto-map function buttons for all devices and as such do not provide any "Dragging and Dropping" of IR commands but automatically map the most commonly used commands and the right level of control you should be providing the end-user. As an example, when a satellite set-top box is configured the Channel numbers, Channel Up, and Channel Down are automatically mapped along with other functions, but not all functions found on the original remote may be mapped and some buttons are left blank (with no function assigned/mapped) on the touch screen based user interface. This is a normal occurrence and should be no cause for alarm.

Replacement Questions

Are there any parts or pieces of Niles previous Multi Room/MultiZone systems that are compatible with the new MRC-6430 system?

The MRC-6430 is not backward compatible with any other Niles Multi Room system or user interfaces. The MRC-6430 was designed with a completely new architecture to address Niles Dealers/Installers and End-user request for mobile device control. This request for mobile device control and demand for streaming music services with feedback led to an architecture that is IP based, whereas none of the previous Niles MultiZone were IP based. Previous Niles MultiZone systems (ZR-4630, ZX-8630AV, A4.6Ci, ZR-4, ZR-6 or IntelliControl ICS GXR-2 systems) can be completely pulled out including the user interfaces and the new MRC-6430 can use the existing CAT5 and speaker wiring, however the CAT5 cable used for the keypad and touchscreens of the older Niles MultiZone system should be examined to be terminated using T568A or T568B. That CAT5 cable can be used with the new Niles user interfaces nKP7 and nTP7 but must be connected to the same customer's local area network via a PoE switch. The speaker wire infrastructure can be used on the new MRC-6430 Multi Room system.

ADDITIONAL INFORMATION

WARRANTY

All Niles products are manufactured with reliability in mind and backed by factory warranties against defects in materials or workmanship. For details, see the warranty statement included with each product.

Customer Service and Technical Support

Call: 800-289-4434 (BUY-HIFI)

Customer Service is available from 8:00 AM to 5:30 PM (PST)

Technical Support is available from 8:00 AM to 7:00 PM (PST)

Online at: www.nilesaudio.com/ or via email: techsupport@nilesaudio.com

PRODUCT SUGGESTIONS

We are eager to hear your product suggestions. Please e-mail your suggestions to: productsuggestions@nilesaudio.com

Like us on facebook at: [facebook.com/NilesAudio](https://www.facebook.com/NilesAudio)

Niles strives to constantly improve our products, all specifications may change without notice.



©2015 Core Brands, LLC. All rights reserved.
Niles® is a registered trademark of Core Brands, LLC, a Nortek company.

1800 South McDowell, Petaluma CA 94954 – Tel: (800) BUY-HIFI (289-4434) – www.nilesaudio.com – P/N 9901343 – Rev-A0