

[4] Schematic diagram/Wiring side of P.W.Board

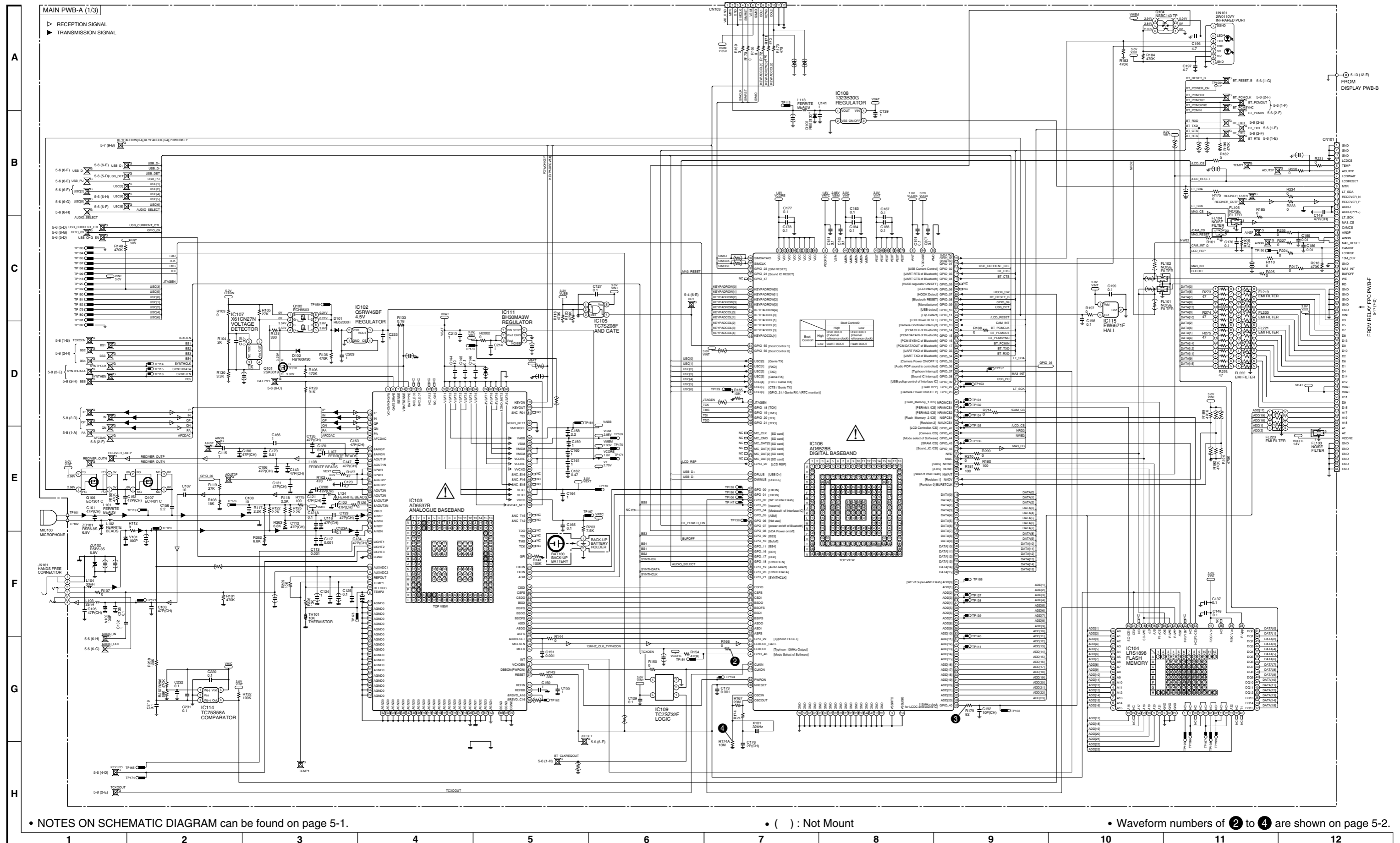

• NOTES ON SCHEMATIC DIAGRAM can be found on page 5-1.

• () : Not Mount

• Waveform numbers of ② to ④ are shown on page 5-2.

Figure 1 SCHEMATIC DIAGRAM (1/6)

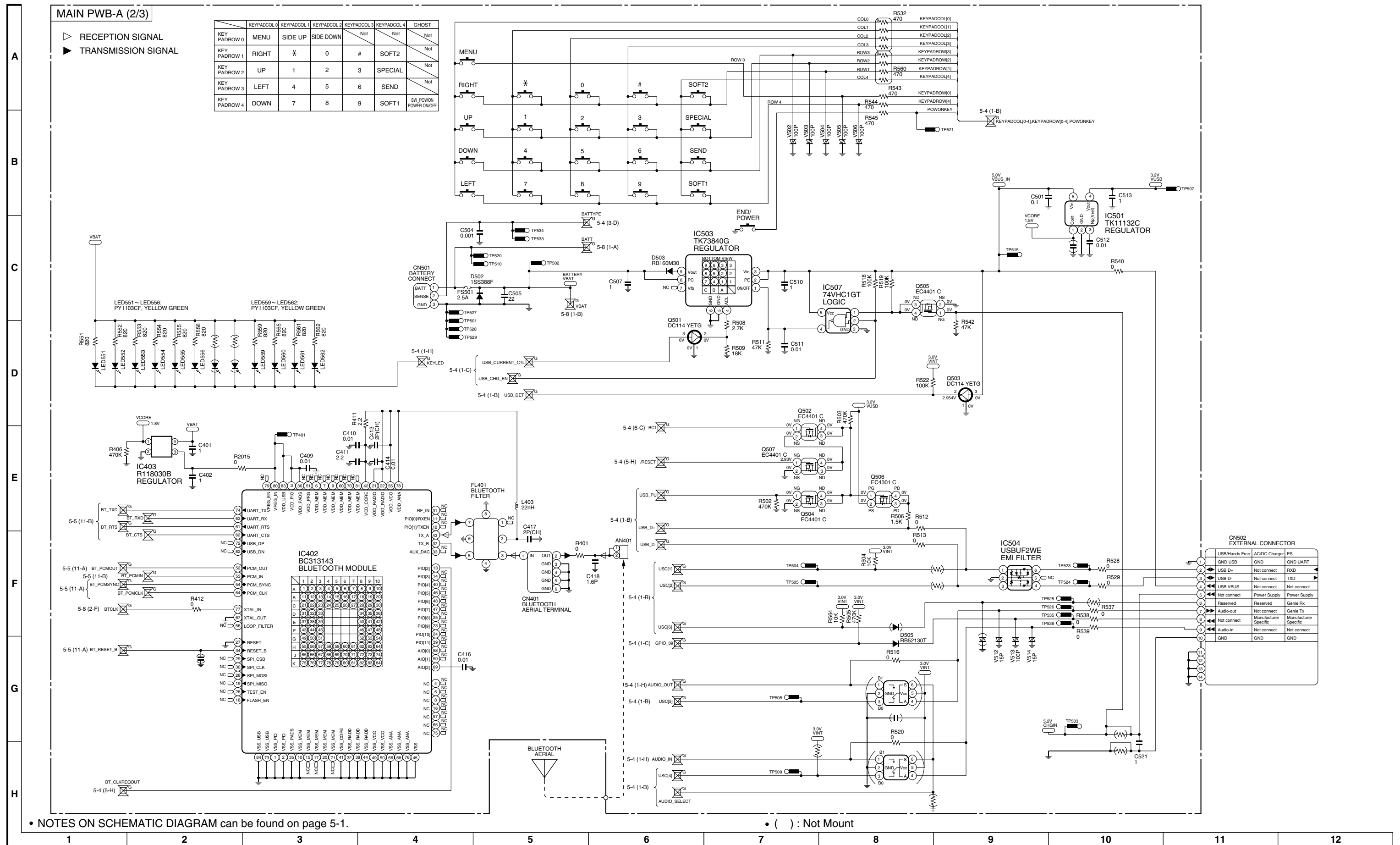

Figure 2 SCHEMATIC DIAGRAM (2/6)

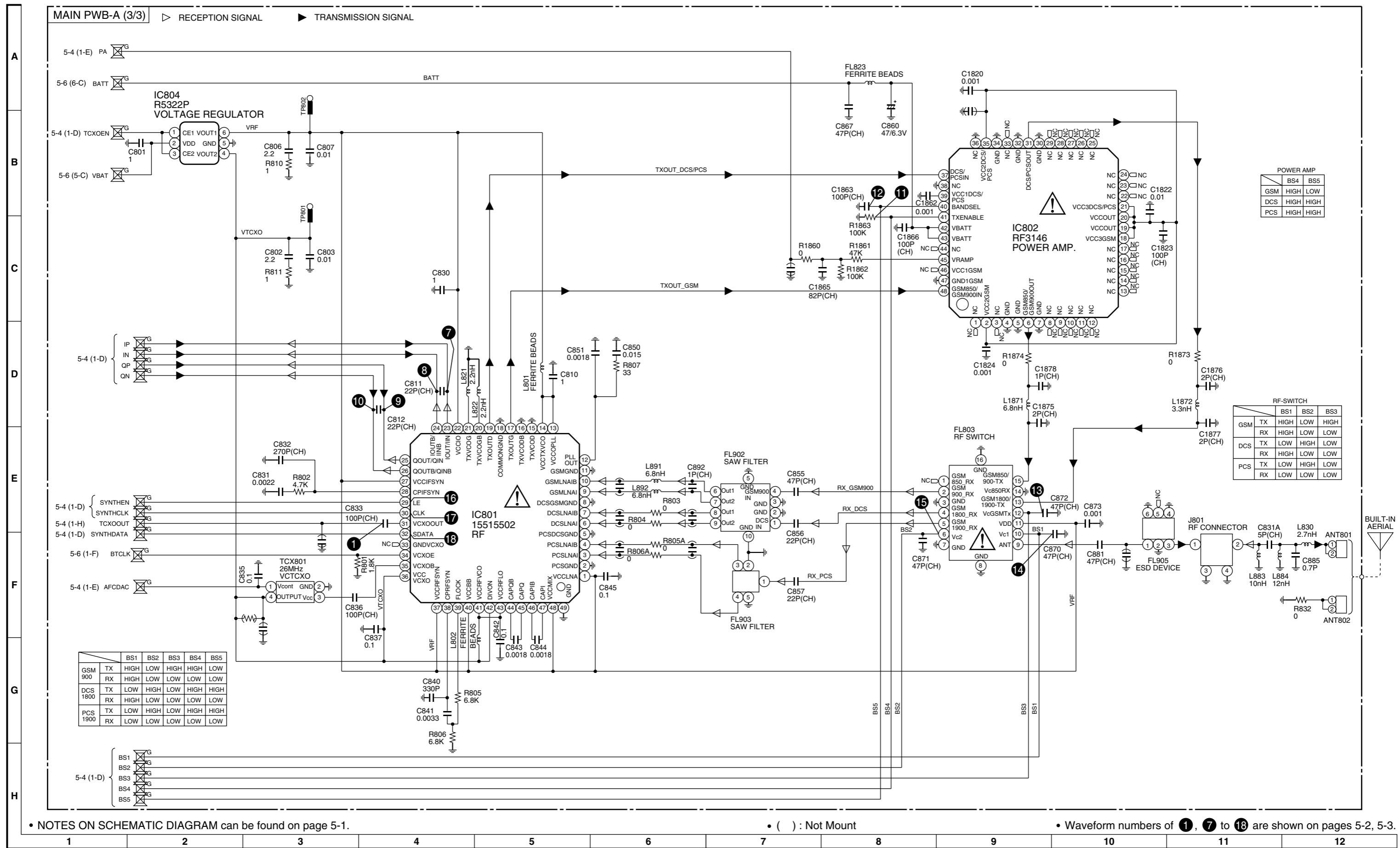
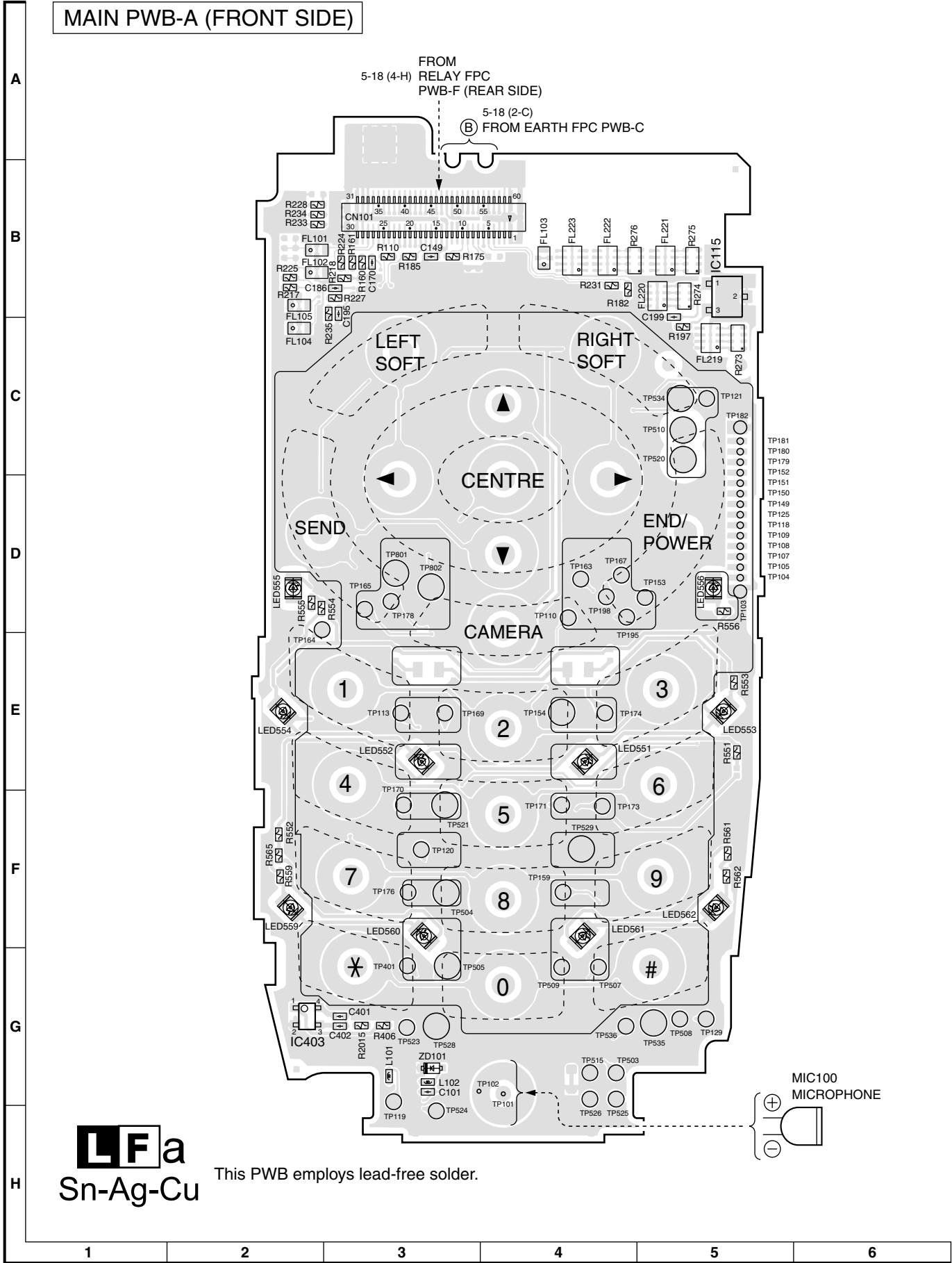

Figure 3 SCHEMATIC DIAGRAM (3/6)

MAIN PWB-A (FRONT SIDE)



LFa
Sn-Ag-Cu

This PWB employs lead-free solder.

Figure 4 WIRING SIDE P.W. BOARD (1/5)

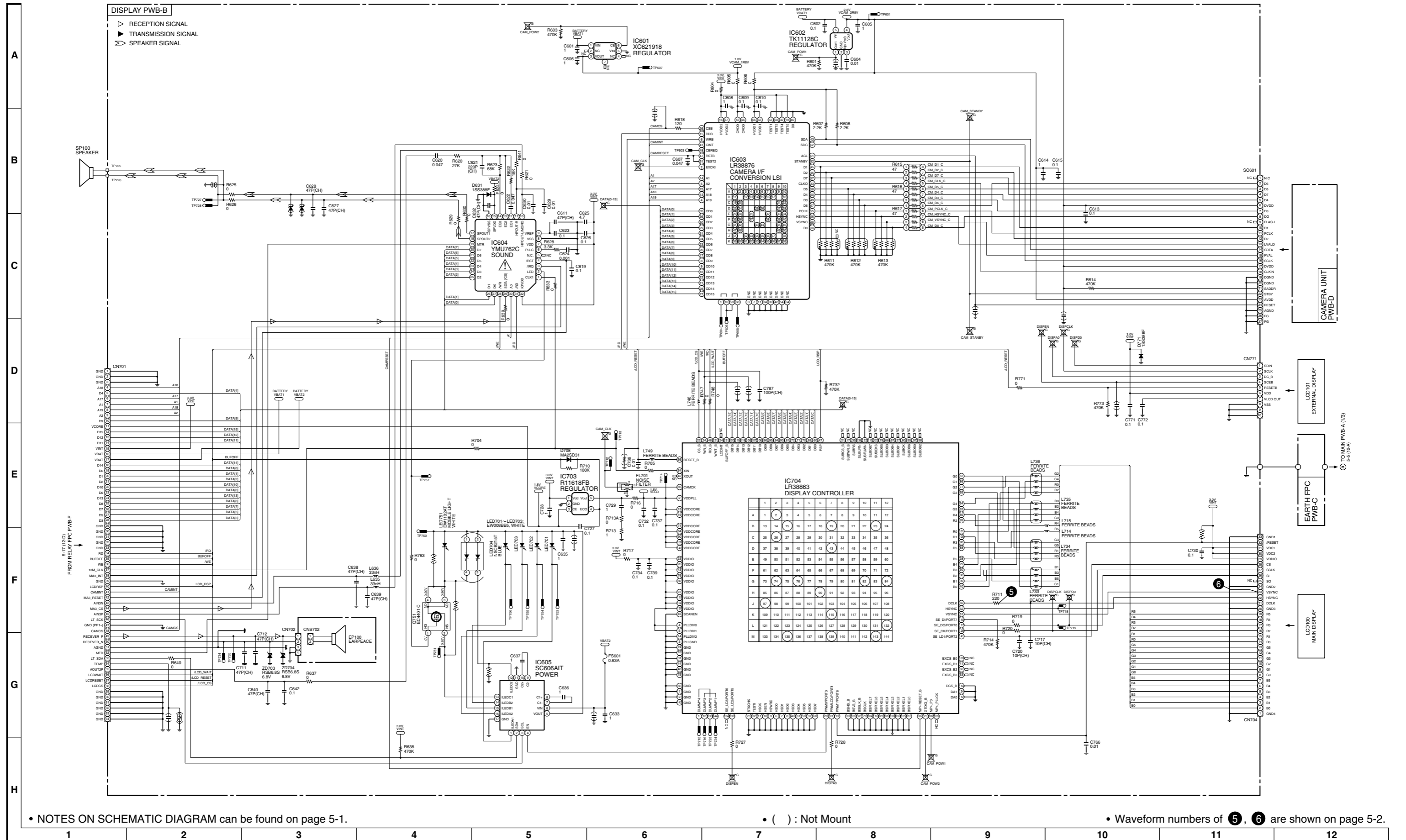
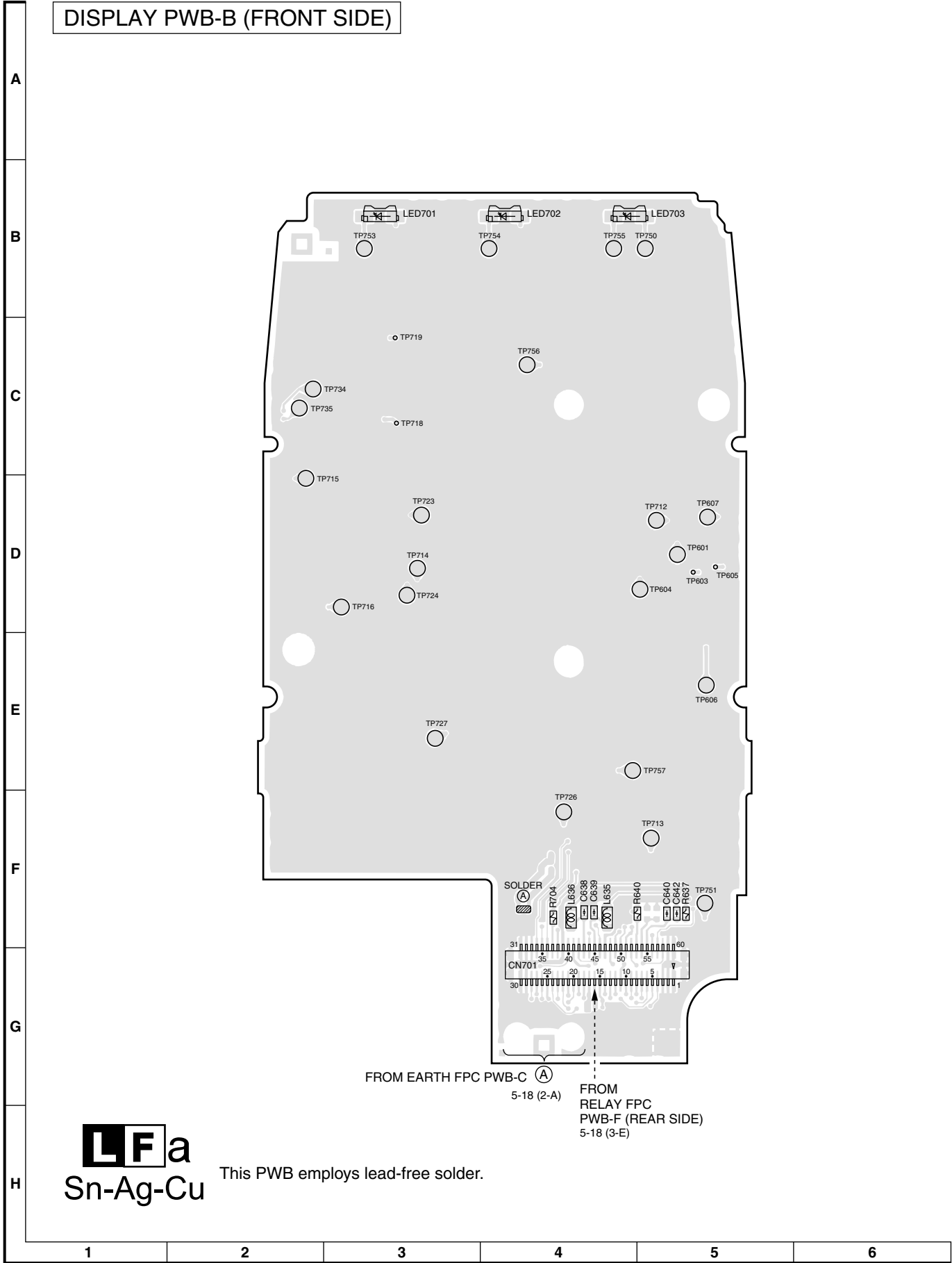

Figure 6 SCHEMATIC DIAGRAM (4/6)

DISPLAY PWB-B (FRONT SIDE)



LFa
Sn-Ag-Cu

This PWB employs lead-free solder.

Figure 7 WIRING SIDE P.W.BOARD (3/5)

DISPLAY PWB-B (REAR SIDE)

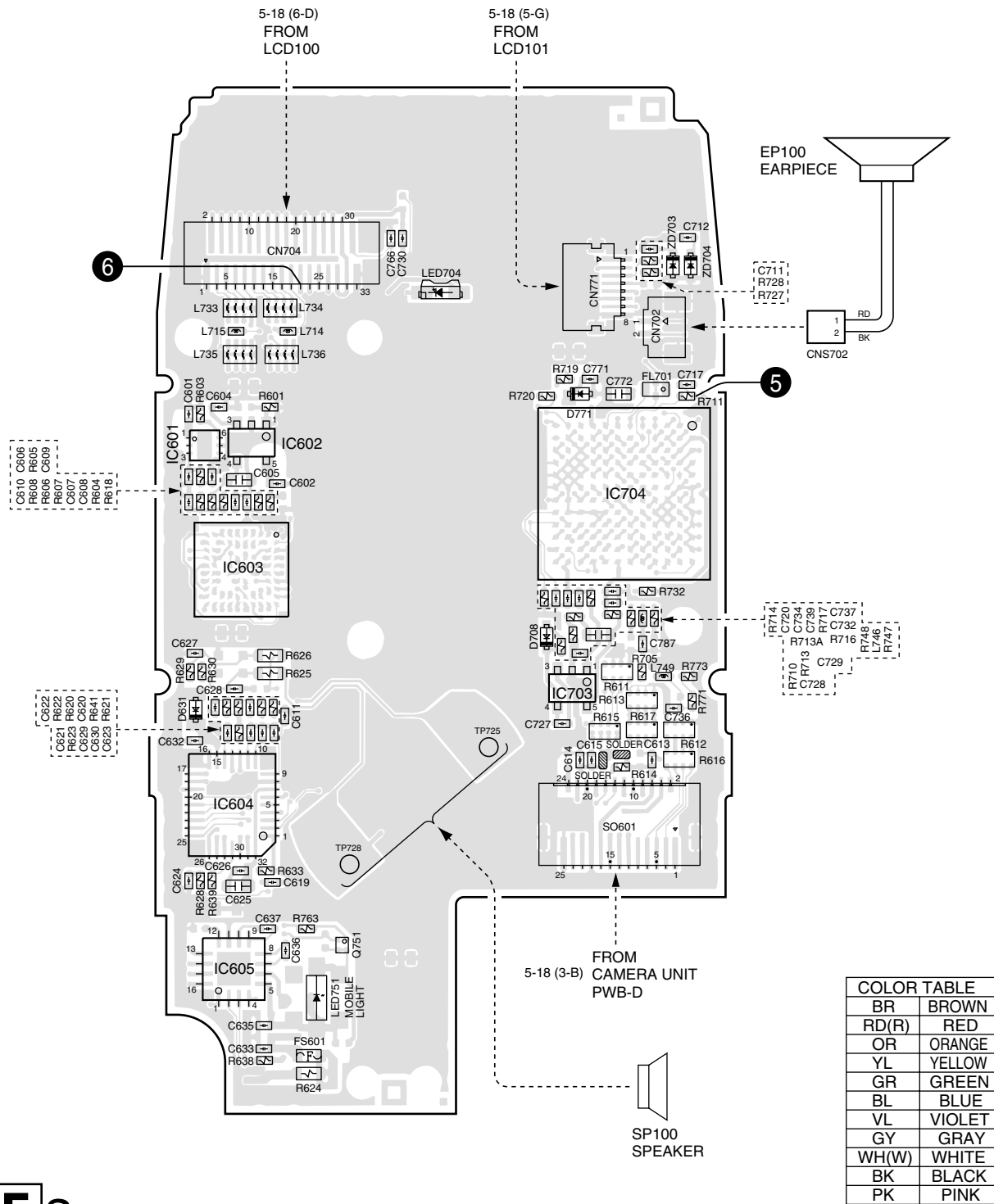

LFa
Sn-Ag-Cu

This PWB employs lead-free solder.

• Waveform numbers of 5, 6 are shown on pages 5-2.

7	8	9	10	11	12
---	---	---	----	----	----

Figure 8 WIRING SIDE P.W.BOARD (4/5)

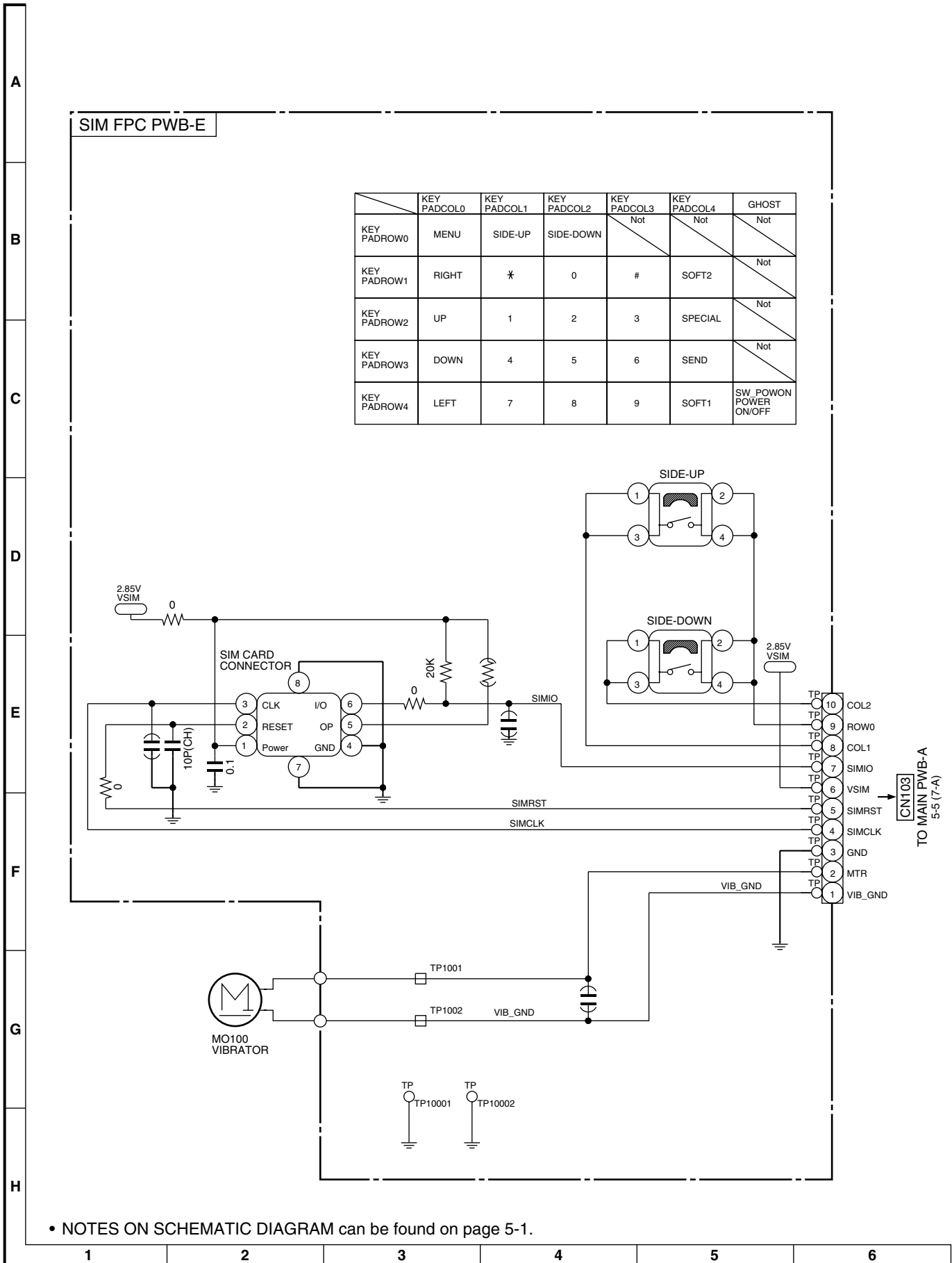
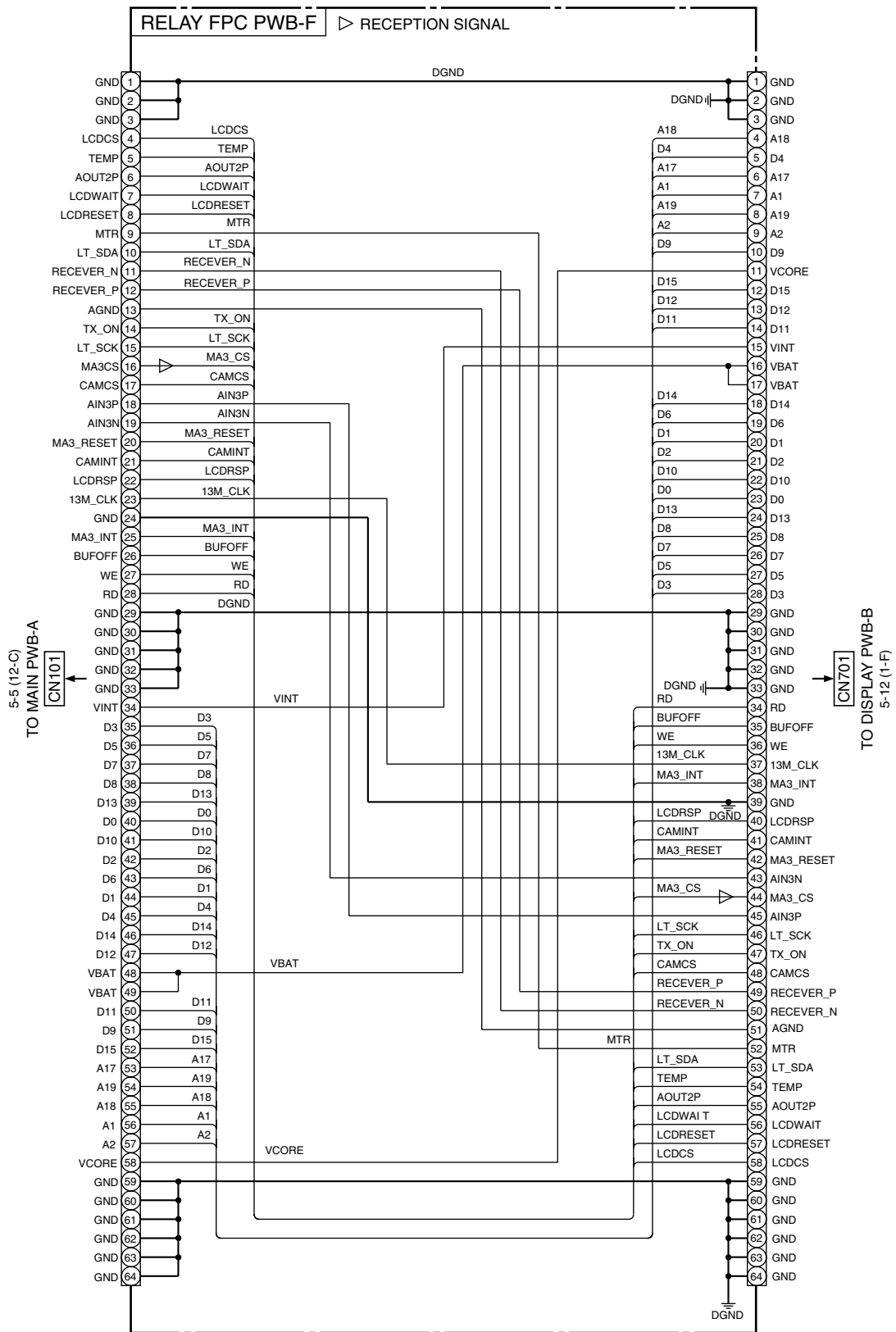

Figure 9 SCHEMATIC DIAGRAM (5/6)



• () : Not Mount

7	8	9	10	11	12
---	---	---	----	----	----

Figure 10 SCHEMATIC DIAGRAM (6/6)

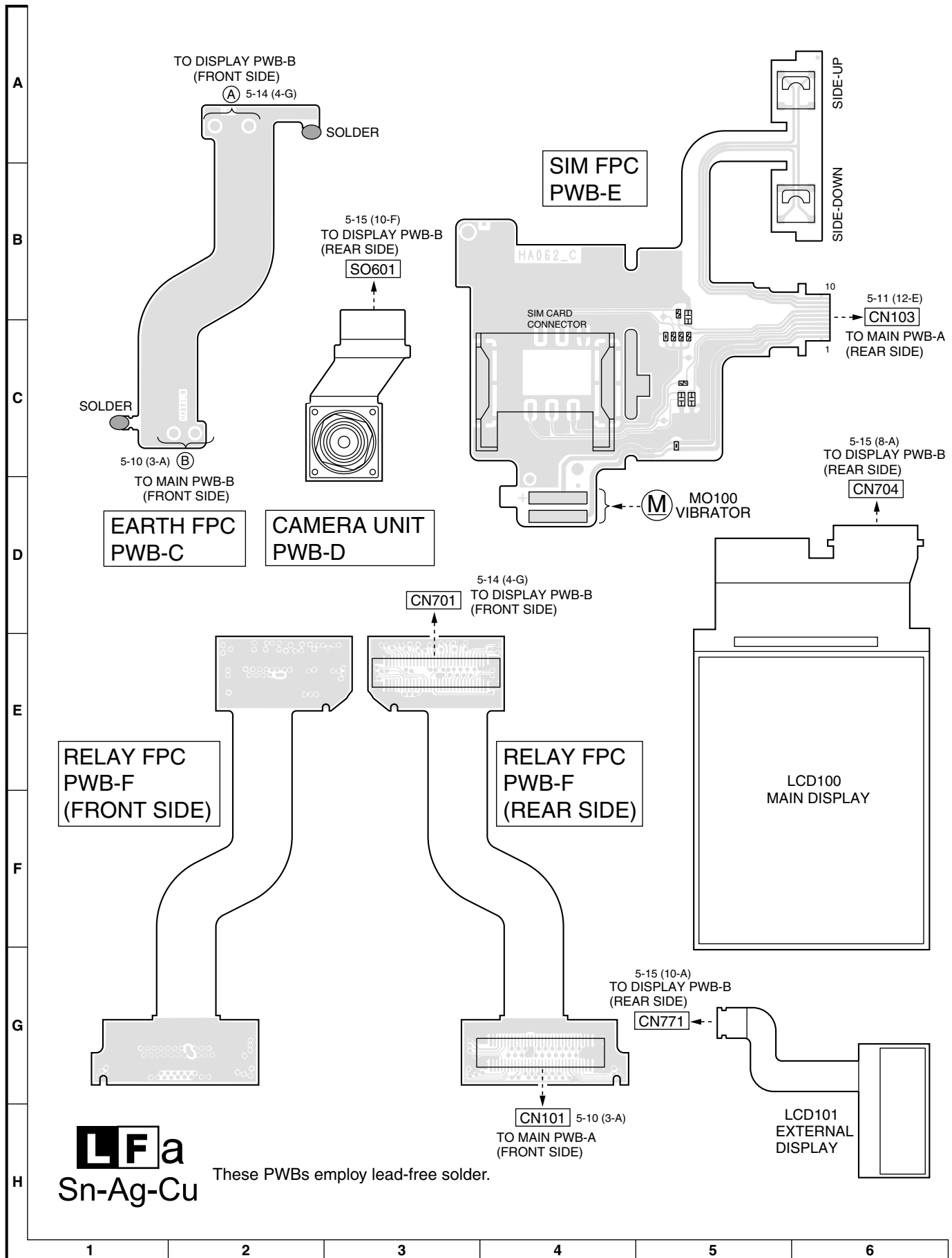

Figure 11 WIRING SIDE P.W.BOARD (5/5)