

1-13-76



PIONEER
CHAIN SAWS

**ILLUSTRATED
PARTS
CATALOGUE**

model
1073

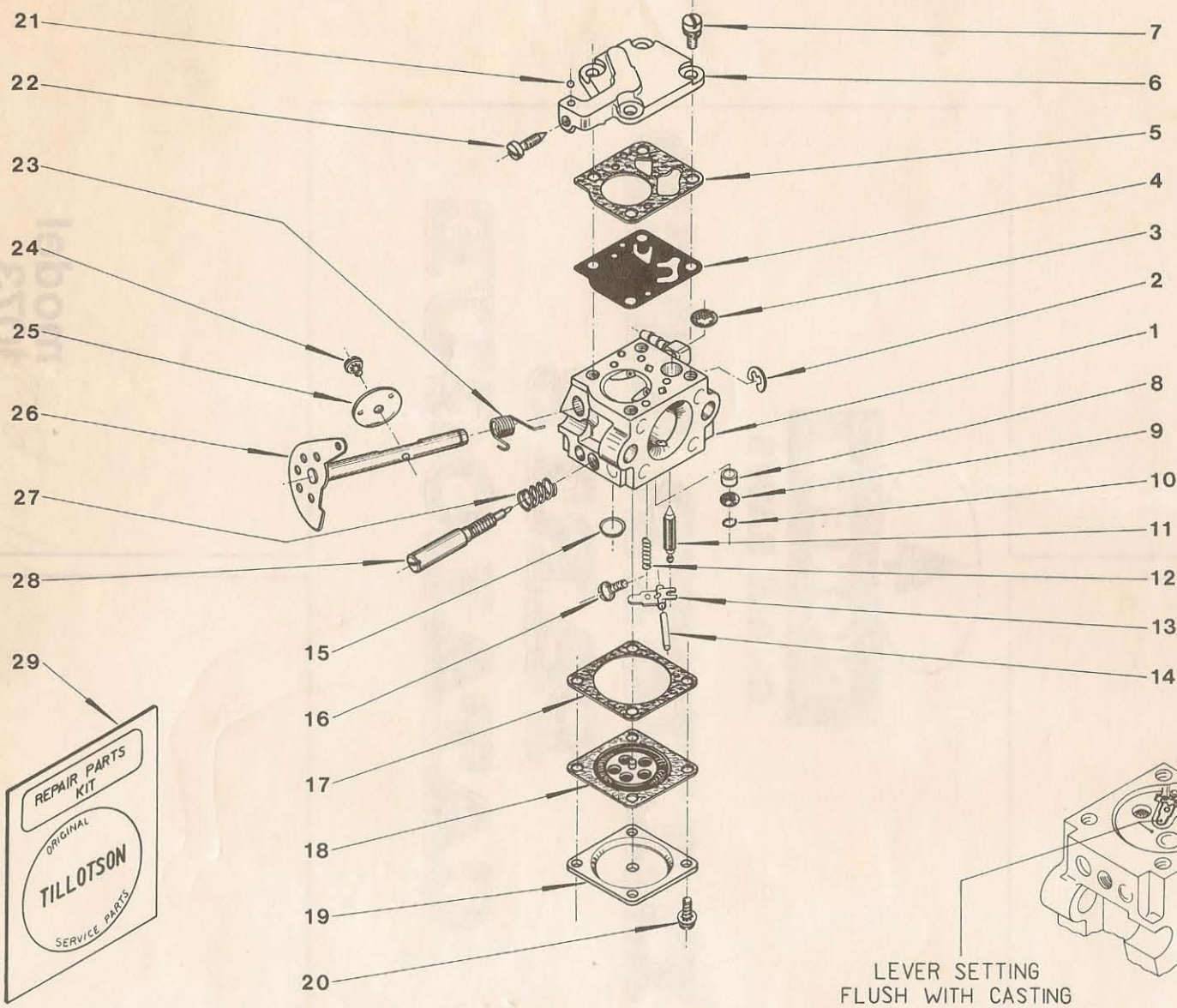

LEVER SETTING
FLUSH WITH CASTING

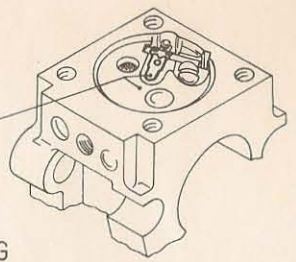

68474-9

PIONEER MODEL 1073

REF. NO.	PART NO.	NAME OF PART	QTY. PER ASSY.	REF. NO.	PART NO.	NAME OF PART	QTY. PER ASSY.
1	473870	Carburetor Assembly Complete . .	1	*15	430294	. Plug, 9/32 Dia. Welch	1
2	430281	. "E" Ring	1	*16	427962	. Screw, 4-40 x 5/16 Oval Hd. . .	1
*3	427951	. Screen	1	*17	430288	. Gasket, Metering Diaphragm . .	1
*4	430290	. Diaphragm, Fuel Pump	1	*18	473958	. Diaphragm Assembly	1
*5	430291	. Gasket, Fuel Pump	1	19	430289	. Cover, Diaphragm	1
6	430298	. Cover, Pump	1	20	426415	. Screw & Lockwasher, 4-40 x 1/4 RD. HD.	4
7	430296	. Screw & Lockwasher (6-32 x 5/16 FIL. HD.)	4	21	430285	. Ball 3/32 DIA Nylon	1
8	430302	. Cage, Main Fixed - Orifice & Nozzle	1	*22	430301	. Screw, Idle Sped Regulating . .	1
9	427942	. Screen	1	*23	430299	. Spring, Throttle Return	1
10	427943	. Ring, Retainer	1	*24	430280	. Screw & Lockwasher, 4-40 x 3/16 RD. HD.	1
11	427952	. Needle, Inlet	1	25	430292	. Shutter, Throttle	1
*12	430293	. Spring, Tension	1	26	473959	. Throttle Shaft & Lever Assy. . .	1
*13	430297	. Lever, Inlet Valve Control	1	*27	425449	. Spring Adjusting Screw	1
*14	430295	. Pin, Fulcrum	1	28	430300	. Screw, Idle Adjustment	1

* NOTE: Parts included in repair parts kit part no. 473960

INDENTED PART NAMES INDICATE THAT THESE PARTS ARE INCLUDED IN PRECEDING ASSEMBLY
ORDER ALL PARTS FROM YOUR LOCAL AUTHORIZED DEALER

PIONEER MODEL 1073

REF. NO.	PART NO.	NAME OF PART	QTY. PER ASSY.	REF. NO.	PART NO.	NAME OF PART	QTY. PER ASSY.
1	474426	Crankcase Half Assy., Mag. Side .	1	31	430112	Washer, Air Filter Cover	1
2	473861	Crankcase Half Assy., Strut Side .	1	32	430114	Air Filter Cover	1
3	430442	Gasket, Crankcase	1	33	430520	Air Filter Element	1
4	474536	Crankshaft & Conrod Assy.	1	34	430519	Sealing Strip, Air Filter Cover	1
5	427662	Bearing, Wristpin	1	35	429593	Muffler Body	1
6	427671	Retainer, Wristpin	2	36	473916	Baffle & Screen Assy. (Optional)	1
7	429216	Wristpin	1	37	473912	Cover, Muffler	1
8	473150	Piston Assembly	1	38	307193	Screw, Muffler Cover	3
9	473155	Piston Ring set	1	39	510195	Screw, Muffler to cylinder (see also item No. 109)	3
10	428746	Oil Seal	2	40	306546	Lockwasher, Muffler to cylinder .	2
11	427849	Main Bearing	2	41	306286	Screw, Cylinder Shroud to C'Case	2
12	430589	Key, Flywheel	1	42	429726	Screw, Handle Brace	1
13	430119	Throttle Link	1	43	306542	Rear Handle Brace	1
14	427696	Throttle Trigger	1	44	429266	Nut, Handle brace	1
15	429262	Gasket, Cylinder	1			Screw, Handle Brace (see also item No. 114)	2
16	430398	Cylinder	1	45	311516	Screw, Condenser to Crankcase . .	1
17	429309	Muffler Shroud	1	46	307190	Screw, Crankcase Halves	12
18	473524	Decompression Valve Assy.	1	47	316133	Screw, Cylinder Shroud to C'case (see also item no. 110)	1
19	429852	Cylinder Shroud	1	48	300635	Screw, Cylinder Base	4
20	428601	Spark Plug (C6J)	1	49	306985	Lockwasher, Cylinder Base	4
21	580339	Sparky Cover Assembly	1	50	315381	Nut, Cylinder Base	4
22	473770	Oil Cap Assy.	1	51	429702	Washer, Decompression Valve	1
23	429324	. "O" Ring - Oil Cap	1	52	473589	Air Vent Valve (packaged)	1
24	473769	Gas Cap Assy.	1	53	429590	Grounding Switch	1
25	429322	. "O" Ring - Gas Cap	1	54	306531	Nut, Rear Handle	1
26	473161	Condenser Assembly	1	55	307175	Screw, Rear Handle	1
27	430117	Decal - Air Filter Cover	1	56	429650	Grommet, Choke Knob	1
28	430111	Pin, Air Filter Cover	1	57	430113	Choke Knob	1
29	309301	Roll Pin, Air Filter Cover	1	58	318251	Screw - Crankcase Halves	1
30	430115	Spring, Air Filter Cover	1				

INDENTED PART NAMES INDICATE THAT THESE PARTS ARE INCLUDED IN PRECEDING ASSEMBLY
 ORDER ALL PARTS FROM YOUR LOCAL AUTHORIZED DEALER

The Pioneer Model 1073 is equipped with the Pioneer Lightweight Bar Part No. 473141 and Pioneer 3/8 Pitch Sureguard Chain Part No. 474083. Optional Bars & Chain can be purchased through your local Pioneer Dealer.

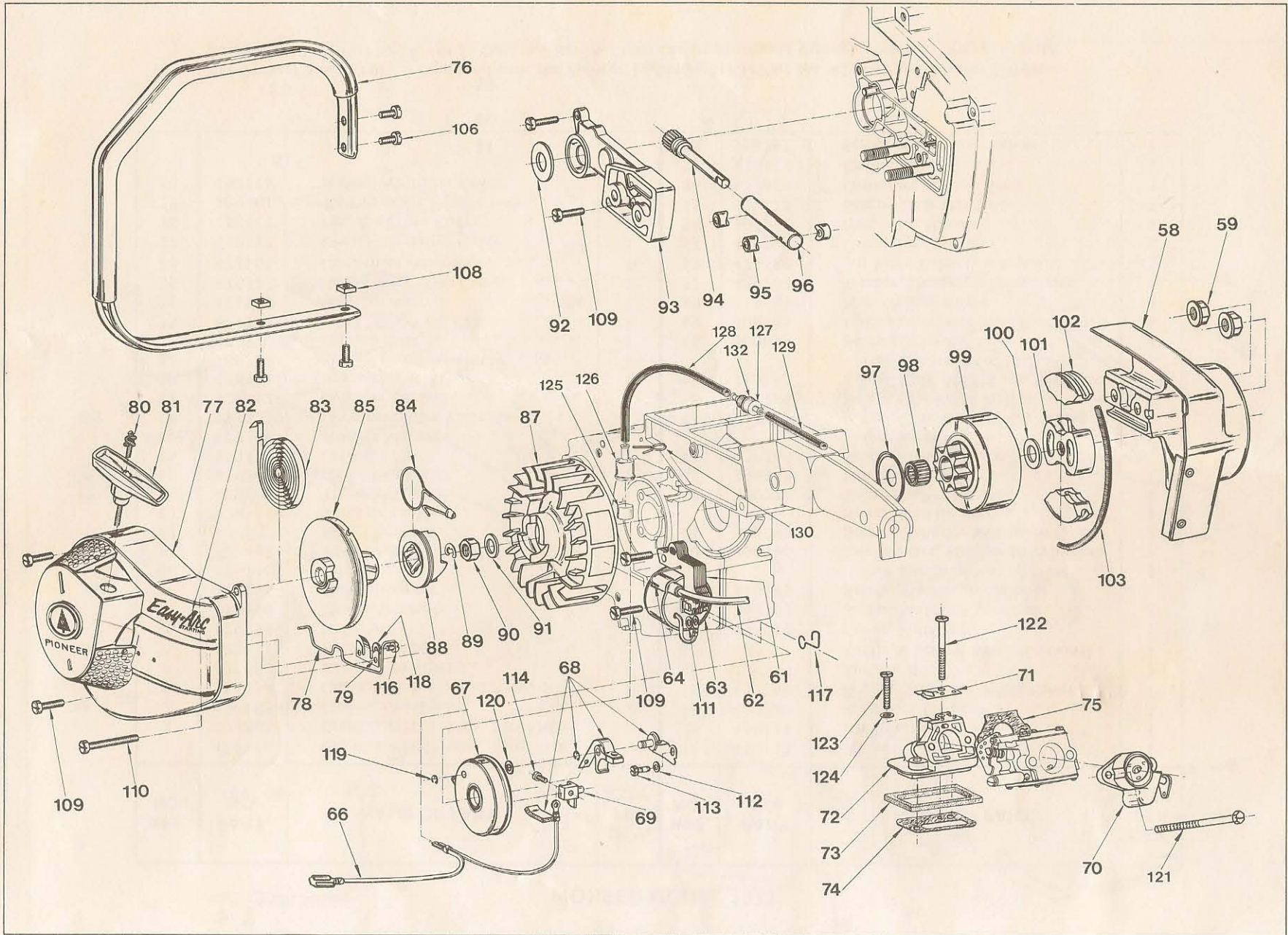

PIONEER MODEL 1073

REF. NO.	PART NO.	NAME OF PART	QTY. PER ASSY.	REF. NO.	PART NO.	NAME OF PART	QTY. PER ASSY.
58	473619	Stur Assembly	1	96	473869	Pump Sleeve Assy., Oil Pump . . .	1
59	429903	Flange Nut	2	97	429672	Thrust Washer, Inner Clutch . . .	1
61	473341	Core Assembly	1	98	429526	Bearing, Clutch	1
62	427745	H.T. Lead	1	99	474447	Sprocket & Clutch Drum Assy. . .	
63	473340	Coil with H.T.	1			with bearing	1
64	429422	Retainer	1	100	429252	Thrust Washer, Outer Clutch . . .	1
66	473627	Switch Wire Assembly	1	101	429250	Clutch Driver	1
67	429929	Ignition Cover	1	102	429251	Clutch Shoe	2
68	473750	Breaker Point Set with Wiper . . .	1	103	426964	Garter Spring	1
69	429925	Terminal Block	1	106	510338	Screw, Front Handle	4
70	473858	Blowback Tube & Choke Assy. . .	1	108	306542	Nut, Front Handle	2
71	430110	Bracket, Air Filter Cover	1	109	510195	Screw, Bar Pad to Crankcase . . .	2
*	473865	Insulating Block Assy. Complete .	1			Screw, Blower Cover to C'case . .	2
72	430105	● Insulating Block	1			Screw, Coil Lamination	2
73	429305	● Seal - Insulating Block	1			(see also item No. 39)	
74	430102	● Gasket - Cyl. to Intake	1	110	316133	Screw, Blower Cover to C'case	
75	430103	● Gasket - Insulating Bl. to Carb. .	1			(see also item no. 47)	1
76	474521	Front Handle Assembly	1	111	300154	Washer, Lamination	1
77	473635	Blower Cover & Screen Assy. . .	1	112	303497	Washer, Base Breaker Plate	1
78	429573	Lever, Decompression Valve . . .	1	113	429928	Screw, Base Breaker Plate	1
79	429575	Spring, Lever	1	114	429266	Screw, Terminal	
80	429278	Starter Rope	1			(see also item no. 44)	1
81	429549	Starter Handle	1	116	309467	Screw, Decompression Valve	2
82	429584	Decal "Easy* Arc"	1	117	430052	Clip Assy., H.T. Lead	1
83	604257	Starter Spring	1	118	308507	Washer, Decompression	1
84	473637	Yoke Assy.	1	119	202755	Retaining Ring, Breaker Pin . . .	1
85	430609	Starter Pulley Ass'y.	1	120	429927	Seal, Breaker Housing	1
87	473160	Flywheel Assembly	1	121	318521	Screw, Carburetor	2
88	429892	Pinion	1	122	316781	Screw, Insulating Block	1
89	429246	Retaining Ring	1	123	305879	Screw, Insulating Block	1
90	404837	Nut, Flywheel	1	124	305863	Washer, Insulating Block	1
91	429851	Washer, Flywheel	1	125	425670	Felt - Pickup	1
92	427917	Seal Washer	1	126	473459	Fuel Pick-up Assembly	1
93	430352	Bar Pad	1	127	473772	Connector ass'y.-Pickup Head to	
94	473166	Plunger Assembly, Oil Pump . . .	1			Tank Wall	1
95	429274	Spacer, Oil Pump	3	128	429677	Fuel Line - Pickup Head	1
				129	430106	Fuel Line - Tank to Carb.	1
				130	429471	Clamp	1
				132	305857	"O" Ring - Connector	1

* NOT SHOWN

INDENTED PART NAMES INDICATE THAT THESE PARTS ARE INCLUDED IN PRECEDING ASSEMBLY
 ORDER ALL PARTS FROM YOUR LOCAL AUTHORIZED DEALER

Chain part no - is 474359

$\frac{3}{8}$ pitch - .050 ga.

14" Bar