



# 7.2V R/C

00007-2041

**CAUTION-ELECTRIC TOY**-NOT RECOMMENDED FOR CHILDREN UNDER 8 YEARS OF AGE. AS WITH ALL ELECTRIC PRODUCTS, PRECAUTIONS SHOULD BE OBSERVED DURING HANDLING AND USE TO PREVENT ELECTRIC SHOCK.  
 INPUT: 120VAC, 60Hz, 12VA. OUTPUT: 8.5VDC, 420mA, 3.8V.

## TYCO® R/C SUPPORT

Questions or problems with your product?  
**DON'T RETURN IT TO THE STORE!**  
 Just call us for help.

U.S. consumers may also register their products at this number.  
**1 888 557-TYCO (8926)**

**tycorc.com**

**CAUTION:** Surfaces may become hot and cause burns if electronics get wet. Do not operate vehicle through water or snow.

Keep these instructions for future reference; they contain important information.  
**IMPORTANT:** Please read all "Consumer Information" (last page) before operating your vehicle.

### CONTENTS/FEATURES

- Vehicle
- Transmitter
- 7.2V Battery Pack
- 7.2V Wall Charger
- 9V Battery

### Vehicle

- 1 Steering Adjuster
  - ☛ Turn with a screwdriver (not included) to keep vehicle running straight.
- 2 Battery Door
- 3 Battery Latch
- 4 ON/OFF/SOUND Switch
  - ☛ This switch has 3 positions:
  - ☛ = Vehicle ON (cool engine sounds). In this position, your vehicle will run with cool "revving" engine sound effects as you drive.
  - = Vehicle OFF
  - ☛ = Vehicle ON (no sounds). In this position, your vehicle will run with engine sound effects off.

### MultiBand™ Selector Switch

☛ Please see the "MultiBand™ Feature" Section for more information.

### Transmitter

- 1 Vehicle Controls
- 2 Antenna
- 3 MultiBand™ Selector Switch

☛ Please see the "MultiBand™ Feature" Section for more information.

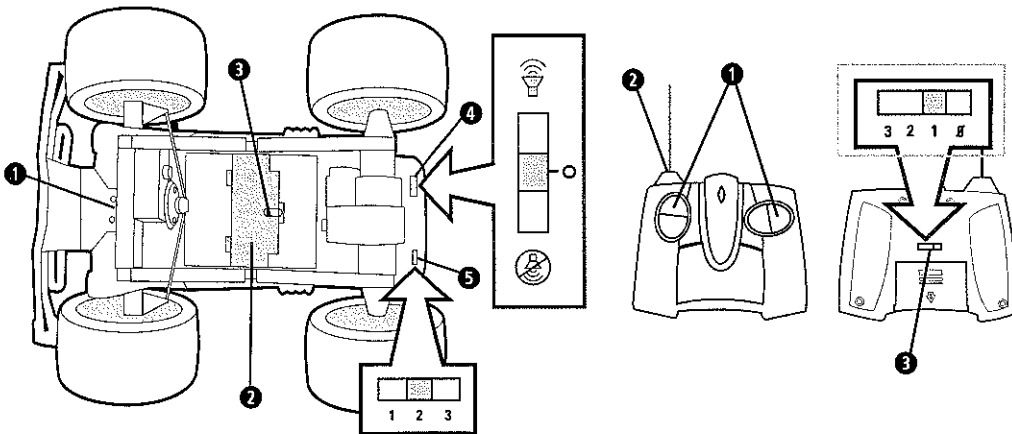

### VEHICLE OPERATION

FORWARD



REVERSE



LEFT



RIGHT



## MULTIBAND™ FEATURE

- Your vehicle features the advanced Tyco® R/C MultiBand™ system. This system lets you race your vehicle head-to-head – against up to two of your friends (up to 3 drivers total) – without any radio interference from your friends' transmitters or vehicles. **You must be racing against another Tyco® R/C MultiBand™-equipped vehicle for this feature to work.**
- There's one MultiBand™ Selector Switch on your vehicle chassis, and another one on your transmitter. The vehicle switch has 3 positions: one for each MultiBand™ setting.



The transmitter switch has 4 positions: one for each MultiBand™ setting, plus an OFF position.



- For successful operation, the vehicle switch and the transmitter switch must be set to the same MultiBand™ setting. When you're driving by yourself, you can set the switches to any of the 3 MultiBand™ settings (as long as they match).
  - When you want to race head-to-head, just make sure that each driver (up to 3 drivers total) has a vehicle and transmitter set to a different MultiBand™ setting.
- ☀ The transmitter's MultiBand™ Selector Switch also serves as the transmitter's power switch. To operate your vehicle, just turn the vehicle ON; then set the transmitter switch to the desired MultiBand™ setting. Push any transmitter control and you will be able to run and control your vehicle.
- ☀ You must be racing against another Tyco® R/C MultiBand™-equipped vehicle for this feature to work. A non-MultiBand™ vehicle, running on the same frequency as your vehicle, may interfere with operation of your vehicle. If you are racing against a non-MultiBand™ vehicle, make sure that vehicle operates on a frequency different from yours.
- ☀ If you need to change the MultiBand™ setting, first make sure that your vehicle is turned OFF. Change the switch position as desired, making sure to change both the transmitter AND the vehicle switches. Then turn your vehicle back ON for more racing action. NOTE: Make certain you're not pressing a transmitter control while changing selector switch position.

## BATTERY INSTALLATION

For detailed information regarding rechargeable battery charging and safety, please refer to the "Battery Charging/Care" Section.

### Vehicle

1. Rotate the battery door latch to unlocked position and open the battery door.
2. Insert the charged battery pack into the battery compartment as shown.
3. Connect the battery pack's wire connector to the vehicle's charging jack as shown. Make certain the connector is securely connected.
4. Close the battery door and rotate the battery door latch to locked position.

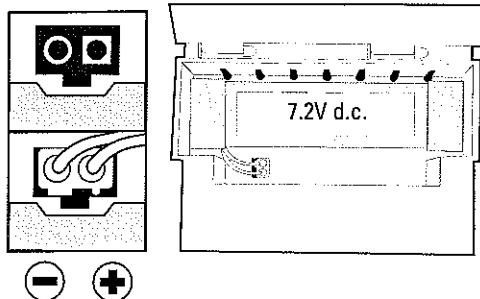

### Transmitter

1. To install transmitter battery, open battery door as shown.
2. Install one 9V battery with polarity (+/-) as shown inside battery compartment.
3. Replace battery cover.

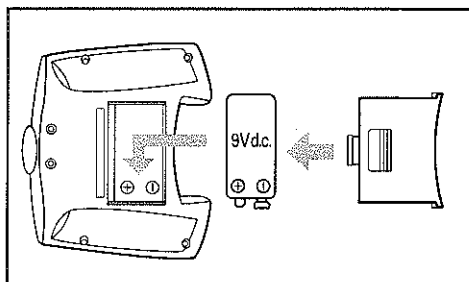

## BATTERY CHARGING/CARE

**CAUTION:** Use only the charger supplied with this toy. Do not use any other charging source.

Use only Tyco® R/C 7.2V NiCd battery packs. Other batteries may leak or rupture, causing personal injury and damage.

1. Plug wall pack charger into standard wall outlet.
2. Connect the battery pack's wire connector to the wall pack charger connector. Make certain the two connectors are tightly snapped together.
3. To disconnect wires, push down on the connector clip and pull apart.
4. After charging, the battery will feel warm. This condition is normal for fully charged batteries.
5. New battery packs must be charged for 5 1/2 hours the first two times charged. Subsequent charges will require 4 hours. Charging the battery pack for more than 5 1/2 hours will not give you a longer running time. 5 1/2 hours is all that is required for a fully charged battery pack.
6. Unlike alkaline batteries, which lose power gradually, a NiCd (Nickel-Cadmium) battery will run for its normal running time and then lose most of its power at once. It is time to recharge the battery pack.
7. After use, the battery pack will be hot! Wait at least 20 minutes until the battery pack cools before recharging. Recharging a warm or hot battery pack will greatly reduce the number of times your battery pack can be recharged.

### RECHARGEABLE BATTERY INFORMATION:

- ✘ DO NOT RECHARGE BATTERY PACK IF IT'S HOT. ALLOW IT TO COOL BEFORE RECHARGING.
- ✘ DO NOT RECHARGE A BATTERY PACK THAT SHOWS LEAKAGE OR CORROSION.
- ✘ DO NOT DISASSEMBLE THE BATTERY PACK. THE BATTERY PACK IS A SEALED RECHARGEABLE NICKEL-CADMIUM BATTERY.
- ✘ EXERCISE CAUTION IN HANDLING A HOT BATTERY PACK.
- ✘ IF BATTERY PACK AND/OR CHARGER ARE WET, THOROUGHLY DRY BEFORE CHARGING.
- ✘ DO NOT RECHARGE NON-RECHARGEABLE BATTERIES.

### Note to Adults:

- Remove rechargeable batteries before recharging. Recharge batteries only under adult supervision.
- Regularly examine for damage to the cord, plug, enclosure and other parts. In the event of any damage, the toy must not be used with the battery charger until the damage has been repaired.
- This toy is not intended for children under 3 years old. The battery charger is not a toy.

THIS PRODUCT USES A NICKEL-CADMIUM RECHARGEABLE BATTERY PACK. BATTERY MUST BE RECYCLED OR DISPOSED OF PROPERLY. FOR FURTHER INFORMATION REGARDING BATTERIES OR THEIR DISPOSAL PLEASE CALL 1-888-557-TYCO.

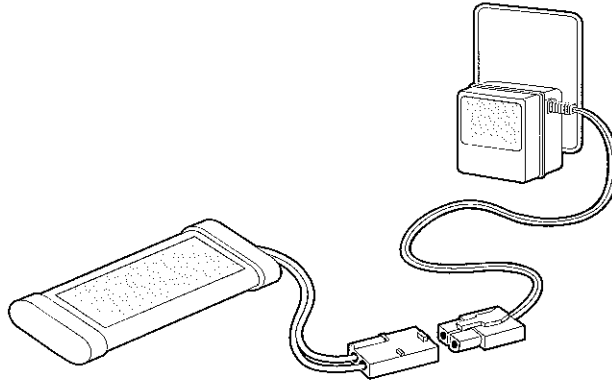

THIS PRODUCT USES A NICKEL-CADMIUM RECHARGEABLE BATTERY PACK. BATTERY MUST BE RECYCLED OR DISPOSED OF PROPERLY. FOR FURTHER INFORMATION REGARDING BATTERIES OR THEIR DISPOSAL PLEASE CALL 1-888-557-TYCO.

## CONSUMER INFORMATION:

### QUICK TIPS

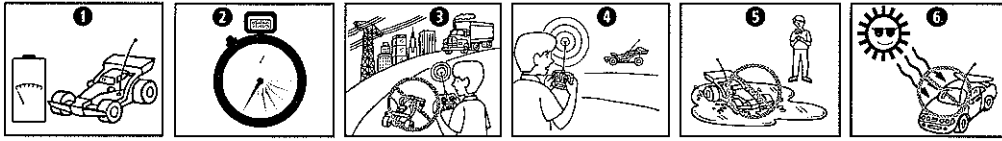

**1** When your vehicle starts to lose power, it may lose functions or performance. It's time for a recharge. For best performance, always start with a fully-charged battery.

**2** Your vehicle's running time may change depending on your driving style.

**3** Radio interference can make your vehicle run badly. Interference can be caused by other non-MultiBand™ R/C vehicles running on the same frequency; electrical wires; large buildings; CB radios; or other wireless gear. Try to stay away from these!

**4** Point your transmitter antenna up - not down toward your vehicle. If your vehicle gets too far away, it won't work properly.

**5** Don't drive your vehicle in sand or through water or snow. If your vehicle does get wet, wipe with a towel and allow to dry completely.

**6** Don't store your vehicle near heat or in direct sunlight. Always turn switches OFF and remove all batteries for storage.

**Note to Adults:** To ensure that the child's play is both safe and fun, please review all operating instructions and safety rules with your child..

#### Safety Tips

- NEVER drive your vehicle on streets! They're for real cars!
- DO NOT pick up vehicle while in motion.
- Keep fingers, hair and loose clothing away from the tires and the wheel hubs while the vehicle is switched ON.

**CAUTION:** To prevent entanglement, keep hair away from wheels.

- Adult supervision is recommended when this vehicle is being operated.
- To avoid accidental operation, remove all batteries when not in use. Always turn all switches OFF before removing batteries.

#### BATTERY SAFETY INFORMATION

In exceptional circumstances batteries may leak fluids that can cause a chemical burn injury or ruin your toy (product). To avoid battery leakage:

- Non-rechargeable batteries are not to be recharged.
- Rechargeable batteries are to be removed from the toy before being charged (if designed to be removable).
- Rechargeable batteries are only to be charged under adult supervision (if designed to be removable).
- Do not mix alkaline, standard (carbon-zinc), or rechargeable (nickel-cadmium) batteries.
- Do not mix old and new batteries.
- Only batteries of the same or equivalent type as recommended are to be used.
- Batteries are to be inserted with the correct polarity.

- Exhausted batteries are to be removed from the toy.
- The supply terminals are not to be short-circuited.
- Dispose of battery(ies) safely.
- Do not dispose of this toy in a fire. The batteries inside may explode or leak.

#### Battery Performance Note:

For best performance use regular or high-performance alkaline batteries (where disposable batteries are called for). If your vehicle is supplied with standard (carbon-zinc) batteries for initial use and/or demonstration purposes, we recommend replacing them with alkaline batteries when necessary. Battery life may vary depending on battery brand.

### TROUBLESHOOTING - PROBLEM? - SOLUTIONS

SYMPTOM	PROBABLE CAUSE	CORRECTION
Vehicle runs slowly or will not run.	<ul style="list-style-type: none"> <li>• Loose battery connection or vehicle switch not ON.</li> <li>• Weak or uncharged rechargeable battery.</li> <li>• Weak transmitter battery.</li> <li>• Transmitter and vehicle MultiBand™ Selector Switches set to different MultiBand™ settings.</li> </ul>	<ul style="list-style-type: none"> <li>• Check battery connector and vehicle switch.</li> <li>• Charge battery or replace.</li> <li>• Replace with fresh alkaline battery.</li> <li>• Check MultiBand™ Selector Switches and change switch positions if necessary (MultiBand™ settings must match).</li> </ul>
Erratic operation or only short range possible.	<ul style="list-style-type: none"> <li>• Radio interference likely.</li> </ul>	<ul style="list-style-type: none"> <li>• Check for possible interference, and change driving location if necessary (see point 2 - Quick Tips).</li> </ul>
Short rechargeable battery life.	<ul style="list-style-type: none"> <li>• Battery not fully charged.</li> </ul>	<ul style="list-style-type: none"> <li>• Recharge vehicle battery.</li> </ul>
Vehicle doesn't work after going through water or snow.	<ul style="list-style-type: none"> <li>• Water in the electronics area.</li> </ul>	<ul style="list-style-type: none"> <li>• Vehicle will take several hours to dry. Allow to dry thoroughly overnight before trying again. Avoid driving in water or snow.</li> </ul>

#### 90 DAY LIMITED WARRANTY - TYCO® R/C PRODUCTS

Mattel, Inc. warrants to the original consumer purchaser that this product will be free of defects in material and workmanship for ninety (90) days (unless specified in alternate warranties) from the date of purchase. Mattel will replace the product in the event of such a defect within the warranty period.

In the event of a defect covered under this warranty, first call the toll-free number listed below. Many problems can be solved in this manner. If necessary, you will be instructed to return the product, postage prepaid and insured, to the address below. Enclose your name, address, dated sales receipt, and a brief explanation of the defect. Replacement and return shipment will be free of charge.

This warranty does not cover damage resulting from unauthorized modification, accident, misuse or abuse. If the product is returned without a dated sales receipt the product may be excluded from coverage under this warranty.

Mattel's liability for defects in material and workmanship under this warranty shall be limited to repair or replacement, at our sole option, and in no event shall we be responsible for incidental, consequential, or contingent damages (except in those states that do not allow this exclusion or limitation). This warranty is exclusive, and is made in lieu of any express or implied warranty. Valid only in U.S.A. This warranty gives you specific legal rights and you may have other rights, which vary from state to state. Some states do not allow the exclusion of incidental or consequential damages, so the above exclusions or limitations may not apply to you.

TOLL-FREE NUMBER: 1-888-857-TYCO (8526) (valid only in U.S.A.)

Hours: 8:00 A.M. - 5:00 P.M. Eastern Time; Monday - Friday. Expect some delay in January following the holiday season. Please be patient and keep trying the toll-free number.

ADDRESS FOR RETURNS:  
CONSUMER RELATIONS  
836 GIRARD AVENUE  
EAST AURORA, NY 14052

© 2004 Mattel, Inc., Mt. Laurel, NJ 08054 U.S.A. PRINTED IN CHINA. All Rights Reserved. MATTEL, TYCO and associated trademarks and trade dress are owned by Mattel, Inc. Retain this address for future reference: Mattel U.K. Ltd., Vauxhall Business Park, Watlington St, ALB, Heddle, 01628 500003, Mattel Australia Pty Ltd., Richmond, Victoria 3121 - Consumer Advisory Service: 1300 135 312, Mattel East Asia Ltd, Room 1106, South Tower, World Finance Centre, Harbour City, Tsimshatsui, HK, China. Dimport & Diedarkan Oleh: Mattel SEA Ptd Ltd, (890332-P) Lot 135, Menara Lien Hoe, Persiaran Tropicana Golf Country Resort, 47410 PJ. Tel: 03-78803817, Fax: 03-78803867.

#### COMPLIANCE WITH FCC REGULATIONS (VALID IN U.S. ONLY)

This device complies with part 15 of the FCC Rules. Operation is subject to the following two conditions: (1) This device may not cause harmful interference, and (2) this device must accept any interference received, including interference that may cause undesired operation.

This device generates and uses radio frequency energy and if not used properly may cause interference to radio and television reception. It has been tested and found to comply with the limits set by the FCC which are designed to provide

reasonable protection against such interference.

**NOTE:** Changes or modifications not expressly approved by the manufacturer responsible for compliance could void the user's authority to operate the equipment.