

Welcome home, I'm Hello Dreamhouse™!



WARNING:
CHOKING HAZARD - Small parts.
Not for children under 3 years.

CAUTION - Risk of Electric Shock - Dry location use only.

CAUTION - ELECTRIC TOY: Not recommended for children under 6 years of age. As with all electric products, precautions should be observed during handling and use to prevent electric shock.

- This toy must only be used with a transformer for toys.
- The transformer is not a toy.
- Toys liable to be cleaned with liquids are to be disconnected from the transformer before cleaning.
- This toy is not to be connected to more than the recommended number of power supplies.

This product is not recommended for use on loose dirt or wet surfaces.

Do not immerse in water.

CONSUMER INFORMATION

Need Assistance? Visit service.mattel.com or call 1-800-524-8697 (US and Canada only).

SERVICE.MATTEL.COM

Mattel, Inc., 636 Girard Avenue, East Aurora, NY 14052, U.S.A. Consumer Services 1-800-524-8697. Mattel U.K. Ltd., Vanwall Business Park, Maidenhead SL6 4UB. Helpline 01628 500303. Mattel Australia Pty., Ltd., Richmond, Victoria. 3121. Consumer Advisory Service - 1300 135 312. Mattel East Asia Ltd., Room 503-09, North Tower, World Finance Centre, Harbour City, Tsimshatsui, HK, China. Tel.: (852) 3185-6500. Diimport & Diedarkan Oleh: Mattel Southeast Asia Pte. Ltd., No 19-1, Tower 3 Avenue 7, Bangsar South City, No 8, Jalan Kerinchi, 59200 Kuala Lumpur, Malaysia. Tel: 03-78803817, Fax: 03-78803867.

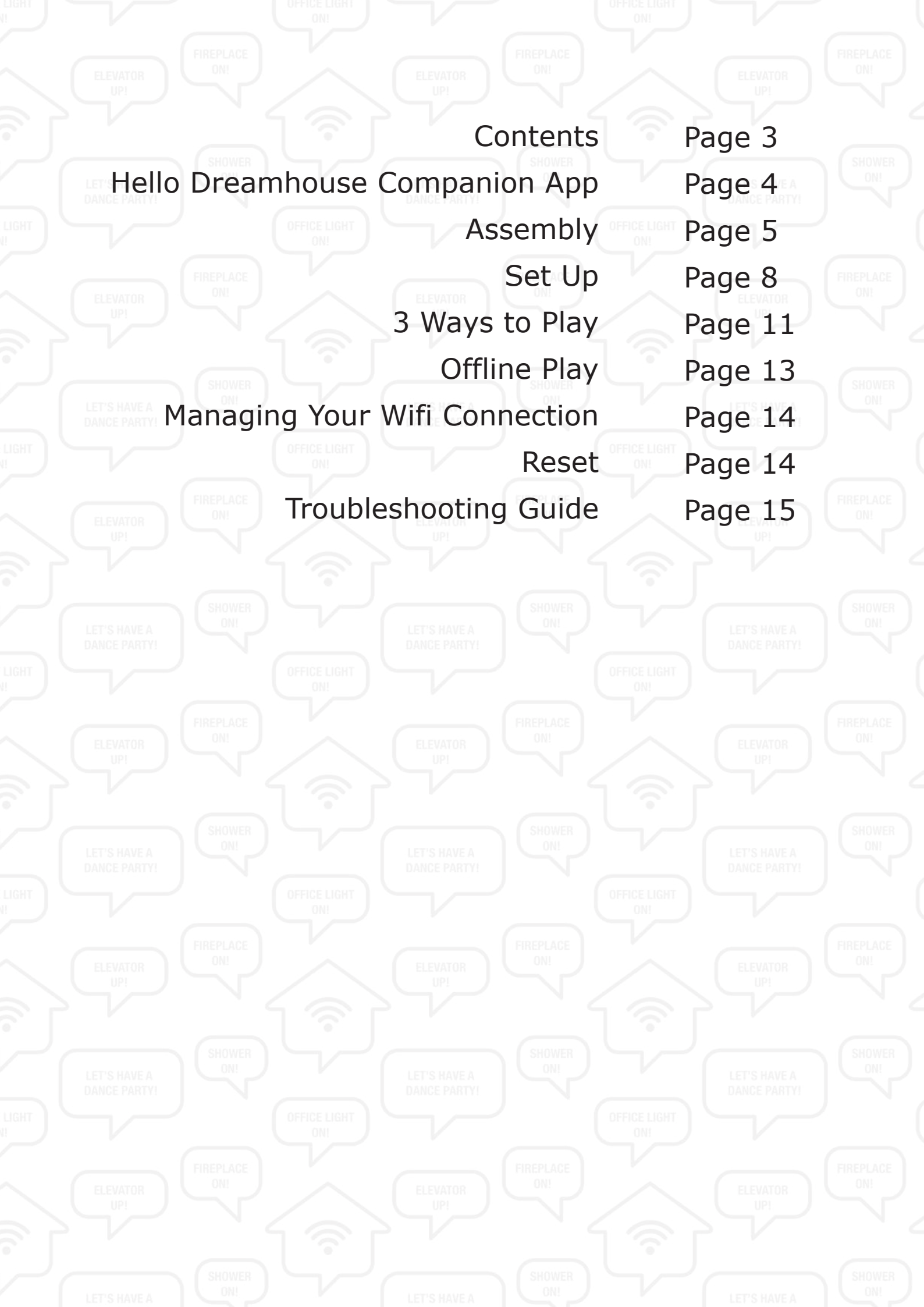
The background features a repeating pattern of smart home icons and speech bubbles. The icons include a house with a Wi-Fi signal, a fireplace, an elevator, a shower, and an office light. The speech bubbles contain phrases like "FIREPLACE ON!", "ELEVATOR UP!", "SHOWER ON!", "OFFICE LIGHT ON!", and "LET'S HAVE A DANCE PARTY!".

Contents	Page 3
Hello Dreamhouse Companion App	Page 4
Assembly	Page 5
Set Up	Page 8
3 Ways to Play	Page 11
Offline Play	Page 13
Managing Your Wifi Connection	Page 14
Reset	Page 14
Troubleshooting Guide	Page 15

CONTENTS

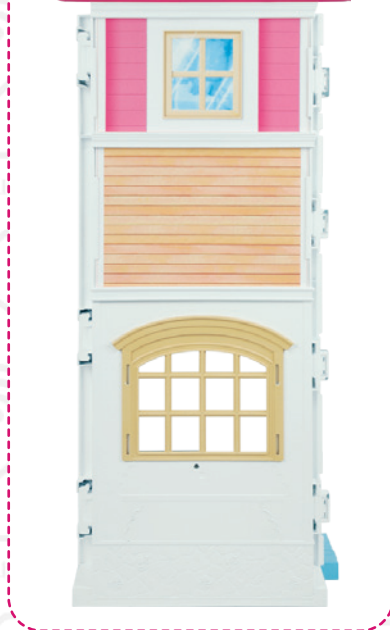
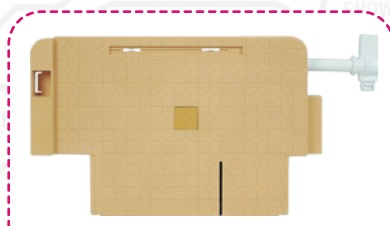
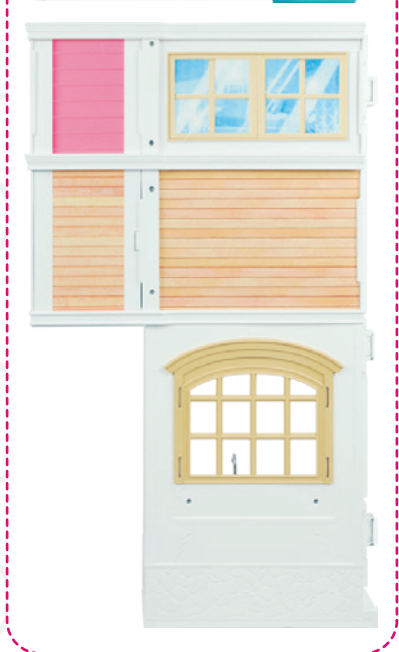
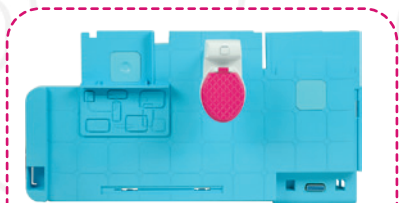
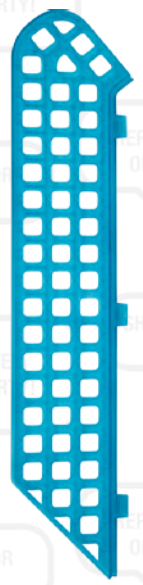
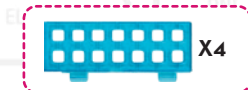
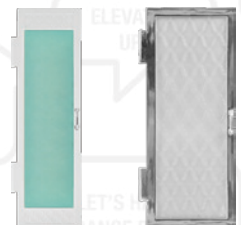
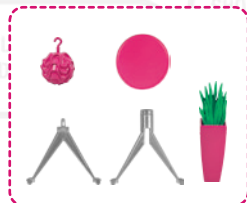
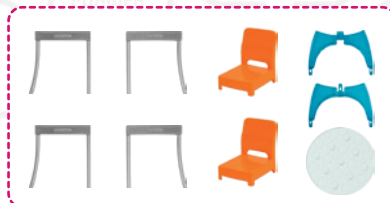
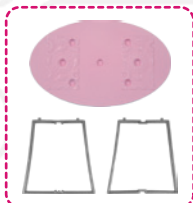

Adult assembly only.

Colors and decorations may vary.

Please remove everything from the package and compare to the contents shown here. If any items are missing, please contact your local Mattel office. Keep these instructions for future reference as they contain important information.

Hello Dreamhouse COMPANION APP

 Before continuing, please download the Hello Dreamhouse Companion App if you haven't ready.

System Requirements

- Smart device required. Not included.
- iPhone® 6S Plus, iPhone 6S, iPhone 6 Plus, iPhone 6, iPhone 5S, iPhone 5C, iPhone 5, iPad Air 2, iPad mini 3, iPad Air, iPad (4th generation).
- Apple devices must have iOS 8.0 or later.
- Android mobile devices with Android OS 4.4.4 or later.
- Wifi internet connection and Wifi enabled device required.
- Parents are required to create a ToyTalk account and grant consent via email by following the in-app instructions.

Hello Dreamhouse Companion App required

- Download the Hello Dreamhouse Companion App at no cost from www.Barbie.com/hellodreamhouse. Data rates may apply.
- We reserve the right to terminate the app and speech recognition service after 4/1/2019.



www.Barbie.com/hellodreamhouse

Launch the app and select "Assemble House" for video instructions on how to assemble *Hello Dreamhouse*.

PRIVACY

Mattel has partnered with ToyTalk to bring speech recognition technology to *Hello Dreamhouse*. Our commitment to security and privacy includes:

- Parental consent is required to set up a parent account and connect with *Hello Dreamhouse*.
- The use of *Hello Dreamhouse* involves the recording of voice data. When the microphone is active, voice data is collected so *Hello Dreamhouse* can understand and respond. These recordings are only used in accordance with ToyTalk's Privacy Policy.
- There is no advertising content within *Hello Dreamhouse*.
- Your children's conversations are not used to advertise to your child.
- See ToyTalk's Privacy Policy toytalk.com/hellodreamhouse/privacy and Terms of Use toytalk.com/hellodreamhouse/terms

Should you have any questions or concerns, please call 1-800-524-8697 (Monday – Friday 9 AM to 6 PM Eastern Time).

ASSEMBLY

1



2



Note: DO NOT ASSEMBLE ROOF UNTIL STEP 8.

3



4



Note: DO NOT ASSEMBLE ROOF UNTIL STEP 7.

5



6



ASSEMBLY

7



8



9

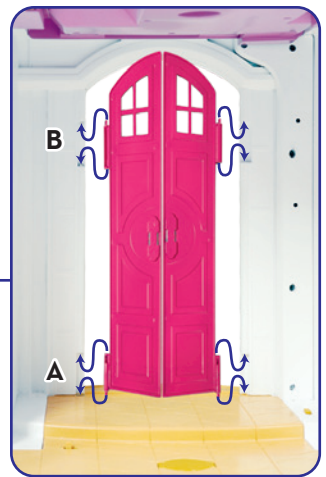

10



11

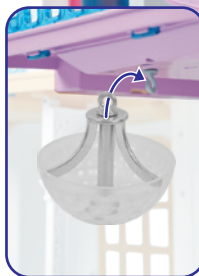

ASSEMBLY

12

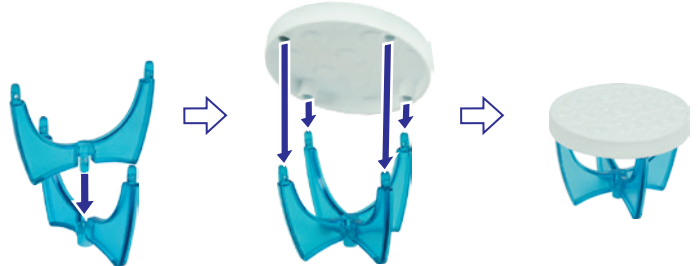
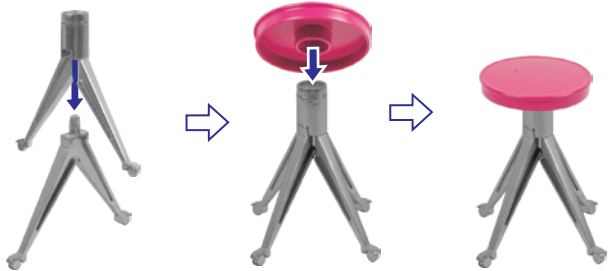
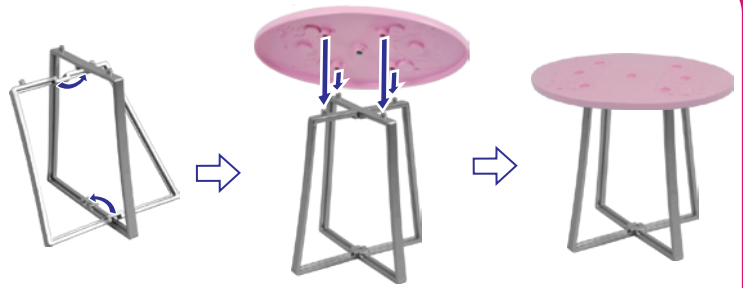

Apply labels by number as shown. Additional label application shown on page 8.

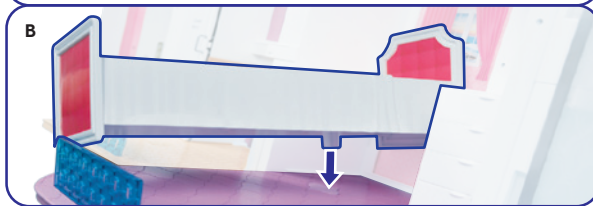
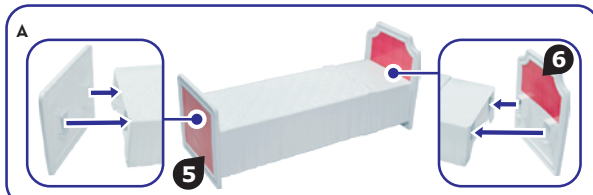

Please make sure the post is aligned with the floor switch.



SET UP



Connect to power. Power adapter model number: PS60A-0503500U.

- 1** Connect the power adapter as shown.

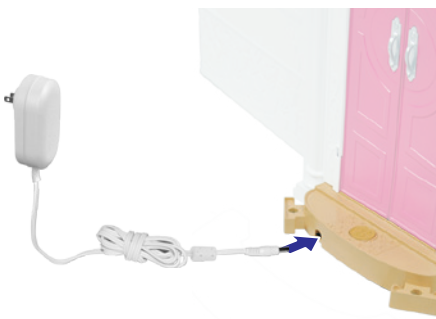

- 2** Place the step as shown.

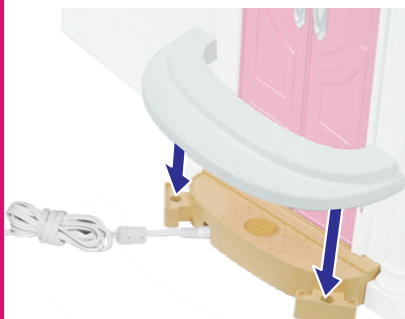

- 3** Plug the power adapter into a power outlet.

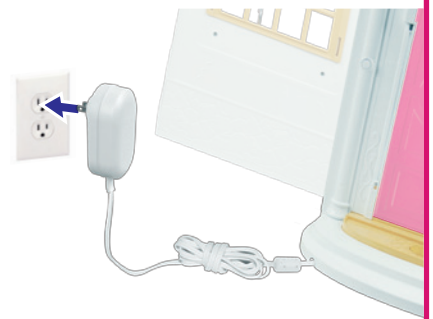

Adult note:

Please regularly examine the power adapter used with this toy for damage to the cord, plug, enclosure and other parts. In the event of such damage, do not use until damage has been repaired. This power adapter is intended to be correctly oriented in a vertical or floor mount position. Children playing with electrical toys operating at 120 volts should be supervised by an adult.