



PTERANO-DRONE™ INSTRUCTIONS

8+

Please keep these instructions for future reference as they contain important information.

CONTENTS

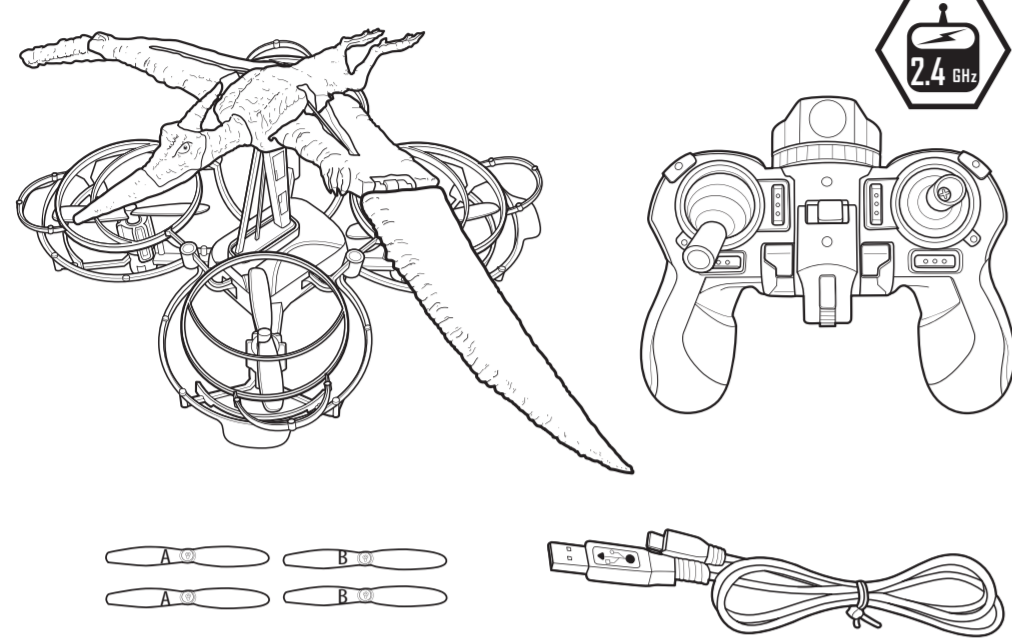

FOR INDOOR USE ONLY.
ADULT ASSEMBLY REQUIRED TO REPLACE PROPELLERS.
Please contact your local Mattel office or visit service.mattel.com for propeller installation assistance.

This product is not recommended for use on loose dirt or wet surfaces. Do not immerse in water.

Keep these instructions for future reference as they contain important information.
IMPORTANT: Please read all instructions before operating your PTERANO-DRONE.

Includes a 3.7V Rechargeable LiPo Battery Pack for the PTERANO-DRONE.
3 AAA (LR03) alkaline batteries (not included) required for the remote control.
Dispose of batteries safely.

Jurassic World is a trademark and copyright of Universal Studios and Amblin Entertainment, Inc. Licensed by Universal Studios. All Rights Reserved.

service.mattel.com

1

1: FEATURES

REMOTE CONTROL

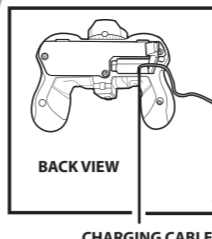
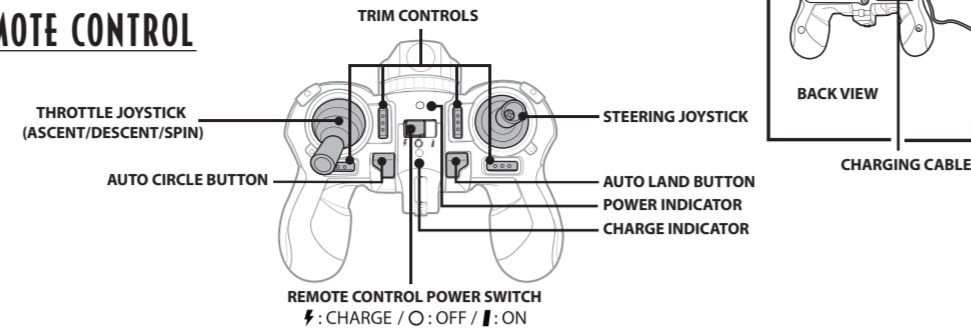

PTERANO-DRONE™

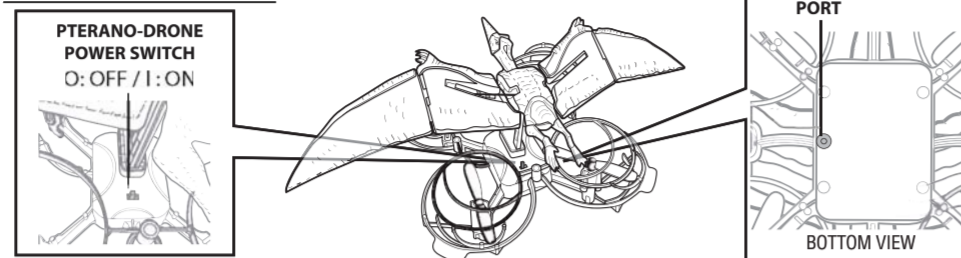

SAFETY INFORMATION

Note to Adults: To ensure that your child's play is both safe and fun, please review all operating instructions and safety rules together.

- The toy is not intended for children under 8 years old.
- Keep fingers, hair, and loose clothing away from the propellers while the PTERANO-DRONE is switched ON.
- Stay at least 3 to 6 feet away from the PTERANO-DRONE. This applies to anyone watching as well.
- Always keep an eye on the PTERANO-DRONE. If it looks like it's going to crash, release the throttle joystick and step out of the way.
- Do not grab the dinosaur's wings and body when handling the PTERANO-DRONE.
- Never disassemble or attempt to modify the PTERANO-DRONE.
- When not in use, turn off the remote control and the PTERANO-DRONE. To avoid accidental operation, remove batteries from the remote control.
- Operating range of the remote control is 25 feet (7.6m).
- The PTERANO-DRONE should only be used under adult supervision. Make sure that there is sufficient space between people, animals, and objects during play.
- Do not hold the PTERANO-DRONE by the attached dinosaur, as the material is fragile and may be easily damaged.
- Do not put objects into the propeller.
- To avoid accidental operation, always turn power switches OFF and remove all batteries before storage.
- IMPORTANT:** DO NOT touch the connectors with metallic objects. The product might short-circuit causing damage.

2: SET UP

REMOTE CONTROL BATTERY INSTALLATION

- Unscrew the battery cover with a Phillips head screwdriver (not included).
- Install 3 new AAA (LR03) alkaline batteries (not included) in the orientation shown.
- Replace battery cover and tighten screw.
- Replace batteries in the remote control if the PTERANO-DRONE does not respond after a recharge or if you see a green light flashing in the power indicator.

NOTE: For longer life, use alkaline batteries. Dispose of batteries safely.

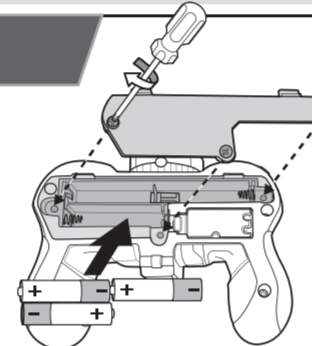

2

CHARGING THE PTERANO-DRONE™

THE PTERANO-DRONE IS POWERED BY A PERMANENTLY INSTALLED LiPo BATTERY, AND IT MUST BE FULLY CHARGED BEFORE FIRST USE. THE RED LIGHT WILL CHANGE FROM RED TO GREEN WHEN CHARGING IS COMPLETE.

- Open the cover on the bottom side of the remote control and take out the charging cable (see 2 "B"). The remote control power switch should be at OFF (O).
- Plug the charging cable firmly into the charging port at the bottom of the PTERANO-DRONE (see 2 "B").
- Connect the remote control to a powered USB port with the supplied USB cable (see 2 "C").
- To begin charging, slide the remote control power switch from OFF (O) to CHARGE (F). The charge indicator will turn red. This indicates that the PTERANO-DRONE is charging (see 2 "B").
- The red light will change from red to green when charging is complete.
- Hold the charging plug and gently pull it out of the port when the charge is complete. NEVER pull on the cable, as this may cause the cable to break.
- Put the charging cable back into the remote control and close the cover.
- Disconnect the USB cable from the remote control before play.

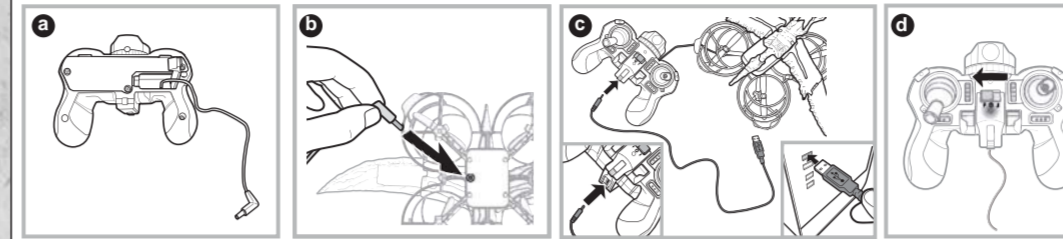

PAIRING THE PTERANO-DRONE™ WITH THE REMOTE CONTROL

You must pair the remote control with the PTERANO-DRONE before you can control it. FIRST, SWITCH ON THE PTERANO-DRONE, THEN IMMEDIATELY SLIDE THE REMOTE CONTROL POWER SWITCH TO ON (I). WAIT FOR A FEW SECONDS AND PUSH THE THROTTLE JOYSTICK ALL THE WAY UP THEN BACK DOWN. The PTERANO-DRONE's wings will begin flapping, and the power indicator will change from flashing green to solid green when pairing is complete. If the green light does not stop flashing after a few seconds, switch OFF the remote control and the PTERANO-DRONE, and then try again.

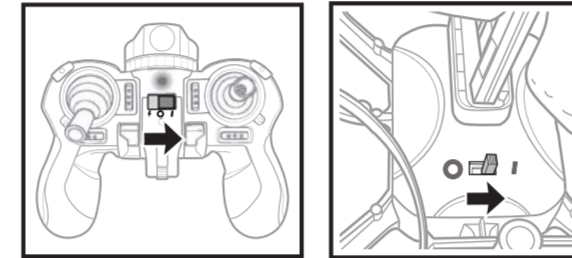

LiPo (LITHIUM POLYMER) BATTERY INFORMATION

Fully charge the battery before storing for an extended period of time (6 months or longer). Periodic charging every few months is recommended to extend battery life when not in use. Do not store near heat or in direct sunlight.

- Do not disassemble the PTERANO-DRONE's permanently installed LiPo (Lithium Polymer) battery. It is a sealed LiPo battery. To properly recycle, follow local Lithium Polymer battery recycling guidelines.
- Do not recharge the PTERANO-DRONE if it feels hot. Allow it to cool before recharging.
- The PTERANO-DRONE is only to be charged using the remote control/charger supplied. Do not charge the LiPo battery in any other battery charger.
- Do not attempt to use or charge the PTERANO-DRONE if it shows signs of leakage or corrosion.
- If the PTERANO-DRONE and/or the remote control get wet, thoroughly dry before using or charging.
- Regularly examine all wires and connectors. In the event of damage, discontinue use.
- Replace batteries in the remote control if the PTERANO-DRONE does not respond after a full recharge.

3

FLYING CORRECTLY: TRIM CONTROLS

Before you start flying your PTERANO-DRONE, it is recommended that you check if any trim adjustments are required to keep it flying correctly. First, slowly push the throttle joystick up until the PTERANO-DRONE is off the ground. If it is drifting in various directions, you can fine-tune your PTERANO-DRONE by adjusting the 4 TRIM CONTROLS:

A. FORWARD/BACKWARD TRIM

If the PTERANO-DRONE drifts forward or backward when the steering joystick is not pushed, press the DOWN trim button until it stops drifting forward or press the UP trim button until it stops drifting backward.

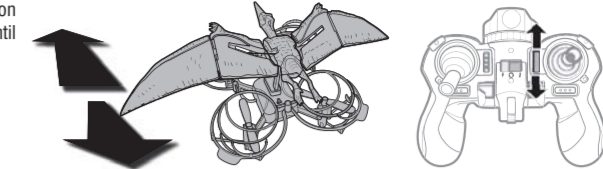

B. SIDEWAYS TRIM

If the PTERANO-DRONE drifts left or right when the steering joystick is not pushed, press the RIGHT trim button until it stops drifting left or press the LEFT trim button until it stops drifting right.

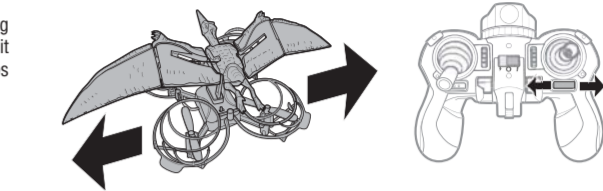

C. THROTTLE TRIM

Push the DOWN throttle trim button to decrease the throttle power and push the UP throttle trim button to increase the power.

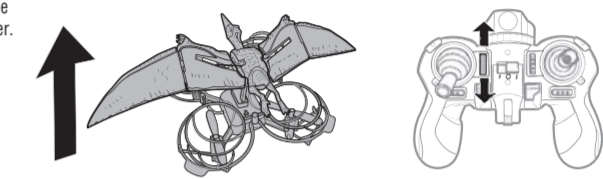

D. SPIN TRIM

If the PTERANO-DRONE spins left or right when the throttle joystick is not pushed toward the sides, press the spin trim button that is opposite the direction from the side that the PTERANO-DRONE is rotating until the spinning stops.



4

3: FLYING THE PTERANO-DRONE™

PRE-FLIGHT CHECK

- The PTERANO-DRONE is designed for INDOOR use. DO NOT fly outdoors.
- Give yourself plenty of flying room. Make sure there are no objects that may obstruct your flight path.
- PLAY SAFELY. Watch out for people, animals, and obstacles.

TAKE-OFF: Place the PTERANO-DRONE on the ground or on a flat surface. With the wings flapping, push the throttle joystick up again until the PTERANO-DRONE begins to take flight. Once the PTERANO-DRONE has reached your desired altitude, slightly pull back on the throttle joystick and keep it in that position to maintain your desired altitude.

MAINTAINING FLIGHT AND LANDING: To increase altitude, push the throttle joystick up. To decrease altitude, slowly pull back on the throttle joystick. To land the PTERANO-DRONE, DO NOT RELEASE the throttle joystick. Rather, slowly pull back on the throttle joystick until the PTERANO-DRONE begins to descend and hold that position. Once the PTERANO-DRONE has landed, release the throttle joystick.

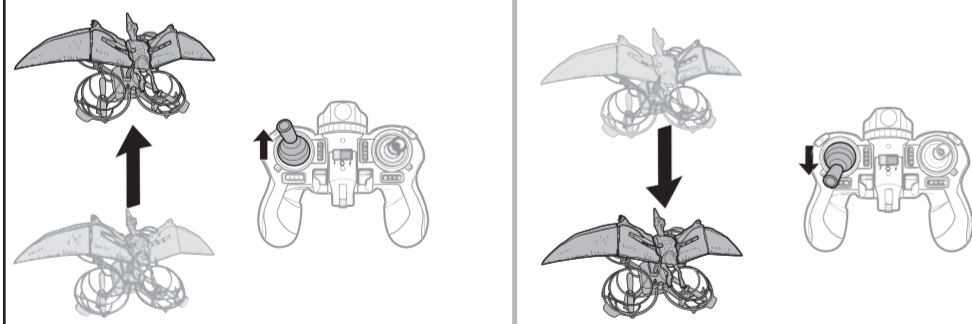

SPINS: Keep the throttle joystick still to maintain the PTERANO-DRONE's altitude, then slowly push the throttle joystick left or right to spin.



STEERING: Keep the throttle joystick still and slowly push the steering joystick. The PTERANO-DRONE can fly in the following directions:

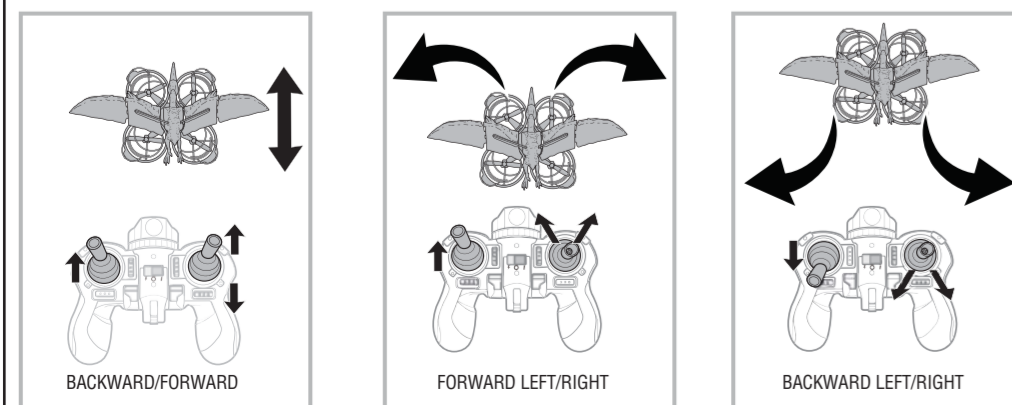

5

4: STUNTS

The PTERANO-DRONE can perform two auto stunts which can be activated at the touch of a button!

AUTO CIRCLE!

- Hold the throttle joystick still to keep the PTERANO-DRONE in the air and to maintain its altitude.
- Press the auto circle button (C).
- Keep holding the throttle joystick still and the PTERANO-DRONE will fly in a circle at the maintained altitude. Move the steering joystick to stop the stunt and return to normal operation.
- Press the auto circle button again to repeat the stunt.

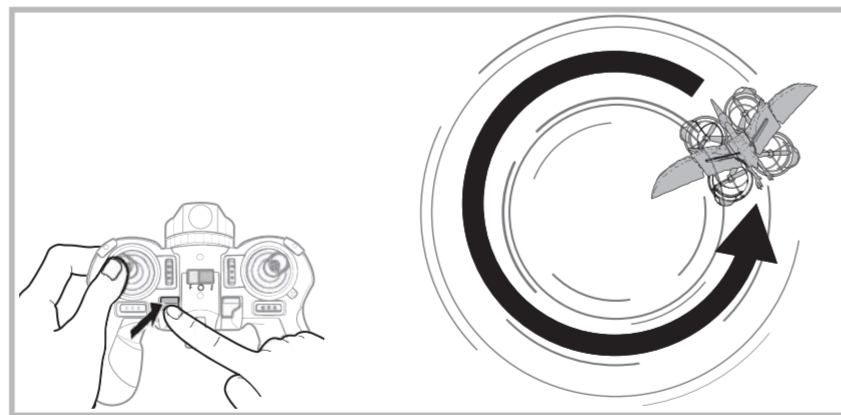

AUTO LAND!

- Hold the throttle joystick still to keep the PTERANO-DRONE in the air and to maintain its altitude.
- Press the auto land button (L) with your other hand and the PTERANO-DRONE will slowly descend and land on the ground.

IMPORTANT: Ascending and descending controls are disabled while the PTERANO-DRONE is auto landing.

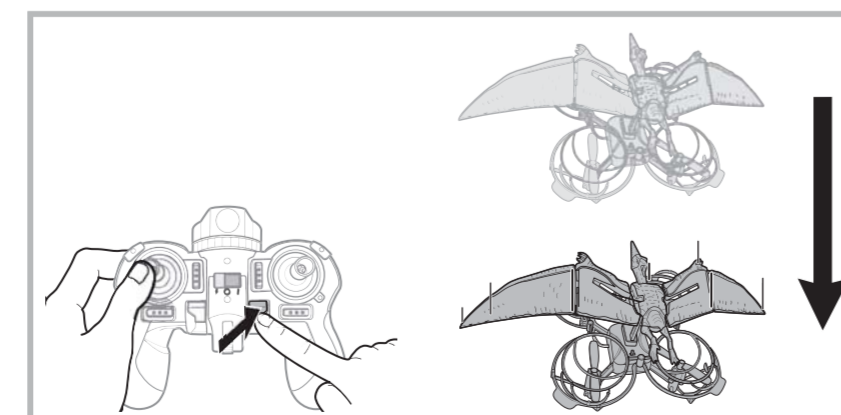

6

5: PERFORMANCE TIPS

REPLACING THE PROPELLERS

The PTERANO-DRONE comes with an extra set of replacement propellers (2 "A" propellers and 2 "B" propellers). If any of the PTERANO-DRONE's propellers break off or become damaged, determine whether it is the "A" propeller or the "B" propeller that has to be replaced. You can replace them by following these steps:

- Use a coin (not included) to pry off the old propeller.
- Select the required propeller and match it to the rail tab with the same letter. The propellers with the same letter (A or B) MUST be attached to the rail with the same letter and MUST also be diagonally across from each other.
- Align the pin to the hole of the propeller. Make sure the molded letter (A or B) on the propeller is facing you.
- Use the coin to gently push the propeller onto the pin. The coin will prevent the pin from poking your finger.

5. After replacing the propellers, reset the propeller rings so that they do not obstruct the propellers during flight.

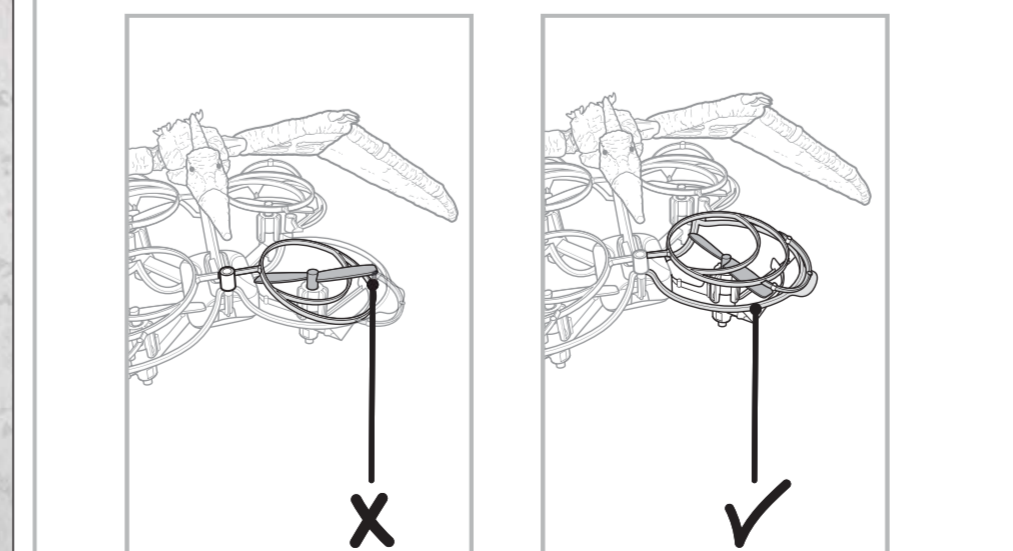

7

TROUBLESHOOTING

Q: The PTERANO-DRONE is not responding to the remote control.

- Try recharging the PTERANO-DRONE or install new batteries in the remote control.
- Turn off the PTERANO-DRONE and remote control and pair them again.
- Radio interference can affect the PTERANO-DRONE's performance. Interference can be caused by other RC vehicles running on the same frequency, electrical wires, large buildings, WiFi, or Bluetooth. If you experience interference, turn off the PTERANO-DRONE and remote control and relocate to a different area.

Q: The propellers are spinning but the PTERANO-DRONE does not take off.

- Check if the propellers are properly installed and match the correct A/B locations.
- Check the propellers for damage and replace any broken propellers with the spare set included.
- Increase the PTERANO-DRONE's throttle by pressing the UP trim button.

Q: The PTERANO-DRONE is flying out of control and drifting in the wrong directions.

- Adjust the FORWARD/BACKWARD or SIDEWAYS TRIM.
- For better control, make small, smooth, and slow movements on the throttle and steering joysticks.

REPAIR & MAINTENANCE

- Use clear household tape to repair tears, creases, or cracks. Use sparingly as added weight will affect performance.
- Dirt or mud on the PTERANO-DRONE can affect its operation. Use a clean, dry cloth to remove any dirt immediately. If the PTERANO-DRONE gets wet, turn it off and allow it to dry completely overnight.

NOTE: The PTERANO-DRONE may malfunction when it is exposed to an electrostatic source. To resume normal operation, turn the power OFF and ON again.

Note to Adults: To remove and dispose of the LiPo rechargeable battery safely, turn off the PTERANO-DRONE, cut out the battery from the foam casing, and use scissors to cut the wires. Next, wrap the wire ends with tape to isolate the LiPo battery and dispose of it in accordance with your local laws.

CAUTION: HARMFUL IF TOUCHED WHILE IN USE

Never grab/touch the PTERANO-DRONE when the propellers are in motion. Stand back from the PTERANO-DRONE when operating. To prevent entanglement, keep all hair away from moving parts. Surfaces may become hot and cause burns if electronics get wet. Do not attempt to grab a rotating propeller. If the propeller(s) is/are damaged, do not fly the PTERANO-DRONE. Flying with damaged propellers may lead to injury.

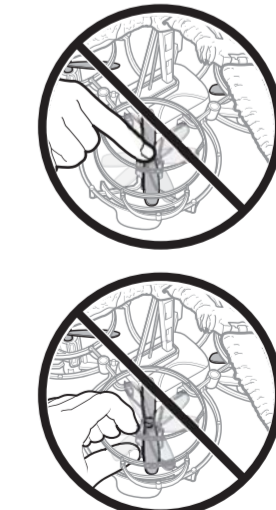

©2017 Mattel. © and ™ designate U.S. trademarks of Mattel, except as noted. Mattel, Inc., 636 Girard Avenue, East Aurora, NY 14052, U.S.A. Consumer Services 1-800-524-8697. Mattel U.K. Ltd., Vanwall Business Park, Maidenhead SL6 4UB. Helpline 01628 500303. Mattel Australia Pty., Ltd., Richmond, Victoria, 3121. Consumer Advisory Service - 1300 135 312. Mattel South Africa (PTY) LTD, office 102 13, 30 Melrose Boulevard, Johannesburg 2196. Mattel East Asia Ltd., Room 503-09, North Tower, World Finance Centre, Harbour City, Tsimshatsui, HK, China. Tel.: (852) 3185-6500. Diimport & Diedarkan Oleh: Mattel Southeast Asia Pte. Ltd., No 19-1, Tower 3 Avenue 7, Bangsar South City, No 8, Jalan Kerinchi, 59200 Kuala Lumpur, Malaysia. Tel: 03-33419052.

8

INSTRUCTION SHEET SPECIFICATIONS	
Toy No.:	JW FLYING DRONE
Toy No.:	FLY54
Lang.:	DOM
Part No.:	0970
Trim Size:	A3
Folded Size:	A5
Type of Fold:	
# colors:	25/1C
Colors:	White Offset
Paper Stock:	70 GSM FSC
Paper Weight:	
EDM No.:	

RAP

8 pages-A (Fold 3x)

COVER 2 3 4

5 6 7 8

Fold

COVER 2 3 4

Please put below
flyers in package:

- FCC Flyer
- Battery Information: 27L-00001-2908_G16

