

5: QUICK TIPS

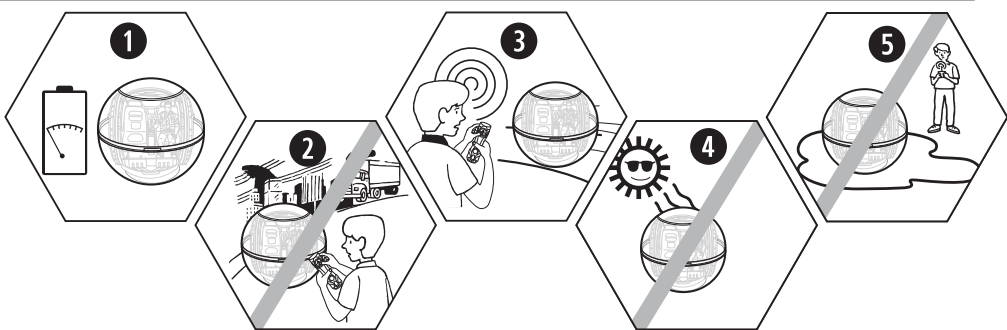

- (1) When your vehicle starts to lose power, it may lose functionality or performance. This means it's time for fresh batteries. Your vehicle's running time may change depending upon your driving style and driving environment.
- (2) Radio interference can affect your vehicle's performance. Interference can be caused by other RC vehicles running on the same frequency, electrical wires, large buildings, or CB radios. Try to stay away from these!
- (3) Point your remote control up and not down toward your vehicle. If your vehicle gets too far away, it won't work properly.
- (4) Don't store your vehicle near heat or in direct sunlight. Always turn switches OFF and remove all batteries for storage.
- (5) Don't drive your vehicle in sand or through water or snow. Do not immerse in water. If your vehicle or remote control does get wet, wipe it with a towel, remove batteries, and allow to dry completely overnight. Replace with fresh batteries before next use.
- (6) When exposed to an electrostatic source, the product may malfunction. To resume normal operation, remove and re-install the batteries. This should reset your vehicle and let you resume normal operation.

NOTE TO ADULTS: To ensure that your child's play is both safe and fun, please review all operating instructions and safety rules together.

- NEVER drive your vehicle on streets! Streets are for real cars!
- DO NOT pick up the vehicle while it is in motion.
- Keep fingers, hair, and loose clothing away from the wheels while the vehicle is switched ON.
- Adult supervision is recommended while this toy is being operated.
- When not in use, turn OFF the vehicle. To avoid accidental operation, remove all batteries.

BATTERY SAFETY INFORMATION

In exceptional circumstances batteries may leak fluids that can cause a chemical burn injury or ruin your product. To avoid battery leakage:

- Non-rechargeable batteries are not to be recharged.
- Rechargeable batteries are to be removed from the product before being charged.
- Rechargeable batteries are only to be charged under adult supervision.
- Do not mix alkaline, standard (carbon-zinc), or rechargeable batteries.
- Do not mix old and new batteries.
- Only batteries of the same or equivalent type as recommended are to be used.
- Batteries are to be inserted with the correct polarity.
- Exhausted batteries are to be removed from the product.
- The supply terminals are not to be short-circuited.
- Dispose of battery(ies) safely.
- Do not dispose of this product in a fire. The batteries inside may explode or leak.



Protect the environment by not disposing of this product or any batteries with household waste. This symbol indicates that this product shall not be treated as household waste. Check your local authority for recycling advice and facilities.

FOR PRODUCT SOLD IN USA

This device complies with Part 15 of the FCC Rules.

Operation is subject to the following two conditions:

- (1) This device may not cause harmful interference, and (2) this device must accept any interference received, including interference that may cause undesired operation.

This equipment has been tested and found to comply with the limits for a Class B digital device, pursuant to part 15 of the FCC rules. These limits are designed to provide reasonable protection against harmful interference in a residential installation. This equipment generates, uses and can radiate radio frequency energy and, if not installed and used in accordance with the instructions, may cause harmful interference to radio communications. However, there is no guarantee that interference will not occur in a particular installation. If this equipment does cause harmful interference to radio or television reception, which can be determined by turning the equipment off and on, the user is encouraged to try to correct the interference by one or more of the following measures:

- Reorient or relocate the receiving antenna.
- Increase the separation between the equipment and receiver.
- Connect the equipment into an outlet on a circuit different from that to which the receiver is connected.
- Consult the dealer or an experienced radio/TV technician for help.

NOTE: Changes or modifications not expressly approved by the manufacturer responsible for compliance could void the user's authority to operate the equipment.

4



GYROSPHERE RC INSTRUCTIONS

4+

Please keep these instructions for future reference as they contain important information.

CONTENTS

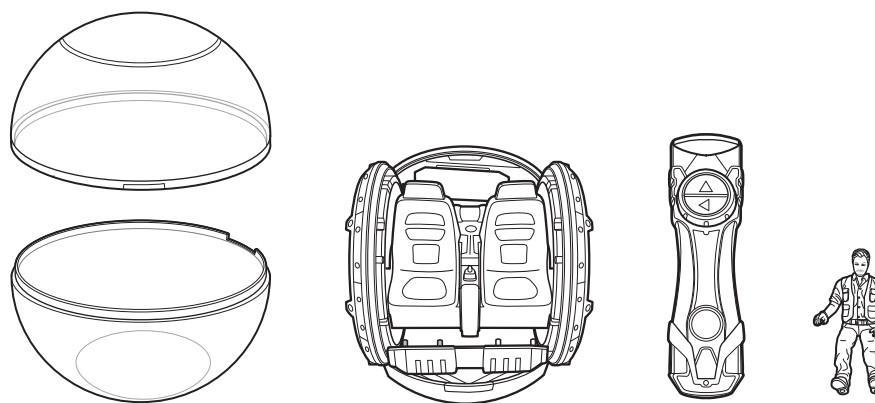

REQUIRES 4 AA (LR6) and 2 AAA (LR03) ALKALINE BATTERIES, NOT INCLUDED. DISPOSE OF BATTERIES SAFELY.



CAUTION: To prevent entanglement, keep all hair away from the wheels.

©2017 Mattel. All Rights Reserved. ® and ™ designate U.S. trademarks of Mattel, except as noted. Mattel, Inc., 636 Girard Avenue, East Aurora, NY 14052, U.S.A. Consumer Services 1-800-524-8697. Mattel U.K. Ltd., Vanwall Business Park, Maidenhead SL6 4UB. Helpline 01628 500303. Mattel Australia Pty., Ltd., Richmond, Victoria. 3121. Consumer Advisory Service - 1300 135 312. Mattel South Africa (PTY) LTD, Office 102 13, 30 Melrose Boulevard, Johannesburg 2196. Mattel East Asia Ltd., Room 503-09, North Tower, World Finance Centre, Harbour City, Tsimshatsui, HK, China. Tel.: (852) 3185-6500. Diimport & Diedarkan Oleh: Mattel Southeast Asia Pte. Ltd., No 19-1, Tower 3 Avenue 7, Bangsar South City, No 8, Jalan Kerinchi, 59200 Kuala Lumpur, Malaysia. Tel: 03-33419052.

FNH11_0970
1101636913_DOM

Jurassic World is a trademark and copyright of Universal Studios and Amblin Entertainment, Inc. Licensed by Universal Studios. All Rights Reserved.



1

INSTRUCTION SHEET SPECIFICATIONS

Toy No.: FNH11
Part No.: 0970
Trim Size: A4
Folded Size: A5
Type of Fold:
colors: Black
Colors: White Offset
Paper Stock: 70 lb.
Paper Weight:
EDM No.:

2 PANEL Folding Dummy

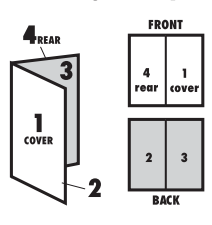

1: BATTERY INSTALLATION

Requires 4 AA (LR6) alkaline batteries for the vehicle and 2 AAA (LR03) alkaline batteries for the remote control. Replace batteries in the vehicle or remote control if the vehicle begins to run slowly or does not respond. For longer life, use alkaline batteries. Dispose of batteries safely.

VEHICLE

1. Unscrew the battery cover with a Phillips head screwdriver (not included).
2. Install 4 AA (LR6) alkaline batteries (not included) with polarity (+/-) as shown inside the battery compartment.
3. Replace battery cover and tighten screw.

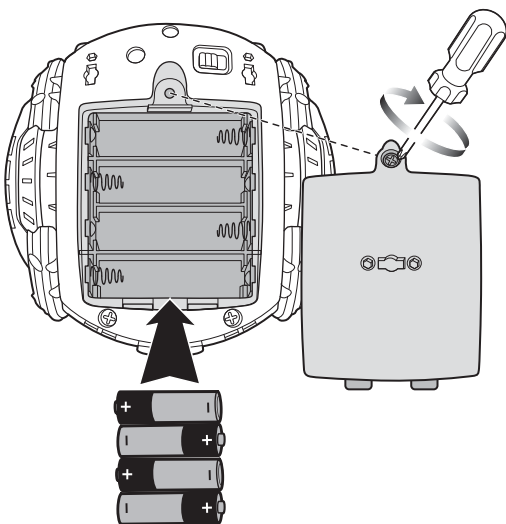

REMOTE CONTROL

1. Unscrew the battery cover with a Phillips head screwdriver (not included).
2. Install 2 AAA (LR03) alkaline batteries (not included) with polarity (+/-) as shown inside the battery compartment.
3. Replace battery cover and tighten screw.

NOTE: Once batteries are installed, the remote control will always be "ON" and will work the moment you use it.

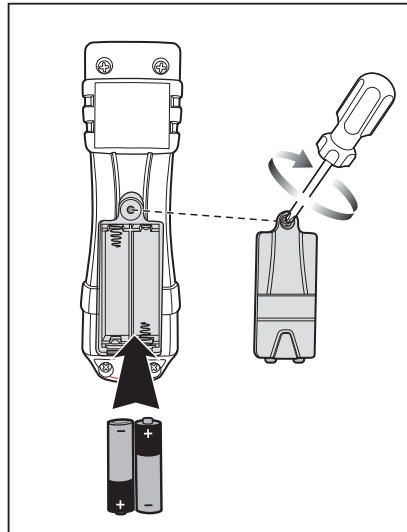

2: FEATURES

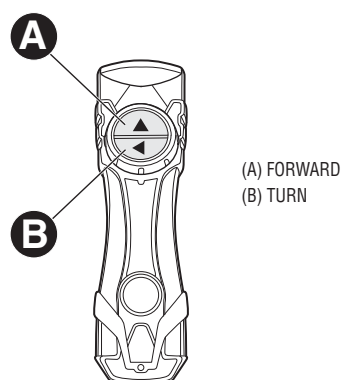
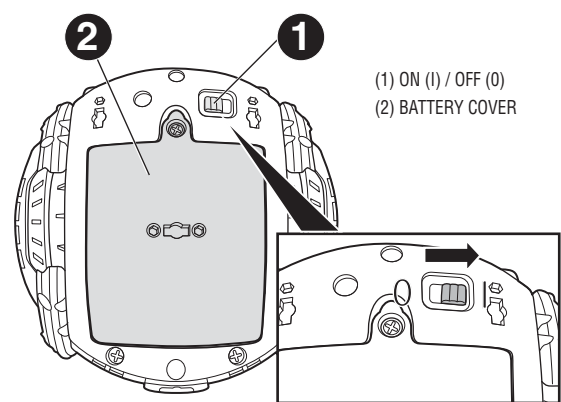

2

3: SET UP

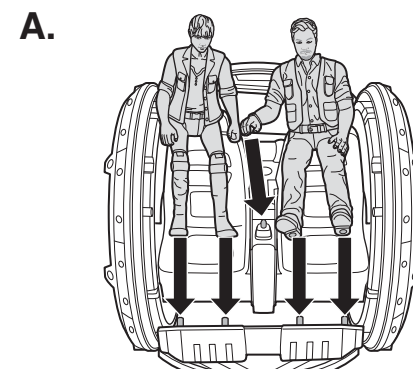

1 figure included. Additional figure sold separately, subject to availability. Fits most figures.

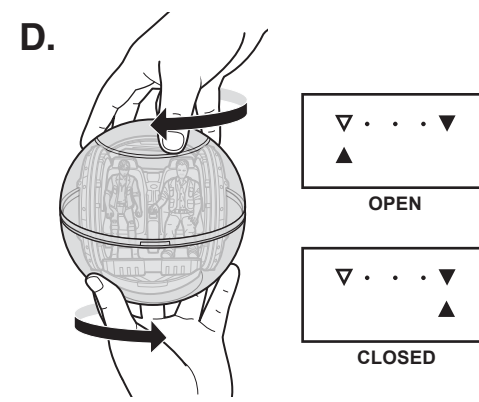
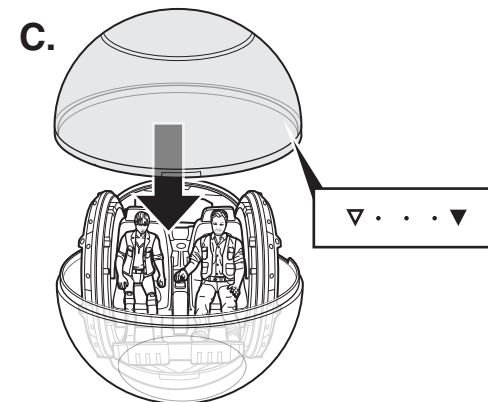
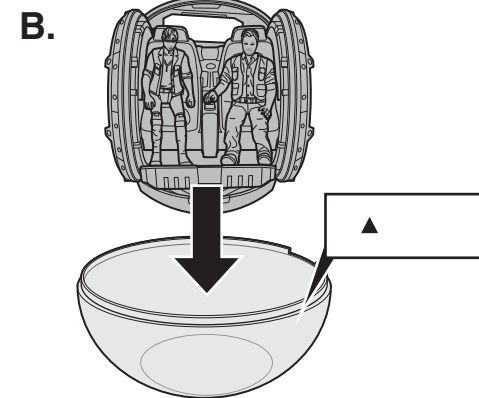

4: TO PLAY

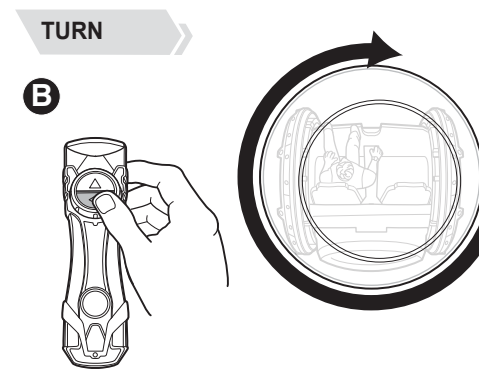
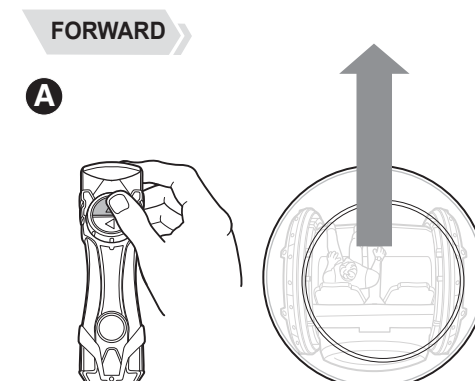

NOTE: If the vehicle goes into sleep mode after sitting idle, pick up and shake the vehicle to wake it up and resume normal play.

3

00007-1850 FCC flyer for 2.4 GHz RC item only

size: 138 x 175 (mm)

FOR PRODUCT SOLD IN USA • POUR LES PRODUITS VENDUS AUX ÉTATS-UNIS

This device complies with Part 15 of the FCC Rules.

Operation is subject to the following two conditions:

(1) This device may not cause harmful interference, and (2) this device must accept any interference received, including interference that may cause undesired operation.

• This equipment has been tested and found to comply with the limits for a Class B digital device, pursuant to part 15 of the FCC rules. These limits are designed to provide reasonable protection against harmful interference in a residential installation. This equipment generates, uses and can radiate radio frequency energy and, if not installed and used in accordance with the instructions, may cause harmful interference to radio communications. However, there is no guarantee that interference will not occur in a particular installation. If this equipment does cause harmful interference to radio or television reception, which can be determined by turning the equipment off and on, the user is encouraged to try to correct the interference by one or more of the following measures:

- Reorient or relocate the receiving antenna.
- Increase the separation between the equipment and receiver.
- Connect the equipment into an outlet on a circuit different from that to which the receiver is connected.
- Consult the dealer or an experienced radio/TV technician for help.

NOTE: Changes or modifications not expressly approved by the manufacturer responsible for compliance could void the user's authority to operate the equipment.

Cet appareil est conforme à l'article 15 de la réglementation de la FCC.

L'utilisation de ce dispositif est autorisée seulement aux deux conditions suivantes :

(1) il ne doit pas produire de brouillage nuisible, et (2) l'utilisateur du dispositif doit être prêt à accepter tout brouillage radioélectrique reçu, même si ce brouillage est susceptible de compromettre le fonctionnement du dispositif.

• Cet appareil a été testé et jugé conforme aux limites de la classe B pour un appareil numérique en vertu de l'article 15 de la réglementation de la FCC. Ces limites ont été instaurées pour fournir une protection raisonnable contre toute interférence nuisible dans une installation résidentielle. Cet appareil génère, utilise et peut émettre de l'énergie radiofréquence. S'il n'est pas installé et utilisé conformément aux instructions, il peut provoquer des interférences sur les communications radio. Cependant, il n'est pas garanti que des interférences ne se produiront pas dans certaines installations. Si cet appareil cause des interférences à la réception radio ou télévisée (ce qui peut être vérifié en éteignant l'appareil puis en le remettant sous tension), l'utilisateur peut tenter de les résoudre en suivant une ou plusieurs des mesures ci-après :

- Réorienter ou déplacer l'antenne réceptrice.
- Augmenter l'espace entre l'appareil et le récepteur.
- Brancher l'appareil sur une prise de courant différente de celle sur laquelle le récepteur est branché.
- Pour obtenir de l'aide, contacter le vendeur ou un technicien radio/télévision expérimenté.

REMARQUE : Tout changement ou modification de cet appareil n'ayant pas été expressément approuvé par les parties responsables de sa conformité peut entraîner l'annulation du droit d'exploitation de l'équipement par l'utilisateur.

FOR PRODUCT SOLD IN CANADA • POUR LES PRODUITS VENDUS AU CANADA

This equipment complies with FCC & Canada radiation exposure limits set forth for uncontrolled environments.

This transmitter must not be co-located or operating in conjunction with any other antenna or transmitter.

Cet équipement est conforme aux limites d'exposition aux radiations définies par le Canada pour des environnements non contrôlés. Cet émetteur ne doit pas être installé au même endroit ni utilisé avec une autre antenne ou un autre émetteur.

THIS DEVICE COMPLIES WITH INDUSTRY CANADA LICENCE-EXEMPT RSSs.

CET APPAREIL EXEMPT DE LICENCE EST CONFORME AU RSSs D'INDUSTRIE CANADA.

Operation is subject to the following two conditions:

(1) this device may not cause interference, and (2) this device must accept any interference, including interference that may cause undesired operation of the device.

L'utilisation de ce dispositif est autorisée seulement aux conditions suivantes :

(1) il ne doit pas produire de brouillage et (2) il doit pouvoir tolérer tout brouillage radioélectrique reçu, même si ce brouillage est susceptible de compromettre son fonctionnement.