

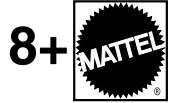

Keep these instructions for future reference as they contain important information. **IMPORTANT:** Please read all "Consumer Information" before operating your vehicle.



ASST. M0678  
N1919/N1920-0920

**TYCO® R/C SUPPORT**  
**Questions or problems with your product?**  
**DON'T RETURN IT TO THE STORE!**  
**Just call us for help.**  
 U.S. consumers may also register their products at this number.  
**1 888 557-TYCO (8926)**

**tycorc.com**

**⚠ CAUTION:** Surfaces may become hot and cause burns if electronics get wet. Do not operate vehicle through water or snow.

**CAUTION-ELECTRIC TOY:** NOT RECOMMENDED FOR CHILDREN UNDER 8 YEARS OF AGE. AS WITH ALL ELECTRICAL PRODUCTS, PRECAUTIONS SHOULD BE OBSERVED DURING HANDLING AND USE TO REDUCE THE RISK OF ELECTRIC SHOCK.

INPUT: 120VAC, 60Hz, 6W. OUTPUT: 11.2VDC, 230mA.

**GET STARTED!**

Your Turbo Pro Wheelie Cycle™ is a high performance motorcycle that allows you to pull off outrageous "one touch" stunts like wheelies and Turbo boost action. Plus, your Turbo Pro Wheelie Cycle™ has a specialized stabilizer that allows for maximum stability for your most radical stunts.

**1. GET SET!**

Hold the Turbo Pro Wheelie Cycle™ off the ground and rotate the right throttle control all the way.

⚡ Be sure to keep your fingers clear of the wheels at all times.

**2. LAUNCH IT!**

Gently hand-launch your vehicle. Set it on the ground and give it a gentle push while rotating the right throttle control.

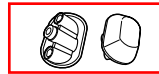
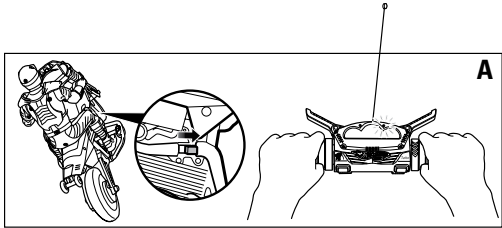

**I. CONTENTS/ FEATURES**

- Turbo Pro Wheelie Cycle™ Vehicle
- TYCO® R/C NiMH Charger
- TYCO® R/C 9.6V d.c. NiMH Battery Pack
- 2 x AA Battery for controller
- Controller
- 2 x Skid Pad

**VEHICLE**

- 1 Rider Figure (not removable)
- 2 ON/OFF Switch
- 3 Battery Latches
- 4 Battery Compartment

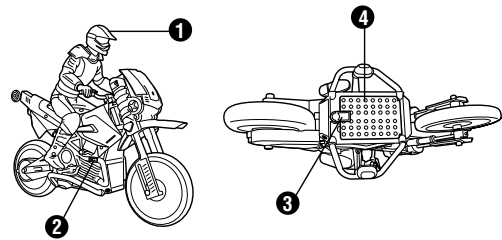

**TURBOTILT™ CONTROLLER**

**NOTE:** Your Turbo Pro Wheelie Cycle™ uses a unique controller with a sophisticated gravity switch to control your steering. Just turn your vehicle ON. Then tilt the Turbotilt™ controller to steer. Tilt the Turbotilt™ to the left to turn left, Tilt right to turn right.

- 1 Forward Control (throttle)
- 2 Wheelie Button
- 3 Turbo Button
- 4 ON/OFF Switch
- 5 Brakes
- 6 Battery Compartment
- 7 Antenna
- 8 ON/OFF Light

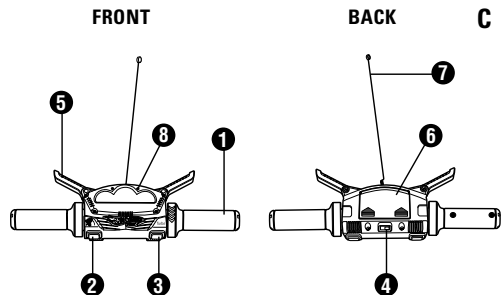

## II. QUICK START

Please read this Owner's Manual thoroughly.

1. Start with a full charge.
2. Turn the vehicle and the transmitter switches to on. Rotate the TurboTilt™ forward "throttle" control to run and control your vehicle.
3. When you're done driving, turn vehicle and transmitter ON/OFF to the OFF position. Remove all batteries for storage.

## III. BASIC OPERATION

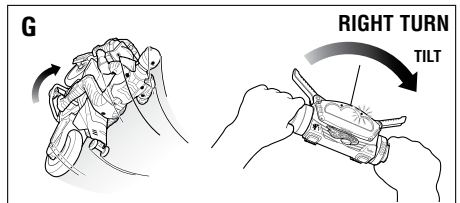
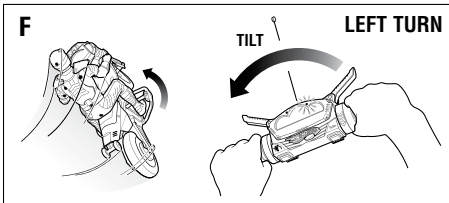
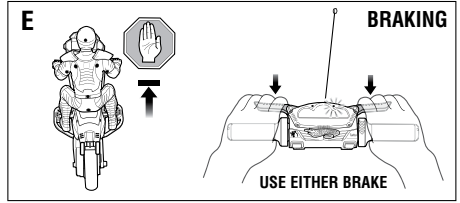
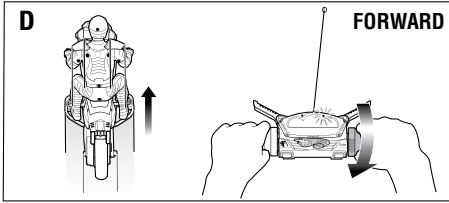

## IV. COOL STUNTS

This is a high-performance stunt vehicle...challenging and fun to drive. You'll need to PRACTICE to perfect your stunt technique. Test your skill and challenge your friends!

### WHEELIES

Press the left button as shown while driving the vehicle straight, it will stand up with one wheel as shown and move forward.

To come out of your wheelie gently tap on the brakes and continue driving.

 Your vehicle will do wheelies on command! It also does great stunts like jumps, rolls, and spin outs, and just keeps on going. The Turbo Pro Wheelie Cycle™ gives you amazing stunt cycle action with realistic tilt-motion controls that feel and respond like the real thing.

### WHEELIE TIP:

Drive for 8 seconds in a straight line to get the gyro stabilizer up to super fast speed, then press the wheelie button to pop a wheelie. Make sure cycle is going straight when you pop a wheelie.

### TURBO BOOST

Press the TURBO BOOST button on the right to add some extra punch to your wicked fast speed!

**Tip:** Wheelie Cycle performs stunts best when the gyro is running at full speed. The gyro automatically revs up as you drive the vehicle. For best stunts, drive the vehicle around for 8 seconds or more to rev up the gyro before attempting a stunt.

### Replace the worn down skid pad

1. If you see that the skid pad has been worn down it's time to replace it.
2. Unscrew the pad from the top of the skid bar with a phillips-head screw driver (not included).
3. Remove the pad and replace it with a new one.
4. Use the screwdriver to fasten the new pad firmly into place.

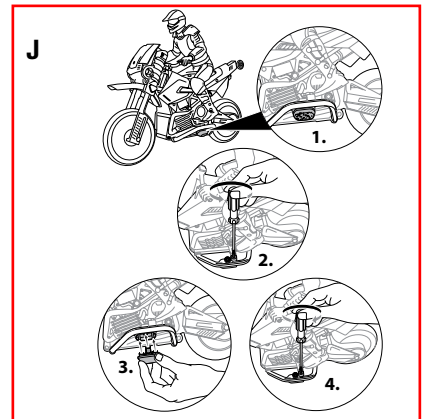
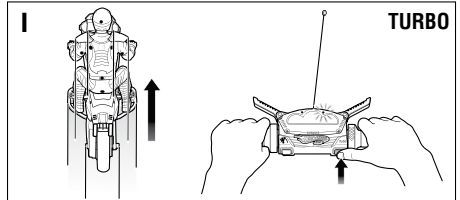
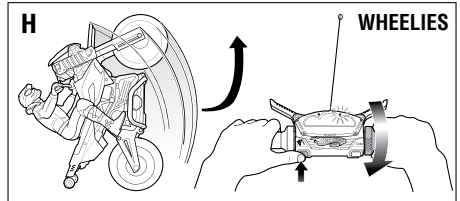

## V. BATTERY CHARGING/CARE

Use only Tyco® R/C 9.6V NiMH battery packs. Other batteries may leak or rupture, causing personal injury and damage.

1. Plug the wall pack charger into a standard wall outlet.
2. Connect the wires leading from the battery pack to the wall pack charger connector. Make certain the two connectors are tightly snapped together.
3. To disconnect the wires, push down on the connector clip and pull apart.
4. After charging, the battery will feel warm. Have no fear, that's normal for fully charged batteries.
5. New battery packs must be charged for 5 1/2 hours the first two times. After that you're looking at 4 hours per charge. Charging the battery pack for more than 4 hours won't extend your running time but if it makes you happy, charge away.
6. Unlike alkaline batteries, which lose power gradually, a NiMH battery will operate for its normal running time and then lose most of its power at once. When that starts to happen, recharge the battery pack.
7. After use, the battery pack will be hot! Wait at least 20 minutes until the battery pack cools down before recharging. Recharging a hot battery will greatly reduce the number of times your battery pack can be recharged.
8. The Charger must be disconnected from the electric supply.

**⚠ CAUTION:** Use only the charger supplied with this toy. Do not use any other charging source.

## VI. BATTERY INSTALLATION

Your vehicle will only operate with the TYCO® R/C 9.6V NiMH Battery Pack and Charger. For detailed information regarding rechargeable battery charging and safety, please refer to "Battery Charging/Care" Section.

### VEHICLE

1. Rotate the battery latches to open position. Open the battery door.
2. Plug the wire connector into the battery compartment as shown.
3. Insert the battery pack into the battery compartment as shown.
4. Close the battery door. Rotate the battery latches to the locked position.
5. To remove the battery pack: first turn the vehicle off, turn the latches on the battery compartment, open the battery door, unplug the wire connector and lift out the battery pack.

### CONTROLLER

1. Open the battery door as shown.
2. Install 2 "AA" batteries inside the battery compartment as shown.
3. Close the battery door.

## VII. QUICK TIPS

1. When your vehicle starts to lose power, it may lose functions or performance. It's time for fresh batteries (or a recharge). Your vehicle's running time may change depending on your driving style.
2. Radio interference can make your vehicle run poorly. Interference can be caused by other R/C vehicles running on the same frequency, electrical wires, large buildings, CB radios or other wireless gear. Try to stay away from these!
3. Point your transmitter antenna toward your vehicle. If your vehicle gets too far away, it won't work properly.
4. Don't drive your vehicle through water or snow. If your vehicle does get wet, wipe it with a towel and allow it to dry completely.
5. Don't store your vehicle near heat or in direct sunlight. Always turn switches OFF and remove all batteries for storage.

### RECHARGEABLE BATTERY INFORMATION:

- DO NOT RECHARGE BATTERY PACK IF IT'S HOT. ALLOW IT TO COOL BEFORE RECHARGING.
- DO NOT RECHARGE A BATTERY PACK THAT SHOWS LEAKAGE OR CORROSION.
- DO NOT DISASSEMBLE THE BATTERY PACK. THE BATTERY PACK IS A SEALED RECHARGEABLE NICKEL-METAL HYDRIDE BATTERY PACK.
- EXERCISE CAUTION IN HANDLING A HOT BATTERY PACK.
- IF BATTERY PACK AND/OR CHARGER ARE WET, THOROUGHLY DRY BEFORE CHARGING.
- DO NOT RECHARGE NON-RECHARGEABLE BATTERIES.

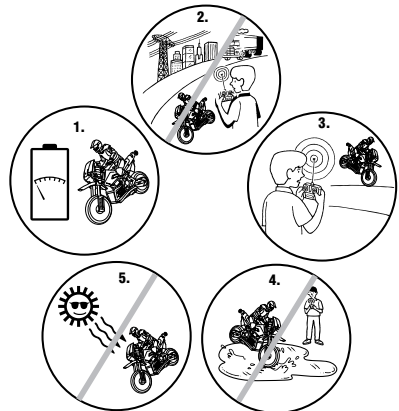
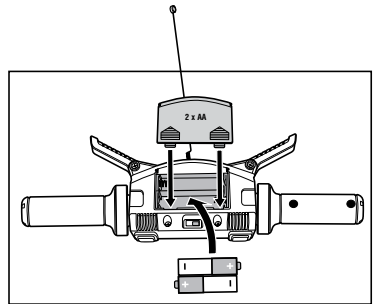
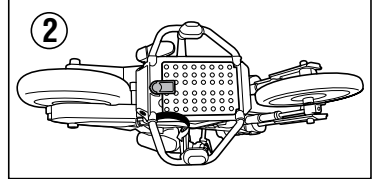
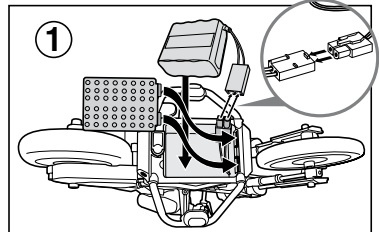
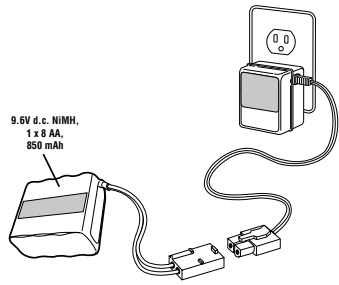

### Note to Adults:

- Use only Tyco® R/C 9.6V NiMH battery packs. Other batteries may leak or rupture, causing personal injury and damage.
- Remove rechargeable batteries before recharging.
- The battery charger is for adult use only.
- Periodically examine this product for damage to the plug, housing, or other parts that may result in the risk of fire, electric shock or injury. If the product is damaged, do not use it.
- The charger is not a toy.

THIS PRODUCT USES A NiMH RECHARGEABLE BATTERY PACK. THE BATTERY MUST BE RECYCLED OR DISPOSED OF PROPERLY. FOR FURTHER INFORMATION REGARDING BATTERIES OR THEIR DISPOSAL PLEASE CONTACT THE APPROPRIATE LOCAL OFFICE

### BATTERY DISPOSAL

Unlike NiMH rechargeable batteries, your NiMH battery pack requires no special procedures or precautions for disposal. However, as with all products, you should dispose of your battery pack in an environmentally responsible and considerate manner.

### CONSUMER INFORMATION

Adults, this toy is recommended for children 8 years of age and older. To ensure that the child's play is both safe and fun, please review the operating instructions and these general safety rules with the child.

### Safety Tips

- NEVER drive your vehicle on streets! They're for real cars!
- DO NOT pick up vehicle while in motion.
- Keep fingers, hair and loose clothing away from the tires and the wheel hubs while the vehicle is switched ON.
- Adult supervision is recommended when this vehicle is being operated.
- To avoid accidental operation, remove all batteries when not in use. Always turn the vehicle OFF before removing batteries.

 **CAUTION:** To prevent entanglement, keep hair away from wheels.

### BATTERY SAFETY INFORMATION

In exceptional circumstances batteries may leak fluids that can cause a chemical burn injury or ruin your product. To avoid battery leakage:

- Non-rechargeable batteries are not to be recharged.
- Rechargeable batteries are to be removed from the product before being charged (if designed to be removable).
- Rechargeable batteries are only to be charged under adult supervision (if designed to be removable).
- Do not mix alkaline, standard (carbon-zinc), or rechargeable (NiMH) batteries.
- Do not mix old and new batteries.
- Only batteries of the same or equivalent type as recommended are to be used.

- Batteries are to be inserted with the correct polarity.
- Exhausted batteries are to be removed from the product.
- The supply terminals are not to be short-circuited.
- Dispose of battery(ies) safely.
- Do not dispose of this product in a fire. The batteries inside may explode or leak.

### Battery Performance Note:

For best performance use regular or high-performance alkaline batteries (where disposable batteries are called for). If your vehicle is supplied with standard (carbon-zinc) batteries for initial use and/or demonstration purposes, we recommend replacing them with alkaline batteries when necessary. Battery life may vary depending on battery brand.

### This device complies with Part 15 of the FCC Rules. Operation is subject to the following two conditions:

(1) This device may not cause harmful interference, and (2) this device must accept any interference received, including interference that may cause undesired operation.

This equipment has been tested and found to comply with the limits for a Class B digital device, pursuant to part 15 of the FCC rules. These limits are designed to provide reasonable protection against harmful interference in a residential installation. This equipment generates, uses and can radiate radio frequency energy and, if not installed and used in accordance with the instructions, may cause harmful interference to radio communications. However, there is no guarantee that interference will not occur in a particular installation. If this equipment does cause harmful interference to radio or television reception, which can be determined by turning the equipment off and on, the user is encouraged to try to correct the interference by one or more of the following measures:

- Reorient or relocate the receiving antenna.
- Increase the separation between the equipment and receiver.
- Connect the equipment into an outlet on a circuit different from that to which the receiver is connected.
- Consult the dealer or an experienced radio/TV technician for help.

**NOTE:** Changes or modifications not expressly approved by the manufacturer responsible for compliance could void the user's authority to operate the equipment.



Protect the environment by not disposing of this product with household waste (2002/96/EC). Check your local authority for recycling advice and facilities.

## 90 DAY LIMITED WARRANTY – TYCO® R/C PRODUCTS

Mattel, Inc. warrants to the original consumer purchaser that this product will be free of defects in material and workmanship for ninety (90) days (unless specified in alternate warranties) from the date of purchase. Mattel will repair or replace the product, at our sole option, in the event of such a defect within the warranty period.

In the event of a defect covered under this warranty, first call the toll-free number listed below. Many problems can be solved in this manner. If necessary, you will be instructed to return the product, postage prepaid and insured, to the address below. Enclose your name, address, dated sales receipt, and a brief explanation of the defect. Repair or replacement, and return shipment, will be free of charge. Please return only the defective part or unit, packed securely.

This warranty does not cover damage resulting from unauthorized modification, accident, misuse or abuse. If the product is returned without a dated sales receipt, the product may be excluded from coverage under this warranty.

Mattel's liability for defects in material and workmanship under this warranty shall be limited to repair or replacement, at our sole option, and in no event shall we be responsible for incidental, consequential, or contingent damages (except in those states that do not allow this exclusion or limitation). This warranty is exclusive, and is made in lieu of any express or implied warranty. This warranty gives you specific legal rights and you may have other rights, which vary from state to state. Some states do not allow the exclusion of incidental or consequential damages, so the above exclusions or limitations may not apply to you.

TOLL-FREE NUMBER: 1-888-557-8926 - Valid only in U.S.A.

Hours: 8:00 A.M.-5:00 P.M. Eastern Time; Monday - Friday.  
Expect some delay in January following the holiday season.  
Please be patient and keep trying the toll-free number.

ADDRESS FOR RETURNS:  
CONSUMER RELATIONS  
636 GIRARD AVENUE  
EAST AURORA, NY 14052

Valid only in U.S.A.