



T7005-0920  
T7006-0920



Get actual Tweets  
from your dog!

# INSTRUCTION MANUAL

Keep these instructions for future reference as they contain important information.

## INSTRUCTION SHEET SPECIFICATIONS

Toy: \_\_\_\_\_ Puppy Tweets  
 Toy No.: \_\_\_\_\_ T7004  
 Part No.: \_\_\_\_\_ 0920  
 Trim Size: \_\_\_\_\_ 8.5" W x 5.5" H  
 Folded Size: \_\_\_\_\_ 4.25" W x 2.75" H  
 Type of Fold: \_\_\_\_\_ Height Fold into half  
 # colors: \_\_\_\_\_ One  
 Colors: \_\_\_\_\_ Black  
 Paper Stock: \_\_\_\_\_ White Offset  
 Paper Weight: \_\_\_\_\_ 70 lb.  
 EDM No.: \_\_\_\_\_ 001

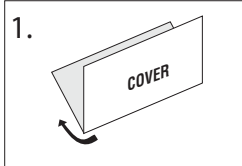

T7004 Manual\_1L-English  
P/N 823-XXXX, Rev.A  
Date: Mar. 31, 2010

### CONTENTS

- 1 Puppy Tweets™ Tag
- 1 USB Dongle

To receive instructions on how to get started with Puppy Tweets™, please visit [www.puppytweet.com/download](http://www.puppytweet.com/download) and select the appropriate file for your computer's operating system!



### SYSTEM REQUIREMENTS

#### PC specification

##### Operation System:

- Windows® XP
- Windows Vista®
- Windows® 7

##### Minimum RAM requirement:

128 MB

##### Required hard disk space:

20 MB

##### CPU:

x86 compatible CPU

#### Macintosh® specification

##### Operation System:

Mac® X10.5

##### Minimum RAM requirement:

128 MB

##### Required hard disk space:

20 MB

#### Internet Access

Internet Access is required to use this product.



**RANGE – up to 100ft/30m**



**900 MHz**

Interruption may occur if dog moves outside the maximum range or an obstruction blocks the signal transmission between the dog tag and dongle.

### BATTERY INSTRUCTIONS

#### HOW TO REPLACE BATTERIES

The proper procedure for installing and replacing the battery is located on the downloaded instructions file @ [www.puppytweet.com](http://www.puppytweet.com).

Requires 1 - 3V Lithium Battery type: CR2032 (included). Dispose of batteries safely.

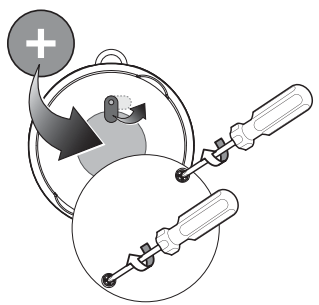

**This device complies with Part 15 of the FCC Rules.**

Operation is subject to the following two conditions:

(1) This device may not cause harmful interference, and (2) this device must accept any interference received, including interference that may cause undesired operation.

- This equipment has been tested and found to comply with the limits for a Class B digital device, pursuant to Part 15 of the FCC rules. These limits are designed to provide reasonable protection against harmful interference in a residential installation. This equipment generates uses and can radiate radio frequency energy and, if not installed and used in accordance with the instructions, may cause harmful interference to radio communications. However, there is no guarantee that interference will not occur in a particular installation. If this equipment does cause harmful interference to radio or television reception, which can be determined by turning the equipment off and on, the user is encouraged to try to correct the interference by one or more of the following measures:
- Reorient or relocate the receiving antenna.
- Increase the separation between the equipment and receiver.
- Connect the equipment into an outlet on a circuit different from that to which the receiver is connected.
- Consult the dealer or an experienced radio/TV technician for help.

**NOTE:** Changes or modifications not expressly approved by the manufacturer responsible for compliance could void the user's authority to operate the equipment.

**BATTERY SAFETY INFORMATION**

In exceptional circumstances batteries may leak fluids that can cause a chemical burn injury or ruin your product. To avoid battery leakage:

- Non-rechargeable batteries are not to be recharged.
- Rechargeable batteries are to be removed from the product before being charged (if designed to be removable).
- Rechargeable batteries are only to be charged under adult supervision (if designed to be removable).
- Do not mix alkaline, standard (carbon-zinc), or rechargeable (nickel-cadmium) batteries.
- Do not mix old and new batteries.
- Only batteries of the same or equivalent type as recommended are to be used.
- Batteries are to be inserted with the correct polarity.
- Exhausted batteries are to be removed from the product.
- The supply terminals are not to be short-circuited.
- Dispose of batteries safely.
- Do not dispose of this product in a fire. The batteries inside may explode or leak.



Protect the environment by not disposing of this product with household waste (2002/96/EC). Check your local authority for recycling advice and facilities.



© 2010 Mattel, Inc. All Rights Reserved.  
RADICA USA Ltd. www.radicagames.com Helpline 1.800.803.9611 or service.mattel.com.  
Mattel, Inc., 636 Girard Avenue, East Aurora, NY 14052, U.S.A.

**CONSUMER INFORMATION**

Need Assistance? Visit [service.mattel.com](http://service.mattel.com) or call 1.800.803.9611  
(US and Canada only).

[SERVICE.MATTEL.COM](http://SERVICE.MATTEL.COM)