



T9499-0720

ENG

Questions or problems with your product? DON'T RETURN IT TO THE STORE! Just call us for help. U.S. consumers may also register their products at this number.

ESP

Si tiene alguna pregunta o problema con el producto, NO DEVUELVA EL PRODUCTO A LA TIENDA. Llámenos, y con gusto le ayudaremos.

F

Vous avez des questions à propos de votre produit ou il ne fonctionne pas correctement? NE LE RETOURNEZ PAS AU MAGASIN! Un appel suffit.



- Protect the environment by not disposing of this product with household waste (2002/96/EC). Check your local authority for recycling advice and facilities.
- Proteger el medio ambiente no disponiendo de este producto en la basura del hogar (2002/96/EC). Consultar con la agencia local pertinente en cuanto a información y centros de reciclaje.
- Protéger l'environnement en ne jetant pas ce produit avec les ordures ménagères (2002/96/EC). Consulter la municipalité pour obtenir des conseils sur le recyclage et connaître les centres de dépôt de la région.

COMPLIANCE WITH FCC REGULATIONS (VALID IN U.S. ONLY).

This device complies with Part 15 of the FCC Rules.

Operation is subject to the following two conditions:

- (1) This device may not cause harmful interference, and
- (2) this device must accept any interference received, including interference that may cause undesired operation.

This equipment has been tested and found to comply with the limits for a Class B digital device, pursuant to part 15 of the FCC rules. These limits are designed to provide reasonable protection against harmful interference in a residential installation. This equipment generates, uses and can radiate radio frequency energy and, if not installed and used in accordance with the instructions, may cause harmful interference to radio communications. However, there is no guarantee that interference will not occur in a particular installation. If this equipment does cause harmful interference to radio or television reception, which can be determined by turning the equipment off and on, the user is encouraged to try to correct the interference by one or more of the following measures:

- Reorient or relocate the receiving antenna.
- Increase the separation between the equipment and receiver.
- Connect the equipment into an outlet on a circuit different from that to which the receiver is connected.
- Consult the dealer or an experienced radio/TV technician for help.

NOTE: Changes or modifications not expressly approved by the manufacturer responsible for compliance could void the user's authority to operate the equipment.

RSS - 310 (Canada) (VALID FOR CANADA ONLY - VALABLE AU CANADA SEULEMENT)

This Category II radiocommunication device complies with Industry Canada Standard RSS-310. Operation is subject to the following two conditions: (1) this device may not cause interference, and (2) this device must accept any interference, including interference that may cause undesired operation of the device.

Ce dispositif de radiocommunication de catégorie II respecte la norme CNR-310 d'Industrie Canada. L'utilisation de ce dispositif est autorisée seulement aux deux conditions suivantes : (1) il ne doit pas produire de brouillage, et (2) l'utilisateur du dispositif doit être prêt à accepter tout brouillage radioélectrique reçu, même si ce brouillage est susceptible de compromettre le fonctionnement du dispositif. CNR-310 d'Industrie Canada (CANADA SEULEMENT)

CNR-310 d'Industrie Canada (CANADA SEULEMENT)
27.145 MHz TX RF = 54 dBµV/m @ 3m.

COMPLIANCE WITH FCC REGULATIONS (VALID IN U.S. ONLY).

This device complies with Part 15 of the FCC Rules.

Operation is subject to the following two conditions:

- (1) This device may not cause harmful interference, and
- (2) this device must accept any interference received, including interference that may cause undesired operation.

This equipment has been tested and found to comply with the limits for a Class B digital device, pursuant to part 15 of the FCC rules. These limits are designed to provide reasonable protection against harmful interference in a residential installation. This equipment generates, uses and can radiate radio frequency energy and, if not installed and used in accordance with the instructions, may cause harmful interference to radio communications. However, there is no guarantee that interference will not occur in a particular installation. If this equipment does cause harmful interference to radio or television reception, which

can be determined by turning the equipment off and on, the user is encouraged to try to correct the interference by one or more of the following measures:

- Reorient or relocate the receiving antenna.
- Increase the separation between the equipment and receiver.
- Connect the equipment into an outlet on a circuit different from that to which the receiver is connected.
- Consult the dealer or an experienced radio/TV technician for help.

NOTE: Changes or modifications not expressly approved by the manufacturer responsible for compliance could void the user's authority to operate the equipment.

COMPLIANCE WITH FCC REGULATIONS (VALID IN U.S. ONLY).

This device complies with Part 15 of the FCC Rules.

Operation is subject to the following two conditions:

- (1) This device may not cause harmful interference, and
- (2) this device must accept any interference received, including interference that may cause undesired operation.

This equipment has been tested and found to comply with the limits for a Class B digital device, pursuant to part 15 of the FCC rules. These limits are designed to provide reasonable protection against harmful interference in a residential installation. This equipment generates, uses and can radiate radio frequency energy and, if not installed and used in accordance with the instructions, may cause harmful interference to radio communications. However, there is no guarantee that interference will not occur in a particular installation. If this equipment does cause harmful interference to radio or television reception, which

can be determined by turning the equipment off and on, the user is encouraged to try to correct the interference by one or more of the following measures:

- Reorient or relocate the receiving antenna.
- Increase the separation between the equipment and receiver.
- Connect the equipment into an outlet on a circuit different from that to which the receiver is connected.
- Consult the dealer or an experienced radio/TV technician for help.

NOTE: Changes or modifications not expressly approved by the manufacturer responsible for compliance could void the user's authority to operate the equipment.

CAUTION: Surfaces may become hot and cause burns if electronics get wet. Do not operate vehicle through water or snow.

PRECAUCIÓN: Las superficies se pueden calentar y causar quemaduras si las piezas electrónicas se mojan. No usar el vehículo en agua ni nieve.

MISE EN GARDE : Les surfaces peuvent devenir chaudes et causer des brûlures si les composants électroniques sont mouillés. Ne pas utiliser le véhicule dans l'eau ou la neige.

CAUTION: To prevent entanglement, keep all hair away from the wheels.

PRECAUCIÓN: Para evitar lesiones, mantener el cabello alejado de las ruedas.

MISE EN GARDE : Pour éviter tout risque d'enchevêtrement, tenir les cheveux éloignés des roues.

ENG

Keep these instructions for future reference as they contain important information. IMPORTANT: Please read all "Consumer Information" before operating your vehicle.

ESP

Leer y guardar estas instrucciones para futura referencia, ya que contienen información de importancia acerca de este producto. IMPORTANTE: Leer toda la "Información al consumidor" antes de usar el vehículo.

F

Conserver ce mode d'emploi pour s'y référer en cas de besoin car il contient des informations importantes. IMPORTANT : Lire tous les «Renseignements pour les consommateurs» avant d'utiliser le véhicule.

© 2010 Mattel, Inc. All Rights Reserved. Tous droits réservés. Mattel, Inc. 636 Girard Avenue, East Aurora, NY 14052, U.S.A. Consumer Relations 1-888-557-8926. Mattel Canada Inc., Mississauga, Ontario L5R 3W2. You may call us free at 1-888-557-8926. Mattel Australia Pty., Ltd., Richmond, Victoria. 3121. Consumer Advisory Service - 1300 135 312. Mattel East Asia Ltd., Room 1106, South Tower, World Finance Centre, Harbour City, Tsimshatsui, HK, China. Dimport & Diedarkan Oleh: Mattel SEA Ptd Ltd.(993532-P) Lot 13.5, 13th Floor, Menara Lien Hoe, Persiaran Tropicana Golf Country Resort, 47410 PJ. Tel:03-78803817, Fax:03-78803867. Retain this address for future reference. Mattel U.K. Ltd., Vanwall Business Park, Maidenhead SL6 4UB. Importado y distribuido por Mattel de México, S.A. de C.V.R.F.C. Insurgentes Sur # 3579, Torre 3, Oficina 601, Col. Tlalpan, Delegación Tlalpan, C.P. 14020, México, D.F. MME-920701-NB3. 59-05-51-00. Ext. 5206 ó -01-800-463 59-89 Mattel Chile, S.A., Avenida Américo Vespucio 501-B, Quilicura, Santiago. Mattel de Venezuela, C.A. RIF J301596439, Ave. Mara, C.C. Macaracuay Plaza, Torre B, Piso 8, Colinas de la California, Caracas 1071. Mattel Argentina S.A., Curupayti 1186, (1607) - Villa Adelina, Buenos Aires. Mattel Colombia, S.A., calle 123#7-07 P.5, Bogotá. Importado por : Mattel do Brasil Ltda.- CNPJ : 54.558.002/0008-04 - Av. Tenente Marques, 1246 - Sala 02 - 2º. Andar - 07770-000 - Polvilho - Cajamar - SP - Brasil Serviço de Atendimento ao Consumidor (SAC): 0800-550780 - sac@mattel.com Mattel France, 27/33 rue d'Antony, Siliç 145, 94523 Rungis Cedex N° Indigo 0 825 00 00 25 (0,15 € TTC/mn) ou www.allomattel.com. Mattel España, S.A., Aribau 200. 08036 Barcelona. cservice.spain@mattel.com Tel: 902.20.30.10 http://www.service.mattel.com/es Mattel Portugal Lda., Av. da República, nº 90/96, 2º andar Fração 2, 1600-206 Lisboa service.mattel.com

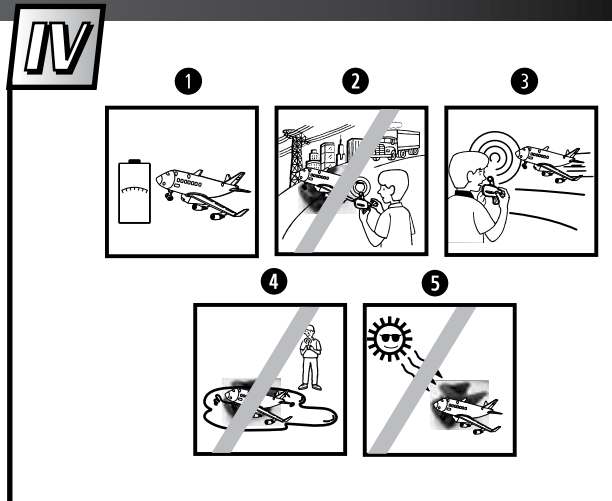
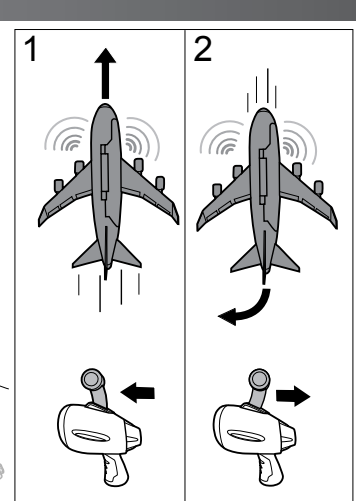
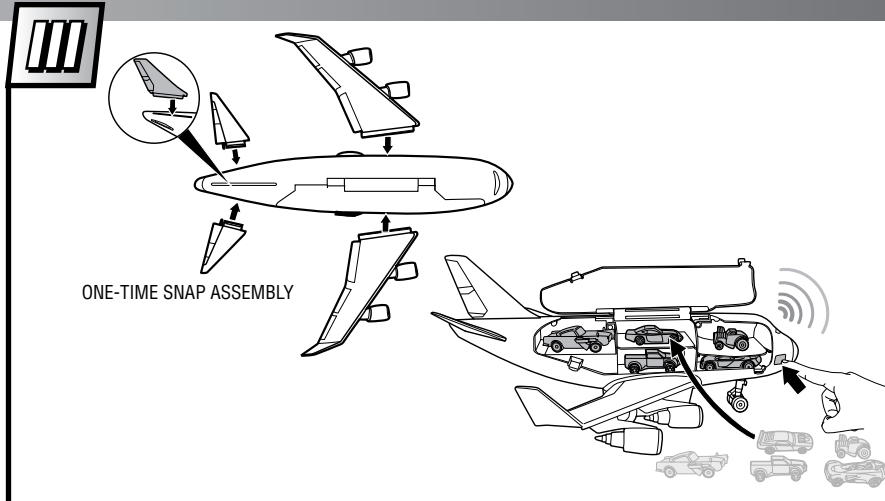
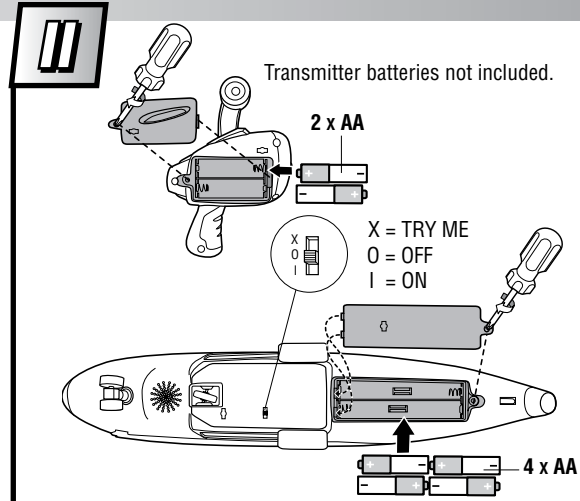
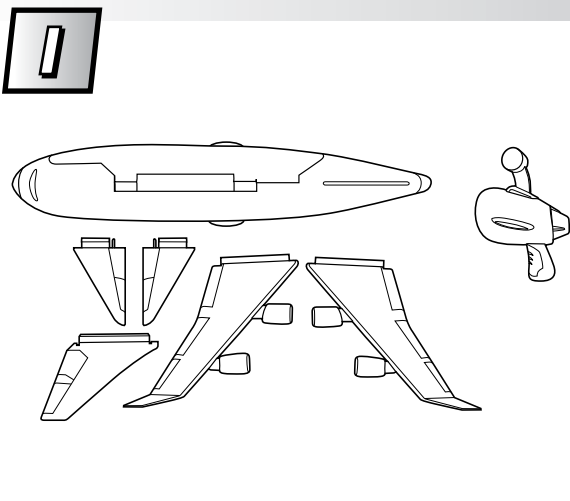

ENG

ESP

F

I. CONTENTS/ FEATURES

Plane
Transmitter

II. BATTERY INSTALLATION

(Transmitter & Vehicle)

Requires 2 AA alkaline batteries for the transmitter and includes 4 AA batteries for the vehicle.

Vehicle

1. Unscrew the battery cover with a Phillips head screwdriver (not included).
2. Remove batteries included for demonstration purposes and dispose of them safely.
3. Install 4 new alkaline batteries with polarity (+/-) as shown inside the battery compartment.
4. Replace battery cover and tighten screw.

Transmitter

1. Unscrew the battery cover with a Phillips head screwdriver (not included).
2. Transmitter requires 2 AA alkaline batteries. Install with polarity (+/-) as shown inside the battery compartment.
3. Replace battery cover and tighten screw.

III. OPERATION

Your vehicle is designed for easy operation. Switch vehicle ON. Push control stick forward and vehicle will move forward as if taking off. Pull control stick backward and vehicle will reverse left in a circle.

IV. QUICK TIPS

- 1 When your vehicle starts to lose power, it may lose functionality or performance. It's time for fresh batteries. Your vehicle's running time varies depending on your driving style.
- 2 Interference can affect your vehicle's performance. Interference can be caused by other I/R devices like a TV remote control or other remotes in the house. Try to stay away from these!
- 3 Point the transmitter toward the vehicle. If your vehicle gets too far away, it won't work properly.
- 4 Don't drive your vehicle in sand or through water or snow. If your vehicle does get wet, wipe it with a towel and allow to dry completely overnight.
- 5 Don't store your vehicle near heat or in direct sunlight. Always turn switches OFF and remove all batteries for storage.
- 6 Do not obstruct the line of sight.
- 7 Do not exceed the specified range.
- 8 This vehicle works better indoors than outdoors where sunlight can sometimes interfere with the I/R.
- 9 If that doesn't work, simply turn the vehicle's power switch OFF and then ON again. This should reset your vehicle and let you resume normal operation.

V. BATTERY SAFETY INFORMATION

In exceptional circumstances batteries may leak fluids that can cause a chemical burn injury or ruin your product. To avoid battery leakage:

- Non-rechargeable batteries are not to be recharged.
- Rechargeable batteries are to be removed from the product before being charged (if designed to be removable).
- Rechargeable batteries are only to be charged under adult supervision (if designed to be removable).
- Do not mix alkaline, standard (carbon-zinc), or rechargeable (nickel-cadmium) batteries.
- Do not mix old and new batteries.
- Only batteries of the same or equivalent type as recommended are to be used.
- Batteries are to be inserted with the correct polarity.
- Exhausted batteries are to be removed from the product.
- The supply terminals are not to be short-circuited.
- Dispose of battery(ies) safely.
- Do not dispose of this product in a fire. The batteries inside may explode or leak.

Battery Performance Note:

For best performance use regular or high-performance alkaline batteries (where disposable batteries are called for). If your vehicle is supplied with standard (carbon-zinc) batteries for initial use and/or demonstration purposes, we recommend replacing them with alkaline batteries when necessary. Battery life may vary depending on battery brand.

VI. CONSUMER INFORMATION

Note to Adults: To ensure that the child's play is both safe and fun, please review all operating instructions and safety rules with your child.

Safety Tips

- NEVER drive your vehicle on streets! They're for real cars!
- DO NOT pick up the vehicle while in motion.
- Keep fingers, hair and loose clothing away from the tires and the wheel hubs while the vehicle is switched ON.
- Adult supervision is recommended when this vehicle is being operated.
- To avoid accidental operation, remove all batteries when not in use.

I. CONTENTS/ FEATURES

Plane
Transmitter

II. BATTERY INSTALLATION

(Transmitter & Vehicle)

Requires 2 AA alkaline batteries for the transmitter and includes 4 AA batteries for the vehicle.

Vehicle

1. Unscrew the battery cover with a Phillips head screwdriver (not included).
2. Remove batteries included for demonstration purposes and dispose of them safely.
3. Install 4 new alkaline batteries with polarity (+/-) as shown inside the battery compartment.
4. Replace battery cover and tighten screw.

Transmitter

1. Unscrew the battery cover with a Phillips head screwdriver (not included).
2. Transmitter requires 2 AA alkaline batteries. Install with polarity (+/-) as shown inside the battery compartment.
3. Replace battery cover and tighten screw.

III. OPERATION

Your vehicle is designed for easy operation. Switch vehicle ON. Push control stick forward and vehicle will move forward as if taking off. Pull control stick backward and vehicle will reverse left in a circle.

IV. QUICK TIPS

- 1 When your vehicle starts to lose power, it may lose functionality or performance. It's time for fresh batteries. Your vehicle's running time varies depending on your driving style.
- 2 Interference can affect your vehicle's performance. Interference can be caused by other I/R devices like a TV remote control or other remotes in the house. Try to stay away from these!
- 3 Point the transmitter toward the vehicle. If your vehicle gets too far away, it won't work properly.
- 4 Don't drive your vehicle in sand or through water or snow. If your vehicle does get wet, wipe it with a towel and allow to dry completely overnight.
- 5 Don't store your vehicle near heat or in direct sunlight. Always turn switches OFF and remove all batteries for storage.
- 6 Do not obstruct the line of sight.
- 7 Do not exceed the specified range.
- 8 This vehicle works better indoors than outdoors where sunlight can sometimes interfere with the I/R.
- 9 If that doesn't work, simply turn the vehicle's power switch OFF and then ON again. This should reset your vehicle and let you resume normal operation.

V. BATTERY SAFETY INFORMATION

In exceptional circumstances batteries may leak fluids that can cause a chemical burn injury or ruin your product. To avoid battery leakage:

- Non-rechargeable batteries are not to be recharged.
- Rechargeable batteries are to be removed from the product before being charged (if designed to be removable).
- Rechargeable batteries are only to be charged under adult supervision (if designed to be removable).
- Do not mix alkaline, standard (carbon-zinc), or rechargeable (nickel-cadmium) batteries.
- Do not mix old and new batteries.
- Only batteries of the same or equivalent type as recommended are to be used.
- Batteries are to be inserted with the correct polarity.
- Exhausted batteries are to be removed from the product.
- The supply terminals are not to be short-circuited.
- Dispose of battery(ies) safely.
- Do not dispose of this product in a fire. The batteries inside may explode or leak.

Battery Performance Note:

For best performance use regular or high-performance alkaline batteries (where disposable batteries are called for). If your vehicle is supplied with standard (carbon-zinc) batteries for initial use and/or demonstration purposes, we recommend replacing them with alkaline batteries when necessary. Battery life may vary depending on battery brand.

VI. CONSUMER INFORMATION

Note to Adults: To ensure that the child's play is both safe and fun, please review all operating instructions and safety rules with your child.

Safety Tips

- NEVER drive your vehicle on streets! They're for real cars!
- DO NOT pick up the vehicle while in motion.
- Keep fingers, hair and loose clothing away from the tires and the wheel hubs while the vehicle is switched ON.
- Adult supervision is recommended when this vehicle is being operated.
- To avoid accidental operation, remove all batteries when not in use.

I. CONTENTS/ FEATURES

Plane
Transmitter

II. BATTERY INSTALLATION

(Transmitter & Vehicle)

Requires 2 AA alkaline batteries for the transmitter and includes 4 AA batteries for the vehicle.

Vehicle

1. Unscrew the battery cover with a Phillips head screwdriver (not included).
2. Remove batteries included for demonstration purposes and dispose of them safely.
3. Install 4 new alkaline batteries with polarity (+/-) as shown inside the battery compartment.
4. Replace battery cover and tighten screw.

Transmitter

1. Unscrew the battery cover with a Phillips head screwdriver (not included).
2. Transmitter requires 2 AA alkaline batteries. Install with polarity (+/-) as shown inside the battery compartment.
3. Replace battery cover and tighten screw.

III. OPERATION

Your vehicle is designed for easy operation. Switch vehicle ON. Push control stick forward and vehicle will move forward as if taking off. Pull control stick backward and vehicle will reverse left in a circle.

IV. QUICK TIPS

- 1 When your vehicle starts to lose power, it may lose functionality or performance. It's time for fresh batteries. Your vehicle's running time varies depending on your driving style.
- 2 Interference can affect your vehicle's performance. Interference can be caused by other I/R devices like a TV remote control or other remotes in the house. Try to stay away from these!
- 3 Point the transmitter toward the vehicle. If your vehicle gets too far away, it won't work properly.
- 4 Don't drive your vehicle in sand or through water or snow. If your vehicle does get wet, wipe it with a towel and allow to dry completely overnight.
- 5 Don't store your vehicle near heat or in direct sunlight. Always turn switches OFF and remove all batteries for storage.
- 6 Do not obstruct the line of sight.
- 7 Do not exceed the specified range.
- 8 This vehicle works better indoors than outdoors where sunlight can sometimes interfere with the I/R.
- 9 If that doesn't work, simply turn the vehicle's power switch OFF and then ON again. This should reset your vehicle and let you resume normal operation.

V. BATTERY SAFETY INFORMATION

In exceptional circumstances batteries may leak fluids that can cause a chemical burn injury or ruin your product. To avoid battery leakage:

- Non-rechargeable batteries are not to be recharged.
- Rechargeable batteries are to be removed from the product before being charged (if designed to be removable).
- Rechargeable batteries are only to be charged under adult supervision (if designed to be removable).
- Do not mix alkaline, standard (carbon-zinc), or rechargeable (nickel-cadmium) batteries.
- Do not mix old and new batteries.
- Only batteries of the same or equivalent type as recommended are to be used.
- Batteries are to be inserted with the correct polarity.
- Exhausted batteries are to be removed from the product.
- The supply terminals are not to be short-circuited.
- Dispose of battery(ies) safely.
- Do not dispose of this product in a fire. The batteries inside may explode or leak.

Battery Performance Note:

For best performance use regular or high-performance alkaline batteries (where disposable batteries are called for). If your vehicle is supplied with standard (carbon-zinc) batteries for initial use and/or demonstration purposes, we recommend replacing them with alkaline batteries when necessary. Battery life may vary depending on battery brand.

VI. CONSUMER INFORMATION

Note to Adults: To ensure that the child's play is both safe and fun, please review all operating instructions and safety rules with your child.

Safety Tips

- NEVER drive your vehicle on streets! They're for real cars!
- DO NOT pick up the vehicle while in motion.
- Keep fingers, hair and loose clothing away from the tires and the wheel hubs while the vehicle is switched ON.
- Adult supervision is recommended when this vehicle is being operated.
- To avoid accidental operation, remove all batteries when not in use.