



INSTRUCTIONS

CAUTION:
To prevent entanglement,
keep hair away from wheels.

Please keep these instructions for future reference, as they contain important information.

BATTERY INSTALLATION:

•Skateboard

1. Unscrew and remove the battery door.

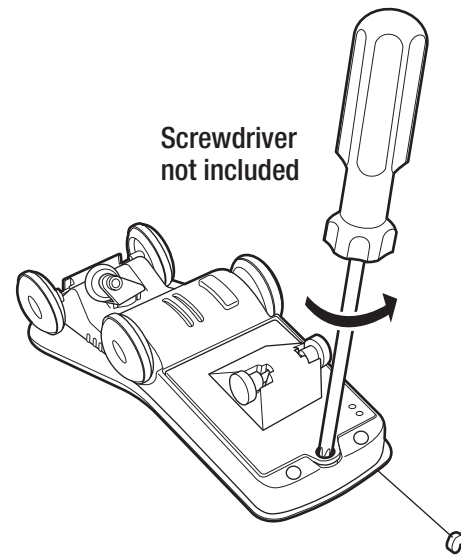

Screwdriver
not included

2. Insert 3 "AA" (LR6) alkaline batteries (not included), as indicated inside the battery compartment.

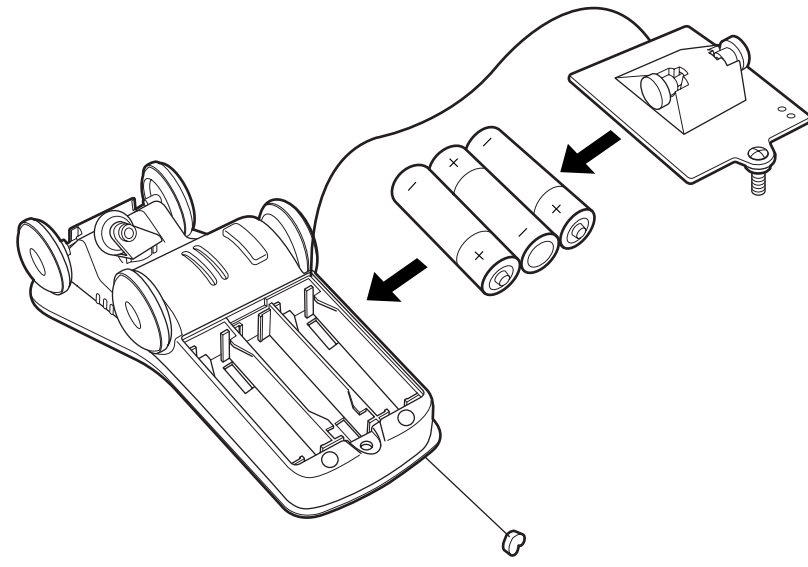

3. Replace and screw the battery door after installing the batteries

•Controller

1. Slide open the battery door.

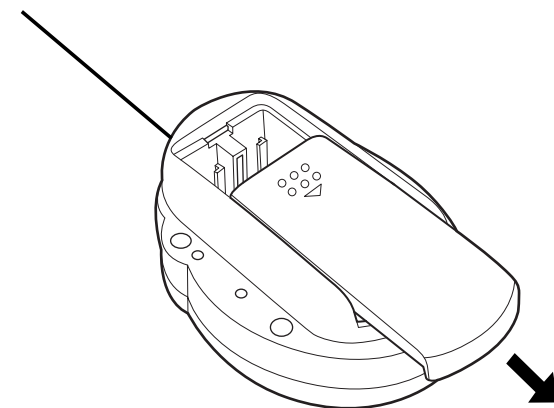

2. Insert one "9V" alkaline battery (not included), as indicated inside the battery compartment.

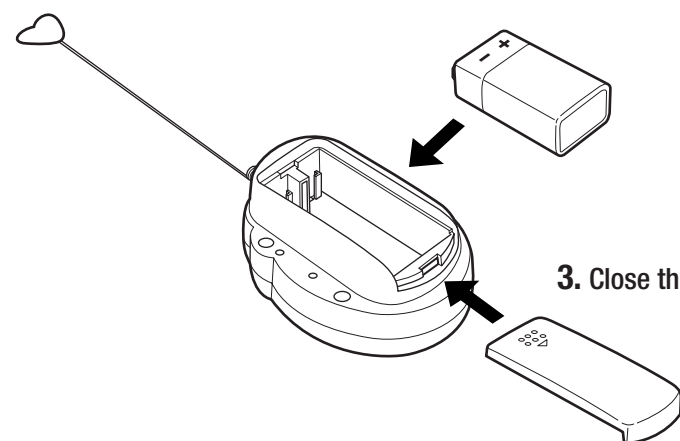

3. Close the battery door.

BATTERY SAFETY INFORMATION

- Non-rechargeable batteries are not to be recharged.
- Rechargeable batteries are to be removed from the toy before being charged (if designed to be removable).
- Rechargeable batteries are only to be charged under adult supervision (if designed to be moveable).
- Do not mix alkaline, standard (carbon-zinc), or rechargeable (nickel-cadmium) batteries.
- Do not mix old and new batteries.
- Only batteries of the same or equivalent type as recommended are to be used.
- Batteries are to be inserted with the correct polarity.
- Exhausted batteries are to be removed from the toy.
- The supply terminals are not to be short-circuited.
- Dispose of batteries safely. Do not dispose of in fire as batteries may explode or leak.
- Products with non-replaceable batteries are not to be disposed of in a fire as the batteries inside may explode or leak.

47999-9993-S1

© 2002 Mattel, Inc., El Segundo, CA 90245 U.S.A. All Rights Reserved. Mattel East Asia Ltd., World Finance Centre, Harbour City, Tsimshatsui, HK, China.
Retain this address for future reference:
Mattel U.K. Ltd., Vanwall Business Park, Maidenhead SL6 4UB.
Help line 01628500303

SIZE: 8.375"W X 11.5"H

NOTE: Changes or modifications not expressly approved by the manufacturer responsible for compliance could void the user's authority to operate the equipment.

This equipment has been tested and found to comply with the limits for a Class B digital device, pursuant to part 15 of the FCC rules. These limits are designed to provide reasonable protection against harmful interference in a residential installation. This equipment generates, uses and can radiate radio frequency energy and, if not installed and used in accordance with the instructions, may cause harmful interference to radio communications. However, there is no guarantee that interference will not occur in a particular installation. If this equipment does cause harmful interference to radio or television reception, which can be determined by turning the equipment off and on, the user is encouraged to try to correct the interference by one or more of the following measures:

Reorient or relocate the receiving antenna.

Increase the separation between the equipment and receiver.

Connect the equipment into an outlet on a circuit different from that to which the receiver is connected.

Consult the dealer or an experienced radio/TV technician for help.

Mattel Inc.

333 Continental Blvd.

El Segundo, CA

(310) 252-2400

R/C toy operates from up to 30 feet (9m) away.

This product operates at a frequency of 27MHz

GETTING STARTED

•Hair band removal installation

Pull ends of strips to release hair. Remove any remaining thread from hair.

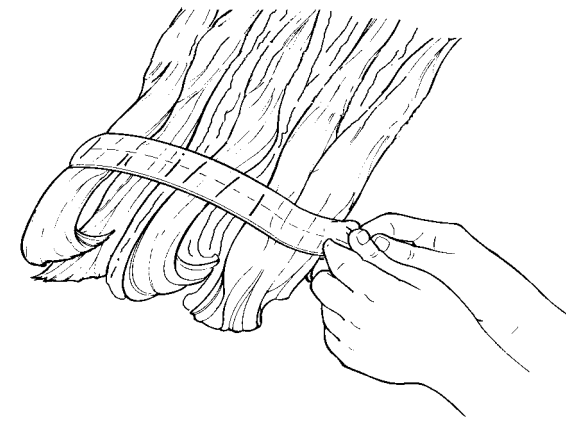

•Stickers

Remove the labels from the sticker sheet and place anywhere on the skateboard, helmet and/or controller

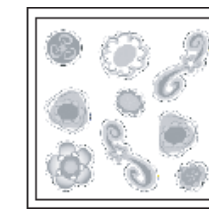

1. Press the power ON/OFF button on the top of the skateboard to turn the unit on and off.

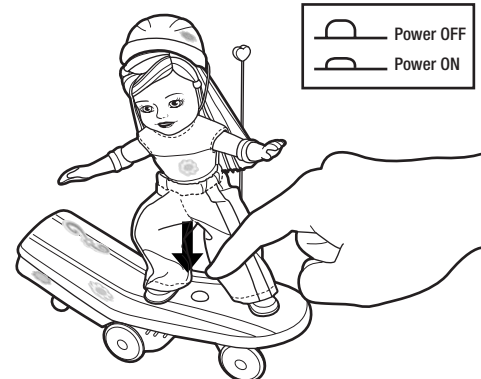

Power OFF
Power ON

2. The skateboard spins clockwise continuously when the Power button is pressed ON.

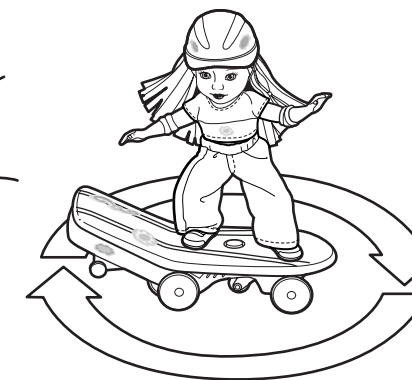

3. When you hold the button on the controller down, the skateboard will tilt back into a wheelie and move forward until the button is released. The skateboard will then continue to spin until the button is pressed down again.

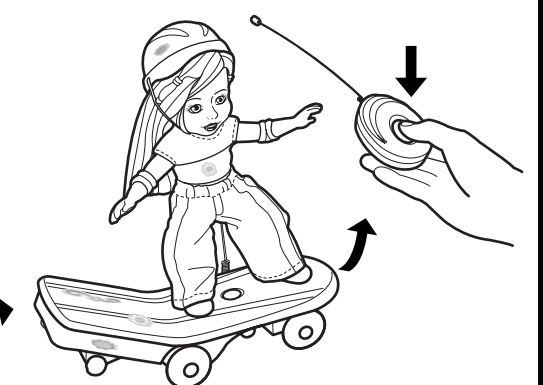

4. To turn the product off, pick up by the back of the skateboard or lift the doll by the head and press the On/Off button.

- Operating multiple vehicles with the same frequency in close proximity will cause interference and poor performance.
- Works best away from high voltage power lines, large buildings and walls.
- Hold the transmitter antenna up for best performance.
- When the product does not respond, slows down, or loses range, change the batteries.
- If transmitter is accidentally dropped in the water, remove battery(ies) and allow transmitter to air dry. Replace with fresh battery(ies) before operation.
- Requires 3 AA alkaline batteries for the skateboard and one 9-V alkaline battery for the transmitter.
- Play Safely! - Do not drive vehicle in the street!
- For longer life use only alkaline batteries.

- This product is not recommended for use on loose dirt or wet surfaces.
- Do not immerse in water.

Surface washable