

QFX®

Boombox with USB/MP3/CD/CASSETTE/RADIO/USB/AUX AND BLUETOOTH



J-50U

OPERATIONAL MANUAL

- 3** Press [●REC] to start recording. [◀PLAY] is also depressed with [●REC]. Recording starts (one side only). The CD also starts playing if in CD mode.

To stop recording
Press [■/▲ STOP/EJECT]. (The CD does not stop.)

To stop recording temporarily
Press [⏸ PAUSE]. (The CD does not stop.) Press once again to resume recording.

To record on the other side of the cassette
Turn the cassette over and press [●REC].

If the CD finishes before the cassette
Recording continues. Press [■/▲ STOP/EJECT] to stop it.

If the cassette finishes before the CD
The CD continues playing, Press [■] to stop it.

Maintenance

If the surfaces are dirty

- To clean this unit, wipe with a soft, dry cloth.
- Never use alcohol, paint thinner or benzine to clean this unit.
 - Before using chemically treated cloth, read the instructions that came with the cloth carefully.

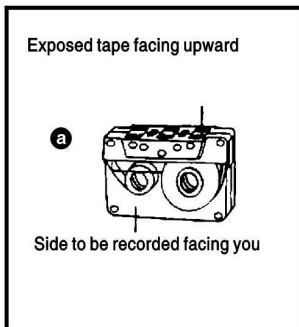

Note

Noise may be recorded if this unit is near a TV. Keep the units at least 1.5 meters apart.

B Erasure prevention

Use a screwdriver or similar object to break out the tab.

C To re-record on a protected cassette
Cover the hole with adhesive tape.

To erase a tape

1. Set [SELECTOR] to „TAPE/OFF“.
2. Insert the cassette with the side to be erased facing towards you and the exposed tape facing up.
3. Press [●REC]. [◀PLAY] is depressed at the same time.

Reference

Changes to volume and sound quality do not affect recording.
To prevent interruptions to recording, supply AC power to the unit or replace the batteries.

Tape head care

Clean the heads regularly to assure good quality playback and recording.
Use a cleaning tape (not included).

D Lens care

Clean the lens regularly to prevent malfunctions.
Use a blower to remove dust and a cotton swab if it is extremely dirty.
Recommended product;
Lens cleaner kit (SZZP1038C).

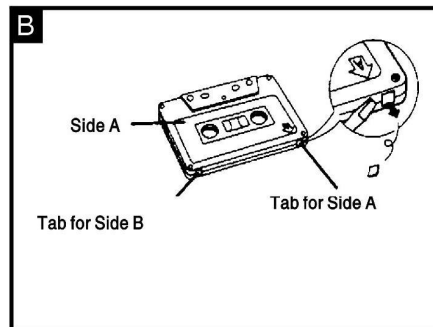

Remote Control

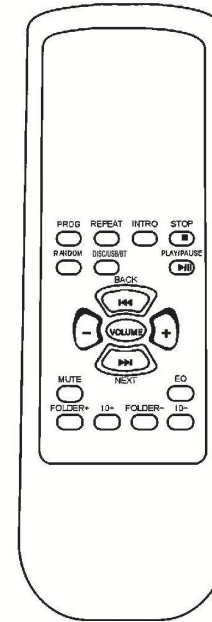

1. PROG
2. REPEAT
3. INTRO
4. STOP
5. RANDOM
6. DISC/USB/BT
7. PLAY/PAUSE
8. NEXT
9. BACK
10. VOLUME +/-
11. MUTE
12. EQ
13. FOLDER +/-
14. 10 +/-

1. PROG

Pressing this button can set up the memory order of chapter title (for CD) or tracks (for CD)

2. REPEAT

Pressing this button successively will repeat current track or the whole disc.

3. INTRO

At playback or stop mode, pressing this button will play each track for a duration of first 15 seconds.

4. STOP

Pressing this button, the player will stop.

5. RANDOM

Pressing this button allows you to play the tracks of the disc in random order.

Press 4 times: enter the self-playing function state.

Press 5 times: to cancel all function.

2. While MP3 playing, Press this key

Press once: enter the current single song repeated playing state

Press twice: enter the current single file repeated playing state.(CD without this function)

Press 3 times: enter the current whole disk repeated playing state

Press 4 times: enter the self-playing function state.

Press 5 times: to cancel all function.

PROG 1. While in stopping state, Press this key to programming

When LCD shows "P-01", Press "NEXT/BACK/FOLDER+/10+" to select the song number, then Press "PROG" for confirmation and enter P-02, by analogy, Press "PLAY" to broadcast follow the programming order.

The number of CD Programming is 20 songs.

The number of MP3/WMA Programming is 99 songs.

5. CD has 10-second's ESP function

MP3 has 10-second's ESP function (Counted by the Unit of 128kbps)

Discs

Continued use of irregular shaped CDs can damage the unit.

Do-not

- use CDs with labels and stickers that are coming off or with adhesive exuding from under labels and stickers.
- attach scratch-proof covers or any other kind of accessory.
- write anything on thr CD.
- clean CDs with liquids. (Wipe with a soft, dry cloth.)
- use CDs printed with label printers available on the market.
- load a blank CD-R as it will cause abnormal malfunction and may damage the CD-R.

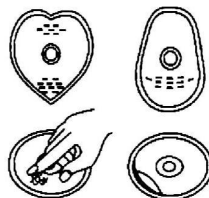

Note

- If interference occurs to radios or televisions, place the unit as far as possible from this equipment.
- Do not press [▲ CD OPEN/CLOSE] during play, pause or immediately after you inserted the CD and closed the CD lid. CD may be scratched.

Cassette tapes

- Tapes exceeding 100 minutes are thin and can break or get caught in the mechanism.
- Tape slack can get caught up in the mechanism and should be taken up before the tape is played.
- Endless tapes can get caught up in the deck's moving parts if used incorrectly.

AUX/MP3-INPUT

Put function switch on "AUX" position, connect "AUX" jack with external source, such as CD, MP3, when no CD disc on CD compartment and no USB is connected with the unit, then this unit is used as a sound box and the songs will playback automatically after read.

USB OPERATION

Put function switch on "CD" position, when no disc on CD compartment, put USB into USB jack, then songs in USB will playback automatically after read.

USE OF BLUETOOTH

Put function switch on "BT" position, long press <PLAY> two times, "BT" icon shows on play screen. Open mobile Bluetooth function, search <QFX>, connecting successful. Or Put function switch on "BT" position, use remote control, pressing the button (DISC/USB/BT two times). The button on unit top for Bluetooth function: ◀◀ Previous ▶▶ Next ▶|| Play/ ■ Stop Disconnected.

NOTE: BLUETOOTH FUNCTION ONLY RECEIVES MUSIC,, THIS UNIT HAS NO HANDSFREE FUNCTION.

PLAY/PAUSE FUNCTION

The button <PLAY/PAUSE> has <MODE> function. Shift between CD、USB and BT. When without CD disc/ USB stick, press button <CD/USB/BT> on remote control. The unit returns to read CD disc automatically.

DISCO LIGHT

The switch of Disco light behinds the unit. Press <ON>, turn on disco light, press <OFF>, turn off disco light.

USE OF BATTERIES

If this unit is not used for a long period of time or is used only from an AC power source, remove all the batteries to prevent potential damage due to possible battery leakage

Align the poles(+ and -) properly when inserting the batteries

Do not mix old and new batteries or different types of batteries.

Do not recharge ordinary dry cell batteries.

Do not heat or disassemble the batteries. Do not allow them to contact flame or water.

Do not keep together with metallic objects such as necklaces.

Do not use rechargeable type batteries.

Do not use batteries if the covering has been peeled off.

Mishandling of batteries can damage other items, cause damage to the unit, and may cause a fire through short-circuiting or electrolyte leakage. If electrolyte leaks from the batteries, consult your dealer.

This product may receive radio interference caused by mobile telephones during use. If such interference is apparent, please increase separation between the product and the mobile telephone.

The unit cannot be powered by batteries if the power cord is connected.

When to change the batteries

Sound quality and operations are affected when the batteries are running low. Replace all eight batteries; it is also a good idea to replace all the batteries before recording.

Removing the batteries

Open the battery cover and insert your finger in the hole on the bottom of the unit and push out.

Radio operation

- (1) Select power supply using either AC or DC source
- (2) Slide function switch to FM or AM position
- (3) Turn tuning select broadcasting (or radio) station
- (4) If interference occurs to radio or televisions place the unit as possible from this equipment

- 2 Push [**▲ CD OPEN/CLOSE**] to open the CD lid and insert the CD.
- 3 Push [**▲ CD OPEN/CLOSE**] to close the CD lid.
- 4 Press [**▶/||**] to start play. Play starts from the first track and continues to the last track.
- 5 Adjust the volume.

CDS

CDs

Normal play

- 1 Switch Function select to "CD".
(Unit comes on.)

This unit can play CD-DA (digital audio) format audio CD-R that has been finalized (a process that enables CD-R players to play audio CD-R) upon completion of recording. It may not be able to play some CD-R due to the condition of the recording. It cannot play CD-RW.

Compatible Style: CD / CD-R / CD-RW / MP3 / WMA

Operating Instruction:

1. Self-reading after playing, LCD shows "——". flicker once simultaneously. It'll show "nod" if no disk or incompatible.
2. Show "OP" when turning on, show "——" then start to automatic play.
3. When read a CD, LCD will show the Song Sum and the style "CD" then automatic playing. If MP3/WMA, LCD will show the File Sum and the style "MP3", after a second show the Song Sum then automatic play.
4. Keystroke: Function Introduction:

PLAY/PAUSE Press this key to play while in stopping state / press this key to suspend while in playing

STOP Stopping Key. now LCD only shows the Song Sum and the Disk Style.

While PROG is playing, First time press "STOP" to stop playing, Second time press "STOP" to cancel PROG Songs.

NEXT Only Press is to next piece, while in a playing state, Long Press is to progress fast.

BACK Only Press is to last piece, while in a playing state. Long Press is to back off fast.

REPEAT 1. While CD's playing, Press this key:

Press once: enter the current single song repeated playing state

Press twice: enter the current whole disk repeated playing state.

Press 3 times: enter ten-minute browsing state.

6. DISC/USB/BT

Pressing this button, the function can shift among DISC, USB and BT.

7. PLAY/PAUSE

Pressing this button,function can shift between PLAY and PAUSE.

8. NEXT

Pressing this button,it will skip to next track.

9. BACK

Pressing this button,it will skip to previous track.

10. VOLUME +/-

Pressing button +/- will increase or reduce volume sound output.

11. MUTE

Pressing this button,all sound will disappear.

Pressing this button again,all sound will be recovered.

12. EQ

Pressing this button,you can choose and enjoy 3 different music modes.

13.FOLDER+/-

Pressing FOLDER +/- ,it will skip to tracks in next / previous file.

14.10+/-

Pressing 10 +/-,it will skip to the track of ten tracks increased/ decreased.

POWER SUPPLY: AC 120V/240V 60Hz/50Hz,
DC 12V (UM-1 "D" SIZE x 8)

BATTERY : 8 BATTERIES 12V (UM-1 "D" SIZE x 8)

MAX POWER CONSUMPTION : 33W

MAX CURRENT CONSUMPTION : 0.15A

POWER OUTPUT : 22W

FREQUENCY : FM 88 - 108MHz
AM 540 - 1600KHz

Cassettes

This unit is suitable for playing normal tapes, but high and metal position tapes will not be played to their full potential.

- 1 Switch [**FUNCTION**] to "TAPE/SELECT".
- 2 Press [**STOP/EJECT**] to open the deck and load a cassette.
Close deck by hand.
- 3 Press [**PLAY**] to start play.
Unit comes on and play starts.
- 4 Adjust the volume.

To stop play
Press [**STOP/EJECT**]. (Unit is switched off.)

To pause	Press [PAUSE] during playback. To resume, press [PAUSE].
To rewind/ fast-forward	Press [REW/REV] (to rewind) or [FF/CUE] (to fast-forward) in the stop mode.
To find a particular spot	Press [REW/REV] (to search backward) or [FF/CUE] (to search forward) during playback. Play is resumed when the button is released.

Note

- The unit is on in the pause mode. Stop tape to turn the unit off by pressing [**STOP/EJECT**] when leaving the unit.
- Do not press [**PLAY**] when rewinding or fast-forwarding. as this may jam the tape.
Be sure to press [**STOP/EJECT**] before the next operation.

Recording

You can record radio broadcasts or CDs.

Before recording

- This unit is suitable for recording normal tapes, but it cannot record onto high and metal position tapes to their full potential and prior recordings will not be erased correctly.
- The recording level is set automatically.
- **A** Take up the leader tape before proceeding.

Using headphones (not included)

A Turn down the volume and connect the headphones to the [**PHONES**] jack
Plug type: 3.5 mm stereo

Note

Avoid listening for prolonged periods of time to prevent hearing damage.

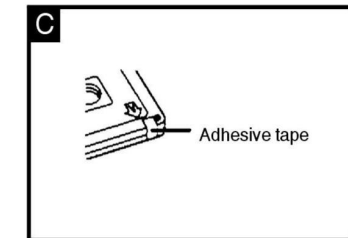
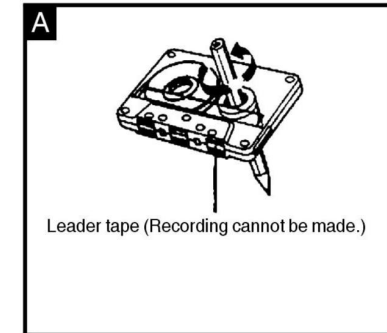

- 1 Press [**STOP/EJECT**] to open the deck and load a cassette. **(a)**
Close deck by hand.
- 2 Select the source to be recorded.
When recording radio broadcasts
Tune in the station.

Description of parts

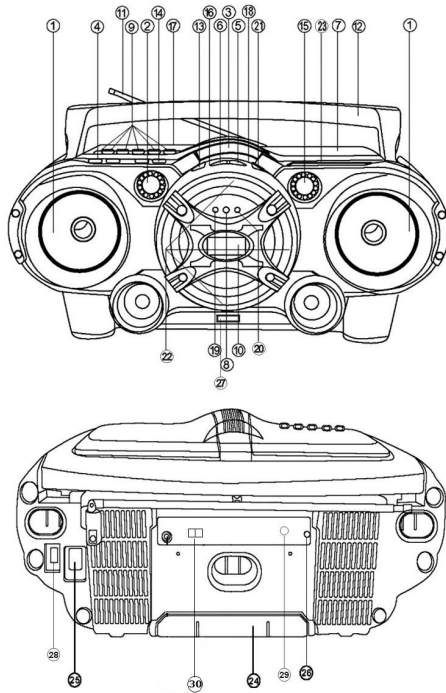

- | | |
|--------------------------------|-----------------------------|
| ① SPEAKER | ①⑦ DECK DOOR |
| ② VOLUME CONTROL | ①⑧ CD SKIP SEARCH BUTTON(+) |
| ③ BASS POWER DRIVE WOOFER | ①⑨ POWER LAMP |
| ④ FUNCTION SELECT SWITCH | ②⑩ FM STEREO LAMP |
| ⑤ CD PLAY/PAUSE | ②⑪ CD REPEAT |
| ⑥ CD STOP BUTTON | ②⑫ POWER DRIVE WOOFER LIGHT |
| ⑦ CD LID | ②⑬ DECORATIONS |
| ⑧ REMOTE CONTROL SIGNAL SENSOR | ②⑭ BATTERIES COVER |
| ⑨ CASSETTE RECORDER | ②⑮ AC IN |
| ⑩ LCD DISPLAY | ②⑯ EARPHONES JACK |
| ⑪ ROD ANTENNA | ②⑰ USB JACK |
| ⑫ HANDLE | ②⑱ VOLTAGE SELECTOR |
| ⑬ PROGRAMME | ②⑲ AUX/MP3-IN LINE |
| ⑭ RADIO BAND | ③⑰ DISCO LIGHT SWITCH |
| ⑮ TUNING BUTTON | |
| ⑯ CD SKIP SEARCH BUTTON(-) | |

FCC Statement:

This device complies with part 15 of the FCC Rules. Operation is subject to the following two conditions: (1) This device may not cause harmful interference, and (2) this device must accept any interference received, including interference that may cause undesired operation.

This equipment has been tested and found to comply with the limits for a Class B digital device, pursuant to part 15 of the FCC Rules.

These limits are designed to provide reasonable protection against harmful interference in a residential installation. This equipment generates uses and can radiate radio frequency energy and, if not installed and used in accordance with the instructions, may cause harmful interference to radio communications. However, there is no guarantee that interference will not occur in a particular installation. If this equipment does cause harmful interference to radio or television reception, which can be determined by turning the equipment off and on, the user is encouraged to try to correct the interference by one or more of the following measures:

- Reorient or relocate the receiving antenna.
- Increase the separation between the equipment and receiver.
- Connect the equipment into an outlet on a circuit different from that to which the receiver is connected.
- Consult the dealer or an experienced radio/TV technician for help.

Changes or modifications not expressly approved by the party responsible for compliance could void the user's authority to operate the equipment.