

Instruction Sheet

for Bearing Replacement Procedure

Kit Contains:

- 1 Tub Seal
- 1 Drive Shaft
- 1 Bearing, Top
- 1 Bearing, Bottom
- 1 Washer, Bottom Bearing
- 1 Shaft Nut
- 1 Tube of Adhesive - Pliobond
- 1 Tube of Grease
- 1 Spacer Tube
- 1 Instruction Sheet

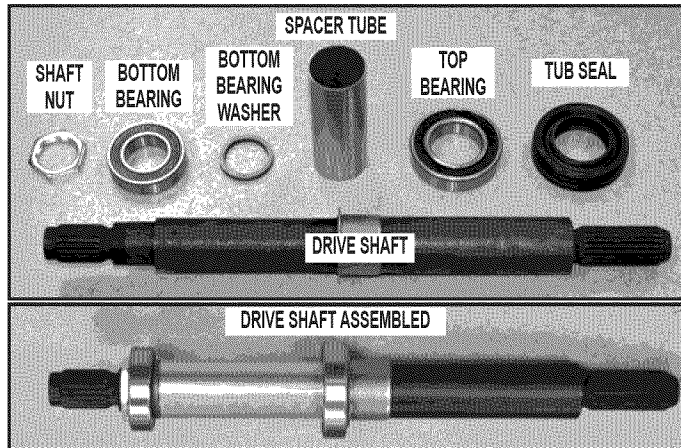

Tools Needed:

- Tub Press Tool Assembly (see diagram)
- Removal Rod (not shown)
- Seal Press Tool (not shown)
- 7/16" Wrench
- 1/4" Hex Driver
- Hammer

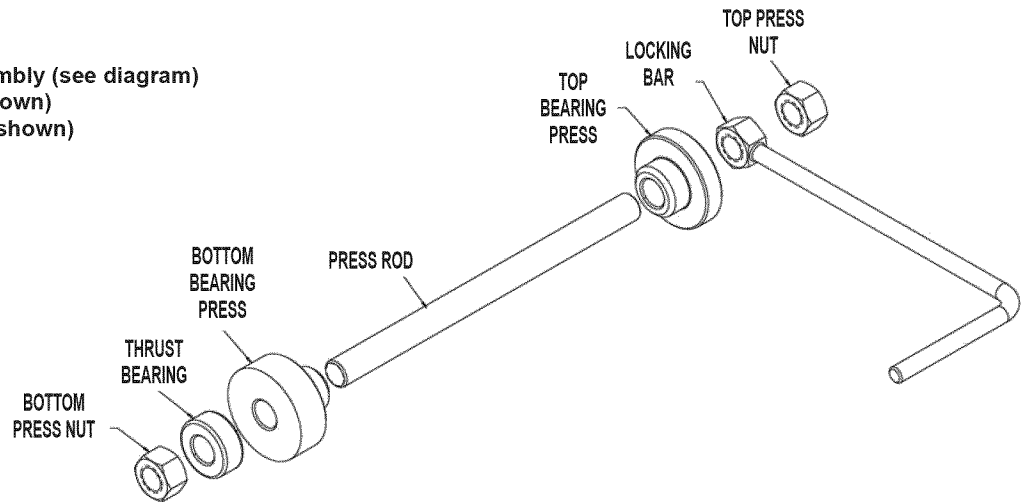

⚠ WARNING	
	<p style="text-align: center;">Electrical Shock Hazard</p> <p>Disconnect power before servicing.</p> <p>Replace all parts and panels before operating.</p> <p>Failure to do so can result in death or electrical shock.</p>

1. Unplug washer or disconnect power.
2. Tape lid shut before opening top. Open top. See *Figure 1*.

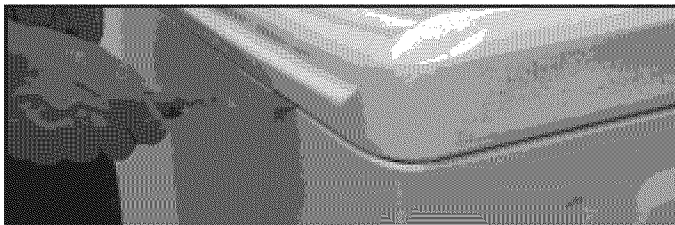

FIGURE 1

3. Remove hose clamp and hose from tub ring.
4. Remove tub ring.

5. Remove cap from either wash plate or agitator. See *Figure 2*.

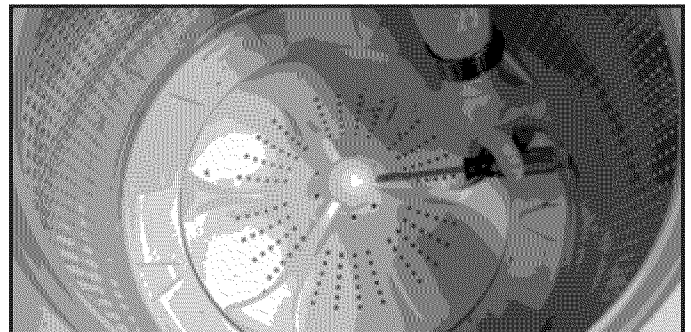

FIGURE 2

6. Remove 7/16" bolt. Lift and remove basket assembly with wash plate/agitator. See Figure 3.

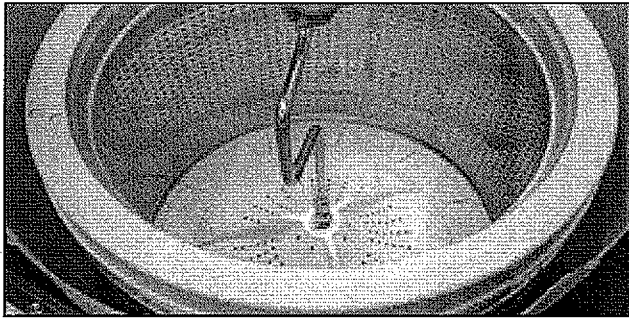

FIGURE 3

7. Slide washer out and tip back on hoses.
8. Using a 1/4" Hex Driver, remove rotor bolt and rotor. See Figure 4.

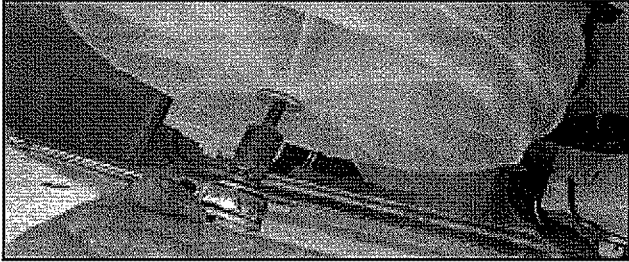

FIGURE 4

9. Remove four (4) stator bolts (5/16" or 3/8"). Unclip wire harness and remove stator. Set stator on a clean rag on the floor. See Figure 5.

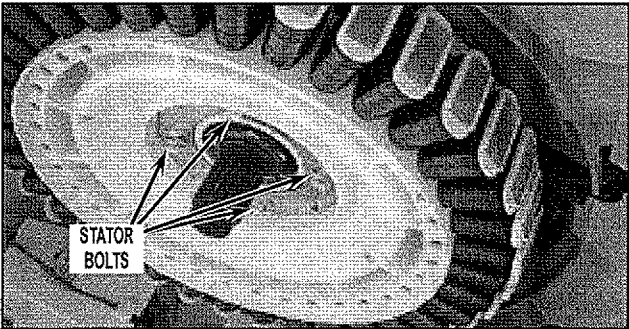

FIGURE 5

10. Remove Shaft Nut. See Figure 6.



FIGURE 6

11. Remove drive shaft and seal (with hammer). See Figure 7.

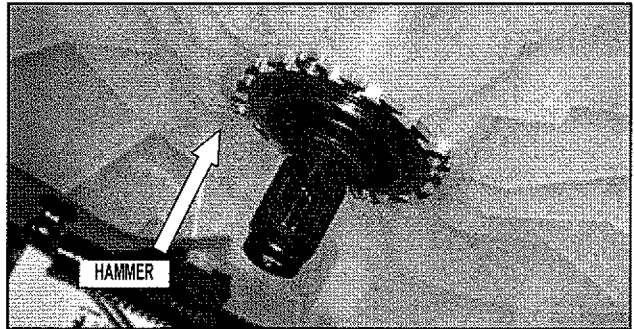

FIGURE 7

12. Tip washer forward off the hoses and remove drive shaft and seal from tub. See Figure 8.

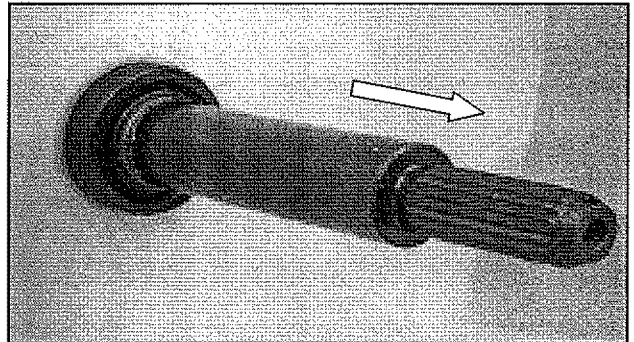

FIGURE 8

13. Drive Bottom Bearing, Bottom Bearing Washer and Spacer Tube out using Removal Rod and hammer. See Figure 9.

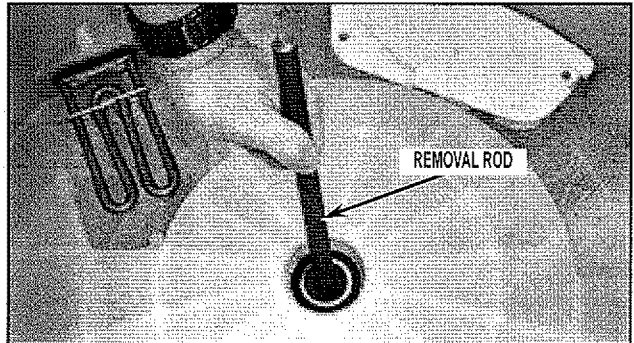

FIGURE 9

14. Tip washer back on hoses and drive Top Bearing out using Removal Rod and hammer. Discard all parts. See Figure 10.

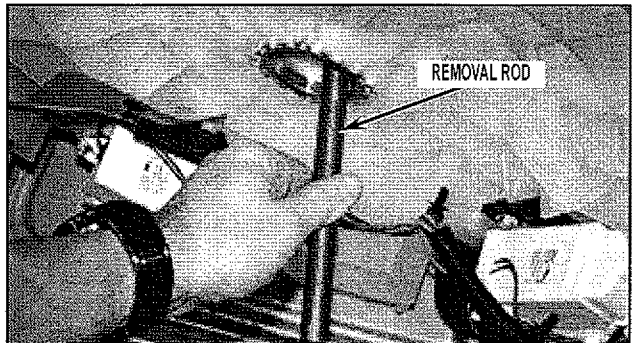

FIGURE 10

15. Tip washer forward off of hoses.

16. Clean bearing and seal areas with a rag. Check the weep hole (make sure it is not plugged). See *Figure 11*.

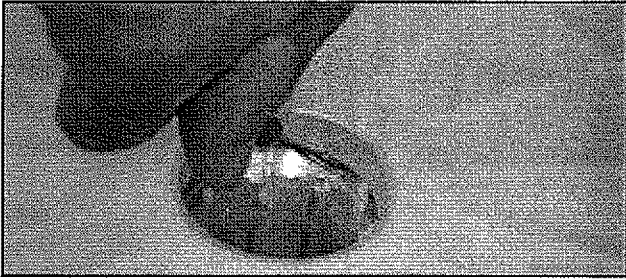

FIGURE 11

17. Install Top Bearing and press into the tub.
 18. Place Tub Press Tool Assembly (without the Bottom Bearing Press, Thrust Bearing, and Bottom Press Nut) over new Top Bearing.

NOTE: ENSURE TUB PRESS TOOL ASSEMBLY LOCKING BAR IS LOCATED IN THE SUMP AREA. See *Figure 12*.

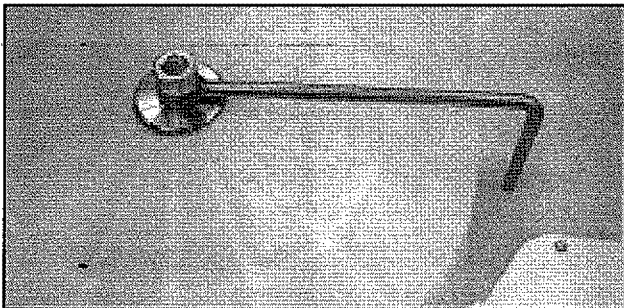

FIGURE 12

19. Tip washer back on hoses.
 20. Install onto Press Rod; new Spacer Tube, new Bottom Bearing Washer and Bottom Bearing. Then install tool parts; Bottom Bearing Press, Thrust Bearing and Bottom Press Nut. See *Figure 13*.

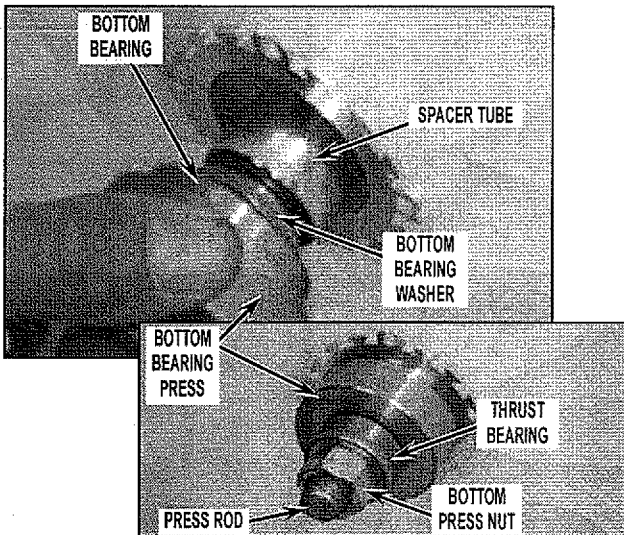

FIGURE 13

21. Tighten Bottom Press Nut until bearings bottom out. Then back the Bottom Press Nut off and remove. See *Figure 14*.

NOTE: Final position of Bottom Bearing will extend from bottom of tub by 1/8" to 3/16" (3 to 5mm).

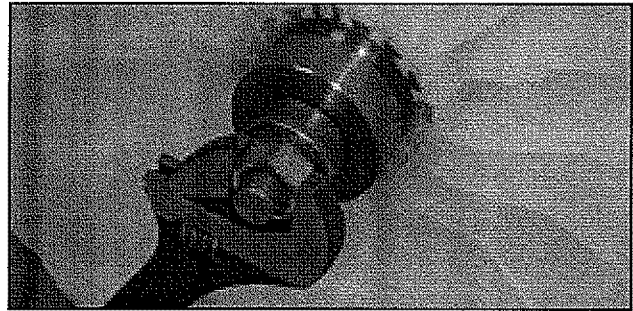

FIGURE 14

22. Tip washer forward off the hoses and remove Tub Press Tool Assembly.
 23. Install new Drive Shaft (make sure wear sleeve is bottomed out on Top Bearing). See *Figure 15*.

NOTE: If necessary, tap shaft with hammer to install.

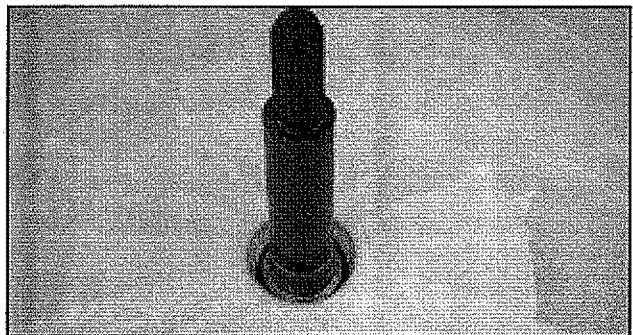

FIGURE 15

24. Tip washer back onto hoses. Install new Shaft Nut and tighten. See *Figure 16*.

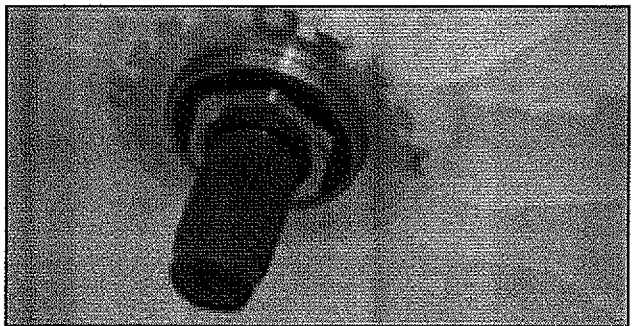

FIGURE 16

25. Reinstall stator.
 26. Reinstall rotor.
 27. Reinstall wiring harness and check for proper location.
 28. Tip washer forward off the hoses.

29. Locate Tub Seal and Grease. Apply grease to both cavities inside Tub Seal lip. See *Figure 17*.

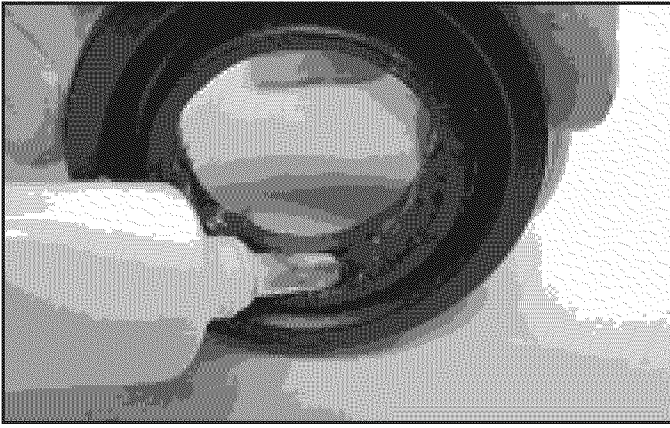

FIGURE 17

30. Apply the Pliobond Adhesive in a continuous bead around bottom of Tub Seal to enter tub first. Verify grease is inside the seal. See *Figure 18*.

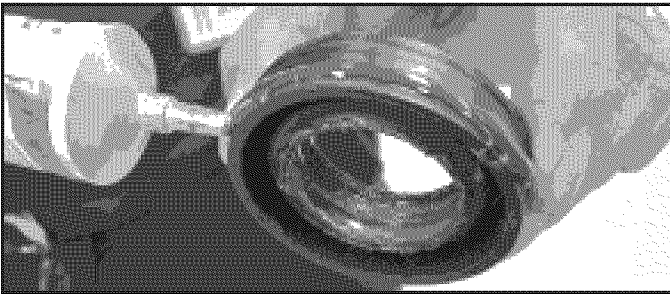

FIGURE 18

31. Newer versions of the seal have a spring around the inside. See *Figure 19*.

NOTE: When installing this seal, make sure the spring remains in place in the groove.

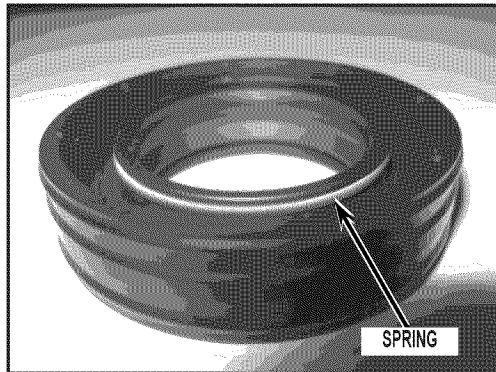

FIGURE 19

32. Push Tub Seal into place using the Seal Press Tool, and hammer until it bottoms out. Add a bead of Pliobond Adhesive to top edge of seal and tub (spread out with finger). See *Figure 20*.

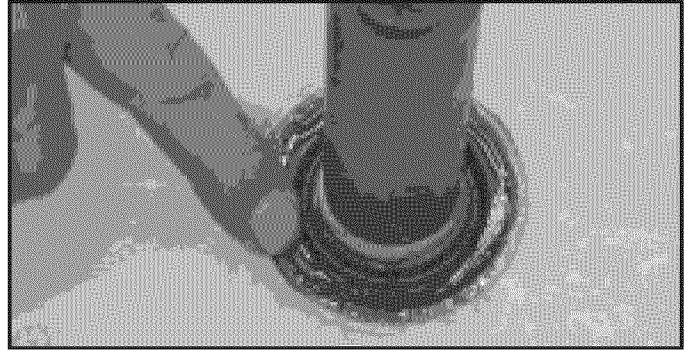

FIGURE 20

33. Reinstall basket.
34. Reinstall tub ring, hose, and hose clamp.
35. Close top.
36. Replace all parts and panels.

⚠ WARNING



Electrical Shock Hazard

Plug into a grounded 3 prong outlet.

Do not remove ground prong.

Do not use an adapter.

Do not use an extension cord.

Failure to follow these instructions can result in death, fire, or electrical shock.

37. Plug in washer or reconnect power.
38. Test washer with Diagnostic "C0" Test and Manual Spin Test.