

Specification Name : Quick Guide
Package : Sensor Pad box
Size : 210mm x 148mm; 4 pages
Method : Double side printing

 Grey 100%
 C 0 M 0 Y 0 K 70

White 100%
C O M O Y O K O

This device complies with Part 15 of the FCC Rules.
Operation is subject to the following two conditions:
(1) This device may not cause harmful interference.
(2) This device must accept any interference received,
including interference that may cause undesired operation.

NOTE: This equipment has been tested and found to comply with the limits for a Class B digital device, pursuant to Part 15 of the FCC Rules. These limits are designed to provide reasonable protection against harmful interference in a residential installation.

This equipment generates uses and can radiate radio frequency energy and, if not installed and used in accordance with the instructions, may cause harmful interference to radio communications. However, there is no guarantee that interference will not occur in a particular installation. If this equipment does cause harmful interference to radio or television reception, which can be determined by turning the equipment off and on, the user is encouraged to try to correct the interference by one or more of the following measures:

- Reorient or relocate the receiving antenna.
- Increase the separation between the equipment and receiver.
- Connect the equipment into an outlet on a circuit different from that to which the receiver is connected.
- Consult the dealer or an experienced radio/TV technician for help.

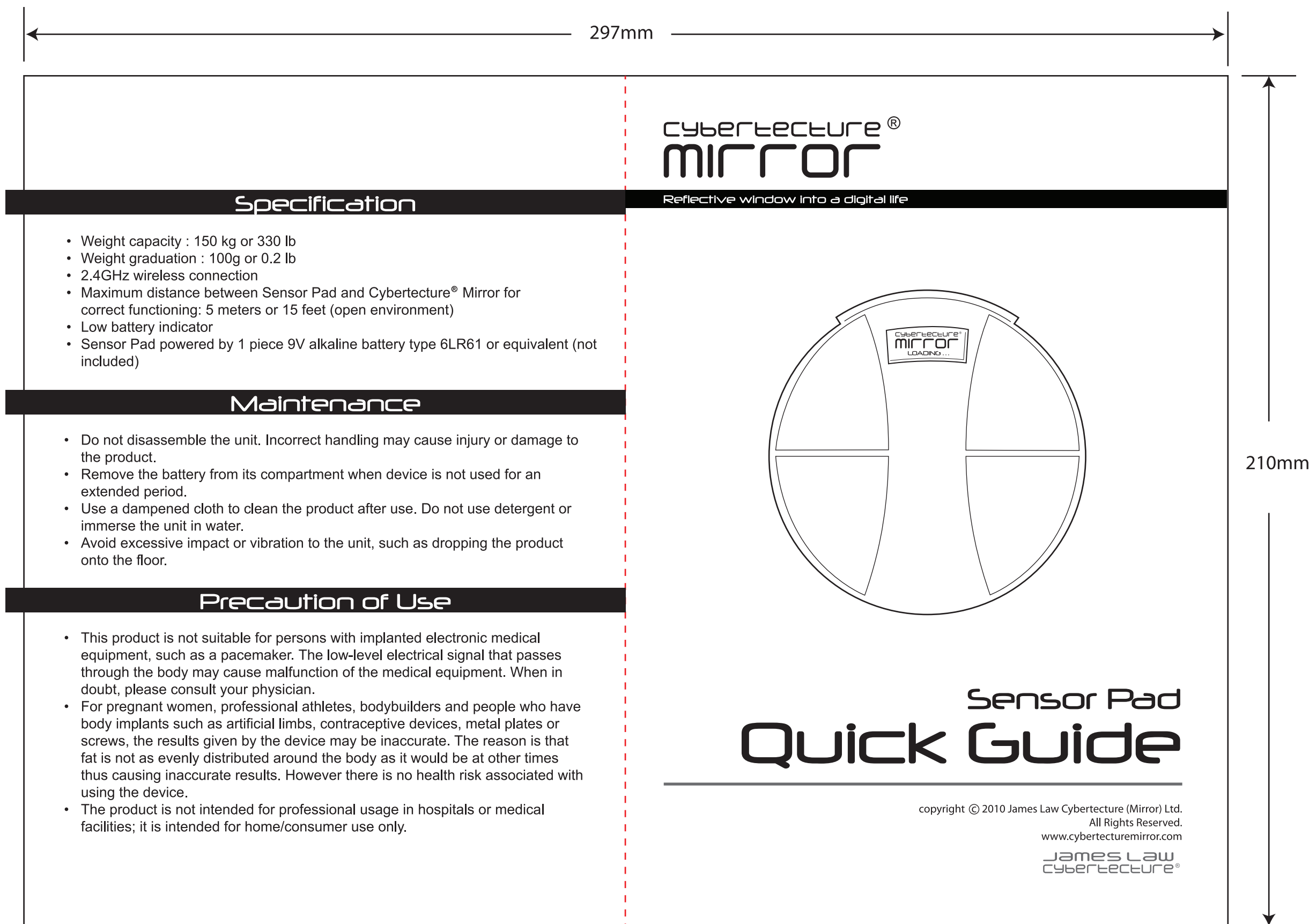

The diagrams illustrate the front and back views of the mFCP-2000 device. The front view shows a circular device with a central rectangular area labeled 'mFCP-2000' and 'LCD Display'. Four ITO Electrodes are indicated around the perimeter. The back view shows the internal components, including the Sync Button, Battery Compartment, and four Load Cells.

The diagram shows the Cyberecture Mirror logo, which is a black trapezoidal shape with white text. The text inside the shape reads "OVERLOAD ERROR" in a small, spaced-out font, followed by a square icon with a diagonal line. Below this is "Cybertecture" in a stylized font, and "mirror" in a large, bold, sans-serif font. At the bottom, it says "LOADING ...". Five numbered callouts point to specific parts of the logo: 1 points to the top left corner, 2 points to the top center, 3 points to the top right corner, 4 points to the bottom left corner, and 5 points to the bottom right corner.

1. Insert battery in the battery compartment.
2. Press the sync button on the back of the Sensor Pad and the respective button on the Cybertecture® Mirror (For details on how to operate Cybertecture® Mirror refer to the Cybertecture® Mirror User Manual).
3. Tap the Sensor Pad once. "LOADING" icon will turn on. **DO NOT** step on the Sensor Pad until the "LOADING" icon is turned off.

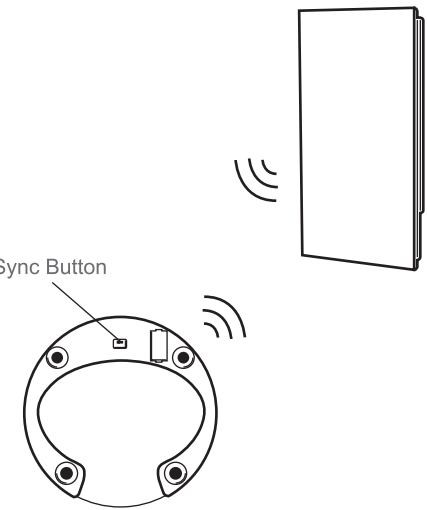

- To get accurate reading, place the Sensor Pad on a hard and flat surface. Stand still on the Sensor Pad until the “Cybertecture” Mirror” logo comes up.
- Stand with your bare feet on the platform in a way that will provide maximum contact with Sensor Pad platform. This ensures the best contact between your feet and the electrodes.

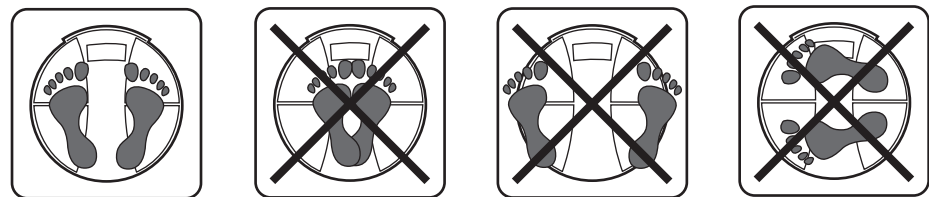

Email : support@cybertecturemirror.com
Tel : (852) 3925 9036
Address : 402 - 3 Innocentre, 72 Tat Chee Ave,
Kowloon Tong, Kowloon,
Hong Kong SAR