

# User's Guide



E7  
FCC ID:2AB5T-E7

# Contents

---

1. Introduction .....	2
2. Battery Precautions .....	3
3. Getting Started .....	4
4. Installation Operation .....	5
5. Cable Connection .....	6
6. Bluetooth Connection .....	6
7. NFC Connection .....	7
8. Function Guidance .....	8
9. LED Display Status .....	8
10. Battery Charging .....	9
11. Product care .....	9

Please read the following safety warnings and precaution before using your device.

# Specification

## E7

Load impedance:	32Ω
S/N:	≥90dB
Frequency range:	22Hz-20KHz
Power supply:	Lithium battery or USB cable
Audio source:	iPhone, iPad, Smartphone, Notebook, MP3, MP4, etc
Function spec:	Bluetooth, Microphone, Active Noise Cancelling
Size:	166x92x181mm

Operating range up to 20 meters.

## 1. Introduction

---

Thank you for purchasing our Active Noise Cancelling Bluetooth headphone: E7. This device can be easily connected with Smartphone, tablet PC and other devices via Bluetooth during your traveling and daily usage. It will bring you an easy lifestyle.

## 2. Battery Precautions

---

The device can be powered by a built-in rechargeable lithium battery. Please charge the battery for at least 8 hours before your first use of device.

- If the device is not used for a long period of time, the battery may be out of power. Please charge the battery.
- Rechargeable batteries are only to be charged under adult supervision.
- Use only the supplied micro USB cable to recharge the battery. Improper charging may damage the battery and the device.
- Do not attempt to open the rechargeable battery or battery pack. There are no serviceable parts inside.
- Should a battery leak, the device may become damaged. Clean the battery compartment immediately, avoid touching your skin.
- Keep the battery out of reach of children. If swallowed, consult a physician immediately.
- Avoid storing the battery in extremely hot or cold environment. A device with a hot or cold battery may not work temporarily, even when the battery is fully charged.
- Do not dispose batteries in a fire as they may explode. Batteries may also explode if damaged. Please dispose them according to local regulation. Do not dispose them as household waste.

### 3. Getting Started

---

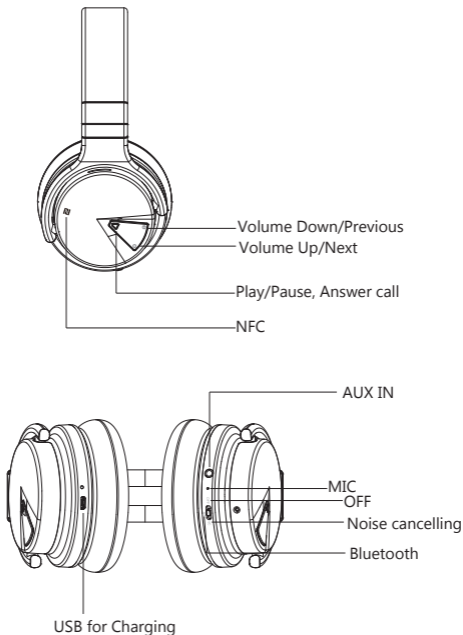

## 4. Installation Operation

---

### Step . 1

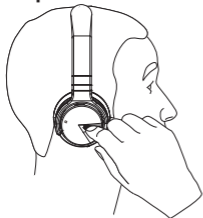

put on this headphone

### Step . 2



Adjustable length

### Step . 3



Adjustable angle

It can be adjusted To be fit by twisting the left and right ear muffs.

## 5. Cable Connection

---

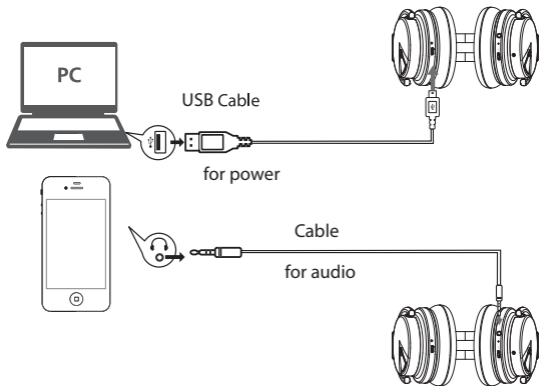

## 6. Bluetooth Connection

---

Pairing headphone to your Smart device (Smart device should be within 10 meters of this headphone).

1. Activate pairing mode on headphone by turn the switch to "BT" .The LED will flash in blue.
2. Turn on Bluetooth function of your device, (refer to the device owner's manual to locate Bluetooth function).
3. Select "Search" or "Discover" devices.
4. Select "E7".
5. If requested, type the password or PIN 0000
6. Press the Enter key.

After completing the steps above, a message on your Smart device will appear confirming that your device is now paired/ connected.

In case of unsuccessful pairing, turn off it and restart, then do as steps above.

If the Bluetooth on your smart device remains open, when you restart the headphone, the Bluetooth will be connected automatically.

## 7. NFC Connection

---



NFC: Near Field Communication, is a set of standard for wireless devices to establish radio communication with each other by touching them together or bringing them into close proximity, usually within a few centimeters.



Please activate the NFC function of your smart device and put the device close to the Bluetooth headphone.

Your smart device will ask you if you want to pair with the headphone, choose Yes or OK to complete the pairing process.



## 8. Function Guidance

### Play music from your Smart device

Button	Operation	Function
	Long Press	Volume up
	Short Press	Next song
	Long Press	Volume down
	Short Press	Previous song
	Short Press	Play/Pause, Answer/End a call.
	Long press	Ready for pairing

## 9. LED Display Status

	LED Display		Light indication
	Right Light	Blue	Flash
Stay Solid			Paired
White		Noise cancelling	
Left Light	Red	Charging in process	
	OFF	Fully charged	

## **10. Battery Charging**

---

The device has a rechargeable battery. This can be charged by USB cable connected with your computer. When it's charging, the light below the left button will turn to red.

After charged, the device can be used without the power connection. Charge the device again when you hear the headphone make successive beep sound.

## **11. Product care**

---

This device is designed to be light, compact and durable. As an electronic device it must be treated carefully. Putting unnecessary pressure on it or striking the device against other objects may cause damage. To avoid damage to your device, please

- Do not drop, crush, bend or apply excessive force to the device.
- Do not expose your device to moisture, extreme or prolonged heat, cold, humidity, or other adverse conditions. Avoid storing it in damp, humid or wet places, as it is not waterproof.
- Clean the unit with a soft cloth or damp chamois leather. Never use solvents.
- The Unit can only be opened by qualified personnel.
- This device contains magnets. Keep magnetic field sensitive products such as credit cards and video screen away from this device to avoid damage or malfunction.

NOTE: This equipment has been tested and found to comply with the limits for a Class B digital device, pursuant to part 15 of the FCC Rules. These limits are designed to provide reasonable protection against harmful interference in a residential installation. This equipment generates, uses and can radiate radio frequency energy and, if not installed and used in accordance with the instructions, may cause harmful interference to radio communications. However, there is no guarantee that interference will not occur in a particular installation. If this equipment does cause harmful interference to radio or television reception, which can be determined by turning the equipment off and on, the user is encouraged to try to correct the interference by one or more of the following measures:

- Reorient or relocate the receiving antenna.
- Increase the separation between the equipment and receiver.
- Connect the equipment into an outlet on a circuit different from that to which the receiver is connected.
- Consult the dealer or an experienced radio/TV technician for help.

This device complies with part 15 of the FCC rules. Operation is subject to the following two conditions:

- (1) this device may not cause harmful interference, and
- (2) this device must accept any interference received, including interference that may cause undesired operation.

Changes or modifications to this unit not expressly approved by the party responsible for compliance could void the user's authority to operate the equipment.