

User's Guide

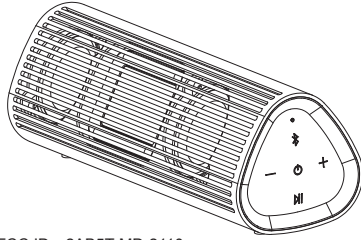

MD-2110 BT Speaker



FCC ID : 2AB5T-MD-2110



Specification

MD-2110

Output Power: 10 W
 SN: >75dB
 Frequency range: 70Hz-20KHz
 Power supply: Lithium battery or USB cable
 Audio source: iPhone, iPad, Smartphone, Notebook, MP3, MP4, etc
 Function spec: Bluetooth, Microphone, Line-in
 Size: 180mm x 59.0mm x 59.0mm

1. Introduction

Thank you for purchasing MD-2110 This device can be easily connected with audio or video devices for your daily needs. The MD-2110 speaker supports both Bluetooth and Aux-in function.

2. Battery Precautions

The device is power by a built-in rechargeable lithium battery. Please charge the battery at least 8 hours before your first use of device.

- If the device is not used for a long period of time, the battery may be out of power. please charge the battery.
- Rechargeable batteries are only to be charged under adult supervision.
- Do not attempt to open the rechargeable battery or battery pack. There are no serviceable parts inside.
- Should a battery leak, the device may become damaged. Clean the battery compartment immediately, avoiding contact with your skin.
- Keep the battery out of reach of children. If swallowed, consult a physician immediately.
- Avoid storing the battery in extremely hot or cold environment. A device with a hot or cold battery may not work temporarily, even when the battery is fully charged.

3. Getting Started

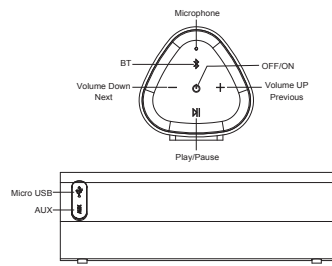

4. Cable Connection

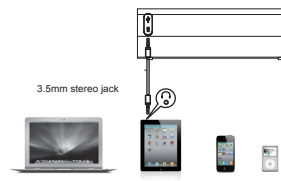

5. Bluetooth Connection

Pairing MD-2110 to your device (device should be within 10 meters of your speaker)

1. Activate pairing mode on MD-2110 by pressing "ON/OFF" button. After prompt voice, the device is in pairing mode and can be searched.
 2. Navigate to the Bluetooth function (refer to the tablet owner's manual to locate Bluetooth function).
 3. Select "Set Up" Bluetooth or turn "ON" Bluetooth.
 4. Select "Search" or "Discover" devices.
 5. Select "MD-2110"
 6. If requested, type the password or PIN 0000
 7. Press the enter key.
- After completing the steps above, a message on your device will appear confirming that your device is now paired/connected. In case of unsuccessful pairing, turn off the speaker by long pressing "ON/OFF" button and restart it. If you turn off the device, but the Bluetooth on your device remains open, when you restart the device, the Bluetooth will be connected automatically.

Notice:

1. If you turn off the device, but the Bluetooth on your device remains open, when you restart the device, the Bluetooth will be connected automatically.
2. When your smartphone and this speaker are apart beyond bluetooth receiving range, after 10 minutes, this speaker will disconnect with your smartphone and turn into pairing mode. If within 10 minutes your smartphone is back, will connect with this speaker automatically.

正面

6. Microphone Usage

When a phone call comes in, you could talk through the microphone on speaker.

Tips:
 When you make a call from your mobile phone the call will (subject to phone settings) automatically transfer to your MD-2110.

7. Charging and LED Indicator Light

Built-in lithium battery, can be charged through micro USB cable, see below picture:

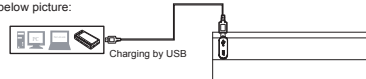

The indicator light status display as below:

	LED Display	Light Indication
Green	Flash slow	Ready to pair
Light	Stay solid	Paired
Red	Flash fast	Low battery
Light	Stay solid	Charging in process
	OFF	Fully charged

8. Reset Instruction

Resetting your MD-2110
 To reset the MD-2110 insert either a toothpick or straightened paper clip into the AUX IN jack until it makes contact with the micro switch. Gently push and release the switch and the speaker will reset.

9. FAQ&Customer Support

For assistance with questions or any issue with your MD-2110 that is not answered in the troubleshooting tips below, please contact us via email: meidong2006@gmail.com

- 1- MD-2110 will not turn on
 .The battery may have become fully drained. Charge the MD-2110 using a USB wall charger from a smartphone/iPhone or table for at least 15 minutes, then press the power button to turn the speaker on. Then continue charging the battery.
 .Reset the MD-2110, follow the reset instructions 8.
- 2- Cannot pair or connect to the MD-2110
 .Check that your MD-2110 has a sufficient battery charge, the speaker may not connect when the battery has a low charge.
 Connect the speaker to a charging source and try again to pair and connect.
 .Your source device may be out of range. Move it closer to within 30 unobstructed feet of your speaker.
 .Check the bluetooth LED light to make sure it is flashing. If it is solid blue that MD-2110 is already connected to another device. The MD-2110 can be connected to one device at a time. You need to disconnect the connected device then you can connect to the next device.
 .Your device may have a temporary bluetooth connection issue please try the following steps which can resolve this:
 For iPhone, iPad, iPod, smartphone and tablets
 .Turn off the MD-2110 speaker, go to the bluetooth device list on your iPhone, iPad or iPod, smartphone or table and check if the MD-2110 is listed. If it listed press the bluetooth icon and then press unpair this device. With the MD-2110 unpaired or if it was not listed, do a hard restart on your smartphone or tablet. When it restarts turn on the MD-2110 and then try again to pair and connect. Please see instructions 5.

For Apple Mac

.Please go to the bluetooth device list and if the MD-2110 is listed please remove it. With the MD-2110 removed or if was not listed, restart your Apple Mac and try again to pair and connect.
 For windows systems
 .Please go to the bluetooth device list and if the MD-2110 is listed please remove it. With the MD-2110 removed or if was not listed, restart your Apple Mac and try again to pair and connect.
 .If your windows system displays an error message requesting a driver. You need to update your computer's bluetooth driver. The MD-2110 does not require a special driver itself and there is no driver for it. Go to the support site for your system manufacture and specific model and select the bluetooth driver. Download and install the bluetooth driver, restart your system and try again to pair and connect to your MD-2110 speaker.

3-No audio playing from the MD-2110 when connect over bluetooth
 .Reset the MD-2110, follow the reset instruction 8.
 .Remove the MD-2110 from the bluetooth device list on your device, restart your device, and then re-pair and connect to the speaker.
 .Make sure the volume is up on your MD-2110 and your device.
 .Make sure your bluetooth device is playing audio, and is not paused and volume is up.
 .Your bluetooth device may be out of range, move closer within 30 unobstructed feet.
 Turn your MD-2110 off and back on.
 Some apps have their own volume setting. Please check the app to make sure the volume is not on mute and the volume is up.

4-Poor sound quality when connect over bluetooth
 .Your bluetooth device may be out of range, move closer within 30 unobstructed feet.
 .Remove the MD-2110 from the bluetooth device list on your source device, restart your source device, and then re-pair and connect to the speaker.

- .Turn your MD-2110 off and back on.
- .Some devices need to have their WIFI turned off to improve audio quality over bluetooth.
- 5-No audio playing from the MD-2110 when connected with the 3.5mm audio cable
 .Make sure the 3.5mm audio cable is fully inserted into the MD-2110 and device. Some devices have cases that prevent a proper fit and need to be removed to connect. Make sure your device is on and playing and music.
 .Increase the volume level on the MD-2110 and the device.
- 6-Poor sound quality when connected with the 3.5mm audio cable
 .Reduce the volume level on the AUX source.
 .Remove the charging cable while playing.
- 7-No response when pressing any button or speaker will not turn off
 .Reset the MD-2110, follow the reset instructions 8.

Service and Support

If your device is not performing as it should, please contact us at meidong2006@gmail.com

NOTE: This equipment has been tested and found to comply with the limits for a Class B digital device, pursuant to part 15 of the FCC Rules. These limits are designed to provide reasonable protection against harmful interference in a residential installation. This equipment generates uses and can radiate radio frequency energy and, if not installed and used in accordance with the instructions, may cause harmful interference to radio communications. However, there is no guarantee that interference will not occur in a particular installation. If this equipment does cause harmful interference to radio or television reception, which can be determined by turning the equipment off and on, the user is encouraged to try to correct the interference by one or more of the following measures:

- Reorient or relocate the receiving antenna.
- Increase the separation between the equipment and receiver.
- Connect the equipment into an outlet on a circuit different from that to which the receiver is connected.
- Consult the dealer or an experienced radio/TV technician for help

Changes or modifications not expressly approved by the party responsible for compliance could void the user's authority to operate the equipment. This device complies with Part 15 of the FCC Rules. Operation is subject to the following two conditions:
 (1) this device may not cause harmful interference, and
 (2) this device must accept any interference received, including interference that may cause undesired operation.