

User's Guide



FCC ID: 2AB5T-QCHOCOLATE



ROHS



Contents

1. Introduction	2
2. Battery Precautions	3
3. Getting Started	4
4. Cable Connection	4
5. Bluetooth Connection	5
6. NFC Connection	6
7. Microphone Usage	6
8. Charging And LED Indicator Light	7
9. Product Care	7

Please read the following safety warnings and precautions before using your device.

Specification

Qchocolate

Output Power: 8W

S/N: >75dB

Frequency range: 60Hz-20KHz

Power supply: Lithium battery or USB cable

Audio source: iPhone, iPad, Smartphone, Notebook, MP3, MP4, etc

Function spec: Bluetooth, Microphone, Line-in

Size: 145.0mm x 45.0mm x 55.0mm

Rechargeable battery with charging option from USB cable

Operating range up to 10 meters

1. Introduction

Thank you for purchasing Qchocolate. This device can be easily connected with audio or video devices for your daily needs. The QChocolate speaker supports both Bluetooth and Aux-in function.

2. Battery Precautions ---

The device is powered by a built-in rechargeable lithium battery. Please charge the battery at least 8 hours before your first use of device.

- If the device is not used for a long period of time, the battery may be out of power. please charge the battery.
- Rechargeable batteries are only to be charged under adult supervision.
- Do not attempt to open the rechargeable battery or battery pack. There are no serviceable parts inside.
- Should a battery leak, the device may become damaged. Clean the battery compartment immediately, avoiding contact with your skin.
- Keep the battery out of reach of children. If swallowed, consult a physician immediately.
- Avoid storing the battery in extremely hot or cold environment. A device with a hot or cold battery may not work temporarily, even when the battery is fully charged.

3. Getting Started

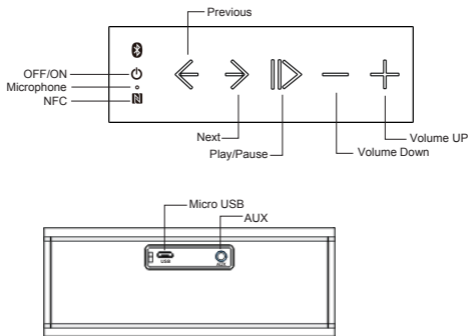

4. Cable Connection



5. Bluetooth Connection

Pairing Qchocolate to your device (device should be within 10 meters of your speaker)

1. Activate pairing mode on Qchocolate by pressing “ON/OFF” button.
After prompt voice, the device is in pairing mode and can be searched.
2. Navigate to the Bluetooth function (refer to the tablet owner’s manual to locate Bluetooth function).
3. Select “Set Up” Bluetooth or turn “ON” Bluetooth.
4. Select “Search” or “Discover” devices.
5. Select “Qchocolate”
6. If requested, type the password or PIN 0000
7. Press the enter key.

After completing the steps above, a message on your device will appear confirming that your device is now paired/connected.

In case of unsuccessful pairing, turn off the speaker by long pressing “ON/OFF” button and restart it.

If you turn off the device, but the Bluetooth on your device remains open, when you restart the device, the Bluetooth will be connected automatically.

Notice:

1. If you turn off the device, but the Bluetooth on your device remains open, when you restart the device, the Bluetooth will be connected automatically.
2. When your smartphone and this speaker are apart beyond bluetooth receiving range, after 10 minutes, this speaker will disconnect with your smartphone and turn into pairing mode. If within 10 minutes your smartphone is back, will connect with this speaker automatically.

6. NFC Connection

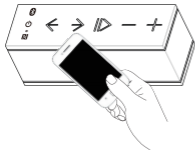

NFC: Near Field Communication, is a set of standard for smartphone and this speaker to establish Bluetooth radio communication with each other by touching them together or bringing them into close proximity, usually no more than a few centimeters.

Please activate the NFC function (subjects to

device own setting) function of your Bluetooth device. Bring your Bluetooth device close to speaker, as above picture.

Bluetooth device will ask you whether you want to pair the speaker, confirm by “Yes” or “OK”, then the pairing process is completed.

7. Microphone Usage

When a phone call comes in, you could talk through the microphone on speaker.

Tips:

When you make a call from your mobile phone the call will (subject to phone settings) automatically transfer to your QChocolate.

8. Charging and LED Indicator Light _____

Built-in lithium battery, can be charged through micro USB cable, see below picture:

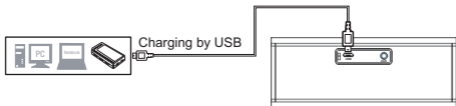

The indicator light status display as below:

	LED Display	Light Indication
Green Light	Flash slow	Ready to pair
	Stay solid	Paired
Red Light	Flash fast	Low battery
	Stay solid	Charging in process
	OFF	Fully charged

9. Product Care _____

Your device is designed to be heavy and durable. As an electronic device, it must be treated carefully. Putting unnecessary pressure on it or striking the device against other objects may cause damage.

- Do not drop, crush, bend or apply excessive force to the device.
- Clean the unit with a soft cloth or damp chamois leather. Never use solvents.
- The unit can only be opened by qualified person.
- This device contains magnets. Keep magnetic field sensitive products such as credit cards and video screen away from this device to avoid damage or malfunction.

NOTE: This equipment has been tested and found to comply with the limits for a Class B digital device, pursuant to part 15 of the FCC Rules. These limits are designed to provide reasonable protection against harmful interference in a residential installation. This equipment generates uses and can radiate radio frequency energy and, if not installed and used in accordance with the instructions, may cause harmful interference to radio communications. However, there is no guarantee that interference will not occur in a particular installation. If this equipment does cause harmful interference to radio or television reception, which can be determined by turning the equipment off and on, the user is encouraged to try to correct the interference by one or more of the following measures:

- Reorient or relocate the receiving antenna.
- Increase the separation between the equipment and receiver.
- Connect the equipment into an outlet on a circuit different from that to which the receiver is connected.
- Consult the dealer or an experienced radio/TV technician for help

Changes or modifications not expressly approved by the party responsible for compliance

could void the user's authority to operate the equipment. This device complies with Part

15 of the FCC Rules. Operation is subject to the following two conditions:

- (1) this device may not cause harmful interference, and
- (2) this device must accept any interference received, including interference that may cause undesired operation.

