

Super-express Radio Control Missile Launcher

MSD2003

Operation Manual

(Please read this manual carefully before operation)

Meisida Electronic Toys Co.Ltd

Add: No.1 of the 8th Block of Anping Development Zone, Anhai, Jinjiang, FuJian,China.

Tel: 0595-5788889 Zip Code: 362261 Cable: 4388

Executing Standards: GB6675-86, GB5296.5-1996

Suitable Ages: Over 6

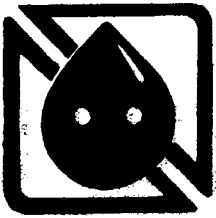

Warnings!

1. How to use the charger
 - The plug shall be pulled off immediately in case of smoke, strange smell or noise so as to prevent fire or electric shock. And it shall be available again after repair.
2. How to use the charger
 - Use the battery in strict accordance with the regulations in this manual.
3. Abstain from using any self-made bullets or hard plastic bullets without spongy package
4. Abstain from shooting at any person.

Cautions!

1. How to use the charger
 - Do not touch the plug or socket with wet hand to avoid electric shock.
 - Pull the plug upon completing the charger for the risk of fire.
2. How to use the battery
(Improper use of battery may lead to dangers such as heat, breakage or leakage. Note the following items)
 - Strictly observe the methods and cautions of the operation manual.
 - Avoid short circuit as it may lead to great currents.
 - Leakage from the battery may hurt skin. Cleanse the skin when contaminated
 - Do not drop the battery into water or fire or even dissolve the battery
 - Keep off fire, heat, and wet places for operation, charging or storage.
 - No more charging upon completion. Overcharging may be hazardous.
 - Make sure to install the positive and negative poles correctly.
 - Switch off upon the end of play and take out the battery of the car.

Cautions!

3. Cautions in play:

(Please note the following Items for the sake of avoiding accidents)

- Play on roads or crowded places may be risky, choose a safe outdoor place for operation.
- Do not distort the antenna or the twist may injure people.
- Do not damage glass or furniture when play indoors.
- Avoid the risk of finger or hair's being involved when the wheel is in operation.
- Turn on the car before turning on the remote controller, while do this in an opposite way at the end of the play.

4. Rules for play:

- Do not run the toy car on rainy day or wet surface, this shall lead to breakdown of the car.
- Avoid operation on soil or fine sand.
- Do not keep the car near to the high-temperature place.
- Do not store the car in heating room or places next to fire.
- Do not play near some wireless transmission facilities.
- Do not play next to some remote control car of the same frequency so as to avoid interference.
- Changes or modifications not expressly approved by the party responsible for compliance could void the user's authority to operate the equipment.

Charging Ways of the Battery

1. Join the plug of the battery with that of the charger correctly. See illustration.
2. Turn the adjustment switch for the voltage of the charger to the zero point of 9.6v.
3. Turn the adjustment switch for the speed of the charger to zero points of QUICK or STANDARD (QUICK for speedy charging that involves a period of 3-4 hours; STANDARD for normal charging that involves a duration of 10-12 hours.)
4. Insert the plug of the charger into a household power socket.
5. After a designated time for charging, pull off the charger and plug of the battery.

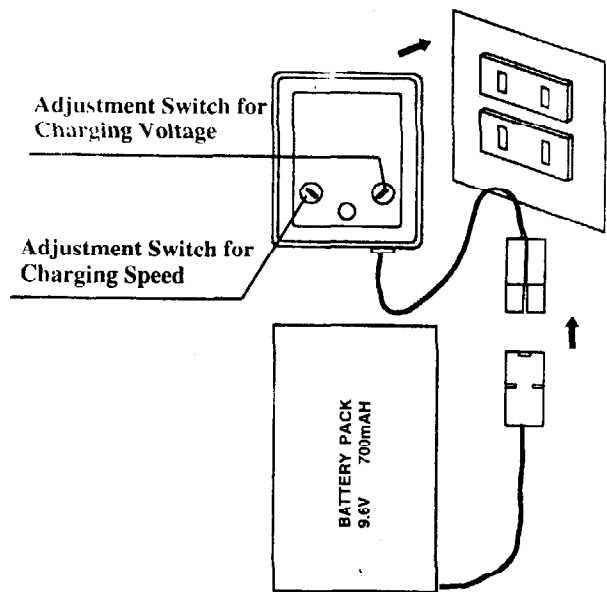

Names of Parts

9.6v Battery Pack

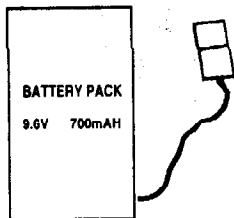

9.0v Laminated Battery

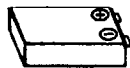

Main Body of the Car

9.6v Charger

INPUT: AC Household.voltage 50HZ
OUTPUT: DC 4.8,6,7.2,8.4,9.6V

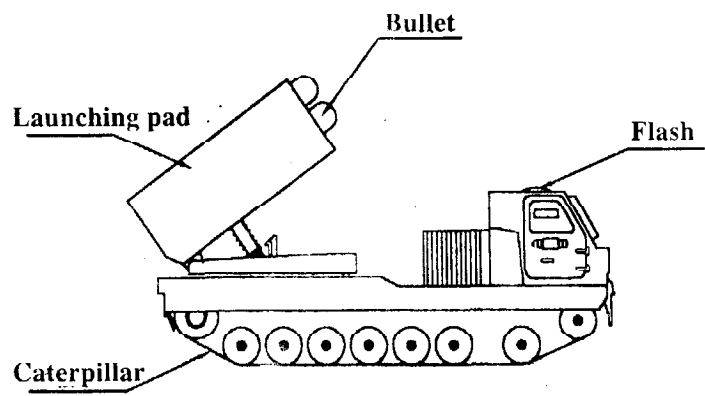
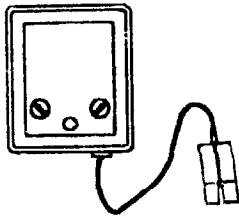

Remdote Controller

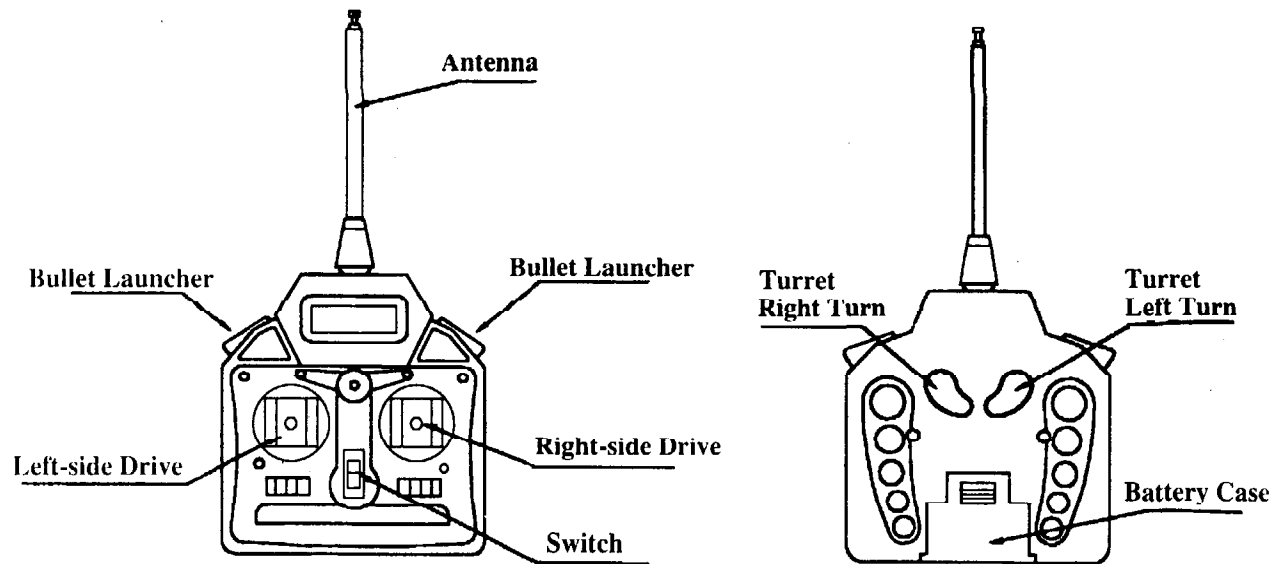

Loading Bullets

1. Take spongy bullets and insert them into the bullet hole and rotate the bullets;
2. If the bullets fail to rotate, press the head of the bullet downward. On hearing " crack ", the bullet is well loaded.
3. If there is difficulty in loading any of the bullets,do not force the bullet in .Press the shooting button on the remote controller and reload the bullet. If it is still hard to load the bullets, repeat to press the shooting button until the bullets can be loaded again.

Cautions:

- When loading,avoid pointing at any human.
Do not point at yourself or any other people.
- The spongy bullet will distort under force and become dangerous as the sponge falls off.
- Take the bullets out from the launching rack at the end of the play.
- Abstain from using any naked bullet without spongy package

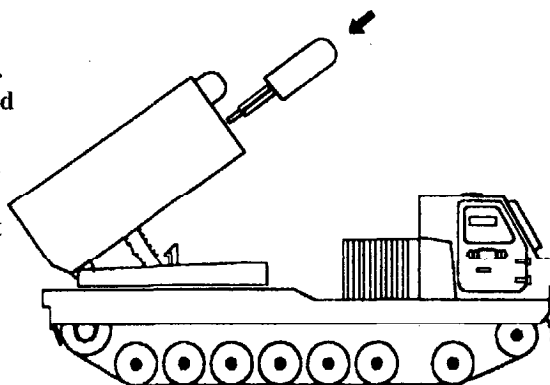

1. Open the battery cover on the back of the remote controller and install 9v laminated battery after checking the positive and negative poles. See the illustration.
2. Cover the battery.
3. When the switch is "ON", the indicator lights up to show that you have installed the battery correctly. Otherwise, follow the above steps to install again.
 - The duration for continuous operation of the remote controller is 8 hours.

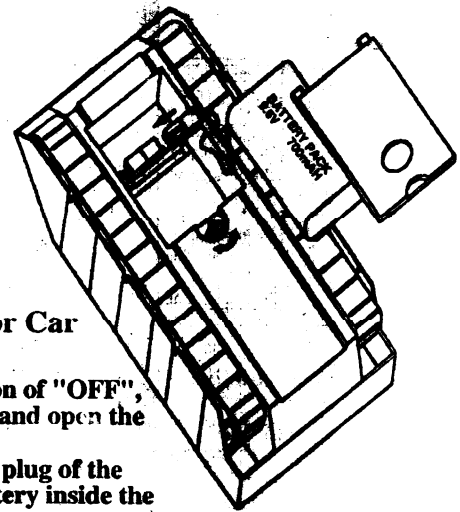

Loading & Unloading of the Battery for Car

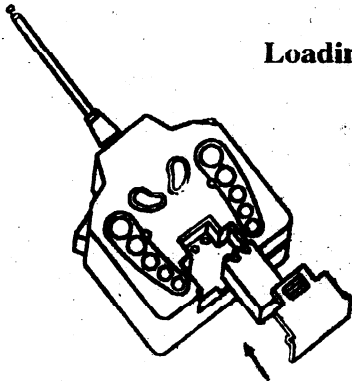

1. Confirm that switch is at the position of "OFF", turn loose the lock of battery cover and open the battery cover.
 2. Join the plug of the battery and the plug of the power supply of the car, put the battery inside the battery case.
 3. Cover the battery case and fasten the lock to close the cover.
- *Deceleration of the car may be caused by low battery. Recharge the battery. The duration for continuous use of fully charged battery is 20 minutes. It may differ according to different road conditions and moving states.

Operation Methods

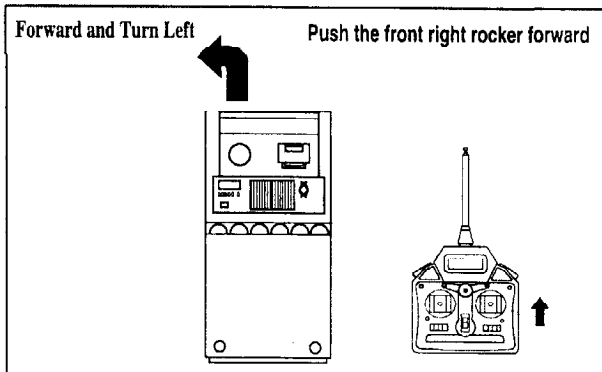
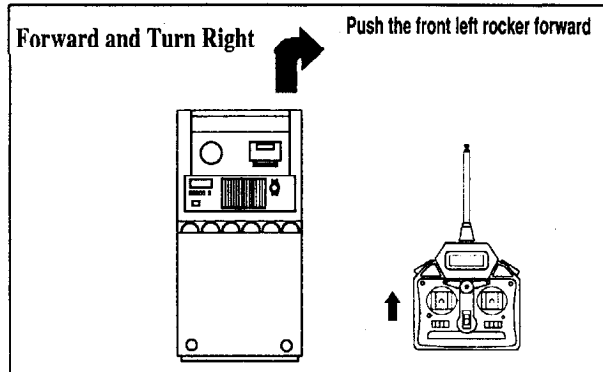
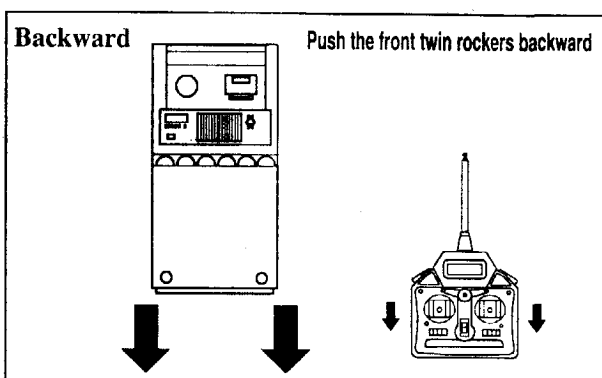
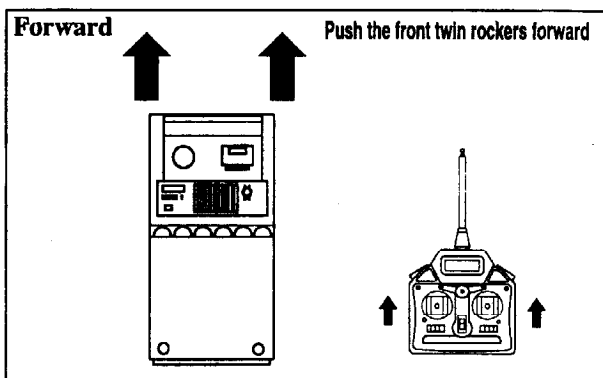

Operation Methods

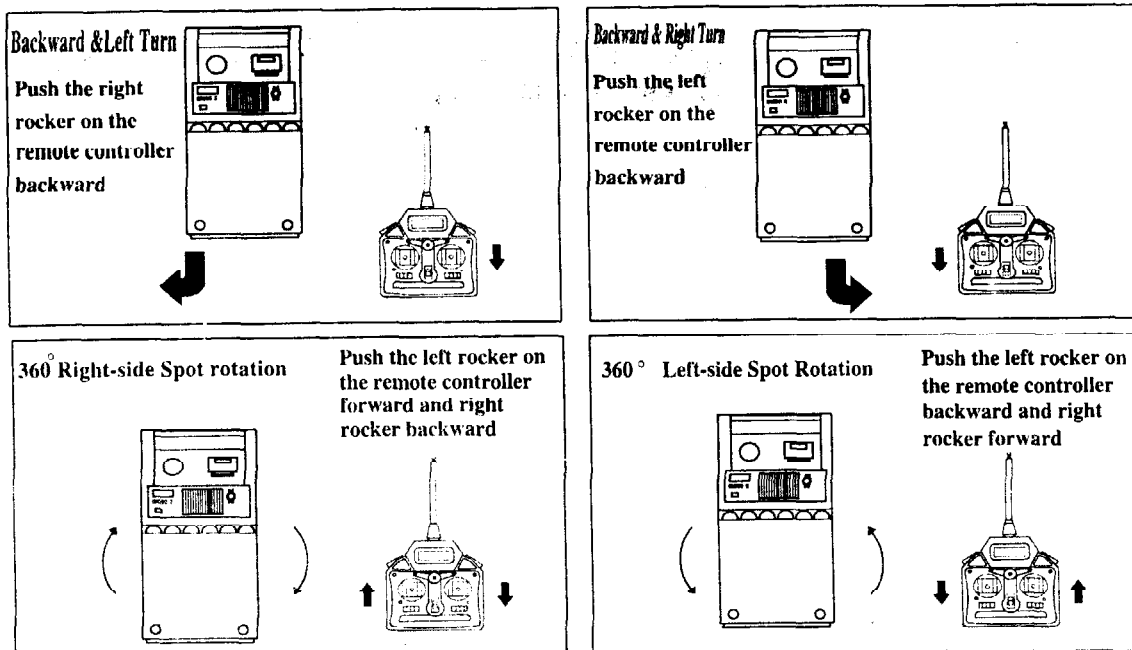

- Remarks:
1. The track may slip out if it is hindered when the car is doing high-speed rotation on bumpy surface or lawn. The clutch slips and emits "crack" sounds though this does no harm to the toy. Avoid rotating the car on bumpy surfaces or lawn.
 2. If the track slips out, reverse the direction of the tracks on both side or switch off and use your hand to put them back in action.

Operation Methods

Left Turn of the Launching PAD

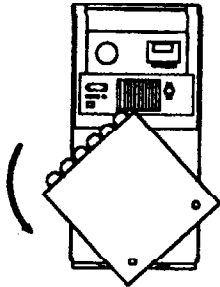

Please press the left button on the back of the remote controller

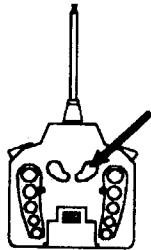

Right Turn of the Launching PAD

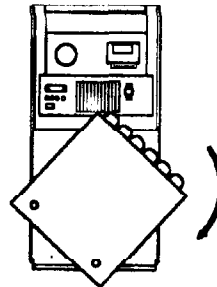

Please press the right button on the back of the remote controller

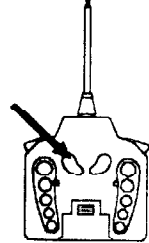

Elevation of the Launching Rack

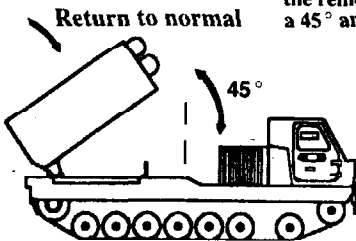

Upon the horizontal position of the launching rack, press the left or right button of the front of the remote controller to form a 45° angle

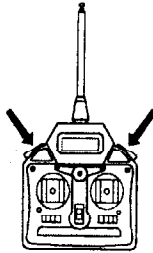

Launching Bullets

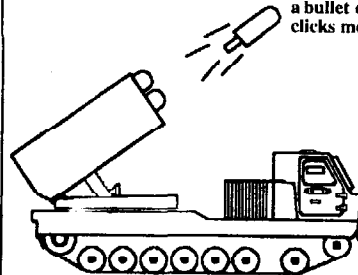

Upon the 45° angle, press the left or right button on the front of the remote controller to shoot out bullets. Each press means a bullet each time while continuous clicks mean continuous shooting

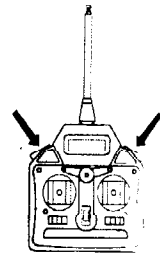

Field Fight

The remote control car is capable of field tour. It can ride on 30° slope or in a straight line on bumpy roads.

Up the Slope

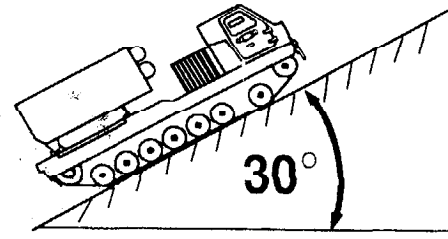

Cross the Ditch

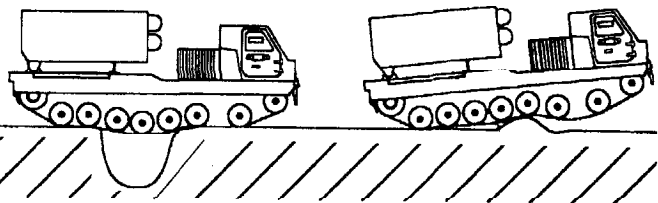

Analysis of Breakdowns

Before sending out for repair, readjust the car because most of the breakdowns have been caused by low battery.

Conditions of the Car	Reasons	Ways for Inspection & Adjustment	Relevant Page
Stop Working	No battery in the remote controller or the car	Reloading the battery	7
	Incorrect installation of the battery of remote controller	Reinstalling the battery	7
	Low battery of the remote controller	Changing for new battery	7
	Low battery of the car	Recharging	3
Failure to Launch the Bullets	Low battery of the car	Changing for new battery	7
	Launching signals being interrupted	Relocating the launching rack and launching again	
Out of Control	Low battery of the remote controller	Changing for new battery	7
	Interference by some waves	Changing for new place or wait for a few seconds	
	Operation of remote control car at the same cycle nearby	Changing for new place or wait for a few seconds	
Easy Exhaust of Battery or Hard Acceleration	Low battery	Recharging	3
	Expiration of the battery	Changing for new battery	7