

This device complies with Part 15 of the FCC Rules. Operation is subject to the following two conditions:

- (1) This device may not cause harmful interference and
- (2) This device must accept any interference received, including interference that may cause undesired operation.

**FEDERAL COMMUNICATIONS COMMISSION INTERFERENCE STATEMENT**

This equipment has been tested and found to comply with the limits for a Class B digital device, pursuant to Part 15 of the FCC Rules. These limits are designed to provide reasonable protection against harmful interference in a residential installation. This equipment generates, uses and can radiate radio frequency energy and, if not installed and used in accordance with the instructions, may cause harmful interference to radio communications. However, there is no guarantee that interference will not occur in a particular installation. If this equipment does cause harmful interference to radio or television reception, which can be determined by turning the equipment off and on, the user is encouraged to try to correct the interference by one or more of the following measures:

- Reorient or relocate the receiving antenna.
- Increase the separation between the equipment and receiver.
- Connect the equipment into an outlet on a circuit different from that to which the receiver is connected.
- Consult the dealer or an experienced radio/TV technician for help.

**CAUTION:**

Any changes or modifications not expressly approved by the party responsible for compliance could void the user's authority to operate the equipment.

This device complies with Part 15 of the FCC Rules. Operation is subject to the following two conditions:

- (1) This device may not cause harmful interference and
- (2) This device must accept any interference received, including interference that may cause undesired operation.

Please follow the instruction below to start using the cordless 2.4G RF product.

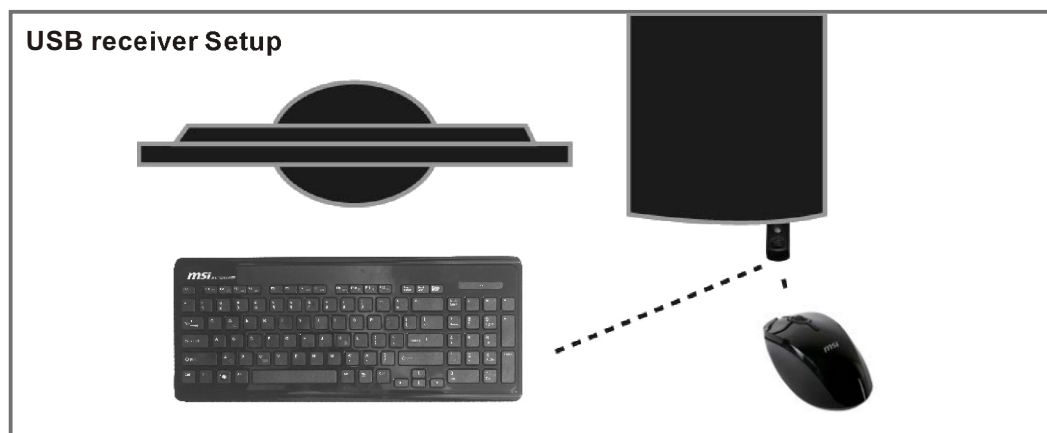

**Synchronization buttons**

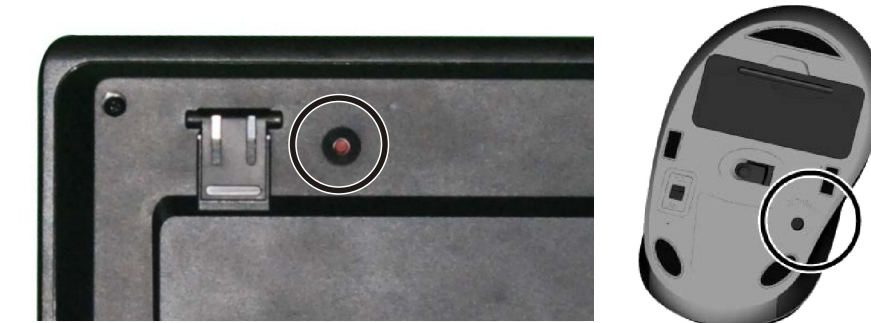

**Setting up your keyboard and mouse**

1. Insert batteries into mouse and keyboard.
2. Connect the USB receiver into an available USB port on your computer or into the USB extension cable.
3. Place the keyboard and mouse within 6 feet of the USB keyboard, mouse and the USB receiver.
4. The operating system will automatically detect the keyboard and mouse and it will begin working, if it does not work, see Synchronizing your keyboard and mouse.

**Synchronizing your keyboard and mouse**

Synchronize your keyboard and mouse each time the batteries are changed and if the keyboard or mouse stops responding.

1. Press the receiver synchronization button
2. Press the mouse synchronization button with a paperclip
3. Press the receiver synchronization button
4. Press the keyboard synchronization button with a paperclip
5. The keyboard will begin working

**Note:** If the keyboard or mouse does not work, replace the batteries and repeat steps 1.2 or 3.

**Preserving battery life on your mouse**

To preserve battery life, turn the mouse off when it is not in use.



**Features:**

- 2.4GHz Radio Frequency technology.
- Slim keycap structure based on notebook keyboard.
- Only half height of common standard keyboard.
- Compact size for space saving.
- Comfortable, optical mouse shape that fits good in right hand.
- Soft touch and tactile feedback.
- Compatible with Windows® ME/2000/XP/VISTA/7.
- USB port supports "Plug and Play".

## RF exposure warning ·

This equipment must be installed and operated in accordance with provided instructions and the antenna(s) used for this transmitter must be installed to provide a separation distance of at least 20 cm from all persons and must not be co-located or operating in conjunction with any other antenna or transmitter. End-users and installers must be provide with antenna installation instructions and transmitter operating conditions for satisfying RF exposure compliance.