



CLUTCH GM70



Micro Star International Co Ltd
No. 69, Li-De Street, Zhonghe Dist., New Taipei City 235, Taiwan
tel: +886-2-3234-5599 fax: +886-2-3234-5488
www.msi.com

TRUE GAMING
SOME ARE PC, WE ARE GAMING

Introduction

Thank you for choosing the gaming mouse with marvelous design, MSI Clutch GM70, to be your companion. This exquisite gaming mouse will surely give you a delightful and professional experience in PC games.

This guide provides instructions and illustrations to help you get the most from the mouse, and it is recommended to read this guide before using it.

Package Contents

- Clutch GM70 GAMING Mouse
- USB Dongle x1
- USB Connector Cable x1
- Top Cover x1, Side grip x4
- Carry Pouch
- Multi-language Quick user guide

System Requirements

- PC with available USB port
- Windows 10/8.1/8/7/vista/XP
- At least 256 MB of free hard disk space

Specifications

- Interface: USB
- Operating System: Windows 10/8.1/8/7/Vista/XP
- Number of Macro Keys: 8
- Sensor Engine: up to 18,000 DPI
- Cable Length: 2 M braided cable with gold-plated USB connector
- Dimension: 125 x 66 x 39 mm (w/o side grips)
- Operating Band [MHz]: 2406MHz-2478MHz
- Target output power: ≤ 1 mw

Overview

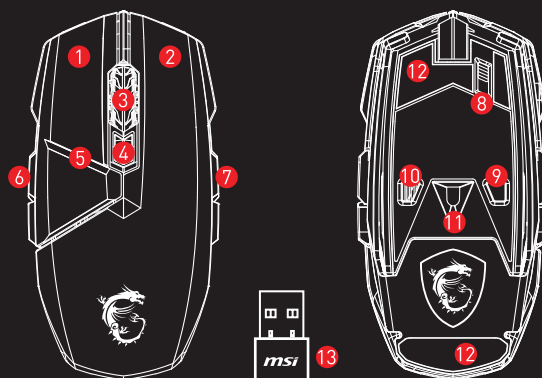

- | | | |
|------------------|--------------------------------|-------------------------------|
| 1. Left Click | 2. Right Click | 3. Ultra-precise Scroll Wheel |
| 4. DPI Switch | 5. DPI Indicator | 6. Left Buttons |
| 7. Right Buttons | 8. Cable Release | 9. Pairing Button |
| 10. Power Switch | 11. Professional Gaming Sensor | 12. Teflon Mouse Feet |
| 13. USB Dongle | | |

Hardware Installation

- **Wireless Mode**
 1. Connect the USB dongle to your PC.
 2. The mouse should be ready for use immediately.
 3. If not, please press the Pairing Button on the bottom of mouse for three seconds to enable the mouse.
- **Wired / Charging Mode**
 1. Connect the mouse to your PC with a USB cable.
 2. Once the [Hardware found] notification is shown on the screen, you should be able to use the mouse directly in the charging mode.

※ To obtain more functions about GM70, please visit MSI website at www.msi.com to download the specific software for the device.

How to Disassemble and Install the Top Cover

- Disassemble

Find the indentation located on the rear side of the mouse and pull the top cover up with your thumb, and then take the cover off.

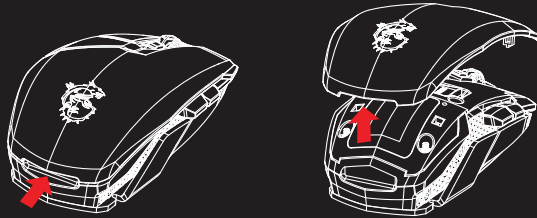

- Install

Align the mouse and the tenon attached to the back side of the mouse cover with correct orientation, and firmly fasten the cover to the mouse. The mouse should be ready for use immediately.

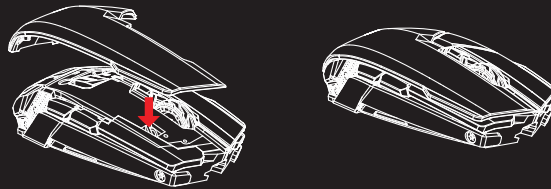

How to Recharge the Mouse

1. Connect GM70 to your PC with a USB cable.
2. The charging mode will be activated automatically.

※ It may take roughly 2 to 4 hours to have GM70 fully recharged, depending on the power source connected to the mouse.

FCC

Federal Communication Commission Interference Statement

This equipment has been tested and found to comply with the limits for a Class B digital device, pursuant to Part 15 of the FCC Rules. These limits are designed to provide reasonable protection against harmful interference in a residential installation.

This equipment generates, uses and can radiate radio frequency energy and, if not installed and used in accordance with the instructions, may cause harmful interference to radio communications. However, there is no guarantee that interference will not occur in a particular installation.

If this equipment does cause harmful interference to radio or television reception, which can be determined by turning the equipment off and on, the user is encouraged to try to correct the interference by one of the following measures:

- . Reorient or relocate the receiving antenna.
- . Increase the separation between the equipment and receiver.
- . Connect the equipment into an outlet on a circuit different from that to which the receiver is connected.
- . Consult the dealer or an experienced radio/TV technician for help.

FCC Caution:

To assure continued compliance, any changes or modifications not expressly approved by the party responsible for compliance could void the user's authority to operate this equipment.
(Example - use only shielded interface cables when connecting to computer or peripheral devices).

This device complies with Part 15 of the FCC Rules. Operation is subject to the following two conditions:

- (1) This device may not cause harmful interference, and
- (2) This device must accept any interference received, including interference that may cause undesired operation.

Clutch GM70 GAMING Mouse
FCC ID: 14LGM70TXTI

Clutch GM70 GAMING Dongle
FCC ID: 14LGM70RXTI