

1

Preface

MS-ND13

**Tablet PC
User's Manual**



Contents

Chapter 1: Preface

Content	1-2
Regulations and Statements	1-3
FCC	1-4
CE Conformity	1-4
Battery Regulations.....	1-4
WEEE Statement	1-5
Safety Instructions	1-5
Trademarks	1-7
Reversion History	1-7

Chapter 2: Introductions

Manual Map	2-2
Unpacking	2-2
Product Overview	2-3
Top-Open View	2-3
Specification	2-6

Chapter 3: Getting Started

Power Management	3-2
AC Power	3-2
Connecting the AC Power	3-2
Battery Power	3-3
Powering ON	3-4
Power Management in Windows OS	3-5
Basic Operations	3-8
Knowing the Display Features.....	3-8
Wireless Activation.....	3-10
Connecting the External Devices	3-11
Keyboard	3-11
Wireless / Bluetooth / Camera Functions	3-12

❖ Regulations and Statements

FCC

This device complies with Part 15 of the FCC Rules. Operation is subject to the following two conditions:

- (1) this device may not cause harmful interference, and
- (2) this device must accept any interference received, including interference that may cause undesired operation.

Changes or modifications not expressly approved by the party responsible for compliance could void the user's authority to operate the equipment.

NOTE: This equipment has been tested and found to comply with the limits for a Class B digital device, pursuant to Part 15 of the FCC Rules. These limits are designed to provide reasonable protection against harmful interference in a residential installation. This equipment generates, uses and can radiate radio frequency energy and, if not installed and used in accordance with the instructions, may cause harmful interference to radio communications. However, there is no guarantee that interference will not occur in a particular installation. If this equipment does cause harmful interference to radio or television reception, which can be determined by turning the equipment off and on, the user is encouraged to try to correct the interference by one or more of the following measures:

- Reorient or relocate the receiving antenna.
- Increase the separation between the equipment and receiver.
- Connect the equipment into an outlet on a circuit different from that to which the receiver is connected.
- Consult the dealer or an experienced radio/TV technician for help.

FCC RF Radiation Exposure and SAR Statements SAR Statement The Archos 7 home tablet

has been tested for body-worn Specific Absorption Rate (SAR) compliance. The FCC has established detailed SAR requirements and has established that these requirements. RF Exposure Information The radio module has been evaluated under FCC Bulletin OET 65C (01-01) and found to be compliant to the requirements as set forth in CFR 47 Sections, 2.1093, and 15.247 (b) (4) addressing RF Exposure from radio frequency devices. This model meets the applicable government requirements for exposure to radio frequency waves. The highest SAR level measured for this device was 1.007 W/kg .

Battery Regulations



European Union:

Batteries, battery packs, and accumulators should not be disposed of as unsorted household waste. Please use the public collection system to return, recycle, or treat them in compliance with the local regulations.



廢電池請回收

Taiwan:

For better environmental protection, waste batteries should be collected separately for recycling or special disposal.

California, USA: The button cell battery may contain perchlorate material and requires special handling when recycled or disposed of in California.

For further information please visit: <http://www.dtsc.ca.gov/hazardouswaste/perchlorate/>

Safety Guideline for Using Lithium Battery

Danger of explosion if battery is incorrectly replaced. Replace only with the same or equivalent type recommended by the equipment manufacturer. Discard used batteries according to manufacturer's instructions.

WEEE Statement

Under the European Union ("EU") Directive on Waste Electrical and Electronic Equipment, Directive 2002/96/EC, which takes effect on August 13, 2005, products of "electrical and electronic equipment" cannot be discarded as municipal waste anymore and manufacturers of covered electronic equipment will be obligated to take back such products at the end of their useful life.



❖ Safety Instructions



Read the safety instructions carefully and thoroughly. All cautions and warnings on the equipment or user's manual should be noted.



Keep this equipment away from humidity and high temperature.



Lay this equipment on a stable surface before setting it up.



The openings on the enclosure are used for air convection and to prevent the equipment from overheating. Do not cover the openings.



- ◆ Do not leave the equipment in an unconditioned environment with a storage temperature above 60°C (140°F) or below 0°C (32°F), which may damage the equipment.
- ◆ This unit should be operated under maximum ambient temperature of 40°C (120°F).



- ◆ Make sure the power voltage is within safety range and has been adjusted properly to the value of 100~240V before connecting the equipment to the power outlet.
- ◆ Always unplug the AC power cord before installing any add-on card or module to the equipment.
- ◆ Always disconnect the AC power cord or uninstall the battery pack or switch off the wall socket if the equipment would be left unused for a certain time to achieve zero energy consumption.



Never pour liquid into the opening that could damage the equipment or cause an electrical shock.



Place the power cord in a way that people are unlikely to step on it. Do not place anything on top of the power cord.



Always keep the strong magnetic or electrical objects away from the equipment.



When installing the coaxial cable to the TV Tuner, it is necessary to ensure that the metal shield is reliable connected to protective earthing system of the building.

Cable distribution system should be grounded (earthed) in accordance with ANSI/NFPA 70, the National Electrical Code (NEC), in particular Section 820.93, Grounding of Outer Conductive Shield of a Coaxial Cable.



If any of the following situations arises, get the equipment checked by a service personnel:

- ◆ The power cord or plug is damaged.
- ◆ Liquid has penetrated into the equipment.
- ◆ The equipment has been exposed to moisture.
- ◆ The equipment has not worked well or you can not get it work according to User's Manual.
- ◆ The equipment was dropped and damaged.
- ◆ The equipment has obvious signs of breakage.

Green Product Features

- ◆ Reduced energy consumption during use and stand-by
- ◆ Limited use of substances harmful to the environment and health
- ◆ Easily dismantled and recycled
- ◆ Reduced use of natural resources by encouraging recycling
- ◆ Extended product lifetime through easy upgrades
- ◆ Reduced solid waste production through take-back policy



Environmental Policy

- ◆ The product has been designed to enable proper reuse of parts and recycling and should not be thrown away
-

-
- ◆ Users should contact the local authorized point of collection for recycling and disposing of their end-of-life products.
-

❖ Trademarks

All trademarks are the properties of their respective owners.

❖ Revision History

Version	Revision History	Date
1.0	First Released	06, 2015

2

Introductions

MS-ND13

Congratulations on becoming an user of this product, the finely designed Tablet PC. This brand-new exquisite Tablet PC will give you a delightful and professional experience in using it. We are proud to tell our users that this product is thoroughly tested and certified by our reputation for unsurpassed dependability and customer satisfaction.

❖ Manual Map

This User's Manual provides instructions and illustrations on how to operate this Tablet PC. It is recommended to read this manual carefully before using this Tablet PC.

Chapter 1, Preface: Provide users the basic safety information and caution that is relevant when using this Tablet PC. It is recommended to read these information or caution when using this Tablet PC for the first time.

Chapter 2, Introductions: Include the descriptions of all the accessories of this Tablet PC. It is recommended to check out that if you have all the accessories included when you open the packing box. If any of these accessories is damaged or missing, please contact the vendor where you purchased this product. Also, this chapter provides the specification of this Tablet PC, and introduces the function buttons, connectors, LED of this product.

Chapter 3, Getting Started: Provide the basic operation instructions when using this Tablet PC.

❖ Unpacking

First, unpack the shipping carton and check all items carefully. If any item contained is damaged or missing, please contact your local dealer immediately. Also, keep the box and packing materials in case you need to ship the unit in the future. The package should contain the following items:

- Tablet PC
- Quick Start Manual
- AC/DC adapter / Interchangeable Plug
- USB Charging Cable
- External Keyboard (optional)

❖ Product Overview

This section provides the description of basic aspects of the Tablet PC. It will help you to know more about the appearance of this device before using it. Please be aware that the Tablet PC shown in this section may vary from the actual one that users purchased.

Top-open View

The figure of top-open view and description shown below will lead you to browse the main operating area of this Tablet PC.

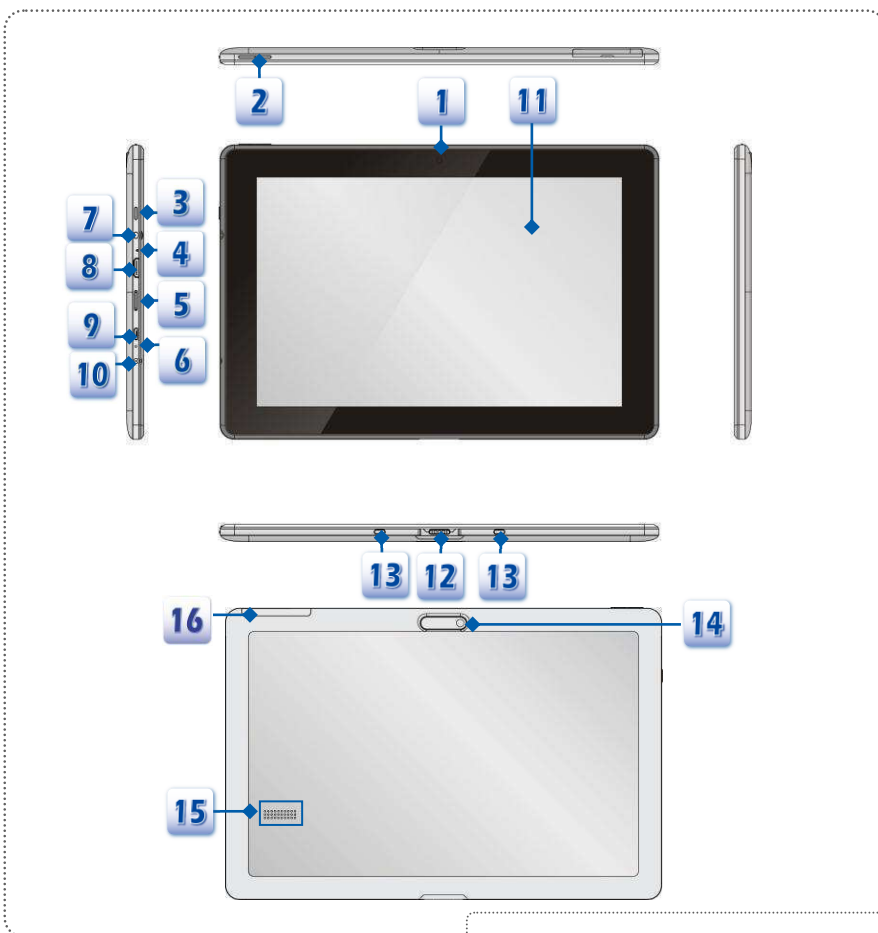

The figures shown here are for reference only.

1. Front Camera

This built-in front camera can be used for picture taking, video recording or conferencing, and any other interactive applications.

2. Volume Up / Volume Down Button

Press the Volume Up or Volume Down button to adjust the sound volume.

3. Power Button

Press this button to turn this product ON and OFF.

i. Before powering on the Tablet PC for the very first time, you must connect it with AC power.

ii. Press and hold the power button for 4 seconds can shut down the Tablet PC.

4. Reset Hole

If the Tablet PC cannot be turned off normally or no respond by pressing the power button for 4 seconds, insert a straightened paperclip to the hole.

Please note that in this case, AC power must be connected before restarting the Tablet PC.

5. Micro-SD Card Slot

Used for inserting or replacing micro-SD card to increase the storage capacity of the Tablet PC.

6. Internal Microphone

This is the built-in microphone and its function is the same with microphone.

7. Headphone Jack

Used for connecting the speakers or headphones.

8. Mini-HDMI Port

HDMI (High Definition Multimedia Interface) is a new interface standard for PCs, displays and consumer electronics devices that supports standard, enhanced and high-definition video, plus multi-channel digital audio on a single cable. Through the mini-HDMI to HDMI cable makes the mini-HDMI port connect with HDMI devices.

9. Micro-USB Port

Connecting the Tablet PC to a PC

You can use the micro-USB cable to connect the tablet PC to a PC and this process allows you to access the personal data from or to a PC easily. The tablet PC will become a removable disk and a USB storage device in this time.

Connecting the USB device to the Tablet PC

Through the micro-USB OTG cable, this tablet PC is able to connect various USB devices, such as mouse, keyboard, external storage device, etc. To correctly connect and utilize these devices, you might need to install their respective applications provided by the device vendors.

10. DC-in Jack

It is an electrical connector for supplying direct current (DC) power.

11. Touch Screen

Whenever the display is rotated, the touch screen will be rotated and expanded to fit the display automatically.

This function will be changed depends on the user's settings.

12. Keyboard Docking Station

A keyboard docking station is an expansion unit used to attach a keyboard simultaneously.

13. Boss Hole

Used for locking the boss hole of the keyboard.

14. Rear Camera

This built-in rear camera can be used for picture taking, video recording or conferencing, and any other interactive applications.

15. Speaker



Support high quality sound.

16. UltraStick Slot (optional)

Used for inserting or replacing UltraStick.

❖ Specification

The specification may change without notice. The actual products sold are different from areas. Please check the detailed specification with your local dealers.

Physical Characteristic	
Dimension	262.17(W) x 173.6 (D) x 9.8 (H) mm
Weight	<575 kg
CPU	
Processor Type	Intel® Atom™ Processor
Supported Processor	Intel® Quad Core processor
Memory	
Technology	DDR3L 1333 MHz
Memory	2GB on board
Power	
AC/DC Adapter	18W, 12V Input: 100~240V, 50~60Hz Output: 12V  1.5A  The supported AC/DC adapter may vary without notice.
Storage (items listed here may vary without notice)	
EMMC	64GB
I/O Port	
Headphone Jack	x 1
DC-in Jack	x 1
Internal Microphone	x 1
Mini-HDMI Port	x 1
Micro-USB Port	x 1
Keyboard Docking Station	x 1
UltraStick Slot	x 1 (optional)

Communication Port

Wireless LAN	Supported
--------------	-----------

Bluetooth	Supported
-----------	-----------

Display

LCD Type	10.1" IPS display
----------	-------------------

Resolution	1280 x 800
------------	------------

Multi Touch	10-Point Touch Supported
-------------	--------------------------

Brightness	Brightness controlled by setting
------------	----------------------------------

Video

Graphics	UMA
----------	-----

Audio

Internal Speaker	1 speaker
------------------	-----------

Sound Volume	Adjust by volume button & SW
--------------	------------------------------

WebCam

Front Camera	2.0MP
--------------	-------

Rear Camera	2.0MP
-------------	-------

Others

G-Sensor	Supported
----------	-----------

The actual function preinstalled in this product depends on the model you purchased, and may vary without notice.

3

Getting Started

MS-ND13

❖ Power Management

AC Power

It is strongly recommended to connect the AC/DC adapter to the Tablet PC and use the AC power while using this Tablet PC for the first time since some models may require the AC/DC adapter to be connected in order to power on the Tablet PC safely and properly. When the AC power is connected, recharging the battery will start immediately.

Note that the AC/DC adapter included in the package is approved for your Tablet PC; using other adapter model may damage either the Tablet PC or other devices attached to it.

Do not cover the AC/DC adapter since it may generate a certain heat while in use. Always be aware of heat coming from the AC/DC adapter in use.

Connecting the AC Power

1. Take up the interchangeable plug and look for the groove on the interchangeable plug which can be used for locking on the AC/DC adapter. Then align the groove of the interchangeable plug on the tenon of the AC/DC adapter with correct orientation. Next, rotate the interchangeable plug 90 degrees clockwise until it is fixed on the AC/DC adapter.
2. Plug the DC end of the AC/DC adapter into the DC-in jack of the Tablet PC.
3. Then plug the AC/DC adapter into the power outlet.
4. When remove, please follow the steps 3→2→1.

Note: *The interchangeable plug may vary depending on countries or regions.*

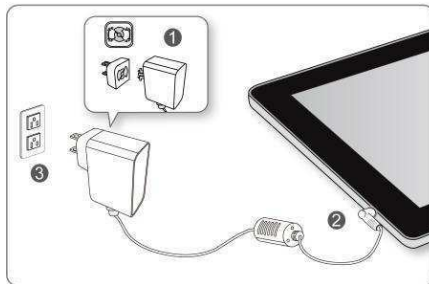

❖ Battery Power

This Tablet PC is equipped with a built-in high-capacity Lithium-ion Polymer battery pack. The rechargeable Lithium-ion Polymer battery pack is an internal power source of the Tablet PC.

Be aware that this battery pack may be damaged if users try to disassemble the battery pack on their own. Also, please note that the limited warranty of the battery pack will be voided if the battery pack is disassembled by non-authorized technicians.

Please follow your local laws and regulations to recycle the Tablet PC and the built-in battery pack.

Conserving Battery Power

Efficient battery power is critical to maintain a normal operation. If the battery power is not managed well, the saved data and customized settings may be lost.

To optimize battery life and avoid a sudden power loss, read the tips below:

- ◆ Suspend system operation if the system will be idle for a while or shorten the suspend time period.
- ◆ Turn off the system if you won't be using it for a period of time.
- ◆ Disable unnecessary settings or remove idle peripherals.
- ◆ Connect an AC/DC adapter to the system whenever possible.

Charging the Battery Pack

The built-in battery pack can be recharged when the Tablet PC is connected to the AC power.

Please pay attention to the following tips before recharging the battery:

- ◆ You can use the system, suspend system operation or shut down and turn off the system without interrupting the charging process.
- ◆ The built-in battery pack uses Lithium-ion Polymer battery cells that have no "memory effect." It is unnecessary to discharge the battery before recharging. However, to optimize the life of battery, we suggest that consuming the battery power completely once a month is necessary.
- ◆ The actual charging time will be determined by the applications in use.

Power On

Long press the Power Button to power on the Tablet PC.



Power Management in Windows OS

Power management of personal computers (PCs) and monitors has the potential to save significant amounts of electricity as well as deliver environmental benefits. To be energy efficient, turn off your display or set your PC to standby/hibernate mode after a period of user inactivity.

Follow the instructions below to adjust the power management settings in Windows OS:

“Power Options” in Windows OS allows you to control the power management features of your display, hard drive, and battery.



In Windows 8 Metro APPs screen, please select “Desktop” to return back to the desktop.



Slide your finger from the right edge of the desktop leftward will bring a list of functional icons. Find the [Settings] icon on the desktop.

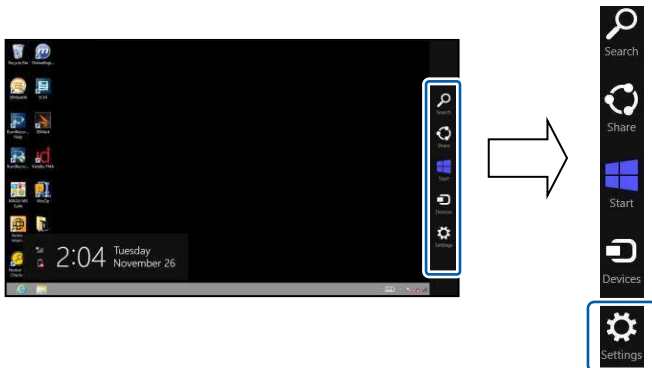

- 3** Tap [Settings] icon will get the following selection menu. Select **Control Panel** in the menu.

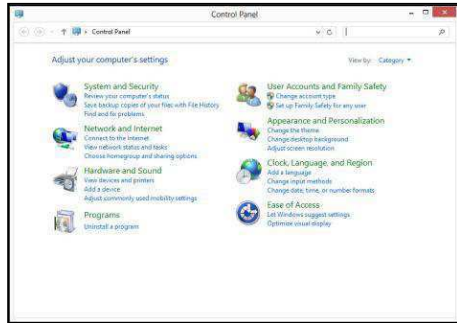
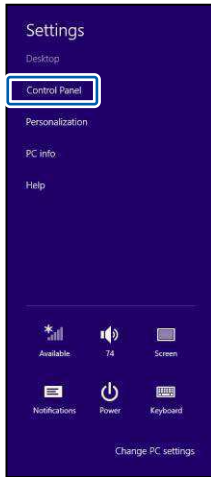

- 4** Tap **System and Security**.

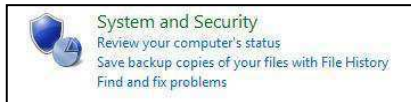

- 5** Tap **Power Options**.

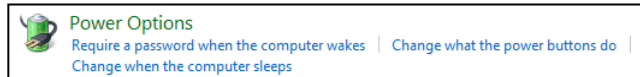

6

Then select a power plan that meets your personal needs.

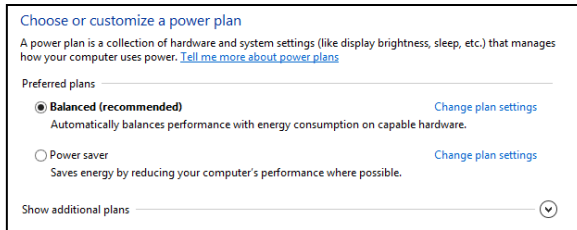

7

The Power icon will present various and relative options as following:



8

You can wake up your computer from power saving mode by pressing the power button

❖ Basic Operations



Knowing the Display Features

Ten-point-touch IPS Display

This Tablet PC is equipped with a ten-point-touch IPS display which delivers consistent and accurate color from all viewing angles, and makes viewing more pleasure with vivid and clear picture on the screens. Users are allowed to use finger gestures to interact with multi-media content, play games, read e-books, access documents, create special effects, manipulate art and photographs, and even surf on the internet, in a truly unique and compelling way.

Display Lock

With a built-in G-sensor module, this IPS display gives users a more flexible way in viewing web pages, documents, pictures, videos, etc. Whenever the display is rotated, the screen will be rotated and expanded to fit the display automatically.

1. Find the **[Settings]** icon on the desktop and tap it.
2. Enter the **[PC Settings]** main page by tapping **[Change PC Settings]**.
3. Select this Screen icon  to enable this function.
4. Tap this  icon again will lock the screen .



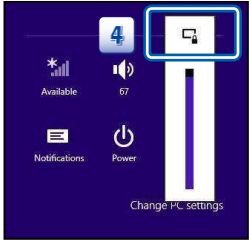
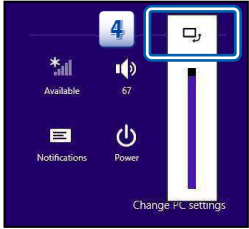
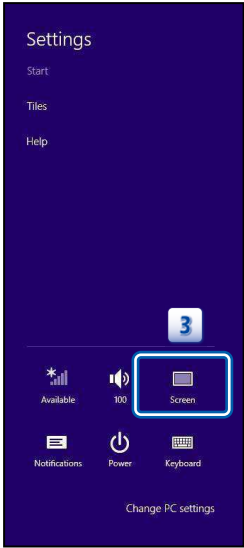

Wireless Activation

1. Find the **Settings** icon on the desktop and click on it.
2. Enter the **PC settings** main page by clicking on **Change PC settings**.
3. Unfold the **Airplane mode** selections under **Network**.
4. Make sure Airplane mode is set to OFF here.
5. Turn the Wi-Fi or Bluetooth function on/ off by sliding the function switch bar.

Refer to the Status LED to check the device status.

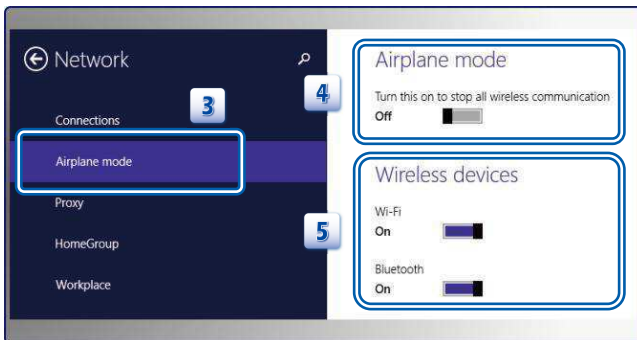
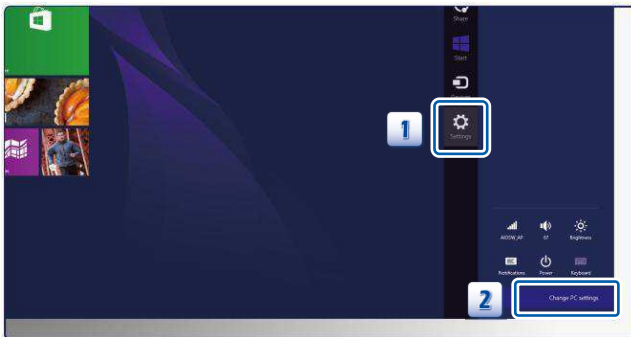

1. When Airplane mode is set to ON, the Wi-Fi and Bluetooth function will be disabled at once.
2. The information provided here is for reference only, and may vary without notice.

❖ Connecting the External Devices

Keyboard

The keyboard docking station on the Tablet PC allows you to connect the external keyboard. Lock the boss hole of the Tablet PC and the boss hole of the keyboard docking station together and you can use keyboard function.



Wireless / Bluetooth/ Camera Functions

- 1. Tap the [SCM] icon  on the desktop to bring SCM (System Control Manager) screen.
- 2. Find Wireless, Bluetooth and Camera in SCM screen, tapping the corresponding icon to enable/ disable the device.
- 3. After enabling wireless or camera function, tap the windows key can switch the present display to Windows8 main screen. Then you can use the Internet Explorer or camera for your own desire.

