

microlab



microlab

just listen



MD312
User Manual

www.microlab.cn
Microlab Electronics Co.,Ltd
Made in China

The *Bluetooth*® work mark and logos are registered trademarks owned by Bluetooth SIG, Inc. and any use of such marks by Microlab Electronics Co., Ltd is under license. Other trademarks and trade names are those of their respective owners.



Disclaimer: All symbols and logos belong to the respective brand holder or registered holder. All specifications and information are subject to changes without further notice. Slight variations and differences might appear between the printed photos and actual product due to product enhancement.

Prior to initial use, please read the manual carefully

Portable Wireless Speaker System

Technical Information

AMPLIFIER

Total Power:	4 Watt RMS
Power distribution:	1.25 Watt x 2 + 1.5 Watt
Harmonic distortion:	< 5% 1W 1 kHz
Frequency response:	40 Hz - 18 kHz
Signal/Noise ratio:	> 65 dB
Separation:	> 45 dB

Speakers

Tweeter type:	2" x 2
Tweeter rated power:	2 Watt 4 Ohm
Woofer type:	3"
Woofer rated power:	5 Watt 2 Ohm

Interfaces

Input:	3.5mm stereo jack, mini-USB charging port
Wireless:	Bluetooth 2.1, and A2DP

Frequently Asked Questions (FAQ)

Frequently Asked Questions	Answers
LED do not light up	Check if the system is powered on or battery is replaced with fresh BL-5C type Please perform an initial charge of 4 hours prior to initial use.
No Sound	Check if the audio source is properly paired and connected. Secondly check if the 3.5mm stereo plug is correctly inserted for AUX mode. Ensure volume is correctly set
Intermittent sound	Please check the audio source distance, try to place it nearer to the speaker system.
How to charge the system?	Simply connect the system to the supplied Charging adapter. After charged the LED will turned off. Do not charge from any USB port or hub.
What are the products supported?	Any <i>Bluetooth</i> ® enabled music devices and playback devices such as PC, Media players with 3.5mm stereo plug.
Sound is distorted	Check if the volume is at lower level and the Mp3 format is recorded at above 196 bitrate
Where to place this speaker	It is magnetically shielded so can be placed near LCD TV Monitor without any distortion
If the problem still exists, please contact the distributor or ask for professional service	

1. Power on

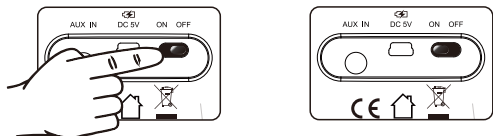

Once turned on, after 3 seconds the system will search for previous paired devices for 20 seconds with its LED blinking slowly. After 20 seconds if no paired devices are found, it will commence new pairing sequence automatically. It will start the pairing sequence for 3 minutes before returning to the initial sequence of locating previously paired device.

2. BT Pairing ON (manually)

Depress for 3 secs, pairing mode sequence will commence. If prompted for security code, please key in "0000".

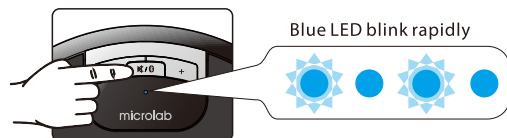

3. BT Pairing with BT audio device

Pairing with *Bluetooth*® music devices. Once paired, an audio tone buzz can be heard, and the Bluetooth LED will blink for 2 seconds once about every 5 to 6 seconds interval. (skip this step if both MD312 and music device had saved this profile before)

iPhone, iPad or iPod - go to SETTINGS > GENERAL > enable BLUETOOTH > select MD312

Android Phone - go to SETTINGS > WIRELESS & NETWORKS > enable BLUETOOTH > select MD312

Others - read the instruction manual included with your BT music device > enable BLUETOOTH > select MD312.

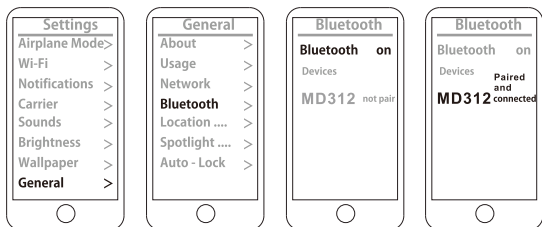

go to setting page select Bluetooth setting turn on Bluetooth & select MD312 pair and connect MD312



Once paired successfully, an audio tone buzz can be heard, and the LED will blink twice in 5 to 6 seconds intervals

4. BT playback

Once connected, you can commence the music playback either on the mobile phone, tablet or notebook, etc. The sound will be transferred wirelessly to the MD312 system directly. During streaming, the LED will blink once for 2 seconds duration in 5 seconds intervals.

Depress the + or - buttons for volume adjustments. The LED will illuminate in green steadily once depress. To mute the playback, depress the Mute button and the LED will illuminate in green constantly till it is depress again to deactivate.

5. AUX IN mode

Connect the 3.5 mm stereo source to the AUX IN jack. This will immediately disconnect the Bluetooth mode if it is on. Commence your media player via the 3.5 mm stereo connection.

6. Battery charging (Lithium battery type: BL-5C)

Connect the charging adapter to mini-USB port of the speaker. Ensure the speaker system is turned off for charge. The system will commence its auto charging mode. The LED will illuminate in bright red colour. Once fully-charged, it will be turn dim red. Please initial charge the system for 4 hours prior to first. Note: When battery level is depleted, the system will shut down immediately. Please do not charge from USB port or Hub.



Caution:

To reduce the risk of electric shock, do not dismantle the product and do not expose the apparatus to rain or moisture. No user-serviceable parts inside. Refer servicing to qualified personnel only.

Explanation of Graphical Symbols:

The lightning flash within an equilateral triangle is intended to alert you to the presence of uninsulated dangerous voltage within the product's enclosure that may be of sufficient magnitude to constitute an electric shock to a person or persons.

The exclamation point within an equilateral triangle is intended to alert you to the presence of important operating and maintenance (servicing) instructions in the literature accompanying the product.

WARNINGS:

1. Read Instructions - All the safety and operating instructions must be read before the product is operated.
2. Retain Instructions - The safety and operating instructions should be kept with the product for future reference.
3. Heed warnings - All warnings on the product and in the operating instructions should be adhered to.
4. Follow instructions - All operating and users instructions should be followed.
5. Installation - Install in accordance with the manufacturer's instructions.
6. Power sources - This product should be operated only from the type of power source indicated by the marking adjacent to the power cord entry. If you are not sure of the type of power supply to your home, consult your product dealer or local power company.
7. Grounding or polarization - the product is not required to be grounded. Ensure the plug is fully inserted into the wall outlet or extension cord receptacle to prevent blade or pin exposure. Some versions of the product are equipped with a power cord fitted with a polarized alternating line plug (a plug having one blade wide than the other). This plug will fit onto the power outlet only one way. This is a safety feature. If you are unable to insert the plug fully into the outlet, try reversing the plug. If the plug should still fail to fit, contact your electrician to replace your obsolete outlet. Do not defeat the safety purpose of the polarized plug. When using an extension power-supply cord or a power-supply cord other than that supplied with the appliance, it should be fitted with the appropriate molded plugs and carry safety approval appropriate to the country of use.
8. Power cord protection - Power-supply cords should be routed so that they are not likely to be walked on, kinked or pinched by items placed on or against them, paying particular attention to cords from plugs, receptacles and the point where they exit from the appliance.
9. Overloading - Do not overload wall outlets, extension cords or multiple sockets, as this can result in a risk of fire or electric shock.
10. Ventilation - The product must be properly ventilated. Do not place the product on a bed, sofa, or other similar surface. Do not cover the product with any items such as tablecloths, newspapers, etc.
11. Heat - The product should be situated away from heat sources such as radiators, heat registers, stoves, or other products including amplifiers that produce heat. No naked flame sources, such as lighted candles, should be placed on the apparatus.
12. Water and moisture - To reduce the risk of fire or electric shock, do not expose the product to rain, dripping, splashing or excessive moisture such as in a sauna or bathroom. Do not use this product near water, for example, near a bathtub, washbowl, kitchen sink, laundry tub, in a wet basement, or near a swimming pool, or etc.
13. Object and Liquid Entry - Never push objects of any kind into this product through openings, as they may touch dangerous voltage points or short-circuit parts that could result in a fire or electric shock. Never spill liquid of any kind on the product. Do not place any object containing liquid on top of the product.
14. Cleaning - Unplug the product from the wall outlet before cleaning. The cabinet of the subwoofer may be cleaned by dusting with a dry cloth. If you wish to use an aerosol cleaning spray, do not spray directly on the cabinet; spray onto the cloth. Be careful not to damage the drive units.
15. Attachments - Do not use attachments not recommended by the product manufacturers, as they may cause hazards.
16. Accessories - Do not place this product on an unstable cart, stand, tripod, bracket or table. The product may fall, causing serious injury to a child or adult, and serious damage to the product. Use only with a cart, stand, tripod, bracket or table recommended by the manufacturer or sold with the product. Any mounting of the product should follow the manufacturers' instructions and should use a mounting accessory recommended by the manufacturer.
17. Moving the product - A product and cart combination should be moved with care. Quick stops, excessive force and uneven surfaces may cause the product and cart combination to overturn.
18. Un-use periods - The power cord of the device should be unplugged from the outlet during lightning storms or when the apparatus is left unused for a long period of time.
19. Servicing - Do not attempt to service this product yourself, as opening or removing covers may expose you to dangerous voltage or other hazards. Refer all servicing to qualified service personnel.

20. Please remove the power plug from the main power source or wall power source when not in use. When plugged in to a power source, the system is in standby mode, so the power is not entirely cut off.
21. Replacement parts - When replacement parts are required, ensure the service technician has used replacement parts specified by the manufacturer or have the same characteristics as the original part. Unauthorized substitutions may result in fire, electric shock or other hazards.
22. Mains fuses - For continued protection against fire hazard, use fuses only of the correct type and rating. The correct fuse specification for each voltage range is marked on the product.
23. Do not turn up the volume while listening to a section with very low level inputs or no audio signals. If you do, the speaker may be damaged when a peak level section is suddenly played.
24. The only means of completely disconnecting the product from the power supply is by removing the power cord from the wall outlet or the product. The wall outlet or the power cord entry to the product must remain freely accessible at all times while the product is in use.
25. Try to install the product near a wall socket or extension cord and shall be easily accessible.
26. The highest environmental temperature suitable for this product is 40°C.

FCC STATEMENT

1. This device complies with Part 15 of the FCC Rules.

Operation is subject to the following two conditions:

- (1) This device may not cause harmful interference, and
 - (2) This device must accept any interference received, including interference that may cause undesired operation.
2. Changes or modifications not expressly approved by the party responsible for compliance could void the user's authority to operate the equipment.

FCC Radiation Exposure Statement

This equipment complies with FCC radiation exposure limits set forth for an uncontrolled environment. This equipment should be installed and operated with minimum distance 20cm between the radiator & your body

Illustrations

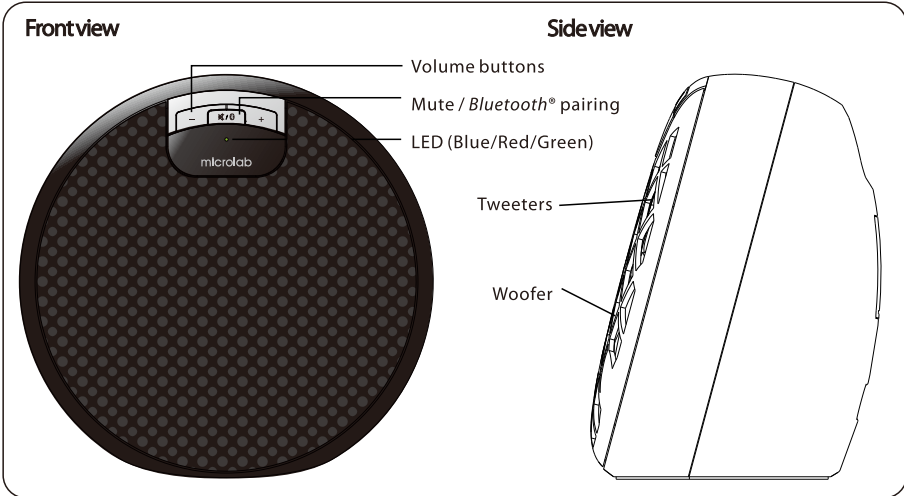

EN
3

Introduction

Uniquely designed 2.1 speaker system in a single compact sound box. Aesthetic in design, it fits into most room types such as bedroom, kitchen or even your studies.

Connects wirelessly to your *Bluetooth*® wirelessly technology enabled mobile phone or media player. Enjoy music without any messy cables from the music source. Listen to your favourite music from your mobile phone, tablet, or notebook. Alternatively you can connect to traditional 3.5 mm stereo music source. Highly portable, this system features rechargeable battery and hand grip that lets you use it almost anywhere.

Features

- 2.1 speaker system for full range music production
- Wireless music with *Bluetooth*® technology
- Generous bass effects and clear treble
- Front panel controls for playback and *Bluetooth*® pairing functions
- Comes with alternative 3.5mm stereo connection to most media players and computer
- Rechargeable battery powered for portable use; carry it with you

Package contents

- MD312 speaker system 1 pc
- 3.5mm - 3.5mm audio cable 1 pc
- Charging adapter 1 pc
- Rechargeable battery, BL-5C 1 pc
- User manual 1 pc

Connection

1. Insert the rechargeable battery, part number: BL-5C into the battery compartment. Please observe the battery orientation with the electrical pins in the compartment.
2. For proper speaker operation, please ensure the rechargeable battery is inserted and battery energy level is sufficient.

EN
4

RearView: Connection illustrations

Hand grip

Battery compartment

to Charging adapter

AUX IN

3.5mm stereo

3.5 mm stereo input source

Power On / Off

TV

Media player

CD \ VCD \ DVD Blu-Ray player

Mp3 \ Mp4 Media player

PC or Notebook

LED indication status	
POWER ON / OFF	Power ON - Blue LED will blink slowly for 20 secs searching for paired devices, after 20 secs it will start new pairing sequence for 3 minutes.
AUX IN	With AUX IN connected, Green LED illuminates in 5 secs intervals.
BT PAIRING	When BT pairing sequence initiated, Blue LED will blink rapidly searching for new BT devices
BT PAIRED	When BT device is paired successfully, Blue LED will blink slowly for 2 secs in 5 secs intervals
VOLUME ADJUST	Volume button is depressed, LED will illuminate in Green.
BATT Charging	Charging adapter connected to the mini-USB port, the LED will illuminate in bright red. Fully charged, the red LED will turn dim.

Rear view

BL-5C
Rechargeable battery
Type: Lithium

BL-5C rechargeable battery

AUX IN USB ON OFF