

Model 1724 User Guide

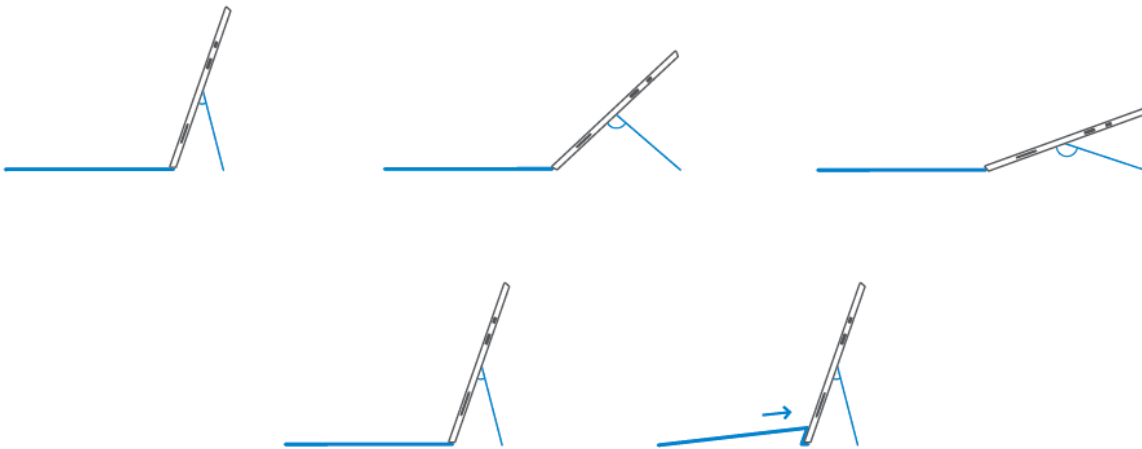
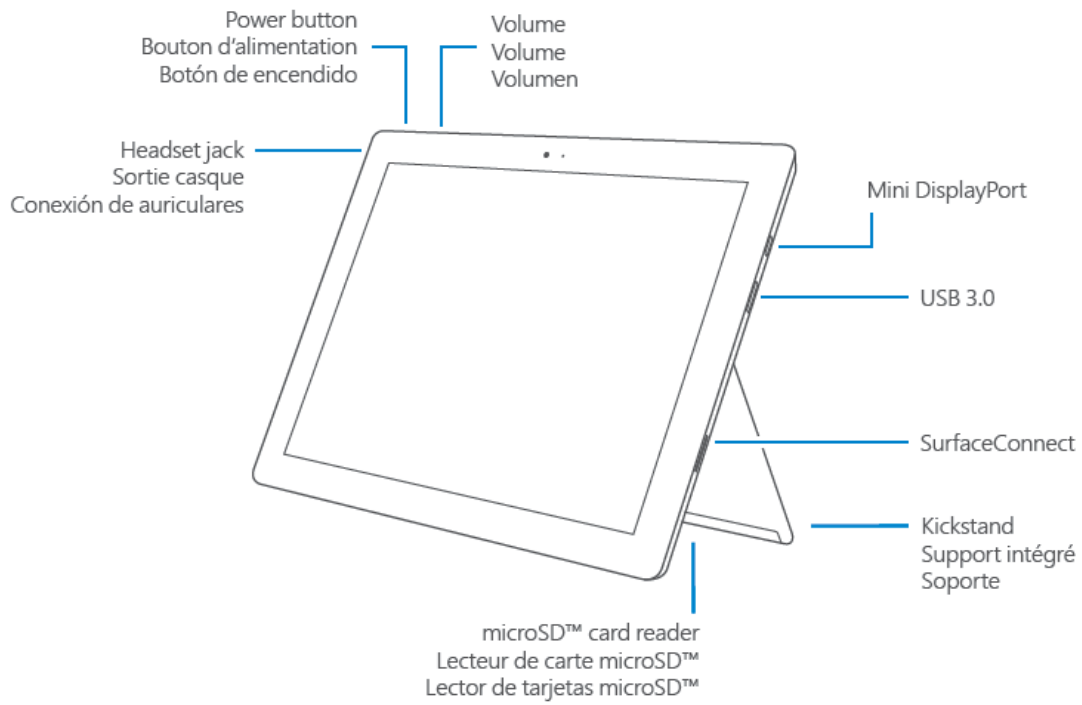

Setting up your Surface Pro 4

1. Get ready

To set up your Surface Pro 4, we recommend you have:

- Wi-Fi network access (and the password if it is secured).
- A Microsoft account (use an existing account, such as Hotmail, Outlook.com or Xbox, or sign up during setup).

For more information on the benefits of using a Microsoft account with Surface, visit windows.microsoft.com/account

3. Sign in

Follow the on-screen instructions and enter (or sign up for) your Microsoft account info when prompted.

4. Complete Setup

Your Surface Pro 4 is going to take a few minutes to complete the setup process.

Windows Hello

Configure **Windows Hello** using the integrated camera in **Surface Pro 4**

1. Make sure you have installed all updates on your **Surface Pro 4**
2. Swipe in from the right and go to **All settings**.
3. Open Accounts and select Sign-in Options
4. Create a pin
5. Click on **Windows Hello** and configure your **Surface Pro 4** for Face Authentication

2. Set up

- Flip out the Kickstand -Place your thumb in the groove on the side of the device and push out to engage the Kickstand
- Click in the optional keyboard cover
Use the keyboard cover flat on tables or fold the keyboard edge against the screen for better stability on your lap.
- Plug in the power supply and tap the Power button (wait a few seconds for text to appear on screen)
- Take your Surface Pen out of the box, then press and hold the top button for 5 seconds and you will see a white LED flashing on the Pen - now the Pen is in pairing mode and you can continue on-screen set up.

5. Important Software Updates

Updates to Surface and Windows are released regularly to improve performance. Your Surface Pro 4 will automatically download updates during the setup process and in the first few days you are using Surface Pro 4.

To troubleshoot or learn more

Open the Surface app on your Surface

- Hit the Windows key, type **Surface** and open the Surface app
- Here you can configure your Surface Pen & learn more about your Surface

If you'd like to learn more about Windows, visit windows.microsoft.com/how-to