

# Nokia 6060 and Nokia 6061 User Guide

---

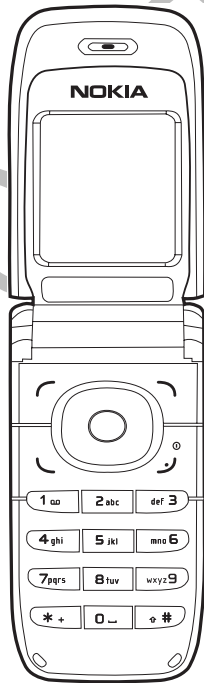

9242242  
Issue 1

## LEGAL INFORMATION

PART NO. 9242242, Issue NO. 1  
Copyright © 2005 Nokia. All rights reserved.



The crossed-out wheeled bin means that within the European Union the product must be taken to separate collection at the product end-of life. This applies to your device but also to any enhancements marked with this symbol. Do not dispose of these products as unsorted municipal waste.

Reproduction, transfer, distribution or storage of part or all of the contents in this document in any form without the prior written permission of Nokia is prohibited.

Nokia and Nokia Connecting People are trademarks or registered trademarks of Nokia Corporation. Other product and company names mentioned herein may be trademarks or tradenames of their respective owners.

Nokia tune is a sound mark of Nokia Corporation.

US Patent No 5818437 and other pending patents. T9 text input software Copyright (C) 1997-2005. Tegic Communications, Inc. All rights reserved.



Includes RSA BSAFE cryptographic or security protocol software from RSA Security.



Java is a trademark of Sun Microsystems, Inc.

Nokia operates a policy of continuous development. Nokia reserves the right to make changes and improvements to any of the products described in this document without prior notice. Under no circumstances shall Nokia be responsible for any loss of data or income or any special, incidental, consequential or indirect damages howsoever caused.

The contents of this document are provided "as is". Except as required by applicable law, no warranties of any kind, either express or implied, including, but not limited to, the implied warranties of merchantability and fitness for a particular purpose, are made in relation to the accuracy, reliability or contents of this document. Nokia reserves the right to revise this document or withdraw it at any time without prior notice.

The availability of particular products may vary by region. Please check with the Nokia dealer nearest to you.

### Export Controls

This device may contain commodities, technology or software subject to export laws and regulations from the US and other countries. Diversion contrary to law is prohibited.

FCC INDUSTRY CANADA NOTICE

Your device may cause TV or radio interference (for example, when using a telephone in close proximity to receiving equipment). The FCC or Industry Canada can require you to stop using your telephone if such interference cannot be eliminated. If you require assistance, contact your local service facility. This device complies with part 15 of the FCC rules. Operation is subject to the condition that this device does not cause harmful interference. Any changes or modifications not expressly approved by Nokia could void the user's authority to operate this equipment.

FCC DRAFT

# Contents

---

For your safety.....	6	Options during a call.....	20
<b>General information.....</b>	<b>9</b>	<b>4. Write text.....</b>	<b>21</b>
Overview of functions.....	9	Settings.....	21
Access codes.....	9	Predictive text input.....	21
Security code.....	9	Traditional text input.....	22
PIN codes.....	9	<b>5. Navigate the menus.....</b>	<b>23</b>
PUK codes.....	9	<b>6. Messages.....</b>	<b>24</b>
Restriction password.....	10	Text messages (SMS).....	24
Configuration settings.....	10	Write and send an SMS.....	25
Download content and applications.....	10	Read and reply to an SMS.....	25
Nokia support on the Web.....	10	Templates.....	26
<b>1. Get started.....</b>	<b>11</b>	Multimedia messages (MMS).....	26
Open the fold.....	11	Write and send a multimedia	
Install the SIM card and battery....	11	message.....	26
Charge the battery.....	12	Read and reply to a multimedia	
Switch the phone on and off.....	13	message.....	27
Plug and play service.....	13	Memory full.....	28
Normal operating position.....	13	Folders.....	28
<b>2. Your phone.....</b>	<b>14</b>	Voice messages.....	29
Keys and parts.....	14	Info messages.....	29
Standby mode.....	16	Service commands.....	29
Display.....	16	Delete messages.....	29
Personal shortcut list.....	16	Message settings.....	30
Shortcuts in the standby mode...	16	Text and SMS e-mail.....	30
Power saving.....	17	Multimedia.....	30
Indicators.....	17	Other settings.....	31
Keys lock (keyguard).....	17	Message counter.....	31
<b>3. Call functions.....</b>	<b>19</b>	<b>7. Call log.....</b>	<b>32</b>
Make a call.....	19	Recent calls lists.....	32
Use the keypad.....	19	Counters and timers.....	32
Use contacts.....	19	<b>8. Contacts.....</b>	<b>33</b>
Use 1-touch dialing.....	19	Find a contact.....	33
Answer or decline a call.....	19	Save names and phone numbers....	33
Call forwarding.....	20	Save numbers, items, or an image.	33
Call waiting.....	20	Copy contacts.....	34

Edit contact details.....	34	Game downloads.....	48
Delete contacts or contact details .	34	Game settings.....	48
Business cards.....	34	Collection.....	48
Settings.....	35	Launch an application.....	48
Groups.....	35	Other application options.....	48
1-touch dialing.....	35	Download an application.....	49
Info, service, and my numbers.....	35		
<b>9. Settings.....</b>	<b>36</b>	<b>13. Web.....</b>	<b>50</b>
Profiles.....	36	Set up browsing.....	50
Themes.....	36	Connect to the Web.....	50
Tones.....	36	Browse pages.....	51
Light settings.....	37	Browse with phone keys.....	51
My shortcuts.....	37	Options while browsing.....	51
Display.....	37	Direct calling.....	51
Time and date.....	38	Appearance settings.....	51
Call.....	38	Cookies.....	52
Phone.....	39	Scripts over secure connection.....	52
Connectivity.....	39	Bookmarks.....	53
Enhancements.....	40	Create a bookmark.....	53
Configuration.....	40	Receive a bookmark.....	53
Security.....	41	Download files.....	53
Restore factory settings.....	42	Service inbox.....	53
		Access service inbox.....	54
<b>10. Gallery.....</b>	<b>43</b>	Service inbox settings.....	54
<b>11. Organizer.....</b>	<b>44</b>	Cache memory.....	54
Alarm clock.....	44	Browser security.....	55
Set the alarm.....	44	Security module.....	55
Stop the alarm.....	44	Certificates.....	56
Calendar.....	44	Digital signature.....	56
Make a calendar note.....	45	<b>14. SIM services.....</b>	<b>58</b>
Note alarm.....	45	<b>15. Battery information.....</b>	<b>59</b>
To-do list.....	45	Charging and discharging.....	59
Notes.....	45	Nokia battery authentication	
Calculator.....	46	guidelines.....	60
Stopwatch.....	46	<b>Care and maintenance.....</b>	<b>62</b>
Countdown timer.....	47	<b>Additional safety information</b>	<b>63</b>
<b>12. Applications.....</b>	<b>48</b>	<b>Technical information.....</b>	<b>67</b>
Games.....	48		
Launch a game.....	48		

For your safety

## For your safety

---

Read these simple guidelines. Not following them may be dangerous or illegal. Read the complete user guide for further information.



### SWITCH ON SAFELY

Do not switch the phone on when wireless phone use is prohibited or when it may cause interference or danger.



### ROAD SAFETY COMES FIRST

Obey all local laws. Always keep your hands free to operate the vehicle while driving. Your first consideration while driving should be road safety.



### INTERFERENCE

All wireless phones may be susceptible to interference, which could affect performance.



### SWITCH OFF IN HOSPITALS

Follow any restrictions. Switch the phone off near medical equipment.



### SWITCH OFF IN AIRCRAFT

Follow any restrictions. Wireless devices can cause interference in aircraft.



### SWITCH OFF WHEN REFUELING

Do not use the phone at a refueling point. Do not use near fuel or chemicals.



### SWITCH OFF NEAR BLASTING

Follow any restrictions. Do not use the phone where blasting is in progress.



### USE SENSIBLY

Use only in the normal position as explained in the product documentation. Do not touch the antenna unnecessarily.



### QUALIFIED SERVICE

Only qualified personnel may install or repair this product.



### ENHANCEMENTS AND BATTERIES

Use only approved enhancements and batteries. Do not connect incompatible products.

## For your safety



### WATER-RESISTANCE

Your phone is not water-resistant. Keep it dry.



### BACK-UP COPIES

Remember to make back-up copies or keep a written record of all important information stored in your phone.



### CONNECTING TO OTHER DEVICES

When connecting to any other device, read its user guide for detailed safety instructions. Do not connect incompatible products.



### EMERGENCY CALLS

Ensure the phone is switched on and in service. Press the end key as many times as needed to clear the display and return to the start screen. Enter the emergency number, then press the call key. Give your location. Do not end the call until given permission to do so.

## ■ About your device

The wireless device described in this guide is approved for use on the GSM 900, 1800, and 1900 networks. Contact your service provider for more information about networks.

When using the features in this device, obey all laws and respect the privacy and legitimate rights of others.



**Warning:** To use any features in this device, other than the alarm clock, the device must be switched on. Do not switch the device on when wireless device use may cause interference or danger.

Your device and its enhancements may contain small parts. Keep them out of the reach of small children.

For availability of approved enhancements, please check with your dealer. When you disconnect the power cord of any enhancement, grasp and pull the plug, not the cord.

## ■ Network services

To use the phone you must have service from a wireless service provider. Many of the features in this device depend on features in the wireless network to function. These network services may not be available on all networks or you may have to make specific arrangements with your service provider before you can utilize network services. Your service provider may need to give you additional instructions for their use and explain what charges will apply. Some networks

## For your safety

may have limitations that affect how you can use network services. For instance, some networks may not support all language-dependent characters and services. Your service provider may have requested that certain features be disabled or not activated in your device. If so, they will not appear on your device menu. Your device may also have been specially configured. This configuration may include changes in menu names, menu order and icons. Contact your service provider for more information.

This device supports WAP 2.0 protocols (HTTP and SSL) that run on TCP/IP protocols. Some features of this device, such as text messages, multimedia messages, mobile Internet services, and content and application download, require network support for these technologies.

## ■ Shared memory

The phone has two memories. The following features may share the first memory: contacts, text messages, multimedia messages (but no attachments), groups, calendar, and to-do notes. The second shared memory is used by files stored in *Gallery*, attachments of multimedia messages, and Java™ applications. Use of one or more of these features may reduce the memory available for the remaining features sharing memory. For example, saving many Java applications may use all of the available memory. Your device may display a message that the memory is full when you try to use a shared memory feature. In this case, delete some of the information or entries stored in the shared memory features before continuing. Some of the features, such as text messages, may have a certain amount of memory specially allotted to them in addition to the memory shared with other features.

## ■ Enhancements

A few practical rules about accessories and enhancements are as follows:

- Keep all accessories and enhancements out of the reach of small children.
- When you disconnect the power cord of any accessory or enhancement, grasp and pull the plug, not the cord.
- Check regularly that enhancements installed in a vehicle are mounted and are operating properly.
- Installation of any complex car enhancements must be made by qualified personnel only.



## General information

---

### ■ Overview of functions

Your phone provides many functions that are practical for daily use, such as a calendar, clock, and alarm clock. Your phone also supports the following functions:

- Extensible hypertext markup language (XHTML) (See "Web," p. 50.)
- Java 2 Platform, Micro Edition (J2ME™) (See "Applications," p. 48.)

### ■ Access codes

#### Security code

The security code (5 to 10 digits) helps to protect your phone against unauthorized use. The preset code is 12345. To change the code and set the phone to request the code, see "Security," p. 41.

#### PIN codes

The personal identification number (PIN) code and the universal personal identification number (UPIN) code (4 to 8 digits) help to protect your SIM card against unauthorized use. See "Security," p. 41.

The PIN2 code (4 to 8 digits) may be supplied with the SIM card and is required for some functions.

The module PIN is required to access the information in the security module. See "Security module," p. 55.

The signing PIN is required for the digital signature. See "Digital signature," p. 56.

#### PUK codes

The personal unblocking key (PUK) code and the universal personal unblocking key (UPUK) code (8 digits) are required to change a blocked PIN code and UPIN code, respectively. The PUK2 code (8 digits) is required to change a blocked PIN2 code. If the codes are not supplied with the SIM card, contact your local service provider for the codes.

## General information

### **Restriction password**

The restriction password (4 digits) is required when using the *Call restrictions*. See "Security," p. 41.

### ■ **Configuration settings**

To use some of the network services, such as mobile Internet services and MMS, your phone needs the correct configuration settings. You may be able to receive the settings directly as a configuration message. After receiving the settings you need to save them on your phone. The service provider may provide a PIN that is needed to save the settings. For more information on availability, contact your network operator, service provider, nearest authorized Nokia dealer, or visit the support area on the Nokia Web site at [www.nokia.com/support](http://www.nokia.com/support).

When you have received a configuration message *Configuration sett. received %U* is displayed.

To save the settings, select Show > Save. If the phone requests *Enter settings' PIN;* enter the PIN code for the settings, and select OK. To receive the PIN code, contact the service provider that supplies the settings. If no settings are saved yet, these settings are saved and set as default configuration settings. Otherwise, the phone asks *Activate saved configuration settings?*

To discard the received settings, select Exit or Show > Discard.

To edit the settings, see "Configuration," p. 40.

### ■ **Download content and applications**

You may be able to download new content (for example, themes) to the phone (network service). Select the download function (for example, in the *Gallery* menu). To access the download function, see the respective menu descriptions. For availability, contact your network operator or service provider.



**Important:** Use only services that you trust and that offer adequate security and protection against harmful software.

### ■ **Nokia support on the Web**

Check [www.nokiausa.com/support](http://www.nokiausa.com/support) or your local Nokia Web site for the latest version of this guide, additional information, downloads, and services related to your Nokia product.

## 1. Get started

---

### ■ Open the fold

When you open the fold of the phone, it opens up to 154 degrees. Do not try to force the fold open more.

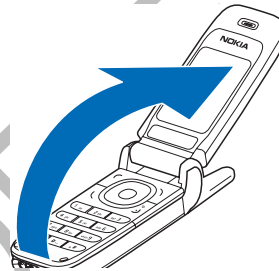

### ■ Install the SIM card and battery



**Note:** Always switch off the power and disconnect the charger and any other device before removing the covers. Avoid touching electronic components while changing the covers. Always store and use the device with the covers attached.

Keep all SIM cards out of the reach of small children. For availability and information on using SIM card services, contact your SIM card vendor. This may be the service provider, network operator, or other vendor.

This device is intended for use with the BL-5B battery.

The SIM card and its contacts can easily be damaged by scratches or bending, so be careful when handling, inserting, or removing the card.

To remove the back cover of the phone, slide the back cover to remove it from the phone (1).

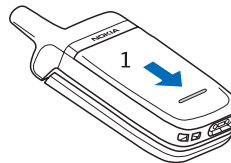

## Get started

Remove the battery as shown (2).

Release the SIM card holder (3).

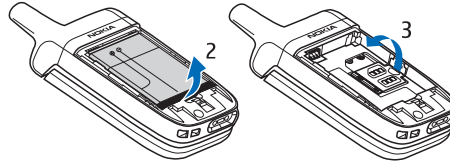

Insert the SIM card (4). Make sure that the SIM card is properly inserted, and that the gold-colored contact area on the card is facing downwards. Close the SIM card holder (5), and press it until it snaps into position.

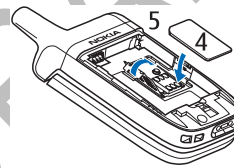

Insert the battery into the battery slot (6). See "Nokia battery authentication guidelines," p. 60.

Position the battery so the gold-colored contacts match up with those on the phone. Insert the battery into the battery slot. Snap the other end of the battery into place. Slide the back cover into its place (7).

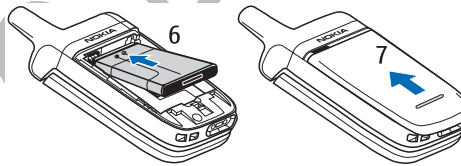

## ■ Charge the battery



**Warning:** Use only batteries, chargers, and enhancements approved by Nokia for use with this particular model. The use of any other types may invalidate any approval or warranty, and may be dangerous.

Check the model number of any charger before use with this device. This device is intended for use when supplied with power from the ACP-12 charger provided with your phone.

For availability of approved enhancements, please check with your dealer. When you disconnect the power cord of any enhancement, grasp and pull the plug, not the cord.

## Get started

1. Connect the charger to an ac wall socket.
2. Connect the lead from the charger to the socket on the bottom of your phone.

The charging time depends on the charger and the battery used.

If the battery is completely discharged, it may take a few minutes before the charging indicator appears on the display or before any calls can be made.

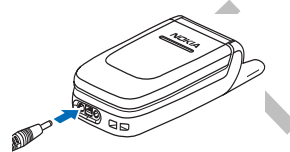

### ■ Switch the phone on and off



**Warning:** Do not switch the phone on when wireless phone use is prohibited or when it may cause interference or danger.

Press and hold the end key.

If the phone asks for a PIN or a UPIN code, enter the code (displayed as \*\*\*\*), and select *OK*.

### Plug and play service

When you switch on your phone for the first time, and the phone is in the standby mode, you are asked to get the configuration settings from your service provider (network service). Confirm or decline the query. See *Connect to service provider support* in "Configuration," p. 40 and "Configuration settings," p. 10.

### ■ Normal operating position

Use the phone only in its normal operating position.

Your device has an external antenna.



**Note:** As with any other radio transmitting device, do not touch the antenna unnecessarily when the device is switched on. Contact with the antenna affects call quality and may cause the device to operate at a higher power level than otherwise needed. Avoiding contact with the antenna area when operating the device optimizes the antenna performance and the battery life.

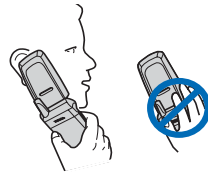

Your phone

## 2. Your phone

### ■ Keys and parts

- Earpiece (1)
- Display (2)
- Left selection key (3)
- Middle selection key (4)
- Right selection key (5)
- 4-way navigation key (6)
- Call key (7)
- End key and power key (8)
- Charger connector (9)
- Headset connector (10)
- Microphone (11)
- Eyelet for the wrist strap (12)

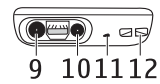
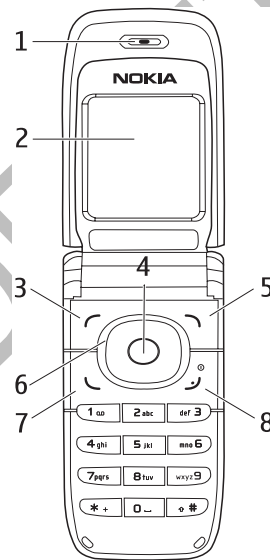

- Loudspeaker (13)
- Pulsating light (14)

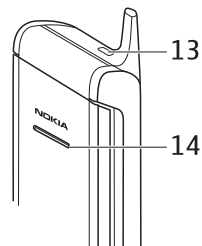

Your phone



**Note:** Avoid removing the cover of this connector and touching the connector as it is intended for use by authorized service people only.

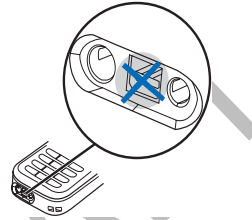

**Warning:** Certain parts of this device may contain nickel. It is not designed for prolonged contact with the skin. Continuous exposure to nickel on the skin may lead to nickel allergy.

FCC DRAFT

Your phone

## ■ Standby mode

When the phone is ready for use, and you have not entered any characters, the phone is in the standby mode.

### Display

- Name of the network or the operator logo (1)
- Signal strength of the cellular network at your current location (2)
- Battery charge level (3)
- The left selection key is Go to (4).
- The middle selection key is Menu (5).
- The right selection key is Names (6) or another shortcut to a function that you selected. See "My shortcuts," p. 37. Operator variants may have an operator-specific name to access an operator-specific Web site.

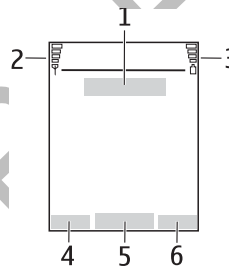

### Personal shortcut list

The left selection key is Go to.

To view the functions in the personal shortcut list, select Go to. To activate a function, select it.

To view a list with available functions, select Go to > Options > *Select options*.

To add a function to the shortcut list, select Mark. To remove a function from the list, select Unmark.

To rearrange the functions on your personal shortcut list, select Go to > Options > *Organize*. Select the desired function, Move, and the place where you want to move the function.

### Shortcuts in the standby mode

- To access the list of dialed numbers, press the call key once. Scroll to the number or name that you want; and to call the number, press the call key.
- To open the Web browser, press and hold 0.
- To call your voice mailbox, press and hold 1.
- Use the navigation key as a shortcut. See "My shortcuts," p. 37.







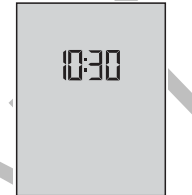

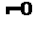

### Power saving

When the phone fold is opened, a digital clock view overwrites the display when no function of the phone has been used for a certain period of time. To activate the power saver, see *Power saver* in "Display," p. 37. To deactivate the screen saver, press any key.



### Indicators

-  You received one or several text or picture messages. See "Read and reply to an SMS," p. 25.
-  You received one or several multimedia messages. See "Read and reply to a multimedia message," p. 27.
-  The phone logged a missed call. See "Call log," p. 32.
-  The keys are locked. See "Keys lock (keyguard)," p. 17.
-  The phone does not ring for an incoming call or text message when *Incoming call alert* and *Message alert tone* are set to *Off*. See "Tones," p. 36.
-  The alarm clock is set to *On*. See "Alarm clock," p. 44.
-  When the packet data connection mode *Always online* is selected and the packet data service is available, the indicator is shown. See "Connectivity," p. 39.
-  A packet data connection is established. See "Connectivity," p. 39 and "Browse pages," p. 51.
-  The packet data connection is suspended (on hold), for example, if there is an incoming or outgoing call during a packet data dial-up connection.

### ■ Keys lock (keyguard)

To prevent the keys from being accidentally pressed, select **Menu**, and press \* within 1.5 seconds to lock the keys.

To unlock the keys, select **Unlock**, and press \*. If the *Security keyguard* is set *On*, enter the security code if requested.

#### Your phone

To answer a call when the keyguard is on, press the call key. When you end or decline the call, the keys automatically locks.

For *Automatic keyguard* and *Security keyguard*, see "Phone," p. 39.

When the keyguard is on, calls still may be possible to the official emergency number programmed into your device.

## 3. Call functions

---

### ■ Make a call

There are several convenient ways to dial a number.

#### Use the keypad

1. Enter the phone number, including the area code.  
For international calls, press \* twice for the international prefix (the + character replaces the international access code) and then enter the country code, the area code without the leading 0, if necessary, and the phone number.
2. To call the number, press the call key.
3. To end the call or to cancel the call attempt, press the end key, or close the fold of the phone.

#### Use contacts

To make a call using names, find the name or phone number in *Contacts*. See "Find a contact," p. 33. Press the call key to call the number.

To access the list of numbers you last called or attempted to call, press the call key once in the standby mode. To call the number, scroll to a number or name, and press the call key.

#### Use 1-touch dialing

Assign a phone number to one of the 1-touch dialing keys, 2 to 9.

See "1-touch dialing," p. 35. Call the number in either of the following ways:

- Press a 1-touch dialing key, then press the call key.
- If *1-touch dialing* is set to *On*, press and hold a 1-touch dialing key until the call begins. See *1-touch dialing* in "Call," p. 38.

### ■ Answer or decline a call

To answer an incoming call, press the call key, or open the phone fold when *Answer when fold is opened* is set *On*. See "Call," p. 38. To end the call, press the end key, or close the phone fold.

## Call functions

To decline an incoming call, press the end key, or if the phone fold is opened, close the fold of the phone. To decline an incoming call when the phone fold is closed, open the phone fold, and press the end key .

If a compatible headset supplied with the headset key is connected to the phone, to answer and end a call, press the headset key.

### Call forwarding

If the *Forward if busy* function is activated to forward calls (for example, to your voice mailbox), declining an incoming call also forwards the call. See "Call," p. 38.

### Call waiting

For availability, contact your network operator or service provider.

To answer the waiting call during an active call, press the call key. The first call is put on hold. To end the active call, press the end key.

To activate the *Call waiting* function, see "Call," p. 38.

## ■ Options during a call

Many of the options that you can use during a call are network services. For availability, contact your network operator or service provider.

During a call, select Options and from the following options:

Call options are *Mute or Unmute*, *Contacts*, *Menu*, *Auto volume on Lock keys*, *Loudspeaker or Handset*.

Network services options are *Answer and Decline*, *Hold or Unhold*, *New call*, *Add to conference*, *End call*, *End all calls*, and the following:

*Touch tones* – to send tone strings

*Swap* – to switch between the active call and the call on hold

*Transfer calls* – to connect a call on hold to an active call and disconnect yourself

*Conference* – to make a conference call that allows up to six persons to take part in a conference call

*Private call* – to discuss privately in a conference call





**Warning:** Do not hold the device near your ear when the loudspeaker is in use, because the volume may be extremely loud.

## 4. Write text

---

You can enter text (for example, when writing messages) using traditional or predictive text input. When using traditional text input, press a number key, 1 to 9, repeatedly until the desired character appears. In predictive text input you can enter a letter with a single keypress.

When you are writing text, predictive text input is indicated by  and traditional text input by  at the top left of the display. **Abc**, **abc**, or **ABC** appear next to the text input indicator, indicating the character case.

To change the character case and the text input mode, press #. **123** indicates number mode. To change from the letter mode to number mode, press and hold #, and select *Number mode*.

### ■ Settings

To set the writing language, select *Options > Writing language*. Predictive text input is only available for the languages listed.

Select *Options > Dictionary on* to set the predictive text input or *Dictionary off* to set traditional text input.

### ■ Predictive text input

Predictive text input is based on a built-in dictionary to which you can also add new words.

1. Start writing a word using the 2 to 9 keys. Press each key only once for a single letter. The word changes after each keypress.
2. When you have finished writing the word and it is correct, to confirm it, press 0 to add a space, or press any of the navigation keys. Press a navigation key to move the cursor.

If the word is not correct, press \* repeatedly, or select *Options > Matches*. When the word that you want appears, confirm it.

If ? is displayed after the word, the word you intended to write is not in the dictionary. To add the word to the dictionary, select *Spell*. Enter the word (traditional text input is used), and select *Save*.

3. Start writing the next word.

### Write text

To write compound words, enter the first part of the word, and press the right navigation key to confirm it. Write the last part of the word, and confirm the word.

### ■ Traditional text input

Press a number key, 1 to 9, repeatedly until the desired character appears. Not all characters available under a number key are printed on the key. The characters available depend on the writing language. See "Settings," p. 21.

If the next letter you want is located on the same key as the present one, wait until the cursor appears, or press any of the navigation keys and enter the letter. The most common punctuation marks and special characters are available under the 1 key.

## 5. Navigate the menus

---

The phone offers you an extensive range of functions, which are grouped into menus.

1. To access the menu, select Menu. To change the menu view, select Options > *Main menu view* > *List* or *Grid*.
2. Scroll through the menu, and select a submenu (for example, *Settings*).
3. If the menu contains submenus, select the one that you want (for example, *Call*).
4. If the selected menu contains further submenus, select the one that you want (for example, *Anykey answer*).
5. Select the setting of your choice.
6. To return to the previous menu level, select Back. To exit the menu, select Exit.

## 6. Messages



The message services can only be used if they are supported by your network or your service provider.



**Note:** When sending messages, your phone may display the words *Message sent*. This is an indication that the message has been sent by your device to the message center number programmed into your device. This is not an indication that the message has been received at the intended destination. For more details about messaging services, check with your service provider.



**Important:** Exercise caution opening messages. Messages may contain malicious software or otherwise be harmful to your device or PC.

Only devices that have compatible features can receive and display messages. The appearance of a message may vary depending on the receiving device.

### ■ Text messages (SMS)

You can use the short message service (SMS) to send and receive multipart messages made of several ordinary text messages (network service) that can contain pictures.

Before you can send any text, picture, or message, you must save your message center number. See "Message settings," p. 30.

To check SMS e-mail service availability and to subscribe to the service, contact your service provider.

Your device supports the sending of text messages beyond the character limit for a single message. Longer messages will be sent as a series of two or more messages. Your service provider may charge accordingly. Characters that use accents or other marks, and characters from some language options like Chinese, take up more space limiting the number of characters that can be sent in a single message.

At the top of the display, you can see the message length indicator that tracks the number of characters available. For example, 10/2 means that you can still add 10 characters for the text to be sent as two messages.





### Write and send an SMS

1. Select Menu > Messages > Create message > Text message.
2. Enter a message. See "Write text," p. 21. To insert text templates or a picture into the message, see "Templates," p. 26. Each picture message comprises several text messages. Sending one picture or multipart message may cost more than sending one text message.
3. To send the message, select Send > Recently used, To phone number, To many, or To e-mail address. To send a message using a predefined message profile, select Via sending profile. For the message profile, see "Text and SMS e-mail," p. 30. Select or enter a phone number or e-mail address, or select a profile.



**Note:** The picture message function can be used only if it is supported by your network operator or service provider. Only compatible devices that offer picture message features can receive and display picture messages. The appearance of a message may vary depending on the receiving device.



### Read and reply to an SMS

 is shown when you received an SMS message or an SMS e-mail. The blinking  indicates that the message memory is full. Before you can receive new messages, delete some of your old messages in the *Inbox* folder.

1. To view a new message, select Show. To view it later, select Exit.  
To read the message later, select Menu > Messages > Inbox. If more than one message is received, select the message that you want to read.  indicates an unread message.
2. While reading a message, select Options and delete or forward the message; edit the message as a text message or an SMS e-mail, rename the message you are reading or move it to another folder; or view or extract message details. You can also copy text from the beginning of the message to your phone calendar as a reminder note. To save the picture in the *Templates* folder when reading a picture message, select Options > Save picture.
3. To reply as a message, select Reply > Text message or Multimedia msg.. Enter the reply message. When replying to an e-mail, first confirm or edit the e-mail address and subject.
4. To send the message to the displayed number, select Send > OK.

## Messages

### Templates

Your phone has text templates  and picture templates  that you can use in text, picture, or SMS e-mail messages.

To access the template list, select Menu > Messages > Saved items > Text messages > Templates.

### ■ Multimedia messages (MMS)

A multimedia message can contain text, a picture, a calendar note, or a business card. If the message is too large, the phone may not be able to receive it. Some networks allow text messages that include an Internet address where you can view the multimedia message.

Only devices that have compatible features can receive and display multimedia messages. The appearance of a message may vary depending on the receiving device.

You cannot receive multimedia messages during a call, a game, another Java application, or an active browsing session over GSM data. Because delivery of multimedia messages can fail for various reasons, do not rely solely upon them for essential communications.

### Write and send a multimedia message

To set the settings for multimedia messaging, see "Multimedia," p. 30. To check availability and to subscribe to the multimedia messaging service, contact your service provider.

1. Select Menu > Messages > Create message > Multimedia msg..

2. Enter a message. See "Write text," p. 21.

To insert a file, select Options > Insert and from the following options:

*Image* — to insert a file from *Gallery*

*Sound Clip* — to insert a sound file from *Gallery*

*Business card* or *Calendar note* — to insert a business card or a calendar note in the message

*Slide* — to insert a slide to the message. Your phone supports multimedia messages that contain several pages (slides). Each slide can contain text, one image, a calendar note, and a business card. To open a desired slide if the message contains several slides, select Options > *Previous slide*, *Next slide*, or *Slide list*. To set the interval between the slides, select Options > *Slide timing*.

To move the text component to the top or bottom of the message, select *Options > Place text first* or *Place text last*.

The following options may also be available: *Delete* to delete an image or slide from the message, *Clear text*, *Preview*, or *Save message*. In *More options* the following options may be available: *Insert contact*, *Insert number*, *Message details*, and *Edit subject*.

3. To send the message, select *Send > Recently used*, *To phone number*, or *To many*.
4. Select the contact from the list, or enter the recipient's phone number or e-mail address, or find it in *Contacts*. Select OK. The message is moved to the *Outbox* folder for sending.

While the multimedia message is being sent, the animated indicator  is displayed, and you can use other functions on the phone. If the sending fails, the phone tries to resend it a few times. If this fails, the message remains in the *Outbox* folder, and you can try to resend it later.

If you select *Save sent messages > Yes*, the sent message is saved in the *Sent items* folder. See "Multimedia," p. 30. When the message is sent, it is not an indication that the message has been received at the intended destination.



Copyright protections may prevent some images, music (including ringing tones), and other content from being copied, modified, transferred, or forwarded.

### **Read and reply to a multimedia message**

The default setting of the multimedia message service is generally on.



**Important:** Exercise caution when opening messages. Multimedia message objects may contain malicious software or otherwise be harmful to your device or PC.

When your phone receives a multimedia message, the animated  is displayed. When the message has been received,  and *Multimedia message received* are shown.

1. To read the message, select *Show*. To view it later, select *Exit*.  
To read the message later, select *Menu > Messages > Inbox*. In the list of messages,  indicates an unread message. Select the message that you want to view.

## Messages

2. The function of the middle selection key changes according to the currently displayed attachment in the message.  
To view the whole message if the received message contains a presentation, select Play.  
To zoom in on an image, select Zoom. To view a business card or calendar note or to open a theme object, select Open.
3. To reply to the message, select Options > Reply > Text message, or Multimedia msg.. Enter the reply message, and select Send. You can send the reply message only to the person who sent you the original message.  
Select Options to access available options.

The wireless network may limit the size of MMS messages. If the inserted picture exceeds this limit, the device may make it smaller so that it can be sent by MMS.

### ■ Memory full

When you have received a new text message and the message memory is full,  blinks and *Text msgs. memory full. Delete msgs.* is shown. Select No, and delete some messages from a folder. To discard the waiting message, select Exit > Yes.

When you have a new multimedia message waiting and the memory for the messages is full,  blinks and *Multimedia memory full. View waiting msg.* is shown. To view the waiting message, select Show. Before you can save the waiting message, delete old messages to free memory space. To save the message, select Options > Saving message.

To discard the waiting message, select Exit > Yes. If you select No, you can view the message.

### ■ Folders

The phone saves received text and multimedia messages in the *Inbox* folder.

Multimedia messages that have not yet been sent are moved to the *Outbox* folder.

If you select *Message settings > Text messages > Save sent messages > Yes*, and *Message settings > Multimedia msgs. > Save sent messages > Yes*, the sent messages are saved in the *Sent items* folder.

## Messages

To save the text message that you are writing and wish to send later in the *Saved items* folder, select *Options > Save message > Saved text msgs.* For multimedia messages, select *Save message*.  indicates unsent messages.

To organize your text messages, you can move some of them to *My folders* or add new folders for your messages. Select *Messages > Saved items > Text messages > My folders*.

To add a folder, select *Options > Add folder*. If you have not saved any folders, select *Add*.

To delete or rename a folder, scroll to the desired folder, and select *Options > Delete folder* or *Rename folder*.

### ■ Voice messages

The voice mailbox is a network service and you may need to subscribe to it. For details, contact your service provider.

To call your voice mailbox, select *Menu > Messages > Voice messages > Listen to voice messages*. To enter, find, or edit your voice mailbox number, select *Voice mailbox number*.

If supported by the network,  indicates that there are new voice messages. Select *Listen* to call your voice mailbox number.

### ■ Info messages

Select *Menu > Messages > Info messages*. With the *Info messages* network service, you can receive messages on various topics from your service provider. To check availability, topics, and the relevant topic numbers, contact your service provider.

### ■ Service commands

Select *Menu > Messages > Service commands*. Write and send service requests (also known as USSD commands) to your service provider, such as activation commands for network services.

### ■ Delete messages

To delete all messages from a folder, select *Menu > Messages > Delete messages* and the folder from which you want to delete the messages. Select *Yes*, and if the

## Messages

folder contains unread messages, the phone asks whether you want to delete them also. Select *Yes* again.

### ■ Message settings

#### Text and SMS e-mail

The message settings affect the sending, receiving, and viewing of messages.

Select Menu > *Messages* > *Message settings* > *Text messages* and from the following options:

*Sending profile* — If more than one message profile set is supported by your SIM card, select the set you want to change.

The following options may be available: *Message center number* (delivered from your service provider), *Messages sent via*, *Message validity*, *Default recipient number* (text messages) or *E-mail server* (e-mail), *Delivery reports*, *Use packet data*, *Reply via same center* (network service), and *Rename sending profile*.

*Save sent messages* > *Yes* — Set the phone to save the sent text messages in the *Sent items* folder.

*Automatic resending* > *On* — The phone automatically attempts to resend a text message, if the sending has failed.

#### Multimedia

The message settings affect the sending, receiving, and viewing of multimedia messages.

Select Menu > *Messages* > *Message settings* > *Multimedia msgs.* and from the following options:

*Save sent messages* > *Yes* — to set the phone to save sent multimedia messages in the *Sent items* folder

*Delivery reports* — to ask the network to send delivery reports about your messages (network service)

*Scale image down* — to define the image size when you insert an image to a multimedia message

*Default slide timing* — to define the default time between slides in multimedia messages

*Allow multimedia reception* > *Yes* or *No* — to receive or to block the multimedia message. If you select *In home network*, you cannot receive multimedia messages when outside your home network.

## Messages

*Incoming multi-media messages > Retrieve, Retrieve manually, or Reject*— to allow the reception of multimedia messages automatically, manually after being prompted, or to reject the reception.

*Configuration settings > Configuration* — Only the configurations that support multimedia messaging are shown. Select a service provider, *Default*, or *Personal config.* for multimedia messaging. Select *Account* and a multimedia messaging service account contained in the active configuration settings.

*Allow advertisements* — to receive or reject advertisements. This setting is not shown if *Allow multimedia reception* is set to *No*.

### Other settings

To select other settings for messages, select *Menu > Messages > Message settings > Other settings*. To change the font size for reading and writing messages, select *Font size*. To replace character-based smileys with graphical ones, select *Graphical smileys > Yes*.

### ■ Message counter

Select *Menu > Messages > Message counter* for approximate information on your recent communications.

## 7. Call log

---

The phone logs the phone numbers of identified missed, received, and dialed calls; the message recipients; and the approximate length of your calls.

The phone logs if it is switched on and within the network service area, and the network supports these functions.

### ■ Recent calls lists

When you select Options in the *Missed calls*, *Received calls*, *Dialed numbers*, or *Message Recipients* menu, you can view the time of the call; edit, view, or call the logged phone number; add it to the memory; or delete it from the list. You can also send a text message. To delete the recent calls lists, select *Delete recent calls*.

### ■ Counters and timers



**Note:** The actual invoice for calls and services from your service provider may vary, depending upon network features, rounding-off for billing, taxes, and so forth.

Some timers, including the life timer, may be reset during service or software upgrades.

Select Menu > Call log > Call timers, Packet data counter, or Packet data conn. timer for approximate information on your recent communications.



## 8. Contacts



You can save names and phone numbers (*Contacts*) in the phone memory and SIM card memory.

The phone memory may save contacts with numbers and text items. You can also save an image for a certain number of names.

Names and numbers saved in the SIM card memory are indicated by .

### ■ Find a contact

Select Menu > *Contacts* > *Names* > Options > *Find*. Scroll through the list of contacts, or enter the first letter of the name for which you are searching.

### ■ Save names and phone numbers

Names and numbers are saved in the used memory. Select Menu > *Contacts* > *Names* > Options > *Add new contact*. Enter the name and the phone number.

### ■ Save numbers, items, or an image

In the phone memory for contacts, you can save different types of phone numbers and short text items per name.

The first number you save is automatically set as the default number. It is indicated with a frame around the number type indicator (for example, .

When you select a name (for example, to make a call), the default number is used unless you select another number.

1. Make sure that the memory in use is *Phone* or *Phone and SIM*.
2. Scroll to the name to which you want to add a new number or text item, and select Details > Options > *Add detail*.
3. To add a number, select *Number* and a number type.
  - To add another detail, select a text type or an image from *Gallery*.
  - To save the ID, select Options > *Save*. To enter the ID, select *Enter ID manually*.
  - To change the number type, scroll to the desired number, and select Options > *Change type*. To set the selected number as the default number, select *Set as default*.

## C o n t a c t s

4. Enter the number or text item; to save it, select OK.
5. To return to the standby mode, select Back > Exit.

### ■ Copy contacts

Find the contact you want to copy, and select Options > Copy. You can copy names and phone numbers from the phone contact memory to the SIM card memory, or vice versa. The SIM card memory can save names with one phone number attached to them.

### ■ Edit contact details

1. Find the contact you want to edit, select Details, and scroll to the desired name, number, text item, or image.
2. To edit a name, number, or text item, or to change an image, select Options > Edit name, Edit number, Edit detail, or Change image.

### ■ Delete contacts or contact details

To delete all the contacts and the details attached to them from the phone or SIM card memory, select Menu > Contacts > Delete all contacts > From phone mem. or From SIM card. Confirm with the security code.

To delete a contact, find the desired contact, and select Options > Delete contact.

To delete a number, text item, or an image attached to the contact, find the contact, and select Details. Scroll to the desired detail, and select Options > Delete > Delete number, Delete detail, or Delete image. Deleting an image from contacts does not delete it from Gallery.

### ■ Business cards

You can send and receive a person's contact information from a compatible device that supports the vCard standard as a business card.

To send a business card, find the contact whose information you want to send, and select Details > Options > Send bus. card > Via multimedia or Via text message.

When you have received a business card, select Show > Save to save the business card in the phone memory. To discard the business card, select Exit > Yes.

## ■ Settings

Select **Menu > Contacts > Settings** and from the following options:

*Memory in use* – to select the SIM card or phone memory for your contacts

*Contacts view* – to select how the names and numbers in contacts are displayed

*Memory status* – to view the free and used memory capacity

## ■ Groups

Select **Menu > Contacts > Groups** to arrange the names and phone numbers saved in the memory into caller groups with different ringing tones and group images.

## ■ 1-touch dialing

To assign a number to a 1-touch dialing key, select **Menu > Contacts > 1-touch dialing**, and scroll to the 1-touch dialing number that you want.

Select *Assign*, or if a number has already been assigned to the key, select **Options > Change**. Select **Find**, the name, then the number you want to assign. If the *1-touch dialing* function is off, the phone asks whether you want to activate it. See also *1-touch dialing* in "Call," p. 38.

To make a call using the 1-touch dialing keys, see "Use 1-touch dialing," p. 19.

## ■ Info, service, and my numbers

Select **Menu > Contacts** and from the following functions:

*Info numbers* – to call the information numbers of your service provider if the numbers are included on your SIM card (network service)

*Service numbers* – to call the service numbers of your service provider if the numbers are included on your SIM card (network service)

*My numbers* – to view the phone numbers assigned to your SIM card if the numbers are included on your SIM card

## 9. Settings

---

### ■ Profiles

Your phone has various setting groups, called profiles, for which you can customize the phone tones for different events and environments.

Select **Menu > Settings > Profiles**. Scroll to a profile, and select it.

To activate the selected profile, select *Activate*.

To set the profile to be active until a certain time up to 24 hours, select *Timed* and set the time the profile setting shall end. When the time set for the profile expires, the previous profile that was not timed becomes active.

To personalize the profile, select *Customize*. Select the setting you want to change, and make the changes.

### ■ Themes

A theme contains many elements for customizing your phone, such as wallpaper, screen saver, color scheme, and a ringing tone (your phone support MP3 format ringing tone).

Select **Menu > Settings > Themes** and from the following options:

*Select theme* – to set a theme in your phone. A list of folders in *Gallery* opens.

Open the *Themes* folder, and select a theme.

*Theme downloads* – to open a list of links to download more themes. See "Download files," p. 53.

### ■ Tones

You can change the settings of the selected active profile.

Select **Menu > Settings > Tones**. Select and change *Incoming call alert*, *Ringtone*, *Ringtone volume*, *Vibrating alert*, *Message alert tone*, *Keys tones*, and *Warning tones*. You can find the same settings in the *Profiles* menu. See "Profiles," p. 36.

To set the phone to ring only for calls from phone numbers that belong to a selected caller group, select *Alert for*. Scroll to the caller group you want or *All calls*, and select *Mark*.

## ■ Light settings

When the fold is closed, the pulsating light notifies you of the phone status (for example, an incoming call) if the *Light effects* is set *On*. To set the pulsating light on, select Menu > Settings > Lights > Light effects > On.

## ■ My shortcuts

With personal shortcuts, you get quick access to often used functions of the phone. To manage the shortcuts, select Menu > Settings > My shortcuts and from the following options:

*Right selection key* – to select a function from the list for the right selection key. See also "Standby mode," p. 16. This menu may not be shown, depending on your service provider.

*Navigation key* – to select shortcut functions for the navigation key. Scroll to the desired navigation key, and select Change and a function from the list. To remove a shortcut function from the key, select *(empty)*. To reassign a function for the key, select Assign. This menu may not be shown, depending on your service provider.

## ■ Display

Select Menu > Settings > Display settings and from the following options:

*Wallpaper* – to add the background image to the display in the standby mode. To select, activate, or deactivate the wallpaper, select *Image, On or Off*. Select *Slide set* and a folder in the *Gallery* to use the images in the folder as a slide set. To download more images for wallpaper, select *Graphic downloads*.

*Screen saver > On* – to activate the screen saver for the display. To set the time after which the screen saver is activated, select *Time-out*. To select a graphic for the screen saver, select *Screen savers > Image* and choose an image or a graphic from the *Gallery*. Select *Screen savers > Slide set* and a folder in the *Gallery* to use the images in the folder as a slide set. To download more images for the screen saver, select *Graphic downloads*.

*Power saver > On* – to save some battery power. A digital clock is displayed when no function of the phone is used for a certain time.

*Color schemes* – to change the color in some display components, for example, menu background color and signal and battery bar colors

*Idle state font color* – to select the color for the texts on the display in the standby mode

## Settings

*Operator logo* — to set your phone to display or hide the operator logo. The menu is dimmed if you have not saved the operator logo. For more information on availability of an operator logo, contact your network operator or service provider.

### ■ Time and date

Select Menu > Settings > Time and date and from the following options:

*Clock* — to set the phone to show the clock in the standby mode, adjust the clock, and select the time zone and the time format

*Date* — to set the phone to show the date in the standby mode, set the date, and select the date format and date separator

*Auto-update of date & time (network service)* — to set the phone to automatically update the time and date according to the current time zone

### ■ Call

Select Menu > Settings > Call and from the following options:

*Automatic volume control* — to set the phone to automatically adjust the speaker volume according to the background noise

*Call forwarding (network service)* — to forward your incoming calls. You may not be able to forward your call, if some call restriction functions are active. See *Call restrictions* in "Security," p. 41.

*Anykey answer > On* — to answer an incoming call, briefly press any key, except the end key and the left and right selection keys.

*Answer when fold is opened > On* — to answer an incoming call directly when the phone fold is opened.

*Automatic redial > On* — to set your phone to make a maximum of 10 attempts to connect the call after an unsuccessful call attempt

*1-touch dialing > On* — to activate 1-touch dialing. To set up 1-touch dialing, see "1-touch dialing," p. 35. To dial, press and hold the corresponding number key.

*Call waiting > Activate* — to set the network to notify you of an incoming call while you have a call in progress (network service). See "Call waiting," p. 20.

*Summary after call > On* — to briefly display the approximate duration and cost (network service) of the call after each call

*Send my caller ID (network service) > Set by network or Yes, No*

*Line for outgoing calls (network service)* — to select the phone line 1 or 2 to make calls, if supported by your SIM card

## ■ Phone

Select *Menu* > *Settings* > *Phone* and from the following options:

*Phone language* — to set the display and writing language

*Memory status* — to view the free memory and the used memory in *Gallery*, *Messages*, and *Applications*

*Automatic keyguard* — to set the keys of your phone to lock automatically after a preset time delay when the phone is in the standby mode and no function of the phone has been used. Select *On*, and you can set the time from 5 seconds to 60 minutes.

*Security keyguard* — to set the phone to ask for the security code when you unlock the keyguard. Enter the security code, confirm it, and select *On*.

*Cell info display* > *On* — to receive information from the network operator depending on the network cell used (network service)

*Welcome note* — to enter a welcome note to be shown briefly when the phone is switched on

*Operator selection* > *Automatic* — to set the phone automatically to select one of the cellular networks available in your area. With *Manual*, you can select a network that has a roaming agreement with your home network operator.

*Confirm SIM service actions* — See "SIM services," p. 58.

*Help text activation* — to select whether the phone shows help texts

*Start-up tone* — to select whether the phone plays a start-up tone when the phone is switched on

## ■ Connectivity

General packet radio service (GPRS) is a network service that allows mobile phones to be used for sending and receiving data over an Internet protocol (IP)-based network. GPRS is a data bearer that enables wireless access to data networks such as the Internet.

The applications that may use GPRS are MMS, browsing, and Java application downloading.

Before you can use GPRS technology, contact your network operator or service provider for availability of and subscription to the GPRS service. Save the GPRS settings for each of the applications used over GPRS. For information on pricing, contact your network operator or service provider.

## Settings

Select Menu > *Settings* > *Connectivity* > *Packet data* > *Packet data connection* to establish an GPRS connection.

To set the phone to automatically register to an GPRS network when you switch on the phone, select *Always online*.

To set the phone to register to an GPRS network and establish a connection when an application needs it, and end the connection when you end the application, select *When needed*.

### ■ Enhancements

This menu is shown only if the phone is or has been connected to a compatible mobile enhancement.

Select Menu > *Settings* > *Enhancements*. You can select an enhancement menu if the corresponding enhancement is, or has been connected to the phone.

Depending on the enhancement, select from the following options:

*Default profile* — to select the profile that you want to be automatically activated when you connect to the selected enhancement

*Automatic answer* — to set the phone to answer an incoming call automatically after 5 seconds. If *Incoming call alert* is set to *Beep once* or *Off*, automatic answer is off.

*Lights* — to set the lights permanently *On*. Select *Automatic* to set the lights on for 15 seconds after a keypress.

*TTY/TDD* > *Use TTY* > *Yes* — to use the TTY settings instead of headset or loopset settings

### ■ Configuration

You can configure your phone with settings that are required for certain services to function correctly. The services are browser and multimedia messaging. Get the settings from your SIM card, from a service provider as a configuration message, or enter your personal settings manually.

To save the configuration settings received by a configuration message from a service provider, see "Configuration settings," p. 10.

Select Menu > *Settings* > *Configuration* and from the following options:

*Default configuration settings* — to view the service providers saved in the phone. Scroll to a service provider, and select *Details* to view the applications that the configuration settings of this service provider support. To set the configuration



settings of the service provider as default settings, select *Options > Set as default*. To delete configuration settings, select *Delete*.

*Activate default in all applications* — to activate the default configuration settings for supported applications

*Preferred access point* — to view the saved access points. Scroll to an access point, and select *Options > Details* to view the name of the , data bearer, and packet data access point .

*Connect to service provider support* — to download the configuration settings from your service provider

*Personal configuration settings* — to add new personal accounts for various services manually, and to activate or delete them. To add a new personal account if you have not added any, select *Add new*; otherwise, select *Options > Add new*. Select the service type, and select and enter each of the required parameters. The parameters differ according to the selected service type. To delete or activate a personal account, scroll to it, and select *Options > Delete* or *Activate*.

## ■ Security

When security features that restrict calls are in use (such as call restriction, closed user group, and fixed dialing) calls still may be possible to the official emergency number programmed into your device.

Select *Menu > Settings > Security* and from the following options:

*PIN code request* — to set the phone to ask for your PIN or UPIN code every time the phone is switched on. Some SIM cards do not allow the code request to be turned off.

*Call restrictions* (network service) — to restrict incoming calls to and outgoing calls from your phone. A restriction password is required.

*Fixed dialing* — to restrict your outgoing calls to selected phone numbers if this function is supported by your SIM card

*Closed user group* (network service) — to specify a group of people whom you can call and who can call you

*Security level > Phone* — the phone asks for the security code whenever a new SIM card is inserted into the phone. Select *Memory* and the phone asks for the security code when SIM card memory is selected and you want to change the memory in use.

*Access codes* — to set the PIN code or UPIN code in use or to change the security code, PIN code, UPIN code, PIN2 code, and restriction password

## Settings

*Code in use* – to select whether the PIN code or UPIN code should be active

*Pin2 code request* – to select whether the PIN2 code is required when using a specific phone feature which is protected by the PIN2 code

### ■ Restore factory settings

To reset some of the menu settings to their original values, select *Menu > Settings > Restore settings*. Enter the security code. The data you have entered or downloaded is not deleted, for example, the names and phone numbers saved in *Contacts*.

## 10. Gallery

---



In this menu you can manage graphics, images, themes, and tones. These files are arranged in folders.

Your phone supports an activation key system to protect acquired content. Always check the delivery terms of any content and activation key before acquiring them, as they may be subject to a fee.

Copyright protections may prevent some images, music (including ringing tones), and other content from being copied, modified, transferred, or forwarded.

To see the list of folders, select Menu > *Gallery*.

To see the available options of a folder, select a folder > Options.

To view the list of files in a folder, select a folder > Open.

To see the available options of a file, select a file > Options.

Some of the files may be protected by an activation key.

To update the activation key of the selected file, select Options > *Activate content*. The option is only shown if the activation key updating is supported by the file.

To view the list of all available activation keys, select Options > *Activation key list*. You can delete the activation keys (for example, delete the expired ones).

## 11. Organizer

---



### ■ Alarm clock

You can set the phone to alarm at a desired time. Select Menu > *Organizer* > *Alarm clock*.

#### Set the alarm

To set the alarm, select *Alarm time*, and enter the alarm time. To change the alarm time when the alarm time is set, select *On*. To set the phone to alert you on selected days of the week, select *Repeat alarm*.

To select the alarm tone, select *Alarm tone*.

To set a snooze time-out, select *Snooze time-out*.

#### Stop the alarm

The phone sounds an alert tone, and flashes *Alarm!* and the current time on the display, even if the phone was switched off. To stop the alarm, select *Stop*. If you let the phone continue to sound the alarm for a minute or select *Snooze*, the alarm stops for the selected snooze time-out, then resumes.

If the alarm time is reached while the device is switched off, the device switches itself on and starts sounding the alarm tone. If you select *Stop*, the device asks whether you want to activate the device for calls. Select *No* to switch off the device or *Yes* to make and receive calls. Do not select *Yes* when wireless phone use may cause interference or danger.

### ■ Calendar

Select Menu > *Organizer* > *Calendar*.

The current day is indicated by a frame. If there are any notes set for the day, the day is in bold type. To view the day notes, select *View*. To view a week, select *Options* > *Week view*. To delete all notes in the calendar, select the month or week view, and select *Options* > *Delete all notes*.

Other options for the day view may be *Make a note*, *Delete*, *Edit*, *Move*, or *Repeat* a note; *Copy* a note to another day; *Send note* as a text message, as a multimedia message, or to the calendar of another compatible phone. In *Settings* you can set

the date and time settings. In *Auto-delete notes* you can set the phone to delete old notes automatically after a specified time.

### **Make a calendar note**

Select *Menu > Organizer > Calendar*. Scroll to the date you want, and select *Options > Make a note* and one of the following note types:

 *Meeting*,  *Call*,  *Birthday*,  *Memo*, or  *Reminder*.

### **Note alarm**

The phone beeps and displays the note. With a call note  on the display, to call the displayed number, press the call key. To stop the alarm and to view the note, select *View*. To stop the alarm for approximately 10 minutes, select *Snooze*. To stop the alarm without viewing the note, select *Exit*.

### **■ To-do list**

To save notes for tasks that you must do, select *Menu > Organizer > To-do list*.

To create a note if no note is added, select *Add note*; otherwise, select *Options > Add*. Write the note, and select *Save*. Select the priority, the deadline, and the alarm type for the note.

To view a note, scroll to it, and select *View*.

You can also select an option to delete the selected note and delete all the notes that you have marked as done. You can sort the notes by priority or by deadline, send a note to another phone as a text message or a multimedia message, save a note as a calendar note, or access the calendar.

While viewing a note, you can also select an option to edit the deadline or priority for the note or mark the note as done.

### **■ Notes**

To use this application for writing and sending notes, select *Menu > Organizer > Notes*. To create a note if no note is added, select *Add note*; otherwise, select *Options > Make a note*. Write a note, and select *Save*.

Other options for notes include deleting and editing a note. While editing a note, you can also exit the text editor without saving the changes. You can send the note to compatible devices using a text message or multimedia message.

## Organizer

### ■ Calculator

The calculator in your phone adds, subtracts, multiplies, divides, calculates the square and the square root, and converts currency values.



**Note:** This calculator has limited accuracy and is designed for simple calculations.

Select **Menu > Organizer > Calculator**. When 0 is displayed on the screen, enter the first number in the calculation. Press # for a decimal point. Select **Options > Add, Subtract, Multiply, Divide, Square, Square root, or Change sign**. Enter the second number. For a total, select **Equals**. Repeat this sequence as many times as it is necessary. To start a new calculation, first select and hold **Clear**.

To perform a currency conversion, select **Menu > Organizer > Calculator**. To save the exchange rate, select **Options > Exchange rate**. Select either of the displayed options. Enter the exchange rate, press # for a decimal point, and select **OK**. The exchange rate remains in the memory until you replace it with another one. To perform the currency conversion, enter the amount to be converted, and select **Options > To home or To foreign**.



**Note:** When you change base currency, you must enter the new rates because all previously set exchange rates are set to zero.

### ■ Stopwatch

To measure time, take intermediate times, or take lap times, use the stopwatch. During timing, the other functions of the phone can be used. To set the stopwatch timing in the background, press the end key.

Using the stopwatch or allowing it to run in the background when using other features increases the demand on battery power and reduces the battery life.

Select **Menu > Organizer > Stopwatch** and from the following options:

*Split timing* – to take intermediate times. To start the time observation, select **Start**. Select **Split** every time that you want to take an intermediate time. To stop the time observation, select **Stop**. To save the measured time, select **Save**. To start the time observation again, select **Options > Start**. The new time is added to the previous time. To reset the time without saving it, select **Reset**. To set the stopwatch timing in the background, press the end key.

*Lap timing* – to take lap times. To set the stopwatch timing in the background, press the end key.

*Continue* – to view the timing that you have set in the background

## Organizer

*Show last time* – to view the most recently measured time if the stopwatch is not reset

*View times* or *Delete times* – to view or delete the saved times

### ■ Countdown timer

Select *Menu > Organizer > Countdown Timer*. Enter the alarm time in hours, minutes, and seconds, and select OK. If you wish, write your own note text that is displayed when the time expires. To start the countdown timer, select *Start*. To change the countdown time, select *Change time*. To stop the timer, select *Stop timer*.

If the alarm time is reached when the phone is in the standby mode, the phone sounds a tone and flashes the note text if it is set or *Countdown completed*. To stop the alarm, press any key. If no key is pressed, the alarm automatically stops within 60 seconds. To stop the alarm and to delete the note text, select *Exit*. To restart the countdown timer, select *Restart*.

## 12. Applications

---



### ■ Games

Your phone software includes some games.

#### Launch a game

Select *Menu > Applications > Games*. Scroll to the desired game, and select *Open*. For options related to a game, see "Other application options," p. 48.

#### Game downloads

Select *Menu > Applications > Options > Downloads > Game downloads*. The list of available bookmarks is shown. Select *More bookmarks* to access the list of bookmarks in the *Web* menu. See "Bookmarks," p. 53.



**Important:** Only install and use applications and other software from sources that offer adequate security and protection against harmful software.

#### Game settings

To set sounds, lights, and shakes for the game, select *Menu > Applications > Options > App. settings*.

### ■ Collection

Your phone software includes some Java applications specially designed for this Nokia phone.

#### Launch an application

Select *Menu > Applications > Collection*. Scroll to an application, and select *Open*; or press the call key.

#### Other application options

*Delete* – to delete the application or application set from the phone

*Details* – to view additional information about the application



## Applications

*Update version* – to check if a new version of the application is available for download from *Web* (network service)

*Web page* – to provide further information or additional data for the application from an Internet page. This feature must be supported by the network. It is only shown if an Internet address has been provided with the application.

*App. access* – to restrict the application from accessing the network. Different categories are shown. Select in each category, if available, one of the following permissions: *Ask every time* to set the phone to always ask for network access, *Ask first time only* to set the phone to ask for network access only on the first attempt, *Always allowed* to allow the network access, or *Not allowed* to not allow the network access.

### **Download an application**

Your phone supports J2ME Java applications. Make sure that the application is compatible with your phone before downloading it.



**Important:** Only install and use applications and other software from sources that offer adequate security and protection against harmful software.

You can download new Java applications in different ways.

Select **Menu** > *Applications* > **Options** > *Downloads* > *App. downloads*. The list of available bookmarks is shown. Select *More bookmarks* to access the list of bookmarks in the *Web* menu. Select the appropriate bookmark to connect to the desired page. For the availability of different services, pricing, and tariffs, contact your service provider.

Select **Menu** > *Web* > *Downloads*. Download an appropriate application or game. See "Download files," p. 53.

Use the game download function. See "Game downloads," p. 48.

Your device may have some bookmarks loaded for sites not affiliated with Nokia. Nokia does not warrant or endorse these sites. If you choose to access them, you should take the same precautions, for security or content, as you would with any Internet site.

## 13. Web

---



You can access various mobile Internet services with your phone browser.



**Important:** Use only services that you trust and that offer adequate security and protection against harmful software.

Check the availability of these services, pricing, tariffs, and instructions with your service provider.

With the phone browser you can view the pages that use wireless markup language (WML) or extensible hypertext markup language (XHTML) on their pages. Appearance may vary due to screen size. You may not be able to view all details of the Internet pages.

### ■ Set up browsing

You may receive the configuration settings required for browsing as a configuration message from the network operator or service provider that offers the service that you want to use. See "Configuration settings," p. 10. You can also enter all the configuration settings manually. See "Configuration," p. 40.

### ■ Connect to the Web

First, verify that the correct configuration settings of the service that you want to use are activated.

1. To select the settings for connecting to the service, select *Menu > Web > Settings > Configuration settings*.
2. Select *Configuration*. Only the configurations that support browsing the Web are shown. Select a service provider, *Default*, or *Personal config* for browsing. See "Set up browsing," p. 50.

Select *Account* and a Web account contained in the active configuration settings.

Select *Display terminal window > Yes* to perform manual user authentication for intranet connections.



Secondly, make a connection to the Web in one of the following ways:

- Select *Menu > Web > Home*; or in the standby mode, press and hold 0.
- To select a bookmark of the page, select *Menu > Web > Bookmarks*.

- To select the last URL, select Menu > Web > Last web address.
- To enter the address of the page, select Menu > Web > Go to address, enter the address of the page, and select OK.

## ■ Browse pages

After you make a connection to the Web, you can start browsing its pages. The function of the phone keys may vary in different services. Follow the text guides on the phone display. For more information, contact your service provider.

If packet data is selected as the data bearer,  is shown on the top left of the display during browsing. If you receive a call or a text message, or make a call during a packet data connection,  is shown on the top right of the display to indicate that the packet data connection is suspended (on hold). After a call the phone tries to reconnect the packet data connection.

### Browse with phone keys

Use the navigation keys to browse through the page.

To select a highlighted item, press the call key, or select Select.

To enter letters and numbers, press the 0 to 9 keys. To enter special characters, press \*.

### Options while browsing

Nokia.com, Home, Shortcuts, Add bookmark, Bookmarks, Page options, History, Downloads, Other options, Save to folder, Reload, and Quit may be available. The service provider may also offer other options.

### Direct calling

The browser supports functions that you can access while browsing. You can make a phone call, send touch tones while a voice call is in progress, and save a name and a phone number from a page.

## ■ Appearance settings

While browsing, select Options > Other options > Appear. settings; or in the standby mode, select Menu > Web > Settings > Appearance settings and from the following options:

## Web

*Text wrapping* > *On* — to set the text to continue on the next line on the display. If you select *Off*, the text is abbreviated.

*Font size* > *Extra small, Small, or Medium* — to set the font size

*Show images* > *No* — to hide pictures on the page. This can speed up the browsing of pages that contain a lot of pictures.

*Alerts* > *Alert for unsecure connection* > *Yes* — to set the phone to alert when an encrypted connection changes to unencrypted during browsing.

*Alerts* > *Alert for unsecure items* > *Yes* — to set the phone to alert when an encrypted page contains an unsecure item. These alerts do not guarantee a secure connection. For more information, see "Browser security," p. 55.

*Character encoding* > *Content encoding* — to select the encoding for the browser page content

*Character encoding* > *Unicode (UTF-8) web addresses* > *On* — to set the phone to send a URL as a UTF-8 encoding. You may need this setting when you access a Web page created in a foreign language.

*Screen Size* > *Full or Small* — to set the screen size

### ■ Cookies

A cookie is data that a site saves in the cache memory of your phone. Cookies are saved until you clear the cache memory. See "Cache memory," p. 54.

While browsing, select *Options* > *Other options* > *Security* > *Cookie settings*; or in the standby mode, select *Menu* > *Web* > *Settings* > *Security settings* > *Cookies*. To allow or prevent the phone from receiving cookies, select *Allow* or *Reject*.

### ■ Scripts over secure connection

You can select whether to allow the running of scripts from a secure page. The phone supports WML scripts.

1. While browsing, select *Options* > *Other options* > *Security* > *Script settings*; or in the standby mode, select *Menu* > *Web* > *Settings* > *Security settings* > *Scripts over secure connection*.
2. To allow the scripts, select *Allow*.

## ■ Bookmarks

### Create a bookmark

You can save page addresses as bookmarks in the phone memory.

1. While browsing, select **Options** > *Bookmarks*; or in the standby mode, select **Menu** > *Web* > *Bookmarks*.
2. Scroll to a bookmark, and select it; or press the call key to make a connection to the page associated with the bookmark.
3. Select **Options** to view, edit, delete, or send the bookmark; create a new bookmark; or save the bookmark to a folder.

Your device may have some bookmarks loaded for sites not affiliated with Nokia. Nokia does not warrant or endorse these sites. If you choose to access them, you should take the same precautions, for security or content, as you would with any Internet site.

### Receive a bookmark

When you have received a bookmark that is sent as a bookmark, *1 bookmark received* is displayed. To save the bookmark, select **Show** > *Save*. To view or delete the bookmark, select **Options** > *View* or *Delete*. To discard the bookmark directly after you have received the bookmark, select **Exit** > *OK*.

## ■ Download files

To download more tones, images, games, or applications to your phone (network service), select **Menu** > *Web* > *Downloads* > *Tone downloads*, *Graphic downloads*, *Game downloads*, *Theme downloads*, or *App. downloads*.



**Important:** Only install and use applications and other software from sources that offer adequate security and protection against harmful software.

To save all downloaded files automatically in the appropriate folders in *Gallery* or in *Applications*, select **Menu** > *Web* > *Settings* > *Downloading settings* > *Automatic saving* > *On*.

## ■ Service inbox

The phone is able to receive service messages (pushed messages) sent by your service provider (network service). Service messages are notifications (for

## Web

example, news headlines), and they may contain a text message or an address of a service.

### Access service inbox

To access the *Service inbox* in the standby mode, when you have received a service message, select *Show*. If you select *Exit*, the message is moved to the *Service inbox*. To access the *Service inbox* later, select *Menu > Web > Service inbox*.

To access the *Service inbox* while browsing, select *Options > Other options > Service inbox*. Scroll to the message you want, and to activate the browser and download the marked content, select *Retrieve*. To display detailed information on the service notification or to delete the message, select *Options > Details* or *Delete*.

### Service inbox settings

Select *Menu > Web > Settings > Service inbox settings*.

To set whether you want to receive service message, select *Service messages > On* or *Off*.

To set the phone to receive service messages only from content authors approved by the service provider, select *Message filter > On*. To view the list of the approved content authors, select *Trusted channels*.

To set the phone to automatically activate the browser from the standby mode when the phone has received a service message, select *Automatic connection > On*. If you select *Off*, the phone activates the browser only after you select *Retrieve* when the phone has received a service message.

## ■ Cache memory

A cache is a memory location that is used to store data temporarily. If you have tried to access or have accessed confidential information requiring passwords, empty the cache after each use. The information or services you have accessed is stored in the cache.

To empty the cache, while browsing, select *Options > Other options > Clear the cache*; in the standby mode, select *Menu > Web > Clear the cache*.

## ■ Browser security

Security features may be required for some services, such as online banking or shopping. For such connections you need security certificates and possibly a security module, which may be available on your SIM card. For more information, contact your service provider.

### Security module

The security module improves security services for applications requiring a browser connection, and allows you to use a digital signature. The security module may contain certificates as well as private and public keys. The certificates are saved in the security module by the service provider.

Select Menu > Web > Settings > Security settings > Security module settings and from the following options:

*Security module details* — to show the security module title, status, manufacturer, and serial number

*Module PIN request* — to set the phone to ask for the module PIN when using services provided by the security module. Enter the code, and select *On*. To disable the module PIN request, select *Off*.

*Change module PIN* — to change the module PIN, if allowed by the security module. Enter the current module PIN code; then enter the new code twice.

*Change signing PIN* — to change the signing PIN code for the digital signature. Select the signing PIN you want to change. Enter the current PIN code; then enter the new code twice.

See also "Access codes," p. 9.

## Certificates



**Important:** Even if the use of certificates makes the risks involved in remote connections and software installation considerably smaller, they must be used correctly in order to benefit from increased security. The existence of a certificate does not offer any protection by itself; the certificate manager must contain correct, authentic, or trusted certificates for increased security to be available. Certificates have a restricted lifetime. If Expired certificate or Certificate not valid yet is shown even if the certificate should be valid, check that the current date and time in your device are correct.

Before changing any certificate settings, you must make sure that you really trust the owner of the certificate and that the certificate really belongs to the listed owner.

There are three kinds of certificates: server certificates, authority certificates, and user certificates. You may receive these certificates from your service provider. Authority certificates and user certificates may also be saved in the security module by the service provider.

To view the list of the authority or user certificates downloaded into your phone, select *Menu > Web > Settings > Security settings > Authority certificates or User certificates*.

The security indicator  is displayed during a connection, if the data transmission between the phone and the content server is encrypted.

The security icon does not indicate that the data transmission between the gateway and the content server (or place where the requested resource is stored) is secure. The service provider secures the data transmission between the gateway and the content server.

## Digital signature

You can make digital signatures with your phone if your SIM card has a security module. Using the digital signature is similar to signing your name to a paper bill, contract, or other document.

To make a digital signature, select a link on a page (for example, the title of the book you want to buy and its price). The text to sign is shown, which may include the amount and date.

Check that the header text is *Read* and that the digital signature icon  is shown.



Web

If the digital signature icon does not appear, there is a security breach, and you should not enter any personal data such as your signing PIN.

To sign the text, read all of the text first, and select Sign.

The text may not fit within a single screen. Therefore, make sure to scroll through and read all of the text before signing.

Select the user certificate you want to use. Enter the signing PIN (see "Access codes," p. 9), and select OK. The digital signature icon disappears, and the service may display a confirmation of your purchase.

FCC DRAFT

## 14. SIM services

---



Your SIM card may provide additional services that you can access. This menu is shown only if it is supported by your SIM card. The name and contents of the menu depend on the SIM card.

For availability and information on using SIM card services, contact your SIM card vendor. This may be the service provider, network operator, or other vendor.

To set the phone to show you the confirmation messages sent between your phone and the network when you are using the SIM services, select *Menu > Settings > Phone > Confirm SIM service actions > Yes*.

Accessing these services may involve sending messages or making a phone call for which you may be charged.

## 15. Battery information

---

### ■ Charging and discharging

Your device is powered by a rechargeable battery. The full performance of a new battery is achieved only after two or three complete charge and discharge cycles. The battery can be charged and discharged hundreds of times but it will eventually wear out. When the talk and standby times are noticeably shorter than normal, replace the battery. Use only Nokia approved batteries, and recharge your battery only with Nokia approved chargers designated for this device.

Unplug the charger from the electrical plug and the device when not in use. Do not leave a fully charged battery connected to a charger, since overcharging may shorten its lifetime. If left unused, a fully charged battery will lose its charge over time.

Use the battery only for its intended purpose. Never use any charger or battery that is damaged.

Do not short-circuit the battery. Accidental short-circuiting can occur when a metallic object such as a coin, clip, or pen causes direct connection of the positive (+) and negative (-) terminals of the battery. (These look like metal strips on the battery.) This might happen, for example, when you carry a spare battery in your pocket or purse. Short-circuiting the terminals may damage the battery or the connecting object.

Leaving the battery in hot or cold places, such as in a closed car in summer or winter conditions, will reduce the capacity and lifetime of the battery and its ability to charge. Always try to keep the battery between 15°C and 25°C (59°F and 77°F). A device with a hot or cold battery may not work temporarily, even when the battery is fully charged. Battery performance is particularly limited in temperatures well below freezing.

Do not dispose of batteries in a fire as they may explode. Batteries may also explode if damaged. Dispose of batteries according to local regulations. Please recycle when possible. Do not dispose as household waste.

## Battery information

### ■ Nokia battery authentication guidelines

Always use original Nokia batteries for your safety. To check that you are getting an original Nokia battery, purchase it from an authorized Nokia dealer, look for the Nokia Original Enhancements logo on the packaging and inspect the hologram label using the following steps:

Successful completion of the four steps is not a total assurance of the authenticity of the battery. If you have any reason to believe that your battery is not an authentic original Nokia battery, you should refrain from using it and take it to the nearest authorized Nokia service point or dealer for assistance. Your authorized Nokia service point or dealer will inspect the battery for authenticity. If authenticity cannot be verified, return the battery to the place of purchase.

#### Authenticate hologram



1. When looking at the hologram label, you should see the Nokia connecting hands symbol from one angle and the Nokia Original Enhancements logo when looking from another angle.



2. When you angle the hologram left, right, down, and up, you should see 1, 2, 3, and 4 dots on each side respectively.

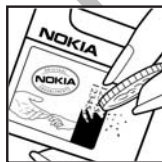

3. Scratch the side of the label to reveal a 20-digit code, for example, 12345678919876543210. Turn the battery so that the numbers are facing upwards. The 20-digit code reads starting from the number at the top row followed by the bottom row.

4. Confirm that the 20-digit code is valid by following the instructions at [www.nokia.com/batterycheck](http://www.nokia.com/batterycheck).

## Battery information

### What if your battery is not authentic?

If you cannot confirm that your Nokia battery with the hologram on the label is an authentic Nokia battery, please do not use the battery. Take it to the nearest authorized Nokia service point or dealer for assistance. The use of a battery that is not approved by the manufacturer may be dangerous and may result in poor performance and damage to your device and its enhancements. It may also invalidate any approval or warranty applying to the device.

To find out more about original Nokia batteries, visit [www.nokia.com/battery](http://www.nokia.com/battery).

FCC DRAFT

## Care and maintenance

---

Your device is a product of superior design and craftsmanship and should be treated with care. The suggestions below will help you protect your warranty coverage.

- Keep the device dry. Precipitation, humidity and all types of liquids or moisture can contain minerals that will corrode electronic circuits. If your device does get wet, remove the battery and allow the device to dry completely before replacing it.
- Do not use or store the device in dusty, dirty areas. Its moving parts and electronic components can be damaged.
- Do not store the device in hot areas. High temperatures can shorten the life of electronic devices, damage batteries, and warp or melt certain plastics.
- Do not store the device in cold areas. When the device returns to its normal temperature, moisture can form inside the device and damage electronic circuit boards.
- Do not attempt to open the device other than as instructed in this guide.
- Do not drop, knock, or shake the device. Rough handling can break internal circuit boards and fine mechanics.
- Do not use harsh chemicals, cleaning solvents, or strong detergents to clean the device.
- Do not paint the device. Paint can clog the moving parts and prevent proper operation.
- Use only the supplied or an approved replacement antenna. Unauthorized antennas, modifications, or attachments could damage the device and may violate regulations governing radio devices.
- Use chargers indoors.
- Always create a backup of data you want to keep (such as contacts and calendar notes) before sending your device to a service facility.

All of the above suggestions apply equally to your device, battery, charger, or any enhancement. If any device is not working properly, take it to the nearest authorized service facility for service.

## Additional safety information

---

Your device and its enhancements may contain small parts. Keep them out of the reach of small children.

### ■ Operating environment

Remember to follow any special regulations in force in any area and always switch off your device when its use is prohibited or when it may cause interference or danger. Use the device only in its normal operating positions. This device meets RF exposure guidelines when used either in the normal use position against the ear or when positioned at least 2.2 centimeters (7/8 inch) away from the body. When a carry case, belt clip or holder is used for body-worn operation, it should not contain metal and should position the device the above-stated distance from your body.

In order to transmit data files or messages, this device requires a good quality connection to the network. In some cases, transmission of data files or messages may be delayed until such a connection is available. Ensure the above separation distance instructions are followed until the transmission is completed.

Parts of the device are magnetic. Metallic materials may be attracted to the device. Do not place credit cards or other magnetic storage media near the device, because information stored on them may be erased.

### ■ Medical devices

Operation of any radio transmitting equipment, including wireless phones, may interfere with the functionality of inadequately protected medical devices. Consult a physician or the manufacturer of the medical device to determine if they are adequately shielded from external RF energy or if you have any questions. Switch off your device in health care facilities when any regulations posted in these areas instruct you to do so. Hospitals or health care facilities may be using equipment that could be sensitive to external RF energy.

### Pacemakers

Pacemaker manufacturers recommend that a minimum separation of 15.3 centimeters (6 inches) be maintained between a wireless phone and a pacemaker to avoid potential interference with the pacemaker. These recommendations are consistent with the independent research by and recommendations of Wireless Technology Research. Persons with pacemakers should do the following:

#### Additional safety information

- Always keep the device more than 15.3 centimeters (6 inches) from the pacemaker
- Not carry the device in a breast pocket
- Hold the device to the ear opposite the pacemaker to minimize the potential for interference.

If you suspect interference, switch off your device, and move the device away.

#### Hearing aids

Some digital wireless devices may interfere with some hearing aids. If interference occurs, consult your service provider.

#### ■ Vehicles

RF signals may affect improperly installed or inadequately shielded electronic systems in motor vehicles such as electronic fuel injection systems, electronic antiskid (antilock) braking systems, electronic speed control systems, and air bag systems. For more information, check with the manufacturer, or its representative, of your vehicle or any equipment that has been added.

Only qualified personnel should service the device, or install the device in a vehicle. Faulty installation or service may be dangerous and may invalidate any warranty that may apply to the device. Check regularly that all wireless device equipment in your vehicle is mounted and operating properly. Do not store or carry flammable liquids, gases, or explosive materials in the same compartment as the device, its parts, or enhancements. For vehicles equipped with an air bag, remember that air bags inflate with great force. Do not place objects, including installed or portable wireless equipment in the area over the air bag or in the air bag deployment area. If in-vehicle wireless equipment is improperly installed and the air bag inflates, serious injury could result.

#### ■ Airplanes

Using your device while flying in aircraft is prohibited. Switch off your device before boarding an aircraft. The use of wireless teledevices in an aircraft may be dangerous to the operation of the aircraft, disrupt the wireless telephone network, and may be illegal.

#### ■ Potentially explosive environments

Switch off your device when in any area with a potentially explosive atmosphere and obey all signs and instructions. Potentially explosive atmospheres include areas where you would normally be advised to turn off your vehicle engine. Sparks in such areas could cause an explosion or fire resulting in bodily injury or



## Additional safety information

even death. Switch off the device at refueling points such as near gas pumps at service stations. Observe restrictions on the use of radio equipment in fuel depots, storage, and distribution areas, chemical plants or where blasting operations are in progress. Areas with a potentially explosive atmosphere are often but not always clearly marked. They include below deck on boats, chemical transfer or storage facilities, vehicles using liquefied petroleum gas (such as propane or butane), and areas where the air contains chemicals or particles such as grain, dust, or metal powders.

### ■ Emergency calls



**Important:** Wireless phones, including this device, operate using radio signals, wireless networks, landline networks, and user-programmed functions. Because of this, connections in all conditions cannot be guaranteed. You should never rely solely on any wireless device for essential communications like medical emergencies.

#### To make an emergency call:

1. If the device is not on, switch it on. Check for adequate signal strength.  
Some networks may require that a valid SIM card is properly inserted in the device.
2. Press the end key as many times as needed to clear the display and ready the device for calls.
3. Enter the official emergency number for your present location. Emergency numbers vary by location.
4. Press the call key.

If certain features are in use, you may first need to turn those features off before you can make an emergency call. If the device is in offline or flight mode you must change the profile to activate the phone function before you can make an emergency call. Consult this guide or your service provider for more information.

When making an emergency call, give all the necessary information as accurately as possible. Your wireless device may be the only means of communication at the scene of an accident. Do not end the call until given permission to do so.

## Additional safety information

### ■ Certification information (SAR)

THIS MOBILE DEVICE MEETS GUIDELINES FOR EXPOSURE TO RADIO WAVES.

Your mobile device is a radio transmitter and receiver. It is designed not to exceed the limits for exposure to radio waves recommended by international guidelines. These guidelines were developed by the independent scientific organization ICNIRP and include safety margins designed to assure the protection of all persons, regardless of age and health.

The exposure guidelines for mobile devices employ a unit of measurement known as the Specific Absorption Rate or SAR. The SAR limit stated in the ICNIRP guidelines is 2.0 watts/kilogram (W/kg) averaged over 10 grams of tissue. Tests for SAR are conducted using standard operating positions with the device transmitting at its highest certified power level in all tested frequency bands. The actual SAR level of an operating device can be below the maximum value because the device is designed to use only the power required to reach the network. That amount changes depending on a number of factors such as how close you are to a network base station. The highest SAR value according to international testing procedures for use at the ear for device type RH-73 is 0.77 W/kg, and for device type RH-74 is 0.41 W/kg.

Use of device accessories and enhancements may result in different SAR values. SAR values may vary depending on national reporting and testing requirements and the network band. Additional SAR information may be provided under product information at [www.nokia.com](http://www.nokia.com).

Your mobile device is also designed to meet the requirements for exposure to radio waves established by the Federal Communications Commission (USA) and Industry Canada. These requirements set a SAR limit of 1.6 W/kg averaged over 1 gram of tissue. The highest SAR value reported under this standard during product certification for use at the ear for device type RH-74 is 0.59 W/kg and when properly worn on the body is 0.92 W/kg. Information about this device model can be found at <http://www.fcc.gov/oet/fccid> by searching the equipment authorization system using FCC ID: QTLRH-74.

## Technical information

Feature	Specification																
Weight	93 g (3.3 oz) with BL-5B Li-Ion 760 mAh battery																
Size	Volume: 78 cm <sup>3</sup> (4.8 in <sup>3</sup> ) Length: 85 mm (3.3 in) Width: 44 mm (1.7 in) Thickness: 24 mm (0.9 in)																
Frequency range	<table border="0"> <tr> <td>RH-73</td> <td>RH-74</td> </tr> <tr> <td>6060</td> <td>6061</td> </tr> <tr> <td>EGSM 900</td> <td>GSM 850</td> </tr> <tr> <td>880–915 MHz (TX)</td> <td>824–894 MHz (TX)</td> </tr> <tr> <td>925–960 MHz (RX)</td> <td>869–894 MHz (RX)</td> </tr> <tr> <td>EGSM 1800</td> <td>GSM 1900</td> </tr> <tr> <td>1710–1785 MHz (TX)</td> <td>1850–1910 MHz (TX)</td> </tr> <tr> <td>1805–1865 MHz (RX)</td> <td>1930–1990 MHz (RX)</td> </tr> </table>	RH-73	RH-74	6060	6061	EGSM 900	GSM 850	880–915 MHz (TX)	824–894 MHz (TX)	925–960 MHz (RX)	869–894 MHz (RX)	EGSM 1800	GSM 1900	1710–1785 MHz (TX)	1850–1910 MHz (TX)	1805–1865 MHz (RX)	1930–1990 MHz (RX)
RH-73	RH-74																
6060	6061																
EGSM 900	GSM 850																
880–915 MHz (TX)	824–894 MHz (TX)																
925–960 MHz (RX)	869–894 MHz (RX)																
EGSM 1800	GSM 1900																
1710–1785 MHz (TX)	1850–1910 MHz (TX)																
1805–1865 MHz (RX)	1930–1990 MHz (RX)																
Transmitter output power	Up to 2 W																
Battery voltage	3.7 V dc																
Number of channels	299																
Operating times	Standby time: up to 3.5 hours Talk time: up to 400 hours																
Operating temperature	15°C to + 25°C (59°F to + 77°F)																

## Numerics

1-touch dialing 19, 35

## A

access codes 9  
alerts 36  
answer a call 19  
applications 48

## B

battery  
  authentication 60  
  charging 12, 59  
  discharging 59  
  install 11  
bookmarks 53  
business cards 34

## C

cache 54  
calculator 46  
calendar 44  
call  
  1-touch dialing 19  
  answer 19  
  contacts 19  
  decline 19  
  keypad 19  
  log 32  
  settings 38  
  waiting 20  
certificates 56  
charging, battery 12  
connectivity 39  
contacts 33  
cookies 52

## D

date setting 38  
dialing  
  1-touch 35  
downloading 53

## E

enhancement settings 40

## G

gallery 43  
games 48

## I

icons 17  
indicators 17  
install SIM and battery 11  
Internet 50

## K

keys lock (keyguard) 17

## L

lock keys 17

## M

memory  
  cache 54  
  multimedia messages 28  
menu  
  applications 48  
  call log 32  
  functions 23  
  gallery 43  
  organizer 44  
  SIM services 58  
  Web 50  
messages  
  multimedia 26  
  read and reply 25  
  sending options 25  
  settings 30  
  templates 26  
  text 24  
  write and send 25  
MMS 26  
multimedia messages  
  read and reply 27  
  restrictions 26  
  write and send 26

## O

organizer 44

## P

- phone settings 39
- power 13
- predictive text 21
- profiles 36

## S

- security
  - browser 55
  - certificates 56
  - digital signature 56
  - module 55
  - settings 41
- settings
  - call 38
  - configuration 40
  - enhancement 40
  - message 30
  - phone 39
  - profiles 36
  - security 41
  - themes 36
  - time and date 38
  - tone 36
- signature 56
- SIM

- install 11
- security module 55
- services 58
- SMS 24
- standby mode 16

## T

- templates 26
- text
  - entry 21
  - messages 24
  - predictive 21
  - writing tips 21
- time setting 38
- tones 36

## W

- Web
  - bookmarks 53
  - browsing 50
  - cookies 52
  - downloading 53
  - network service 50
- write message 25