

# Nokia RM-377 User Guide

---



© 2008 Nokia. All rights reserved.

Nokia, Navi and Nokia Connecting People are trademarks or registered trademarks of Nokia Corporation. Nokia tune is a sound mark of Nokia Corporation. Other product and company names mentioned herein may be trademarks or tradenames of their respective owners.

Reproduction, transfer, distribution, or storage of part or all of the contents in this document in any form without the prior written permission of Nokia is prohibited.



Includes RSA BSAFE cryptographic or security protocol software from RSA Security.

Nokia operates a policy of ongoing development. Nokia reserves the right to make changes and improvements to any of the products described in this document without prior notice.

TO THE MAXIMUM EXTENT PERMITTED BY APPLICABLE LAW, UNDER NO CIRCUMSTANCES SHALL NOKIA OR ANY OF ITS LICENSORS BE RESPONSIBLE FOR ANY LOSS OF DATA OR INCOME OR ANY SPECIAL, INCIDENTAL, CONSEQUENTIAL OR INDIRECT DAMAGES HOWSOEVER CAUSED.

THE CONTENTS OF THIS DOCUMENT ARE PROVIDED "AS IS". EXCEPT AS REQUIRED BY APPLICABLE LAW, NO WARRANTIES OF ANY KIND, EITHER EXPRESS OR IMPLIED, INCLUDING, BUT NOT LIMITED TO, THE IMPLIED WARRANTIES OF MERCHANTABILITY AND FITNESS FOR A PARTICULAR PURPOSE, ARE MADE IN RELATION TO THE ACCURACY, RELIABILITY OR CONTENTS OF THIS DOCUMENT. NOKIA RESERVES THE RIGHT TO REVISE THIS DOCUMENT OR WITHDRAW IT AT ANY TIME WITHOUT PRIOR NOTICE.

Reverse engineering of any software in the Nokia device is prohibited to the extent permitted by applicable law. Insofar as this user guide contains any limitations on Nokia's representations warranties, damages and

liabilities, such limitations shall likewise limit any representations, warranties, damages and liabilities of Nokia's licensors.

The availability of particular products and applications for these products may vary by region. Please check with your Nokia dealer for details, and availability of language options.

#### Export controls

This device may contain commodities, technology, or software subject to export laws and regulations from the US and other countries. Diversion contrary to law is prohibited.

#### FCC NOTICE

Your device may cause TV or radio interference (for example, when using a telephone in close proximity to receiving equipment). The FCC can require you to stop using your telephone if such interference cannot be eliminated. If you require assistance, contact your local service facility. This device complies with part 15 of the FCC rules. Operation is subject to the following two conditions: (1) This device may not cause harmful interference, and (2) this device must accept any interference received, including interference that may cause undesired operation. Any changes or modifications not expressly approved by Nokia could void the user's authority to operate this equipment.

xxxxxxx/Issue 1

# Contents

---

<b>SAFETY</b> .....	<b>6</b>
<b>General information</b> .....	<b>10</b>
Access codes.....	10
Nokia support on the web.....	10
<b>1. Get started</b> .....	<b>11</b>
Install and remove battery.....	11
Insert UIM card.....	13
Charge the battery.....	14
Switch your device on or off .....	15
Normal operating position .....	15
<b>2. Your device</b> .....	<b>17</b>
Keys and parts.....	17
Standby mode and shortcuts.....	18
Keyguard.....	19
<b>3. Call functions</b> .....	<b>21</b>
Make and answer a call .....	21
Conference calling.....	21
Loudspeaker .....	22
Voice dialing.....	22
<b>4. Write text</b> .....	<b>24</b>
Traditional text input.....	24
Predictive text input.....	24
<b>5. Menu functions</b> .....	<b>26</b>
Messaging .....	26

Contacts.....	33
Log.....	35
Settings.....	36
Gallery.....	46
Media.....	49
Organiser.....	53
Applications.....	57
Web.....	57
Extras.....	58
UTK.....	58
<b>6. Enhancements.....</b>	<b>59</b>
<b>7. Battery and charger information.....</b>	<b>60</b>
Nokia battery authentication guidelines.....	63
<b>Care and maintenance.....</b>	<b>66</b>
<b>Additional safety information.....</b>	<b>69</b>

# SAFETY

---

Read these simple guidelines. Not following them may be dangerous or illegal. Read the complete user guide for further information.



## SWITCH ON SAFELY

Do not switch the device on when wireless phone use is prohibited or when it may cause interference or danger.



## ROAD SAFETY COMES FIRST

Obey all local laws. Always keep your hands free to operate the vehicle while driving. Your first consideration while driving should be road safety.



## INTERFERENCE

All wireless devices may be susceptible to interference, which could affect performance.



## SWITCH OFF IN RESTRICTED AREAS

Follow any restrictions. Switch the device off in aircraft, near medical equipment, fuel, chemicals, or blasting areas.



## QUALIFIED SERVICE

Only qualified personnel may install or repair this product.



#### ENHANCEMENTS AND BATTERIES

Use only approved enhancements and batteries. Do not connect incompatible products.



#### WATER-RESISTANCE

Your device is not water-resistant. Keep it dry.

## ■ About your device

The wireless device described in this guide is approved for use on the CDMA 800 MHz network. Contact your service provider for more information about networks.

When using the features in this device, obey all laws and respect local customs, privacy and legitimate rights of others, including copyrights.

Copyright protection may prevent some images, music, and other content from being copied, modified or transferred.

Your device may have preinstalled bookmarks and links for third-party internet sites. You may also access other third-party sites through your device. Third-party sites are not affiliated with Nokia, and Nokia does not endorse or assume liability for them. If you choose to access such sites, you should take precautions for security or content.



**Warning:** To use any features in this device, other than the alarm clock, the device must be switched on. Do not switch the device on when wireless device use may cause interference or danger.

Remember to make back-up copies or keep a written record of all important information stored in your device.

When connecting to any other device, read its user guide for detailed safety instructions. Do not connect incompatible products.

## ■ Network services

To use the phone you must have service from a wireless service provider. Many of the features require special network features. These features are not available on all networks; other networks may require that you make specific arrangements with your service provider before you can use the network services. Your service provider can give you instructions and explain what charges will apply. Some networks may have limitations that affect how you can use network services. For instance, some networks may not support all language-dependent characters and services.

Your service provider may have requested that certain features be disabled or not activated in your device. If so, these features will



not appear on your device menu. Your device may also have a special configuration such as changes in menu names, menu order, and icons. Contact your service provider for more information.

This device supports WAP 2.0 protocols (HTTP and SSL) that run on TCP/IP protocols. Some features of this device, such as sending e-mail, browsing websites, or downloading files require network support for these technologies.

DRAFT

# General information

---

## ■ Access codes

When the device or keypad is locked, calls may be possible to the official emergency number programmed into your device. Making an emergency call in the offline profile or when the device is locked requires that the device recognise the number to be an official emergency number. It is advisable to change the profile or unlock the device by entering the lock code before you make the emergency call.

To activate the device when it is locked, enter the lock code. The default lock code is 1234.

To define the security settings for your device, select [Menu](#) > [Settings](#) > [Security](#).

## ■ Nokia support on the web

Check [www.nokia.com/support](http://www.nokia.com/support) or your local Nokia website for the latest guide, additional information, downloads, and services related to your Nokia product.

# 1. Get started

---

## ■ Install and remove battery



**Note:** Always switch the device off and disconnect the charger before removing the battery.

1. To remove the cover, with the back of the device facing you, press the release button, and lift up the back cover.
2. To insert the battery, position the battery so the gold-coloured contacts match up with those on the device, and insert the battery into the battery slot.

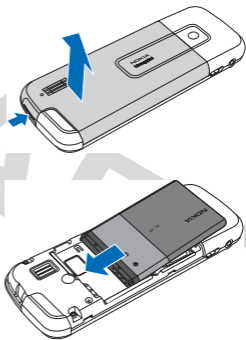

3. Push down on the other end of the battery to snap the battery into place.
4. Insert the back cover toward the top of the device, and press it down until you hear a click.
5. To remove the battery, remove the cover (see step 1), and insert your finger into the finger grip, to lift the battery from its compartment.

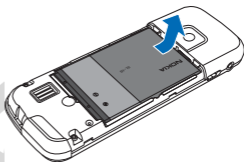
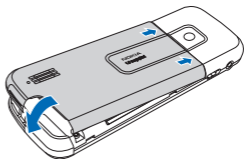

## ■ Insert UIM card

Always switch the device off and disconnect the charger before inserting or removing the UIM card.

1. Remove the cover and battery. See steps 1 and 5 in "Install and remove battery", p. 11.
2. Ensure that the gold-coloured area on the UIM card is facing downwards, and insert the UIM card into the card slot.
3. Install the battery, and replace the cover. See step 4 in "Install and remove battery", p. 11.

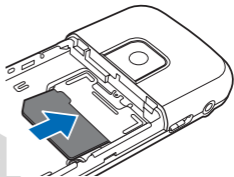

## ■ Charge the battery



**Warning:** Use only batteries, chargers, and enhancements approved by Nokia for use with this particular model. The use of any other types may invalidate any approval or warranty, and may be dangerous.

For availability of approved enhancements, please check with your dealer. When you disconnect the power cord of any enhancement, grasp and pull the plug, not the cord.

1. Connect the charger to a wall socket.
2. Connect the charger plug to the USB connector at the left side of the device.

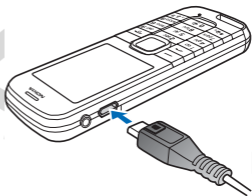

If the battery is completely discharged, it may take a few seconds before the charging indicator appears on the display or before any calls can be made.

## ■ Switch your device on or off

Press and hold the power key on the keypad for at least three seconds.

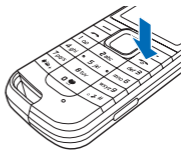

**Warning:** Do not switch the device on when wireless phone use is prohibited or when it may cause interference or danger.

## ■ Normal operating position

Your device has an internal antenna. Hold the phone as you would any other telephone with the antenna pointed up and over your shoulder.





**Note:** As with any radio transmitting device, avoid touching the antenna area unnecessarily while the antenna is transmitting or receiving. Contact with such an antenna affects the communication quality and may cause the device to operate at a higher power level than otherwise needed and may reduce the battery life.





## 2. Your device

---

### ■ Keys and parts

1. Earpiece
2. Volume key
3. Right selection key
4. Power/End key
5. Camera key
6. Microphone
7. Keypad
8. Call key
9. Left selection key
10. Navi™; hereafter referred to as scroll key
11. Charge / USB port
12. Headset connector
13. Camera lens
14. Speaker
15. Release button

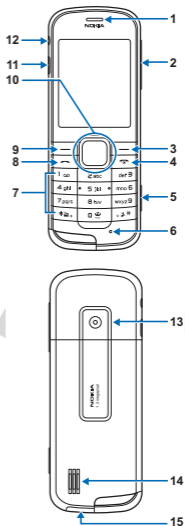

## ■ Standby mode and shortcuts

Depending on your wireless service provider and the model number of your device, some or all of the following selection keys may appear in the standby mode.

1. Signal strength – Shows the signal strength of the wireless network at your current location.
2. Battery level – Shows the battery charge level.
3. Go to – Press the left selection key to access a certain feature quickly.
4. Names – Press the right selection key to access the contacts list.
5. Menu – Press the middle selection key to access the main menu.

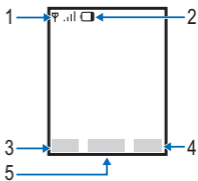

Shortcuts in the standby mode:

- To access the list of dialled numbers, press the call key once.
- To access the main menu, press the middle selection key.
- To switch between current profile and silent profile, press and hold # for at least three seconds.
- To activate the radio function, press and hold \* for at least three seconds.
- For shortcuts of scroll key, see "My shortcuts", p. 40.

## ■ Keyguard

Keyguard locks the keypad to prevent accidental key presses. When the keypad is locked, calls still may be possible to the official emergency number programmed into your device. Enter the emergency number, and press the call key. The number is displayed only after you have entered its last digit.

To lock the keypad automatically when no keys are pressed for a certain time, in the standby mode, select [Menu](#) > [Settings](#) > [Phone](#) > [Automatic keyguard](#) > [On](#).

To lock the keypad, select **Menu**, and press \* within 2 seconds.

To unlock the keypad, select **Menu**, and press \* within 2 seconds.

If you receive a call when the keypad is locked, it is automatically unlocked, and then locked again when you end the call.

## 3. Call functions

---

### ■ Make and answer a call

To make a call, enter the phone number, including the country code and area code, if necessary, and press the call key. Press the volume key to adjust the volume of the earpiece or headset during the call.

To answer a call, press the call key. To end a call or to reject an incoming call, press the end key.

### ■ Conference calling

Conference calling (network service) allows you to take part in a conference call with another two participants. To call a third party during a call, select **Options** > **New call**. Enter the number you want, and press the call key. When the new call is answered, press the call key to connect the calls. To end the conference call, select **Options** > **End all calls**, or press the end key.

## ■ Loudspeaker



**Warning:** Do not hold the device near your ear when the loudspeaker is in use because the volume may be extremely loud.

To activate the loudspeaker during a call, select **Loudsp.**  
To deactivate the loudspeaker, select **Handset.**

The loudspeaker is deactivated automatically when a call (or a call attempt) ends or when certain enhancements are connected.

## ■ Voice dialing

You can make a phone call by saying the name that is saved in the contact list of the device. Before using voice dialling, you must record a voice tag in your device.

Before using voice tags, note the following:

- Voice tags are not language-dependent. They are dependent on the speaker's voice.
- You must say the name exactly as you said it when you recorded it.

- Voice tags are sensitive to background noise. Record voice tags and use them in a quiet environment.
- Very short names are not accepted. Use long names, and avoid similar names for different numbers.



**Note:** Using voice tags may be difficult in a noisy environment or during an emergency, so you should not rely solely upon voice dialling in all circumstances.



To record a voice tag, select **Menu** > *Contacts* > *Names* > *Details* > **Options** > *Add voice tag*. Select **Start**, and speak after the tone. To stop recording, select **Quit**.

To activate voice dialling, press and hold the volume key down. A short tone sounds, and **Speak now** is displayed. To deactivate voice dialling, select **Quit**.

To make a call by voice dialling, clearly speak the name of the contact you want to dial. If the device recognises the name you spoke, it shows a list of matches. Using voice commands to operate the device is similar to voice dialling.

## 4. Write text

---

You can enter text using traditional  **Abc** or predictive  **Abc** text input. To change the text input method, and to switch between upper and lower case, press #. To display a list of special characters, press \*.

### ■ Traditional text input

Press a number key, 2–9, repeatedly until the desired character appears. To add a space, press 0. To add a number, press and hold the desired number key.

### ■ Predictive text input

Predictive text input is based on a built-in dictionary when writing in English. Select **Options** > *Prediction on*.

When using predictive text input, press each key once for each letter. The device suggests a matching word.

If the displayed word is the one you want, press 0, and start writing the next word. If not, press \* repeatedly to view other word options.



If ? is displayed after the word, the word is not in the dictionary. To add the word to the dictionary, select **Spell**, enter the word using traditional text input, and select **Save**.

DRAFT

## 5. Menu functions

---

The device functions are grouped into menus. Not all menu functions or option items are described here.

In the standby mode, select **Menu**, scroll to the menu item you want to open, and select it. To exit the current menu level, select **Exit** or **Back**. To return to the standby mode, press the end key.

### ■ Messaging

You can only use messaging services supported by your network or service provider.



### Text message settings

Select **Menu** > *Messaging* > *Text messages* > *Message settings*.

Select *Sending options* and from the following:

*Priority* – to send text messages with normal priority or as urgent

*Delivery reports*— to receive confirmation when your message is delivered

*Send callback number*— to send a number to which you want to be called back

*Signature*— to attach a signature to outgoing messages. Select *Other settings* and from the following:

*Save incoming text messages*— to automatically save incoming text message on the device, on the UIM card, or on the device only when the UIM card memory is full

*Message font size*— to change the font size when reading and writing messages

*Message overwriting*— When the message memory is full, your device cannot receive any new messages. To choose which messages are overwritten when new ones arrive, select *Sent items only*, *Inbox only*, or *S. items & Inbox*.

*Save sent messages*— to select whether to save sent messages to the *Sent items* folder

*Queue if no digital*— to select whether messages that fail to send are stored in the *Outbox* folder

## Multimedia messages settings

Select **Menu** > *Messaging* > *Multimedia messages* > *Message settings* and from the following:

*Save sent messages* – Select whether the multimedia messages you send are saved to the *Sent items* folder.

*Delivery reports* – Select whether to receive message delivery reports.

*Default slide timing* – Set the default time for slides in multimedia messages.

*Allow multimedia reception* – Select whether to receive multimedia messages. To only receive multimedia messages when you are in your home network, select *In home network* (network service). For more information, contact your service provider.

*Incoming multimedia messages* *Incoming multimedia messages* – Select whether incoming multimedia messages are retrieved automatically or manually, or not at all.

*Allow advertisements* – Select whether to block or allow advertisements (network service) sent as multimedia messages. For more information, contact your service provider.

## Write and send a text message

1. Select **Menu** > *Messaging* > *Text message* > *Create message*.
2. To send the message to one recipient, select **Add** > *Contacts*, the recipient, and **Select**.
3. To send the message to many recipients, select **Add** > *Contact groups*, the group, and **Select**.

## Write and send a multimedia message

To check availability and to subscribe to the multimedia messaging service (network service), contact your service provider.

Only devices that have compatible features can receive and display multimedia messages. A multimedia message can contain objects such as images, video clips, and sound clips. The appearance of a message may vary depending on the receiving device.

The wireless network may limit the size of MMS messages. If the inserted picture exceeds this limit, the device may make it smaller so that it can be sent by MMS.

To send a multimedia message, do the following:

1. Select **Menu** > **Messaging** > **Multimedia messages** > **Create message**.
2. Select **Insert**, a multimedia folder and the file you want to send.
3. Press scroll key to select the second or third files.
4. Select **Send** to insert the files into the message.
5. Enter the phone number or e-mail address for your recipient, or select **Add** to retrieve a number or address from the contacts list.
6. Enter a subject for the message and select **Send**.

## Read and reply to a message

When you receive a message, a notification and  are displayed.

1. Select **Show** to read the message or **Exit** to dismiss the notification.  
 in the standby mode indicates that you have unread messages in your inbox.
2. Select **Reply** and from the available options.

3. Enter your reply, and select **Send**.

## Inbox, Sent items, and Drafts folders

All incoming text and multimedia messages are saved in the **Inbox** folder. **Outbox** contains unsent and failed messages.

If you have set the device to save the sent messages, they are saved in the **Sent items** folder.

To save the message you are writing to the **Drafts** folder to edit and send later, select **Options** > **Save as draft** (text message) or **Save message** (multimedia message).

## Delete messages

If your message memory is full and you have incoming messages,  blinks in the standby mode. To receive the messages, delete some of the old messages.

To delete a message, select **Menu** > **Messaging** > **Text messages** or **Multimedia messages**, the message, and **Options** > **Delete** > **Yes**.

To delete all text messages in a folder, select **Menu** > *Messaging* > *Text messages* > *Delete messages* > *All, All read, All unread* and the folder.

To delete all multimedia messages in a folder, select **Menu** > *Messaging* > *Multimedia messages* > *Delete messages* and the folder.

## Voice messages

To activate voice mail (network service), contact your service provider. When you subscribe to the service, you receive voice mailbox number. Save the number to your device. For more information, contact your service provider.

To listen to your voice messages, select **Menu** > *Messaging* > *Voice message* > *Listen to voice messages*, or press and hold 1 in the standby mode.

## Minibrowser message

Minibrowser messaging is a network service. See "Network services", p. 8 for more information.



Minibrowser (network service) allows you to check your e-mail messages with your device. Select [Menu](#) > [Messaging](#) > [Minibrowser messages](#).



**Important:** Exercise caution when opening messages. Messages may contain malicious software or otherwise be harmful to your device or PC.

## ■ [Contacts](#)



To search for a contact, select [Menu](#) > [Contacts](#) > [Names](#) > [Options](#) > [Find](#), and enter the first character of the contact name. Matching contacts are displayed. To change the text input method, select #. To edit the detail, set speed dial, or add voice tag for contact, highlight the contact, and select [Details](#) > [Options](#) and from the available options.

To define how the contact names are displayed, select [Menu](#) > [Contacts](#) > [Settings](#) and from the available options. To view how much memory your contacts information is using, select [Memory status](#).

To copy or move contacts from your device to the UIM card, or from the UIM card to your device, select **Menu** > *Contacts* > *Move contacts* or *Copy contacts*.

To empty your contacts list, select **Menu** > *Contacts* > *Delete all contacts*.

## Groups

Groups allow you to send messages to a designated group of people.

To add a new group, select **Menu** > *Contacts* > *Groups* > *Add*, the detail for the group, and *Save*.

## Voice tag

You can record voice tags for contacts to call them using voice dialling. See "Voice dialling", p. 22.

## Speed dials

Speed dialling allows you call a contact just by pressing and holding a key.

To call your voice mailbox, press and hold **1** in the standby mode. To assign a phone number to another number key,

select **Menu** > *Contacts* > *1-touch dialng* > a number key from 2–9, and **Assign**. Enter the phone number you want to assign to the key, or select **Search** to retrieve the number from your contacts.

## ■ Log



To view your most recent missed or received calls or dialed numbers, select **Menu** > **Log** > *Missed calls*, *Received calls*, or *Dialed numbers*. You can view the date and time of the call, edit, view, or call the registered phone number, send a text message to it, or save it to your contacts.

To view all of the numbers chronologically, select *Call log*. To view the contacts to whom you most recently sent messages, select *Message recipients*.

To delete calls from the log, select **Menu** > **Log** > *Clear log lists* and from the available options.

To view the approximate duration of calls, select **Menu** > **Log** > *Call duration*. To reset the timers, select *Clear timers*, enter your lock code, and select **OK**.

To view the duration or amount of data sent or received during data and fax calls (network service) or using the minibrowser (network service), select [Menu](#) > [Log](#) > [Data/fax calls](#) or [Minibrowser calls](#).

## ■ Settings



From this menu, you can adjust various device settings.

## Profiles

Profiles define how your device reacts when you receive a call or message, and how your keypad sounds when you press a key. You can personalise ringing options, keypad tones, and other settings for each of the available profiles. The available profiles are: [General](#), [Silent](#), [Meeting](#), [Outdoor](#), [Flight](#), and two customisable ones.

To activate or customise a profile or set a time limit for a profile, select [Menu](#) > [Settings](#) > [Profiles](#), a profile, and [Activate](#), [Personalise](#), or [Timed](#).

## Themes

A theme contains various elements for personalising your device.

To change the theme for your device, select **Menu** > **Settings** > **Themes**, select a theme, and **Apply**.

## Tones

Tone settings only apply to the currently selected profile.

Select **Menu** > **Settings** > **Tones** and from following:

**Incoming call alert** – to set the alert type for incoming calls

**Ringtone** – to set the tone for incoming calls

**Ringtone volume** – to set the volume level for the ringing tone and message alert tone

**Incoming call video** – to set a video clip to be played when you receive call

**Vibrating alert** – to set the device to vibrate when you receive a call or a text message

**Message alert tone** – to set the tone to sound when you receive a text message

*Keypad tones* – to select the volume level of the keypad tones

*End of list tone* – to set a tone to sound when you are at the end of a menu list, contacts list, or calls list

*Other tones* – to select a tone for other functions

*Application tones* – to set the application default tone

*Alert for* – to set the device to alert for all calls or only when a member of a selected caller group calls

## **Display**

Select **Menu** > *Settings* > *Display* and from the following options:

*Wallpaper* – to set a background image that is displayed when the device is in the standby mode

*Standby mode font color* – to set the font colour for text shown in the standby mode

*Light indicator* – to set how long the light indicator can blink when the device receives a notification

*Screen saver* – to set a screen saver for the display

*Power saver* – to select the power saver for saving battery

*Sleep mode* – to turns the phone display off during inactivity

*Font size* – to select the font size for display text

*Active standby* – to switch the active standby mode on or off and to organise and personalise the active standby mode

*Navigation key icons* – to display the icons of the current scroll key shortcuts in the standby mode when the active standby mode is off

## **Date and time**

Select **Menu** > *Settings* > *Date and time* and from the following:

*Date and time settings* – to set the date and time, change the time zone, and daylight saving time

*Date and time format settings* – to set the format for the date and time

*Auto-update of date & time* – to set whether your device updates the date and time automatically

## My shortcuts

To quickly access your most frequently used functions, add them to the *My shortcuts* menu.

Select **Menu** > *Settings* > *My shortcuts*, the key on which you want to assign the shortcut to, and **Select**.

## Connectivity

You can transfer data between your device and a compatible PC using a CA-101 USB data cable.



**Important:** To make a phone call, disconnect the USB data cable.

To be asked for the purpose of the connection each time when the cable is connected, select **Menu** > *Settings* > *Connectivity* > *USB data cable* > *Ask on connection*.

To use the PC Suite to transfer files between your device and PC:

1. Connect your device and your PC with a CA-101 USB data cable.
2. If asked to select the connection mode, select *PC Suite*.



## Call

Select **Menu** > **Settings** > **Call** and from the following options:

**Anykey answer** – to answer an incoming call by pressing any key except the call key or the left selection key

**Automatic redial** – to automatically redial a number after an unsuccessful call attempt

**1-touch dialing** – to select whether the number keys (2-9) can be used for calling a number by pressing and holding the key

**Calling card** – to save up to four calling card numbers in your device to use for long distance calls

**Abbreviated dialing** – to save a short phone number (2-3 digits) for speed dialling

**Preferred carrier** – to select the preferred long distance carrier

**International prefix** – to make calls using the + sign as the international prefix. The device replaces the + sign in a saved phone number when making a call

**Data/fax calls** – to set your device to send or receive data and fax calls when connected to a device such as a PDA or PC

*Call summary* – to display the call duration when you end a call

*Show call time on display* – to select whether the duration of the current call is displayed

*Ringing tone for no caller ID* – to set whether a tone sounds for calls where there is no caller ID

## Device

Select **Menu** > *Settings* > *Phone* and from the following options:

*Language settings* – to select the language for the display text

*Memory status* – to view the free memory and used memory of your device

*Automatic keypad* – to set the keypad to lock automatically after a preset time delay

*Touch tones* – to set the tone duration when you press the keys on your device keypad

*Start-up tone and Switch-off tone* – to select whether the device sounds a tone when it is switched on or off

*Welcome note* – to write a welcome note that briefly appears when you switch your device on

*Confirm UIM service actions* – to ask for confirmation for UIM service actions

*Help text activation* – to display brief descriptions for most menu items

*Flight query* – to be asked if the Flight mode should be used each time the device is switched on

*Backlight time-out* – to define how long the backlight remains on

## Voice commands

You can set up to five voice commands, which allow hands-free operation of certain device features.

Before using voice commands, you must add a voice tag to the device function.

1. Select **Menu** > *Settings* > *Voice commands*.
2. Select the device function you want to tag, select **Add** > **Start** and speak the voice tag clearly into the microphone. After recording the voice tags, you may change or delete them.

To activate a voice command, press and hold the right selection key in the standby mode. When **Speak now** is displayed, say the voice tag clearly into the microphone.

If a match is found, the function is activated. If a match is not found, the message **No match found** is displayed.

## Enhancements

To connect a compatible enhancement to your device, select **Menu** > **Settings** > **Enhancements**.

To select the profile automatically activated when your phone is connected to the charger, select **Charger** > **Default profile**.

To optimise the sound quality when using a t-coil hearing aid, select **Hearing aid** > **T-coil hearing aid mode** > **On**.

## Security

To set the security settings for your device, select **Menu** > **Settings** > **Security** > **Change lock code**, **Security level**, **PIN code request**, **Change PIN code**, **Call restrictions**, or **Voice privacy**.

## Network

The *Network* menu allows you to customise how your device chooses which network to operate in while you are within or away from your primary or home system. Your device is set to search for the most effective network. To set which network to use when the device cannot find a preferred network, select **Menu** > *Settings* > *Network* > *Set mode*, and select a mode.

## Network services

To view the network services available on your device, select **Menu** > *Settings* > *Network services* and from the available options. For more information, contact your service provider.

## Device information

To view the user, version, system, and icon information of your device, select **Menu** > *Settings* > *Phone details*.

## Restore settings

You can restore the original factory settings to your device without affecting personal data such as contacts, language selection, or calendar notes.

To reset some of the menu setting to their original signal:

1. Select **Menu** > *Settings* > *Restore settings* > *Restore settings only*.
2. Enter your lock code, and select **OK**.

## ■ Gallery

You can save images, videos clips, music files, tones, and recordings to a folder in Gallery.



## Graphics

You can personalise your device with a background picture (wallpaper), screensavers, stylish clip-art, and frames using the preloaded or downloaded images in this folder. To display a list of available images folders, select **Menu** > *Gallery* > *Graphics* > **Open**. To delete, send, or move an image, select the image, **Options**, and from the available options.

## Images

To view and manage images captured with your device camera, select **Menu** > **Gallery** > **Images** > **Open**. To delete or send an image, select the image, **Options**, and from the available options.

## Video clips

Video clips recorded with the camera are stored in the Video clips folder. To view and manage video clips, select **Menu** > **Gallery** > **Video clips** > **Open**. To set a video clips as screen saver or call video, select the video clip, **Options**, *Use video clips*.

## Themes

Themes help you to personalise your device. To display a list of available themes, select **Menu** > **Gallery** > **Themes** > **Open**. To delete, send, move, or rename a theme, select the theme, **Options**, and from the available options.

## Tones

You can personalise your device with ringing tones and alert tones. To display a list of available tones, select **Menu** > *Gallery* > *Tones*. To listen to a tone, select the tone and **Open**. To select the tone for incoming calls and alert, select the tone, **Options** and *Use tone*.

## Received files

Files sent to your device are saved in this folder. To display a list of received files, select **Menu** > *Gallery* > *Receiv. files* > **Open**. To delete, send, move, or rename the received files, select a file, **Options**, and the available options.

## Recordings

Recordings is the default folder for files you record. To display a list of recordings, select **Menu** > *Gallery* > *Recordings* > **Open**. To listen to a recording, select the recording and **Open**. To move, delete, or send a recording in Recordings, select **Options** and from the available options.



## ■ Media



Media offers the camera, video, media player, radio, and voice recorder functions.

### Camera

You can take photos with the built-in camera. The camera produces images in JPEG format. The camera lens is on the back of the device. Your device supports image capture resolutions of up to 1024x1280 pixels.

You can send images in a multimedia message. You can also attach an image to a contact to be displayed when the contact calls you.

#### Capture an image

In the standby mode, select **Menu** > **Media** > **Camera** or press the camera key.

To capture an image, press the camera key or **Capture**. The image is saved in the Image folder in Gallery. To capture another image, select **Back**. To send the image as a message, select **Send**. To view more options, select **Options**.

## Camera options

In the standby mode, select **Menu** > **Media** > **Camera** > **Options** and from the following:

**Video** – Switch to the still image or video mode.

**Landscape mode** or **Portrait mode** – Switch the capture mode to landscape or portrait.

**Night mode on** or **Night mode off** – Switch the camera night mode on or off.

**Self-timer** – Use the self-timer to include yourself in the picture. Select the time for the camera to wait before capturing the image after you press the camera key.

**Img. sequence on** and **Img. sequence off** – Capture three images in succession.

**Effects** – Adjust the camera filters.

**Open Gallery** – Open the Gallery to view saved images.

**Settings** – Change the camera settings.

## Video

You can record video clips with the built-in camera. The video clips are saved in MPEG format. The camera lens is on the back of the device. Your device supports image capture resolution of up to 144 x167 pixels.

## Record a video clip

In the standby mode, select **Menu** > **Media** > **Video**.

To record a video clip, press the camera key, or select **Record**. To adjust the camera zoom level, press the scroll key or volume key up and down. The video clip is saved in the Recordings folder in Gallery. To record another video clip, select **Back**. To send the video clip in a message, select **Options** > **Send**. To view more options, select **Options**.

## Video options

In the standby mode, select **Menu** > **Media** > **Video** > **Options** and from the following:

**Still image** – Switch to the still image or video mode.

**Mute** – Record a video clip without sound.

**Effects** – Adjust the video filters.

**Open Gallery** – Open the Gallery to view saved video clip and other recordings.

**Settings** – Change the camera settings.

## Media player

Download, view, and play compatible images, audio and video files, and animated images from a variety of sources.

To open a file, select **Menu** > *Media* > *Media player* > *Open gallery*, the file, and **Open**.

## **Radio**

The FM radio depends on an antenna other than the wireless device antenna. A compatible headset or enhancement must be attached to the device for the FM radio to function properly.





**Warning:** Listen to music at a moderate level. Continuous exposure to high volume may damage your hearing.

To listen to the radio, select **Menu** > *Media* > *Radio*.

To tune to a channel, scroll left or right. To go to the next or previously saved station, scroll up or down. To search for available stations, select **Options** > *Search all stations*. To access more options while listening to a channel, select **Options**. To turn the radio off, select **Options** > *Turn off*.

## Voice recorder

Record speech or sound with your device and listen to them later. You can record up to 180 seconds of sound, depending on the available memory.

To start recording, select **Menu** > **Media** > **Voice recorder**, and the record button . To stop recording, select the stop button . The recording is saved to the Recordings list in the Recordings folder in Gallery.

After you save a recording, select **Options** > **Play last recorded**, **Send last recorded**, **Recordings list**, or **Select memory**.

## ■ **Organiser**

Your device contains features to help organise your everyday.



## Alarm clock

The alarm clock is based on the device clock. A set alarm will sound even when the device is switched off.

To set an alarm, select **Menu** > **Organiser** > **Alarm clock**, select **On**, and enter the time.

To set the phone to alert on selected days of week, select *Repeat* and *Repeat days*.

To set the alarm tone, select *Alarm tone*.

When the alarm sounds, select *Stop* to shut the alarm off, or *Snooze* to postpone it.

To turn off an active alarm, select *Menu* > *Organiser* > *Alarm* > *Off*.

## Calendar

The calendar keeps track of reminders, calls you need to make, meetings, memos, to-do list, and birthdays. You can also set an alarm to remind you of these events.

To open the calendar, scroll right, or select *Menu* > *Organiser* > *Calendar*. To go to a specific date, select *Options* in the calendar view and *Go to date*, enter the date, and select *OK*.

## To-do list

You can keep track of your tasks with the to-do list. To add a to-do note, select *Menu* > *Organiser* > *To-do list* > *Add*

**note** . Enter the subject, priority, due date, due time, and alarm type, and select **Save**.

## Notes

You can save short notes in your device.

To add a note, select **Menu** > **Organiser** > **Notes** > **Add note**. Enter the note, and select **Save**.

## Calculator

You can use the calculator to add, subtract, multiply, divide, calculate the square and the square root, and convert currency values, also using the negative values.



**Note:** This calculator has limited accuracy and is designed for simple calculations.

1. Select **Menu** > **Organiser** > **Calculator**.
2. Enter the first number in the calculation.  
Press **#** for a decimal point, if necessary.

Press **\*** repeatedly to add the add (+), subtract (-), multiply (\*), or divide (/) operator. Pause briefly to select the displayed character.

3. Enter the second number in your calculation. To display the result, select **Equals**. To perform a square or square root calculation after, select **Options** > *Square* or *Square root*.

## Countdown timer

You can enter a specified time up to 99 hours, 59 minutes, and 59 seconds. The timer starts to count down.

The countdown timer only works when the device is switched on.

Select **Menu** > *Organiser* > *Countd. timer*.

To set the countdown timer, select *Normal timer*, enter the time in hh:mm:ss format, select **OK**. Enter a note for the timer, and select **Start**.

To set an interval timer, select *Interval timer* > *Add new timer*, enter a name for the timer, and select **Save**. Enter the time interval, and select **OK**.

To start an interval timer, select **Menu** > *Organiser* > *Countd. timer* > *Interval timer*, the interval timer you want, and *Start timer* > **Start**.

When the time runs out, your device sounds an alarm, displays the timer note, and flashes its lights.



## Stopwatch

Your device has a stopwatch that can be used to track time. The stopwatch displays time in hours, minutes, seconds, and fractions of a second.

Using the stopwatch, or allowing it to run in the background when using other features, increases the demand on battery power and reduces the battery life.

To use the split time or lap time functions for activities where you need to time yourself, select **Menu** > *Organiser* > *Stopwatch* > *Split timing* or *Lap timing* > **Start**.

To stop the stopwatch, select **Stop**.

### ■ Applications

Applications is a network service. For more information, see "Network services", p. 8.

The Brew functions may be listed if your service provider supports these features.

### ■ Web

You can access various mobile internet services with your phone browser. Check the availability



of these services, pricing, tariffs, and instructions with your service provider.

## ■ Extras



Select **Menu** > *Extras*.

To play a game in your device, select *Games*.

To set or view the time in a different location, select *Collection* > *World clock*.

To calculate exchange rates, select *Collection* > *Converter*.

## ■ UTK



Your UIM card may provide additional services.

You can access this menu only if it is supported by your UIM card. The name and contents of the menu depend on the available services. For availability and information on using UIM card services, contact your UIM card vendor. This may be the service provider, network operator, or other vendor.

## 6. Enhancements

---



For availability of approved enhancements, please check with your dealer. When you disconnect the power cord of any enhancement, grasp and pull the plug, not the cord.



**Warning:** Use only batteries, chargers, and enhancements approved by Nokia for use with this particular model. The use of any other types may invalidate any approval or warranty, and may be dangerous.

## 7. Battery and charger information

---

This section provides information about your phone batteries, enhancements, chargers, safety guidelines and technical information. Be aware that the information in this section is subject to change as batteries, chargers, and enhancements change.

Your device is powered by a rechargeable battery. The battery intended for use with this device is BL-4C 860 mAh Li-Ion battery. This device is intended for use when supplied with power from the following charger: AC-6U. The battery can be charged and discharged hundreds of times, but it will eventually wear out. When the talk and standby times are noticeably shorter than normal, replace the battery. Use only Nokia approved batteries, and recharge your battery only with Nokia approved chargers designated for this device. Use of an unapproved battery or charger may present a risk of fire, explosion, leakage, or other hazard.

If a battery is being used for the first time or if the battery has not been used for a prolonged period, it may be necessary to connect the charger, then disconnect and

reconnect it to begin charging the battery. If the battery is completely discharged, it may take several minutes before the charging indicator appears on the display or before any calls can be made.

Always switch the device off and disconnect the charger before removing the battery.

Unplug the charger from the electrical plug and the device when not in use. Do not leave a fully charged battery connected to a charger, since overcharging may shorten its lifetime. If left unused, a fully charged battery will lose its charge over time.

Always try to keep the battery between 15°C and 25°C (59°F and 77°F). Extreme temperatures reduce the capacity and lifetime of the battery. A device with a hot or cold battery may not work temporarily. Battery performance is particularly limited in temperatures well below freezing.

Do not short-circuit the battery. Accidental short-circuiting can occur when a metallic object such as a coin, clip, or pen causes direct connection of the positive (+) and negative (-) terminals of the battery. (These look like metal strips on the battery.) This might happen, for

example, when you carry a spare battery in your pocket or purse. Short-circuiting the terminals may damage the battery or the connecting object.

Do not dispose of batteries in a fire as they may explode. Batteries may also explode if damaged. Dispose of batteries according to local regulations. Please recycle when possible. Do not dispose as household waste.

Do not dismantle, cut, open, crush, bend, deform, puncture, or shred cells or batteries. In the event of a battery leak, do not allow the liquid to come in contact with the skin or eyes. In the event of such a leak, flush your skin or eyes immediately with water, or seek medical help.

Do not modify, remanufacture, attempt to insert foreign objects into the battery, or immerse or expose it to water or other liquids.

Improper battery use may result in a fire, explosion, or other hazard. If the device or battery is dropped, especially on a hard surface, and you believe the battery has been damaged, take it to a service centre for inspection before continuing to use it.

Use the battery only for its intended purpose. Never use any charger or battery that is damaged. Keep your battery out of the reach of small children.

## ■ Nokia battery authentication guidelines

Always use original Nokia batteries for your safety. To check that you are getting an original Nokia battery, purchase it from an authorised Nokia dealer, and inspect the hologram label using the following steps:

Successful completion of the steps is not a total assurance of the authenticity of the battery. If you have any reason to believe that your battery is not an authentic, original Nokia battery, you should refrain from using it, and take it to the nearest authorised Nokia service point or dealer for assistance. Your authorised Nokia service point or dealer will inspect the battery for authenticity. If authenticity cannot be verified, return the battery to the place of purchase.

## Authenticate hologram

1. When you look at the hologram on the label, you should see the Nokia connecting hands symbol from one angle and the Nokia Original Enhancements logo when looking from another angle.
2. When you angle the hologram left, right, down, and up, you should see 1, 2, 3 and 4 dots on each side respectively.



## What if your battery is not authentic?

If you cannot confirm that your Nokia battery with the hologram on the label is an authentic Nokia battery, please do not use the battery. Take it to the nearest authorised Nokia service point or dealer for assistance. The use of a battery that is not approved by the manufacturer may be dangerous and may result in poor



performance and damage to your device and its enhancements. It may also invalidate any approval or warranty applying to the device.

To find out more about original Nokia batteries, visit [www.nokia.com/battery](http://www.nokia.com/battery).

DRAFT

## Care and maintenance

---

Your device is a product of superior design and craftsmanship and should be treated with care. The following suggestions will help you protect your warranty coverage.

- Keep the device dry. Precipitation, humidity, and all types of liquids or moisture can contain minerals that will corrode electronic circuits. If your device does get wet, remove the battery, and allow the device to dry completely before replacing it.
- Do not use or store the device in dusty, dirty areas. Its moving parts and electronic components can be damaged.
- Do not store the device in hot areas. High temperatures can shorten the life of electronic devices, damage batteries, and warp or melt certain plastics.
- Do not store the device in cold areas. When the device returns to its normal temperature, moisture can form inside the device and damage electronic circuit boards.
- Do not attempt to open the device other than as instructed in this guide.
- Do not drop, knock, or shake the device. Rough handling can break internal circuit boards and fine mechanics.

- Do not use harsh chemicals, cleaning solvents, or strong detergents to clean the device.
- Do not paint the device. Paint can clog the moving parts and prevent proper operation.
- Use a soft, clean, dry cloth to clean any lenses, such as camera, proximity sensor, and light sensor lenses.
- Use only the supplied or an approved replacement antenna. Unauthorised antennas, modifications, or attachments could damage the device and may violate regulations governing radio devices.
- Use chargers indoors.
- Always create a backup of data you want to keep, such as contacts and calendar notes.
- To reset the device from time to time for optimum performance, power off the device and remove the battery.

These suggestions apply equally to your device, battery, charger, or any enhancement. If any device is not working properly, take it to the nearest authorised service facility for service.



## Disposal

The crossed-out wheeled-bin symbol on your product, literature, or packaging reminds you that all electrical and electronic products, batteries, and accumulators must be taken to separate collection at the end of their working life. This requirement applies to the European Union and other locations where separate collection systems are available. Do not dispose of these products as unsorted municipal waste.

By returning the products to collection you help prevent uncontrolled waste disposal and promote the reuse of material resources. More detailed information is available from the product retailer, local waste authorities, national producer responsibility organizations, or your local Nokia representative. For the product Eco-Declaration or instructions for returning your obsolete product, go to country-specific information at [www.nokia.com](http://www.nokia.com).

# Additional safety information

---

## ■ Small children

Your device and its enhancements may contain small parts. Keep them out of the reach of small children.

## ■ Operating environment

This device meets RF exposure guidelines when used either in the normal use position against the ear or when positioned at least 2.2 centimeters (7/8 inch) away from the body. When a carry case, belt clip, or holder is used for body-worn operation, it should not contain metal and should position the device the above-stated distance from your body.

To transmit data files or messages, this device requires a quality connection to the network. In some cases, transmission of data files or messages may be delayed until such a connection is available. Ensure the above separation distance instructions are followed until the transmission is completed.

Parts of the device are magnetic. Metallic materials may be attracted to the device. Do not place credit cards or other magnetic storage media near the device, because information stored on them may be erased.

## ■ Medical devices

Operation of any radio transmitting equipment, including wireless phones, may interfere with the functionality of inadequately protected medical devices. Consult a physician or the manufacturer of the medical device to determine if they are adequately shielded from external RF energy or if you have any questions. Switch off your device in health care facilities when any regulations posted in these areas instruct you to do so. Hospitals or health care facilities may be using equipment that could be sensitive to external RF energy.

### Implanted medical devices

Manufacturers of medical devices recommend that a minimum separation of 15.3 centimetres (6 inches) should be maintained between a wireless device and an implanted medical device, such as a pacemaker or implanted cardioverter defibrillator, to avoid potential interference with the medical device. Persons who have such devices should:

- Always keep the wireless device more than 15.3 centimetres (6 inches) from the medical device when the wireless device is turned on.
- Not carry the wireless device in a breast pocket.
- Hold the wireless device to the ear opposite the medical device to minimise the potential for interference.

- Turn the wireless device off immediately if there is any reason to suspect that interference is taking place.
- Read and follow the directions from the manufacturer of their implanted medical device.

If you have any questions about using your wireless device with an implanted medical device, consult your health care provider.

### Hearing aids

Some digital wireless devices may interfere with some hearing aids. If interference occurs, consult your service provider.

### ■ Vehicles

RF signals may affect improperly installed or inadequately shielded electronic systems in motor vehicles such as electronic fuel injection systems, electronic antiskid (antilock) braking systems, electronic speed control systems, and air bag systems. For more information, check with the manufacturer, or its representative, of your vehicle or any equipment that has been added.

Only qualified personnel should service the device or install the device in a vehicle. Faulty installation or service may be dangerous and may invalidate any warranty that may apply to the device. Check regularly that all wireless device equipment in your vehicle is mounted and operating properly. Do not store or

carry flammable liquids, gases, or explosive materials in the same compartment as the device, its parts, or enhancements. For vehicles equipped with an air bag, remember that air bags inflate with great force. Do not place objects, including installed or portable wireless equipment in the area over the air bag or in the air bag deployment area. If in-vehicle wireless equipment is improperly installed and the air bag inflates, serious injury could result.

Using your device while flying in aircraft is prohibited. Switch off your device before boarding an aircraft. The use of wireless teledevices in an aircraft may be dangerous to the operation of the aircraft, disrupt the wireless telephone network, and may be illegal.

### ■ Potentially explosive environments

Switch off your device when in any area with a potentially explosive atmosphere, and obey all signs and instructions. Potentially explosive atmospheres include areas where you would normally be advised to turn off your vehicle engine. Sparks in such areas could cause an explosion or fire resulting in bodily injury or even death. Switch off the device at refuelling points such as near gas pumps at service stations. Observe restrictions on the use of radio equipment in fuel depots, storage, and distribution areas; chemical plants; or where blasting operations are in progress. Areas with a potentially explosive atmosphere are



often, but not always, clearly marked. They include below deck on boats, chemical transfer or storage facilities and areas where the air contains chemicals or particles such as grain, dust, or metal powders. You should check with the manufacturers of vehicles using liquefied petroleum gas (such as propane or butane) to determine if this device can be safely used in their vicinity.

## ■ Emergency calls



**Important:** This device operates using radio signals, wireless networks, landline networks, and user-programmed functions. If your device supports voice calls over the internet (internet calls), activate both the internet calls and the cellular phone. The device will attempt to make emergency calls over both the cellular networks and through your internet call provider if both are activated. Connections in all conditions cannot be guaranteed. You should never rely solely on any wireless device for essential communications like medical emergencies.

### To make an emergency call:

1. If the device is not on, switch it on. Check for adequate signal strength. Depending on your device, you may also need to complete the following:
  - Insert a UIM card if your device uses one.

- Remove certain call restrictions you have activated in your device.
  - Change your profile from offline or flight profile mode to an active profile.
2. Press the end key as many times as needed to clear the display and ready the device for calls.
  3. Enter the official emergency number for your present location. Emergency numbers vary by location.
  4. Press the call key.

When making an emergency call, give all the necessary information as accurately as possible. Your wireless device may be the only means of communication at the scene of an accident. Do not end the call until given permission to do so.

## ■ Certification information (SAR)

**This mobile device meets guidelines for exposure to radio waves.**

Your mobile device is a radio transmitter and receiver. It is designed not to exceed the limits for exposure to radio waves recommended by international guidelines. These guidelines were developed by the independent scientific organization ICNIRP and include safety margins designed to assure the protection of all persons, regardless of age and health.

The exposure guidelines for mobile devices employ a unit of measurement known as the Specific Absorption Rate or SAR. The SAR limit stated in the ICNIRP guidelines is 2.0 watts/kilogram (W/kg) averaged over 10 grams of tissue. Tests for SAR are conducted using standard operating positions with the device transmitting at its highest certified power level in all tested frequency bands. The actual SAR level of an operating device can be below the maximum value because the device is designed to use only the power required to reach the network. That amount changes depending on a number of factors such as how close you are to a network base station. The highest SAR value under the ICNIRP guidelines for use of the device at the ear is 0.76 W/kg.

Use of device accessories and enhancements may result in different SAR values. SAR values may vary depending on national reporting and testing requirements and the network band. Additional SAR information may be provided under product information at [www.nokia.com](http://www.nokia.com).

Your mobile device is also designed to meet the requirements for exposure to radio waves established by the Federal Communications Commission (USA) and Industry Canada. These requirements set a SAR limit of 1.6 W/kg averaged over one gram of tissue. The highest SAR value reported under this standard during product certification for use at the ear is 1.12 W/kg and when properly worn on the body is 0.55 W/kg.

## ■ Technical information

Feature	Specification
Dimensions	Width 40 mm Length 110 mm Depth 12 mm
Weight	72 g with BL-4C Li-ion battery
Wireless networks	CDMA 800 MHz
Volume	46.4 cc
Cell Frequency range (Tx)	824.70~848.31 MHz
Cell Frequency range (Rx)	869.70~893.31 MHz
Audio formats	MIDI, MP3, 4GV-EVRC-B, QCELP
Ringing tones	MIDI 64 polyphonics

## ■ Battery information

This section provides information about battery charging times with the travel charger (AC-6U), and talk and standby times. The information in this section is subject to change. For more information, contact your service provider.



**Important:** Battery talk and standby times are estimates only and depend on signal strength, network conditions, features used, battery age and condition, temperatures to which battery is exposed, use in digital mode, and many other factors. The amount of time a device is used for calls will affect its standby time. Likewise, the amount of time that the device is turned on and in the standby mode will affect its talk time.

### Charging times

The following charging times are approximate:

Charger	AC-6U
BL-4C 860 mAh Li-Ion battery	Up to 3.5 hours

### Talk and standby times

Operation times are estimates only and depend on signal strength, phone use, network conditions, features used, battery age and condition (including charging habits), temperatures to which the battery is exposed, and many other factors.

Function	Digital
Talk time	Up to 3.5 hours
Standby time	Up to 10 days