

# RM-687 User Guide

---

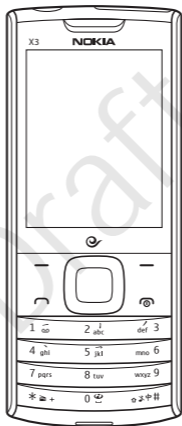

© 2010 Nokia. All rights reserved.

Nokia, Nokia Connecting People, and Navi are trademarks or registered trademarks of Nokia Corporation. Nokia tune is a sound mark of Nokia Corporation. Other product and company names mentioned herein may be trademarks or tradenames of their respective owners.

Reproduction, transfer, distribution, or storage of part or all of the contents in this document in any form without the prior written permission of Nokia is prohibited.



Includes RSA BSAFE cryptographic or security protocol software from RSA Security.

Nokia operates a policy of ongoing development. Nokia reserves the right to make changes and improvements to any of the products described in this document without prior notice.

TO THE MAXIMUM EXTENT PERMITTED BY APPLICABLE LAW, UNDER NO CIRCUMSTANCES SHALL NOKIA OR ANY OF ITS LICENSORS BE RESPONSIBLE FOR ANY LOSS OF DATA OR INCOME OR ANY SPECIAL, INCIDENTAL, CONSEQUENTIAL OR INDIRECT DAMAGES HOWSOEVER CAUSED.

THE CONTENTS OF THIS DOCUMENT ARE PROVIDED "AS IS" EXCEPT AS REQUIRED BY APPLICABLE LAW, NO WARRANTIES OF ANY KIND, EITHER EXPRESS OR IMPLIED, INCLUDING, BUT NOT LIMITED TO, THE IMPLIED WARRANTIES OF MERCHANTABILITY AND FITNESS FOR A PARTICULAR PURPOSE, ARE MADE IN RELATION TO THE ACCURACY, RELIABILITY OR CONTENTS OF THIS DOCUMENT. NOKIA RESERVES THE RIGHT TO REVISE THIS DOCUMENT OR WITHDRAW IT AT ANY TIME WITHOUT PRIOR NOTICE.

Reverse engineering of any software in the Nokia device is prohibited to the extent permitted by applicable law. Insofar as this user guide contains any limitations on Nokia's representations warranties, damages and

liabilities, such limitations shall likewise limit any representations, warranties, damages and liabilities of Nokia's licensors.

The availability of particular products and applications for these products may vary by region. Please check with your Nokia dealer for details, and availability of language options.

### Export controls

This device may contain commodities, technology, or software subject to export laws and regulations from the US and other countries. Diversion contrary to law is prohibited.

The third-party applications provided with your device may have been created and may be owned by persons or entities not affiliated with or related to Nokia. Nokia does not own the copyright or intellectual property rights to the third-party applications. As such, Nokia does not take any responsibility for end-user support, functionality of the applications, or the information in the applications or these materials. Nokia does not provide any warranty for the third-party applications.

BY USING THE APPLICATIONS YOU ACKNOWLEDGE THAT THE APPLICATIONS ARE PROVIDED AS IS WITHOUT WARRANTY OF ANY KIND, EXPRESS OR IMPLIED, TO THE MAXIMUM EXTENT PERMITTED BY APPLICABLE LAW. YOU FURTHER ACKNOWLEDGE THAT NEITHER NOKIA NOR ITS AFFILIATES MAKE ANY REPRESENTATIONS OR WARRANTIES, EXPRESS OR IMPLIED, INCLUDING BUT NOT LIMITED TO WARRANTIES OF TITLE, MERCHANTABILITY OR FITNESS FOR A PARTICULAR PURPOSE, OR THAT THE APPLICATIONS WILL NOT INFRINGE ANY THIRD-PARTY PATENTS, COPYRIGHTS, TRADEMARKS, OR OTHER RIGHTS.

### FCC NOTICE

Your device may cause TV or radio interference (for example, when using a telephone in close proximity to receiving equipment). The FCC can require

you to stop using your telephone if such interference cannot be eliminated. If you require assistance, contact your local service facility. This device complies with part 15 of the FCC rules. Operation is subject to the following two conditions: (1) This device may not cause harmful interference, and (2) this device must accept any interference received, including interference that may cause undesired operation. Any changes or modifications not expressly approved by Nokia could void the user's authority to operate this equipment.

xxxxxxx/Issue 1

Draft

# Contents

---

## SAFETY 7

### 1. Get started 11

- Insert the UIM card and battery 11
- Insert and remove the microSD card 13
- Charge the battery 15
- Switch your device on or off 16
- Normal operating position 16
- Access codes 17
- Nokia support on the web 18

### 2. Your device 19

- Keys and parts (front) 19
- Keys and parts (back) 20
- Standby mode and shortcuts 21
- Active standby 22
- Keyguard 23

### 3. Call functions 24

- Make a call 24
- Answer or reject a call 24
- Conference call 24
- Loudspeaker 25
- Voice dialling 25

### 4. Write text 27

- Switch between input methods 27
- Pinyin input method 28

- Stroke input method 28
- Phrase input 30
- Activate or deactivate predictive English input 32
- Traditional English input 32
- Predictive English input 33
- Tips for writing text 34

### 5. Voice commands 35

- Activate and use voice commands 35
- Voice commands settings 36

### 6. Menu functions 37

- Messaging 37
- Contacts 46
- Log 49
- esurfing 50
- Web 50
- Best Tone 50
- Customer Service 51
- Settings 51
- Gallery 63
- Media 65
- Organiser 71
- Extras 74

### 7. Accessories 75

## 8. Battery and charger information 80

Battery information 83

Nokia battery authentication guidelines 84

Care and maintenance 87

Additional safety information 91

Index 99

Draft

# SAFETY

---

Read these simple guidelines. Not following them may be dangerous or illegal. Read the complete user guide for further information.



## SWITCH ON SAFELY

Do not switch the device on when wireless phone use is prohibited or when it may cause interference or danger.



## ROAD SAFETY COMES FIRST

Obey all local laws. Always keep your hands free to operate the vehicle while driving. Your first consideration while driving should be road safety.



## INTERFERENCE

All wireless devices may be susceptible to interference, which could affect performance.



## SWITCH OFF IN RESTRICTED AREAS

Follow any restrictions. Switch the device off in aircraft, near medical equipment, fuel, chemicals, or blasting areas.



## QUALIFIED SERVICE

Only qualified personnel may install or repair this product.



#### ACCESSORIES AND BATTERIES

Use only approved accessories and batteries. Do not connect incompatible products.



#### WATER-RESISTANCE

Your device is not water-resistant. Keep it dry.

## ■ About your device

The wireless device (RM-687) described in this guide is approved for use on the CDMA 800 MHz network. Contact your service provider for more information about networks.

When using the features in this device, obey all laws and respect local customs, privacy and legitimate rights of others, including copyrights.

Copyright protection may prevent some images, music, and other content from being copied, modified or transferred.

Your device may have preinstalled bookmarks and links for third-party internet sites. You may also access other third-party sites through your device. Third-party sites are not affiliated with Nokia, and Nokia does not endorse or assume liability for them. If you choose to access such sites, you should take precautions for security or content.





**Warning:** To use any features in this device, other than the alarm clock, the device must be switched on. Do not switch the device on when wireless device use may cause interference or danger.

Remember to make back-up copies or keep a written record of all important information stored in your device.

When connecting to any other device, read its user guide for detailed safety instructions. Do not connect incompatible products.

## ■ Network services

To use the device you must have service from a wireless service provider. Many of the features require special network features. These features are not available on all networks; other networks may require that you make specific arrangements with your service provider before you can use the network services. Using network services involves transmission of data. Check with your service provider for details about fees in your home network and when roaming in other networks. Your service provider can give you instructions and explain what charges will apply. Some networks may have limitations that affect how you can use network services. For instance, some networks may not support all language-dependent characters and services.

Your service provider may have requested that certain features be disabled or not activated in your device. If so, these features will not appear on your device menu. Your device may also have a special configuration such as changes in menu names, menu order, and icons. Contact your service provider for more information.

This device supports WAP 2.0 protocols (HTTP and SSL) that run on TCP/IP protocols. Some features of this device, such as sending e-mail, browsing websites, or downloading files require network support for these technologies.

Draft

# 1. Get started

## ■ Insert the UIM card and battery



**Note:** Always switch off the power and disconnect the charger and any other device before removing the cover. Avoid touching electronic components while changing the cover. Always store and use the device with the cover attached.

### Remove the back cover and battery

1. With the back of the device facing you, press the release button, and lift up the back cover.

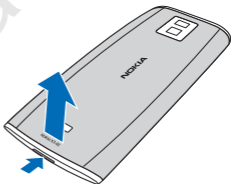

2. Insert your finger into the finger grip, and lift the battery from its compartment.

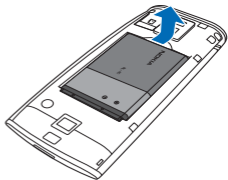

### **Insert the UIM card**

Ensure that the contact area on the UIM card is facing downwards and the bevelled corner on the card is facing away from the top of the device, and insert the UIM card into the card slot.

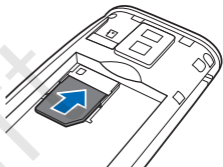

### **Replace the battery and back cover**

1. Align the battery contacts with those on the device, and press down on the other end of the battery.

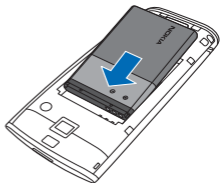

2. Insert the tabs at the top of the cover into the slots in the device, and press down on the other end of the back cover.

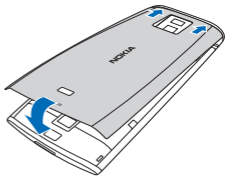

## ■ Insert and remove the microSD card

Use only compatible microSD cards approved by Nokia for use with this device. Your device supports microSD cards up to 16 GB. Nokia uses approved industry standards for memory cards, but some brands may not be fully compatible with this device. Incompatible cards may damage the card and the device and corrupt data stored on the card.

## Insert the microSD card

1. Remove the back cover.
2. Ensure that the contact area on the microSD card is facing downwards, and insert the microSD card into the card slot.
3. Replace the back cover.



## Remove the microSD card



**Important:** Do not remove the memory card in the middle of an operation when the card is being accessed. Removing the card in the middle of an operation may damage the memory card as well as the device, and data stored on the card may be corrupted.

1. Remove the back cover.
2. Remove the memory card from the slot.
3. Replace the back cover.

## ■ Charge the battery



**Warning:** Use only batteries, chargers, and accessories approved by Nokia for use with this particular model. The use of any other types may invalidate any approval or warranty, and may be dangerous.

Your battery has been partially charged at the factory. If the device indicates a low charge, do the following:

1. Connect the charger to a wall outlet.
2. Connect the charger to the device.
3. When the device indicates a full charge, disconnect the charger from the device, then from the wall outlet.

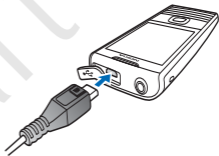

You do not need to charge the battery for a specific length of time, and you can use the device while it is charging. If the battery is completely discharged, it may take several minutes before the charging indicator appears on the display or before any calls can be made.

## ■ Switch your device on or off

Press and hold the power key for at least 3 seconds.



**Warning:** Do not switch the device on when wireless phone use is prohibited or when it may cause interference or danger.

## ■ Normal operating position

Your device has an internal antenna. Use the device only in its normal operating position.







**Note:** Your device may have internal and external antennas. As with any radio transmitting device, avoid touching the antenna area unnecessarily while the antenna is transmitting or receiving. Contact with such an antenna affects the communication quality and may cause the device to operate at a higher power level than otherwise needed and may reduce the battery life.



## ■ Access codes

When the device or keypad is locked, calls may be possible to the official emergency number programmed into your device. Making an emergency call in the flight profile or when the device is locked requires that the device recognise the number to be an official emergency number. It is advisable to change the profile or unlock the device by entering the lock code before you make the emergency call.

To activate the device when it is locked, enter the lock code. The default lock code is 1234. You can create and change the code, and set the device to request the code. Keep the new code secret and in a safe place separate from your device. If you forget the code and your device is locked, your device will require service. Additional charges may apply, and all the personal data in your device may be deleted. For more information, contact a Nokia Care point or your device dealer.

To define the security settings for your device, select **Menu** > *Settings* > *Security*.

## ■ **Nokia support on the web**

Check [www.nokia.com/support](http://www.nokia.com/support) or your local Nokia website for the latest guide, additional information, downloads, and services related to your Nokia product.

## 2. Your device

### ■ Keys and parts (front)

1. Nokia AV connector
2. Earpiece
3. Navi™ key (scroll key)
4. Left selection key
5. Call key
6. Keypad
7. Release button
8. Microphone
9. Power/End key
10. Middle selection key
11. Right selection key
12. Charger/Micro USB connector

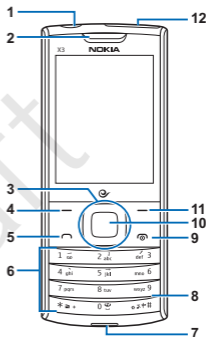

## ■ Keys and parts (back)

1. Volume keys
2. Media key
3. Capture key
4. Speaker
5. Camera lens
6. Flash
7. Wrist strap eyelet

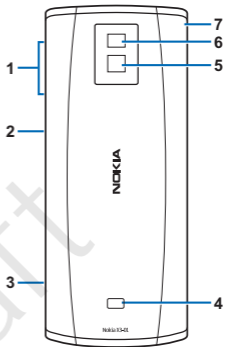

## ■ Standby mode and shortcuts

Generally, instructions in this guide start from the standby mode except when specifically indicated. To go to the standby mode, press the power key.

Depending on your wireless service provider, some or all of the following selection keys may appear in the standby mode.

1. Signal strength – The signal strength of the wireless network at your current location.
2. Battery level – The battery power is indicated by the length of the bar.
3. **Go to** – Press the left selection key to quickly access a certain feature.
4. **Menu** – Press the middle selection key to access the main menu.
5. **Web** – Press the right selection key to access mobile internet service.

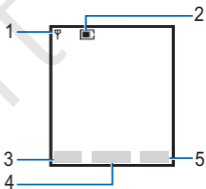

## Shortcuts in the standby mode:

- To access the call log, press the call key once.
- To switch between General profile and Silent profile, press and hold # for at least 3 seconds.
- To activate the radio function, press and hold \* for at least 3 seconds.
- For shortcuts of the scroll key, see "My shortcuts", p. 55.

## ■ Active standby

To activate the active standby mode, scroll up in the standby mode. To access a feature, scroll up or down to select the feature, and select **Select**. To end the active standby mode, select **Exit**.

To activate the active standby mode, select **Menu** > *Settings* > *Display* > *Active standby* > *Active standby mode* > *On*.

To change the default application shortcuts, select **Menu** > *Settings* > *Display* > *Active standby* > *Personalise view*.

## ■ Keyguard

The keyguard locks the keypad to prevent accidental key presses.

When the keypad is locked, calls still may be possible to the official emergency number programmed into your device. Enter the emergency number, and press the call key. The number is displayed only after you have entered its last digit.

To lock the keypad automatically when no keys are pressed for a certain length of time, in the standby mode, select **Menu** > **Settings** > **Phone** > **Automatic keyguard** > **On**, and enter the desired delay time.

To unlock the keypad, select **Unlock**, then press \* within 2 seconds.

If you receive a call when the keypad is locked, it is automatically unlocked, and then locked again when you end the call.

## 3. Call functions

### ■ Make a call

1. In the standby mode, enter the phone number, including the country code and area code if necessary.
2. Press the call key.
3. To end the call or to cancel the call attempt, press the end key.

### ■ Answer or reject a call

To answer a call, press the call key. To reject an incoming call, press the end key.

### ■ Conference call

Conference call (network service) allows you to take part in a call with up to three participants, including yourself.

1. To call a third party during a call, select **Options** > *New call*.
2. Enter the number you want, and press the call key.



3. When the new call is answered, press the call key.
4. To end the conference call, select **Options** > *End all calls*, or press the end key.

## ■ Loudspeaker



**Warning:** Do not hold the device near your ear when the loudspeaker is in use because the volume may be extremely loud.

To activate the loudspeaker during a call, select **Loudsp..**  
To deactivate the loudspeaker, select **Normal**. When a headset is connected, select **Heads..**

The loudspeaker is deactivated automatically when a call ends or when certain accessories are connected.

## ■ Voice dialling

You can make a phone call by saying the name or the number that is saved in the contacts list of the device. Voice tags are automatically created when a new contact is added.



**Note:** Using voice tags may be difficult in a noisy environment or during an emergency, so you should not rely solely upon voice dialling in all circumstances.

As voice commands are language-dependent, before voice dialling, select **Menu** > **Settings** > **Phone** > **Language settings** > **Recogn. language** and your language.

To activate voice dialling, press and hold the volume down key. A short tone sounds, and **Say a command** is displayed.

To cancel voice dialling, press the end key.

To make a call by voice dialling, clearly say Call then the name or the number of the contact you want to dial. If the device recognises the name you spoke, it shows a list of matches.





## 4. Write text

This phone supports simplified Chinese input methods.

To switch writing language, when writing text, press and hold #, and select *Writing language* and the desired language.

### ■ Switch between input methods

Input method indicators are shown at the top of the display:

Pinyin		Lower case	
Stroke		Number input	
Uppercase			

Not all the methods may be available in all circumstances. Always check the indicator to see which input method is in use.

To switch between available input methods, press # repeatedly until the indicator of the desired input method is displayed.

## ■ Pinyin input method

The pinyin symbols are printed on the number keys. You only need to press a key once, regardless of the position of the symbol on the number key. The phone makes logical combinations of the pinyin symbols.

To input a character using the pinyin input method:

1. Press the number key once for each pinyin symbol you want to input (use "v" for "u").
2. Press 1 repeatedly until you get the desired tone mark.
3. If necessary, press \* repeatedly to highlight the desired pinyin combination.
4. Scroll to the desired Chinese character, and select **OK**.

## ■ Stroke input method

The strokes constituting Chinese characters have been divided into five categories: horizontal, vertical, left-falling, dot, and turning. Each category corresponds to a number key from 1 to 5, respectively.

按键	1	2	3	4	5
笔画分类	一	丨	丿	丶	→





**Tip:** if you are not sure which stroke to use or which category it belongs to, press **6** to substitute that stroke, then continue with the subsequent strokes. A question mark appears in the input area to represent that stroke.

2. Scroll to the desired Chinese character, and select **OK**.

## ■ Phrase input

You may input a phrase of no more than seven Chinese characters at a time.

1. Press the relevant number keys to enter the syllable or pinyin initial, or first strokes for the first character of the phrase.
2. Press **0** to enter a separator; or, if in the pinyin mode, press **1** repeatedly to enter the tone mark of the character you want.
3. Enter the syllable or pinyin initial, or first strokes of the next Chinese character.
4. Repeat step 2 and 3, if necessary, to enter the syllables or pinyin initials, or first strokes of all the characters in the phrase.

5. If in the pinyin mode, press \* repeatedly, if necessary, to highlight the pinyin combination you want.
6. Scroll through the candidate list to the desired phrase, and select **OK**.

Not all phrases are stored in your phone. To create a phrase of no more than seven characters, when no input symbol or prediction list is displayed, select **Options** > *User phrases* > *Add*. When the database becomes full, the new phrase replaces the phrase that has not been accessed for the longest time.

Use a separator to separate pinyin strings for syllables of different characters or the strokes of different characters.

When you enter a separator, the phone predicts characters or character strings that can form a phrase with the possible candidates of the combination of pinyin or stroke strings and separators, if any, that you have entered.

## ■ Activate or deactivate predictive English input

When writing in English, press and hold #, and select *Prediction on* or *Prediction off*.

## ■ Traditional English input

Press a number key (2 to 9) repeatedly until the desired character is displayed.

If the next letter is located on the same key as the present one, wait until the cursor appears, or scroll right, and enter the letter.

Not all characters available under a number key are printed on the key. The available characters depend on the selected *Writing language*.

The most common punctuation marks and special characters are available under the number key 1. To access the list of special characters, press \*.



## ■ Predictive English input

Predictive English input is based on a built-in dictionary to which you can also add new words.

1. Start writing a word using the keys 2–9. Press each key only once for one letter.
2. To confirm a word, scroll right or add a space.
  - If the word is not correct, press \* repeatedly until the desired word is displayed, and confirm it.
  - If the ? character is displayed after the word, the word you intended to write is not in the dictionary. To add the word to the dictionary, select **Spell**. Enter the word using traditional text input, and select **Save**.
  - To write compound words, enter the first part of the word, and scroll right to confirm it. Write the second part of the word, and confirm the word.
3. Start writing the next word.

## ■ Tips for writing text

The following functions may also be available for writing text:

- To insert a number when no input symbol is displayed, press and hold the desired number key.
- To insert a space when there is no candidate or prediction list displayed, press 0.
- To enter a special character after you have finished entering a word or character, press \*.
- To repeat a character to the left of the cursor in the editing window, press and hold \*.
- To end the Chinese character prediction, select **Back**, or press the relevant keys to start entering new text.

## 5. Voice commands

### ■ Activate and use voice commands

To activate voice command, in the standby mode, press and hold the volume down key. The following options are listed:

- *Call <Name or #>* – Say "Call" and a name or a phone number from the contacts list to make a call.
- *Send Text <Name or #>* – Say "Send text" and a name or a phone number from the contacts list to send a text message.
- *Send MMS <Name or #>* – Say "Send MMS" and a name or a phone number from the contacts list to send an MMS.
- *Lookup <Name>* – Say "Lookup" and the name from the contacts list to retrieve and display information of a contact.
- *Go To <Menu>* – Say "Go to" and the application name to activate certain device function. For the list of

functions to be activated with a voice command, see "Voice commands", p. 61.

- *Check <Item>* – Say "*Check*" and the specific status item or say "*Check*" "*Status*" to hear all the status information for your device.

To learn how to use the voice commands, select [Tutorial](#).

## ■ Voice commands settings

To personalise settings for your voice command functions, select [Settings](#) and from the following:

- *Confirmation* – Set how often the system asks you to confirm the name or number.
- *Adaptation* – Adapt the system to your voice for optimal recognition accuracy.
- *Modes* – Set the mode of audio guidance.
- *Speakerphone* – Set how the system uses the speakerphone.

## 6. Menu functions

The device functions are grouped into menus. Not all menu functions or option items are described here.

In the standby mode, select **Menu**, scroll to the menu item you want to open, and select it. To exit the current menu level, select **Exit** or **Back**. To return to the standby mode, press the end key.

### ■ Messaging



You can only use messaging services supported by your network or service provider.

### Write and send a text message

To send a message, do the following:

1. Select **Menu** > **Messaging** > **Text messages** > **Create message**.
2. Enter the recipient's phone number in the **To** field. To retrieve a phone number from the recently used recipient list or contacts, select **Add** > **Recently used** or **Contacts**, and the recipient. To send to a contact

group, select **Add** > *Contact groups*, and the desired group.

3. Write the message in the *Message* field, and select **Send**.

## Write and send a multimedia message

For availability and subscription to the multimedia messaging service (network service), contact your service provider.

Only devices that have compatible features can receive and display multimedia messages. The appearance of a message may vary depending on the receiving device.

The wireless network may limit the size of MMS messages. If the inserted picture exceeds this limit, the device may make it smaller so that it can be sent by MMS.

To send a multimedia message, do the following:

1. Select **Menu** > *Messaging* > *Multim. Messages* > *Create message*.
2. Select **Options** > *Add object*, a multimedia folder, and the file you want to send.
3. Select **Insert**.

4. Press **Options** > *Add another object*, to add the second or third files.
5. In the *To* field, enter the phone number or e-mail address for your recipient, or select **Add** to retrieve a number or address from the contacts list.
6. Enter the text for the message, and select **Send**.

## Read and reply to a message

When you receive a message, a notification and  are displayed.

1. To read the message, select **Show**, or to dismiss the notification, select **Exit**.  
 in the standby mode indicates that you have unread messages in your inbox.
2. Select **Reply** and from the available options.
3. Enter your reply, and select **Send**.

## Text message settings

Select **Menu** > *Messaging* > *Text messages* > *Message settings*.

Select *Sending options* and from the following:

- *Priority* – Send text messages with normal priority or as urgent.
- *Delivery reports* – Receive confirmation when your message is delivered. This function applies only when the recipient is a CDMA subscriber.
- *Send callback number* – Send a number to which you want to be called back.
- *Signature* – Attach a signature to outgoing message.
- *Message validity* – Select the period of validity of a messaging request (network service).

Select *Other settings* and from the following:

- *Save rcvd. text msgs.* – Select where to store received messages.
- *Message font size* – Change the font size when reading and writing messages.



- *Message overwriting* – When the message memory is full, your device cannot receive any new messages. To select which messages are overwritten when new ones arrive, select *Sent items only*, *Inbox only*, or *S. items & Inbox*.
- *Save sent messages* – Select whether to save sent messages to the Sent items folder.
- *Queue if no digital* – Save the messages in the Outbox that can be sent later when the digital service is available.

Select *Memory status* to view available and used memory.

## Multimedia messages settings

Select *Menu* > *Messaging* > *Multim. Messages* > *Message settings* and from the following:

- *Save sent messages* – Select whether the multimedia messages you send are saved to the Sent items folder.
- *Delivery reports* – Select whether to receive message delivery reports. This function applies only when the recipient is a CDMA subscriber.

- *Default slide timing* – Set the default time for slides in multimedia messages.
- *Allow MMS receipt*. – Select whether to receive multimedia messages. To only receive multimedia messages when you are in your home network, select *In home network* (network service). For more information, contact your service provider.
- *Incoming MMS msgs.* – Select whether incoming multimedia messages are retrieved automatically or manually, or not at all.
- *Allow adverts* – Select whether to block or allow advertisements (network service) sent as multimedia messages. For more information, contact your service provider.
- *Delivery report reject* – Select whether you want to deny your device sending delivery reports of received messages.
- *Message validity* – Select how long the message centre tries to send your message if the first attempt fails, if the recipient cannot be reached within the validity period, the message is deleted from the message centre.

- [Connection settings](#) – Define connection settings.
- [Memory status](#) – View available and used memory.

## Inbox, Sent items, and Drafts folders

All incoming text and multimedia messages are saved in the Inbox folder. The Outbox folder contains unsent and failed messages.

If you have set the device to save sent messages, they are saved in the Sent items folder.

To save the message you are writing to the Draft folder, to edit and send later, select [Options](#) > [Save as draft](#) (text message) or [Save message](#) (multimedia message).

## Delete messages

If your message memory is full and you have incoming messages,  blinks in the standby mode. To receive the messages, delete some of the old messages.

To delete a message, select [Menu](#) > [Messaging](#) > [Text messages](#) or [Multim. Messages](#), the message location, the message, and [Options](#) > [Delete](#) > [Yes](#).

To delete all text messages in a folder, select **Menu** > *Messaging* > *Text messages* > *Delete messages* > *All, All read, All unread* and the folder.

To delete all multimedia messages in a folder, select **Menu** > *Messaging* > *Multim. Messages* > *Delete messages* and the folder.

## Voice messages

To activate voice mail (network service), contact your service provider. When you subscribe to the service, a voice mailbox number is provided. Save the number to your device. For more information, contact your service provider.

To listen to your voice messages, select **Menu** > *Messaging* > *Voice messages* > *Listen to voice msgs.*, or, in the standby mode, press and hold 1.

## Browser messages

Browser (network service) allows you to access web services offered and updated by service providers. For more information, see "Network services", p. 9.

Select [Menu](#) > [Messaging](#) > [Browser msgs.](#)



**Important:** Exercise caution when opening messages. Messages may contain malicious software or otherwise be harmful to your device or PC.

## QQ

QQ (network service) allows you to converse with other people using instant messages. To check more information about signing up and costs of QQ service, contact your service provider.

Select [Menu](#) > [Messaging](#) > [QQ](#).

## E-mail mailbox

E-mail mailbox (network service) allows you to set up your e-mail account and check e-mail messages on your device. For more information, see "Network services", p. 9.

Select [Menu](#) > [Messaging](#) > [E-mail mailbox](#).



**Important:** Exercise caution when opening messages. Messages may contain malicious software or otherwise be harmful to your device or PC.

## Groups

Groups allow you to send messages to a designated group of people.

To add a new group, select [Menu](#) > [Messaging](#) > [Groups](#) > [Add](#) (if the list is empty) or [Options](#) > [Add new group](#) to create another group, enter details of the group, and select [Save](#).

## ■ [Contacts](#)



To add a new contact, select [Menu](#) > [Contacts](#) > [Names](#) > [Add](#) (if the contacts list is empty) or [Options](#) > [Add new contact](#), enter the name and the phone number, and select [Save](#).

To add details, set a speed dial, or add to a group, select [Menu](#) > [Contacts](#) > [Names](#), the desired contact, [Details](#) > [Options](#) and from the available options.

To define how contact names are displayed, select **Menu** > *Contacts* > *Settings* and the appropriate option. To view how much memory your contacts information is using, select *Memory status*.

To empty your contacts list, select **Menu** > *Contacts* > *Del. all contacts*.

## Search using the search command

1. Select **Menu** > *Contacts* > *Names* > *Options* > *Search*.
2. Enter the first characters or letters of the name you are searching for, and select *Search*.

## Search using the pop-up window

1. In the standby mode, scroll down to highlight the first name (or number).
2. Enter the first input symbol of the name you are searching for. The symbol is displayed in a pop-up window. If you want, enter more symbols in the pop-up window. The matching names are displayed. The listed names may not be in the same order as in

*Names*. When using the *Search* command or pop-up window, to change the input method, press #.

## Groups

Groups allow you to send messages to a designated group of people.

To add a new group, select *Menu* > *Contacts* > *Groups* > *Add* (if the list is empty) or *Options* > *Add new group* to create additional groups, enter details of the group, and select *Save*.

## Speed dials

You can associate a speed dialling slot from 2 to 99 with an entry in the contacts. To activate or deactivate speed dialling, see "Call", p. 58.

To assign a phone number to a speed dialling slot, select *Menu* > *Contacts* > *Speed dials*, an empty speed dialling slot, and *Assign*. Enter the phone number you want to assign to the slot, or select *Search* to retrieve the number from your contacts list.



## ■ Log



To view details of your calls, select **Menu** > *Log*.

- *Call log* – View all of the numbers chronologically.
- *Missed calls*, *Received calls*, or *Dialled numbers* – View your most recently missed or received calls or dialled numbers.
- *Msg. recipients* – View the contacts to whom you most recently sent messages.
- *Clear log lists* – Delete call records from the log.
- *Call duration* – View the approximate duration of calls. To reset the timers, select *Clear timers*, enter your lock code, and select **OK**.



**Note:** The actual time invoiced for calls by your network service provider may vary, depending on network features, rounding off for billing, and so forth.

- *Data/fax calls* or *Browser calls* – View the duration or amount of data sent or received during data calls (network service) or using the browser (network service).

## ■ esurfing



esurfing provides you with mobile internet application services and voice communication services. For example, you can access your 189 e-mail mailbox, and download music and videos with mobile internet services. Check the availability of these services, pricing, tariffs, and instructions with your service provider.

## ■ Web



You can access various mobile internet services using your phone browser. For availability of these services, pricing, tariffs, and instructions, contact your service provider.



**Important:** Use only services that you trust and that offer adequate security and protection against harmful software.

## ■ Best Tone



Best Tone provides you with a kind of facilitative service that relates to "clothing, dining, housing, travelling, and other consumptions". By dialling the

service access number 118114, this service provides you with such information as food and beverage availability, tourist advice, road guide, hotel reservation, and daily consumption articles. For communication assistance, this service also offers you with enterprise switchboard, and personal secretary. Check the availability of these services, pricing, tariffs, and instructions with your service provider.

## ■ Customer Service



You can access various customer services provided by your service provider. Accessing these services may involve sending messages or making a phone call for which you may be charged. For more details, contact your service provider.

## ■ Settings



## Profiles

With profiles, you can define ringing options and how your device reacts when it receives a call or message. You

can personalise ringing options, keypad tones, and other settings for each of the available profiles.

To activate or customise a profile or set a time limit for a profile, select [Menu](#) > [Settings](#) > [Profiles](#), a profile, and [Activate](#), [Personalise](#), or [Timed](#).

## Blog site

Blog site defines the web address where you can upload your images or video clips.

To add a blog site, select [Menu](#) > [Settings](#) > [Blog site](#) > [Add](#), enter details of the site, and select [Save](#).

## Themes

A theme contains various elements for personalising your device.

To change the theme for your device, select [Menu](#) > [Settings](#) > [Themes](#) > [Select theme](#) > [Themes](#), a theme, and [Apply](#).

## Tones

Tone settings only apply to the currently selected profile.

Select **Menu** > *Settings* > *Tones* and from the appropriate option.

## Display

Select **Menu** > *Settings* > *Display* and from the following :

- *Wallpaper* – Set a background image that is displayed when the device is in the standby mode.
- *Standby font colour* – Set the font colour for text displayed when the device is in the standby mode.
- *Display brightness* – Adjust the level for the display brightness.
- *Screen saver* – Set a screen saver for the display.
- *Power saver* – Activate power saving mode to save battery power.
- *Sleep mode* – Switch off the display during inactivity.
- *Font size* – Set the font size for text.
- *Backlight time-out* – Set the length of the time-out period, after which, the backlight is switched off.

- *Active standby* – Activate or deactivate the active standby mode, to organise and personalise the active standby mode, and to set the active standby keys.
- *Navigation key icons* – Display the icons of the current scroll key shortcuts in the standby mode when the active standby mode is not activated.
- *Transition effects* – Activate or deactivate transition effect.

## Date and time

Select **Menu** > *Settings* > *Date and time* and from the following:

- *Date and time* – Set the date and time, time zone, and daylight saving time.
- *Date and time format* – Set the format for the date and time.
- *Auto-update of time* – Select if the time in your device is automatically updated to local time by the network.

## My shortcuts

To quickly access your most frequently used functions, add them to the *My shortcuts* menu.

To select a function from the list for the key you want to assign the shortcut to, select **Menu** > *Settings* > *My shortcuts*, the key, and the function.

## Connectivity

At Nokia, we understand how important it is that your mobile phone or device operates reliably and that your personal content is saved safely.

Any information from an unknown or unreliable source, via Bluetooth connectivity, multimedia message, or cable, may harm your PC, mobile phone, or device. You may protect your mobile phone or device from damage and keep it secured by following simple measures:

- Always keep Bluetooth connectivity closed unless you want your phone or device to be visible to others.
- Always be alert when receiving information from an unknown or untrustworthy source.

- Do not download or install any applications that may include software harmful to your phone or device.
- Always download and install applications or content from trusted or wellknown sources, such as Nokia Software Market, where good protection is provided against viruses and other harmful software.

Your device offers several options to connect to the internet or to another compatible device or PC.

### Bluetooth connection

This device is compliant with Bluetooth Specification 2.1 with EDR and supports the following profiles: Advance Audio Distribution Profile, A/V Remote Control, Basic Printing Profile, Dial-up Networking, File Transfer Profile, Generic A/V Dist. Profile, Hands Free Profile, Headset Profile, Object Push Profile, and Phone Book Access Profile. To ensure interoperability between other devices supporting Bluetooth technology, use Nokia approved accessories for this model. Check with the manufacturers of other devices to determine their compatibility with this device.

To activate Bluetooth connectivity, select [Menu](#) > [Settings](#) > [Connectivity](#) > [Bluetooth](#) > [Bluetooth](#) > [On](#).



To connect an audio device using Bluetooth technology, select [Menu](#) > [Settings](#) > [Bluetooth](#) > [Bluetooth](#) > [Conn. to audio acc.](#)

To pair your phone with any Bluetooth device in range, select [Paired devices](#) > [Add new device](#), a device, and [Add](#). Enter a password on your phone and allow the connection on the other Bluetooth device.

To see a list of your Bluetooth connections, select [Active devices](#).

To define how your device is shown to other Bluetooth devices, select [My phone's visibility](#) or [My phone's name](#).

Features using Bluetooth technology increase the demand on battery power and reduce the battery life.

## USB data cable

You can transfer data between your device and a compatible PC using a CA-101 USB data cable.



**Important:** To make a phone call, disconnect the USB data cable.

To transfer data, connect the data USB cable, select from the following :

- *Ask on conn.* – Set the device to ask which mode to use, each time the cable is connected.
- *PC Suite* – Use the data cable connection for Nokia PC Suite.
- *Data storage* – Connect to a PC that does not have Nokia software and use your device for data storage.

## Call

Select **Menu** > *Settings* > *Call* and from the following :

- *Anykey answer* – Answer an incoming call by pressing any key, except the end key, left and right selection key.
- *Automatic redial* – Automatically redial the number if the network is busy.
- *Speed dialling* – Activate speed dialling.
- *Calling card* – Save up to four calling card numbers in your device, to use for long distance calls.
- *Abbreviated dialling* – Program a 5-6 digit prefix for commonly used phone numbers.

- *Preferred carrier* – Select the preferred long distance carrier.
- *International prefix* – Make calls using the + sign as the international prefix. The device replaces the + sign in a saved phone number when making a call.
- *Data/fax calls* – Set your device to send or receive data calls when connected to a device such as a PDA or PC.
- *Call summary* – Display the call duration when you end a call.
- *Show call time displ.* – Select whether the duration of the current call is displayed.
- *Ringtone no caller ID* – Select whether a tone sounds for calls where there is no caller ID.
- *Message response* – Set your device to send a text message when a call is rejected.

## Device

Select **Menu** > *Settings* > *Phone* and from the following :

- *Language settings* – Set the display language of your device, select *Phone language*. To set a language for voice commands, select *Recogn. language*.
- *Memory status* – View the available memory and used memory of your device.
- *Automatic keypad* – Set the keypad to lock automatically after a preset time-out period.
- *DTMF tones* – Activate DTMF tones and set the tone duration.
- *Start-up tone* – Select whether the device sounds a tone when it is switched on.
- *Welcome note* – Write a welcome note that is displayed when you switch your device on.
- *Phone updates* – Update the phone with the latest software available.
- *Confirm UIM actions* – Set the UIM service actions visible.
- *Help text activation* – Display brief descriptions for most menu items.

- *Flight query* – Set the device to ask if you want to activate the flight profile, every time you switch the device on.
- *Gateway settings* – Select the gateway for web browsing.
- *BREW EFS enable* – Select whether to allow BREW EFS downloads.

## Voice commands

You can use voice commands to control your device.

Voice commands are language-dependent. To set the language, see "Device", p. 59.

## Accessories

Select **Menu** > *Settings* > *Enhancements*, an accessory, and an option, depending on the accessory.

## Security

To set the security settings for your device, select **Menu** > *Settings* > *Security*, and from the available options.

Some of the settings may require the lock code. The default lock code is 1234.

## Network

The Network menu allows you to customise how your device chooses which network to operate in while you are within or away from your primary or home network. Your device is set to search for the most effective network. To set which network to use when the device cannot find a preferred network, select [Menu](#) > [Settings](#) > [Network](#) > [Set mode](#), and select a mode.

## Network services

To view the network services available on your device, select [Menu](#) > [Settings](#) > [Network services](#) and the desired option. For more information, contact your service provider.

## Device information

To view the user, version, system, or icon information of your device, select [Menu](#) > [Settings](#) > [Phone details](#), and the corresponding option.

## Restore settings

Select **Menu** > *Settings* > *Rest. factory sett.* and from the following:

- *Restore settings only* – Reset some menu settings.
- *Restore all* – Restore all settings and delete personal data.

## ■ Gallery



Manage images, video clips, music files, themes, graphics, tones, recordings, and received files. These files are stored in the phone memory or on a memory card, and may be arranged in folders.

When a memory card is inserted, a folder with the memory card appears on the list. To view the memory card contents, select the folder.

To see the list of folders, select **Menu** > *Gallery*. To see the available options of a folder, select a folder and **Options**. To view the list of files in a folder, select a folder and **Open**. To see the available options of a file, select a file and **Options**.

Content owners may use different types of digital rights management (DRM) technologies to protect their intellectual property, including copyrights. This device uses various types of DRM software to access DRM-protected content. With this device you can access content protected with OMA DRM 1.0. If certain DRM software fails to protect the content, content owners may ask that such DRM software's ability to access new DRM-protected content be revoked. Revocation may also prevent renewal of such DRM-protected content already in your device. Revocation of such DRM software does not affect the use of content protected with other types of DRM or the use of non-DRM-protected content.

Digital rights management (DRM) protected content comes with an associated activation key that defines your rights to use the content.





### Camera and Video

You can capture images and record video clips with the built-in camera. The camera lens is on the back of the device.

Your device supports image capture resolutions of up to 2048x1536 pixels. The camera produces images in the JPEG format.

Your device supports video clip resolutions of up to 176x144 pixels. The video clips are saved in the 3GP format.

You can send images and video clips in a multimedia message, or using Bluetooth connectivity or web browser.

You can attach an image to a contact to be displayed when the contact calls you.

#### **Capture an image**

In the standby mode, select **Menu** > **Media** > **Camera** or press the capture key.

Keep a safe distance when using the flash. Do not use the flash on people or animals at close range. Do not cover the flash while taking a picture.

To capture an image, press the capture key, or select **Capture**. The image is saved in the Image folder in Gallery. To capture another image, select **Back**. To send the image using a multimedia message, Bluetooth, or web browser, select **Send** and the desired options. To view more options, select **Options**.

### Record a video clip

In the standby mode, select **Menu** > **Media** > **Video**.

To record a video clip, press the capture key, or select **Record**. To adjust the camera zoom level, press the scroll or volume keys. The video clip is saved in the Video clips folder in Gallery. To record another video clip, select **Back**. To send the video clip using a multimedia message, Bluetooth or web browser, select **Send** and the desired options. To view more options, select **Options**.

### Camera and Video options

In the standby mode, select **Menu** > **Media** > **Camera** or **Video** > **Options** and from the following:

- *Video* or *Still image* – Switch the mode to video or image.
- *Brightness* – Adjust the brightness setting.
- *Standard photo* or *Portrait photo* – Switch the capture mode to landscape or portrait.
- *Flash on* or *Flash off* – Switch the flash on or off.
- *Self-timer* – Use the self-timer to include yourself in the picture. Select the time for the camera to wait before capturing the image after you press the capture key.
- *Img. sequence on* and *Img. sequence off* – Capture six images in succession.
- *Mute* – Record a video clip without sound.
- *Effects* – Select the camera filters.
- *White balance* – Adjust the white balance setting.
- *Scene modes* – Select the camera scene modes.
- *View previous* – Display the last captured image.
- *Settings* – Adjust the camera or video settings.

## Media player

The media player supports the following audio formats: MIDI, CMX CODES, MP3, AAC, QCELP, AMR-NB, WMA, AAC+, and EAAC+; and the following video formats: MPEG4, H.263, and H.264.

Download, view, and play compatible images, audio and video clips, and animated images from a variety of sources.



**Warning:** Listen to music at a moderate level.

Continuous exposure to high volume may damage your hearing. Do not hold the device near your ear when the loudspeaker is in use, because the volume may be extremely loud.

To play a song, select **Menu** > **Media** > **Media player**, a multimedia folder, **Open**, the song you want to play, and **Play**.

You may use the middle selection key, left, right, up or down scroll key to control the media player.

To start or pause playback, press the middle selection key.

To fast-forward or rewind, press and hold the left or right scroll key. Release the key at the position you want to continue the playback.

To skip to the next song, press the right scroll key. To restart the current song, press the left scroll key. To skip to the previous song, press the left scroll key twice.

To close the media player, press and hold the end key.

## Voice recorder

Record speech or audio with your device and listen to them later. You can record for up to 5 minutes, depending on the available memory.

To start recording, select **Menu** > **Media** > **Voice recorder** and the record icon ●. To stop recording, select the stop icon ■. The file is saved in the Recordings folder in Gallery.

After you save a recording, select **Options** > **Play last recorded**, **Send last recorded**, **Recordings list**, or **Select memory**.

## Radio

The FM radio depends on an antenna other than the wireless device antenna. A compatible headset or accessory must be attached to the device for the FM radio to function properly.



**Warning:** Listen to music at a moderate level. Continuous exposure to high volume may damage your hearing.

To listen to the radio, select **Menu** > **Media** > **Radio**.

To search for a station, press and hold the left or right scroll key. To search for available stations, select **Options** > **Search all stations**. To save the station to a memory location, select **Options** > **Save station**. To go to the next or previously saved station, press the up or down scroll key. To access more options while listening to a station, select **Options**. To close the radio, select **Options** > **Switch off**.

## Equaliser

The equaliser enhances the sound quality when using the music player.

To use a preset setting when playing music, select **Menu** > **Media** > **Equaliser**, an equaliser set, **Activate**.

To view a setting, select the setting, **Options**, and the appropriate option.

## ■ **Organiser**



### **Alarm clock**

The alarm clock is based on the device clock. A set alarm will sound even when the device is switched off.

Select **Menu** > **Organiser** > **Alarm Clock** and from the following:

- **Alarm** – Activate or deactivate an alarm.
- **Alarm time** – Set the alarm time.
- **Repeat** – Set the alarm to repeat.
- **Repeat days** – Set the alarm to be activated on selected days of the week if Repeat is set to On.
- **Alarm tone** – Select a tone for the alarm.
- **Snooze time-out** – Set the snooze time-out period (2-59 minutes).

When the alarm sounds, to postpone the alarm, select **Snooze**; to deactivate the alarm, select **Stop**.

## **Calendar**

Calendar includes option for writing and viewing calendar notes, and allows you to set a reminder alarm.

To open the calendar, select **Menu** > **Organiser** > **Calendar**.

To go to a specific date in the calendar view, select **Options** > **Go to date**, enter the date, and select **OK**.

To access more options while viewing the calendar, select **Options**.

## **Lunar calendar**

To use the lunar calendar, the phone language must be Chinese.

To view lunar details of the highlighted day, in the month view, select **Options** > **Lunar calendar**.

To search for a lunar festival, in the lunar day view, select **Lunar festival**, enter the Gregorian year of the Spring festival, and select the desired lunar festival.



In the lunar day view, select [Options](#) and from the following:

- [Solar item](#) – Search for a solar item.
- [Gregorian to lunar](#) – Convert a Gregorian date to a lunar date.
- [Lunar to gregorian](#) – Convert a lunar date to a Gregorian date.

## Notes

Notes lets you write, edit, view, and send notes.

To add a note, select [Menu](#) > [Organiser](#) > [Notes](#) > [Add](#). Enter the note, and select [Save](#).

## Calculator

The calculator in your device provides basic arithmetic functions, converts currency values, and calculates the square, the square root, and change the sign of the number entered.



**Note:** This calculator has limited accuracy and is designed for simple calculations.

Select [Menu](#) > [Organiser](#) > [Calculator](#).

## Dictionary

In Dictionary, you can look up a Chinese word for English translation, and look up an English word for Chinese translation.

1. Select **Menu** > *Organiser* > *Dictionary*.
2. Switch to the desired input mode if necessary.
3. Enter the Chinese or English word.
4. Scroll to desired word in the displayed list of words, and select it to view the translation.

To view the translation of the previous or next word in the displayed list of words, scroll left or right.

## ■ Extras



Select **Menu** > *Extras*.

To play a game in your device, select *Games*.

To set or view the time in a different location, select *Collection* > *World clock*.

To calculate exchange rates, select *Collection* > *Converter*.

To record all your incomes and expenses, select *Collection* > *Expense Manager*.

## 7. Accessories



**Warning:** Use only batteries, chargers, and accessories approved by Nokia for use with this particular model. The use of any other types may invalidate any approval or warranty, and may be dangerous.

For availability of approved accessories, please check with your dealer.

An extensive range of accessories is available for your device. For more details, see [www.nokia.com.cn](http://www.nokia.com.cn).

All accessories for Nokia devices are supplied in an elegant sales package. An accessory bought without a separate package is not an original Nokia accessory.

How to buy Nokia original accessories:

1. Go to an authorised retailer for Nokia original accessories.

For information on the nearest authorised retailer for Nokia accessories, check with a Nokia original accessory distributor.

\* When you are buying an accessory, always ask the dealer to issue a separate invoice listing the price and model number, which is helpful in safeguarding your own rights.

2. Visit a Nokia online shop at [www.shop.nokia.com.cn](http://www.shop.nokia.com.cn).

### Practical rules about accessories

- Keep all accessories out of the reach of small children.
- When you disconnect the power cord of any accessory, grasp and pull the plug, not the cord.
- Check regularly that accessories installed in a vehicle are mounted and are operating properly.
- Installation of any complex car accessories must be made by qualified personnel only.

### Why use original accessories?

As key components of your handset, batteries and chargers play a critical role in making sure the handset is operating properly and safely. As shown by our long-term customer surveys and after-sales services, handsets fail in many cases by using unapproved accessories, especially unapproved batteries and chargers.

## Dangers of using unapproved batteries and chargers

- Short lifetime, with charging and discharging times noticeably less than those of original batteries.
- Consequent much shorter lifetime of the handset, unstable power supply that prevents the handset circuit from functioning properly, which causes lasting damages.
- Poor performance and reliability of the handset, undermined voice quality and frequent breakdown.
- Potential burning or explosion that endangers consumer's safety.

## Benefits of using Nokia original accessories

- Adequate safety.
- High quality after-sales maintenance and services that are available to original accessories only.
- Nokia warranty does not apply to handset failures attributable to the use of non-original Nokia accessories.

*False:* Handset battery is a simple product that combines a group of linked cells within a single package.

*True:* A number of high-tech designs and high quality raw materials are necessary for a handset battery to provide stable and lasting performance. A battery manufactured in a slipshod way differs from an original product on process, design, and raw material considerably, hence dramatic difference in performance and safety.

*False:* All accessories with the Nokia trademark are original ones.

*True:* Nokia original accessories are supplied in an elegant sales package (complying with national package regulations), and each battery carries a hologram label. It is recommended that consumers are aware of counterfeit Nokia accessories on the market. In particular, some dealers might remove the original battery from the supplied handset, which violates our distribution policies and infringes on consumer's rights.

*False:* Despite low quality, counterfeit battery is much cheaper and is worthwhile even if it requires frequent replacement.

*True:* Unapproved batteries and chargers are not only of short lifetime and poor performance, but will noticeably undermine the handset's performance and reduce its

lifetime. It is also deprived of comprehensive after-sales maintenance and repair. Most important, unapproved batteries and chargers pose safety threats to consumers. Losses in these regards far exceed the savings on price. In fact, with inferior raw materials and irregular designs, some counterfeit batteries cost less than 1/10 of original products.

Draft

## 8. Battery and charger information

Your device is powered by a rechargeable battery. The battery intended for use with this device is BL-4C Li-Ion battery. This device is intended for use when supplied with power from the following charger: AC-8. The exact charger model number may vary depending on the type of plug. The plug variant is identified by one of the following: E, EB, X, AR, U, A,C or UB.

The battery can be charged and discharged hundreds of times, but it will eventually wear out. When the talk and standby times are noticeably shorter than normal, replace the battery. Use only Nokia approved batteries, and recharge your battery only with Nokia approved chargers designated for this device. Use of an unapproved battery or charger may present a risk of fire, explosion, leakage, or other hazard.

If a battery is being used for the first time or if the battery has not been used for a prolonged period, it may be necessary to connect the charger, then disconnect and reconnect it to begin charging the battery. If the battery is completely discharged, it may take several minutes before



the charging indicator appears on the display or before any calls can be made.

Always switch the device off and disconnect the charger before removing the battery.

Unplug the charger from the electrical plug and the device when not in use. Do not leave a fully charged battery connected to a charger, since overcharging may shorten its lifetime. If left unused, a fully charged battery will lose its charge over time.

Always try to keep the battery between 15°C and 25°C (59°F and 77°F). Extreme temperatures reduce the capacity and lifetime of the battery. A device with a hot or cold battery may not work temporarily. Battery performance is particularly limited in temperatures well below freezing.

Do not short-circuit the battery. Accidental short-circuiting can occur when a metallic object such as a coin, clip, or pen causes direct connection of the positive (+) and negative (-) terminals of the battery. (These look like metal strips on the battery.) This might happen, for example, when you carry a spare battery in your pocket or

purse. Short-circuiting the terminals may damage the battery or the connecting object.

Do not dispose of batteries in a fire as they may explode. Batteries may also explode if damaged. Dispose of batteries according to local regulations. Please recycle when possible. Do not dispose as household waste.

Do not dismantle, cut, open, crush, bend, deform, puncture, or shred cells or batteries. In the event of a battery leak, do not allow the liquid to come in contact with the skin or eyes. In the event of such a leak, flush your skin or eyes immediately with water, or seek medical help.

Do not modify, remanufacture, attempt to insert foreign objects into the battery, or immerse or expose it to water or other liquids.

Improper battery use may result in a fire, explosion, or other hazard. If the device or battery is dropped, especially on a hard surface, and you believe the battery has been damaged, take it to a service centre for inspection before continuing to use it.

Use the battery only for its intended purpose. Never use any charger or battery that is damaged. Keep your battery out of the reach of small children.

## ■ Battery information

This section provides information about battery charging times with the travel charger (AC-8), and talk and standby times. The information in this section is subject to change. For more information, contact your service provider.



**Important:** Battery talk and standby times are estimates only and depend on signal strength, network conditions, features used, battery age and condition, temperatures to which battery is exposed, use in digital mode, and many other factors. The amount of time a device is used for calls will affect its standby time. Likewise, the amount of time that the device is turned on and in the standby mode will affect its talk time.

### Charging times

The charging time depends on the charger used. Charging a BL-4C battery with the AC-8 charger takes

approximately 3.5 hours while the device is in the standby mode.

### Talk and standby times

Battery Type	Talk time	Standby time
BL-4C	Up to 5 hours	Up to 13 days

### ■ Nokia battery authentication guidelines

Always use original Nokia batteries for your safety. To check that you are getting an original Nokia battery, purchase it from a Nokia authorised service centre or dealer, and inspect the hologram label using the following steps:

## Authenticate hologram

1. When you look at the hologram on the label, you should see the Nokia connecting hands symbol from one angle and the Nokia Original Accessories logo when looking from another angle.
2. When you angle the hologram left, right, down, and up, you should see 1, 2, 3 and 4 dots on each side respectively.



Successful completion of the steps is not a total assurance of the authenticity of the battery. If you have any reason to believe that your battery is not an authentic, original Nokia battery, you should refrain from using it, and take it to the nearest authorised Nokia service centre or dealer for assistance. If authenticity cannot be verified, return the battery to the place of purchase.

## What if your battery is not authentic?

If you cannot confirm that your Nokia battery with the hologram on the label is an authentic Nokia battery, please do not use the battery. Take it to the nearest authorised Nokia service centre or dealer for assistance. The use of a battery that is not approved by Nokia may be dangerous and may result in poor performance and damage to your device and its accessories. It may also invalidate any approval or warranty applying to the device.

To find out more about original Nokia batteries, visit [www.nokia.com/batterycheck](http://www.nokia.com/batterycheck).

# Care and maintenance

Your device is a product of superior design and craftsmanship and should be treated with care. The following suggestions will help you protect your warranty coverage.

- Keep the device dry. Precipitation, humidity, and all types of liquids or moisture can contain minerals that will corrode electronic circuits. If your device does get wet, remove the battery, and allow the device to dry completely before replacing it.
- Do not use or store the device in dusty, dirty areas. Its moving parts and electronic components can be damaged.
- Do not store the device in hot areas. High temperatures can shorten the life of electronic devices, damage batteries, and warp or melt certain plastics.
- Do not store the device in cold areas. When the device returns to its normal temperature, moisture can form inside the device and damage electronic circuit boards.
- Do not attempt to open the device other than as instructed in this guide.
- Do not drop, knock, or shake the device. Rough handling can break internal circuit boards and fine mechanics.

- Do not use harsh chemicals, cleaning solvents, or strong detergents to clean the device.
- Do not paint the device. Paint can clog the moving parts and prevent proper operation.
- Use a soft, clean, dry cloth to clean any lenses, such as camera, proximity sensor, and light sensor lenses.
- Use only the supplied or an approved replacement antenna. Unauthorised antennas, modifications, or attachments could damage the device and may violate regulations governing radio devices.
- Use chargers indoors.
- Always create a backup of data you want to keep, such as contacts and calendar notes.
- To reset the device from time to time for optimum performance, power off the device and remove the battery.

These suggestions apply equally to your device, battery, charger, or any accessory. If any device is not working properly, take it to the nearest authorised service facility for service.





## Disposal

The crossed-out wheeled-bin symbol on your product, literature, or packaging reminds you that all electrical and electronic products, batteries, and accumulators must be taken to separate collection at the end of their working life. This requirement applies to the European Union and other locations where separate collection systems are available. Do not dispose of these products as unsorted municipal waste.

By returning the products to collection you help prevent uncontrolled waste disposal and promote the reuse of material resources. More detailed information is available from the product retailer, local waste authorities, national producer responsibility organizations, or your local Nokia representative. For the product Eco-Declaration or instructions for returning your obsolete product, go to country-specific information at [www.nokia.com](http://www.nokia.com).

## Chinese RoHS table



部件名称 (Parts)	有毒有害物质或元素 (Hazardous Substance)					
	铅 (Pb)	汞 (Hg)	镉 (Cd)	六价铬 (Cr6+)	多溴联苯 (PBB)	多溴二苯醚 (PBDE)
主机 (Phone)	×	○	○	○	○	○
电池 (Battery)	×	○	○	○	○	○
附件 (Accessories)	×	○	○	○	○	○
<p>○：表示该有毒有害物质在该部件所有均质材料中的含量均在 SJ/T 11363-2006 标准规定的限量要求以下。</p> <p>×：表示该有毒有害物质至少在该部件的某一均质材料中的含量超出 SJ/T 11363-2006 标准规定的限量要求。</p> <p>注：本产品标有“×”的原因是：现阶段没有可供选择的替代技术或部件。</p>						

# Additional safety information

## ■ Small children

Your device and its accessories may contain small parts. Keep them out of the reach of small children.

## ■ Operating environment

This device meets RF exposure guidelines when used either in the normal use position against the ear or when positioned at least 1.5 centimetres (5/8 inch) away from the body. When a carry case, belt clip, or holder is used for body-worn operation, it should not contain metal and should position the device the above-stated distance from your body.

To transmit data files or messages, this device requires a quality connection to the network. In some cases, transmission of data files or messages may be delayed until such a connection is available. Ensure the above separation distance instructions are followed until the transmission is completed.

Parts of the device are magnetic. Metallic materials may be attracted to the device. Do not place credit cards or other magnetic storage media near the device, because information stored on them may be erased.

## ■ Medical devices

Operation of any radio transmitting equipment, including wireless phones, may interfere with the functionality of inadequately protected medical devices. Consult a physician or the manufacturer of the medical device to determine if they are adequately shielded from external RF energy or if you have any questions. Switch off your device in health care facilities when any regulations posted in these areas instruct you to do so. Hospitals or health care facilities may be using equipment that could be sensitive to external RF energy.

### Implanted medical devices

Manufacturers of medical devices recommend that a minimum separation of 15.3 centimetres (6 inches) should be maintained between a wireless device and an implanted medical device, such as a (cardiac) pacemaker, implanted cardioverter defibrillator, implanted cochlea (bionic ear), etc., to avoid potential interference with the medical device. Persons who have such devices should:

- Always keep the wireless device more than 15.3 centimetres (6 inches) from the medical device when the wireless device is turned on.
- Not carry the wireless device in a breast pocket.

- Hold the wireless device to the ear opposite the medical device to minimise the potential for interference.
- Turn the wireless device off immediately if there is any reason to suspect that interference is taking place.
- Read and follow the directions from the manufacturer of their implanted medical device.

If you have any questions about using your wireless device with an implanted medical device, consult your health care provider.

### Hearing aids

Some digital wireless devices may interfere with some hearing aids. If interference occurs, consult your service provider.



**Warning:** For hearing aid compatibility, you must turn off the Bluetooth.

### ■ Vehicles

RF signals may affect improperly installed or inadequately shielded electronic systems in motor vehicles such as electronic fuel injection systems, electronic antiskid (antilock) braking systems, electronic speed control systems, and air bag systems. For more information, check with the manufacturer, or its representative, of your vehicle or any equipment that has been added.

Only qualified personnel should service the device or install the device in a vehicle. Faulty installation or service may be dangerous and may invalidate any warranty that may apply to the device. Check regularly that all wireless device equipment in your vehicle is mounted and operating properly. Do not store or carry flammable liquids, gases, or explosive materials in the same compartment as the device, its parts, or accessories. For vehicles equipped with an air bag, remember that air bags inflate with great force. Do not place objects, including installed or portable wireless equipment in the area over the air bag or in the air bag deployment area. If in-vehicle wireless equipment is improperly installed and the air bag inflates, serious injury could result.

Using your device while flying in aircraft is prohibited. Switch off your device before boarding an aircraft. The use of wireless teledevices in an aircraft may be dangerous to the operation of the aircraft, disrupt the wireless telephone network, and may be illegal.

### ■ Potentially explosive environments

Switch off your device when in any area with a potentially explosive atmosphere, and obey all signs and instructions. Potentially explosive atmospheres include areas where you would normally be advised to turn off your vehicle engine. Sparks in such areas could cause an explosion or fire resulting in bodily injury or even death. Switch off the device at refuelling points

such as near gas pumps at service stations. Observe restrictions on the use of radio equipment in fuel depots, storage, and distribution areas; chemical plants; or where blasting operations are in progress. Areas with a potentially explosive atmosphere are often, but not always, clearly marked. They include below deck on boats, chemical transfer or storage facilities and areas where the air contains chemicals or particles such as grain, dust, or metal powders. You should check with the manufacturers of vehicles using liquefied petroleum gas (such as propane or butane) to determine if this device can be safely used in their vicinity.

## ■ Emergency calls



**Important:** This device operates using radio signals, wireless networks, landline networks, and user-programmed functions. If your device supports voice calls over the internet (internet calls), activate both the internet calls and the cellular phone. The device will attempt to make emergency calls over both the cellular networks and through your internet call provider if both are activated. Connections in all conditions cannot be guaranteed. You should never rely solely on any wireless device for essential communications like medical emergencies.

## To make an emergency call:

1. If the device is not on, switch it on. Check for adequate signal strength. Depending on your device, you may also need to complete the following:
  - Insert a UIM card if your device uses one.
  - Remove certain call restrictions you have activated in your device.
  - Change your profile from offline or flight profile mode to an active profile.
2. Press the end key as many times as needed to clear the display and ready the device for calls.
3. Enter the official emergency number for your present location. Emergency numbers vary by location.
4. Press the call key.

When making an emergency call, give all the necessary information as accurately as possible. Your wireless device may be the only means of communication at the scene of an accident. Do not end the call until given permission to do so.

## ■ Certification information (SAR)

This mobile device meets guidelines for exposure to radio waves.



Your mobile device is a radio transmitter and receiver. It is designed not to exceed the limits for exposure to radio waves recommended by international guidelines. These guidelines were developed by the independent scientific organization ICNIRP and include safety margins designed to assure the protection of all persons, regardless of age and health.

The exposure guidelines for mobile devices employ a unit of measurement known as the Specific Absorption Rate or SAR. The SAR limit stated in the ICNIRP guidelines is 2.0 watts/kilogram (W/kg) averaged over 10 grams of tissue. Tests for SAR are conducted using standard operating positions with the device transmitting at its highest certified power level in all tested frequency bands. The actual SAR level of an operating device can be below the maximum value because the device is designed to use only the power required to reach the network. That amount changes depending on a number of factors such as how close you are to a network base station. The highest SAR value under the ICNIRP guidelines for use of the device at the ear is 0.69 W/kg, which is in compliance with the requirement from the National Standard GB 21288-2007.

Use of device accessories may result in different SAR values. SAR values may vary depending on national reporting and testing requirements and the network band. Additional SAR information may be provided under product information at [www.nokia.com](http://www.nokia.com).

Your mobile device is also designed to meet the requirements for exposure to radio waves established by the Federal Communications Commission (USA) and Industry Canada. These requirements set a SAR limit of 1.6 W/kg averaged over one gram of tissue. The highest SAR value reported under this standard during product certification for use at the ear is 0.98 W/kg and when properly worn on the body is 1.24 W/kg.

Draft

# Index

---

## A

- access code 17
- accessories 75
- alarm clock 71
- antenna 16

## B

- battery
  - charging 15
  - installation 11
- battery and charger information 80
- Best Tone 50
- blog site 52
- Bluetooth connectivity 56

## C

- calculator 73
- calendar 72
- calls
  - conference 24
  - log for 49
  - making 24
  - settings 58
- camera

- capture image 65
- connectivity 55
- contacts 46
- converter 74
- customer service 51

## D

- date and time 54
- device information 62
- device settings 59
- dictionary 74
- display settings 53

## E

- enhancements 61
- equaliser 70
- esurfing 50
- expense manager 74
- extras 74

## H

- hearing aids 93

## K

- keyguard 23

## L

language setting 60  
loudspeaker 25  
lunar calendar 72

## M

media 65  
media player 68  
messages  
    deleting 43  
    E-mail 45  
    minibrowser 44  
    multimedia 38  
    read and reply 39  
    settings 40  
    voice 44  
    write and send 37  
missed calls 49

## N

network settings 62

## O

organiser 71

## P

profiles 51

100

## Q

QQ 45

## R

radio 70  
restoring factory settings 63

## S

scene modes 67  
security settings 61  
settings menu 51  
shortcuts 22  
speed dialling 48  
standby mode 21  
switching device on/off 16

## T

text entry  
    pinyin input method 28  
    predictive English input 33  
    stroke input method 28  
    traditional English input  
    method 32  
themes 52  
tones 52

## V

video clips

recording 66  
voice commands 35, 61  
voice dialling 25  
voice recorder 69

## W

web 50  
world clock 74

Draft