

Nokia C2-02 User Guide

555555
Issue 1



Contents		Indicators	22
		Copy contacts or pictures from your old device	23
Safety	5	Change the volume of a call, song, or video	25
Get started	7		
Keys and parts	7	Calls	25
Insert a SIM card and battery	8	Make a call	25
Insert a memory card	12	Call the last dialled number	26
Charge the battery	13	View your missed calls	26
Attach a strap	15		
Switch the device on or off	15	Contacts	27
GSM antenna	16	Save a name and phone number	27
Basic use	17	Write text	28
Access codes	17	Switch between text input modes	28
Lock the keys and screen	19	Write using traditional text input	29
Touch screen actions	19	Use predictive text input	30
Swipe to open an application or activate a feature	22		



Messaging	31	Music and audio	41
Send a message	31	FM radio	41
View a conversation	32	Media player	44
Listen to voice messages	33	Pictures and videos	45
Personalise your device	33	Take a picture	45
About the home screen	33	Record a video	46
Personalise the home screen	34	Send a picture or video	46
Personalise your device tones	35	Web	47
Time management	37	About Ovi Browser	47
Change the time and date	37	Browse the web	48
Set an alarm	37	Clear your browsing history	50
Add an appointment	38	Keep in touch with your online friends	50
Connectivity	38	About Communities	50
Bluetooth	38	Mail and chat	51
USB data cable	40	About Mail	51
		Send a mail	52



4 www.nokia.com/support

Read and reply to mail	52	Keep your device up to date	60
About Chat	53	Protect the environment	66
Chat with your friends	53	Save energy	66
Ovi Maps	54	Recycle	66
About Maps	54	Product and safety information	67
View your current location on the map	56	Index	79
Find a place	56		
Share your location or a place	57		
Nokia's Ovi services	58		
Availability and costs of Nokia's Ovi services	58		
Access Nokia's Ovi services	58		
Find help	58		
Support	58		
My Nokia	59		

Safety

Read these simple guidelines. Not following them may be dangerous or illegal. Read the complete user guide for further information.

SWITCH OFF IN RESTRICTED AREAS



Switch the device off when mobile phone use is not allowed or when it may cause interference or danger, for example, in aircraft, near medical equipment, fuel, chemicals, or blasting areas.

ROAD SAFETY COMES FIRST



Obey all local laws. Always keep your hands free to operate the vehicle while driving. Your first consideration while driving should be road safety.

INTERFERENCE



All wireless devices may be susceptible to interference, which could affect performance.



6 Safety

QUALIFIED SERVICE



Only qualified personnel may install or repair this product.

KEEP YOUR DEVICE DRY



Your device is not water-resistant. Keep it dry.

PROTECT YOUR HEARING



Listen to a headset at a moderate level, and do not hold the device near your ear when the loudspeaker is in use.



Get started

Keys and parts

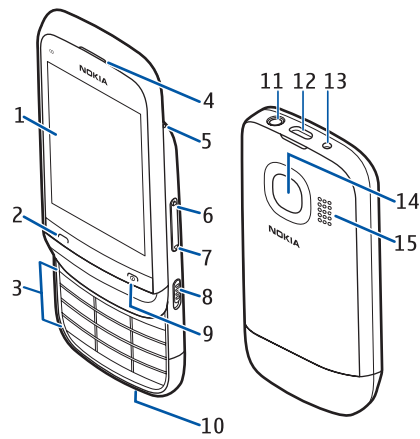

- 1 Display
- 2 Call key



8 Get started

- 3 Keypad
- 4 Earpiece
- 5 Wrist strap hole
- 6 Volume up/Zoom key
- 7 Volume down/Zoom key
- 8 Key lock switch
- 9 End/Power key
- 10 Microphone
- 11 Nokia AV Connector (3.5 mm)
- 12 Micro USB connector
- 13 Charger connector
- 14 Camera lens
- 15 Loudspeaker

Insert a SIM card and battery



Note: Switch the device off and disconnect the charger and any other device before removing any covers. Avoid touching electronic components while changing any covers. Always store and use the device with any covers attached.

 **Important:** Do not use a mini-UICC SIM card, also known as a micro-SIM card, a micro-SIM card with an adapter, or a SIM card that has a mini-UICC cutout (see figure) in this device. A micro SIM card is smaller than the standard SIM card. This device does not support the use of micro-SIM cards and use of incompatible SIM cards may damage the card or the device, and may corrupt data stored on the card.



 **Important:** To prevent damage to the SIM card, always remove the battery before you insert or remove the card.

This device is intended for use with a BL-5C battery. Always use original Nokia batteries.

The SIM card and its contacts can be easily damaged by scratches or bending, so be careful when handling, inserting, or removing the card.



10 Get started

- 1 Place your finger in the recess at the top of the device, and carefully lift and remove the back cover (1). If the battery is inserted, lift it out (2).

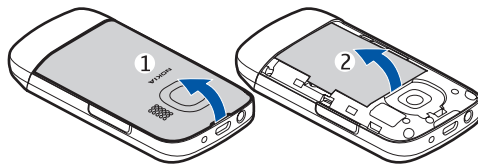

- 2 Open the SIM card holder (3), and insert or remove the SIM card (4 or 5). Make sure the contact area of the card is facing down.

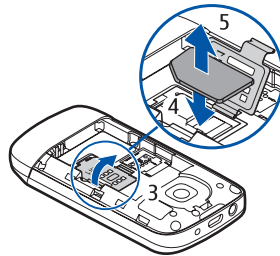

- 3 Line up the contacts of the battery and the battery compartment, and insert the battery (6). To replace the back cover, direct the bottom locking catches toward their slots (7), and press down until the cover locks into place (8).

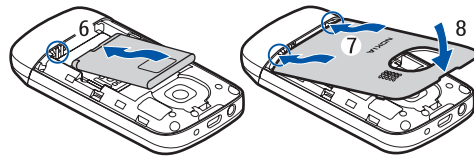

12 Get started

Insert a memory card

Use only compatible memory cards approved by Nokia for use with this device. Incompatible cards may damage the card and the device and corrupt data stored on the card.

Your device supports memory cards with a capacity of up to 32 GB.

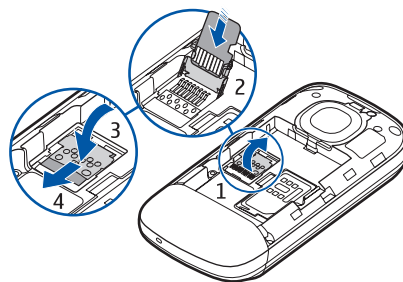

- 1 Switch the device off, and remove the back cover and battery.

- 2 To release the memory card holder, slide the holder in the direction indicated by the arrow on the holder. Open the memory card holder (1).
- 3 Insert a compatible memory card. Make sure the contact area of the card is facing down (2).
- 4 Close the memory card holder (3).
- 5 To lock the memory card holder, slide the holder to its original position (4).

Remove the memory card

- 1 Switch the device off.
- 2 Remove the back cover and battery.
- 3 To release the memory card holder, slide the holder in the direction indicated by the arrow on the holder. Open the memory card holder, and remove the memory card.

Charge the battery

Your battery has been partially charged at the factory, but you may need to recharge it before you can switch on your device for the first time. If the device indicates a low charge, do the following:



14 Get started

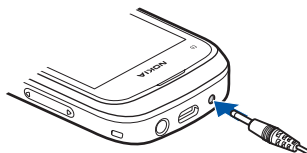

- 1 Connect the charger to a wall outlet.
- 2 Connect the charger to the device.
- 3 When the device indicates a full charge, disconnect the charger from the device, then from the wall outlet.

You do not need to charge the battery for a specific length of time, and you can use the device while it is charging.

If the battery is completely discharged, it may take several minutes before the charging indicator appears on the display or before any calls can be made.

If the battery has not been used for a long time, to begin charging, you may need to connect the charger, then disconnect and reconnect it.

Attach a strap

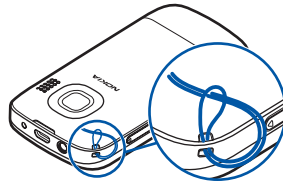

Switch the device on or off

Press and hold the power key .

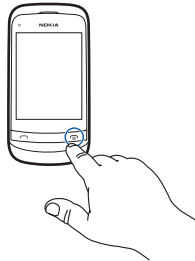

16 Get started

You may be prompted to get the configuration settings from your service provider (network service). For more information, contact your service provider.

GSM antenna

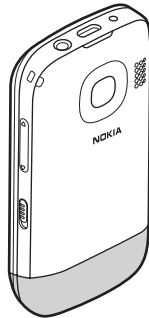

The figure shows the GSM antenna area marked in grey.
Avoid touching the antenna area unnecessarily while the antenna is transmitting or receiving. Contact with antennas affects the communication quality and may

cause a higher power level during operation and may reduce the battery life.

Basic use

Access codes

Select Menu > Settings > Security > Access codes.

<p>PIN or PIN2 code (4-8 digits)</p>	<p>These protect your SIM card against unauthorised use or are required to access some features.</p> <p>If not supplied with the card or you forget the codes, contact your service provider.</p> <p>You can set your device to ask for the PIN code when you switch it on.</p> <p>If you enter the code incorrectly three times in a row, you need to unblock the code with the PUK or PUK2 code.</p> <p>The module PIN is required to access the information in the security module of your SIM card. The signing PIN may be required for the digital signature.</p>
--	--



18 Basic use

PUK or PUK2 code (8 digits)	<p>These are required to unblock a PIN or PIN2 code.</p> <p>If not supplied with your SIM card, contact your service provider.</p>
Security code (5–10 digits)	<p>This protects your device against unauthorised use.</p> <p>You can set your device to ask for the security code that you define. The default security code is 12345.</p> <p>Keep the code secret and in a safe place, separate from your device.</p> <p>If you forget the code and your device is locked, your device will require service. Additional charges may apply, and all the personal data in your device may be deleted.</p> <p>For more information, contact a Nokia Care Point or your device dealer.</p>
Barring password	<p>This is required for call barring services.</p>

(4 digits)	For more information, contact your service provider.
------------	--

Lock the keys and screen

To avoid accidentally making a call when your device is in your pocket or bag, lock the keys and screen of your device.

Slide the key lock switch.

Unlock the keys and screen

Slide the key lock switch.

Tip: If the key lock switch is out of reach, to unlock the device, press the end key, and select **Unlock**.

Touch screen actions

To interact with the touch screen user interface, tap or tap and hold the touch screen.

Open an application or other screen element

Tap the application or element.



20 Basic use

Access item-specific options

Tap and hold the item. A pop-up menu with available options opens.



Scroll in a list or menu

Place your finger on the screen, slide it quickly up or down the screen, and then lift your finger. The content of the screen scrolls with the speed and direction it had at the moment of release. To select an item from a scrolling list and to stop the movement, tap the item.

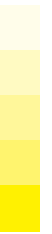

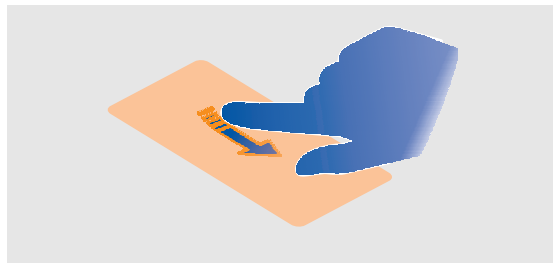

Swipe

Place a finger on the screen, and steadily slide your finger in the desired direction.

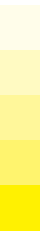
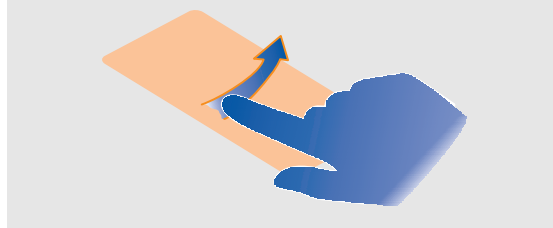

22 Basic use

For example, when you are viewing a picture, to view the next picture, swipe left. To quickly browse through your pictures, swipe the screen quickly, and then scroll left or right through the thumbnails.





Swipe to open an application or activate a feature

You can open applications or activate features when you swipe left or right on the home screen.





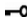

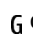

Assign a function or feature to a swipe action

Select **Menu > Settings > My shortcuts > Swipe gesture**, and select the swipe direction and desired function or feature.

Indicators

-  You have unread messages.
-  You have unsent, cancelled, or failed messages.
-  The keypad is locked.
-  The device does not ring for incoming calls or text messages.
-  An alarm is set.

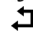

-  **G or E** The device is registered to the GPRS or EGPRS network.
-  **G or E** A GPRS or EGPRS connection is open.
-  **G or E** The GPRS or EGPRS connection is suspended (on hold).
-  **B** Bluetooth is activated.
-  **D** All incoming calls are diverted to another number.
-  **T** Calls are limited to a closed user group. The currently active profile is timed.
-  **H** A headset is connected to the device.
-  **U** The device is connected to another device, using a USB data cable.

Copy contacts or pictures from your old device

Want to copy your content from your previous compatible Nokia device and start using your new device quickly? You can copy, for example, contacts, calendar entries, and pictures to your new device, free of charge.



24 Basic use

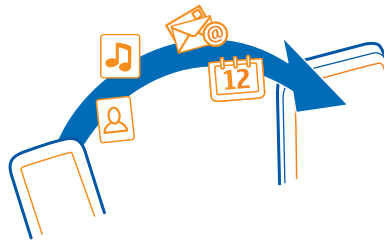

- 1 Activate Bluetooth in both devices.
Select **Menu** > **Settings** > **Connectivity** > **Bluetooth**.
- 2 Connect the devices.
- 3 Select **Menu** > **Settings** > **Sync & backup**.
- 4 Select **Phone switch** > **Copy to this**.
- 5 Select the content to copy and **Done**.
- 6 Select your previous device from the list.
- 7 If the other device requires a passcode, enter the passcode. The passcode, which you can define yourself, must be entered in both devices. The

passcode in some devices is fixed. For details, see the user guide of the device.

The passcode is valid only for the current connection.

- 8 If prompted, allow connection and copying requests.

Change the volume of a call, song, or video

Use the volume keys.

The built-in loudspeaker allows you to speak and listen from a short distance without having to hold the device to your ear.

Activate the loudspeaker during a call

Select Loudsp..

Calls

Make a call

- 1 Open the slide.
- 2 On the home screen, enter the phone number.
To delete a number, select **Clear**.
For international calls, select * twice for the + character (which replaces the international access code), and



26 Calls

enter the country code, area code (omit the leading zero if necessary), and phone number. The + character as a replacement for the international access code may not work in all regions. In this case, enter the international access code directly.

- 3 Press the call key.
- 4 To end the call, press the end key.

Tip: If the slide is closed and  is displayed on the home screen, to use the virtual keypad to enter the phone number, select .

Call the last dialled number

Trying to call someone, but they are not answering? It is easy to call them again.

- 1 On the home screen, press the call key.
- 2 Go to the number, and press the call key.

View your missed calls

Want to see who made the call you missed?

On the home screen, select **View**. The caller's name is displayed, if stored in the contacts list.



Missed and received calls are logged only if supported by the network, and the device is switched on and within the network service area.

Call back the contact or number

Go to the contact or number, and press the call key.

View the missed calls later

Select Menu > Contacts > Log and Missed calls.

Contacts

Save a name and phone number

Select Menu > Contacts.

Select **Add new**.

If prompted, select where to save the contact.

Add or edit the details of a contact

- 1 Select **Names** and a contact.
- 2 Select **Options** > **Add detail**.



Tip: To add a ringtone or picture for a contact, select the contact and **Options** > **Add detail** > **Multimedia**.



28 Write text

Write text

Switch between text input modes

When writing text, you can use traditional  or predictive  text input.

Abc, abc, and ABC indicate the character cases. 123 indicates that number mode is activated.

Switch between text input methods

Select **Options** > **Prediction**. Not all languages are supported by predictive text input.

Switch between character cases

Select #.

Switch between the letter and number modes

Select and hold #.

Set the writing language

Select **Options** > **Writing language**.



Write using traditional text input

- 1 Press a number key (2-9) repeatedly, until the desired character is displayed.
- 2 Insert the next character. If it is located on the same key, wait until the cursor is displayed, or move the cursor forward.

The available characters depend on the selected writing language.

Move the cursor

Select ◀ or ▶, or tap where you want to place the cursor.

Insert a common punctuation mark

Press 1 repeatedly.

Insert a special character

Select ?!£ and the desired character.

Insert a space

Press 0.



30 Write text

Use predictive text input

Write using predictive text input

The built-in dictionary suggests words as you select the number keys.

- 1 Select each number key (2-9) once for each character.
- 2 To find the desired word, select * repeatedly.
- 3 To confirm the word, select ►.

Add a missing word to the dictionary

If ? is displayed when you enter a word using predictive text input, the word is not in the dictionary. You can add it to the built-in dictionary.

- 1 Select **Spell**.
- 2 Write the word using traditional text input.
- 3 Select **Save**.

Write a compound word

- 1 Write the first part of the word. To confirm the word, move the cursor forward.
- 2 Write the next part of the word, and confirm again.



Messaging

Send a message

Keep in touch with your family and friends with text and multimedia messages. You can attach your pictures, videos, and business cards to your message.

Select **Menu** > **Messaging**.

- 1 Select **Create message**.
- 2 To add an attachment, select **Options** > **Insert object**.
- 3 Write your message, and select **Continue**.
- 4 To enter a phone number or mail address manually, select **Number or mail**. Enter a phone number, or select **Mail**, and enter a mail address.
- 5 Select **Send**.

Tip: To insert a special character or smiley, select **Options** > **Insert symbol**.

Sending a message with an attachment may be more expensive than sending a normal text message. For more information, contact your service provider.

32 Messaging

You can send text messages that are longer than the character limit for a single message. Longer messages are sent as two or more messages. Your service provider may charge accordingly.

Characters with accents, other marks, or some language options, take more space, and limit the number of characters that can be sent in a single message.

If the item you inserted in a multimedia message is too large for the network, the device may automatically reduce the size.

Only compatible devices can receive and display multimedia messages. Messages may look different in different devices.

View a conversation

You can see the messages you have sent to and received from a particular contact from a single view, and continue the conversation from that view.

Select **Menu > Messaging**.



Read a message in a conversation

Select **Conversations**, a conversation, and a message.

Switch to the traditional Inbox view

Select **Options** > **Inbox view**.

Listen to voice messages

When you can't answer, you can divert calls to your voice mailbox and listen to your messages later.

You may need a voice mailbox subscription. For more information on this network service, contact your service provider.

- 1 Select **Menu** > **Messaging** > **Voice messages** and **Voice mailbox no.**.
- 2 Enter your voice mailbox number, and select **OK**.
- 3 To call your voice mailbox, on the home screen, press and hold **1**.

Personalise your device

About the home screen

In the home screen, you can:



34 Personalise your device

- See notifications of missed calls and received messages
- Open your favourite applications
- Control applications, such as the radio
- Add shortcuts for different features, such as writing a message
- View your favourite contacts, and quickly call, chat, or send messages to them

Personalise the home screen

Want to see your favourite landscape or pictures of your family in the background of the home screen? You can change this wallpaper, and rearrange items on the home screen, to personalise it to your liking.

Select **Menu** > **Settings and Display**.

Change the wallpaper

Select **Wallpaper** and a picture.

Tip: Download more wallpapers from Nokia's Ovi Store. To learn more about Ovi Store, go to www.ovi.com.



Add content to the home screen

Select **Home screen** > **Personalise view**.

Tip: To increase the font size in the Messaging and Contacts applications, when browsing the web, or in the main menu, select **Font size**.

Personalise your device tones

You can personalise the ringtones and key and warning tones for each profile.

Select **Menu** > **Settings and Tones**.

Change the ringtone

Select **Ringtone:** and a ringtone.



Tip: Download more ringtones from Nokia's Ovi Store. To learn more about Ovi Store, go to www.ovi.com.

After selecting a ringtone, you can mark a section of the ringtone, and set the section as your ringtone. The original ringtone or sound clip is not copied or modified. Preset ringtones cannot be modified, and not all formats of ringtones are supported.





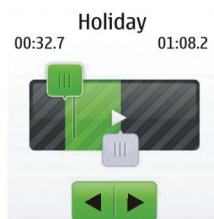

36 Personalise your device

Mark the section to use

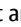
- 1 Select a ringtone. When prompted, select **Yes**.
- 2 Drag the start marker  to the start point.
- 3 Drag the end marker  to the end point.
When a marker is moved to a new point, the selection plays.
- 4 To manually play the selection, select **Play**.
- 5 Select **Done**.



Tip: To fine-tune the start and end points of the selection, select  or , and select and hold  or .

Change the volume of the keypad tones

Select **Keypad tones**, and drag the volume bar.

Time management

Change the time and date

Select **Menu** > **Settings** and **Date and time**.

Change the time zone when travelling

- 1 Select **Date & time settings** > **Time zone**.
- 2 Select the time zone of your location.
- 3 Select **Save**.

The time and date are set according to the time zone. This makes sure that your device displays the correct sending time of received text or multimedia messages.

For example, GMT -5 denotes the time zone for New York (USA), 5 hours west of Greenwich, London (UK).

Set an alarm

You can use your device as an alarm clock.

Select **Menu** > **Applications** > **Alarm clock**.



38 Connectivity

- 1 Set the alarm time.
- 2 Select (🔔) to set the alarm.
- 3 To set the alarm to sound, for example, at the same time every day, select **Settings > Alarm repeat > On** and the days.

Add an appointment

Save your important appointments to your calendar as meeting entries.

Select **Menu > Calendar**.

- 1 Go to the desired date, and select **Options > Add new entry**.
- 2 Select the entry type field **Meeting**, and fill in the fields.

Connectivity

Bluetooth

About Bluetooth connectivity

Select **Menu > Settings > Connectivity > Bluetooth**.

Use Bluetooth to connect wirelessly to compatible devices, such as other mobile devices, computers, headsets, and car kits.



You can also send items from your device, copy files from your compatible PC, and print using a compatible printer.

Bluetooth uses radio waves to connect, and devices must be within 10 metres (33 feet) of each other. Obstructions, such as walls or other electronic devices, can cause interference.

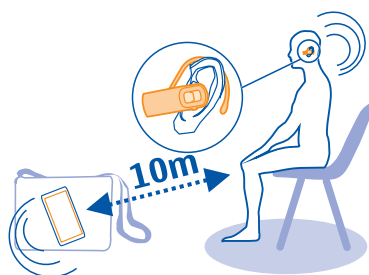

Send a picture or other content to another device using Bluetooth

Use Bluetooth to send pictures, videos, business cards, and other content created by you to your computer or a friend's compatible device.



40 Connectivity

- 1 Select and hold the item to send, and from the pop-up menu, select **Send > Via Bluetooth**.
- 2 Select the device to connect to. If the desired device is not displayed, select **New search**, to search for it. Bluetooth devices within range are displayed.
- 3 If the other device requires a passcode, enter the passcode. The passcode, which you can define yourself, must be entered in both devices. The passcode in some devices is fixed. For details, see the user guide of the device.
The passcode is valid only for the current connection.

The available options may vary.

USB data cable

Copy content between your device and a computer

You can use a USB data cable to copy your pictures and other content between your device and a compatible computer.

- 1 Use a compatible USB cable to connect your device to a computer.
- 2 Select from the following modes:

Nokia Ovi Suite — Nokia Ovi Suite is installed on your computer.

Media transfer — Nokia Ovi Suite is not installed on your computer. If you want to connect your device to a home entertainment system or printer, use this mode.

Mass storage — Nokia Ovi Suite is not installed on your computer. The device is displayed as a portable device on your computer. If you want to connect your device to other devices, such as a home or car stereo, use this mode.

- 3 To copy the content, use the file manager of the computer.

To copy your contacts, music files, videos, or pictures, use Nokia Ovi Suite.

Music and audio

FM radio

About the FM radio

Select Menu > Music > Radio.

You can listen to FM radio stations using your device - just plug in a headset, and select a station!

42 Music and audio

To listen to the radio, you need to attach a compatible headset to the device. The headset acts as an antenna.



It is not possible to listen to the radio through a Bluetooth headset.

Listen to the radio

Select **Menu** > **Music** > **Radio**.

Change the volume

Use the volume keys.

Close the radio

Press and hold the end key.

Set the radio to play in the background

Select **Options** > **Play in backgr..**

Close the radio when it is playing in the background

Press and hold the end key.

Find and save radio stations

Search for your favourite radio stations, and save them, so you can easily listen to them later.

Select **Menu** > **Music** > **Radio**.

Search for the next available station

Select and hold **⏮** or **⏭**.

Save a station

Select **Options** > **Save station**.

Automatically search for radio stations

Select **Options** > **Search all stat..** For best results, search when outdoors or near a window.



44 Music and audio

Switch to a saved station

Select  or .

Rename a station

- 1 Select **Options** > **Stations**.
- 2 Select and hold the station, and from the pop-up menu, select **Rename**.

Tip: To access a station directly from the saved station list, press the number key that corresponds to the number of the station.

Media player

Play a song

Play music stored in the device memory or on the memory card.

Select **Menu** > **Music** > **My music** and **All songs**.

- 1 Select a song.
- 2 To pause playing, select ; to resume, select .

Play a video

Play videos stored in the device memory or on the memory card.

Select **Menu > Music > My music and Videos**.

- 1 Select a video.
- 2 To pause playback, select **⏸**; to resume, select **▶**.

Pictures and videos

Take a picture

- 1 Select **Menu > Photos > Camera**.
- 2 To zoom in or out, use the volume keys.
- 3 Select **📷**.
The pictures are saved in **Menu > Photos > My photos**.

Close the camera

Press the end key.





46 Pictures and videos

Record a video

Besides taking pictures with your device, you can also capture your special moments as videos.

Select **Menu > Photos > Video camera**.

- 1 To switch from image mode to video mode, if necessary, select  > **Video cam..**
- 2 To start recording, select .
To zoom in or out, use the volume keys.
- 3 To stop the recording, select .

Videos are saved in **Menu > Photos > My videos**.

Close the camera

Press the end key.

Send a picture or video

Want to share your pictures and videos with friends and family? Send a multimedia message or send a picture using Bluetooth.

Select **Menu > Applications > Gallery**.

Send a picture

- 1 Select the folder containing the picture.
- 2 Select and hold the picture to send.
To send more than one picture, select **Options > Mark**, and mark the desired pictures.
- 3 Select **Send** or **Send marked** and the desired sending method.

Send a video

- 1 Select the folder containing the video.
- 2 Select **Options > Mark**, and mark the video. You can mark several videos to send.
- 3 Select **Options > Send marked** and the desired sending method.

Web

About Ovi Browser

Select **Menu > Internet**.

Catch up on the news and visit your favourite websites. You can use Ovi Browser to view web pages on the internet.



48 Web

Ovi Browser compresses and optimises web content for your device, so you can browse the web more quickly and save on data costs.

If Ovi Browser is not pre-loaded in your device, download it from Nokia's Ovi Store. For more information about Ovi Store, go to www.ovi.com.

To browse the web, you must have an internet access point configured in your device and be connected to a network.

For availability, pricing, and instructions, contact your service provider.

You may receive the configuration settings required for browsing as a configuration message from your service provider.

Browse the web

Select **Menu** > **Internet**.

View your browsing history, featured sites, or your bookmarks

To switch between the History, Featured, and Favourites tabs, swipe left or right.



Go to a website Select the address bar, and enter the address.
Move on the web page Drag the page with your finger.
Zoom in Select the desired section of the web page.
Zoom out Double-tap the screen.
Search the internet Select the search field, and enter a search word. If prompted, select your default search engine.
Return to a previously visited web page Open the History tab, and select the web page.

Tip: You can download web apps from Nokia's Ovi Store. When you first open a web app, it is added as a bookmark. To learn more about Ovi Store, go to www.ovi.com.



50 Keep in touch with your online friends

Clear your browsing history

Select Menu > Internet.

Open the History tab, and select ☰ > Clear history.

Clear stored cookies or text saved in web forms

Select ☰ > Tools > Settings > Clear cookies or Clear auto-fill.

Keep in touch with your online friends

About Communities

Select Menu > Applications > Apps and games > Communities, and sign in to your relevant social networking services.

With the Communities application, you can enhance your social networking experience. The application may not be available in all regions. When signed in to social networking services, such as Facebook or Twitter, you can do the following:

- See your friends' status updates
- Post your own status update



- Instantly share pictures you take with the camera

Only those features that are supported by the social networking service are available.

Using social networking services requires network support. This may involve the transmission of large amounts of data and related data traffic costs. For information about data transmission charges, contact your service provider.

The social networking services are third party services and not provided by Nokia. Check the privacy settings of the social networking service you are using as you may share information with a large group of people. The terms of use of the social networking service apply to sharing information on that service. Familiarise yourself with the terms of use and the privacy practices of that service.

Mail and chat

About Mail

Select Menu > Messaging > Mail.

You can use your mobile device to read and send mail from your mail accounts from different mail service providers.



52 Mail and chat

If you do not already have a mail account, you can create a Nokia account, which includes Nokia's Ovi Mail service. For more information, go to www.ovi.com. With your Nokia account, you can access all of Nokia's Ovi services.

Send a mail

Select **Menu** > **Messaging** > **Mail** and a mail account.

- 1 Select **Options** > **Compose New**.
- 2 Enter the recipient's mail address and the subject, and write your message.
- 3 To attach a file, for example, a picture, select **Options** > **Attach** > **Attach file**.
- 4 To take a picture to attach to the mail, select **Options** > **Attach** > **Attach new image**.
- 5 Select **Send**.

Read and reply to mail

Select **Menu** > **Messaging** > **Mail** and a mail account.

- 1 Select a mail.
- 2 To reply to or forward a mail, select **Options**.

About Chat

Select Menu > Messaging > Chat.

With Chat (network service), you can exchange instant messages with your friends. If you do not have a chat account, you can create a Nokia account, and use Nokia's Ovi Chat.

You can leave the Chat application running in the background while you use other features of your device, and still be notified of new instant messages.

Using the service or downloading content may cause transfer of large amounts of data, which may result in data traffic costs.

Chat with your friends

Select Menu > Messaging > Chat.

You can sign in to and chat in several services at the same time. You must separately sign in to each service.

You can have ongoing conversations with several contacts at the same time.



54 Ovi Maps

- 1 If several chat services are available, select the desired service.
- 2 Sign in to the service.
- 3 In your contacts list, select the contact you want to chat with.
- 4 Write your message in the text box at the bottom of the display.
- 5 Select **Send**.

Ovi Maps

About Maps

Your device comes with the Maps application, and may have a memory card with preloaded maps for your country. Insert the memory card into the device before using Maps.

Select **Menu > Maps**.

You can browse maps of different cities in your country. You can also:

- View your current location
- Plan a route to a nearby place
- Search for a place or specific address, and save it

- Send your location or a place to a friend in a text message

When you browse to an area which is not covered by the maps already downloaded on the memory card, a map for the area is automatically downloaded through the internet. Downloading maps may involve transmission of large amounts of data through your service provider's network. For information about data transmission charges, contact your service provider.

You can also use the Nokia Ovi Suite application to download maps. To download and install Nokia Ovi Suite on your compatible computer, go to www.ovi.com.

Network access may be required to find your current location. You may be prompted to select an internet access point.

Some services may not be available in all countries, and may be provided only in selected languages.

Almost all digital cartography is inaccurate and incomplete to some extent. Never rely solely on the cartography that you download for use in this device.



56 Ovi Maps

View your current location on the map

Select Menu > Maps and My position.

Update your current location

Select Options > Update position.

Save your current location

Select Options > Save as favourite.

Find a place

Select Menu > Maps.

- 1 Select **Search**.
- 2 Enter the name of the place or address.
- 3 Select **Go**. A list of matching places or addresses is displayed.

Refine your search

- 1 Select **Advanced** > **Find place** or **Find address**.
- 2 Define more details for your search, and follow the instructions.

Tip: To search from the entire category of places, leave all name fields blank.

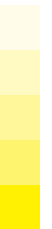

Tip: If you can't find the place you are looking for, try to search from an online database. Select **Search online for**. Additional charges may apply. For details, contact your service provider.

Share your location or a place

You can send your current location or a place on the map to a friend in a text message.

Select **Menu > Maps**.

- 1 Select **My position** or a place on the map and **Options > Send this place**.
- 2 Write your message. The address and a link to the location are automatically added.
- 3 Enter the recipient's phone number, or select **Search** and a contact.
- 4 Select **Send**.

When your friend receives the message containing the address details and link, to view the place on the map in the device web browser, they can select the link.



Nokia's Ovi services

Availability and costs of Nokia's Ovi services

The availability of Nokia's Ovi services may vary by region. Using the services or downloading content may cause transfer of large amounts of data, which may result in data traffic costs. For information about data transmission charges, contact your network service provider.

To learn more about Ovi, go to www.ovi.com.

Access Nokia's Ovi services

Select **Menu** > **Applications** > **Apps and games** and the desired Ovi service.

Using some of the services or downloading content may cause transfer of large amounts of data, which may result in data traffic costs.

Find help

Support

When you want to learn more about how to use your product or you are unsure how your device should



function, go to www.nokia.com/support, or using a mobile device, nokia.mobi/support.

If this does not resolve your issue, do one of the following:

- Reboot your device. Switch off the device, and remove the battery. After about a minute, replace the battery, and switch on the device.
- Restore the original factory settings
- Update your device software

If your issue remains unsolved, contact Nokia for repair options. Go to www.nokia.com/repair, or in Latin America, www.nokia-latinoamerica.com/centrosdeservicio. Before sending your device for repair, always back up your device data.

For additional product support information, see the warranty and reference leaflet included with your Nokia device.

My Nokia

Select **Menu** > **Applications** > **Apps and games** > **Tips and offers**.

60 Find help

My Nokia is a free service that regularly sends you text messages containing tips, tricks, and support for your Nokia device. It also allows you to browse the My Nokia site where you can find details about Nokia devices and download tones, graphics, games, and applications.

To use the My Nokia service, it must be available in your country and supported by your service provider. You must sign up to use the service. Text message charges apply when you send messages to sign up or unsubscribe. For terms and conditions, see the documentation supplied with your device, or go to www.nokia.com/mynokia.

Keep your device up to date

Update device software using your device

Want to improve the performance of your device and get application updates and great new features? Update the software regularly to get the most out of your device. You can also set your device to automatically check for updates.





Warning:

If you install a software update, you cannot use the device, even to make emergency calls, until the installation is completed and the device is restarted. If you install a software update, you cannot use the device until the installation is completed and the device is restarted.

Using the service or downloading content may cause transfer of large amounts of data, which may result in data traffic costs.

Make sure that the device battery has enough power, or connect the charger before starting the update.

Select **Menu > Settings**.



62 Find help



- 1 Select **Device** > **Device updates**.
- 2 To display the current software version and check whether an update is available, select **Current sw details**.
- 3 To download and install a software update, select **Downl. device sw**. Follow the displayed instructions.

- 4 If the installation was cancelled after the download, select **Install sw update**.

The software update may take several minutes. If there are problems with the installation, contact your service provider.

Check for software updates automatically

Select **Automatic SW update**, and define how often to check for new software updates.

Your service provider may send device software updates over the air directly to your device. For more information on this network service, contact your service provider.

Update device software using your PC

You can use the Nokia Ovi Suite PC application to update your device software. You need a compatible PC, a high-speed internet connection, and a compatible USB data cable to connect your device to the PC.

To get more information and to download the Nokia Ovi Suite application, go to www.ovi.com/suite.



64 Find help

Restore original settings

If your device is not working properly, you can reset some settings to their original values.

- 1 End all calls and connections.
- 2 Select **Menu > Settings and Rest. fact. sett. > Settings only.**
- 3 Enter the security code.

This does not affect documents or files stored on your device.

After restoring the original settings, your device switches off and then on again. This may take longer than usual.

Organise files

You can move, copy, delete, or create new files and folders in your device memory or on the memory card. If you organise your files into their own folders, it might help you find the files in future.

Select **Menu > Applications > Gallery.**



Create a new folder

In the folder where you want to create a sub-folder, select **Options > Add folder**.

Copy or move a file to a folder

Select and hold the file, and from the pop-up menu, select the appropriate option.

Tip: You can also play music or videos, or view pictures in Gallery.

Back up your pictures and other content to a memory card

Want to make sure you will not lose any important files? You can back up your device memory to a compatible memory card.

Select **Menu > Settings > Sync & backup**.

Select **Create backup**.

Restore a backup

Select **Restore backup**.



66 Protect the environment

Protect the environment

Save energy

You do not need to charge your battery so often if you do the following:

- Close applications and data connections, for example, your Bluetooth connection, when not in use.
- Deactivate unnecessary sounds, such as touch screen and key tones.

Recycle



When this device has reached the end of its working life, all of its materials can be recovered as materials and energy. To guarantee the correct disposal and reuse, Nokia co-operates with its partners through a program called We:recycle. For information on how to recycle your old Nokia products and where to find collection sites, go to www.nokia.com/werecycle, or using a mobile device, nokia.mobi/werecycle, or call the Nokia Contact Center.



Product and safety information 67

Recycle packaging and user guides at your local recycling scheme.

For more information on the environmental attributes of your device, go to www.nokia.com/ecodeclaration.

Product and safety information

Network services and costs

Your device is approved for use on the [E]GSM 850, 1900 MHz networks. To use the device, you need a subscription with a service provider.

Using network services and downloading content to your device requires a network connection and may result in data traffic costs. Some product features require support from the network, and you may need to subscribe to them.

Take care of your device

Handle your device, battery, charger and accessories with care. The following suggestions help you protect your warranty coverage.

- Keep the device dry. Precipitation, humidity, and all types of liquids or moisture can contain minerals that corrode electronic circuits. If your device gets wet, remove the battery, and allow the device to dry.
- Do not use or store the device in dusty or dirty areas. Moving parts and electronic components can be damaged.
- Do not store the device in high temperatures. High temperatures can shorten the life of the device, damage the battery, and warp or melt plastics.

68 Product and safety information

- Do not store the device in cold temperatures. When the device warms to its normal temperature, moisture can form inside the device and damage electronic circuits.
- Do not attempt to open the device other than as instructed in the user guide.
- Unauthorised modifications may damage the device and violate regulations governing radio devices.
- Do not drop, knock, or shake the device. Rough handling can break internal circuit boards and mechanics.
- Only use a soft, clean, dry cloth to clean the surface of the device.
- Do not paint the device. Paint can clog the moving parts and prevent proper operation.
- Switch off the device and remove the battery from time to time for optimum performance.
- Keep your device away from magnets or magnetic fields.
- To keep your important data safe, store it in at least two separate places, such as your device, memory card, or computer, or write down important information.

Recycle

Always return your used electronic products, batteries, and packaging materials to dedicated collection points. This way you help prevent uncontrolled waste disposal and promote the recycling of materials. Check product environmental information and how to recycle your Nokia products at www.nokia.com/werecycle, or with a mobile device, <http://nokia.mobi/werecycle>.

About Digital Rights Management

When using this device, obey all laws and respect local customs, privacy and legitimate rights of others, including copyrights. Copyright protection may prevent you from copying, modifying, or transferring images, music, and other content.

Product and safety information 69

Content owners may use different types of digital rights management (DRM) technologies to protect their intellectual property, including copyrights. This device uses various types of DRM software to access DRM-protected content. With this device you can access content protected with WMDRM 1.0 and OMA DRM 1.0. If certain DRM software fails to protect the content, content owners may ask that such DRM software's ability to access new DRM-protected content be revoked. Revocation may also prevent renewal of such DRM-protected content already in your device. Revocation of such DRM software does not affect the use of content protected with other types of DRM or the use of non-DRM-protected content.

Digital rights management (DRM) protected content comes with an associated licence that defines your rights to use the content.

If your device has OMA DRM-protected content, to back up both the licences and the content, use the backup feature of Nokia Ovi Suite.

Other transfer methods may not transfer the licences which need to be restored with the content for you to be able to continue the use of OMA DRM-protected content after the device memory is formatted. You may also need to restore the licences in case the files on your device get corrupted.

If your device has WMDRM-protected content, both the licences and the content will be lost if the device memory is formatted. You may also lose the licences and the content if the files on your device get corrupted. Losing the licences or the content may limit your ability to use the same content on your device again. For more information, contact your service provider.

Some licences may be connected to a specific SIM card, and the protected content can be accessed only if the SIM card is inserted in the device.



70 Product and safety information

Batteries and chargers

Battery and charger information

Your device is intended for use with a BL-5C rechargeable battery. Nokia may make additional battery models available for this device. Always use original Nokia batteries.

This device is intended for use when supplied with power from the following chargers: AC-3. The exact Nokia charger model number may vary depending on the plug type, identified by E, X, AR, U, A, C, K, or B.

The battery can be charged and discharged hundreds of times, but it will eventually wear out. When the talk and standby times are noticeably shorter than normal, replace the battery.

Battery safety

Always switch the device off and disconnect the charger before removing the battery. When you unplug a charger or an accessory, hold and pull the plug, not the cord.

When your charger is not in use, unplug it from the electrical plug and the device. Do not leave a fully charged battery connected to a charger, as overcharging may shorten the battery's lifetime. If left unused, a fully charged battery will lose its charge over time.

Always keep the battery between 15°C and 25°C (59°F and 77°F). Extreme temperatures reduce the capacity and lifetime of the battery. A device with a hot or cold battery may not work temporarily.

Accidental short-circuiting can happen when a metallic object touches the metal strips on the battery, for example, if you carry a spare battery in your pocket. Short-circuiting may damage the battery or the connecting object.



Product and safety information 71

Do not dispose of batteries in a fire as they may explode. Dispose of batteries according to local regulations. Recycle when possible. Do not dispose as household waste.

Do not dismantle, cut, open, crush, bend, puncture, or shred cells or batteries. If a battery leaks, do not let battery liquid touch skin or eyes. If this happens, immediately flush the affected areas with water, or seek medical help.

Do not modify, remanufacture, attempt to insert foreign objects into the battery, or immerse or expose it to water or other liquids. Batteries may explode if damaged.

Use the battery and charger for their intended purposes only. Improper use, or use of unapproved batteries or incompatible chargers may present a risk of fire, explosion, or other hazard, and may invalidate any approval or warranty. If you believe the battery or charger is damaged, take it to a service centre for inspection before continuing to use it. Never use a damaged battery or charger. Only use the charger indoors.

Additional safety information

Make an emergency call

- 1 Make sure the device is switched on.
- 2 Check for adequate signal strength. You may also need to do the following:
 - Insert a SIM card.
 - Deactivate call restrictions you have activated for your device, such as call barring, fixed dialling, or closed user group.
 - Make sure the offline or flight profile is not activated.
 - If the device screen and keys are locked, unlock them.
- 3 Press the end key repeatedly, until the home screen is displayed.
- 4 Select Call.

72 Product and safety information

- 5 Enter the official emergency number for your present location. Emergency call numbers vary by location.
- 6 Press the call key.
- 7 Give the necessary information as accurately as possible. Do not end the call until given permission to do so.



Important: Activate both cellular and internet calls, if your device supports internet calls. The device may attempt to make emergency calls both through cellular networks and through your internet call service provider. Connections in all conditions cannot be guaranteed. Never rely solely on any wireless device for essential communications like medical emergencies.

Small children

Your device and its accessories are not toys. They may contain small parts. Keep them out of the reach of small children.

Medical devices

Operation of radio transmitting equipment, including wireless phones, may interfere with the function of inadequately protected medical devices. Consult a physician or the manufacturer of the medical device to determine whether they are adequately shielded from external RF energy. Switch off your device when regulations posted instruct you to do so, for example, in hospitals.

Implanted medical devices

Manufacturers of medical devices recommend a minimum separation of 15.3 centimetres (6 inches) between a wireless device and an implanted medical device, such as a pacemaker or implanted cardioverter defibrillator, to avoid potential interference with the medical device. Persons who have such devices should:

Product and safety information 73

- Always keep the wireless device more than 15.3 centimetres (6 inches) from the medical device.
- Not carry the wireless device in a breast pocket.
- Hold the wireless device to the ear opposite the medical device.
- Turn the wireless device off if there is any reason to suspect that interference is taking place.
- Follow the manufacturer directions for the implanted medical device.

If you have any questions about using your wireless device with an implanted medical device, consult your health care provider.

Accessibility solutions

Nokia is committed to making mobile phones easy to use for all individuals, including those with disabilities. For more information, visit the Nokia website at www.nokiaaccessibility.com.

Hearing



Warning:
When you use the headset, your ability to hear outside sounds may be affected. Do not use the headset where it can endanger your safety.

Some wireless devices may interfere with some hearing aids.

Protect your device from harmful content

Your device may be exposed to viruses and other harmful content. Take the following precautions:

74 Product and safety information

- Be cautious when opening messages. They may contain malicious software or otherwise be harmful to your device or computer.
- Be cautious when accepting connectivity requests, browsing the internet, or downloading content. Do not accept Bluetooth connections from sources you do not trust.
- Only install and use services and software from sources that you trust and that offer adequate security and protection.
- Install antivirus and other security software on your device and any connected computer. Only use one antivirus application at a time. Using more may affect performance and operation of the device and/or computer.
- If you access preinstalled bookmarks and links to third party internet sites, take the appropriate precautions. Nokia does not endorse or assume liability for such sites.

Operating environment

This device meets RF exposure guidelines in the normal use position at the ear or at least 1.5 centimetres (5/8 inch) away from the body. Any carry case, belt clip, or holder for body-worn operation should not contain metal and should position the device the above-stated distance from your body.

To send data files or messages requires a quality connection to the network. Data files or messages may be delayed until such a connection is available. Follow the separation distance instructions until the transmission is completed.

Vehicles

Radio signals may affect improperly installed or inadequately shielded electronic systems in motor vehicles such as electronic fuel injection, electronic antilock braking, electronic speed control, and air bag systems. For more information, check with the manufacturer of your vehicle or its equipment.



Product and safety information 75

Only qualified personnel should install the device in a vehicle. Faulty installation or service may be dangerous and may invalidate your warranty. Check regularly that all wireless device equipment in your vehicle is mounted and operating properly. Do not store or carry flammable liquids, gases, or explosive materials in the same compartment as the device, its parts, or accessories. Remember that air bags inflate with great force. Do not place your device or accessories in the air bag deployment area.

Switch off your device before boarding an aircraft. The use of wireless devices in an aircraft may be dangerous to the operation of the aircraft and may be illegal.

Potentially explosive environments

Switch off your device in any area with a potentially explosive atmosphere. Obey all posted instructions. Sparks in such areas could cause an explosion or fire resulting in bodily injury or death. Switch off the device at refuelling points such as near gas pumps at service stations. Observe restrictions in fuel depots, storage, and distribution areas; chemical plants; or where blasting operations are in progress. Areas with a potentially explosive atmosphere are often, but not always, clearly marked. They include areas where you would be advised to turn off your vehicle engine, below deck on boats, chemical transfer or storage facilities and where the air contains chemicals or particles such as grain, dust, or metal powders. You should check with the manufacturers of vehicles using liquefied petroleum gas (such as propane or butane) to determine if this device can be safely used in their vicinity.

Certification information (SAR)

This mobile device meets guidelines for exposure to radio waves.

Your mobile device is a radio transmitter and receiver. It is designed not to exceed the limits for exposure to radio waves recommended by international guidelines. These guidelines were developed by the independent scientific organisation ICNIRP and include safety margins designed to assure the protection of all persons, regardless of age and health.

www.nokia.com/support

75

76 Product and safety information

The exposure guidelines for mobile devices employ a unit of measurement known as the Specific Absorption Rate or SAR. The SAR limit stated in the ICNIRP guidelines is 2.0 watts/kilogram (W/kg) averaged over 10 grams of tissue. Tests for SAR are conducted using standard operating positions with the device transmitting at its highest certified power level in all tested frequency bands. The actual SAR level of an operating device can be below the maximum value because the device is designed to use only the power required to reach the network. That amount changes depending on a number of factors such as how close you are to a network base station.

The highest SAR value under the ICNIRP guidelines for use of the device at the ear is 0.46 W/kg.

Use of device accessories may result in different SAR values. SAR values may vary depending on national reporting and testing requirements and the network band. Additional SAR information may be provided under product information at www.nokia.com.

Your mobile device is also designed to meet the requirements for exposure to radio waves established by the Federal Communications Commission (USA) and Industry Canada. These requirements set a SAR limit of 1.6 W/kg averaged over one gram of tissue. The highest SAR value reported under this standard during product certification for use at the ear is 0.68 W/kg and when properly worn on the body is 0.55 W/kg.



© 2011 Nokia. All rights reserved.

Nokia, Nokia Connecting People, Ovi, and WE: logo are trademarks or registered trademarks of Nokia Corporation. Nokia tune is a sound mark of Nokia Corporation. Other product and company names mentioned herein may be trademarks or tradenames of their respective owners.

Reproduction, transfer, distribution, or storage of part or all of the contents in this document in any form without the prior written permission of Nokia is prohibited. Nokia operates a policy of continuous development. Nokia reserves the right to make changes and improvements to any of the products described in this document without prior notice.



Includes RSA BSAFE cryptographic or security protocol software from RSA Security.



Java and all Java-based marks are trademarks or registered trademarks of Sun Microsystems, Inc.

Portions of the Nokia Maps software are ©1996-2011 The FreeType Project. All rights reserved.

The Bluetooth word mark and logos are owned by the Bluetooth SIG, Inc. and any use of such marks by Nokia is under license.

To the maximum extent permitted by applicable law, under no circumstances shall Nokia or any of its licensors be responsible for any loss of data or income or any special, incidental, consequential or indirect damages howsoever caused.

The contents of this document are provided "as is". Except as required by applicable law, no warranties of any kind, either express or implied, including, but not limited to, the implied



warranties of merchantability and fitness for a particular purpose, are made in relation to the accuracy, reliability or contents of this document. Nokia reserves the right to revise this document or withdraw it at any time without prior notice.

The availability of products, features, applications and services may vary by region. For more information, contact your Nokia dealer or your service provider. This device may contain commodities, technology or software subject to export laws and regulations from the US and other countries. Diversion contrary to law is prohibited. The availability of Ovi services may vary by region.

FCC/INDUSTRY CANADA NOTICE

Your device may cause TV or radio interference (for example, when using a telephone in close proximity to receiving equipment). The FCC or Industry Canada can require you to stop using your telephone if such interference cannot be eliminated. If you require assistance, contact your local service facility. This device complies with part 15 of the FCC rules. Operation is subject to the following two conditions: (1) This device may not

cause harmful interference, and (2) this device must accept any interference received, including interference that may cause undesired operation. Any changes or modifications not expressly approved by Nokia could void the user's authority to operate this equipment.

Some operations and features are SIM card and/or network dependent, MMS dependent, or dependent on the compatibility of devices and the content formats supported. Some services are subject to a separate charge.

5555555/Issue 1 EN



Index		— log	26
		— making	25, 26
		camera	
A		— recording videos	46
access codes	17	— sending pictures and videos	46
alarm clock	37	— taking pictures	45
alarms	37	charging the battery	70
antennas	16	chat services (IM)	53
		clock	37
B		connectivity	38
backing up data	65	contacts	
battery	8, 70	— adding	27
— charging	13	— copying	23
Bluetooth	38, 39	— saving	27
browser		conversations	32
<i>See web browser</i>		copying content	23, 40
business cards	39		
		D	
C		data connections	
cable connection	40	— Bluetooth	38
Calendar	38	date and time	37
calendar	39	device	
calls		— switching on/off	15
— emergency	71		
www.nokia.com/support			79



80 Index

dictionary 30

E
e-mail 51
emergency calls 71

F
factory settings,
restoring 64
file management 64
FM radio 41, 42, 43

H
home screen 22, 33, 34

I
IM (instant
messaging) 53
inbox, messages 32
indicators 22
internet
See web browser

K
keyguard 19
keys and parts 7

L
locking
— keys 19
— screen 19
loudspeaker 25

M
mail 51
— creating 52
— reading and replying
to 52
— sending 52
mailbox
— voice 33
Maps 54
— current location 56
— searching 56
— sharing 57
meeting entries 38
memory card 12



messages	32	personalising your device	34, 35
— sending	31	Phone switch	23
MMS (multimedia message service)	31	pictures	
multimedia messages	31	— copying	23, 40
music	44	— sending	39, 46
My Nokia	59	— taking	45
N		PIN codes	17
Nokia Messaging		powering device on/off	15
— chat services (IM)	53	predictive text input	28, 30
Nokia support information	58	profiles	
Nokia's Ovi services	58	— personalising	35
O		PUK codes	17
Ovi Browser	47	R	
Ovi by Nokia	58	radio	41, 42, 43
Ovi Maps	54	recording	
P		— videos	46
passwords	17	recycling	66
		restoring data	65
		restoring settings	64
		ringtones	35



82 Index

S		tones
searching		— personalising 35
— radio stations	43	touch screen 19
security code	17	transferring content 23, 40
settings		turning device on/off 15
— restoring	64	
SIM card	8	U
SMS (short message service)	31	updates
social networks	50	— device software 60, 63
software updates	60, 63	USB connection 40
strap	15	
support	58	V
switching device on/off	15	videos
		— copying 23, 40
T		— playing 45
taking pictures		— recording 46
See <i>camera</i>		— sending 39, 46
text input	28, 29, 30	voice messages 33
text messages	31	volume 25
themes	34	
time and date	37	

W	
web browser	47
— browsing pages	48
— cookies	50

