

**NOKIA**



555555 Issue 1 EN





## Contents

<b>Get started.....</b>	<b>5</b>
Your dual SIM phone.....	5
Keys and parts.....	6
Insert a SIM card and battery .....	8
Insert a second SIM card.....	9
Insert or remove a memory card.....	10
Charge the battery.....	11
Switch on.....	11
Copy content from your old phone.....	13
Set which SIM card to use.....	14
Lock the keys and screen .....	15
Change the volume.....	15
<b>Phone basics.....</b>	<b>16</b>
Switch between home screens.....	16
Explore your phone.....	17
Add a shortcut to My screen.....	19
Change the wallpaper.....	20
Change your ringtone.....	21
<b>About Nokia Store.....</b>	<b>22</b>
<b>Calls.....</b>	<b>23</b>
Make a call .....	23
<b>Contacts.....</b>	<b>24</b>



Save a name and phone number.....	24
<b>Write text.....</b>	<b>25</b>
Use the on-screen keypad.....	25
Use the on-screen keypad.....	26
Use predictive text.....	27
<b>Messaging.....</b>	<b>28</b>
Send a message.....	28
Write using the on-screen keyboard.....	29
<b>Mail .....</b>	<b>30</b>
Send a mail.....	30
<b>Photos and videos.....</b>	<b>31</b>
Take a photo.....	31
Record a video.....	32
<b>Web.....</b>	<b>33</b>
Browse the web.....	33
Add a bookmark.....	35
<b>Connectivity.....</b>	<b>36</b>
Connect to a wireless headset.....	36
<b>Maps.....</b>	<b>37</b>
Search for a place.....	37

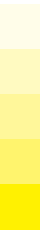



**Support and updates.....38**

Troubleshooting.....38

Back up content to a memory card.....40

About phone software updates .....41

Update phone software using your PC.....42

Update phone software using your phone.....43

Restore original settings.....44

Access codes.....45

**Product and safety information.....47**





---

## Get started

### Your dual SIM phone

You can have two SIM cards in your phone.

#### Some benefits of a dual SIM phone

- Have two phone numbers, but carry one phone – use a work and personal SIM at the same time.
- It doesn't matter which number people call – both SIMs are active.
- Save money – use the best network service provider for a situation.
- Stay in touch – avoid differences in network coverage between service providers.

Both SIM cards are available at the same time when the device is not being used, but while one SIM card is active, for example, making a call, the other is unavailable.

If you only have one SIM card, put the card into the SIM1 card holder. Some features and services may only be available when using the SIM card in the SIM1 card holder. If there is a SIM card only in the SIM2 card holder, you can only make emergency calls.

#### Availability of SIMs

- When you set one SIM to be used for outgoing calls, sending text or multimedia messages, or uploading and downloading data, the other SIM can still receive calls or text and multimedia messages.
- When one SIM is having a call, sending or receiving text or multimedia messages, or uploading or downloading data, the other is not available.



Keys and parts

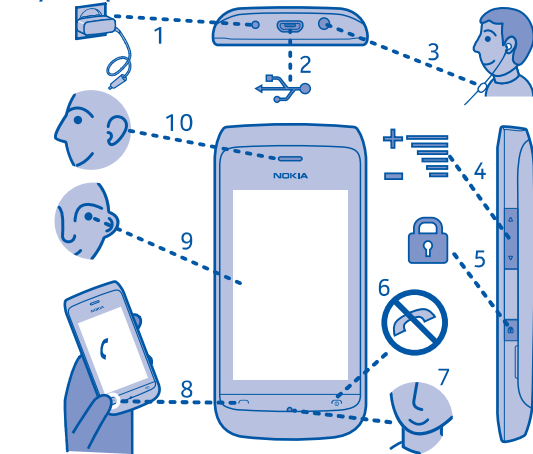

- |   |   |    |               |
|---|---|----|---------------|
| 1 | Charger connector                             | 6  | End/Power key |
| 2 | Micro-USB connector                           | 7  | Microphone    |
| 3 | Headset connector (Nokia AV connector 3.5 mm) | 8  | Call key      |
| 4 | Volume keys                                   | 9  | Screen        |
| 5 | Lock key                                      | 10 | Earpiece      |

6

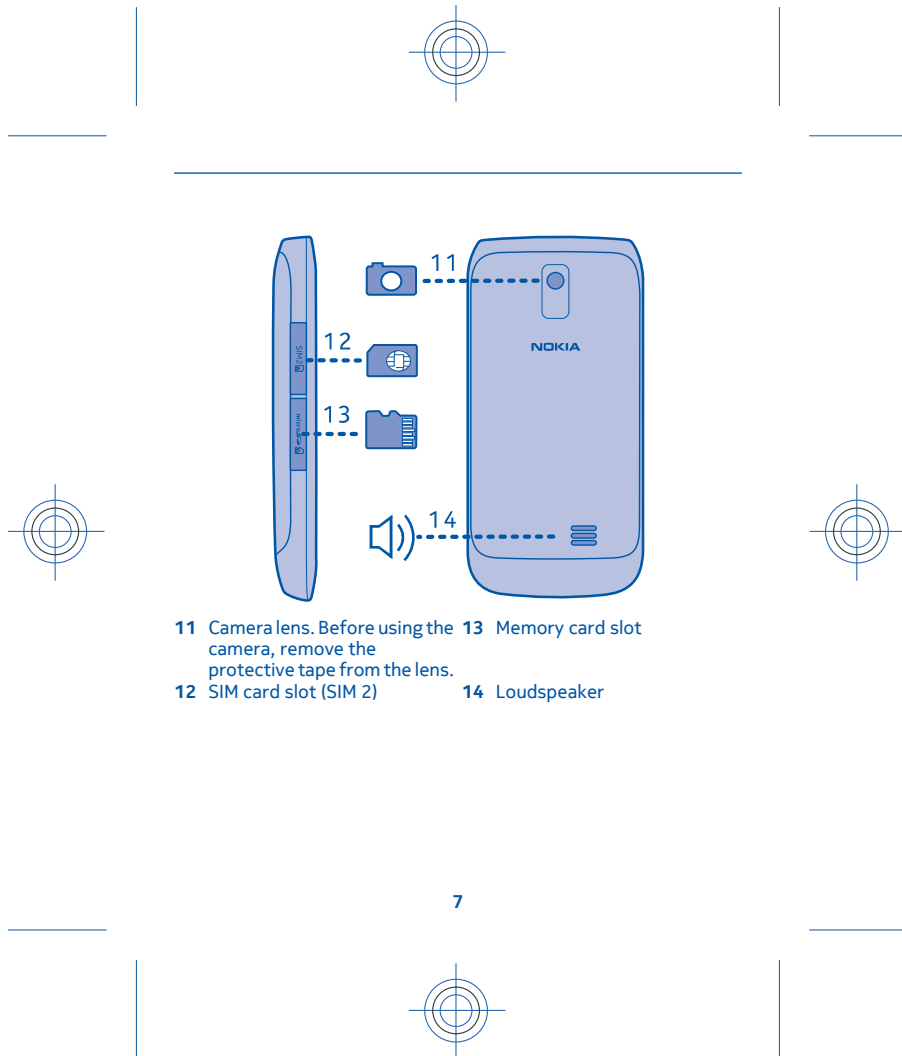

- 11 Camera lens. Before using the camera, remove the protective tape from the lens.
- 12 SIM card slot (SIM 2)
- 13 Memory card slot
- 14 Loudspeaker



### Insert a SIM card and battery

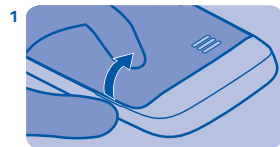

1 Switch the phone off, and remove the back cover.



4 Line up the battery contacts, and push the battery in.

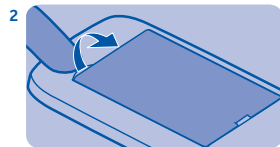

2 If the battery is in the phone, lift it out.

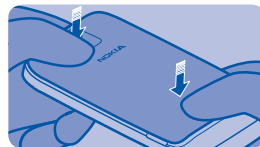

5 Replace the back cover.

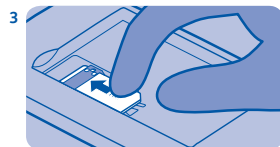

3 Slide the SIM under the holder with the contact area face down.

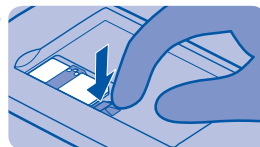

6 To remove the SIM, press the tongue down, and slide the SIM out.







### Insert a second SIM card

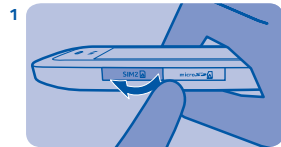

1 Open the SIM SIM cover.

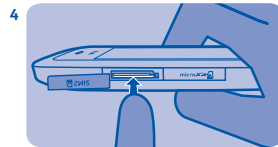

4 To remove the SIM, push the SIM in until it's free.

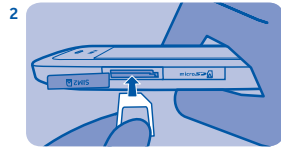

2 Put the SIM in with the contact area face up.

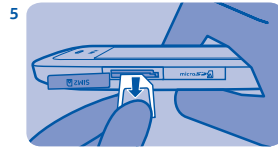

5 Pull the SIM out.



3 Push the card in until it locks into place. Close the cover.

9

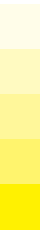



### Insert or remove a memory card

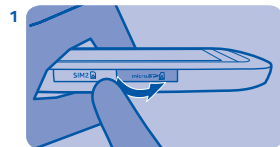

1 Open the memory card slot cover.



4 To remove the memory card, push the card in until it's free.



2 Put the memory card in with the contact area face up.

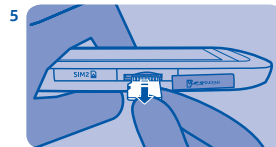

5 Pull the memory card out.

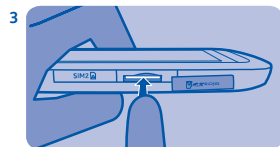

3 Push the card in until it locks into place. Close the cover.





### Charge the battery

### Switch on

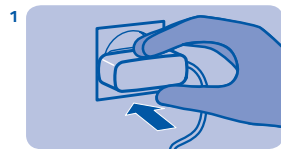

Plug the charger into a wall outlet.

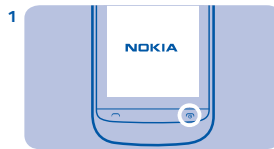

Press and hold the power key.

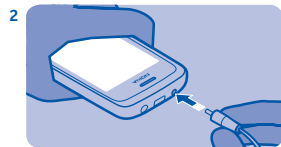

Connect the charger to the phone.  
See 1, 2 in "Feature specific instructions".



Select the date field, and set the date.



Battery full? Unplug from the phone,  
then from the wall outlet.

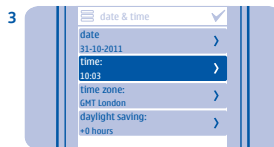

Select the time field, and set the time.

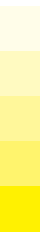

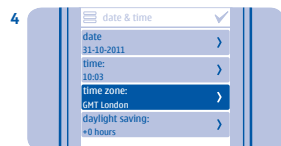

4 Select the time zone, and select if daylight saving time is used.

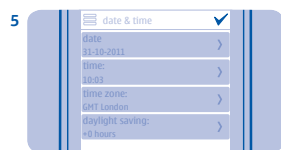

5 Select ✓.



Tip: To switch the phone off, press and hold the power key.





### Copy content from your old phone

Easily get your contacts, calendar, and other stuff to your new phone.

1. Switch Bluetooth on in both phones.
2. On your new phone, select **settings** and **sync & backup > phone switch**.
3. Select **copy to this** and what you want to copy, then select **✓**.
4. Select your old phone from the list of found devices.
5. Follow the instructions shown on both phones.





### Set which SIM card to use

You can set the default SIM card to use to make a call, send a message, or connect to the internet. If you name your SIMs, you can see at a glance which is, for example, for work and which is for personal use.

Select **SIM manager**.

Select from the following:

**1** or **2** — Use the SIM in either the internal SIM holder or the external SIM slot as the default SIM.

**?** — When a SIM is needed, you are asked which SIM to use.

**+** — Set which SIM to use in different cases. For example, you can use one SIM to make calls, but another to connect to the internet. To change the settings, select **personalise**.

### Rename a SIM card

Select the SIM you want to rename, then write the new name.

**Tip:** To quickly change between SIMs and modes, swipe down from the top of the screen, then tap the SIM area.



### Lock the keys and screen

### Change the volume



Lock the keys and screen when not using your phone.



Is the volume too loud during a call or when listening to the radio?

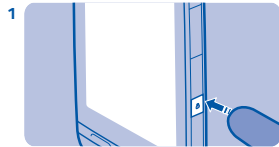

To lock, press the key lock button.

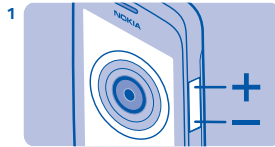

Use the volume keys.

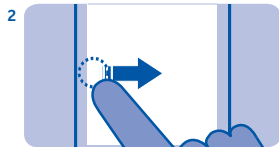

To unlock, press the key lock button, then swipe left or right.



Better.

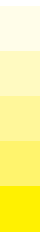

## Phone basics

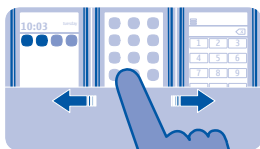

### Switch between home screens

Your phone has three home screens, one for apps, one for your favourite shortcuts, and one for your most used app, such as the dialler.

Swipe left or right.

- My screen is the place where you can add your favourite contacts and shortcuts.
- On the apps screen, you can open apps, and organise them to your liking.
- On the dialler screen, you can make calls. In place of the dialler, you can also have the music player or radio.

**Tip:** To personalise the dialler screen, tap and hold My screen, swipe to the dialler screen, and select the app you want.





### Explore your phone

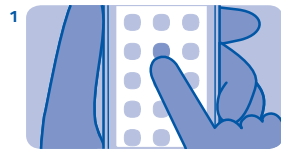

1 Tap an app or other item to open it.

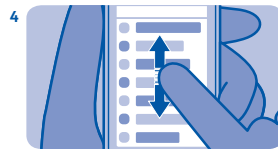

4 To scroll, slide your finger quickly up or down, then lift your finger.

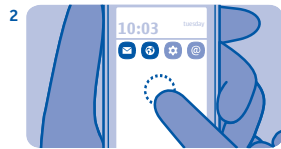

2 Tap and hold an item to see more options.



5 To zoom, slide two fingers apart or together on the screen.

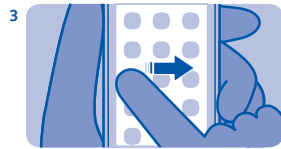

3 To swipe, steadily slide your finger to the desired direction.



6 To go back to the previous view, select .

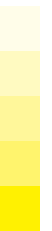



7

To go back to the home screen, select .



8

To view notifications, swipe down from the top of the screen. See [3](#).



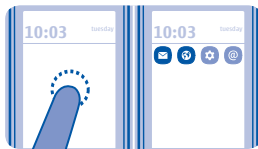

### Add a shortcut to My screen

Want to open your favourite apps straight from My screen? Add shortcuts to your most used features.

1. Tap and hold My screen, and select **+ shortcut**.
2. Select an item, such as a widget or action, and select .

### Remove a shortcut

Tap and hold My screen, and select  on the shortcut you want to remove.

**Tip:** Try tapping different areas on My screen. You can, for example, change the date and time, set alarms, or add to your calendar also from My screen.





### Change the wallpaper

Want to see a favourite landscape or your family photos in the background of the lock screen? You can change the wallpaper to personalise the lock screen to your liking.

1. Select **settings** and **wallpaper**.
2. Select a folder and a photo.

**Tip:** You can also take a photo on your phone, and use that.

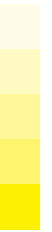



### Change your ringtone

You can set a different ringtone for each profile.

1. Select **settings** > **tone profiles** and a profile.
2. Select **ringtone**.
3. Select a ringtone from **open files** or your downloaded tones. The ringtone plays so you can see if you like it.
4. When you've found a ringtone you like, select **YES**.

**Tip:** Download more ringtones from Nokia Store. To learn more about Nokia Store, go to [www.nokia.com/support](http://www.nokia.com/support).

**Tip:** You can also change the message alert tone. Select **msg. alert tone** and a tone.

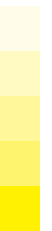



## About Nokia Store



Download mobile games, apps, videos, themes, wallpapers, and ringtones to your phone from Nokia Store.

Select **store**.

Many items are free of charge; some you need to pay for with your credit card or on your phone bill. The availability of payment methods depends on your country of residence and your network service provider. To learn more about Nokia Store, go to [www.nokia.com/support](http://www.nokia.com/support).

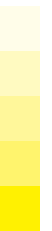





## Calls



### Make a call

1. Select **phone**, or swipe left to open the dialler.
2. Type in the phone number.

The + character may not work in all regions. In this case, type in the international access code directly.

3. Press .
4. If asked, select the SIM to use.
5. To end the call, press .

### Answer a call

Press .

When you receive a call, your phone shows you which SIM is used.

### Decline a call

Press .





## **Contacts**



### **Save a name and phone number**

Add new contacts to your phone.

Select **contacts**.

Select , then write the name, number, and other details.

If asked, select where to save the contact.

### **Edit the details of a contact**

Select a contact and , then edit the details.

### **Add more details**

Select  > **add detail** and a detail.







## Write text

### Use the on-screen keypad

To open the traditional alphanumeric keypad, turn the phone to portrait mode.

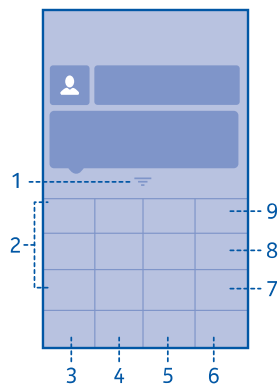

1 Close key

2 Character keys

6 Input options key - Switch predictive text input on or off, change the writing language, or switch to the on-screen keyboard.

7 Symbol key - Type in a special character.

25





- |  |  |
|--|--|
| 3 Smiley key - This may not be available in all languages.                           | 8 Character/number mode key - Switch between characters and numbers. |
| 4 Space key  | 9 Backspace key - Delete a character.                                |
| 5 Shift key - Change the character case. This may not be available in all languages. |  |

**Close the keypad**

Swipe down on the keypad. You can also select and hold the close key.

**Switch back to using the keyboard**

Turn the phone to landscape mode.

**Use the on-screen keypad**

To open the on-screen keypad when writing text, turn the phone to portrait mode.

**Type in a character**

1. Select a character key repeatedly until the character is shown. There are more characters available than are shown on the key.

2. If the next letter is on the same key, wait until the cursor is shown, then select the key again.

**Type in a space**

Select .

**Move the cursor to the next line**

Select  three times.



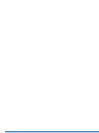

**Type in a number**



Select 123, then select the number.

**Type in a special character**

Select the sym key, then select the special character.



**Use predictive text**

Predictive text is not available in all languages.

1. Select  > **prediction** > .
2. Start writing a word. Your phone suggests possible words as you write. When the correct word is shown, select the word.
3. If the word is not in the dictionary, select the pop-up and , and add the new word to the dictionary.

When using predictive text, you can set your phone to complete and type in words for you automatically.

**Use word completion**

Select  > **word completion** > .







## Messaging



### Send a message

Keep in touch with your family and friends through messages.

1. Select **messaging** and .
2. To add a contact as a recipient, select . You can also type in a phone number.
3. Write your message in the text box.

**Tip:** To include an attachment, such as a photo or video, select  **> insert content**.

4. Select .

If asked, select which SIM to use.

Sending a message with an attachment, such as a photo or video, may be more expensive than sending a normal text message. For more info, contact your network service provider.

See  4, 5, 6.



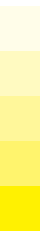

### Write using the on-screen keyboard

When writing text, select  > **input type**, then select the language and **full keyboard**.

#### Add an accent to a character

Select and hold the character. This may not be available in all languages.

#### Switch between character cases

Select .

#### Type in a space

Select .

#### Move the cursor to the next line

Select .

#### Delete a character

Select .





## ✉ Mail

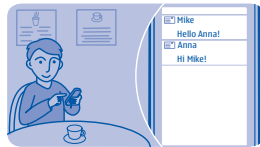

### Send a mail

Would you like to send a mail while on the go? With your phone, you can read and send mail, even when not sitting at your desk.

1. Select **mail** and a mail account.
  2. Select ✉.
  3. To add a recipient, select 👤, or manually write the address in the To: field.
  4. Write the subject and your message.
- Tip:** To include an attachment, such as a photo, select 📎.
5. Select ✉.

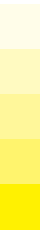



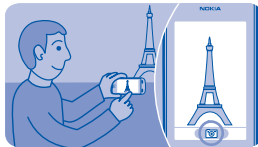

## Photos and videos



### Take a photo

1. To open the camera, select **camera**.
2. To zoom in or out, use the volume keys.
3. Select .

Photos are saved in gallery.

**Close the camera**  
Select .

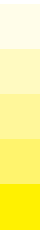



### Record a video

Besides taking photos with your phone, you can also capture your special moments as videos.

To open the video camera, select **video**.

1. To start recording, select ●.
2. To zoom in or out, use the volume keys.
3. To stop recording, select ■.

Videos are saved in gallery.

### Close the camera

Select ☰.





## Web



### **Browse the web**

Catch up on the news, and visit your favourite websites on the go.

Select **internet**.

### **Go to a website**

Write the web address in the address bar.

### **Move on the web page**

Drag the page with your finger.

### **Zoom in**

Tap the section of the web page you want to see better.

### **Zoom out**

Double-tap the screen.

**Tip:** To zoom in or out, you can also place two fingers on the screen, and slide your fingers apart or together.

### **Search the internet**

Write a search word in the address bar. If asked, select your default search engine.

### **Go back to a previously visited web page**

Select **★ > history** and the web page.

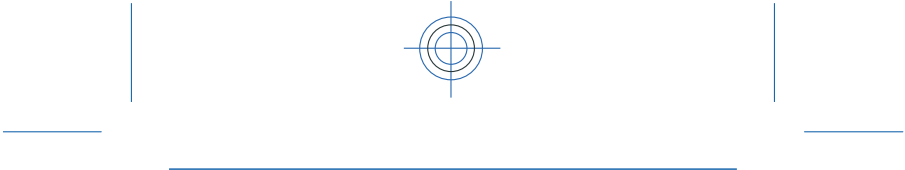

**Tip:** To show the address bar and toolbar when browsing, select .

**Tip:** You can download web apps from Nokia Store. When you first open a web app, it is added as a bookmark. For more info, go to [www.nokia.com/support](http://www.nokia.com/support).





#### Add a bookmark

If you visit the same websites all the time, add them as bookmarks, so you can easily access them.

Select **internet**.

While browsing, select ☰ → **add to favourites**.

**Go to a bookmarked website**

Select ★ and a bookmark.

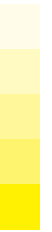



## ✦ Connectivity



### Connect to a wireless headset

Want to keep working at your computer during a call? Use a wireless headset. You can also answer a call, even if your phone's not directly at hand.

Select **settings** > **connectivity** > **Bluetooth**.

1. Make sure **Bluetooth** is on.
2. Switch the headset on.
3. To search for your headset, select **Q**.
4. Select the headset.
5. You may need to type in a passcode (such as 1234).





## Maps



### Search for a place

You can search for locations, such as street addresses, and places, such as restaurants.

1. Select **maps**.
2. Select  to see the toolbar, then select **Q**.
3. Write the name of the place or the address.



## Support and updates



### Troubleshooting

If you have an issue, do the following:

- Switch the phone off, and remove the battery. After about a minute, put the battery back in, and switch the phone on again.
- Update your phone software: Select **settings** and **phone > device updates**.
- Restore the original factory settings: End all calls and connections, and select **settings** and **restore factory sett. > settings only**.

If your issue remains unsolved, contact Nokia for repair options at [www.nokia.com/support](http://www.nokia.com/support). Before sending your phone for repair, back up your data, as all personal data in your phone may be deleted.

You can also go to [www.nokia.com/support](http://www.nokia.com/support) where you can find:

- Troubleshooting info
- News on apps and downloads
- Longer version of this user guide
- Software update info
- Details about features and technologies, and the compatibility of devices and accessories

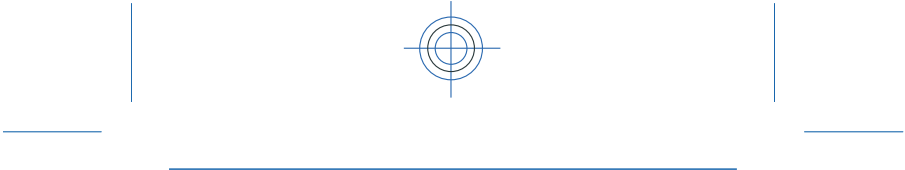

For additional product support info, see the warranty and reference leaflet included with your Nokia device.

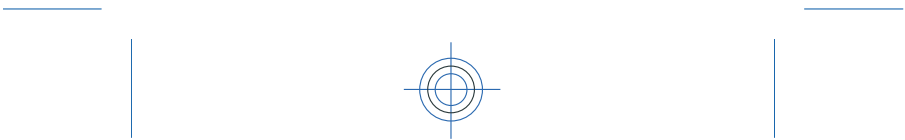
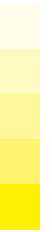



### Back up content to a memory card

Want to make sure you won't lose any important files? You can back up your phone memory to a compatible memory card.

Select **settings > sync & backup**.

1. Select **create backup**.
2. Select what you want to back up, then select ✓.

### Restore a backup

Select **restore backup** and what you want to restore, then select ✓.





### About phone software updates

Stay in step with the beat – update your phone software to get new and enhanced features for your phone. Updating the software may also improve your phone performance.

It is recommended that you back up your personal data before updating your phone software.

**⚠ Warning:**

If you install a software update, you cannot use the device, even to make emergency calls, until the installation is completed and the device is restarted.

Using services or downloading content may cause transfer of large amounts of data, which may result in data traffic costs.

Before starting the update, connect a charger or make sure the device battery has enough power.

After the update, the instructions in the user guide may no longer be up to date. You may find the updated user guide at [www.nokia.com/support](http://www.nokia.com/support).





#### Update phone software using your PC

Update your phone software with the Nokia Suite PC app. You can also back up the photos and other stuff in your phone to your computer.

You need a compatible PC, a high-speed internet connection, and a compatible USB cable to connect your phone to the PC.

To get more info and to download the app, go to [www.nokia.com/support](http://www.nokia.com/support).

See [7](#).

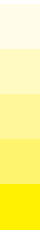



### Update phone software using your phone

You can update your phone software wirelessly. You can also set your phone to automatically check for updates.

You can only update your software when using the SIM in the internal SIM holder.

Select **settings** and **phone > device updates**.

1. To check if there is an update, select **current sw details**.
2. To download and install an update, select **downl. phone sw**, then follow the instructions shown on the phone.

The update may take several minutes. If you encounter problems, contact your network service provider.

#### Check for updates automatically

Select **auto SW update**, then set how often to check.

Your network service provider may send updates over the air directly to your phone. For more info on this network service, contact your network service provider.





### Restore original settings

If your phone is not working properly, you can reset some settings to their original values.

1. End all calls and connections.
2. Select **settings** and **restore factory sett. > settings only**.
3. Type in the security code.

This does not affect documents or files stored on your phone.

After restoring the original settings, your phone switches off and then on again. This may take longer than usual.



### Access codes

PIN or PIN2 code (4-8 digits)	These protect your SIM against unauthorised use or are required to access some features. You can set your phone to ask for the PIN code when you switch it on. If not supplied with your card or you forget the codes, contact your service provider. If you type in the code incorrectly three times in a row, you need to unblock the code with the PUK or PUK2 code.
PUK or PUK2 code (8 digits)	These are required to unblock a PIN or PIN2 code. If not supplied with your SIM, contact your service provider. See ➔ 8.
IMEI number (15 digits)	This is used to identify valid phones in the network. The number can also be used to block, for example, stolen phones. You may also need to give the number to Nokia Care services. To view your IMEI number, dial <b>*#06#</b> .
Lock code (security code) (min. 5 digits)	This helps you protect your phone against unauthorised use. You can set your phone to ask for the lock code that you define. The default lock code is 12345.



Keep the code secret and in a safe place, separate from your phone.

If you forget the code and your phone is locked, your phone will require service. Additional charges may apply, and all the personal data in your phone may be deleted.

For more information, contact Nokia Care or your phone dealer.



The personal unblocking key (PUK) code and the universal personal unblocking key (UPUK) code (8 digits) are required to change a blocked PIN code and UPIN code, respectively. The PUK2 code (8 digits) is required to change a blocked PIN2 code. These codes are not supplied with the SIM card. Contact your local service provider for the codes.



## Product and safety information

### Safety

Read these simple guidelines. Not following them may be dangerous or illegal. For further info, read the complete user guide.



#### SWITCH OFF IN RESTRICTED AREAS

Switch the device off when mobile phone use is not allowed or when it may cause interference or danger, for example, in aircraft, in hospitals or near medical equipment, fuel, chemicals, or blasting areas. Obey all instructions in restricted areas.



#### ROAD SAFETY COMES FIRST

Obey all local laws. Always keep your hands free to operate the vehicle while driving. Your first consideration while driving should be road safety.



#### INTERFERENCE

All wireless devices may be susceptible to interference, which could affect performance.



#### QUALIFIED SERVICE

Only qualified personnel may install or repair this product.



#### KEEP YOUR DEVICE DRY

Your device is not water-resistant. Keep it dry.



#### PROTECT YOUR HEARING

To prevent possible hearing damage, do not listen at high volume levels for long periods. Exercise caution when holding your device near your ear while the loudspeaker is in use.

#### Feature specific instructions

Remember to comply with any applicable safety requirements.

Use only compatible memory cards approved by Nokia for use with this device. Incompatible cards may damage the card and the device and corrupt data stored on the card.

**Important:** This device is designed to be used with a standard SIM card (see figure) only. Use of incompatible SIM cards may damage the card or the device, and may corrupt data stored on the card. Please consult your mobile operator for the use of a SIM card that has a mini-UICC cutout.



If you only have one SIM card, put the card into the SIM1 card holder. Some features and services may only be available when using the SIM card in the SIM1 card holder. If there is a SIM card only in the SIM2 card holder, you can only make emergency calls.

Both SIM cards are available at the same time when the device is not being used, but while one SIM card is active, for example, making a call, the other is unavailable.

➔ 1 If the battery has not been used for a long time, to begin charging, you may need to connect the charger, then unplug and reconnect it.

➔ 2 If the battery is completely discharged, it may take several minutes before the charging indicator is displayed or before any calls can be made.

Avoid touching the antenna area while the antenna is in use. Contact with antennas affects the communication quality and may reduce battery life due to higher power level during operation.

➔ 3 **Important:** Avoid scratching the touch screen. Never use an actual pen, pencil, or other sharp object on the touch screen.

To enter the + character, used for international calls, select \* twice.

This may not be possible in all regions. In this case, enter the international access code directly.

The + character may not work in all regions. In this case, enter the international access code directly.

**Warning:** When the flight profile is activated, you cannot make or receive any calls, including emergency calls, or use other features that require network coverage. To make a call, activate another profile.

Missed and received calls are logged only if supported by the network, and the phone is switched on and within the network service area.

You can only use speed dials for the contacts stored on your phone or on the SIM card in the internal SIM1 card holder.

Using services or downloading content may cause transfer of large







amounts of data, which may result in data traffic costs.

➔ 4 You can send text messages that are longer than the character limit for a single message. Longer messages are sent as two or more messages. Your service provider may charge accordingly.

Characters with accents, other marks, or some language options, take more space, limiting the number of characters that can be sent in a single message.

➔ 5 If the item you insert in a multimedia message is too large for the network, the device may automatically reduce the size.

➔ 6 Only compatible devices can receive and show multimedia messages. Messages may look different in different devices.

Sending a message with an attachment may be more expensive than sending a normal text message. For more information, contact your service provider.

Operating the device in hidden mode is a safer way to avoid malicious software. Do not accept Bluetooth connection requests from sources

you do not trust. You can also switch the Bluetooth function off when you are not using it.

➔ 7 You can only use Nokia Suite with the SIM card in the internal SIM card holder.

➔ 8 The personal unblocking key (PUK) code and the universal personal unblocking key (UPUK) code (8 digits) are required to change a blocked PIN code and UPIN code, respectively. The PUK2 code (8 digits) is required to change a blocked PIN2 code. These codes are not supplied with the SIM card. Contact your local service provider for the codes.

**Network services and costs**

Your device is approved for use on the EGSM 850 and 1900 MHz networks. To use the device, you need a subscription with a service provider.

Using network services and downloading content to your device requires a network connection and may result in data traffic costs. Some product features require support from the network, and you may need to subscribe to them.

**Take care of your device**

Handle your device, battery, charger and accessories with care. The



following suggestions help you protect your warranty coverage.

- Keep the device dry. Precipitation, humidity, and all types of liquids or moisture can contain minerals that corrode electronic circuits. If your device gets wet, remove the battery, and allow the device to dry.
- Do not use or store the device in dusty or dirty areas. Moving parts and electronic components can be damaged.
- Do not store the device in high temperatures. High temperatures can shorten the life of the device, damage the battery, and warp or melt plastics.
- Do not store the device in cold temperatures. When the device warms to its normal temperature, moisture can form inside the device and damage electronic circuits.
- Do not attempt to open the device other than as instructed in the user guide.
- Unauthorised modifications may damage the device and

violate regulations governing radio devices.

- Do not drop, knock, or shake the device. Rough handling can break internal circuit boards and mechanics.
- Only use a soft, clean, dry cloth to clean the surface of the device.
- Do not paint the device. Paint can clog moving parts and prevent proper operation.
- Switch off the device and remove the battery from time to time for optimum performance.
- Keep your device away from magnets or magnetic fields.
- To keep your important data safe, store it in at least two separate places, such as your device, memory card, or computer, or write down important information.

**Recycle**

Always return your used electronic products, batteries, and packaging materials to dedicated collection points. This way you help prevent uncontrolled waste disposal and promote the recycling of materials.





Check how to recycle your Nokia products at [www.nokia.com/recycling](http://www.nokia.com/recycling).

#### About Digital Rights Management

When using this device, obey all laws and respect local customs, privacy and legitimate rights of others, including copyrights. Copyright protection may prevent you from copying, modifying, or transferring pictures, music, and other content.

Content owners may use different types of digital rights management (DRM) technologies to protect their intellectual property, including copyrights. This device uses various types of DRM software to access DRM-protected content. With this device you can access content protected with OMA DRM 2.0. If certain DRM software fails to protect the content, content owners may ask that such DRM software's ability to access new DRM-protected content be revoked. Revocation may also prevent renewal of such DRM-protected content already in your device. Revocation of such DRM software does not affect the use of content protected with other types of

DRM or the use of non-DRM-protected content.

Digital rights management (DRM) protected content comes with an associated licence that defines your rights to use the content.

If your device has OMA DRM-protected content, to back up both the licences and the content, use the backup feature of Nokia Suite.

Other transfer methods may not transfer the licences which need to be restored with the content for you to be able to continue the use of OMA DRM-protected content after the device memory is formatted. You may also need to restore the licences if the files on your device become corrupted.

#### Tips and Offers

To help you take maximum advantage of your phone and services, you receive free customised text messages from Nokia. The messages contain tips and tricks and support.

To stop receiving the messages, select **settings > Nokia account > Tips and Offers**.

To provide the service described above, your mobile phone number,





the serial number of your phone, and some identifiers of the mobile subscription are sent to Nokia when you use the phone for the first time. Some or all information may also be sent to Nokia when updating software. This information may be used as specified in the privacy policy, available at [www.nokia.com](http://www.nokia.com).

**Batteries and chargers  
Battery and charger  
information**

Your device is intended for use with a BL-4U rechargeable battery. Nokia may make additional battery models available for this device. Always use original Nokia batteries.

This device is intended for use when supplied with power from the following chargers: AC-11. The exact Nokia charger model number may vary depending on the plug type, identified by E, X, AR, U, A, C, K, B, or N.

The battery can be charged and discharged hundreds of times, but it will eventually wear out. When the talk and standby times are noticeably shorter than normal, replace the battery.

**Battery safety**

Always switch the device off and disconnect the charger before removing the battery. When you unplug a charger or an accessory, hold and pull the plug, not the cord.

When your charger is not in use, unplug it from the electrical plug and the device. Do not leave a fully charged battery connected to a charger, as overcharging may shorten the battery's lifetime. If left unused, a fully charged battery will lose its charge over time.

Always keep the battery between 15°C and 25°C (59°F and 77°F). Extreme temperatures reduce the capacity and lifetime of the battery. A device with a hot or cold battery may not work temporarily.

Accidental short-circuiting can happen when a metallic object touches the metal strips on the battery, for example, if you carry a spare battery in your pocket. Short-circuiting may damage the battery or the connecting object.

Do not dispose of batteries in a fire as they may explode. Dispose of batteries according to local





regulations. Recycle when possible. Do not dispose as household waste.

Do not dismantle, cut, open, crush, bend, puncture, or shred cells or batteries. If a battery leaks, do not let battery liquid touch skin or eyes. If this happens, immediately flush the affected areas with water, or seek medical help.

Do not modify, remanufacture, attempt to insert foreign objects into the battery, or immerse or expose it to water or other liquids. Batteries may explode if damaged.

Use the battery and charger for their intended purposes only. Improper use, or use of unapproved batteries or incompatible chargers may present a risk of fire, explosion, or other hazard, and may invalidate any approval or warranty. If you believe the battery or charger is damaged, take it to a service centre for inspection before continuing to use it. Never use a damaged battery or charger. Only use the charger indoors.

**Additional safety information**  
**Make an emergency call**

1 Make sure the device is switched on.

2 Check for adequate signal strength. You may also need to do the following:

- Insert a SIM card.
- Deactivate call restrictions you have activated for your device, such as call barring, fixed dialling, or closed user group.
- Make sure the flight profile is not activated.
- If the device screen and keys are locked, unlock them.

3 Press the end key repeatedly, until the home screen is displayed.

4 To open the dialler, select **☎**.

5 Enter the official emergency number for your present location. Emergency call numbers vary by location.

6 Press the call key.

7 Give the necessary information as accurately as possible. Do not end the call until given permission to do so.

**Important:** Activate both cellular and internet calls, if your device supports internet calls. The device





may attempt to make emergency calls both through cellular networks and through your internet call service provider. Connections in all conditions cannot be guaranteed. Never rely solely on any wireless device for essential communications like medical emergencies.

#### **Small children**

Your device and its accessories are not toys. They may contain small parts. Keep them out of the reach of small children.

#### **Medical devices**

Operation of radio transmitting equipment, including wireless phones, may interfere with the function of inadequately protected medical devices. Consult a physician or the manufacturer of the medical device to determine whether they are adequately shielded from external radio frequency energy.

#### **Implanted medical devices**

Manufacturers of medical devices recommend a minimum separation of 15.3 centimetres (6 inches) between a wireless device and an implanted medical device, such as a pacemaker or implanted cardioverter defibrillator, to avoid potential interference with the medical device.

Persons who have such devices should:

- Always keep the wireless device more than 15.3 centimetres (6 inches) from the medical device.
- Not carry the wireless device in a breast pocket.
- Hold the wireless device to the ear opposite the medical device.
- Turn the wireless device off if there is any reason to suspect that interference is taking place.
- Follow the manufacturer directions for the implanted medical device.

If you have any questions about using your wireless device with an implanted medical device, consult your health care provider.

#### **Accessibility solutions**

Nokia is committed to making mobile phones easy to use for all individuals, including those with disabilities. For more information, visit the Nokia website at [www.nokiaaccessibility.com](http://www.nokiaaccessibility.com).





**Hearing**

**⚠ Warning:** When you use the headset, your ability to hear outside sounds may be affected. Do not use the headset where it can endanger your safety.

Some wireless devices may interfere with some hearing aids.

**Operating environment**

This device meets radio frequency exposure guidelines in the normal use position at the ear or at least 1.5 centimetres (5/8 inch) away from the body. Any carry case, belt clip, or holder for body-worn operation should not contain metal and should position the device the above-stated distance from your body.

To send data files or messages requires a quality connection to the network. Data files or messages may be delayed until such a connection is available. Follow the separation distance instructions until the transmission is completed.

**Vehicles**

Radio signals may affect improperly installed or inadequately shielded electronic systems in motor vehicles such as electronic fuel injection, electronic antilock braking, electronic

speed control, and air bag systems. For more info, check with the manufacturer of your vehicle or its equipment.

Only qualified personnel should install the device in a vehicle. Faulty installation or service may be dangerous and may invalidate your warranty. Check regularly that all wireless device equipment in your vehicle is mounted and operating properly. Do not store or carry flammable liquids, gases, or explosive materials in the same compartment as the device, its parts, or accessories. Remember that air bags inflate with great force. Do not place your device or accessories in the air bag deployment area.

**Potentially explosive environments**

Switch off your device in any area with a potentially explosive atmosphere, for example near gas pumps at service stations. Sparks in such areas could cause an explosion or fire resulting in bodily injury or death. Observe restrictions in fuel service stations, storage, and distribution areas; chemical plants; or where blasting operations are in progress. Areas with a potentially explosive atmosphere



are often, but not always, clearly marked. They include areas where you would be advised to turn off your vehicle engine, below deck on boats, chemical transfer or storage facilities and where the air contains chemicals or particles such as grain, dust, or metal powders. You should check with the manufacturers of vehicles using liquefied petroleum gas (such as propane or butane) to determine if this device can be safely used in their vicinity.

**Certification information (SAR)  
This mobile device meets guidelines  
for exposure to radio waves.**

Your mobile device is a radio transmitter and receiver. It is designed not to exceed the limits for exposure to radio waves recommended by international guidelines. These guidelines were developed by the independent scientific organisation ICNIRP and include safety margins designed to assure the protection of all persons, regardless of age and health.

The exposure guidelines for mobile devices employ a unit of measurement known as the Specific Absorption Rate or SAR. The SAR limit stated in the ICNIRP guidelines is 2.0

watts/kilogram (W/kg) averaged over 10 grams of tissue. Tests for SAR are conducted using standard operating positions with the device transmitting at its highest certified power level in all tested frequency bands. The actual SAR level of an operating device can be below the maximum value because the device is designed to use only the power required to reach the network. That amount changes depending on a number of factors such as how close you are to a network base station.

The highest SAR value under the ICNIRP guidelines for use of the device at the ear is 0.63 W/kg (RM-852).

Use of device accessories may result in different SAR values. SAR values may vary depending on national reporting and testing requirements and the network band. Additional SAR information may be provided under product information at [www.nokia.com](http://www.nokia.com).

Your mobile device is also designed to meet the requirements for exposure to radio waves established by the Federal Communications Commission (USA) and Industry Canada. These requirements set a SAR limit of 1.6 W/kg averaged over one gram of tissue. The highest SAR value reported under





this standard during product certification for use at the ear is 0.89 W/kg (RM-852) and when properly worn on the body is 0.80 W/kg (RM-852).

**Copyright and other notices**  
© 2012 Nokia. All rights reserved.

Nokia, and Nokia Connecting People are trademarks or registered trademarks of Nokia Corporation. Nokia tune is a sound mark of Nokia Corporation. Other product and company names mentioned herein may be trademarks or tradenames of their respective owners.

Reproduction, transfer, distribution, or storage of part or all of the contents in this document in any form without the prior written permission of Nokia is prohibited. Nokia operates a policy of continuous development. Nokia reserves the right to make changes and improvements to any of the products described in this document without prior notice.



Includes RSA BSAFE cryptographic or security protocol software from RSA Security.



**Java**  
POWERED Oracle and Java are registered trademarks of Oracle and/or its affiliates.

The Bluetooth word mark and logos are owned by the Bluetooth SIG, Inc. and any use of such marks by Nokia is under license.

This product is licensed under the MPEG-4 Visual Patent Portfolio License (i) for personal and noncommercial use in connection with information which has been encoded in compliance with the MPEG-4 Visual Standard by a consumer engaged in a personal and noncommercial activity and (ii) for use in connection with MPEG-4 video provided by a licensed video provider. No license is granted or shall be implied for any other use. Additional information, including that related to promotional, internal, and commercial uses, may be obtained from MPEG LA, LLC. See <http://www.mpegla.com>.

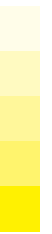



To the maximum extent permitted by applicable law, under no circumstances shall Nokia or any of its licensors be responsible for any loss of data or income or any special, incidental, consequential or indirect damages howsoever caused.

The contents of this document are provided "as is". Except as required by applicable law, no warranties of any kind, either express or implied, including, but not limited to, the implied warranties of merchantability and fitness for a particular purpose, are made in relation to the accuracy, reliability or contents of this document. Nokia reserves the right to revise this document or withdraw it at any time without prior notice.

The availability of products, features, applications and services may vary by region. For more information, contact your Nokia dealer or your service provider. This device may contain commodities, technology or software subject to export laws and regulations from the US and other countries. Diversion contrary to law is prohibited.

Nokia does not provide a warranty for or take any responsibility for the functionality, content, or end-user

support of third-party applications provided with your device. By using an application, you acknowledge that the application is provided as is. Nokia does not make any representations, provide a warranty, or take any responsibility for the functionality, content, or end-user support of third-party applications provided with your device.

**FCC/INDUSTRY CANADA NOTICE**

This device complies with part 15 of the FCC rules and Industry Canada licence-exempt RSS standard(s). Operation is subject to the following two conditions: (1) This device may not cause harmful interference, and (2) this device must accept any interference received, including interference that may cause undesired operation. Your device may cause TV or radio interference (for example, when using a device in close proximity to receiving equipment). If you require assistance, contact your local service facility. Any changes or modifications not expressly approved by Nokia could void the user's authority to operate this equipment.

555555 Issue 1 EN