

Nokia Nxx User Guide

555555
Issue 1

Cyan Magenta Yellow Black



Contents		Get connected	14
		Connect to the internet	14
		Create accounts	14
Safety	4	Update software	15
About your device	4	Kickstand	15
Network services	5	Stylus	15
Shared memory	5	Use accessories	16
Set up your device	6	Headset	16
Insert the SIM card and battery	6	Wrist strap	16
Insert the memory card	7	Control volume	16
Charge the battery	8	Lock touch screen and keys	16
Keys and parts	9	Further information	17
Keys and parts (front)	9	Visit maemo.nokia.com	17
Keys and parts (back)	10	Read the in-device user guide	17
Keys and parts (top)	10	Support	17
Keys and parts (sides)	10	Open source software notice	18
First start-up	11	Accessories	18
Switch the device on and off	11	Battery	18
Start-up wizard	11	Battery and charger information	18
Introduction to the desktop	11	Nokia battery authentication guidelines	19
About the desktop	11		
View the Get started tutorial	12		
Edit and personalise the desktop	13		
Transfer content from another device	13		
Synchronise and transfer content	13		
Import and merge contacts from a mobile device	13		

www.nokia.com/support

Taking care of your device	20
Recycle	20
Additional safety information	20
Small children	20
Operating environment	20
Medical devices	21
Vehicles	21
Potentially explosive environments	21
Emergency calls	21
Certification information (SAR)	22

www.nokia.com/support



Safety

Read these simple guidelines. Not following them may be dangerous or illegal. Read the complete user guide for further information.

SWITCH ON SAFELY



Do not switch the device on when wireless phone use is prohibited or when it may cause interference or danger.

ROAD SAFETY COMES FIRST



Obey all local laws. Always keep your hands free to operate the vehicle while driving. Your first consideration while driving should be road safety.

INTERFERENCE



All wireless devices may be susceptible to interference, which could affect performance.

SWITCH OFF IN RESTRICTED AREAS



Follow any restrictions. Switch the device off in aircraft, near medical equipment, fuel, chemicals, or blasting areas.

QUALIFIED SERVICE



Only qualified personnel may install or repair this product.

ACCESSORIES AND BATTERIES



Use only approved accessories and batteries. Do not connect incompatible products.

WATER-RESISTANCE



Your device is not water-resistant. Keep it dry.

About your device

The wireless device described in this guide is approved for use on the (E)GSM 850, 900, 1800,1900, and UMTS 900, 1700, 2100 networks. Contact your service provider for more information about networks.

Your device may have preinstalled bookmarks and links for third-party internet sites and may allow you to access third-party sites. These are not affiliated with Nokia, and Nokia does not endorse or assume liability for them. If you access such sites, take precautions for security or content.

Warning:
To use any features in this device, other than the alarm clock, the device must be switched on. Do not switch the device on when wireless device use may cause interference or danger.

When using this device, obey all laws and respect local customs, privacy and legitimate rights of others, including copyrights. Copyright protection may prevent some images,

www.nokia.com/support

music, and other content from being copied, modified, or transferred.

Make back-up copies or keep a written record of all important information stored in your device.

When connecting to any other device, read its user guide for detailed safety instructions. Do not connect incompatible products.

The images in this guide may differ from your device display.

Refer to the user guide for other important information about your device.

Network services

To use the device you must have service from a wireless service provider. Some features are not available on all networks; other features may require that you make specific arrangements with your service provider to use them. Network services involve transmission of data. Check with your service provider for details about fees in your home network and when roaming on other networks. Your service provider can explain what charges will apply. Some networks may have limitations that affect how you can use some features of this device requiring network support such as support for specific technologies like WAP 2.0 protocols (HTTP and SSL) that run on TCP/IP protocols and language-dependent characters.

Your service provider may have requested that certain features be disabled or not activated in your device. If so, these features will not appear on your device menu. Your

device may also have customized items such as menu names, menu order, and icons.

Shared memory

The following features in this device may share memory: bookmarks; image, audio, and video files; notes, sketch, and other files; contacts; e-mail messages; and applications. Use of one or more of these features may reduce the memory available for the remaining features. If your device displays a message that the memory is full, delete some of the information stored in the shared memory.

www.nokia.com/support



Set up your device

Insert the SIM card and battery

Safe removal. Always switch the device off and disconnect the charger before removing the battery.

Important: To prevent damage to the SIM card, always remove the battery before you insert or remove the card.

- 1 To prevent the battery from coming loose, place the device so that the back cover is facing up.
- 2 Place your finger in the grip, and lift the back cover up. You do not need to press any button to release the back cover.

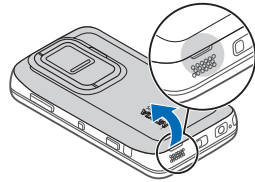

- 3 To release the SIM card holder, slide the holder to the right (1), and lift the left end of the holder up (2). Make sure that the bevelled corner on the card is facing up, and that the contact area on the card is facing the connectors on the device (3). Close the holder (4), and slide it to the left to lock it into place (5).

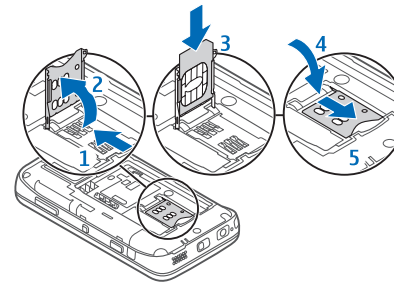

- 4 Align the contacts of the battery with the corresponding connectors on the battery compartment, and insert the battery in the direction of the arrow.

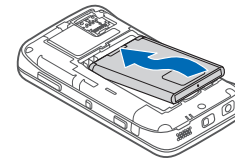

- 5 To replace the back cover, direct the locking catch toward its slot, and press down until the cover locks into place.

www.nokia.com/support

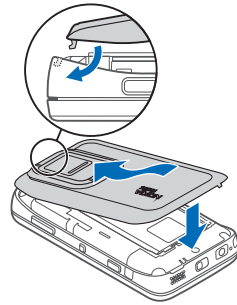

- 1 To prevent the battery from coming loose, place the device so that the back cover is facing up.
- 2 Place your finger in the grip, and lift the back cover up. You do not need to press any button to release the back cover.

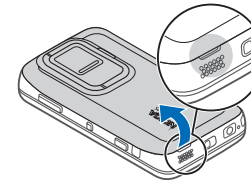

Insert the memory card



Use only compatible MicroSD cards approved by Nokia for use with this device. Nokia uses approved industry standards for memory cards, but some brands may not be fully compatible with this device. Incompatible cards may damage the card and the device and corrupt data stored on the card.

The memory card can be safely inserted or removed even when the device is switched on.

A memory card may be already inserted in the device. If not, do the following:

- 3 To release the memory card holder, slide the holder towards the battery (1), and lift up the end of the holder (2). Insert a compatible memory card into the holder (3). Make sure the contact area on the card is facing the connectors on the device. Close the holder (4), and slide it back to lock it into place (5).

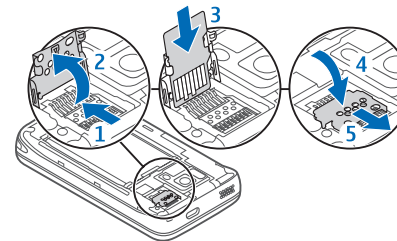

www.nokia.com/support

- 4 Replace the back cover. Keep the device facing down when replacing the cover. Make sure the cover is properly closed.

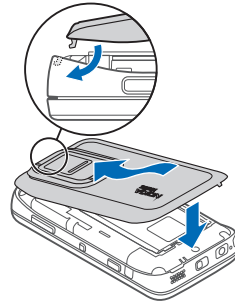

Charge the battery

Your battery has been partially charged at the factory. If the device indicates a low charge, do the following:

Charge the battery using the charger

- 1 Connect the charger to a wall outlet.

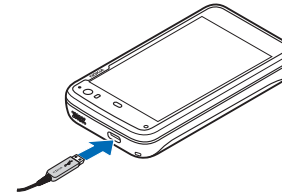

- 2 Connect the charger to the micro USB connector of the device.
- 3 When the device indicates a full charge, disconnect the charger from the device, then from the wall outlet.

The indicator light blinks when the device is charging. The indicator light stays lit when the battery is fully charged.

You do not need to charge the battery for a specific length of time, and you can use the device while it is charging. If the battery is completely discharged, it may take several minutes before the indicator light starts blinking or before any calls can be made.

Charge the battery using the USB cable

You can charge your device using a compatible USB device, for example a computer, when a wall outlet is not available. You can also transfer data while charging the device.

www.nokia.com/support

- 1 Connect a compatible USB cable between a compatible USB device and your device.
Depending on the type of device that is used for charging, it may take a while for charging to start.
- 2 If your device is switched on, USB mode options are displayed. Select ##usbh_menu_plugin_va_mass_storage## or ##usbh_menu_plugin_va_pc_suite## to make sure that your device receives enough power from USB charging.

The indicator light blinks when the device is charging. The indicator light stays lit when the battery is fully charged.

If the battery is completely discharged, allow some time for charging before using your device.

If your device is on and you have many applications running, the device can consume more power than it receives from USB charging. Close some of the applications and disconnect data connections, or use the charger that comes with the sales package.

Keys and parts

Keys and parts (front)

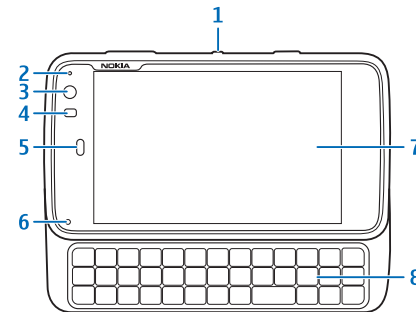

- 1 Power key
- 2 Light sensor
- 3 Secondary camera lens
- 4 Proximity sensor
- 5 Earpiece
- 6 Indicator light
- 7 Touch screen
- 8 Physical keyboard

To ensure proper functionality of the touch screen, remove the protective film from the device display.

Do not cover the area left of the touch screen with, for example, protective film or tape.

www.nokia.com/support

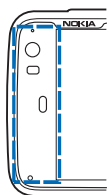

Keys and parts (back)

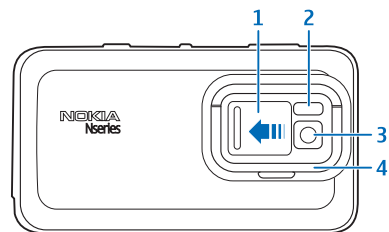

- 1 Lens cover
- 2 Camera flash
- 3 Camera lens
- 4 Kickstand

Keys and parts (top)

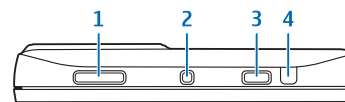

- 1 Zoom/Volume key
- 2 Power key
- 3 Capture key
- 4 Infrared port

None of the pre-installed applications of your device use the infrared port, but it enables the development of third party applications requiring an infrared port. The infrared port is not IrDA compatible.

Keys and parts (sides)

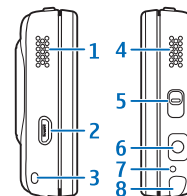

- 1 Stereo speaker
- 2 Micro USB connector
- 3 Wrist strap eyelet
- 4 Stereo speaker
- 5 Lock switch

www.nokia.com/support



- 6 Nokia AV Connector (3.5 mm)
- 7 Microphone
- 8 Stylus

First start-up

Switch the device on and off

Switch the device on

- 1 Press the power key.

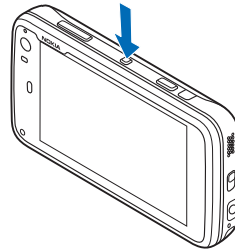

- 2 If the device asks for a PIN code or lock code, enter it, and select **Done**. The preset lock code is **12345**. If you forget the code and your device is locked, your device requires service for which additional charges may apply. For more information, contact a Nokia Care point or your device dealer.

Switch the device off

Press the power key, and select **Switch off!**.

Tip: You can also switch the device off by pressing and holding the power key.

Start-up wizard

- 1 Switch the device on. A welcome note is briefly displayed, and the start-up wizard opens.
- 2 The language, region, time and date settings are displayed. Define the following:

Language — Slide your finger up or down to scroll through the list, and select the language.

Region — Slide your finger up or down to scroll through the list and, select the region.

Time — Define the time format by moving the slider to **24 hrs** or **12 hrs**, and move the hands of the clock to the correct time with your finger. If you are using the 12-hour clock, move the slider to **AM** or **PM**.

Date — Set the current date. To do this, slide your finger up or down on the day, month, and year columns.

- 3 To accept and save the settings, select **Save**.

Introduction to the desktop

About the desktop

The desktop is displayed when you switch on the device. It offers quick access to different features of your device. You

www.nokia.com/support

can have up to four desktops. The desktops can be personalised to have different widgets, bookmarks, background images, and shortcuts to applications and contacts.

The desktop contains the following:

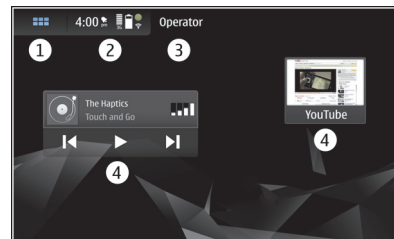

- 1 Application menu
- 2 Status area
- 3 Your network service provider (if a SIM card is inserted)
- 4 Widgets

Switch between desktops

Swipe left or right.

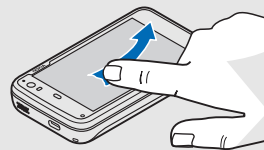

Search for contacts

Start entering a name, using the physical keyboard.

Open the virtual keypad to make a call

Start entering a phone number on the desktop, using the physical keyboard. To enter numbers, press and hold , and then the desired numbers.

View the Get started tutorial

To view an introductory tutorial on the key functions of your device, on the desktop, select **Get started**. The tutorial contains instructions on the following, for example:

- Switch between desktops
- Launch applications
- Switch between applications
- Cancel and go back to the desktop
- Use the status menu

www.nokia.com/support

Edit and personalise the desktop

Open the desktop menu

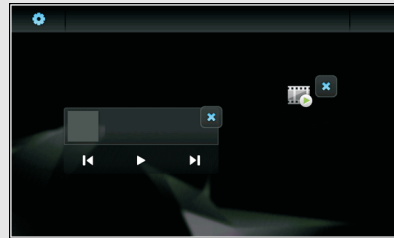



Tap the desktop, and select  > Desktop menu.

Use the menu to add items, such as shortcuts or widgets, to the desktop, to select active desktops, or to change the background image.

You can drag items to move them on the desktop or from one desktop to another.

Remove items from the desktop

You may want to remove an item, for example, the **Get started** tutorial, from the desktop. To do this, tap the desktop, and select , and  on the item you want to remove.

For more information on personalising the desktop, see the in-device user guide.

Transfer content from another device

Synchronise and transfer content

Select  > **Settings** > **Transfer & sync**.

You can use the Transfer & sync application to transfer and synchronise content such as contact information, events and tasks, or notes between compatible devices, like Nokia mobile devices. Synchronisation and data transfer can be done without an active network connection, using Bluetooth connectivity or a compatible USB data cable.

Import and merge contacts from a mobile device

You can import contact information from another device, IM accounts, SIM card, or from a compatible file. For example, you can transfer your contacts from your other mobile device. If your mobile device is not a Nokia device, you can save your contacts as VCF files and import the files to your device.

When you select  > **Contacts** for the first time, the device asks you if you want to synchronise your contacts. Follow the instructions.

If you have duplicate contacts, you can merge the contacts into one.

For more information on managing contacts, see the complete in-device user guide.

www.nokia.com/support

Get connected

Connect to the internet

It is recommended that you connect your device to the internet. An internet connection is needed, for example, to receive automatic software updates.

Your device can automatically switch between wireless LAN (WLAN) and packet data connections. When automatic switching is activated, the device first searches for a saved WLAN connection, and if none is available, the device switches to the packet data connection. You can also set the device to always ask you before switching to the packet data connection.

For more information on connecting to the internet, see the in-device user guide.

Use a WLAN connection

- 1 Tap the status area, and select **Internet connection**. The device scans for available connections, and displays them in the **Select connection** dialog.
- 2 Select a WLAN connection. You may need to enter your wired equivalent privacy (WEP) password or similar, depending on the security settings of the WLAN.

The WLAN connection is saved to the device. When you use an application that requires a network connection, the device uses a saved connection automatically, if one is available.

Tip: If a WLAN is hidden, it is indicated as hidden in the **Select connection** dialog. You can select a hidden WLAN as any

other WLAN connection, if you know the network name (SSID). See the in-device user guide for more information on hidden WLANs.

Use a packet data connection

Packet data settings are usually set automatically by the device, based on your SIM card. If you need to modify the settings, contact your service provider for details.

- 1 Tap the status area, and select **Internet connection**.
- 2 Select the packet data connection provided by your network service provider.
- 3 If you are using a packet data connection for the first time, you are prompted to confirm you want to allow your device to automatically switch to a packet data connection, when a saved WLAN connection is not available. To allow automatic switching to a packet data connection, select **Yes**, or if you want to be prompted when a packet data connection is needed, select **No**.

Create accounts

To use certain network services, you must have an active network connection and an account with the network service provider. You can create new and set up existing accounts for the following:

- Mail
- Instant messaging
- Internet call
- Sharing

See the in-device user guide for more information.

www.nokia.com/support

Update software

Your device supports Maemo Update, which allows updating the software and applications over a WLAN or packet data connection. When you are connected to the internet, you may receive update notifications from Maemo Update. New updates are indicated by the  icon in the status area.

When new software updates are available for the operating system or for Nokia or third party applications, or when there are additional applications available for your device, it is recommended that you install software updates, as they may contain important bug fixes and other updates. If you dismiss the suggested updates, you can later install them from the Application Manager.

See the in-device user guide for more information on updating software and installing additional applications.

You can also use Nokia Software Updater to update your software.

Kickstand

The kickstand is on the back of the device, and when placed on a flat surface, can be used when you watch, for example, video clips, or photos.

Open the kickstand

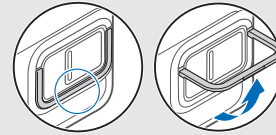

Stylus

Some functions, such as sketching, may be easier to use with a stylus than with your finger.

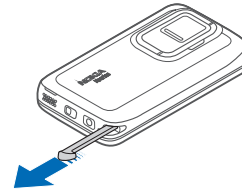

Important: Use only a stylus approved by Nokia for use with this device. Using any other stylus may invalidate any warranty applying to the device and may damage the touch screen. Avoid scratching the touch screen. Never use an actual pen or pencil or other sharp objects to write on the touch screen.



Use accessories

Headset

You can connect a compatible headset or compatible headphones to your device. Nokia headsets with music controls can also be used, but the device does not support the music controls.

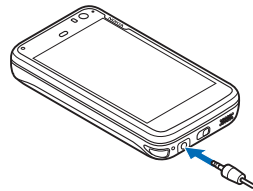

Warning:
When you use the headset, your ability to hear outside sounds may be affected. Do not use the headset where it can endanger your safety.

Do not connect products that create an output signal as this may cause damage to the device. Do not connect any voltage source to the Nokia AV Connector.

When connecting any external device or any headset, other than those approved by Nokia for use with this device, to the Nokia AV Connector, pay special attention to volume levels.

Wrist strap

- 1 Remove the back cover.

- 2 Hook a strap behind the clamp and close the back cover.

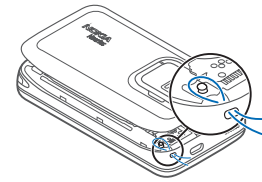

Control volume

Adjust the volume
Use the volume keys.

Mute sounds
Drag the volume slider in the status menu all the way to the left.

To adjust the call and message tone volumes, select  > **Settings** and **Profiles**.

Lock touch screen and keys

Locking the touch screen and keys prevents accidental keypresses.

To lock or unlock the touch screen and keys, slide the lock switch.

www.nokia.com/support



Further information

Visit maemo.nokia.com

You can find the latest tools, background images, and applications to personalise your device, and view the Maemo experience at maemo.nokia.com. To access this web site, select the Maemo shortcut on the desktop or the Maemo bookmark in the web browser.

Read the in-device user guide

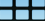
- 1 Select  > **Applications** > **File manager and Documents** > **User guides**.
- 2 Select the index file of your preferred language.

The in-device user guide opens in the web browser.

Tip: You can add a shortcut to the user guide to the desktop, to make it easier to access the guide later. To do this, open the user guide, and select  from the toolbar, and **Add shortcut to home**.

Support

When you want to learn more about how to use your product or you are unsure how your device should function, see the user guide or see the support pages at www.nokia.com/support or your local Nokia website.

If this does not resolve your issue, do the following:

- Restart the device: switch off the device, and remove the battery. After about a minute, replace the battery, and switch on the device.

- Restore the original factory settings as explained in the user guide.
- Update your device software regularly for optimum performance and possible new features, as explained in the user guide.

If the issue remains unsolved, contact Nokia for repair options. See www.nokia.com/repair, or in Latin America, www.nokia-latinoamerica.com/centrosdeservicio. Before sending your device for repair, always back up the data in your device.

www.nokia.com/support



Open source software notice

This product includes certain free/open source software.

The exact terms of the licenses, disclaimers, acknowledgements and notices are provided to you in the product. You may obtain the source code of the relevant free and open source software at <http://www.maemo.org/>. Alternatively, Nokia offers to provide such source code to you on a CD-ROM for a charge covering the cost of performing such distribution, such as the cost of media, shipping and handling, upon written request to Nokia at:

Maemo Source Code Requests

Nokia Corporation

P.O.Box 407

FI-00045 Nokia Group

Finland

This offer is valid for a period of three (3) years from the date of the distribution of this product by Nokia.

This software is based in part on the work of the Independent JPEG Group.

The Graphics Interchange Format® is the Copyright property of CompuServe Incorporated. GIF(sm) is a Service Mark property of CompuServe Incorporated.

Adobe® Flash® Player. Copyright (c) 1996 - 2007 Adobe Systems Incorporated. All Rights Reserved. Protected by U.S. Patent 6,879,327; Patents Pending in the United States and other countries. Adobe and Flash are either trademarks or registered trademarks in the United States and/or other countries.

This product includes software developed by following copyright holders:

- Computing Services at Carnegie Mellon University (<http://www.cmu.edu/computing/>)
- Tommi Komulainen (Tommi.Komulainen@iki.fi)
- The OpenSSL Project for use in the OpenSSL Toolkit (<http://www.openssl.org>)
- Pedro Roque Marques

- Eric Rosenquist, Srata Software Limited
- The XFree86 Project, Inc (<http://www.xfree86.org>) and its contributors
- Paul mackerras (paulus@samba.org)
- Purdue Research Foundation
- OpenEvidence Project for use in the OpenEvidence Toolkit (<http://www.openevidence.org/>)
- Eric Young (eay@cryptsoft.com)
- Tim Hudson (tjh@cryptsoft.com)

Copyright (c) 1996 NVIDIA, Corp. NVIDIA design patents pending in the U.S. and foreign countries.

NVIDIA, CORP. MAKES NO REPRESENTATION ABOUT THE SUITABILITY OF THIS SOURCE CODE FOR ANY PURPOSE. IT IS PROVIDED "AS IS" WITHOUT EXPRESS OR IMPLIED WARRANTY OF ANY KIND. NVIDIA, CORP. DISCLAIMS ALL WARRANTIES WITH REGARD TO THIS SOURCE CODE, INCLUDING ALL IMPLIED WARRANTIES OF MERCHANTABILITY AND FITNESS FOR A PARTICULAR PURPOSE. IN NO EVENT SHALL NVIDIA, CORP. BE LIABLE FOR ANY SPECIAL, INDIRECT, INCIDENTAL, OR CONSEQUENTIAL DAMAGES, OR ANY DAMAGES WHATSOEVER RESULTING FROM LOSS OF USE, DATA OR PROFITS, WHETHER IN AN ACTION OF CONTRACT, NEGLIGENCE OR OTHER TORTIOUS ACTION, ARISING OUT OF OR IN CONNECTION WITH THE USE OR PERFORMANCE OF THIS SOURCE CODE.

Accessories

Warning:

Use only batteries, chargers, and accessories approved by Nokia for use with this particular model. The use of any other types may invalidate any approval or warranty, and may be dangerous. In particular, use of unapproved chargers or batteries may present a risk of fire, explosion, leakage, or other hazard.

For availability of approved accessories, please check with your dealer. When you disconnect the power cord of any accessory, grasp and pull the plug, not the cord.

Battery

Battery and charger information

Your device is powered by a rechargeable battery. The battery intended for use with this device is BL-5J. Nokia may make additional battery models available for this device. This device is intended for use when supplied with power from the following chargers:

www.nokia.com/support

AC-10. The exact charger model number may vary depending on the type of plug. The plug variant is identified by one of the following: E, EB, X, AR, U, A, C, K, or UB.

The battery can be charged and discharged hundreds of times, but it will eventually wear out. When the talk and standby times are noticeably shorter than normal, replace the battery. Use only Nokia approved batteries, and recharge your battery only with Nokia approved chargers designated for this device.

If a battery is being used for the first time or if the battery has not been used for a prolonged period, it may be necessary to connect the charger, then disconnect and reconnect it to begin charging the battery. If the battery is completely discharged, it may take several minutes before the charging indicator appears on the display or before any calls can be made.

Safe removal. Always switch the device off and disconnect the charger before removing the battery.

Proper charging. Unplug the charger from the electrical plug and the device when not in use. Do not leave a fully charged battery connected to a charger, since overcharging may shorten its lifetime. If left unused, a fully charged battery will lose its charge over time.

Avoid extreme temperatures. Always try to keep the battery between 15°C and 25°C (59°F and 77°F). Extreme temperatures reduce the capacity and lifetime of the battery. A device with a hot or cold battery may not work temporarily. Battery performance is particularly limited in temperatures well below freezing.

Do not short-circuit. Accidental short-circuiting can occur when a metallic object such as a coin, clip, or pen causes direct connection of the positive (+) and negative (-) terminals of the battery. (These look like metal strips on the battery.) This might happen, for example, when you carry a spare battery in your pocket or purse. Short-circuiting the terminals may damage the battery or the connecting object.

Disposal. Do not dispose of batteries in a fire as they may explode. Dispose of batteries according to local regulations. Please recycle when possible. Do not dispose as household waste.

Leak. Do not dismantle, cut, open, crush, bend, puncture, or shred cells or batteries. In the event of a battery leak, prevent battery liquid contact with skin or eyes. If this happens, flush the affected areas immediately with water, or seek medical help.

Damage. Do not modify, remanufacture, attempt to insert foreign objects into the battery, or immerse or expose it to water or other liquids. Batteries may explode if damaged.

Correct use. Use the battery only for its intended purpose. Improper battery use may result in a fire, explosion, or other hazard. If the device or battery is dropped, especially on a hard surface, and you believe the battery has been damaged, take it to a service centre for inspection before continuing to use it. Never use any charger or battery that is damaged. Keep your battery out of the reach of small children.

Nokia battery authentication guidelines

Always use original Nokia batteries for your safety. To check that you are getting an original Nokia battery, purchase it from a Nokia authorised service centre or dealer, and inspect the hologram label using the following steps:

Authenticate hologram

- 1 When you look at the hologram on the label, you should see the Nokia connecting hands symbol from one angle and the Nokia Original Enhancements logo when looking from another angle.

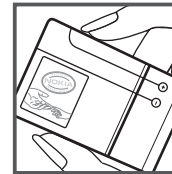

www.nokia.com/support

- 2 When you angle the hologram left, right, down and up, you should see 1, 2, 3 and 4 dots on each side respectively.

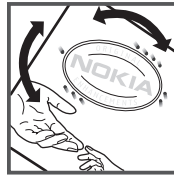

Successful completion of the steps is not a total assurance of the authenticity of the battery. If you cannot confirm authenticity or if you have any reason to believe that your Nokia battery with the hologram on the label is not an authentic Nokia battery, you should refrain from using it, and take it to the nearest Nokia authorised service centre or dealer for assistance.

For additional information, refer to the warranty and reference leaflet included with your Nokia device.

Taking care of your device

Your device is a product of superior design and craftsmanship and should be treated with care. The following suggestions will help you protect your warranty coverage.

- Do not use or store the device in dusty, dirty areas. Its moving parts and electronic components can be damaged.
- Do not store the device in high or cold temperature. High temperatures can shorten the life of electronic devices, damage batteries, and warp or melt certain plastics. When the device warms to its normal temperature from a cold temperature, moisture can form inside the device and damage electronic circuit boards.
- Do not attempt to open the device other than as instructed in this guide.
- Do not drop, knock, or shake the device. Rough handling can break internal circuit boards and fine mechanics.
- Do not use harsh chemicals, cleaning solvents, or strong detergents to clean the device. Only use a soft, clean, dry cloth to clean the surface of the device.

- Do not paint the device. Paint can clog the moving parts and prevent proper operation.
- Use only the supplied or an approved replacement antenna. Unauthorised antennas, modifications, or attachments could damage the device and may violate regulations governing radio devices.
- Use chargers indoors.
- Backup all data you want to keep, such as contacts and calendar notes.
- To reset the device from time to time for optimum performance, power off the device and remove the battery.

These suggestions apply equally to your device, battery, charger, or any accessory.

Recycle

Always return your used electronic products, batteries, and packaging materials to dedicated collection points. This way you help prevent uncontrolled waste disposal and promote the recycling of materials. Check product environmental information and how to recycle your Nokia products at www.nokia.com/werecycle, or nokia.mobi/werecycle.

Additional safety information

Small children

Your device and its accessories are not toys. They may contain small parts. Keep them out of the reach of small children.

Operating environment

This device meets RF exposure guidelines in the normal use position at the ear or at least 2.2 centimetre (7/8 inch) away from the body. Any carry case, belt clip, or holder for body-worn operation should not contain metal and should position the device the above-stated distance from your body.

To send data files or messages requires a quality connection to the network. Data files or messages may be delayed until such a connection is available. Follow the separation distance instructions until the transmission is completed.

Parts of the device are magnetic. Metallic materials may be attracted to the device. Do not place credit cards or other magnetic storage media near the device, because information stored on them may be erased.

www.nokia.com/support

Medical devices

Operation of radio transmitting equipment, including wireless phones, may interfere with the function of inadequately protected medical devices. Consult a physician or the manufacturer of the medical device to determine whether they are adequately shielded from external RF energy. Switch off your device when regulations posted instruct you to do so. Hospitals or health care facilities may use equipment sensitive to external RF energy.

Implanted medical devices

Manufacturers of medical devices recommend a minimum separation of 15.3 centimetres (6 inches) between a wireless device and an implanted medical device, such as a pacemaker or implanted cardioverter defibrillator, to avoid potential interference with the medical device. Persons who have such devices should:

- Always keep the wireless device more than 15.3 centimetres (6 inches) from the medical device.
- Not carry the wireless device in a breast pocket.
- Hold the wireless device to the ear opposite the medical device.
- Turn the wireless device off if there is any reason to suspect that interference is taking place.
- Follow the manufacturer directions for the implanted medical device.

If you have any questions about using your wireless device with an implanted medical device, consult your health care provider.

Hearing aids

Some digital wireless devices may interfere with some hearing aids.

Your mobile device model complies with FCC rules governing hearing aid compatibility. These require a M3 microphone or higher value. Your device M-value is shown on the box. A higher M-value generally indicates that a device model has a lower RF emissions level, which may improve the likelihood that the device will operate with certain hearing aids. Some hearing aids are more immune than others to interference. Please consult your hearing health professional to determine whether your hearing aid will work with this device. More information on accessibility can be found at www.nokiaaccessibility.com.

Vehicles

RF signals may affect improperly installed or inadequately shielded electronic systems in motor vehicles such as electronic fuel injection, electronic antilock braking, electronic

speed control, and air bag systems. For more information, check with the manufacturer of your vehicle or its equipment.

Only qualified personnel should service the device or install the device in a vehicle. Faulty installation or service may be dangerous and may invalidate your warranty. Check regularly that all wireless device equipment in your vehicle is mounted and operating properly. Do not store or carry flammable liquids, gases, or explosive materials in the same compartment as the device, its parts, or accessories. Remember that air bags inflate with great force. Do not place your device or accessories in the air bag deployment area.

Switch off your device before boarding an aircraft. The use of wireless teledevices in an aircraft may be dangerous to the operation of the aircraft and may be illegal.

Potentially explosive environments

Switch off your device in any area with a potentially explosive atmosphere. Obey all posted instructions. Sparks in such areas could cause an explosion or fire resulting in bodily injury or death. Switch off the device at refuelling points such as near gas pumps at service stations. Observe restrictions in fuel depots, storage, and distribution areas; chemical plants; or where blasting operations are in progress. Areas with a potentially explosive atmosphere are often, but not always, clearly marked. They include areas where you would be advised to turn off your vehicle engine, below deck on boats, chemical transfer or storage facilities and where the air contains chemicals or particles such as grain, dust, or metal powders. You should check with the manufacturers of vehicles using liquefied petroleum gas (such as propane or butane) to determine if this device can be safely used in their vicinity.

The surface of this device is nickel-free.



Emergency calls

Before making an emergency call, switch the device on, and check for adequate signal strength. If the screen and keys are locked, slide the lock switch on the side of the device to unlock them.



Important: This device operates using radio signals, wireless networks, landline networks, and user-programmed functions. Emergency calls can be made using the cellular phone. It is not possible to make an emergency call using voice calls over the internet (internet calls). Connections in all conditions cannot be guaranteed. You should never rely solely on any wireless device for essential communications like medical emergencies.

www.nokia.com/support

Make an emergency call

- 1 Select  > **Phone**.
- 2 Select  and the cellular call type.
- 3 Enter the official emergency number for your present location.
- 4 Select  to start the call.

Make an emergency call without entering PIN, PUK, or lock code

- 1 When the device asks for the code, enter the emergency number for your present location. The  Emergency call icon appears.
- 2 Select  Emergency call to make the call. After the emergency call, you need to enter the required PIN, PUK, or lock code to be able to use other device functions.

When making an emergency call, give all the necessary information as accurately as possible. Your wireless device may be the only means of communication at the scene of an accident. Do not end the call until given permission to do so.

Certification information (SAR)

This mobile device meets guidelines for exposure to radio waves.

Your mobile device is a radio transmitter and receiver. It is designed not to exceed the limits for exposure to radio waves recommended by international guidelines. These guidelines were developed by the independent scientific organisation ICNIRP and include safety margins designed to assure the protection of all persons, regardless of age and health.

The exposure guidelines for mobile devices employ a unit of measurement known as the Specific Absorption Rate or SAR. The SAR limit stated in the ICNIRP guidelines is 2.0 watts/kilogram (W/kg) averaged over 10 grams of tissue. Tests for SAR are conducted using standard operating positions with the device transmitting at its highest certified power level in all tested frequency bands. The actual SAR level of an operating device can be below the maximum value because the device is designed to use only the power required to reach the network. That amount changes depending on a number of factors such as how close you are to a network base station.

The highest SAR value under the ICNIRP guidelines for use of the device at the ear is 0.80 W/kg.

Use of device accessories may result in different SAR values. SAR values may vary depending on national reporting and testing requirements and the network band. Additional SAR information may be provided under product information at www.nokia.com.

Your mobile device is also designed to meet the requirements for exposure to radio waves established by the Federal Communications Commission (USA) and Industry Canada. These requirements set a SAR limit of 1.6 W/kg averaged over one gram of tissue. The highest SAR value reported under this standard during product certification for use at the ear is 0.92 W/kg and when properly worn on the body is 0.82 W/kg.

www.nokia.com/support

DECLARATION OF CONFORMITY

CE0434 ⓘ

Hereby, NOKIA CORPORATION declares that this RX-51 product is in compliance with the essential requirements and other relevant provisions of Directive 1999/5/EC. A copy of the Declaration of Conformity can be found at www.nokia.com/phones/declaration_of_conformity/.

Nokia, Nokia Connecting People, Nseries and Nxx are trademarks or registered trademarks of Nokia Corporation. Nokia tune is a sound mark of Nokia Corporation. Other product and company names mentioned herein may be trademarks or tradenames of their respective owners.

Reproduction, transfer, distribution, or storage of part or all of the contents in this document in any form without the prior written permission of Nokia is prohibited. Nokia operates a policy of continuous development. Nokia reserves the right to make changes and improvements to any of the products described in this document without prior notice.

Portions of the Nokia Maps software are ©1996-2009 The FreeType Project. All rights reserved.

This product is licensed under the MPEG-4 Visual Patent Portfolio License (i) for personal and noncommercial use in connection with information which has been encoded in compliance with the MPEG-4 Visual Standard by a consumer engaged in a personal and noncommercial activity and (ii) for use in connection with MPEG-4 video provided by a licensed video provider. No license is granted or shall be implied for any other use. Additional information, including that related to promotional, internal, and commercial uses, may be obtained from MPEG LA, LLC. See <http://www.mpegla.com>.

TO THE MAXIMUM EXTENT PERMITTED BY APPLICABLE LAW, UNDER NO CIRCUMSTANCES SHALL NOKIA OR ANY OF ITS LICENSORS BE RESPONSIBLE FOR ANY LOSS OF DATA OR INCOME OR ANY SPECIAL, INCIDENTAL, CONSEQUENTIAL OR INDIRECT DAMAGES HOWSOEVER CAUSED.

THE CONTENTS OF THIS DOCUMENT ARE PROVIDED "AS IS". EXCEPT AS REQUIRED BY APPLICABLE LAW, NO WARRANTIES OF ANY KIND, EITHER EXPRESS OR IMPLIED, INCLUDING, BUT NOT LIMITED TO, THE IMPLIED WARRANTIES OF MERCHANTABILITY AND FITNESS FOR A PARTICULAR PURPOSE, ARE MADE IN RELATION TO THE ACCURACY, RELIABILITY OR CONTENTS

OF THIS DOCUMENT. NOKIA RESERVES THE RIGHT TO REVISE THIS DOCUMENT OR WITHDRAW IT AT ANY TIME WITHOUT PRIOR NOTICE.

Reverse engineering of software in the device is prohibited to the extent permitted by applicable law. Insofar as this user guide contains any limitations on Nokia's representations, warranties, damages and liabilities, such limitations shall likewise limit any representations, warranties, damages and liabilities of Nokia's licensors. The availability of particular products and applications and services for these products may vary by region. Please check with your Nokia dealer for details and availability of language options. This device may contain commodities, technology or software subject to export laws and regulations from the US and other countries. Diversion contrary to law is prohibited.

FCC/INDUSTRY CANADA NOTICE

Your device may cause TV or radio interference (for example, when using a telephone in close proximity to receiving equipment). The FCC or Industry Canada can require you to stop using your telephone if such interference cannot be eliminated. If you require assistance, contact your local service facility. This device complies with part 15 of the FCC rules. Operation is subject to the following two conditions: (1) This device may not cause harmful interference, and (2) this device must accept any interference received, including interference that may cause undesired operation. Any changes or modifications not expressly approved by Nokia could void the user's authority to operate this equipment.

555555/Issue 1 EN

