User Guide

Nokia Treasure Tag (WS-2)

NOKIA

Get started

Learn how to start using your proximity sensor.

About your proximity sensor

Nokia Treasure Tag (WS-2) is a proximity sensor which helps you easily find your misplaced valuables.

Slip the sensor in your bag, or use the strap to attach it to your keys. If you leave your items behind, your phone notifies you. If you do lose your stuff, you can check on a map where to start looking.

You get the best experience when using the sensor with a Nokia Lumia phone with Windows Phone 8. The proximity sensor is compatible with Windows Phone 8 phones with the Nokia Treasure Tag app (available in both Nokia Store and Windows Phone Store) and Bluetooth 4.0 or higher. A full list of compatible devices can be seen at Windows Phone Store.

Read this user guide carefully before using the product. Also, read the user guide for the device that you connect to the product.

Keys and parts

Get to know your proximity sensor.

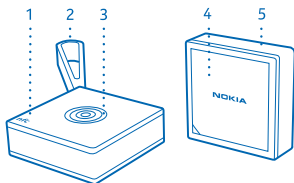

- 1 NFC area
- 2 Silicone strap with loop
- 3 Multifunction key
- 4 Battery cover
- 5 Silicone strap without loop

The surface of this product is nickel-free.

Switch your sensor on or off

You can switch your sensor on or off.

Your sensor is switched on automatically once the battery is inserted.

To switch your sensor off or back on again, press the multifunction key for 3 seconds.

To switch your sensor off, you can also remove the battery.

Change the strap

Your sensor comes with two silicone straps: one with a loop for attaching, one without.

1. Pull the strap from the sensor. You can use a paperclip or similar tool to carefully pry the edge of the strap from the groove.
2. Place the sensor in the other strap and carefully stretch and pull the strap into place.

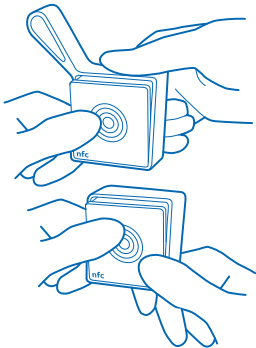

Pair and connect

Before you can use your sensor, you need to pair and connect it to your phone.

You can connect your sensor to your phone using either NFC or Bluetooth. Make sure your sensor is switched on.

Your sensor can be connected to one phone at a time. To locate the phone previously connected to your sensor, press the multifunction key. If you want to connect it to another phone, restore the factory settings first.

You can disconnect your sensor from your phone. For more info, see your phone's user guide.

Pair your sensor using NFC

Pair your sensor with your phone quickly using NFC.

1. Make sure you've switched on NFC on your phone.

For more info on NFC, see your phone's user guide.

2. Touch the NFC areas of your sensor and phone together.

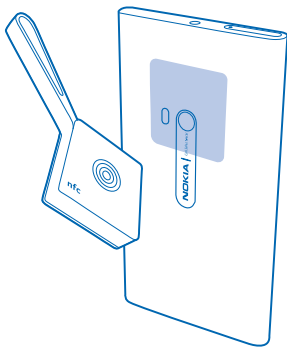

3. Follow the instructions shown on your phone.

Pair your sensor using Bluetooth

If your phone doesn't have NFC, you can pair your sensor with your phone using Bluetooth.

You need the Nokia Treasure Tag app to use the sensor. You can download the app from Nokia Store or Windows Phone Store.

1. Make sure you've switched on Bluetooth on your phone.

For more info on Bluetooth, see your phone's user guide.

2. On your phone, tap **Nokia Treasure Tag**.
3. Select your sensor, and follow the instructions shown on the phone.

Basic use

Learn the basics of using your proximity sensor.

Set up your sensor

Define how and when your sensor alerts you.

On your phone, tap **Nokia Treasure Tag**.

1. When pairing for the first time, the setup starts automatically. Otherwise, on your phone, tap **Set up** under your sensor.

2. To choose an icon for your sensor, tap **add sensor icon** and the icon you want.

★ **Tip:** Want to make your sensor uniquely yours? To add a custom icon, tap +, and either select a photo already on your phone, or use the camera on your phone to take one. If needed, you can crop the image smaller. You can have one custom icon in the app.

3. To give your sensor a name, tap **SENSOR NAME**, and type in the name.

4. Choose either **sensitive** or **normal** to set the distance after which the sensor starts to alert.

5. Select how and where the alert is played, and tap ☺.

★ **Tip:** If you want to test how your alert works, tap **try alerts**.

Whenever the distance between your sensor and phone exceeds the limit you set, you get the alerts you selected, even if your phone is in silent mode. Your phone also shows you a notification about which sensor was triggered.

The alerts are also triggered if the Bluetooth connection to the sensor is lost, or the signal is weak. A closed door, for example, may trigger an alert.

Manage your sensor

Check what's going on with your sensor and change its settings. You can also pin your sensor to the start screen of your phone to access it quickly.

Tap **Nokia Treasure Tag**.

1. Tap the sensor you want to view. You can see how far away the sensor is, and if it connects to your phone.

2. If you have several sensors, to check which is which, tap ☺.

Add a sensor to the sensor list

Tap ●●● > **add sensor**.



Edit sensor settings

Select a sensor, and tap ●●● > **edit sensor**.

Pin your sensor on the start screen of your phone

Tap ●●● > **pin to start**. You can also tap and hold the sensor in the sensor list, and select **pin to start**.

Disconnect your sensor manually

Tap . The sensor graphic turns grey. To reconnect, tap , or tap the NFC areas of the sensor and your phone together.

Remove a sensor

Tap  > **remove sensor**.

Find your sensor

Lost your sensor and have no idea where it is? You can start off your search by checking on a map where your phone lost connection with the sensor.

To check on a map where the connection was lost, GPS coordinates must be available.

Using services or downloading content may cause the transfer of large amounts of data, which may result in data costs.

1. Make sure you've switched on GPS on your phone.
2. Tap **Nokia Treasure Tag** and the sensor you want.
3. Wait while your phone tries to search for the sensor.
4. If your phone doesn't find the sensor, tap **open map**. The approximate area where your phone last connected to the sensor is shown on the map.

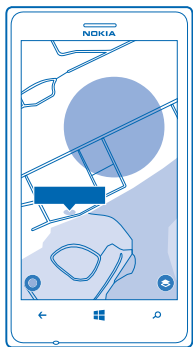

Change the view

To change between map and the LiveSight view, tap  or .

The LiveSight view gives only rough guidance while you're indoors. To get the most accurate position of your sensor, go outside where GPS is available.

Get directions to your sensor

To get route instructions, in the HERE maps view, tap the address notification and **directions to here** or **directions from here**.

Find connected sensor

On your phone, tap the sensor to play a notification sound. To silence the sensor once found, press the multifunction key on the sensor, or tap  on your phone.

Find your phone using your sensor

Can't remember where you put your phone? Use your sensor to locate it.

1. Press the multifunction key. Your phone plays a notification sound to help you locate it, even if your phone is in silent mode.

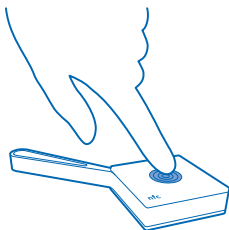

- ★ **Tip:** The sensor plays two notification sounds: one when the phone is within, one when it's outside the set range of the sensor.

2. When you find your phone, tap the notification on your phone to switch off the notification sound.

Change the battery

Your sensor comes with a battery already inserted, but eventually you need to change it.

Your sensor uses a standard CR2032 battery, and can be used for up to 6 months.

When its battery runs low, your sensor plays an alert tone, and a notification shows up on your phone's Nokia Treasure Tag app. If you've pinned your sensor to the start screen of your phone, a battery icon shows up on the tile.

1. Put a paperclip or similar tool into the gap in the lower left corner on the back of the sensor.

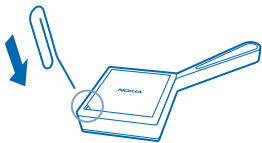

2. Carefully lever the back cover up.
3. Replace the old battery with a new one. Make sure you place the battery in the right way.
4. Align the battery connectors on the back cover and device, and snap the cover back into place.

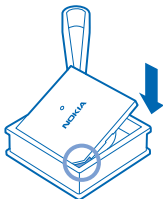

Restore factory settings

You can clear all pairings and reset the sensor back to the original settings.

1. Open the back cover and remove the battery from the sensor.
2. Replace the battery while pressing the multifunction key.

You can also remove your sensor from the connected phone or other device to restore the factory settings.

After restoring the factory settings, the sensor immediately pairs with any phone that has the sensor on its list of paired devices. If you remove the sensor from the list, the sensor disconnects from this phone and restores the factory settings again.

Help and support

When you want to learn more about your device, or if you're unsure how your device should work, there are several support channels for you to check.



To help you get the most out of your device, you can explore www.nokia.com/support.

There you can find:

- Troubleshooting info
- Discussions
- News on apps and downloads
- Further details about features and technologies, and the compatibility of devices and accessories

Troubleshooting and discussions may not be available in all languages.

Product and safety information

Take care of your device

- Keep the device dry. Precipitation, humidity, and all types of liquids or moisture can contain minerals that corrode electronic circuits. If your device gets wet, remove the battery, and let the device dry.
- Do not use or store the device in dusty or dirty areas.
- Do not store the device in high temperatures.
- Do not store the device in cold temperatures. When the device warms to its normal temperature, moisture can form inside the device and damage it.
- Do not open the device.
- Unauthorised modifications may damage the device and violate regulations governing radio devices.
- Do not drop, knock, or shake the device. Rough handling can break it.
- Only use a soft, clean, dry cloth to clean the surface of the device.
- For optimal performance, switch the device off and remove the battery from time to time.

Wet or dusty conditions

- Water-resistance means resistance against cold, clean fresh water only. Do not expose the device to any other type of liquid, such as sea water.
- Do not submerge your device in water.
- If the device has been exposed to water, wipe it off with a dry cloth. If it has been exposed to any other liquid, immediately splash some clean fresh water onto the device. Carefully wipe the device dry.
- Do not charge the device or connect anything if the connectors are dusty, wet, or damp.
- If the connectors are dusty, open the connector cover of the device and splash clean freshwater onto the connectors. Carefully wipe the device and connector area dry, and let the inside of the connectors dry.
- Only open the back cover in dry and clean conditions, and wipe the device dry and clean first, to prevent water or dust reaching the interior. Make sure the interior of your device and the back cover seals are dry, clean, and free of any foreign objects, as they may damage the seals against water.

Recycle



Always return your used electronic products, batteries, and packaging materials to dedicated collection points. This way you help prevent uncontrolled waste disposal and promote the recycling of materials. All materials of the device can be recovered as materials and energy. Check how to recycle your Nokia products at www.nokia.com/recycle.

Crossed-out wheeled-bin symbol



The crossed-out wheeled-bin symbol on your product, battery, literature, or packaging reminds you that all electrical and electronic products and batteries must be taken to separate collection at the end of their working life. Do not dispose of these products as unsorted municipal waste: take them for recycling. For info on your nearest recycling point, check with your local waste authority, or go to www.nokia.com/support. For more info on the environmental attributes of your device, see www.nokia.com/ecoprofile.

Copyrights and other notices

DECLARATION OF CONFORMITY

CE 2280

Hereby, NOKIA CORPORATION declares that this WS-2 product is in compliance with the essential requirements and other relevant provisions of Directive 1999/5/EC. A copy of the Declaration of Conformity can be found at www.nokia.com/global/declaration/declaration-of-conformity.

The availability of products may vary by region. For more info, contact your Nokia dealer. This device may contain commodities, technology or software subject to export laws and regulations from the US and other countries. Diversion contrary to law is prohibited.

The contents of this document are provided "as is". Except as required by applicable law, no warranties of any kind, either express or implied, including, but not limited to, the implied warranties of merchantability and fitness for a particular purpose, are made in relation to the accuracy, reliability or contents of this document. Nokia reserves the right to revise this document or withdraw it at any time without prior notice.

To the maximum extent permitted by applicable law, under no circumstances shall Nokia or any of its licensors be responsible for any loss of data or income or any special, incidental, consequential or indirect damages howsoever caused.

Reproduction, transfer or distribution of part or all of the contents in this document in any form without the prior written permission of Nokia is prohibited. Nokia operates a policy of continuous development. Nokia reserves the right to make changes and improvements to any of the products described in this document without prior notice.

Nokia does not provide a warranty for or take any responsibility for the functionality, content, or end-user support of third-party apps provided with your device. By using an app, you acknowledge that the app is provided as is. Nokia does not make any representations, provide a warranty, or take any responsibility for the functionality, content, or end-user support of third-party apps provided with your device.

FCC NOTICE

This device complies with part 15 of the FCC rules. Operation is subject to the following two conditions: (1) This device may not cause harmful interference, and (2) this device must accept any interference received, including interference that may cause undesired operation. Any changes or modifications not expressly approved by Nokia could void the user's authority to operate this equipment.

Note: This equipment has been tested and found to comply with the limits for a Class B digital device, pursuant to part 15 of the FCC Rules. These limits are designed to provide reasonable protection against harmful interference in a residential installation. This equipment generates, uses and can radiate radio frequency energy and, if not installed and used in accordance with the instructions, may cause harmful interference to radio communications. However, there is no guarantee that interference will not occur in a particular installation. If this equipment does cause harmful interference to radio or television reception, which can be determined by turning the equipment off and on, the user is encouraged to try to correct the interference by one or more of the following measures:

- Reorient or relocate the receiving antenna.
- Increase the separation between the equipment and receiver.
- Connect the equipment into an outlet on a circuit different from that to which the receiver is connected.
- Consult the dealer or an experienced radio/TV technician for help.

NOTE: FCC Radiation Exposure Statement: This equipment complies with FCC radiation exposure limits set forth for an uncontrolled environment. This transmitter must not be co-located or operating in conjunction with any other antenna or transmitter.

TM & © 2013 Nokia. All rights reserved. Third party products/names may be TMs of their respective owners.

© 2013 Microsoft Corporation. All rights reserved. Microsoft, Windows and the Windows logo are trademarks of the Microsoft group of companies.

The Bluetooth word mark and logos are owned by the Bluetooth SIG, Inc. and any use of such marks by Nokia is under license.

Warranty

The warranty period Nokia provides for this product is 12 months. For details please visit the local Nokia online warranty text web site www.nokia.com/support.