

# INDEX

<b>Technical specifications of Midland BTSKI .....</b>	<b>2</b>
<b>Charging batteries .....</b>	<b>3</b>
<b>Description of the BT SKI device and fitting systems .....</b>	<b>3</b>
Description of the BT SKI device .....	3
Fitting your BT SKI Earwarmer system .....	4
Fitting and wiring your BT SKI Universal Helmet system.....	5
<b>Switching your Midland BTSKI On and Off.....</b>	<b>7</b>
<b>Adjusting the volume .....</b>	<b>7</b>
<b>Pairing with Bluetooth devices .....</b>	<b>7</b>
<b>Using the features of the Bluetooth devices .....</b>	<b>8</b>
Using the telephone feature.....	8
Using the MP3 player feature of the mobile phone.....	9
Using the intercom feature.....	9
<b>Resetting all paired devices .....</b>	<b>10</b>
<b>Using the wired audio input .....</b>	<b>10</b>
Using an i-Pod/MP3 player .....	11
Using a Two Way Radio transceiver .....	11
<b>Special configurations .....</b>	<b>11</b>
Enabling/Disabling the VOX feature (Intercom and telephone).....	11
Wired connection always on .....	12
<b>Recommendations for specific uses .....</b>	<b>12</b>
Recommendations for using a PMR446 transceiver .....	12
Use at your own risk .....	13
<b>Warranty .....</b>	<b>13</b>
<b>Light and sound signal/ unit functions .....</b>	<b>15</b>

## Midland BTSKI

*Thank you for purchasing Midland **BTSKI** Intercom, the wireless Intercom system designed for leisure users that want to practice winter sports without giving up the comfort of Bluetooth communications.*

*Thanks to Bluetooth technology, Midland **BT SKI** allows you to make and receive calls, listen to music and connect with another Midland **BT SKI** device hands-free, thanks to the Intercom feature.*

### **Versions:**

- › Midland BT SKI Earwarmer
- › Midland BT SKI Universal Helmet

### **Content of the BT SKI “Earwarmer” packaging**

- › 1 BTSKI device
- › 1 earwarmer with two stereo speakers and 1 microphone with boom
- › 1 Velcro strip to fix the unit onto the helmet
- › 1 Stereo audio cable to connect an iPod/ or other models of MP3 players
- › 1 Mini USB wall-mounting power supply

### **Content of the “Universal Helmet” packaging**

- › 1 BTSKI device
- › 1 Audio kit with two stereo speakers and 1 microphone with boom
- › 1 Velcro strip and 1 bi-adhesive plate to fix the unit onto the helmet
- › 1 Stereo audio cable to connect an iPod/ or other models of MP3 players
- › 1 Mini USB wall-mounting power supply

## Technical specifications of Midland BTSKI

- › Bluetooth ver. 2.0 stereo (Headset/ Handsfree/A2DP protocol)
- › AGC system automatically controls the volume in relation to background noise
- › Voice (VOX) or manual activation of the communication
- › Mobile phone connection
- › Manual controls to enable: telephone, intercom and wire connection
- › Fully waterproof/snowproof
- › Lithium battery with 8 hours talk time
- › Recharge time: app. 4 hours
- › Intercom: max coverage of app. 200mt outdoors

### **Bluetooth connections:**

- › To a mobile phone/MP3 player
- › With another BTSKI device for Intercom communications

### **Wire connections:**

- › For stereo audio input (iPod/MP3 player)
- › For PMR446 transceivers (with optional cable)

***Attention: before using BTSKI for the first time, remember to recharge it for at least 5/6 hours.***

***Attention: Midland BTSKI is designed to withstand rain and snow. However, if it is raining, always verify that the rubber caps protecting the sockets are fully fitted.***

## Charging batteries

Make sure that the unit is fully charged before use. Allow at least 5-6 hours for a full charge before using the unit for the first time. Normally, after the first time, it takes 4 hours for a full charge.

Charge the unit by inserting the wall-charger into the charging socket (lift the rubber cover to insert the plug).

The red LED on the unit will start flashing when charging begins. Let the device charge until the blue LED turns on.

When the charge is complete, release the device from the charger.

**Attention: every time the mini USB recharging plug is inserted (or detached), the device automatically turns off. To use the device while it is in charge, you should turn it on again with the plug inserted.**

## Description of the BT SKI device and fitting systems

### Description of the BT SKI device

The **BTSKI** has 3 multifunction buttons on the front and 3 wired connections in the lower section.

#### Description of the button features:

- › **Control:** to manage mobile phone features and the Intercom function
- › **Volume+:** enables you to increase the volume
- › **Volume -:** enables you to decrease the volume

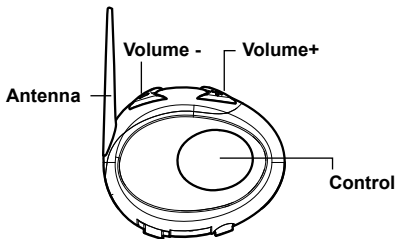

### Description of the wired connections

- › **Charger jack:** enables to recharge the unit using a standard mini USB power supply
- › **Audio kit jack:** enable to connect an audio kit (stereo headset and microphone)
- › **Auxiliary audio jack (AUX):** can be used to connect an audio source, like a stereo iPod/MP3 player, or a PMR446 transceiver

**Attention: for a better sound quality be sure that the plug has been correctly and deeply inserted.**

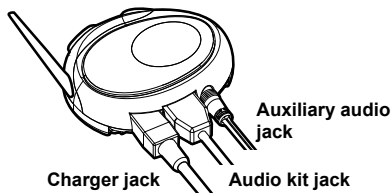

## Fitting your BT SKI Earwarmer system

The Earwarmer audio system includes two ultra-flat stereo speakers and one microphone with boom, all assembled into a soft and warm headset.

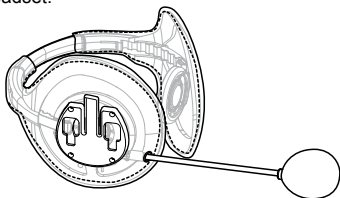

Midland BT SKI is the best solution for Bluetooth communications, designed to be used without helmet or with semi-rigid ski helmets.

### Fitting and removing your Midland BT SKI

The BT SKI can be easily fitted by sliding it downwards so that it fits into the slot of the fixing device.

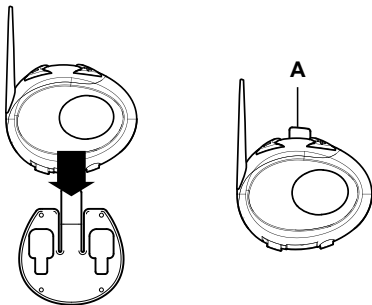

BT SKI is maintained in position thanks to the fixing clip located on the upper section (A).

To detach the BT SKI, simply press the fixing clip and push the unit upwards.

### Using the BT SKI without helmet

After have fixed your BTSKI on its suitable tool and have inserted the audio kit plug into the central socket, wear your headset as shown in the figure. Please, be sure to have placed the microphone in the right way, with the white sign oriented towards your mouth.

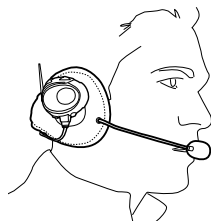

### Using the BTSKI with a semi-rigid helmet

To place the BT SKI into a semi-rigid helmet you should first of all remove the little triangular pads, used to cover the ears in most of helmets on sale, and then put your helmet directly on the BT SKI device.

If your helmet is not equipped with the two removable pads, you could anyway mount your BT SKI system by using the supplied Velcro-band. Be sure to fix the Velcro-band as shown in the figure.

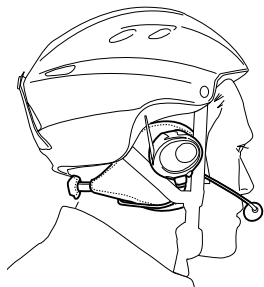

Now, fix the BT SKI on the Velcro-band. Wear your headset, insert the connection cable of the headset into the BT SKI device and wear the helmet.

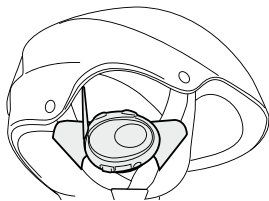
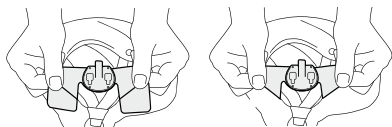

## Fitting and wiring your BT SKI “Universal helmet” system

Midland BT SKI thanks to the “Universal Helmet” audio kit can be mounted on every kind of helmet: rigid and semi-rigid ones.

The “Universal helmet” audio system is composed of two ultra-flat high performance stereo speakers and one microphone with boom (integrated to the speaker on the right).

### To wire the helmet.

Thanks to the functional Velcro band (or the bi-adhesive plate), it is possible to fix the speakers inside the ear pad (the nearest they are to your ears, the better will be the sound quality). Wires can be hidden inside the padding.

To achieve the best microphone performance, be sure to have placed the boom mike the nearest to your mouth.

It is very important to keep the sponge on the microphone in order to reduce wind noises or background interferences.

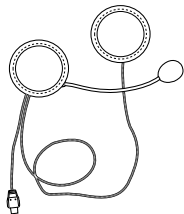

**The best known and distributed helmet brands on the market are designed to contain the speaker inside the padding. The Universal Helmet solution can be perfectly placed inside; just put the speakers into the special compartment in correspondence to your ears.**

**The majority of the models have a pocket on each side (with a pocket closure); remove the foam rubbers and replace them with the speakers.**

**From the little opening of the right, let the boom microphone and the connection plug exit. Adjust the boom microphone the nearest to your mouth.**

**Other helmet models have a little clasp under the soft padding. In this case, open the zip and place the speakers near your ears. Let the boom mike exit from the end of the zip and adjust it. The plug should exit from that little opening too in order to connect it to your BT SKI.**

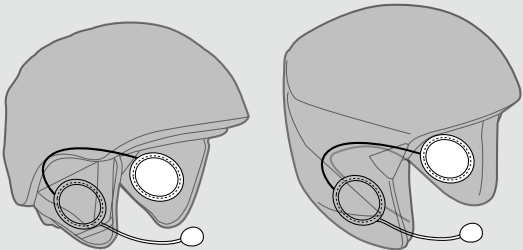

### **To fix the BT SKI**

In case you have a semi-rigid helmet, you should mount your BT SKI system by using the supplied Velcro band.

Be sure to fix the Velcro band on the right side of the helmet between the closing laces, as shown in the figure below.

Now, fix the BT SKI on the Velcro band by slipping it down.

Insert the connection cable into the Audio kit plug of the BT SKI device.

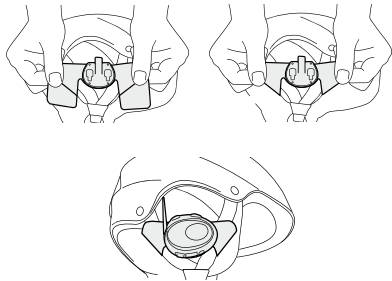

In case you have a rigid helmet, you should mount your BT SKI system by using the bi-adhesive plate.

This little and practical mounting system allows you to fit the BT SKI on the rigid surface of the helmet. Just clasp and slide the BT SKI device down and connect it to the audio kit.

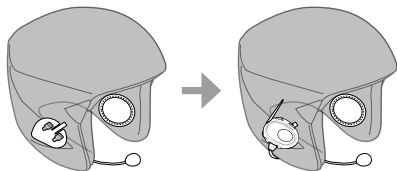

## Switching your Midland BTKI on and off

### Switching the unit on:

- › Press and hold “Control” button down for approximately 3 seconds until the BLUE indicator lights.

### Switching the unit off:

- › Press and hold both “Control” and “VOL-” buttons together for approximately 3 seconds until the RED indicator flashes 3 times, thus lessening the chances that you might turn off the unit accidentally (especially whilst wearing heavy gloves).

## Adjusting the volume

Your Midland BT SKI uses AGC technology, which automatically adjusts the listening volume in relation to background noises.

However, it is also possible to manually adjust the volume by means of the “Volume+” and “Volume -” buttons.

**Attention: volume can be adjusted only when an audio kit connection is active. (Intercom, music, phone call... )**

## Pairing with Bluetooth devices

Your Midland BT SKI is a Bluetooth unit that can be paired with other Bluetooth devices, such as a mobile phone or another BT SKI device for Intercom communications.

Before performing this procedure, it is necessary to set BT SKI into the Setup mode.

### Setup mode

Switch off the BT SKI device. Press and hold down the central button “Control” for about 7 sec. until the red indicator switches on permanently. BT SKI is now in “Setup” mode and can therefore be paired with other devices.

### Exiting from the Setup mode

To exit the Setup mode double click the “Control” button. Once the red light turns off, the blue led starts blinking.

## Using the features of the Bluetooth devices

### Using the telephone feature

To use the Telephone feature, be sure the units are correctly paired together.

#### Pairing the unit with a mobile phone

1. Enable the Bluetooth device search feature on your mobile phone. As this procedure varies according to the brand and model of the mobile phone, refer to the manual supplied to your particular phone for further information.
2. Set the BT SKI unit in "Setup" mode, then press the Control button on the unit until the red and blue indicators start flashing.
3. After a few seconds the mobile phone will display "Midland BT SKI". Select it and follow the instructions provided in your mobile phone manual to accept the pairing. When prompted, enter the pairing code, which is 0000 (four zeroes). Your mobile phone should then display a confirmation message if the pairing operation has been successfully completed.
4. The BT SKI will automatically exit the set up mode (red indicator on) and go to the working mode (blue light flashing).

#### Answering a call

When you hear the phone ring, you can answer in two different ways:

##### *Vocally:*

Simply say one word to answer the call and start talking. Remembering that you can only do this if you answer the call after the third Ring. (Be aware that some phones may not support voice answering)

##### *Manually:*

Tap the "Control" button and start speaking.

#### Rejecting a call

If you don't wish to answer, you can let the mobile phone ring or press the "Control" button for a few seconds (you will hear one audio confirmation tone).

#### Making a call

There are several ways to make a call.

##### *From the mobile keypad:*

Dial the number on the mobile keypad:

- › Press "Send" on the mobile phone.

##### *To redial the last number:*

- › Press and hold "Control" button for 3 seconds in order to redial the last number (you will hear one audio confirmation tone).

##### *To make a voice call:*

- › Briefly press "Control" button. If your mobile phone supports voice calls, you will be asked to speak the name of the contact you wish to call.

*Priority: Calls have a high priority, which means that all other communications are temporarily disabled when a call arrives and automatically re-enabled once the call ends.*

***Attention: the voice call command is possible only if the BTSKI has never been connected to another BTSKI for Intercom communication.***

#### Ending a call

There are several ways to end a call:

- › Wait for the called person to end the call.
- › Press the "Control" button for 3 seconds (you will hear an audio confirmation tone).
- › Press "End" button on the mobile phone.



## Using the MP3 player feature of the mobile phone

Many mobile phones are now designed to be used as stereo MP3 players. The BT SKI device fully supports the A2DP and AVRCP protocols that enable you to listen to stereo music and remotely control your mobile phone's MP3 player. You can even use the buttons on the BT SKI unit to control the following play options: Play, Pause, Forward and Backward.

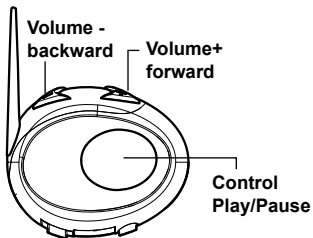

### Available controls:

- › **To play/pause music**, double click the “Control” button.
- › **To skip forward to the next song**, keep pressed the “Volume+” button.
- › **To skip backwards to the previous song**, keep pressed the “volume-” button.
- › **To enable your connected MP3 Player (ADP/AVRCP)**, press and hold down the “Volume +” and “Volume-” buttons for 3 seconds (this feature is active by default).
- › **To disable the MP3 player**, press and hold down the “Volume+” and “volume-” buttons (2 beeps will confirm it).

*Priority: the music listening mode has the lowest priority. Therefore, it will always be disabled when another type of communication is enabled.*

## Using the intercom feature

To use the Intercom feature, be sure both BT SKI units are turned on and previously paired together.

### Pairing with another BTSKI device

Place both BT SKI units in Setup mode (red indicator permanently on) Press the “Volume +” button on the first unit until the RED and BLUE lights begin to flash rapidly and alternately.

Then press the “Volume -” button on the second unit until the RED and BLUE lights begin to flash rapidly and alternately.

Now both BT SKI units are trying to pair to each other.

When successfully paired, the blue led of each device will light for 1 sec and go back to setting mode (red light always on) waiting for additional pairing or setting procedures.

To use the two devices, exit the setting mode. Double click on the “Control” button. The red light will quit and the blue light will begin to flash. Now you can use your BT SKI.

*Priority: Intercom communications always have a higher priority, compared to other communications, with the only exceptions being Telephone.*

Therefore, the Intercom feature automatically disables all other communications.

The intercom feature is disabled during a phone call, and is automatically re-enabled as soon as these communications end.

**Attention: some mobile phone release the line after a few seconds, which means that the Intercom feature may not be immediately available.**

The Intercom feature can be enabled in two ways:

*Manual activation:*

- › Press “Control” button, on one of the two units. Communication is enabled and remains active until you press the “Control” button again. You will hear 1 audio tone when the Intercom feature is enabled and 2 audio tones when it is disabled.

*Voice activation (VOX):*

- › This is enabled by default. To start an Intercom communication, simply start talking.

**Attention: every time the mini USB recharging plug is inserted (or detached), the device automatically turns off. To use the device while it is in charge, you should turn it on again with the plug inserted.**

The communication will remain active for all the time you are talking. If there is no conversation, the Intercom is automatically closed after 20 seconds. To re-open it, simply start talking again. When the Intercom is “VOX” activated, you can decide to disable it before the predefined time, simply by pressing the “Control” button once.

- › To disable the voice activation mode, follow the instructions provided in the “Special configurations” section.

## Distance

Two Midland BT SKI units can communicate

up to a maximum range of approximately 200meters outdoors. The maximum coverage depends on the presence of obstructions in the area or on the head orientation.

## Resetting all paired devices

Sometimes you may find it necessary to delete all the pairing references stored in the BT SKI unit (reset operation).

To perform this operation, switch off the BT SKI and keep pressed the “Control” button. The red led turns on. Simultaneously press and hold down the “Volume +” and “Volume -” buttons for 4 seconds.

The Blue Light will be lit on for 1 sec.

This procedure deletes all the paired Bluetooth devices stored in the memory and it is therefore possible to start a new “clean” pairing session.

## Using the wired audio input

Your Midland BT SKI is also supplied with a wired audio input (labeled AUX), that can be used to connect an audio source, like an iPod (or any other MP3 Player) or a PMR446 transceiver for communications in group or for a coverage increase. The wired audio input allows a higher range of coverage respect to what granted with Bluetooth technology.

Priority: the wired audio input has the lowest priority when compared to the other Bluetooth connections (including the Intercom) and will therefore always be disabled when another Bluetooth communication is opened.

## Using a i-Pod/MP3 Player

### Listening to music

To listen to music from the wired input, connect the audio source using the cable supplied with the BT SKI unit. The volume level is automatically adjusted by the AGC system, which means that you only need to adjust the volume of your iPod/ MP3 player to a level that will allow you to listen to music in normal speed.

**Attention: it is not recommended to set the maximum volume on the MP3 player.**

*Hint: We recommend that you perform a few tests adjusting the volume of your iPod/MP3 player so at the normal speed the Headset volume is suited to your needs. The AGC system will automatically increase the volume on higher speed. Make a note to remember this setting for future trips.*

**Attention: the volume adjustment, (“Volume+” and “Volume –”) buttons, cannot be used to adjust the volume of the wired audio source(eg MP3 player).**

### Enabling/disabling the wire input

The wire input can be enabled and disabled

- › Enabling: double click the “Control” button (you will hear one audio confirmation tone).
- › Disabling: double click the “Control” button(you will hear two audio confirmation tones).

**Attention: this function is available only if there is no music active via Bluetooth.**

## Using a Two Way Radio transceiver

To be able to use the transceiver, it is necessary to purchase a specific cable (sold separately) in order to connect the radio to your Midland BT SKI.

Some manufacturers radios use a different pin configuration, so we recommend that you ask your dealer as to which cable is best suited to your needs.

To communicate via the attached radio, press the transmission Press To Talk (PTT) button to speak and release it to listen. It is not possible to talk and listen simultaneously. Communications can be activated also without pushing the PTT button, by enabling the VOX function.

## Special configurations

Some Midland BT SKI features can be configured to suit specific needs

- › *Enabling/Disabling the VOX feature (Intercom and telephone)*
- › *Wired connection always on*

### Enabling/Disabling the VOX feature (Intercom and telephone)

#### Enabling the intercom by voice (VOX)

The Intercom feature can be enabled both manually and vocally (VOX). The VOX activation is influenced by the background noise and therefore by the speed.

For optimum results, it is possible to choose one of the following four microphone sensitivity levels: high, medium, low and very low. The default setting of BT SKI is “high”. It is also possible to disable the VOX feature in order to

activate the Intercom and phone call answering features in manual mode only.

### **Adjusting the sensitivity of the microphone (VOX)**

1. Enter the Setup mode: Switch your **BTSKI** off.

Press and hold down the central button (Control) until the red indicator switches on permanently. Your BT SKI is now in "Set up mode".

2. Press the "Volume+" and "Control" buttons till the red indicator will turn to steady blue.
3. Now, press "Volume +" or "Volume -" to increase or reduce sensitivity. Every time you press the Volume buttons the RED light will flash for confirmation. When you reach the end of the upper and lower limit, the RED light will not flash.
4. Double press the "Control" button; the Blue light will flash several times, in order to let you know the selected sensitivity:  
once = VOX disabled  
Twice = very low sensitivity  
3 times= low sensitivity  
4 times= medium sensitivity  
5 times = high sensitivity  
Default = high sensitivity
5. The light indicator is now back to steady RED ("Set up mode") and the changes are confirmed
6. If needed, you can adjust again the sensitivity repeating the steps from point 2, otherwise exit the Setting mode by double clicking the "Control" button. Once the red light turns off, the blue led starts blinking. Now you can use your BT SKI.

### **Disabling the VOX feature (Intercom and telephone)**

Follow all the procedure described in the previous steps and choose the option 1 (VOX disabled). You will see the blue led blinks once.

### **Wired connection always on**

This feature let's you keep the wired connection always on, even when the intercom is open. This feature can be useful when you connect a PMR446 transceiver.

Enabling:

- › Enter the "Setup" mode.
- › Press the "Volume+" and "Volume -" buttons for one second. The blue LED will flash once.
- › To exit the "Setup" mode double press the "Control" button.

Disabling:

- › Follow the same procedure up described; now the blue LED will flash twice
- › To exit the "Setup" mode double press the "Control" button.

## **Recommendations for specific uses**

### **Recommendations for using a PMR446 transceiver**

If you wish to use a PMR446 transceiver for group communications and simultaneously maintain the Intercom feature enabled between two BT SKI devices, you must remember that the Intercom feature is enabled every time you speak by means of the BT SKI's VOX feature. Consequently, radio communications will be disabled whilst you are talking with somebody,

because they have a lower priority compared to Intercom communications. This can be prevented by enabling the “Wired connection always on” or disabling the VOX feature.

Disable the VOX feature, as explained in the previous section, to make sure that the intercom will not automatically be activated when you speak on the PMR446. To enable the Intercom feature when using this configuration, you will have to press “Control” button manually. (This operation disables radio communications that will be automatically re-enabled when the Intercom feature is disabled).

***Attention! If you disable the VOX feature, you will only be able to answer incoming phone calls by pressing the “Control” button.***

## Use at your own risk

The use of the headphone-headset will impair your ability to hear other sounds and others around you.

Listening to music or speaking on a telephone may prevent you from hearing others around you and distract you from riding safely. The use of such headphone-headset while skiing or riding may endanger you and others, and its use, in some areas, could not be allowed.

Using this headset at a high volume may result in permanent hearing loss.

If you experience ringing in your ear or any other hearing related pain, reduce the volume or discontinue using this device. With continued use at high volume, your ears may become accustomed to the sound level, which may result in permanent damage to your hearing.

Please use this device at a safe volume level.

## Warranty

The Warranty does not limit the user’s statutory rights under applicable National laws relating to the sale of consumer products.

The warranty period starts at the time of Product’s original purchase by the first end-user and lasts 24 months.

It is only valid and enforceable in the country where the user has purchased the product provided that the same product has been intended for sale in that country by the manufacturer.

To make use of this warranty, it is necessary to return the defective product with its original package together with the original sales receipt to the authorized service centre.

The warranty totally covers the device in all its parts and the workmanship necessary to repair it.

The warranty does not cover defects or damages caused to the Product by misuse with, or connection to, any accessory or software not produced or supplied by the manufacturer or by use of the product for any other use than for intended use of the product.

The warranty is not enforceable if the product has been dismantled, modified or repaired by anyone other than the authorized service centre or if it is repaired using unauthorized spare parts.

Moreover, the warranty is not valid and no protest can be made if the product has been modified or altered respect to its original purpose.

Nobody will be indemnified for the inactivity period of the device nor can expect refund or claim for direct or circumstantial damages due to an inappropriate use of the device.

## **European CE Notice Certification and Safety Approvals Information**

This product is CE marked according to the RTTE Directive (99/5/EC) and is free use in all the EU countries.

Users are not permitted to make any changes or modifications to the device.

Modifications which are not expressly approved by the producer invalidate the warranty card.

For further information, please go to our website [www.cte.it](http://www.cte.it)

## **RSS-Gen & RSS-210 statement:**

This device complies with Industry Canada licence-exempt RSS standard(s).

Operation is subject to the following two conditions: (1) this device may not cause interference, and (2) this device must accept any interference, including interference that may cause undesired operation of the device.

## **RSS-102 Statement:**

"This equipment complies with Industry Canada radiation exposure limits set forth for an uncontrolled environment."

## **FCC statement:**

"This device complies with Part 15 of the FCC Rules. Operation is subject to the following two conditions: (1) this device may not cause harmful interference, and (2) this device must accept any interference received, including interference that may cause undesired operation."

Warning! Changes or modifications to this unit not expressly approved by Midland Radio Corporation could void the user's authority to operate the equipment.

## LIGHT AND SOUND SIGNALS

LED indication	Status
<b>GENERAL</b>	
None	Unit is switched off or full charged when connected to the power supply
Single Blue flash every 3 seconds	Unit being turned on/ Unit in working mode
Triple red flash	Unit being turned off
Single Red flash every 3 seconds	Standby - low battery
RED and BLUE (together) every 3 seconds	Active (Intercom, phone call or Bluetooth connection in progress)
RED and BLUE (together) and one flash of RED light every 3 seconds	Active but low battery
Single red flash every 2 seconds	Unit in charge when connected to the power supply
<b>SETUP</b>	
Steady Red	Setup mode
Rapid Red-Blue alternating flash	Pairing mode (searching for devices)
Steady Blue for two second	Successful pairing/ Reset paired devices
<b>Audio signals</b>	
<b>Status</b>	
Ascending tone (low-high)	Unit being turned on
Descending tone (high-low)	Unit being turned off
Enable/Disable the Intercom	1 tone = enabled / 2 tones = disabled
1 tone	Specific feature turned on
2 tones	Specific feature turned off

## UNIT FUNCTIONS

If you want to...	...do this
<b>GENERAL</b>	
Turn on the unit	Press the Control button for 3 seconds at least (start Blue flash)
Turn off the unit	Press the Control and VOL- buttons together for 3 seconds (triple Red flash)
Increase the volume	Short press the Volume Up control

Decrease the volume	Short press the Volume Down control
<b>MOBILE PHONE</b>	
Answer a call	Short press of the Control button / say a word
Reject a call	Long press the Control Button / remain silent until the rings stop
Terminate a call	Short press the Control Button
Voice Dial	Short press the Control button and state the name of the person to call (only if your BTKI has not been paired with another BTKI device).
Redial Last number	Long press of the Control button
<b>INTERCOM (if paired with another BTKI device)</b>	
Start using the Intercom	Start talking/short press the Control button
Stop using the Intercom	Stop talking (after 20 sec. you will return to stand by mode)/Short press the Control button
<b>BLUETOOTH MP3 player of the mobile phone</b>	
Activate the MP3 player	Press and hold down the VOL+ and VOL- buttons for 3 seconds
Play and Pause	Double click the Control button
Forward (next song)	While the music play, keep pressed of the VOL+ button for 3 sec.
Backward (previous song)	While the music play, keep pressed of the VOL- button for 3 sec.
Deactivate the MP3 Player	Press and hold down the VOL+ and VOL- buttons for 3 seconds
<b>WIRED CONNECTION</b>	
Activate /Deactivate	Double click the Control button (only if Music via Bluetooth is disabled)
<b>SETUP/PAIRING</b>	
Enter SETUP mode	Press the Control button for 7 seconds while the unit is off
Exit SETUP mode	While in Setup mode, double click the Control button. The Red light will turn off and the Blue light starts flashing.
Pairing a Phone	While in Setup mode, press the Control button until the LED light flash Red and Blue alternately



Pairing your BTSKI with another BTSKI device	While in Setup mode, press the Volume + on one unit (the light will flash Red and Blue alternately), press the Volume- on the other unit (the light will flash Red and Blue alternately). On a successful pairing, both light turn to Blue for one second.
Reset all paired devices	While in Setup mode, long press he Volume + and he Volume -. On a successful reset, the Blue light will turn on for two second.
<b>SPECIAL SETUP CONFIGURATION</b>	
Change VOX sensitivity or disable it	While in Setup mode, press short the Control and VOL+ buttons (blue light on). Now, press "Volume +" or "Volume-" to increase or reduce sensitivity. Double click the Control button to visualize the VOX status. Go back to the SETUP mode (Red light always on). VOX STATUS (Blue light flashing): Once = VOX disable Twice = very low sensitivity 3 times = low sensitivity 4 times = medium sensitivity. 5 times = high sensitivity
Wired connection always on	Enabling: In "Setup" mode, press the "Volume+" and "Volume -" buttons for one second. The blue LED will flash once. Disabling: Follow the same procedure up described; now the blue LED will flash twice

