

Audio System

About Your Audio System

The audio system features AM/FM radio. It can also play audio CDs, WMA/MP3/AAC files, USB flash drives, iPod and *Bluetooth*[®]* devices.

You can operate the audio system from the buttons and switches on the panel, or the remote controls* on the steering wheel, or icons on the touchscreen interface*.

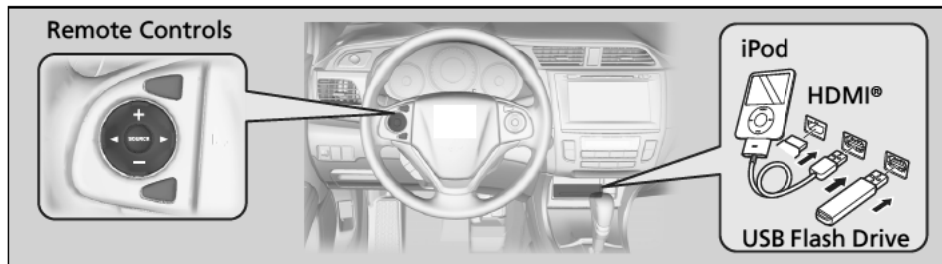

About Your Audio System

Video CDs, DVDs, and 8-cm mini CDs are not supported.

iPod and iPhone are registered trademark owned by Apple Inc.

Place your phone where you can get good reception.

USB/HDMI®* Port

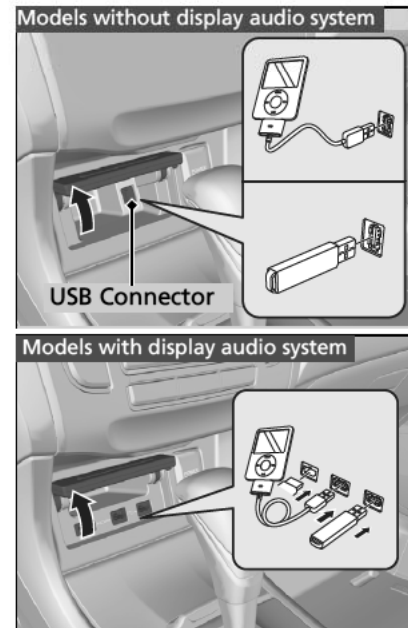

1. Press the lid to open it.
2. Install the iPod dock connector or the USB flash drive to the USB port.
3. Install the HDMI® cable to the HDMI® port*.

⌘ USB/HDMI®* Port

- Do not leave the iPod or USB flash drive in the vehicle. Direct sunlight and high temperatures may damage it.
- Do not connect the iPod or USB flash drive using a hub.
- Do not use a device such as a card reader or hard disk drive, as the device or your files may be damaged.
- We recommend backing up your data before using the device in your vehicle.
- Displayed messages may vary depending on the device model and software version.

If the audio system does not recognise the iPod, try reconnecting it a few times or reboot the device. To reboot, follow the manufacturer's instructions provided with the iPod or visit www.apple.com.cn/ipod.

* Not available on all models

Auxiliary Input Jack*

Use the jack to connect standard audio devices.

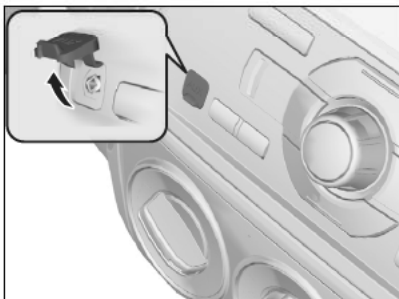

1. Open the AUX cover.
2. Connect a standard audio device to the input jack using a 3.5 mm stereo miniplug.
 - ▶ The audio system automatically switches to the AUX mode.

▶▶ Auxiliary Input Jack *

To switch the mode, press any of the audio mode buttons. You can return to the AUX mode by pressing the **CD/USB** button.

You cannot use the auxiliary input jack if you replace the audio system.

Audio Remote Controls*

Allows you to operate the audio system while driving.

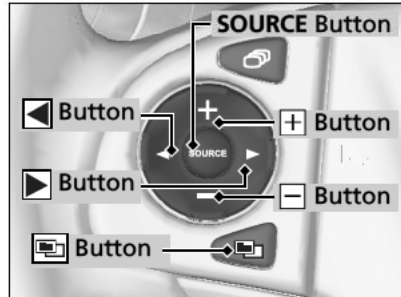

SOURCE Button

Cycles through the audio modes as follows:
 FM→AM→CD→USB→iPod→
 AppMode→Bluetooth®Audio→AUX

+ - (Volume) Buttons

Press +: To increase the volume.
Press -: To decrease the volume.

▶ Buttons

- When listening to the radio
 - Press** ▶: To select the next preset radio station.
 - Press** ◀: To select the previous preset radio station.
 - Press and hold** ▶: To Select the next strong station.
 - Press and hold** ◀: To Select the previous strong station.
- When listening to a CD, iPod, USB flash drive, or Bluetooth® Audio
 - Press** ▶: To Skip to the next song.
 - Press** ◀: To go back to the beginning of the current or previous song.
- When listening to a CD or USB flash drive
 - Press and hold** ▶: To skip to the next folder.
 - Press and hold** ◀: To go back to the previous folder.





▶▶ Audio Remote Controls*

The CD mode appears only when a CD is loaded.

▶▶ button is available only when the audio mode is FM, AM, CD, USB, iPod, or Bluetooth® Audio.

* Not available on all models

 **Button**

- When listening to the radio
Press : To select the radio station by **Scan, Save Preset, or Seek**.
- When listening to a CD or USB flash drive
Press : To select the song by **Scan, Repeat, or Random**.
- When listening to an iPod
Press : To select the song by **Repeat or Shuffle**.
- When listening to a *Bluetooth*[®] Audio
Press : To select **Pause or Play** for the song.
- When watching a video
Press : To select **Scan, Repeat, Random, or Play/Pause** for the video.

Audio System Basic Operation

Models with display audio system

To use the audio system function, the power mode must be in ACCESSORY or ON.

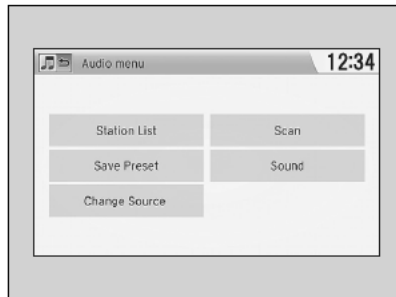
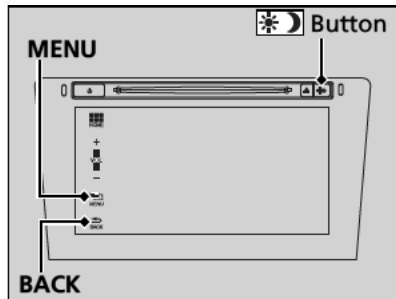

HOME: Select to go to the **HOME** screen.

➤ **Switching the Display** P. 159

MENU: Touch to select any mode.

The available mode includes **Change Source**, **Station List**, **Save Preset**, **Music Search**, and play modes. Play modes can be also selected from **Scan**, **Random/Repeat**, and so on.

BACK: Select to go back to the previous display when it is displayed.

*** button:**

Press to change the audio/information display brightness.

Press * once and select - or + to make an adjustment.

- ▶ Each time you press * , the mode switches among the daytime mode, nighttime mode and **OFF** mode.

Audio System Basic Operation

Audio Menu Items

➤ **Station List** P. 168

➤ **How to Select a File from the Music Search List (MP3/WMA/AAC)** P. 170

➤ **Scan** P. 168

➤ **How to Select a Play Mode** P. 171

Audio/Information Display

Displays the audio status and wallpaper. From this display, you can go to various setup options.

Switching the Display

Using the  button

Press the  (display) button to change the display.

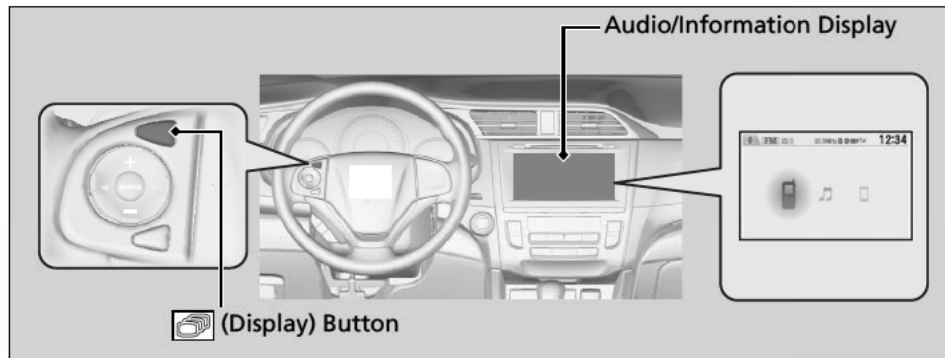

Using the HOME screen

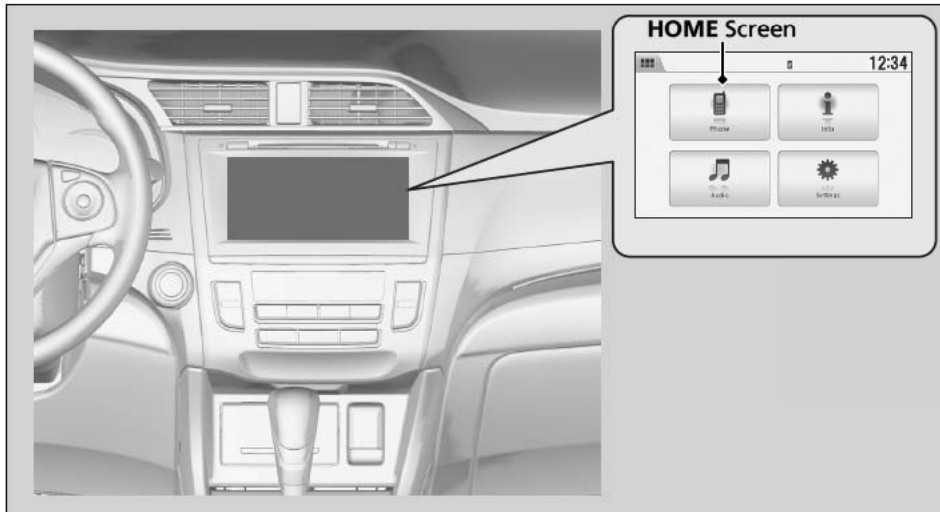

Features

Select **HOME** to go to the **HOME** screen.
Select **Phone**, **Info**, **Audio** or **Settings**.

■ **Phone**

Shows the HFT information.

☑ **Hands-Free Telephone System*** P. 209

■ **Info**

Shows the **Trip Computer**, **Clock/Wallpaper**, or **System/Device Information** information.

Select an item.

■ **Audio**

Shows the current audio information.

■ **Settings**

Enters the customizing menu screen. ▶ **Customized Features*** P. 197

Wallpaper Setup

You can change, store, and delete the wallpaper on the audio/information display.

Import wallpaper

You can import up to five images, one at a time, for wallpaper from a USB flash drive.

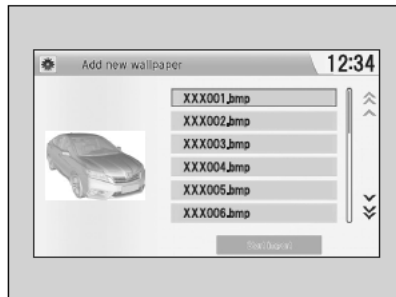
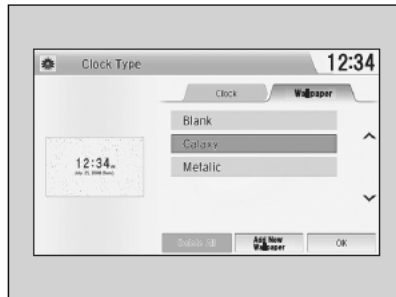

1. Connect the USB flash drive to the USB port.
 ▶ **USB/HDMI®* Port P. 143**
2. Select **Settings** to go to the **Settings** screen.
3. Select **Info Settings**.
 ▶ Repeat the procedure to select **Clock/Wallpaper Type**, then **Wallpaper**.
4. Select **Add New Wallpaper**.
 ▶ The picture name is displayed on the list.
5. Select a desired picture.
 ▶ The preview is displayed on the left side on the screen.
6. Select **Start import** to save the data.
 ▶ The confirmation message will appear. Then the display will return to the wallpaper list.

Wallpaper Setup

- When importing wallpaper files, the image must be in the USB flash drive's root directory. Images in a folder cannot be imported.
- The file name must be fewer than 64 characters.
- The file format of the image that can be imported is BMP (bmp) or JPEG (jpg).
- The individual file size limit is 5 MB.
- The maximum image size is 4,096 × 4,096 pixels. If the image size is less than 800 × 480 pixels, the image is displayed in the middle of the screen with the extra area appearing in black.
- Up to 255 files can be selected.
- If the USB flash drive does not have any pictures, the **No files detected** message appears.

■ Select wallpaper

1. Select **Settings** to go to the **Settings** screen.
2. Select **Info Settings**.
 - ▶ Repeat the procedure to select **Clock/Wallpaper Type**, then **Wallpaper**.
 - ▶ The screen changes to the wallpaper list.
3. Select a desired wallpaper.
 - ▶ The preview is displayed on the left side on the screen.
 - ▶ The pop-up menu appears on the screen.
4. Select **Set**.
 - ▶ The display will return to the wallpaper list.

■ Delete wallpaper

1. Select **Settings** to go to the **Settings** screen.
2. Select **Info Settings**.
 - ▶ Repeat the procedure to select **Clock/Wallpaper Type**, then **Wallpaper**.
 - ▶ The screen changes to the wallpaper list.
3. Select a wallpaper that you want to delete.
 - ▶ The preview is displayed on the left side on the screen.
 - ▶ The pop-up menu appears on the screen.
4. Select **Delete**.
 - ▶ The confirmation message will appear.
5. Select **Yes** to delete completely.
 - ▶ The display will return to the wallpaper list.

Wallpaper Setup

From the pop-up menu, select **Preview** to see a preview at full-size screen.

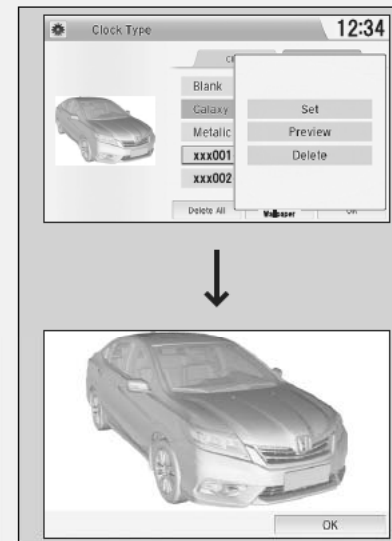

To go back to the previous screen, select **OK**, or **BACK**.

When the file size is large, it takes a while to be previewed.

To delete all wallpapers you add, select **Delete All**, then **Yes**.

Adjusting the Sound



1. Select **Settings**.
2. Select **Audio Settings**.
3. Select **Sound**.

Select the tabs to adjust the following choices:
BASS, TREBLE, FADER, BALANCE, SUBW
(Subwoofer), **SVC** (Speed-sensitive Volume Compensation)

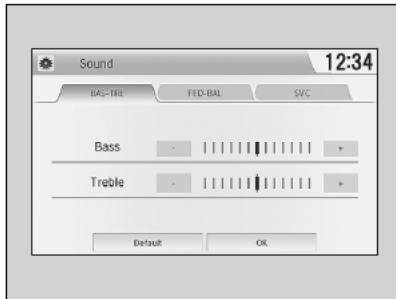

Adjusting the Sound

The SVC has four modes: **Off, Low, Mid, and High**. SVC adjusts the volume level based on the vehicle speed. As you go faster, audio volume increases. As you slow down, audio volume decreases.

Display Setup

You can change the brightness or colour theme of the audio/information display.

■ Changing the Screen Brightness

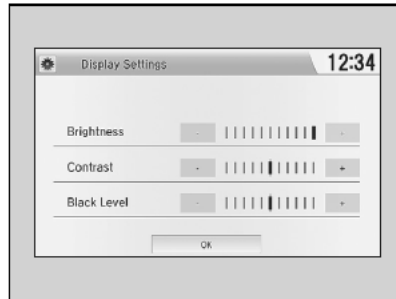

1. Select **Settings** to go to the **Settings** screen.
2. Select **System Settings**.
 - ▶ Repeat the procedure to select **Display** tab.
3. Select **Display Setting**.
4. Select the setting.

■ Changing the Screen's Colour Theme

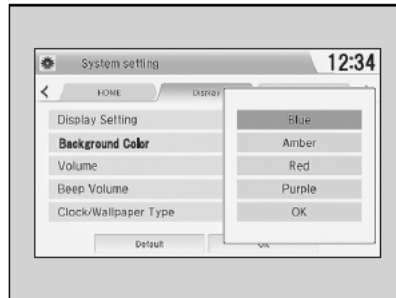

1. Select **Settings** to go to the **Settings** screen.
2. Select **System Settings**.
 - ▶ Repeat the procedure to select **Display** tab.
3. Select **Background Color**.
4. Select the setting you want.

▶▶ Changing the Screen Brightness

You can change the **Contrast** and **Black Level** settings in the same manner.

Playing AM/FM Radio

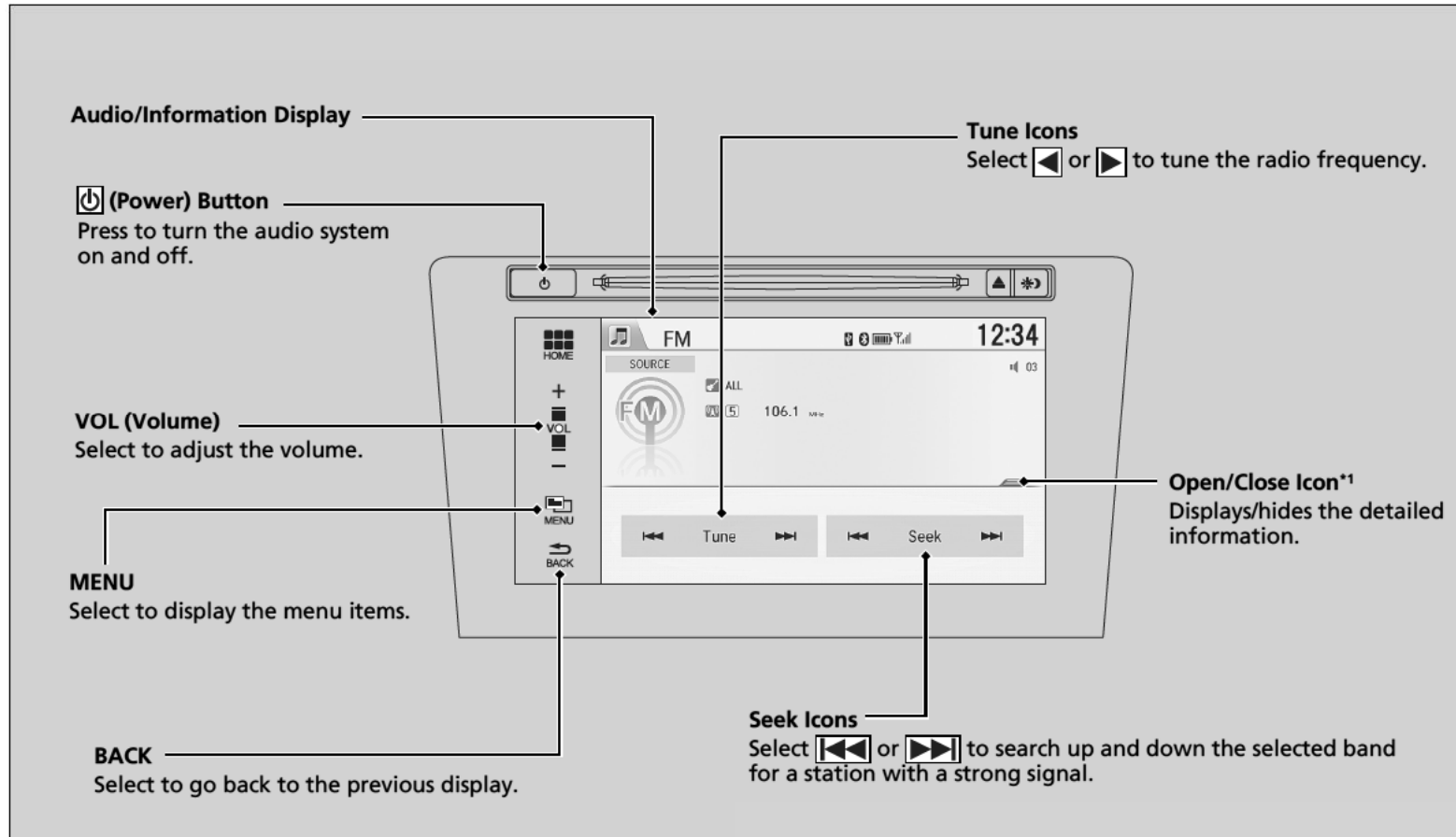

*1:Some or all of the lists may not be displayed.

■ Preset Memory

To store a station:

1. Tune to the selected station.
2. Select **MENU**.
3. Select **Save Preset**.
4. Select the preset number you want to store that station.

⌘ Playing AM/FM Radio

The **ST** indicator appears on the display indicating stereo FM broadcasts.
Stereo reproduction in AM is not available.

Switching the Audio Mode

Press the **SOURCE** button on the steering wheel or select **SOURCE** on the list.

⌘ **Audio Remote Controls*** P. 145

You can also switch the mode by selecting **Change Source** on the **MENU** screen.

You can store 6 AM stations and 12 FM stations into the preset memory.

* Not available on all models

Continued

■ Station List

Lists the strongest stations on the selected band.

1. Select **MENU** to switch to the **MENU** screen while listening to an FM station.
2. Select **Station List**.
3. Select the station.

■ Manual update

Updates your available station list at any time.

1. Select **MENU** to switch to the **MENU** screen while listening to an FM station.
2. Select **Station List**.
3. Select **UPDATE LIST**.

■ Scan

Samples each of the strongest stations on the selected band for 10 seconds.

1. Select **MENU**.
 2. Select **Scan**.
- To turn off scan, select **Cancel Scan**.

Playing a CD

Your audio system supports audio CDs, CD-Rs and CD-RWs in either MP3, WMA, or AAC*1 format. With the CD loaded, select the CD mode.

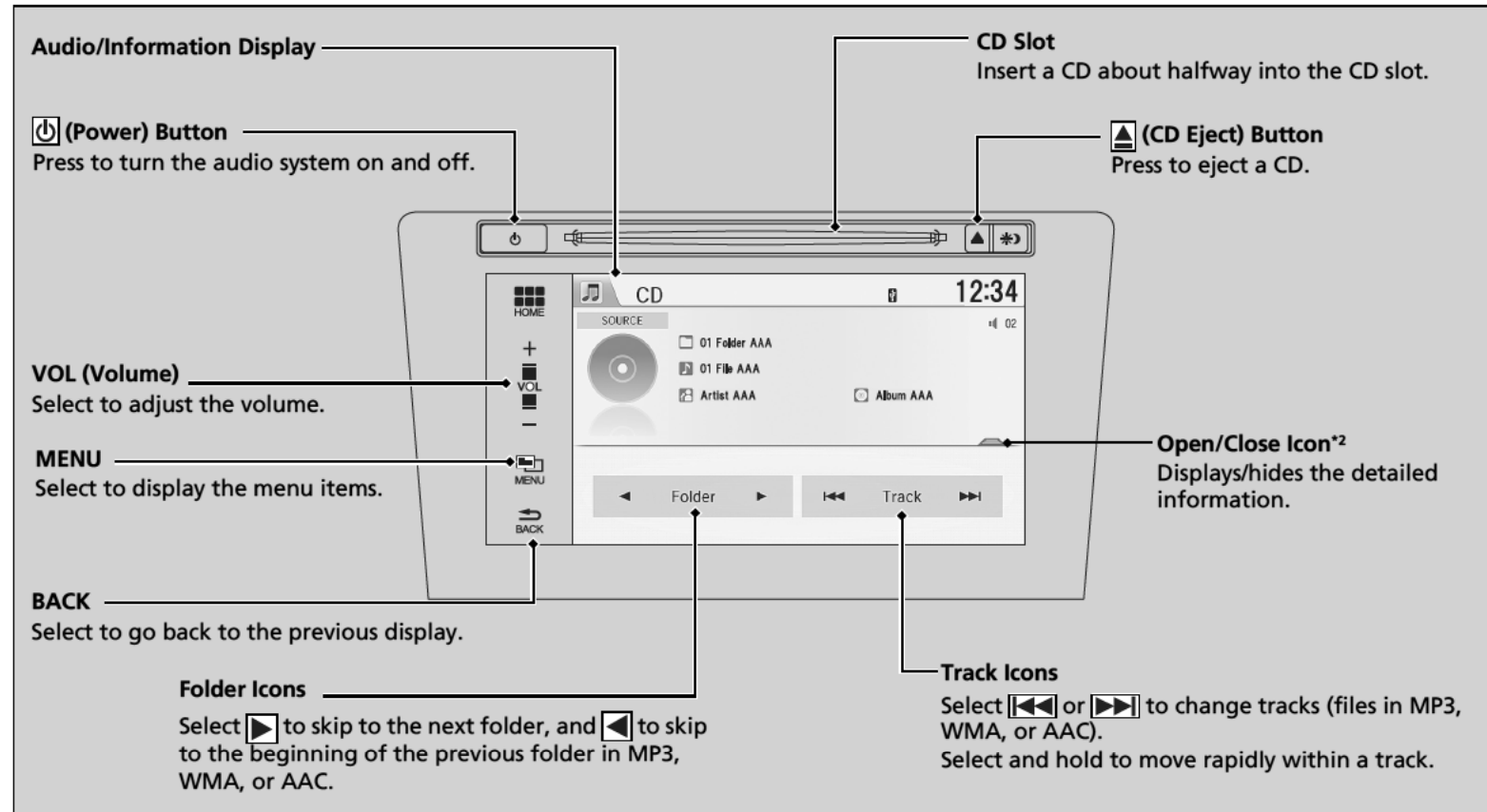

*1: Only AAC format files recorded with iTunes® are playable on this unit.

*2: Some or all of the lists may not be displayed.

How to Select a File from the Music Search List (MP3/WMA/AAC)

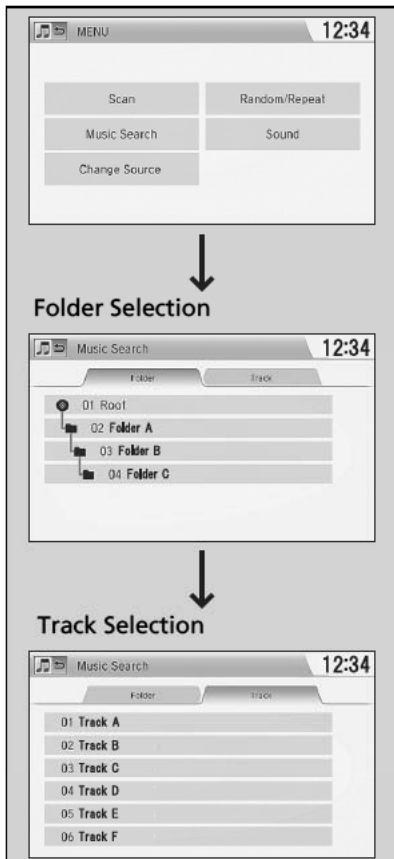

1. Select **MENU** and select **Music Search**.

2. Select a **Folder**.

3. Select a **Track**.

▶▶▶ Playing a CD

NOTICE

Do not use CDs with adhesive labels. The label can cause the CD to jam in the unit.

WMA files protected by digital rights management (DRM) cannot be played.

The audio system displays **Unplayable File**, then skips to the next file.

Text data appears on the display under the following circumstances:

- When you select a new folder, file, or track.
- When you change the audio mode to CD.
- When you insert a CD.

If you eject the CD but do not remove it from the slot, the system reloads the CD automatically after several seconds.

■ How to Select a Play Mode

You can select scan, repeat, and random modes when playing a track or file.



1. Select **MENU**.
2. Select **Scan** or **Random/Repeat**.
3. Select a mode.

■ To turn off a play mode

1. Select **MENU**.
2. Select the mode you want to turn off.

☒ How to Select a Play Mode

Play Mode Menu Items

Scan

Scan Folders (MP3/WMA/AAC): Provides 10-second sampling of the first file in each of the main folders.

Scan Tracks: Provides 10-second sampling of all tracks on the CD (all files in the current folder in MP3, WMA, or AAC).

Random/Repeat

Repeat Folder (MP3/WMA/AAC): Repeats all files in the current folder.

Repeat Track: Repeats the current track/file.

Random in Folder (MP3/WMA/AAC): Plays all files in the current folder in random order.

Random All Tracks: Plays all tracks/files in random order.

Playing an iPod

Connect the iPod using your dock connector to the USB port, then select the iPod mode.

 **USB/HDMI®* Port P. 143**

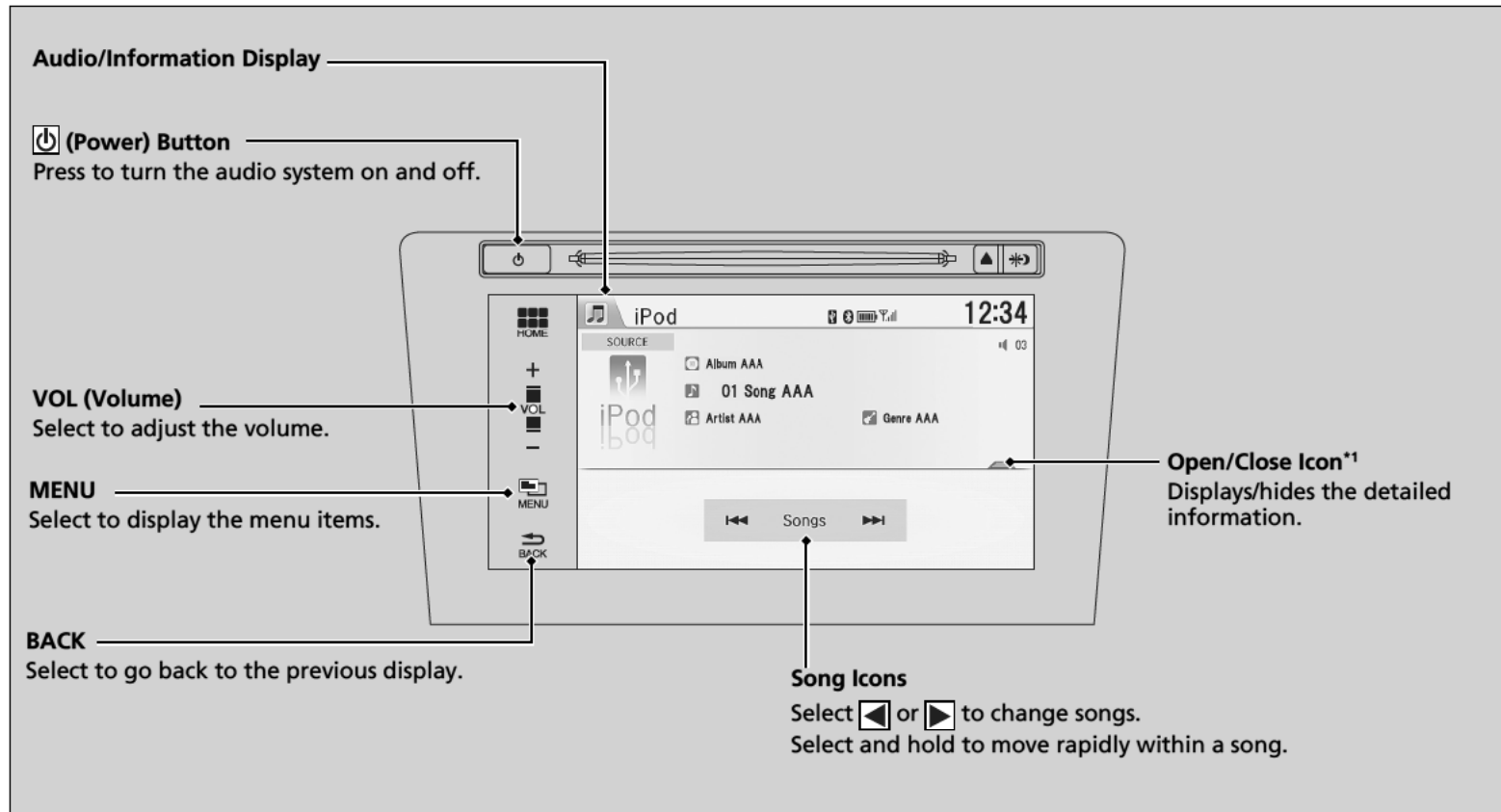

*1: Some or all of the lists may not be displayed.

How to Select a Song from the Music Search List

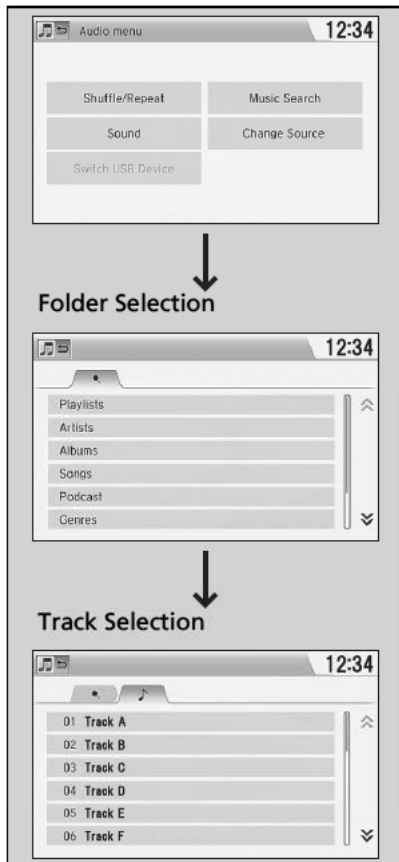

1. Select **MENU** and select **Music Search**.
2. Select the items on that menu.

How to Select a Song from the Music Search List

Available operating functions vary on models or versions. Some functions may not be available on the vehicle's audio system.

If there is a problem, you may see an error message on the audio/information display.

▶ **iPod/USB Flash Drive** P. 191

If you operate the music app on your iPhone/iPod while the phone is connected to the display audio system, you may no longer be able to operate the same app on the display audio. Reconnect the device if necessary.

Features

Continued

■ How to Select a Play Mode

You can select repeat and shuffle modes when playing a file.



1. Select **MENU**.
2. Select **Shuffle/Repeat**.
3. Select a mode.

■ To turn off a play mode

1. Select **MENU**.
2. Select the mode you want to turn off.

▶▶ How to Select a Play Mode

Play Mode Menu Items

Repeat Song: Repeats the current track.

Shuffle Albums: Plays all available albums in a selected list (playlists, artists, albums, songs, genres, or composers) in random order.

Shuffle All Songs: Plays all available files in a selected list (playlists, artists, albums, songs, genres, or composers) in random order.

Playing a USB Flash Drive

Your audio system reads and plays sound files on a USB flash drive in either MP3, WMA or AAC*1 format. Connect your USB flash drive to the USB port, then select the USB mode.

▶ **USB/HDMI** Port** P. 143

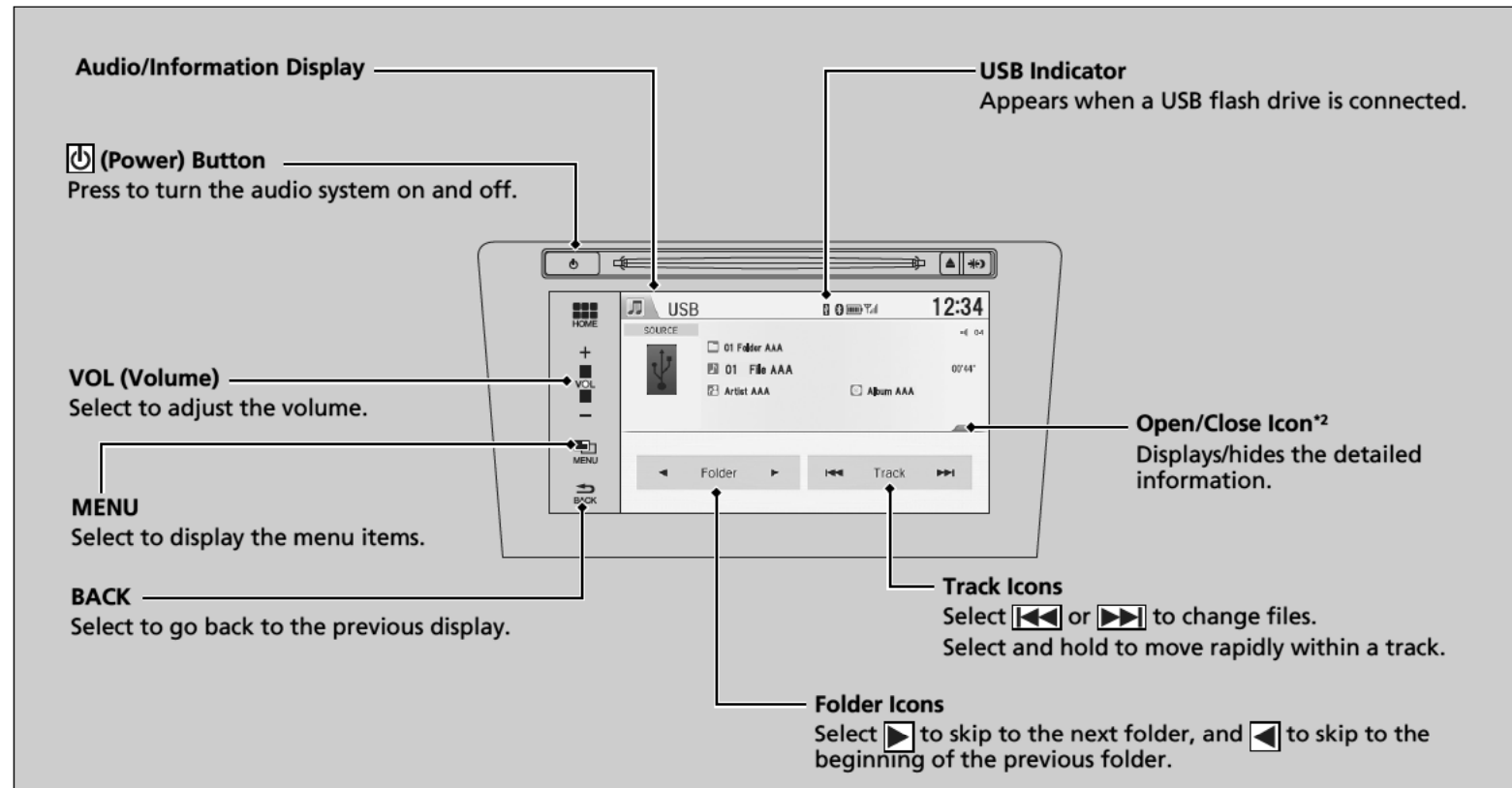

*1: Only AAC format files recorded with iTunes® are playable on this unit.

*2: Some or all of the lists may not be displayed.

* Not available on all models

How to Select a File from the Music Search List

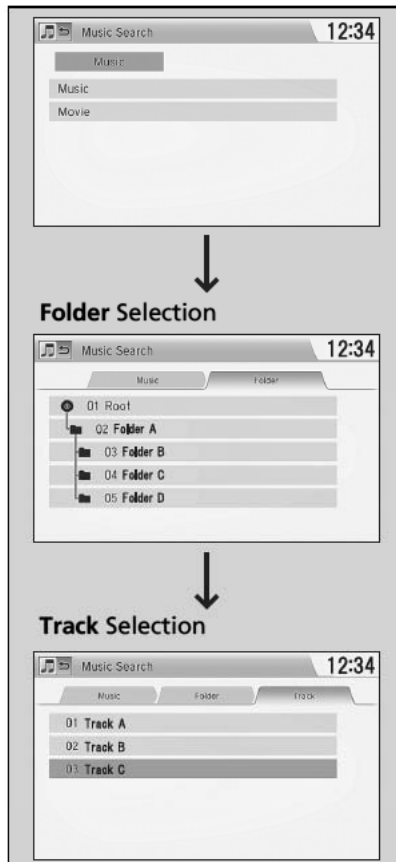

1. Select **MENU** and select **Music Search**.
2. Select **Music** or **Movie**.

3. Select a **Folder**.

4. Select a **Track**.

▶▶▶ Playing a USB Flash Drive

Use the recommended USB flash drives.

▶ **General Information on the Audio System**
P. 193

Files in WMA format protected by digital rights management (DRM) are not played.
The audio system displays **Unplayable File**, and then skips to the next file.

If there is a problem, you may see an error message on the audio/information display.

▶ **iPod/USB Flash Drive** P. 191

■ How to Select a Play Mode

You can select scan, repeat, and random modes when playing a file.



1. Select **MENU**.
2. Select **Scan** or **Random/Repeat**.
3. Select a mode.

■ To turn off a play mode

1. Select **MENU**.
2. Select the mode you want to turn off.

☒ How to Select a Play Mode

Play Mode Menu Items

Scan

Scan Folders: Provides 10-second sampling of the first file in each of the main folders.

Scan Tracks: Provides 10-second sampling of all files in the current folder.

Random/Repeat

Repeat Folder: Repeats all files in the current folder.

Repeat Track: Repeats the current file.

Random in Folder: Plays all files in the current folder in random order.

Random All Tracks: Plays all files in random order.

Slow: Plays the movie slowly.

Playing *Bluetooth*® Audio

Your audio system allows you to listen to music from your *Bluetooth*®-compatible phone.

This function is available when the phone is paired and connected to the vehicle's Hands-Free Telephone (HFT) system.

☑ **Phone Setup** P. 214

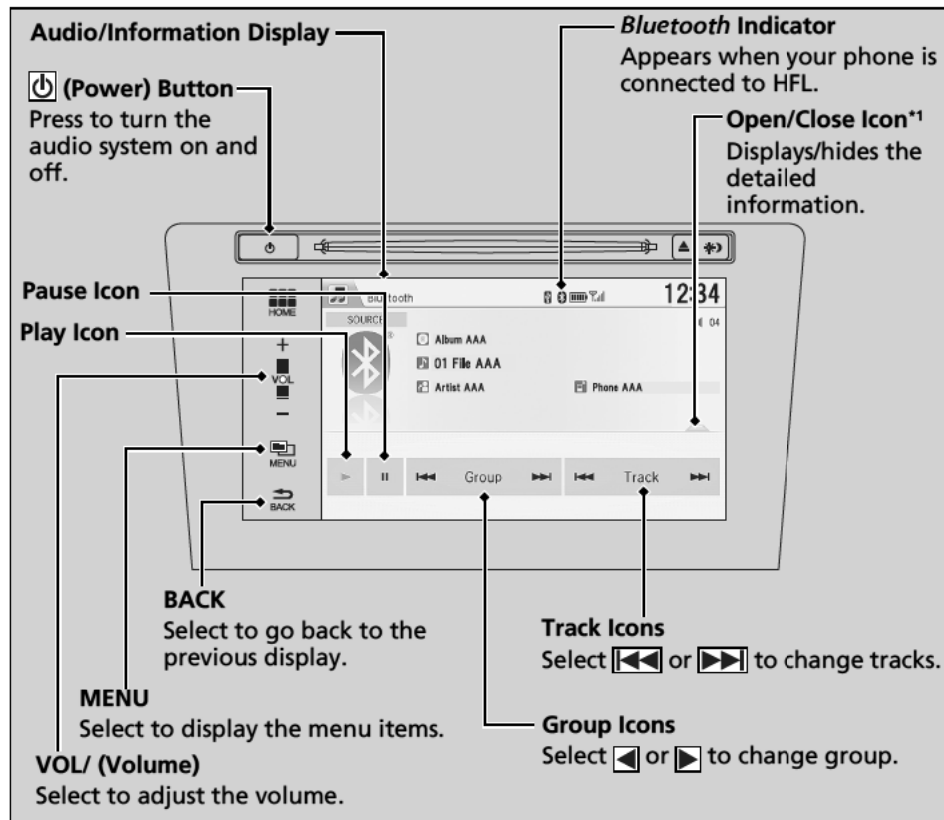

▶▶▶ Playing *Bluetooth*® Audio

Not all *Bluetooth*-enabled phones with streaming audio capabilities are compatible. To check if your phone is compatible, visit www.wdhachandsfree.cn.

It may be illegal to perform some data device functions while driving.

Only one phone can be used with HFT at a time. When there are more than two paired phones in the vehicle, the first paired phone the system finds is automatically linked.

If more than one phone is paired to the HFT system, there may be a delay before the system begins to play.

In some cases, the name of the artist, album, or track may not appear correctly.

A **NO CONNECT** message may be displayed if:

- The phone is not linked to HFT.
- The phone is not turned on.
- The phone is not in the vehicle.
- An incompatible phone is connected.

The following functions may not be available on some devices:

- Pause function
- Group selection

*1: Depending on the *Bluetooth* device you connect, some or all of the lists may not be displayed.

■ To Play *Bluetooth*® Audio Files

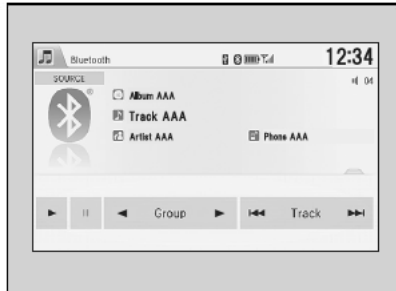

1. Make sure that your phone is paired and connected to the system.
2. Select the *Bluetooth*® Audio mode.

If the phone is not recognized, another HFT-compatible phone, which is not compatible for *Bluetooth*® Audio, may already be connected.

■ To pause or resume a file

Select the play icon or pause icon.

■ Searching for Music

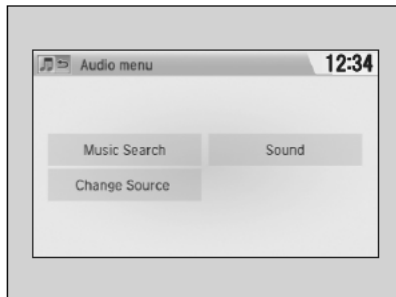

1. Select **MENU**.
2. Select **Music Search**.
3. Select a search category (e.g., Albums).
4. Select an item.
 - ▶ The selection begins playing.

▶▶ To Play *Bluetooth*® Audio Files

To play the audio files, you may need to operate your phone. If so, follow the phone maker's operating instructions.

Switching to another mode pauses the music playing from your phone.

▶▶ Searching for Music

Depending on the *Bluetooth* device you connect, some or all of the lists may not be displayed.

Playing a Video Using the HDMI®

Your audio system allows you to play videos from an HDMI®-compatible device. Connect the device, using an HDMI® cable, then select the HDMI® mode.

📺 **USB/HDMI®* Port** P. 143

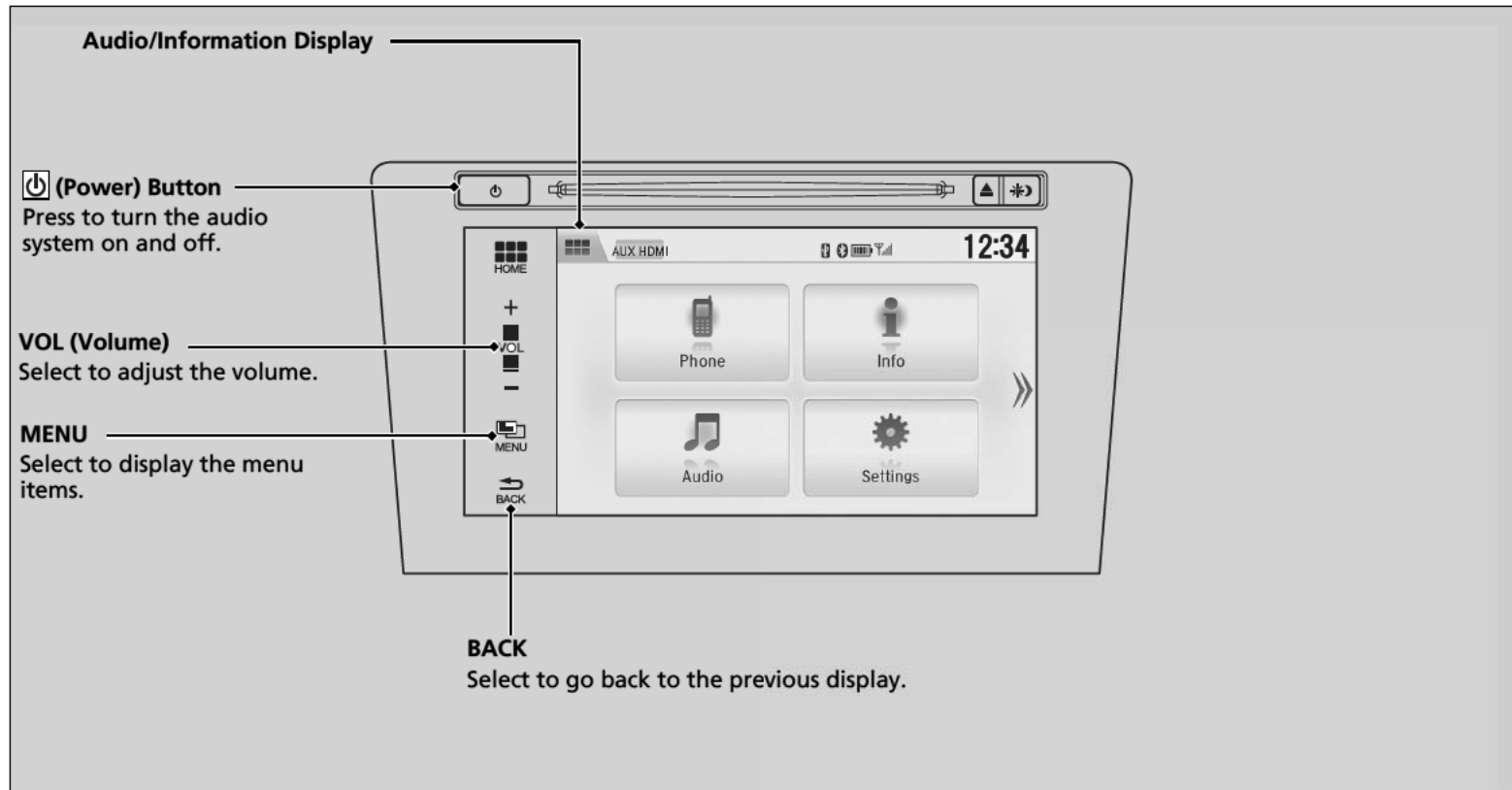

■ Changing the Screen Aspect

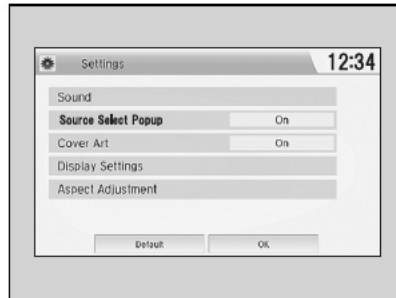

1. Select **Settings** to go to the **Settings** screen.
2. Select **Audio Settings**.
 - ▶ Repeat the procedure to select **Aspect Adjustment**.
3. Select the setting you want.
4. Select **OK**.

▶▶ Playing a Video Using the HDMI®

This feature is limited while driving. To play videos, stop your vehicle and apply the parking brake.

Smartphone Connection

Some of your smartphone apps can be displayed and operated on the display audio screen when the phone is connected to the display audio system. You can connect your phone using a cable, or wirelessly*.

➤ **Connecting Your iPhone** P. 183

Except iPhone

➤ **Connecting Your Smartphone** P. 184

➤ **Wi-Fi mode (setting for the first time)** P. 185

To use smartphone connection, you need to first pair your smartphone to the display audio via *Bluetooth*®.

➤ **Phone Setup** P. 214

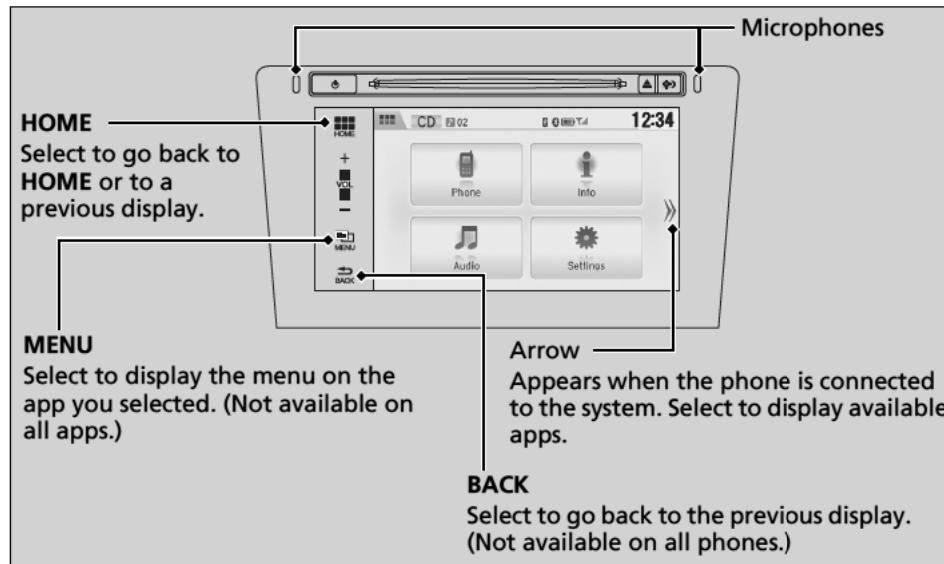

Smartphone Connection

Park in a safe place before connecting your phone and while operating the displayed apps.

Not all phones are compatible with the system. The system does not display all the available apps on smartphone, and some apps need to be preinstalled. Ask a dealer for details.

You need to switch the *Bluetooth* connection to your smartphone if another electronic device is connected.

➤ **Changing the currently paired phone**
P. 215

The following may vary by phone type:
Connection methods
Apps that can be operated on the display audio
Which app functions are operable
Display response time/update time
We do not support all the apps operable on the display audio.
Ask the app provider for any queries on the app's features.

Do not get drawn into the display while operating a vehicle.

■ Connecting Your iPhone

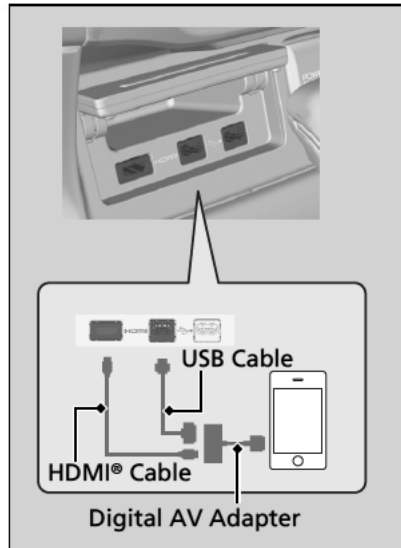

1. Connect your phone to the display audio via *Bluetooth*®.
▶ **Phone Setup** P. 214
2. Plug in the digital AV adapter to the HDMI® jack.
3. Connect the digital AV adapter to your iPhone.
▶ Wait until an arrow appears on **HOME** screen.
4. Select the arrow to display the available smartphone apps on the display audio.
▶ You may need to operate from the phone.
5. Select an app you want to operate from the display audio.
▶ To go back to the previous screen, select **HOME**.

☒ Connecting Your iPhone

Make sure to plug in the digital AV adapter to the HDMI® jack first. If not, smartphone connection may not work properly.

To recharge your phone, connect it to the USB jack, too.

Contact a dealer for the digital AV adapter purchasing information.

Continued

Features

Except iPhone

■ Connecting Your Smartphone

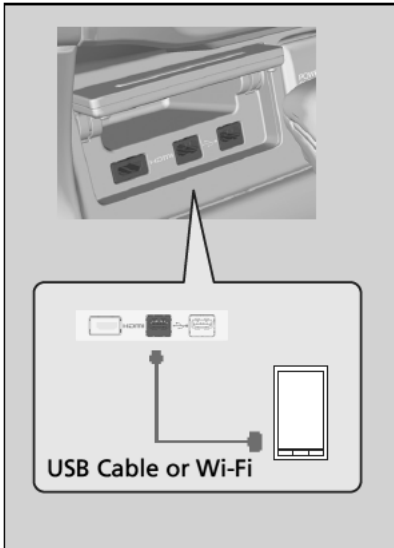

1. Connect your phone to the display audio via *Bluetooth*®.
 - ▶ **Phone Setup** P. 214
2. Plug in your phone to the USB jack.
 - ▶ You may need to operate from the phone.
 - ▶ Wait until an arrow appears on **HOME** screen.
3. Select the arrow to display the available smartphone apps on the display audio.
4. Select an app you want to operate from the display audio.
 - ▶ To go back to the previous screen, select **HOME**.

▶▶ Connecting Your Smartphone

The phone is rechargeable while being connected to the USB jack. However, if the phone is overloaded with many operational tasks, the battery level may get lowered.

■ Wi-Fi mode (setting for the first time)

If your phone has Wi-Fi connectivity, you can set smartphone connection in Wi-Fi mode.

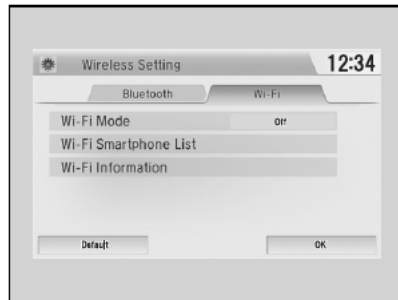

1. Connect your phone to the display audio via *Bluetooth*®.
 - ▶ **Phone Setup** P. 214
 - ▶ Make sure your phone's Wi-Fi setting is in access point (tethering) mode.
2. Select **Settings** from the **HOME** screen.
3. Select **Wireless Settings**.
 - ▶ Open the Wi-Fi tab.
4. Select **Wi-Fi Mode**, then **On**.
 - ▶ A confirmation message appears on the screen. Select **Yes**.

⌘ Wi-Fi mode (setting for the first time)

You cannot go through the setting procedure while a vehicle is moving. Park in a safe place to set the display audio in Wi-Fi mode.

Some telecom carriers charge for tethering. Check your phone's subscribed package.

Check your phone manual to find out if the phone has Wi-Fi connectivity.

Continued

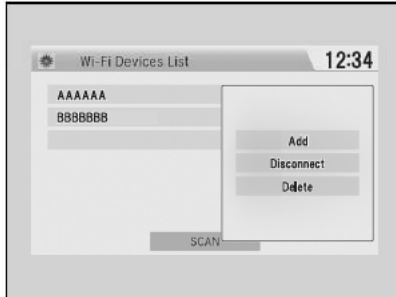

5. Select Wi-Fi Smartphone List.

- ▶ Select the phone you want to connect to the system.
- ▶ If you do not find the phone you want to connect in the list, select **Scan**.

6. Select Add.

- ▶ Enter a password set for your phone, and select **OK**.

7. Select HOME to go back to HOME.

- 8. Select the arrow to display the available smartphone apps on the display audio. Select an app you want to operate from the screen.**
- ▶ To go back to the previous screen, select **HOME**.

»» Wi-Fi mode (setting for the first time)

On some phones, you may need to activate a particular app prior to display all the available apps in step 8.

■ **Wi-Fi mode (after the initial setting has been done)**

Make sure your phone's Wi-Fi setting is in access point (tethering) mode.

On some phones, you may need to activate a particular app prior to display all the available apps.

Siri Eyes Free Mode

You can talk to Siri using the Talk button on the steering wheel when your iPhone is paired to *Bluetooth*® Handsfreelink.

📱 **Phone Setup** P. 214

Using Eyes Free Mode

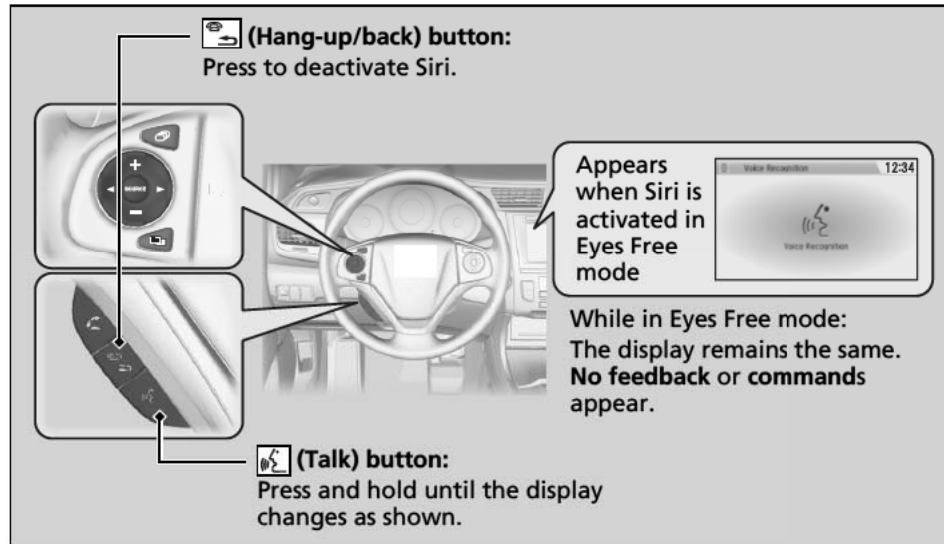

Features

▶▶ Siri Eyes Free Mode

Siri is a registered trademark owned by Apple Inc.

Eyes Free mode is capable of operating the following features by commands:

- Sending and reading text messages, and sending email messages.
- ▶ You need to have your own email address on your iPhone.
- Setting up calendar entries, reminders, and alarms.
- Checking the weather.
- Turn-by-turn iPhone directions.
You can hear turn-by-turn directions through your vehicle only while listening to audio using your iPhone.

Some features may not be available for all countries or all areas. Check Apple Inc. website for more details.

We recommend against using Siri other than in Eyes Free mode while operating a vehicle.

▶▶ Using Eyes Free Mode



Some commands work only on specific phone features or apps.

Audio Error Messages

CD Player

If a disc error occurs, you may see the following error messages.

Models without display audio system

Error Message	Cause	Solution
HEAT	High temperature	<ul style="list-style-type: none">• Turn the audio system off and allow the player to cool down until the error message is cleared.
FORMAT	Track/file format not supported	<ul style="list-style-type: none">• Current track/file will be skipped. The next supported track/file plays automatically.
BAD DISC CHECK MANUAL	Mechanical error	<ul style="list-style-type: none">• Press the  (eject) button and remove the disc, and check that the error message is cleared.• Check that the disc is not damaged or deformed, and insert the disc again.<ul style="list-style-type: none">➤ Protecting CDs P. 194
CHECK DISC	Servo error	<ul style="list-style-type: none">• If the error message reappears, press the  button, and pull out the disc.• Insert a different disc. If the new disc plays, there is a problem with the first disc.• If the error message repeats, or the disc cannot be removed, contact a dealer. Do not try to force the disc out of the player.