



NEC

NWA-xxxxxx-001

Issue 1.0

MH250



USERS GUIDE

NEC Infrontia Corporation
2006 August

LIABILITY DISCLAIMER

NEC Infrontia Corporation reserves the right to change the specifications, functions, or features, at any time, without notice.

NEC Infrontia Corporation has prepared this document for use by its employees and customers. The information contained herein is the property of NEC Infrontia Corporation and shall not be reproduced without prior written approval from NEC Infrontia Corporation. All brand names and product names on this document are trademarks or registered trademarks of their respective companies.

Copyright 2006

NEC Infrontia Corporation

User Safety Protocol

Important: Read this information before using your MH250 Handset.

Observe the following instructions to use this product safely, prevent you and other people from possible injury, and protect properties. Improper handling may cause heat, explosion, and fire.

Danger

- Recharge the battery with the matching battery charger (see battery label description).
- Use the battery only for this MH250 handset system. Do not use it with other electrical devices.
- Keep the following warnings to prevent the battery pack from heating, explosion, and fire.
 - Do not throw the battery pack into fire.
 - Do not solder the battery pack directly.
 - Do not short the positive (+) and negative (-) terminal of the battery pack with metal.
 - Do not poke the battery nor smash it with hammer.
- Do not disassemble nor modify the battery pack. It has a safety circuit and a damaged circuit may cause heat, explosion, and fire.
- The internal liquid of the battery pack has strong acid. If the battery liquid gets into your eye, rinse your eye well with water and consult with a doctor.
- Do not use, leave, nor recharge the battery pack near fire or under the direct sunlight. High temperature may damage the internal safety circuit and may cause malfunction of the recharge, heat, explosion, or fire.

Warning

- Do not use the unit when you notice smoke, strange smell or other unusual happenings. It may cause fire if you continuously use them. Turn off the power switch of the phone system immediately. For the recharger, disconnect the power plug immediately. Confirm that smoke is ceased, and then contact the nearest NEC service office. Never attempt to repair those units by yourself.
- If you had an accident such as dropping the phone and broke the unit, turn off the power of the phone system immediately. For the recharger, disconnect the power plug immediately. Contact the nearest NEC service office. If you keep using those units, they may cause fire or electrical shock.
- If water smeared into the unit, turn off the power of the phone system immediately. For the recharger, disconnect the power plug immediately. Contact with the nearest NEC service office. If you keep using those units, they may cause fire or electrical shock.
- Do not insert flammable or metal objects into the units. If a foreign object were accidentally placed into the units, turn off the power of the phone system and plug out the power adapter. Contact the nearest NEC service office. If you keep using those units, they may cause fire or electrical shock. Pay special attention to children to prevent from similar accidents.
- Do not attempt to disassemble nor modify the units. It may cause fire, electrical shock, or system malfunction. Modification by a user is prohibited by law.
- Do not open the units intentionally. It may cause electrical shock or system malfunction. Ask test adjustment, and repair of the units for the nearest NEC service office.
- Do not twist, put a heavy object, and push the phone system. Such actions may cause damage, fire, or injuries.
- Do not place a container with water such as a vase, a plant pot, a cup, cosmetics, chemicals, nor a small metal object. Splashing water over the units and foreign metal object inserted into the units may cause fire or electrical shock.
- Do not use the unit in a high humid area such as a bathroom or near a humidifier. They may cause fire, electrical shock, or system malfunction.
- Use the specified power adapter, which is attached to the unit. Other adapters may cause fire or system malfunction.
- Do not damage, or modify the power adapter cord. Do not kink, pull, twist, or bundle it. Do not put a heavy object or heat it. They may cause fire, electrical shock, or system malfunction. Contact the nearest NEC service office for a damaged adapter cord.
- Do not touch the power plug with a wet hand. It may cause electrical shock or system malfunction.
- Do not touch the units or replace a battery with a wet hand. It may cause electrical shock or system malfunction.
- When you hear thunder during using the phone system outside, immediately stop using it and move to a safe place.
- Do not use a multiple plugs. It may cause fire or electrical shock.
- Follow the instruction below when you use a battery pack. They may cause heating, explosion, and fire;
 - Do not put the battery pack into a microwave oven or a pressure chamber.
 - Do not use other batteries with this battery pack.
- If the internal battery liquid clung to your skin or clothes, immediately rinse it with clean water to prevent chemical damage to your skin and clothes.
- Do not use the phone or recharge the battery in a place where fire or explosion may occur.
 - This phone system does not have explosion protection. Do not use it where a flammable gas such as propane and gasoline are stored. Turn off the power of the phone immediately. Do not recharge the battery in such a place.
- Do not use near microwave ovens, medical equipments and industrial equipments.

Federal Communication Commission Interference Statement

.....

This equipment has been tested and found to comply with the limits for a Class B digital device, pursuant to part 15 of the FCC Rules. These limits are designed to provide reasonable protection against harmful interference when the equipment is operated in a commercial environment. This equipment generates, uses, and can radiate radio frequency energy and, if not installed and used in accordance with the instruction manual, may cause harmful interference to radio communications. However, there is no guarantee that interference will not occur in a particular installation. If this equipment does cause harmful interference to radio or television reception, which can be determined by turning the equipment off and on, the user is encouraged to try to correct the interference by one of the following measures:

- Reorient or relocate the receiving antenna.
- Increase the separation between the equipment and receiver.
- Connect the equipment into an outlet on a circuit different from that to which the receiver is connected.
- Consult the dealer or an experienced radio/TV technician for help.

This device complies with part 15 of the FCC Rules. Operation is subject to the following two conditions: (1) This device may not cause harmful interference, and (2) this device must accept any interference received, including interference that may cause undesired operation.

CAUTION:

Any changes or modifications not expressly approved by the party responsible for compliance could void the user's authority to operate the equipment.

IMPORTANT NOTE:

This equipment complies with FCC radiation exposure limits set forth for an uncontrolled environment. End users must follow the specific operating instructions for satisfying RF exposure compliance. To maintain compliance with FCC RF exposure compliance requirements, please avoid direct contact to the transmitting antenna during transmitting.

This transmitter must not be co-located or operating in conjunction with any other antenna or transmitter.

We declare that the product is limited in CH1 - CH11 by specified firmware controlled in the USA.

Equipment Class : Digital Transmission System

Notes : WLAN IP Phone

<u>FCC Rule Parts</u>	<u>Frequency Range(MHZ)</u>	<u>Output Watts</u>
15C	2412.0 – 2462.0	0.02

Power Output is Conducted.

INDEX



INTRODUCTION 1

- WHAT IS MH250? 1
- KEYS AND PARTS 2
- ICONS 3
- TWO OPERATIONAL MODES 3

GETTING STARTED 5

- SHIPPED PARTS 5
- HOW TO INSERT THE BATTERY 5
- HOW TO CHARGE THE BATTERY 6

BASIC OPERATIONS 8

- TO TURN ON THE PHONE (STANDBY MODE) 8
- TO TURN OFF THE PHONE 8
- TO ANSWER A CALL 8
- TO REJECT A CALL 8
- TO MAKE A CALL 8
- TO PLACE A CALL ON HOLD 9
- TO TRANSFER A CALL 9
- TO REDIAL (LAST NUMBER REDIAL) 9

FEATURES 10

- TO USE CALL FORWARDING - ALL CALLS 10
- TO USE CALL FORWARDING - DON'T ANSWER 10
- TO USE CALL FORWARDING - NO RESPONSE 10
- TO USE CALL FORWARDING - BUSY 11
- TO USE CALL PICKUP 11
- TO USE CALL PARK 11
- TO USE CALL BACK 12
- TO USE CALL WAITING 12
- TO USE CONFERENCE 12

INDEX



- TO LOCK/UNLOCK THE PHONE 12
- TO ADJUST RECEIVER VOLUME 13

CALL HISTORY 15

- TO VIEW CALL HISTORY 15
- TO MAKE A CALL FROM CALL HISTORY 16
- TO ADD PHONE NUMBER AND NAME TO DIRECTORY 16
- TO DELETE A CALL LOG 17
- TO DELETE ALL CALL LOGS 18

DIRECTORY 19

- TO VIEW DIRECTORY 19
- TO EDIT GROUP NAME 20
- TO ADD A NEW ENTRY 22
- TO DELETE A RECORD 23
- TO MAKE A CALL 24
- TO EDIT 25
- TO CREATE AN INSTANCE MESSAGE (IM) 26

SPEED DIAL 27

- TO SPEED DIAL 27
- TO ADD NEW ENTRY/EDIT 27
- TO ADD NEWY ENTRY FROM DIRECTORY 29
- TO DELETE AN ENTRY 30

SETUP 32

- DISPLAY BACKLIGHT 32
- DISPLAY CONTRAST(不可?) 32
- NOTIFY SETTING 33
- COURTESY MODE 34
- RING/VIBRAOTR 35
- RING VOLUME 36

INDEX



- CALL VOLUME 37
- KEY CLICK 38
- MUSIC SELECT 39
- RTP ALARM 40
- H.O. TONE 41
- DATE AND TIME ADJUSTMENT 42
- DATE FORMAT 43
- TIME FORMAT 44
- DAYLIGHT SAVING 45
- TIME ADJUSTMENT MEANS 46
- SNTP QUERY TIME 47
- TIME OFFSET 48
- PASSWORD 49
- LANGUAGE 50

LOCAL INFO 51

- TO DISPLAY LOCAL INFO 51

LOCK/UNLOCK 52

- TO LOCK THE PHONE 52
- TO UNLOCK THE PHONE 52

PRESENCE 54

- TO CHANGE PRESENCE 54
- TO VIEW PRESENCE 54

SHORT MESSAGE 56

- SHORT MESSAGE INDICATION 56
- TO VIEW SHORT MESSAGE 56
- TO SEND A SHORT MESSAGE 57

TECHNICAL SPECIFICATIONS 58

INDEX



- TECHNICAL SPECIFICATIONS 58

Template 1

- 2

1.INTRODUCTION

• WHAT IS MH250?

MH250 is a wireless IP telephone set that complies with IEEE 802.11b specifications. MH250 has the following features:

- PCS/PHS equivalent service features by connecting with UNIVERGE SV7000, NEAX2400IPX, and WLAN system.
- Phonebook, Instant Message, Presence



- 機能紹介

• KYES AND PARTS

The phone has the following keys and parts.

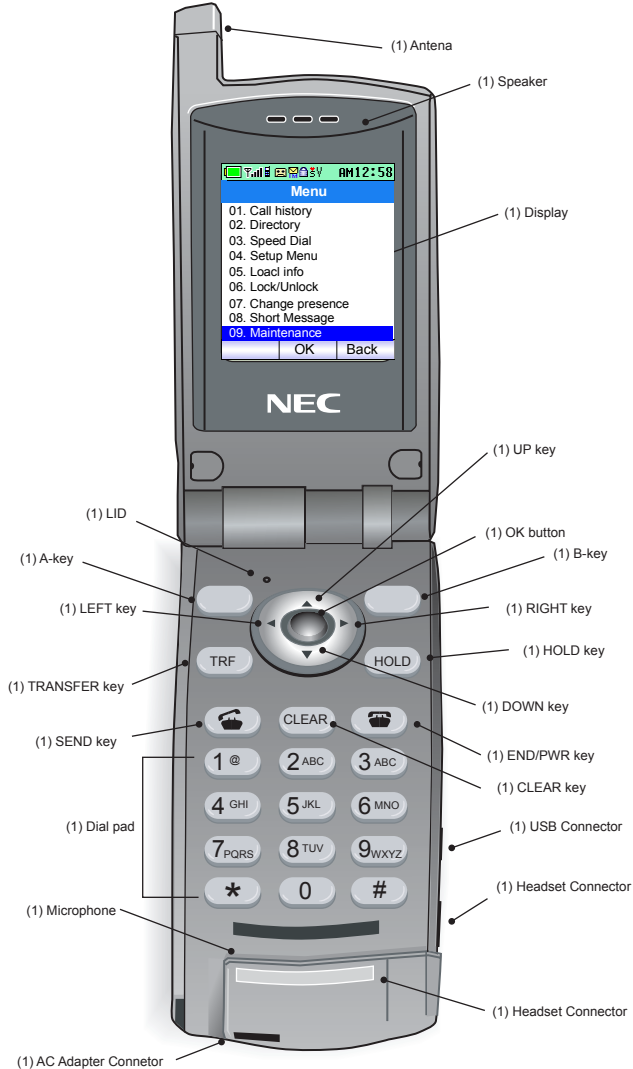
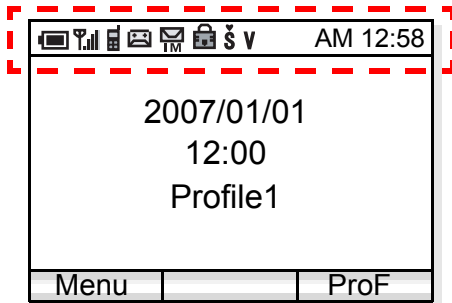









Table 1:Keys And Parts

1	Antenna	
2	Speaker	
3	Display	2.0 inch LCD, resolution is 176 x 220 pixel
4	LID	
5	UP key	
6	LID	
7	A-key	Used for the left soft key.
8	B-key	Used for the right soft key.
9	OK key	Used for the center soft key.
10	UP key	
11	DOWN key	
12	LEFT key	
13	RIGHT key	
14	TRF key	
15	HOLD key	
16	SEND key	
17	CLEAR key	
18	HOLD key	Used for placing the ongoing call in hold.
19	Dial Pad	* key is also used for Courtesy mode.
20	USB Connector	Used for connecting USB cable.
21	Headset Connector	Used for connecting headset.
22	Microphone	
23	AC Adapter Connector	

• ICONS

The following explains icons from left to right.



- Power icon (): indicates battery strength
- Antenna icon (): indicates the radio signal strength received
- VoIP icon (): indicates communication is available on your phone
- VM icon (): indicates you have a voice mail
- IM icon (): indicates you have an instant message
- Lock icon (): indicates your phone is locked
- Courtesy icon (): indicate your phone is in courtesy mode
- Vibrator icon (): indicates vibration is set to ON

• TWO OPERATIONAL MODES

The phone operates in one of the following two modes:

- Standby mode (default mode)
- Menu mode

Standby Mode:

When the phone is turned on, it is placed in this mode. The phone displays the 1st screen similar to the following.

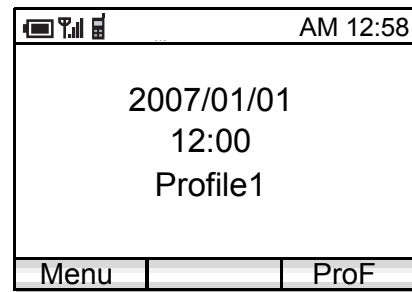

Menu Mode:

Press  soft key on the phone to activate Menu

mode. The following Main Menu will be displayed.

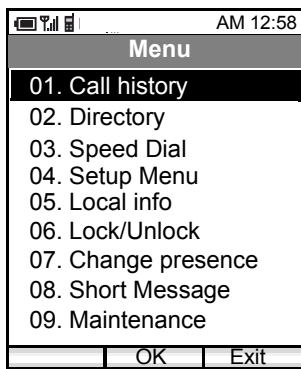

2.GETTING STARTED

• SHIPPED PARTS

MH250 is shipped with the following components. Make sure that you have all before using the phone.

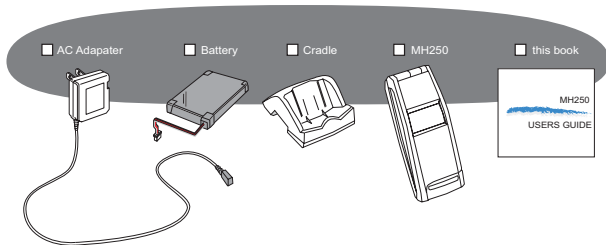

• HOW TO INSERT THE BATTERY

Insert the battery into the unit as follows.

(1) Remove the rear cover from the phone.

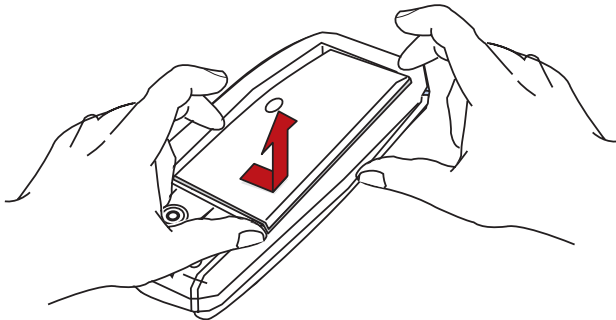

(2) Connect the cable to the unit and then place the battery into the unit so that the label may face toward you.

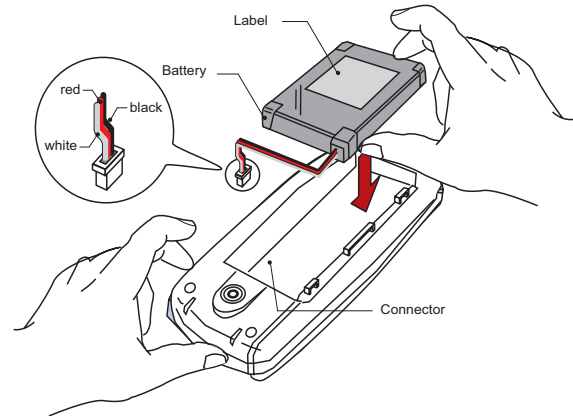

(3) Attach the rear cover again.

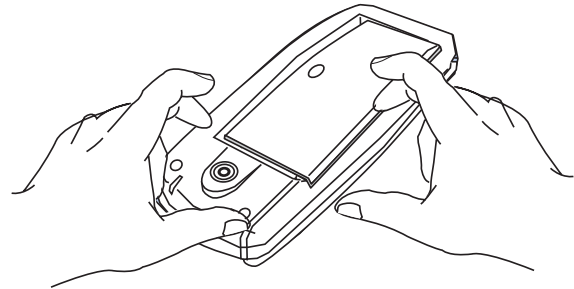

• HOW TO CHARGE THE BATTERY

Be sure to charge the battery when using the phone for the first time. You can charge the battery by using one of the following:

- Cradle
- PC via USB cable
- AC Adapter (direct connection)

By Using the Cradle:

The phone can be charged by using the shipped cradle.

- (1) Insert the AC Adapter plug into the jack in the bottom of the cradle.
- (2) Plug in the AC adapter to an appropriate outlet.
- (3) Place the phone on the cradle as shown below.
- (4) Info-LED turns on, indicating the battery is being charged.
- (5) Info-LED turns off when the battery is recharged.



The empty battery can be recharged for about 3 hours.

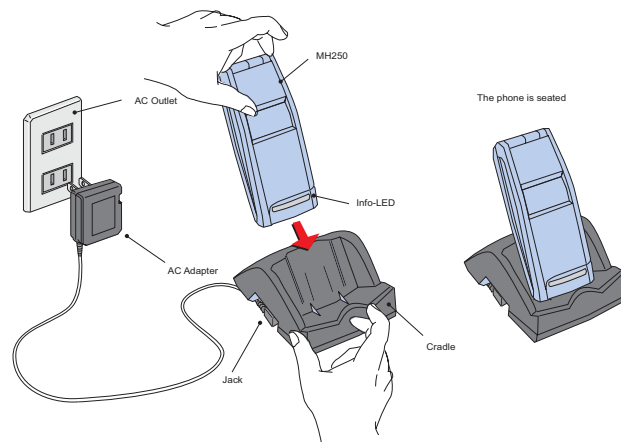

By Using the USB Cable:

The phone can be charged by using your PC via a USB cable.

- (1) Insert the USB connector into the USB jack.
- (2) Insert the other end of the cable to your PC.

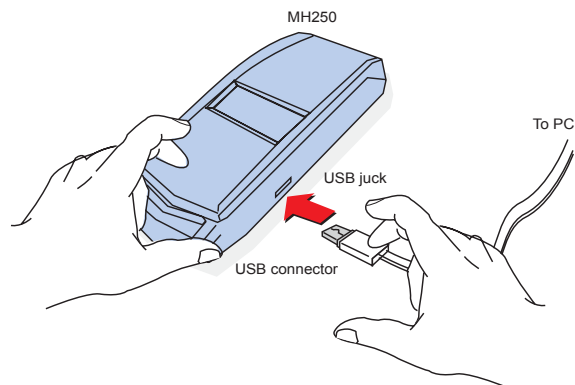

By Using the AC Adapter:

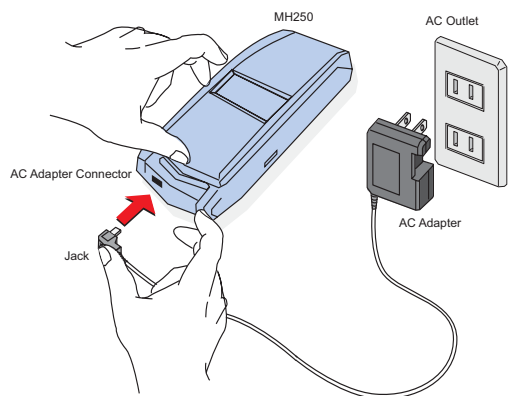

3. BASIC OPERATIONS

• TO TURN ON THE PHONE (STANDBY MODE)

Press and hold  key for 1 second or more. The start screen appears as follows. **Note**

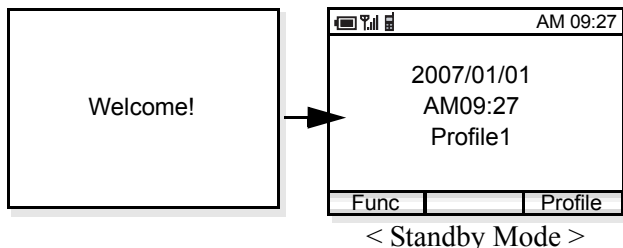

Note: This initial screen is called Standby Mode in this book.

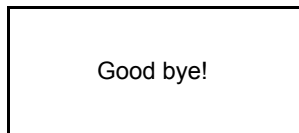

• TO TURN OFF THE PHONE

Press and hold  key for 3 seconds or more. “Good bye!” is displayed.



• TO ANSWER A CALL

When receiving an incoming call, the display automatically changes to Incoming Call screen.

- To answer the call, press  key.
- To end the call, press  key.

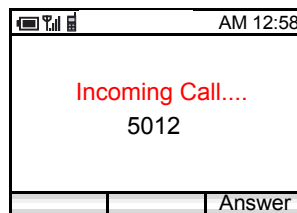



Note: When the calling party has been already registered in the Phonebook, the registered name is displayed.

• TO REJECT A CALL

To reject an incoming call, press  key.

• TO MAKE A CALL

To make a phone call, do one of the following:

- Enter the phone number and then press  key.
- Press  key and then enter the phone number.

Note: Before making a call confirm the following.

- (i) Power is ON?
- (ii) Battery is charged?
- (iii) VoIP Icon/Antenna icons OK?

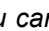

By pressing  key, you can delete the last digit of the dialed number.

• TO PLACE A CALL ON HOLD

During an active call, you can hold the call.

- Press **HOLD** key to hold the line. The phone displays:

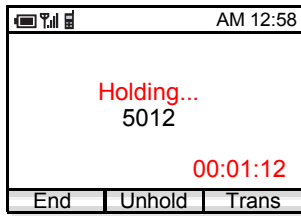

- Press **HOLD** key or  key to retrieve the line.

• TO TRANSFER A CALL

During an active call, you can transfer the call to other phone.

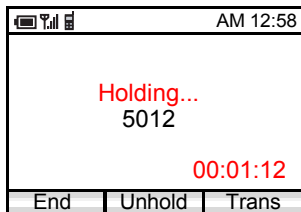

- Press **TRF** key during the call. The phone displays:



- After hearing Special Dial Tone, enter the phone number to transfer the call.
- Press **???** key to complete the transfer.

• TO REDIAL (LAST NUMBER REDIAL)



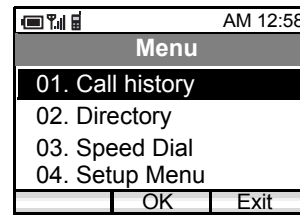

You can make a call from the Call History. A maximum of the last 20 calls can be recorded.

- Press **Menu** key in standby mode. The phone displays the Main Menu.
- Press  key to select “01. Call history” and then press  key.

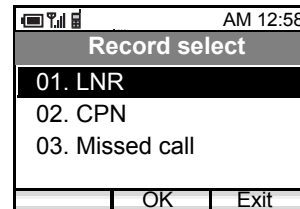

- Press  key to select “01. LNR (Last Number Redial)” and then press  key.





- Press  key to select a desired party you want to redial and then press  key.
- Press  key or  key to redial the party.

4.FEATURES

• TO USE CALL FORWARDING - ALL CALLS

To Set:

- Enter CALL FORWARDING - ALL CALLS (SET) access code.
- Press  key and then hear Special Dial Tone.
- Dial a desired phone number to which you want to forward incoming calls and then receive Service Set Tone (The feature has been set).
- Press  key.

To Cancel:

- Enter CALL FORWARDING - ALL CALLS (CANCEL) access code.
- Press  key and then receive Service Set Tone (The feature has been cancelled).

• TO USE CALL FORWARDING - DON'T ANSWER

To Set:

- Enter CALL FORWARDING - DON'T ANSWER (SET) access code.
- Press  key and then hear Special Dial Tone.



- Dial a desired phone number to which you want to forward incoming calls and then receive Service Set Tone (The feature has been set).
- Press  key.

To Cancel:

- Enter CALL FORWARDING - DON'T ANSWER (CANCEL) access code.
- Press  key and then receive Service Set Tone (The feature has been cancelled).

• TO USE CALL FORWARDING - NO RESPONSE

To Set:



- Enter CALL FORWARDING - NO RESPONSE (SET) access code.
- Press  key and then hear Special Dial Tone.
- Dial a desired phone number to which you want to forward incoming calls and then receive Service Set Tone (The feature has been set).
- Press  key.

To Cancel:

- Enter CALL FORWARDING - NO RESPONSE (CANCEL) access code.
- Press  key and then receive Service Set Tone (The feature has been cancelled).

• TO USE CALL FORWARDING - BUSY

To Set:

- Enter CALL FORWARDING - BUSY (SET) access code.
- Press  key and then hear Special Dial Tone.
- Dial a desired phone number to which you want to forward incoming calls and then receive Service Set Tone (The feature has been set).
- Press  key.

To Cancel:

- Enter CALL FORWARDING - BUSY (CANCEL) access code.
- Press  key and then receive Service Set Tone (The feature has been cancelled).

• TO USE CALL PICKUP

You can pick up an incoming call within the pickup group.

- A phone in the call pickup group receives an incoming call. The phone starts ringing.
- Enter CALL PICKUP access code and then press  key while the phone is ringing.
- The call is picked up and then connection is established.

• TO USE CALL PARK

You can park the ongoing call and replace the handset. The opposite party is placed in hold. You can retrieve the held call from the original phone or other phone by using access code.

To Park a Call:

- Press  key during a call in progress.

To Retrieve the Call from the Original Phone

- Enter CALL PARK - LOCAL RETRIEVAL access code and then press  key.

To Retrieve the Call from Other Phone:

- Enter CALL PARK - REMOTE RETRIEVAL access code (ex. 11) and the station number of the original phone (ex. 5111) in succession (ex. 11 + 5111).
- Press  key and then connection is established.

• TO USE CALL BACK

You can set CALL BACK if the attempted call encounters a busy condition.

- Press **TRF** key and then dial CALL BACK access code when the called party is busy.
- Receive Service Set Tone and then press **☎** key. (Please wait a while until the called party becomes idle)
- When the called party becomes idle, your phone rings.
- Press **☎** key and then receive Ring Back Tone (The opposite party is ringing).
- Connection is established when the opposite party answers.

• TO USE CALL WAITING

To Activate CALL WAITING - ORIGINATING:

- Dial a desired station number - receive Busy Tone.
- Press **TRF** key and then dial CALL WAITING access code.
- Receive Special Ring Back Tone.
- CALL WAITING tone is sent to the busy station.

To Answer the Waiting Call

- CALL WAITING TONE is heard.
- Press **TRF** key and then the Waiting Call is automatically connected by placing the opposite party in hold.
- By pressing **TRF** key you can switch the call between the original party and the new party.

• TO USE CONFERENCE

- Press **TRF** key during a call in progress and then receive Special Dial Tone. (The opposite party is placed in hold)
- Dial a desired phone number and then receive Ring Back Tone.
- When the called party answers, press **TRF** key.
- Three-way conference is established.

• TO LOCK/UNLOCK THE PHONE

~~You can lock the phone against unauthorized usage. This is also useful for guarding the phone against inadvertent button presses.~~

~~To Lock Keypad:~~

- Press **Menu** key in standby mode. The phone displays the Main Menu.
- Press **◆** key to select “06. Lock/Unlock” and then press **☎** key.

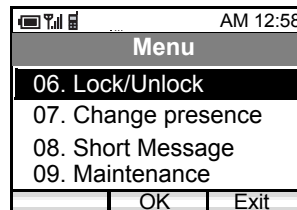

- ~~Enter your User Password (4 digits) by using dial pad and then press **☎** key.~~
- ~~The phone is locked and a lock **🔒** icon appears.~~

Note: ~~Each number is indicated by a * on the phone.~~

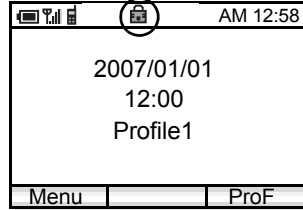
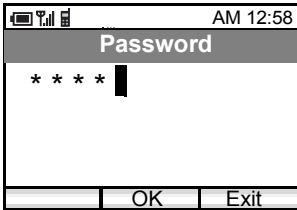

To Unlock Keypad:

- Press **Menu** key in standby mode. The phone displays the Main Menu.
- Press **◆** key to select “06. Lock/Unlock” and then press **⊙** key.
- Enter your User Password (4 digits) by using dial pad and then press **⊙** key.
- The phone is unlocked and the lock **🔒** icon disappears.

• TO ADJUST RECEIVER VOLUME

You can increase or decrease the receiver volume in standby mode or during a call. The volume can be set in seven steps (Level 1[minimum] <=> Level 7 [maximum]). The factory value is Level 5.

During a Call:

Press **◆** key to select a desired volume and then press

⊙ key while talking on the phone.

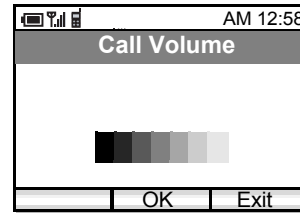

In Standby Mode:

- Press **Menu** key in standby mode. The phone displays the Main Menu.
- Press **◆** key to select “04. Setup Menu” and then press **⊙** key.

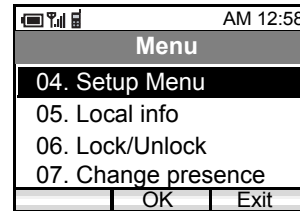

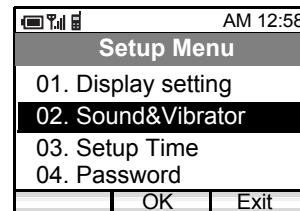

- Press **◆** key to select “02. Sound&Vibrator” and then press **⊙** key.



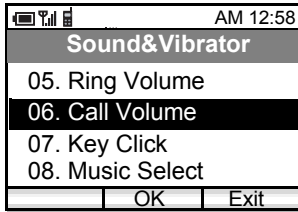

- Press **◆** key to select “06. Call Volume” and then press **⊙** key.

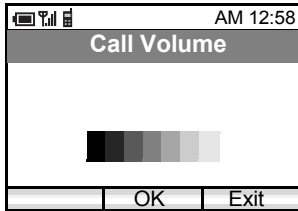

Press  key to select a desired volume and then press  key.



- Press  key or  key to return the standby mode.

5. CALL HISTORY

The phone can register recent call history in the following three lists:

- Last Number Redial (LNR)
- Calling Party Number (CPN)
- Missed Call

LNR is a list of Dialed Numbers and CPN is that of Received Calls. You can make a call from the list and also add a call log to Directory as needed.

• TO VIEW CALL HISTORY

- Press **Menu** key in standby mode. The phone displays the Main Menu.

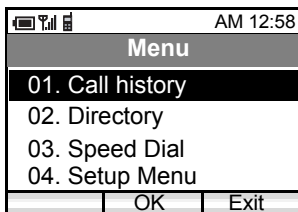

- Press **Down Arrow** key to select “01. Call history” and then press **Enter** key. The phone displays the following.

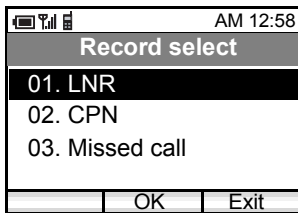

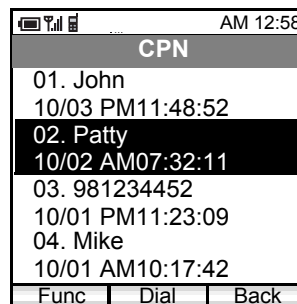

LNR: Last Number Redial
CPN: Calling Party Number

- Press **Down Arrow** key to select a desired item you want to view on the list and then press **Enter** key. The phone displays the following when “02. CPN” is selected.



• TO MAKE A CALL FROM CALL HISTORY

- Press  key to select a desired party you want to make a call and then press  key.

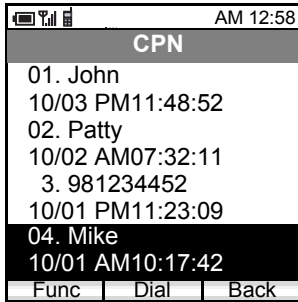

- Press  key to make the call.

Note: *If the phone number has not been registered to the history, Dial button will not appear.*

• TO ADD PHONE NUMBER AND NAME TO DIRECTORY

- Press  key to select a desired party you want to add to Directory.

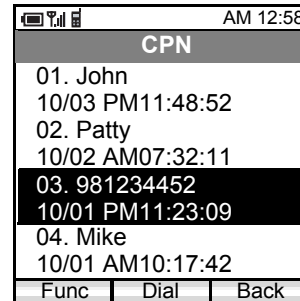

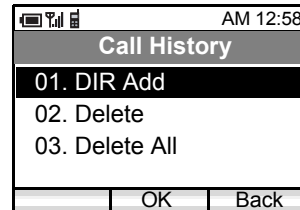

- Press  key.

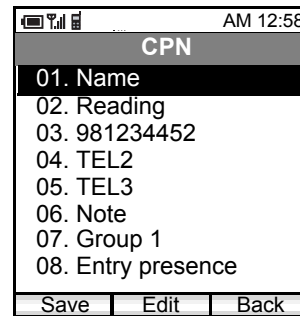

- Press  key to select “01. DIR Add” and press key.



- Press  key to select an item you want to edit and then press  key as required. In this example, Name and Reading will be edited.

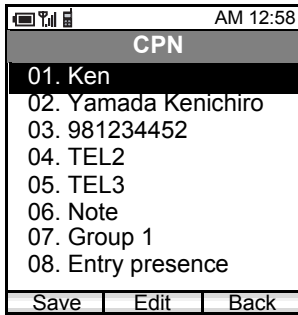

- Press **Save** key to save the data to Directory.

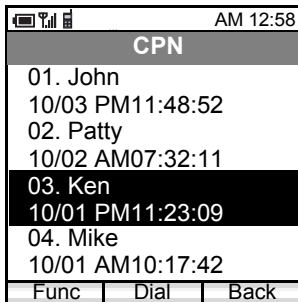

• TO DELETE A CALL LOG

- Press **◆** key to select an item you want to delete and then press **Func** key.

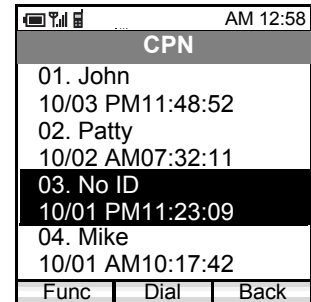

- Press **◆** key to select “01. Delete” and then press **⏪** key.

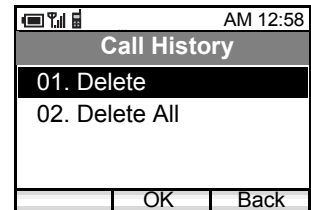

- Press **◆** key to select “Yes” and then press **⏪** key.

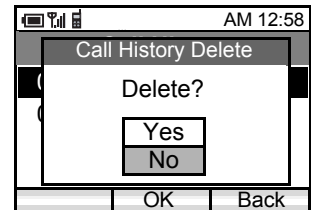

• TO DELETE ALL CALL LOGS

- Open a list (LNR/CPN/Missed Call) you want to delete and then press **Func** key.

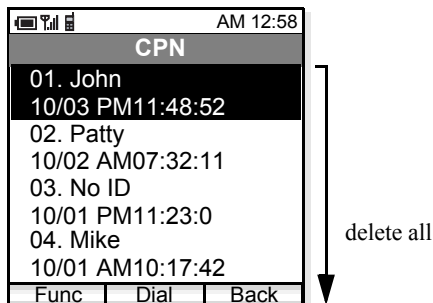

- Press **◆** key to select "02. Delete All" and then press **○** key.

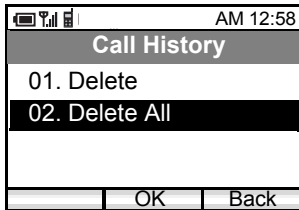

- Press **◆** key to select "Yes" and then press **○** key to delete all.

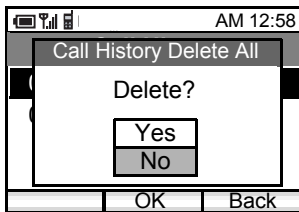

6. DIRECTORY

The phone can register a maximum of 400 phone numbers in the Directory. You can make a call from the Directory.

• TO VIEW DIRECTORY

- Press **Menu** key in standby mode. The phone displays the Main Menu.
- Press **◆** key to select “02. Directory”.

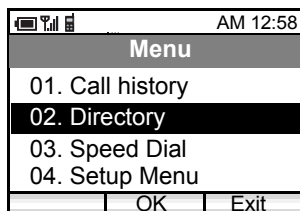

- The phone displays the following.

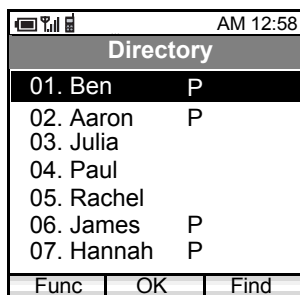

A letter P is added when the person is a target of PRESENCE feature.

- Press **Func** key. The following menu displays.

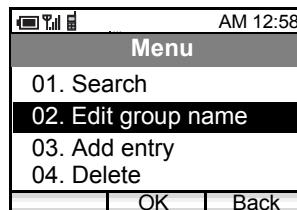

- Press **◆** key to select “01. Search” and then press **○** key. The phone displays Search menu.

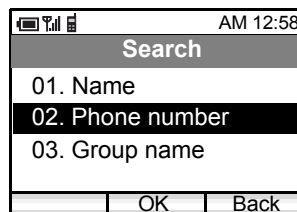

To Search by Name:

- Press **◆** key to select “01. Name” and then press **○** key.
- Enter a name you want to search in the Directory and then press **○** key.

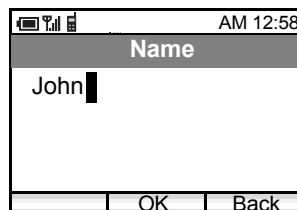

- Searched items will be displayed.

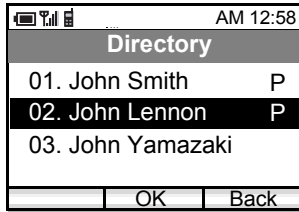

To Search by Phone Number

- Press **◆** key to select “02. Phone number” and then press **○** key.
- Enter a phone number you want to search in the Directory and then press **○** key.

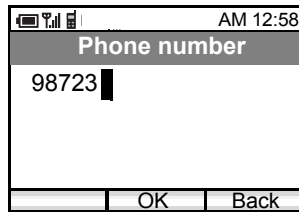

- Searched items whose phone number starts from “98723” will be displayed.

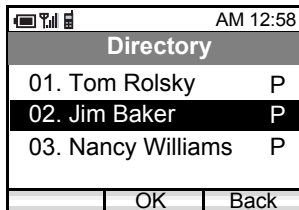

To Search by Group Name

- Press **◆** key to select “03. Group name” and then press **○** key.
- Press **◆** key to move between Group 1 to Group 10.

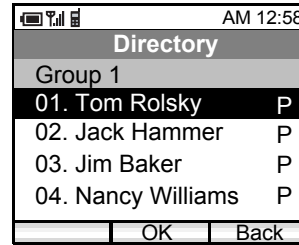

Group 1 ←→ Group 10

• TO EDIT GROUP NAME

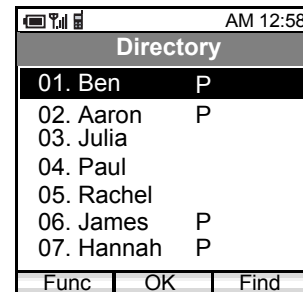

Default Group Name such as Group 1, can be edited as required.

- Press **◆** key to select “02. Directory” and then press **○** key. The phone displays the following.



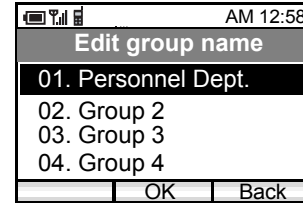
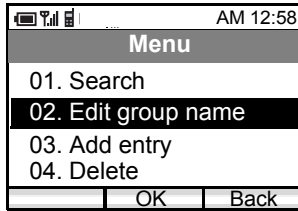

- Press **Func** key. The following menu displays.

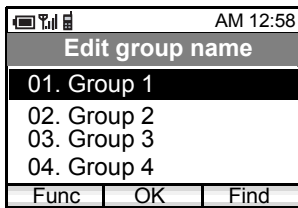

- Press  key to select “02. Edit group name” and then press  key. The phone displays Edit Group Name menu.



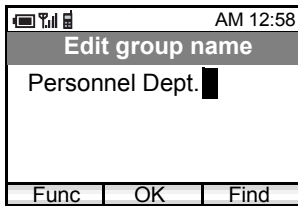

- Press  key to select a group you want to edit and then press  key. The phone displays Edit screen.
- Edit the group name and then press  key.





- The edited group name displays.

• TO ADD A NEW ENTRY

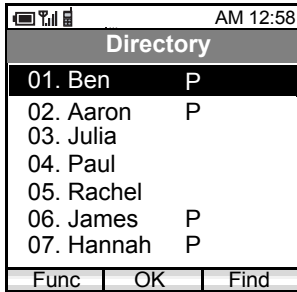

You can add new entry to the Directory.

- Press  key to select “02. Directory” and then press  key. The phone displays the following.



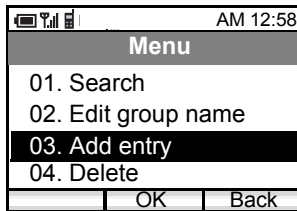

- Press  key. The following menu displays.

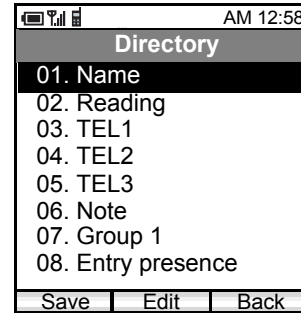

- Press  key to select “03. Add entry” and then press  key. The phone displays Edit Group Name menu.



- Press  key to select an item to be edited and then press  key.
- Edit the selected item. In the following example, Name data is edited.



To add a new entry “Name” must be edited.

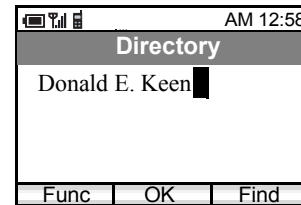

- Press  key to return the previous screen.

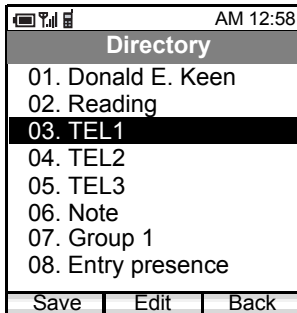

- Press key to select an item to be edited and then press key.
- Edit the selected item. In the following example, TEL1 data is edited.

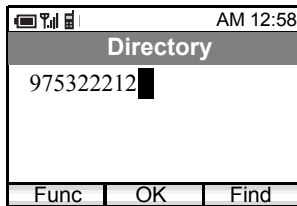

- Press key to return the previous screen.
- Repeat these steps as required for the new entry.

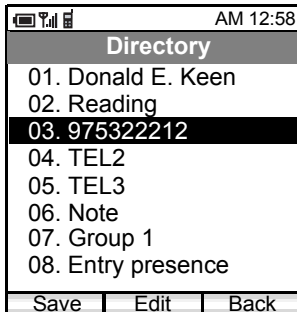

- When edit is complete press key.

• TO DELETE A RECORD

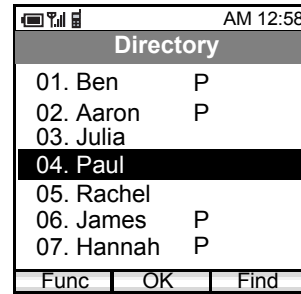

You can delete a record from the Directory.

- Press key to select “02. Directory” and then press key. The phone displays the following.

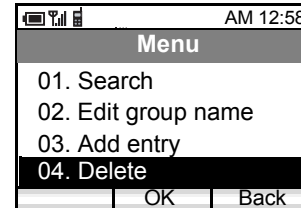

- Press key to select a record you want to delete on the Directory and then press key.
- Press key. The following menu displays.
- Press key to select “04. Delete” and then press key.



- Press  key to select “04. Delete” and then press  key. The phone displays Edit Group Name menu.

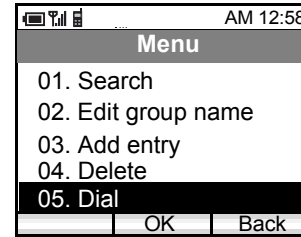
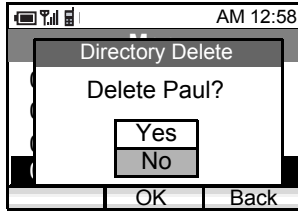



- Press  key to make the call.

• TO MAKE A CALL

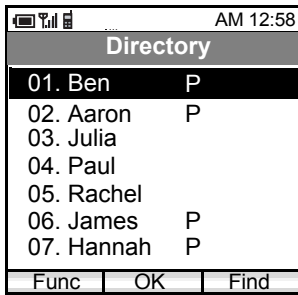
- On Directory page, press  key to select a party you want to make a call.



- Press  key and then the following menu displays.
- Select “05. Dial” and then press  key on the menu.

• TO EDIT

You can edit the Directory on a record basis.

- On Directory page, press **◆** key to select a record you want to edit.

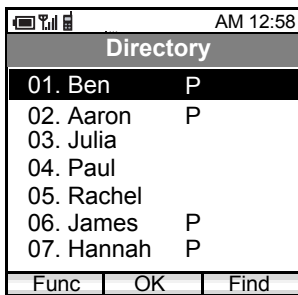

- Press **Func** key and then the following menu displays.
- Select “06. Edit” on the menu.

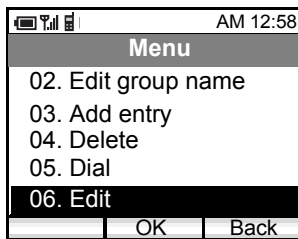

- Press **OK** key to edit the record.

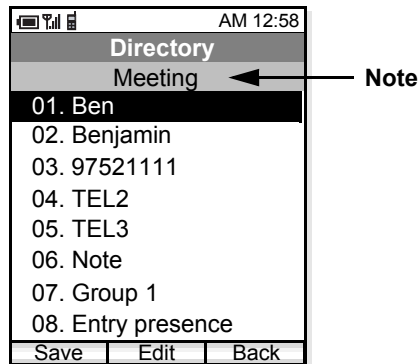

Note: *Presence data is indicated only when the record is the object of presence feature.d*

- Press **◆** key to select an item you want to edit and then press **Edit** key.
- When all edit is complete, press **Save** key.

• TO CREATE AN INSTANCE MESSAGE (IM)

You can create an Instance Message from the Directory.

- On Directory page, press **◆** key to select a person you want to send an IM.

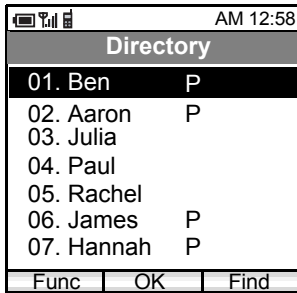

- Press **Func** key and then the following menu displays.
- Select "07. Create IM" on the menu.

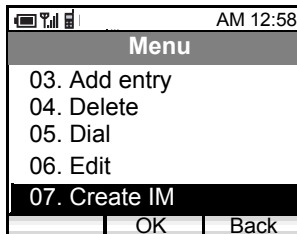

- Press **OK** key to edit the record.

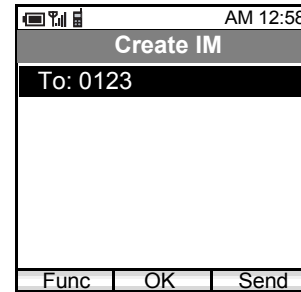

- When the message is complete, press **Send** key.

7. SPEED DIAL

The phone can use Speed Dial. A maximum of 10 entries are available.

• TO SPEED DIAL

- Press **Menu** key in standby mode. The phone displays the Main Menu.
- Press **◆** key to select “03. Speed Dial”.

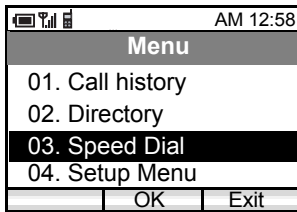

- The phone displays a Speed Dial list similar to the following.

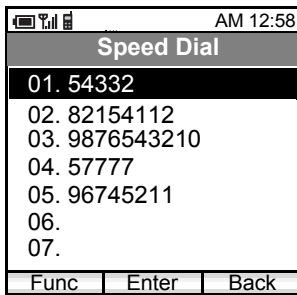

- To make a call to “03. 96781235” for example, press **3** key and then press **☎** key.

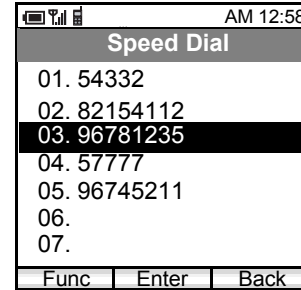

• TO ADD NEW ENTRY/EDIT

- Press **Menu** key in standby mode. The phone displays the Main Menu.
- Press **◆** key to select “03. Speed Dial”.

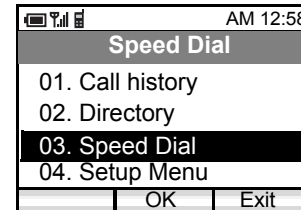

- The phone displays a Speed Dial list similar to the following.

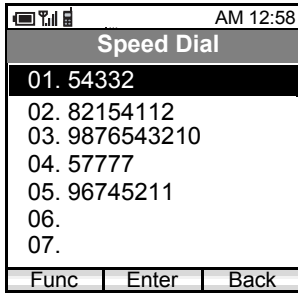

- Select an entry you want to add by using key. In the following example “07.” is selected.

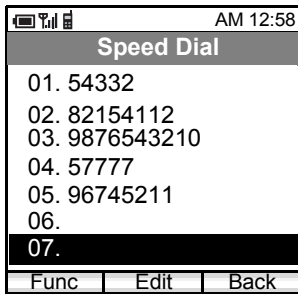

- Press key.
- The following Speed Dial Menu is displayed. Press key to select “01. Add” and then press key.

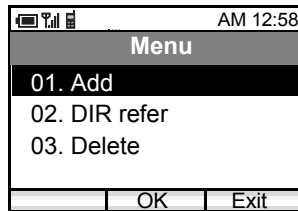

- Enter a phone number you want to add the list.

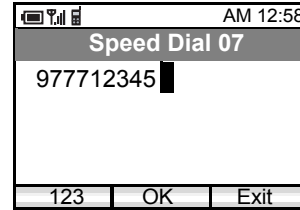

- Press key and then the new entry is added as follows.

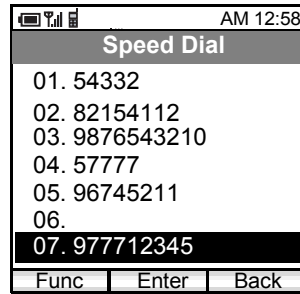

• TO ADD NEWY ENTRY FROM DIRECTORY

You can add a new entry referring to Directory.

- Press **Menu** key in standby mode. The phone displays the Main Menu.
- Press **◆** key to select “03. Speed Dial”.

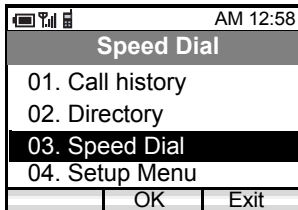

- The phone displays a Speed Dial list similar to the following.

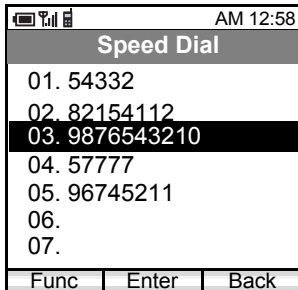

- Select an entry you wan to add by using **◆** key. In the following example “06.” is selected.

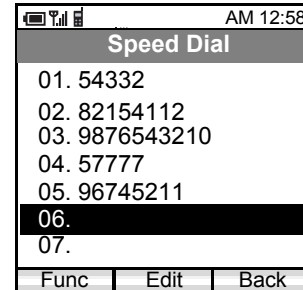

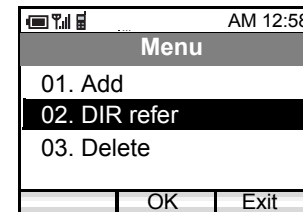

- Press **Func** key.
- The following Speed Dial Menu is displayed. Press **◆** key to select “02. DIR refer” and then press **Enter** key.

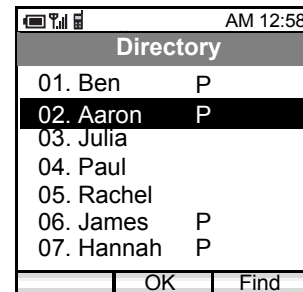

- The phone displays Directory. Select an entry you want to add by using **◆** key and then press **Enter** key.



- Select a phone number you want to add by using  key and then press  key.

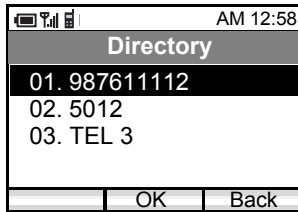

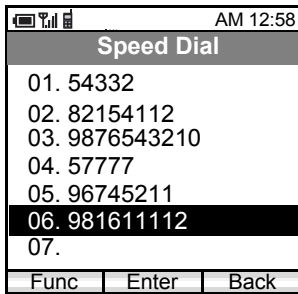

- The new entry is added as follows.



• TO DELETE AN ENTRY

You can delete an entry from the Speed Dial list.

- Press  key in standby mode. The phone displays the Main Menu.
- Press  key to select “03. Speed Dial”.

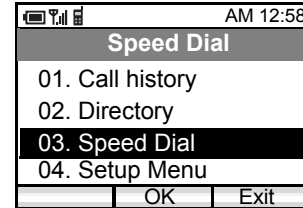

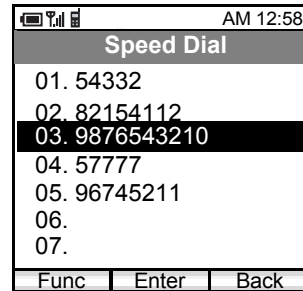

- The phone displays a Speed Dial list similar to the following.



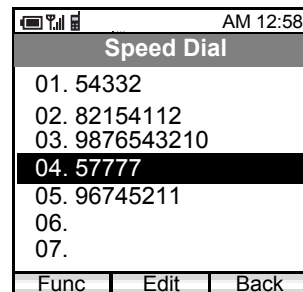

- Select an entry you want to delete by using  key. In the following example “04.” is selected.

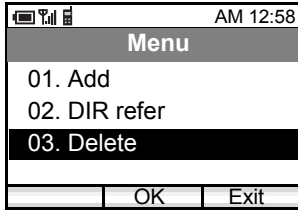

- Press  key.

- The following Speed Dial Menu is displayed. Press  key to select “03. Delete” and then press  key.



- The following message is displayed. To delete the entry select “Yes” and then press  key. When you do not want to delete the entry, select “No” and then press  key.

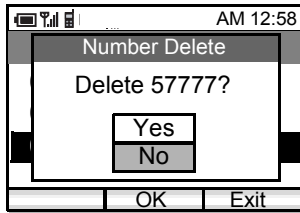

8.SETUP

The phone can set xxxxx.

• DISPLAY BACKLIGHT

- Press **Menu** key in standby mode. The phone displays the Main Menu.
- Press **◆** key to select “04. Setup Menu” and then press **○** key.

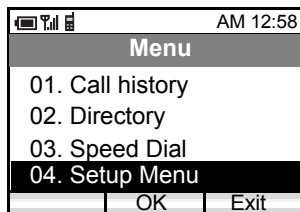

- The phone displays the Setup Menu.
- Press **◆** key to select “01. Display setting”.



- Press **○** key to open “Display setting” menu.
- Press **◆** key to select “01. BackLight Level” and then press **○** key.

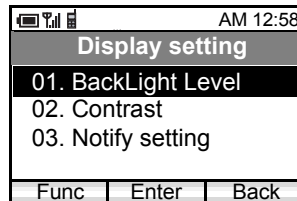

- Backlight can be set in five levels (0 - 4). Select a desired level by using **◆** key and then press **○** key.

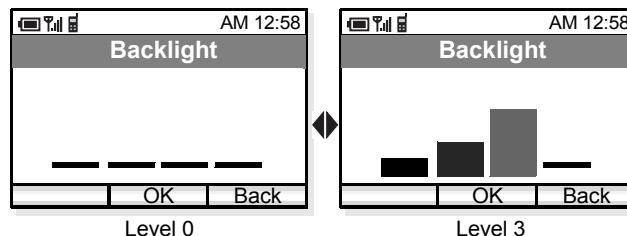

• DISPLAY CONTRAST(不可?)

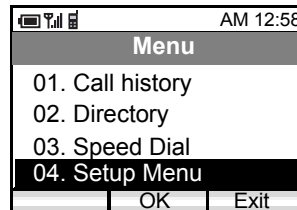

- Press **Menu** key in standby mode. The phone displays the Main Menu.
- Press **◆** key to select “04. Setup Menu” and then press **○** key.





- The phone displays the Setup Menu.

- Press  key to select “01. Display setting”.

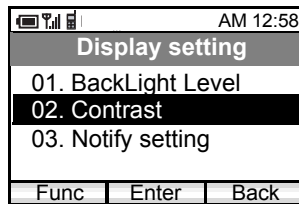

- Press  key to open “Display setting” menu.
- Press  key to select “02. Contrast” and then press  key.



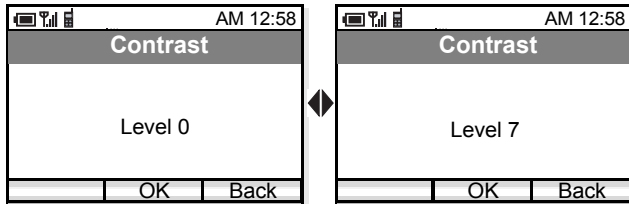

- Contrast can be set in five levels (0 - 7). Select a desired level by using  key and then press  key.





• NOTIFY SETTING

The phone can flash the Info-LED when one of the following occurs:

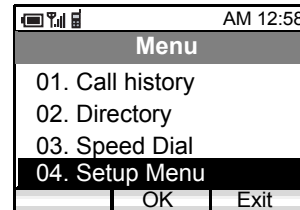

- Unanswered Call
- Voice Message
- Unopened IM

- Press  key in standby mode. The phone displays the Main Menu.
- Press  key to select “04. Setup Menu” and then press  key.



- The phone displays the Setup Menu.
- Press  key to select “01. Display setting”.



- Press  key to open “Display setting” menu.
- Press  key to select “03. Notify setting” and then press  key.

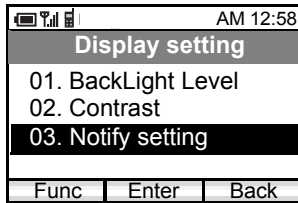

- Select ON/OFF by using key and then press key.

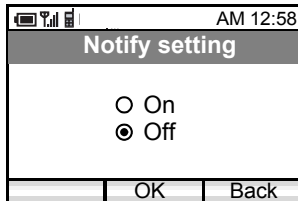

Note: When Off is set, the Info-LED will not flash. However, the ICONS will be displayed.

• COURTESY MODE

You can set the phone in Courtesy Mode, in which the following can be set. When the phone is placed in this mode will be indicated on the display.

COURTESY		ON	OFF
TONE/VIB.			
Key Tone		OFF	ON
Ring		OFF	ON
Demo Sound		OFF	ON
Vibrator		ON	OFF

- Press key in standby mode. The phone displays the Main Menu.
- Press key to select “04. Setup Menu” and then press key.

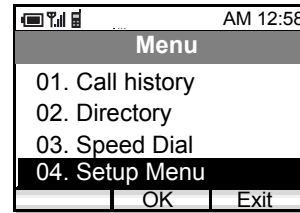

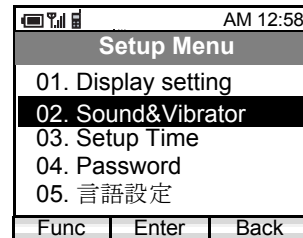

- The phone displays the Setup Menu.
- Press key to select “02. Sound&Vibrator”.

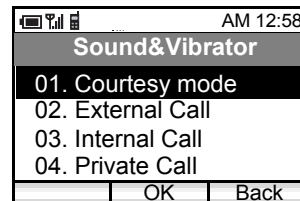

- Press key. Sound&Vibrator menu appears.
- Press key to select “01. Courtesy mode” and then press key.



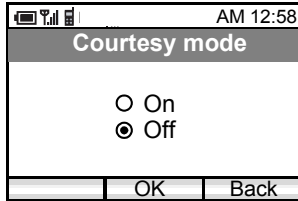

- Select On or Off by using  key and then press  key.



• RING/VIBRAOTR

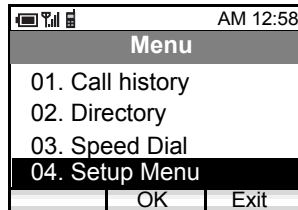

You can set ringer/vibrator pattern on a call kind basis (external call/internal call/private call).

- Press  key in standby mode.
- The phone displays the Main Menu.
- Press  key to select “04. Setup Menu” and then press  key.



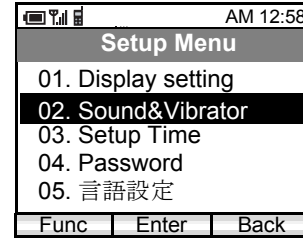

- The phone displays the Setup Menu.
- Press  key to select “02. Sound&Vibrator”.



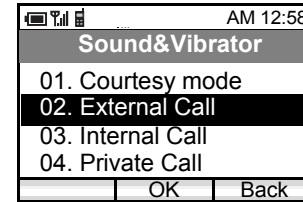

- Press  key. Sound&Vibrator menu appears.
- Press  key to select “02. External Call/03. Internal Call/04. Private Call” and then press  key.

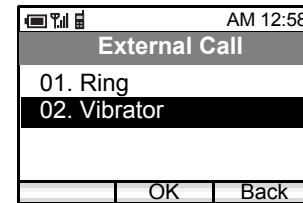

- Select “01. Ring” or “02. Vibrator” by using  key and then press  key.



- Select a pattern or melody by using  key and then press  key.

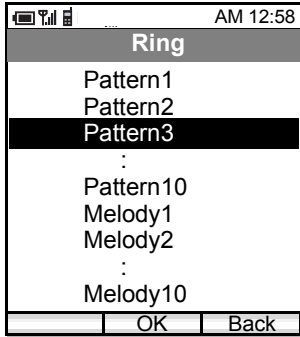

01. Ring

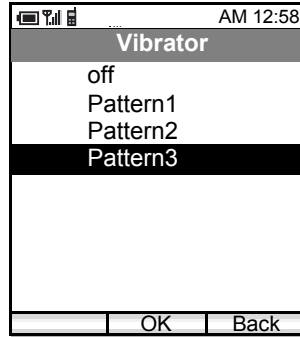

02. Vibrator

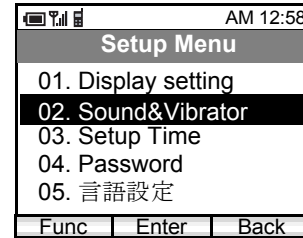

- Press key. Sound&Vibrator menu appears.
- Press key to select “05. Ring Volume” and then press key.

• RING VOLUME

Factory Default: 5

You can adjust ringer volume.

- Press key in standby mode.
- The phone displays the Main Menu.
- Press key to select “04. Setup Menu” and then press key.

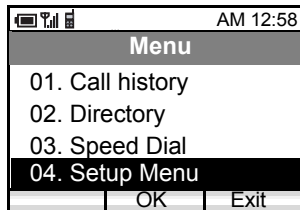

- The phone displays the Setup Menu.
- Press key to select “02. Sound&Vibrator”.

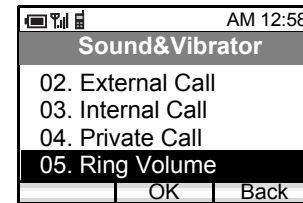

- Ring Volume can be set in eight levels (0 - 7). Select a desired volume by using key and then press key.

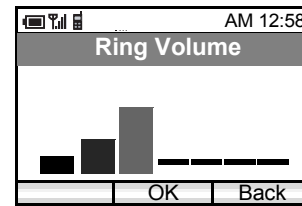

Volume (0 - 7)



When the phone is in courtesy mode, it will not ring irrespective of the volume setting.