

# IIP

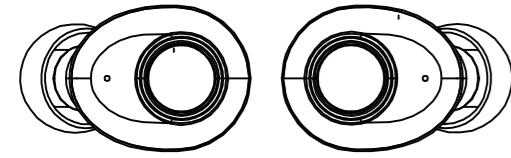

## User Manual True Wireless Earbuds

### Accessories

- 1 x Pair of True Wireless Earbuds
- 1 x Charging Box
- 1 x Micro-USB Cable
- 2 x Pairs of Ear-Tips (S / L)
- 1 x User Manual

### Product Diagram

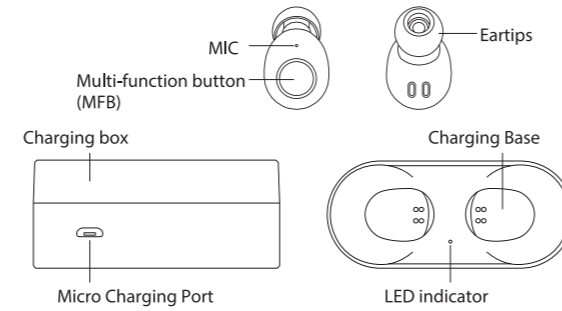

### Power/On & Pairing

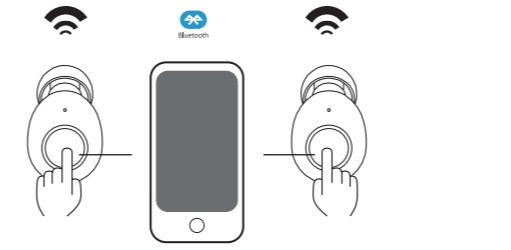

Turn on the left and right earbuds by pressing the MFB on both side for 3s, two earbuds automatic pairing and go to pairing mode, pls find search name "MP30878" on mobilephone and click it to connect.  
Voice prompt:  
Power On → Connected → Left Channel (Pairing) → Right Channel  
Automatic re-connection: disconnected when beyond the effective distance, automatic connection in 10mins when it is in effective distance.

### TWS function



The left earbud is the "Master bud" built with microphone have handsfree function.  
The right earbud is the "Seconday earbud" it can paired with the left one get stereo sound.

### Power off & Charging

**Saving mode:** automatic power off when it doesn't connect in 10 mins.  
**Power off:** press and hold the MFB on both side for 4 seconds until White led flash 1 second with "Power OFF" Voice prompt.

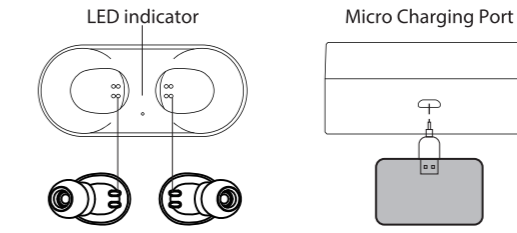

#### Charging Your Charge box

Blue led turns on when fully charged.  
Initial charging time is around 4 hours.

Connect the micro cable to your charging box until the blue led indicator flashes.

### NOTES



Make sure the two earbuds are successfully power on, then they will connect automatically.

NOTE: Do not cover the earbuds with your hand or something else when wearing it, which will cause the signal to break instantly.

Please note in that case, it is not the earbuds issue, and just put your hands away, it should be OK.

P/N 30878 Made in China

FCC ID: 2ADDH-30878  
CAN ICES-3 (B) / NMB-3(B)

### Specifications

Mode	MP30878
Bluetooth Version	V4.2
Profiles Supported	HSP/HFP/A2DP/AVRCP
Wireless Distance Range	10M
Earbud Battery	50mAh x 2
Charging Box Battery	500mAh
Talk Time	up to 2 hours
Playing Time	up to 2~ 4.5 hours
Charging Time	about 2 hours
Stand-by Time	150 hours
Earbud Size	20x16x14.5mm
Earbud Weight	3.5g
Charging Box Size	73x32x32mm
Charging Box Weight	50g

### LED Indicator

LED Indicator Status	
Blue & white flashing alternately	Pairing mode
Blue flashing once every 7 seconds	Connected/ Playing music
White flashing twice every 2 seconds	Disconnected
Blue & white flashing twice every 3 seconds	Incoming call (Master Earbud)
Blue flashing once every 3 seconds	In call (Master Earbud)
White flashing once every 5 seconds	Low battery
White	Charging
LED off (after charging)	Fully charged

### Tips

- Make sure that the earbuds are fully charged.
- Put both left and right earbuds within 1 foot.
- Turn on both earbuds simultaneously by pressing the multi-function buttons of left and right earbuds for 4 seconds until the blue light & white light flash alternatively.
- The left and right earbuds will be paired with each other.
- When pairing is successful, you will hear the voice prompt "connected Left channel/Right channel", the LED indicator of left & right earbud will flash blue every 7 seconds.
- Turn on the Bluetooth function of your device and select "MP30878" from the device list, click connect. When Bluetooth is connected successfully, you will hear the voice "Second device connected".

### Music and Call Control

#### Streaming Audio

Once paired, you can wirelessly stream audio from your device to your earbuds. Music will automatically pause when you receive an incoming phone call, and resume once the call has ended.

Play / Pause	Press the multi-function button once
Next track	Double-press the multi-function button
Volume control	You may adjust the volume through your cell phone

#### Making Calls

Once paired with your smartphone, making and answering phone calls can be managed via the multi-function button.

Answer / End a call	Press the multi-function button once
Reject an incoming call	Double-press the multi-function button
Voice Switch	Double-press the multi-function button during a call to switch between the earbuds and your phone for talking

Remark: Phone functions are only activated on the master earbud.

#### FAQ

- Q: My earbuds will not switch on.  
A: Please recharge them and make sure they have enough power.
- Q: Why can I only hear music from one of the earbuds?  
A: Make sure the earbuds are synced together:  
1. Hold the multi-function Button of both units until Blue & white flashing alternately  
2. Wait until you hear a voice prompt telling you the two devices are connected.
- Q: What if my right earbud cuts out but the left works fine?  
A: Please try the reset procedure with both earbuds, and then try the Stereo Pairing again.
- Q: The earbuds cannot be found or pairing fails  
A: 1. The earbuds does not enter the pairing state, please enable the earbuds to enter into the pairing state

2. The Bluetooth application of the smartphone or device is not operating, please restart the smartphone or device and restart the pairing process with the earbuds
- Q: What if the sound is unclear  
A: 1. Please try changing the position of your device near to the earbuds, a direct line of sight is the best.  
2. Please try the reset procedure on the earbuds, you will need to pair the two earbuds again. We also recommend deleting the pairing with your phone and adding back the pairing again.

#### Product Care & Use

Please keep away from liquids and extreme heat.  
Do not use earbuds at high volume for extended periods, as this may cause permanent hearing damage or loss.

**Warranty**  
Warranty period: 1 years.

耳机说明书折页：128g双铜/4C/单张成品尺寸90\*80mm

### ***FCC Notice***

This device complies with Part 15 of the FCC Rules. Operation is subject to the following two conditions:

(1) This device may not cause harmful interference, and (2) this device must accept any interference received, including interference that may cause undesired operation.

NOTE 1: This equipment has been tested and found to comply with the limits for a Class B digital device, pursuant to part 15 of the FCC Rules. These limits are designed to provide reasonable protection against harmful interference in a residential installation. This equipment generates, uses and can radiate radio frequency energy and, if not installed and used in accordance with the instructions, may cause harmful interference to radio communications. However, there is no guarantee that interference will not occur in a particular installation. If this equipment does cause harmful interference to radio or television reception, which can be determined by turning the equipment off and on, the user is encouraged to try to correct the interference by one or more of the following measures:

- Reorient or relocate the receiving antenna.
- Increase the separation between the equipment and receiver.
- Connect the equipment into an outlet on a circuit different from that to which the receiver is connected.
- Consult the dealer or an experienced radio/TV technician for help.

NOTE 2: Any changes or modifications to this unit not expressly approved by the party responsible for compliance could void the user's authority to operate the equipment.