



motorola **ZN200**

**User's Guide**



# HELLOMOTO

---

Introducing your new Motorola wireless phone! It's packed with multimedia features.

- **My Phone, My Way** – Customise your home screen (page 26) with personal pictures taken with your phone's **2.0 megapixel camera**, and download a chart-topping track and use it as your ringtone.
- **Connect on So Many Levels** – Whether it's with work or friends, stay connected with voice (page 47) and messaging (page 46).
- **Rich Music Experience** – Use the music player (page 54) to set your playlist for your morning commute. Or, use the FM Radio (page 53) to listen to your favourite music or news programs. With a stereo wired headset or high quality **Bluetooth®** stereo headset, listening has never been easier.
- **Camera** - capture key moments with **photos** (page 49) and **videos** (page 51).
- **Convenient Extras** – When you are away from your home or desk, make use of handy tools like Phonebook, Calculator, Alarm Clock, Calendar, and others (page 62).
- **Fun** – When you have a little time to spare, why not surf the web (page 59) or play a game (page 60).

Here's a quick anatomy lesson:

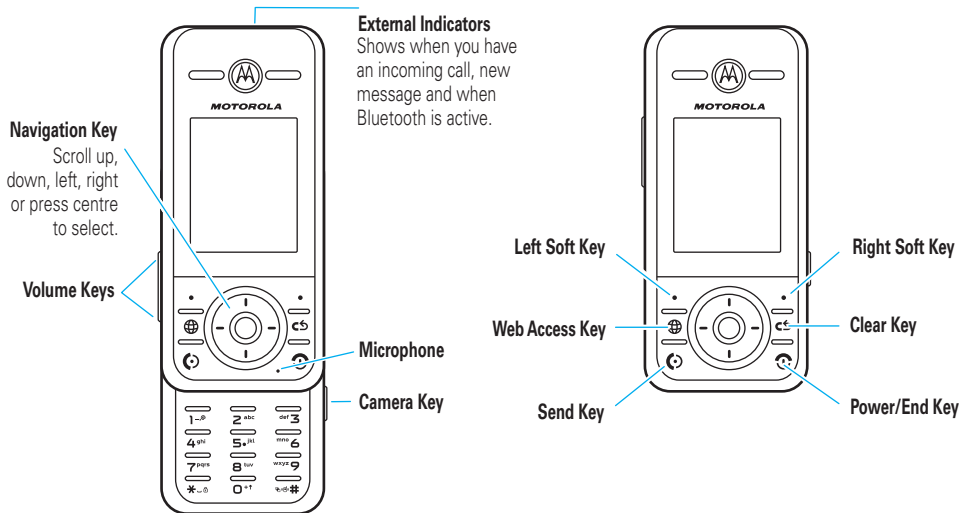

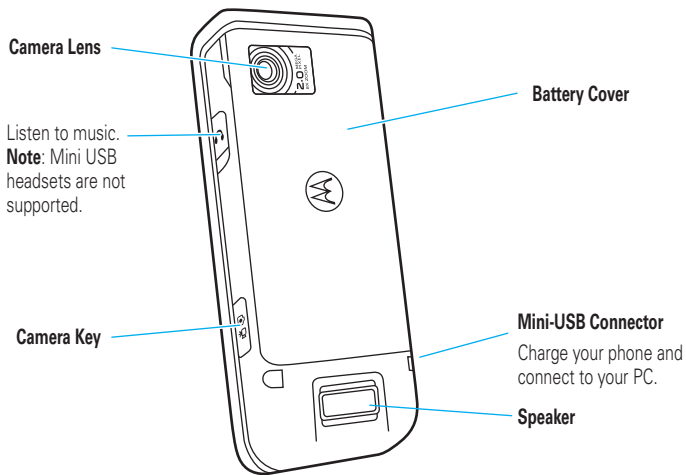

A few menu basics:



### Home Screen



- ① Press the **Left Soft Key** to access a list of menu shortcuts.
- ② Press and hold the **Power Key**  for a few seconds, or until the display lights up, to turn on your phone.
- ③ Press the **Centre Key** () to open the **Main Menu**.

### Main Menu



- ④ Press the Navigation Key **up, down, left, or right** () to highlight a menu feature.
- ⑤ Press the **Centre Key** () to select it.

This is a typical home screen and main menu layout. **Your phone may be a little different.**

Motorola, Inc.  
Consumer Advocacy Office  
1307 East Algonquin Road  
Schaumburg, IL 60196

[www.hellomoto.com](http://www.hellomoto.com)

1-800-331-6456 (United States)

1-888-390-6456 (TTY/TDD United States for hearing impaired)

1-800-461-4575 (Canada)

Certain mobile phone features are dependent on the capabilities and settings of your service provider's network. Additionally, certain features may not be activated by your service provider, and/or the provider's network settings may limit the feature's functionality. Always contact your service provider about feature availability and functionality. All features, functionality, and other product specifications, as well as the information contained in this user's guide are based upon the latest available information and are believed to be accurate at the time of printing. Motorola reserves the right to change or modify any information or specifications without notice or obligation.

MOTOROLA and the Stylized M Logo are registered in the US Patent & Trademark Office. All other product or service names are the property of their respective owners. The Bluetooth trademarks are owned by their proprietor and used by Motorola, Inc. under license. Java and all other Java-based marks are trademarks or registered trademarks of Sun Microsystems, Inc. in the U.S. and other countries. Microsoft and Windows are registered trademarks

of Microsoft Corporation; and Windows XP is a trademark of Microsoft Corporation.

© Motorola, Inc., 2008. All rights reserved.

**Caution:** Changes or modifications made in the radio phone, not expressly approved by Motorola, will void the user's authority to operate the equipment.

### **Software Copyright Notice**

The Motorola products described in this manual may include copyrighted Motorola and third-party software stored in semiconductor memories or other media. Laws in the United States and other countries preserve for Motorola and third-party software providers certain exclusive rights for copyrighted software, such as the exclusive rights to distribute or reproduce the copyrighted software. Accordingly, any copyrighted software contained in the Motorola products may not be modified, reverse-engineered, distributed, or reproduced in any manner to the extent allowed by law. Furthermore, the purchase of the Motorola products shall not be deemed to grant either directly or by implication, estoppel, or otherwise, any license under the copyrights, patents, or patent applications of Motorola or any third-party software provider, except for the normal, non-exclusive, royalty-free license to use that arises by operation of law in the sale of a product.

Manual Number: 68XXXX299-A

# contents

---

<b>menu map</b> . . . . .	<b>8</b>	store a phone number . . . . .	24	ring styles & alerts . . . . .	37
<b>Safety Information</b> . . . . .	<b>10</b>	call a stored phone number . . . . .	24	answer options . . . . .	38
<b>FCC Notice</b> . . . . .	<b>14</b>	lock and unlock keypad . . . . .	24	slide closed . . . . .	38
<b>Use and Care</b> . . . . .	<b>15</b>	<b>basics</b> . . . . .	<b>26</b>	wallpaper . . . . .	38
<b>EU Conformance</b> . . . . .	<b>16</b>	home screen . . . . .	26	screen saver . . . . .	39
<b>Recycling Information</b> . . . . .	<b>17</b>	status indicators . . . . .	27	colour style . . . . .	39
<b>get started</b> . . . . .	<b>18</b>	external indicators . . . . .	28	backlight . . . . .	39
about this guide . . . . .	18	enter text . . . . .	29	<b>calls</b> . . . . .	<b>40</b>
SIM card . . . . .	19	volume keys . . . . .	33	redial a number . . . . .	40
memory card . . . . .	19	handsfree . . . . .	33	recent calls . . . . .	40
battery . . . . .	20	codes & passwords . . . . .	33	return a missed call . . . . .	41
turn it on & off . . . . .	23	lock & unlock phone . . . . .	34	call waiting . . . . .	41
make a call . . . . .	23	memory card . . . . .	34	quick dial . . . . .	41
answer a call . . . . .	23	<b>tips &amp; tricks</b> . . . . .	<b>36</b>	notepad . . . . .	42
adjust volume . . . . .	23	<b>customise</b> . . . . .	<b>37</b>	emergency calls . . . . .	42
change ring alert . . . . .	24	change home screen shortcuts . . . . .	37	<b>messages</b> . . . . .	<b>43</b>
				send a message . . . . .	43



receive a message . . . . .	43	advanced calling . . . . .	68
voicemail . . . . .	44	security . . . . .	69
<b>entertainment . . . . .</b>	<b>45</b>	advanced Bluetooth features	69
camera . . . . .	45	fun & games . . . . .	70
video recorder . . . . .	47	<b>service &amp; repairs. . . . .</b>	<b>71</b>
FM radio . . . . .	48	<b>SAR Data. . . . .</b>	<b>72</b>
music player . . . . .	49	<b>Hearing Aids . . . . .</b>	<b>73</b>
WebAccess . . . . .	53	<b>WHO Information. . . . .</b>	<b>74</b>
<b>connections . . . . .</b>	<b>55</b>	<b>Registration . . . . .</b>	<b>74</b>
Bluetooth® wireless . . . . .	55	<b>Privacy and Data Security . . .</b>	<b>75</b>
cable connections . . . . .	57	<b>Driving Safety. . . . .</b>	<b>76</b>
<b>other features . . . . .</b>	<b>60</b>	<b>index . . . . .</b>	<b>78</b>
contacts. . . . .	60		
more message features . . .	60		
more personalising features	62		
call times . . . . .	64		
in call menu . . . . .	65		
headset . . . . .	66		
network . . . . .	66		
personal organiser. . . . .	67		

# menu map

## main menu



### Phonebook



### Recent Calls

- Received Calls
- Dialed Calls
- Notepad
- Erase All
- Call Time
- Call Cost \*
- GPRS Data Counter
- GPRS Connection Time



### Messages

- Create Message
- Message Inbox
- Outbox
- Drafts
- Voicemail
- Browser Msgs
- Quick Notes
- MMS Templates



### Tools

- Calculator
- Shortcuts
- Alarm Clock
- Chat \*
- Sim Toolkit \*
- Calendar
- Lantern



### Games & Apps



### WebAccess

- Browser
- Web Shortcuts
- Go To URL
- History
- Web Sessions
- Web Settings

\* Network Dependent



### Multimedia

- Camera
- Music Library
- Pictures
- Voice Notes
- Video Recorder
- Video
- FM Radio
- My Picture



### GOOGLE Pointer



### Settings

- (see next page)

This is the standard main menu layout.

**Your phone's menu may be different.**

## settings menu

### Personalise

- Home Screen
- Colour Style
- Wallpaper
- Screen Saver
- Slide Tone
- Quick Dial

### USB

- USB Modem
- USB Disk

### Bluetooth

- Find Me
- Add Audio Device
- Setup

### Ring Styles

- Style
- Style Detail

### Call Forward

- When Busy
- No Reply
- Not Reachable
- Not Available
- All Calls
- Cancel All

### In-Call Setup

- Dialling Prefix
- In-Call Timer
- Call Cost Setup \*
- Show Number
- Call Waiting
- Anykey Answer
- Session Information
- Auto Redial

### Headset & Car Setting

- Auto Answer

### Initial Setup

- Time and Date
- Slide Closed
- Backlight
- Language
- Brightness
- Input Mode
- Connection Indicator
- Status Indicator
- Master Reset
- Master Clear

### Phone Status

- My Tel. Number
- Active Line \*
- Battery Meter

### Security

- Phone Lock
- Keypad Lock
- Lock Application
- Fixed Dial \*
- Call Barring
- SIM PIN
- New Passwords

### Network \*

- New Network
- Network Setup
- Available Networks
- Service Tone

### Lantern

- 30 Seconds
- 1 Minute
- 2 Minutes

\* Network Dependent

# Safety and General Information

---

**This section contains important information on the safe and efficient operation of your mobile device. Read this information before using your mobile device.**

## Exposure to Radio Frequency (RF) Energy

Your mobile device contains a transmitter and receiver. When it is ON, it receives and transmits RF energy. When you communicate with your mobile device, the system handling your call controls the power level at which your mobile device transmits.

Your Motorola mobile device is designed to comply with local regulatory requirements in your country concerning exposure of human beings to RF energy.

## Operational Precautions

For optimal mobile device performance, and to be sure that human exposure to RF energy does not exceed the guidelines set forth in the relevant standards, always follow these instructions and precautions.

## Product Operation

When placing or receiving a phone call, hold your mobile device just like you would a landline phone.

If you wear the mobile device on your body, always place the mobile device in a Motorola-supplied or approved clip, holder, holster, case, or body harness. If you do not use a body-worn accessory supplied or approved by Motorola, keep the mobile device and its antenna at least 2.5 centimeters (1 inch) from your body when transmitting.

Using accessories not supplied or approved by Motorola may cause your mobile device to exceed RF energy exposure guidelines. For a list of Motorola-supplied or approved accessories, visit our Web site at: [www.motorola.com](http://www.motorola.com).

## RF Energy Interference/Compatibility

Nearly every electronic device is subject to RF energy interference from external sources if inadequately shielded, designed, or otherwise configured for RF energy compatibility. In some circumstances your mobile device may cause interference with other devices.

## Follow Instructions to Avoid Interference Problems

Turn off your mobile device in any location where posted notices instruct you to do so.

In an aircraft, turn off your mobile device whenever instructed to do so by airline staff. If your mobile device offers an airplane mode or similar feature, consult airline staff about using it in flight.

## Implantable Medical Devices

If you have an implantable medical device, such as a pacemaker or defibrillator, consult your physician before using this mobile device.

Persons with implantable medical devices should observe the following precautions:

- ALWAYS keep the mobile device more than 20 centimeters (8 inches) from the implantable medical device when the mobile device is turned ON.
- DO NOT carry the mobile device in the breast pocket.
- Use the ear opposite the implantable medical device to minimize the potential for interference.
- Turn OFF the mobile device immediately if you have any reason to suspect that interference is taking place.

Read and follow the directions from the manufacturer of your implantable medical device. If you have any questions about using

your mobile device with your implantable medical device, consult your healthcare provider.

## Driving Precautions

The use of wireless phones while driving may cause distraction. Discontinue a call if you can't concentrate on driving.

Additionally, the use of wireless devices and their accessories may be prohibited or restricted in certain areas. Always obey the laws and regulations on the use of these products.

Responsible driving practices can be found in the "Smart Practices While Driving" section in this guide (or separate guide).

## Operational Warnings

Obey all posted signs when using mobile devices in public areas.







## Potentially Explosive Atmospheres

Areas with potentially explosive atmospheres are often, but not always, posted and can include fueling areas, such as below decks on boats, fuel or chemical transfer or storage facilities, or areas where the air contains chemicals or particles, such as grain dust, or metal powders.

When you are in such an area, turn off your mobile device, and do not remove, install, or charge batteries. In such areas, sparks can occur and cause an explosion or fire.

## Symbol Key

Your battery, charger, or mobile device may contain symbols, defined as follows:

Symbol	Definition
	Important safety information follows.
	Do not dispose of your battery or mobile device in a fire.
	Your battery or mobile device may require recycling in accordance with local laws. Contact your local regulatory authorities for more information.
	Do not throw your battery or mobile device in the trash.
	Do not let your battery, charger, or mobile device get wet.
	Listening at full volume to music or voice through a headset may damage your hearing.

## Batteries & Chargers

**Caution: Improper treatment or use of batteries may present**

**a danger of fire, explosion, leakage, or other hazard. For more information, see the “battery use & safety” section in the user’s guide.**

## Keep Your Mobile Device and Its Accessories Away From Small Children

These products are not toys and may be hazardous to children. For example:

- A choking hazard may exist for small, detachable parts.
- Improper use could result in loud sounds, possibly causing hearing injury.
- Improperly handled batteries could overheat and cause a burn.

## Glass Parts

Some parts of your mobile device may be made of glass. This glass could break if the product is dropped on a hard surface or receives a substantial impact. If glass breaks, do not touch or attempt to remove. Stop using your mobile device until the glass is replaced by a qualified service center.

## Seizures/Blackouts

Some people may be susceptible to epileptic seizures or blackouts when exposed to flashing lights, such as when playing video games. These may occur even if a person has never had a previous seizure or blackout.

If you have experienced seizures or blackouts, or if you have a family history of such occurrences, please consult with your physician before playing video games or enabling a flashing-lights feature (if available) on your mobile device.

Discontinue use and consult a physician if any of the following symptoms occur: convulsion, eye or muscle twitching, loss of awareness, involuntary movements, or disorientation. It is always a good idea to hold the screen away from your eyes, leave the lights on in the room, take a 15-minute break every hour, and stop use if you are very tired.

## Caution About High Volume Usage



**Warning:** Exposure to loud noise from any source for extended periods of time may affect your hearing. The louder the volume sound level, the less time is required before your hearing could be affected. To

protect your hearing:

- Limit the amount of time you use headsets or headphones at high volume.

- Avoid turning up the volume to block out noisy surroundings.
- Turn the volume down if you can't hear people speaking near you.

If you experience hearing discomfort, including the sensation of pressure or fullness in your ears, ringing in your ears, or muffled speech, you should stop listening to the device through your headset or headphones and have your hearing checked.

For more information about hearing, see our Web site at [www.motorola.com/hearingsafety](http://www.motorola.com/hearingsafety) (in English only).

## Repetitive Motion

When you repetitively perform actions such as pressing keys or entering finger-written characters, you may experience occasional discomfort in your hands, arms, shoulders, neck, or other parts of your body. If you continue to have discomfort during or after such use, stop use and see a physician.

Mar0108

# FCC Notice to Users

---

**The following statement applies to all products that have received FCC approval. Applicable products bear the FCC logo, and/or an FCC ID in the format FCC-ID:xxxxxx on the product label.**

Motorola has not approved any changes or modifications to this device by the user. Any changes or modifications could void the user's authority to operate the equipment. See 47 CFR Sec. 15.21.

This device complies with part 15 of the FCC Rules. Operation is subject to the following two conditions: (1) This device may not cause harmful interference, and (2) this device must accept any interference received, including interference that may cause undesired operation. See 47 CFR Sec. 15.19(3).

This equipment has been tested and found to comply with the limits for a Class B digital device, pursuant to part 15 of the FCC Rules. These limits are designed to provide reasonable protection against harmful interference in a residential installation. This equipment generates, uses and can radiate radio frequency energy and, if not installed and used in accordance with the instructions, may cause harmful interference to radio communications.

However, there is no guarantee that interference will not occur in a particular installation. If this equipment does cause harmful interference to radio or television reception, which can be determined by turning the equipment off and on, the user is

encouraged to try to correct the interference by one or more of the following measures:

- Reorient or relocate the receiving antenna.
- Increase the separation between the equipment and the receiver.
- Connect the equipment to an outlet on a circuit different from that to which the receiver is connected.
- Consult the dealer or an experienced radio/TV technician for help.



# Use and Care

---

To care for your Motorola phone, please keep it away from:



## liquids of any kind

Don't expose your phone to water, rain, extreme humidity, sweat, or other moisture. If it does get wet, don't try to accelerate drying with the use of an oven or dryer, as this may damage the phone.



## extreme heat or cold

Avoid temperatures below 0°C/32°F or above 45°C/113°F.



## microwaves

Don't try to dry your phone in a microwave oven.



## dust and dirt

Don't expose your phone to dust, dirt, sand, food, or other inappropriate materials.



## cleaning solutions

To clean your phone, use only a dry soft cloth. Don't use alcohol or other cleaning solutions.



## the ground

Don't drop your phone.

# European Union Directives Conformance Statement

---



Hereby, Motorola declares that this product is in compliance with:

- The essential requirements and other relevant provisions of Directive 1999/5/EC
- All other relevant EU Directives

Approval Number from your product's label in the "Search" bar on the Web site.

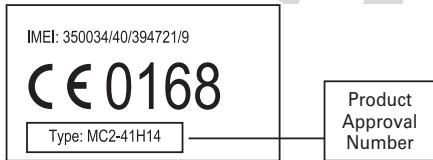

The above gives an example of a typical Product Approval Number.

You can view your product's Declaration of Conformity (DoC) to Directive 1999/5/EC (to R&TTE Directive) at [www.motorola.com/rtte](http://www.motorola.com/rtte). To find your DoC, enter the Product

# Caring for the Environment by Recycling

---



This symbol on a Motorola product means the product should not be disposed of with household waste.

## Disposal of your Mobile Device and Accessories

Please do not dispose of mobile devices or electrical accessories (such as chargers, headsets, or batteries) with your household waste. These items should be disposed of in accordance with the national collection and recycling schemes operated by your local or regional authority. Alternatively, you may return unwanted mobile devices and electrical accessories to any Motorola Approved Service Center in your region. Details of Motorola approved national recycling schemes, and further information on Motorola recycling activities can be found at: [www.motorola.com/recycling](http://www.motorola.com/recycling)

## Disposal of your Mobile Device Packaging and User's Guide

Product packaging and user's guides should only be disposed of in accordance with national collection and recycling requirements. Please contact your regional authorities for more details.

# get started





---

## about this guide

This guide shows how to locate a menu feature as follows:

**Find it:**  >  **Recent Calls** > **Received Calls**

This means that, from the home screen:

- 1 Press the *centre key*  to open the main menu.
- 2 Scroll to  **Recent Calls** and press the centre key .
- 3 Scroll to **Received Calls** and press the centre key .

**Tip:** Press the centre key  or **Select** to select a highlighted option.

### symbols



This means a feature is network/subscription dependent and may not be available in all areas. Contact your service provider for more information.



This means a feature requires an optional accessory.

## SIM card

Your Subscriber Identity Module (SIM) card contains personal information like your phone number and contacts. It can also contain your voicemail and text message settings.

If you put your SIM card in another phone, that phone uses your phone number.

**Caution:** Don't bend or scratch your SIM card. Keep it away from static electricity, water, and dirt.

**Tip:** Make sure your SIM card is fully inserted into the phone before installing the battery.

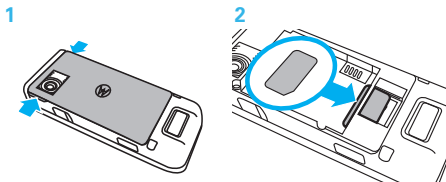

## memory card

You can use a removable microSD memory card (up to 2 GB) with your phone to store and retrieve multimedia objects, such as music and pictures. 

**Note:** Your phone supports up to 2 GB microSD memory cards (greater than 1 GB capacity is guaranteed for SanDisk microSD cards only). We recommend that you use Motorola approved memory cards only, such as SanDisk memory cards. Other memory cards may not be compatible with your phone.

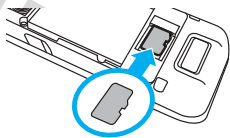
**To install the memory card,** make sure the memory card's metal contacts are facing down. Slide the top of the memory card under the metal band and into the 

holder. **To remove the memory card**, slide the card back out of the holder.

## battery

### battery use and safety

**IMPORTANT: HANDLE AND STORE BATTERIES PROPERLY TO AVOID INJURY OR DAMAGE.** Most battery issues arise from improper handling of batteries, and particularly from the continued use of damaged batteries.

#### DON'Ts

- **Don't disassemble, crush, puncture, shred, or otherwise attempt to change the form of your battery.**
- **Don't let the phone or battery come in contact with water.** Water can get into the phone's circuits, leading to corrosion. If the phone and/or battery get wet, have them

checked by your carrier or contact Motorola even if they appear to be working properly.

- **Don't allow the battery to touch metal objects.** If metal objects, such as jewelry, stay in prolonged contact with the battery contact points, the battery could become very hot.
- **Don't place your battery near a heat source.** Excessive heat can damage the phone or the battery. High temperatures can cause the battery to swell, leak, or malfunction. Therefore:
  - Do **not** dry a wet or damp battery with an appliance or heat source, such as a hair dryer or microwave oven.
  - Avoid leaving your phone in your car in high temperatures.

## DOs

- **Do avoid dropping the battery or phone.**  
Dropping these items, especially on a hard surface, can potentially cause damage.
- **Do contact your service provider or Motorola if your phone or battery has been damaged from dropping or high temperatures.**

**IMPORTANT: USE MOTOROLA ORIGINAL PRODUCTS FOR QUALITY ASSURANCE AND SAFEGUARDS.** To aid consumers in identifying authentic Motorola batteries from non-original or counterfeit batteries (that may not have adequate safety protection), Motorola provides holograms on its batteries. Consumers should confirm that any battery they purchase has a “Motorola Original” hologram.

**Motorola recommends you always use Motorola-branded batteries and chargers.** Motorola mobile devices are designed to work with Motorola

batteries. If you see a message on your display such as **Invalid Battery** or **Unable to Charge**, take the following steps:

- Remove the battery and inspect it to confirm that it has a “Motorola Original” hologram;
- If there is no hologram, the battery is not a Motorola battery;
- If there is a hologram, replace the battery and retry charging it;
- If the message remains, contact a Motorola Authorized Service Center.

**Important:** Motorola’s warranty does not cover damage to the phone caused by non-Motorola batteries and/or chargers.

**Warning:** Use of a non-Motorola battery or charger may present a risk of fire, explosion, leakage, or other hazard.

## PROPER AND SAFE BATTERY DISPOSAL AND RECYCLING

Proper battery disposal is not only important for safety, it benefits the environment. Consumers may recycle their used batteries in many retail or service provider locations. Additional information on proper disposal and recycling may be found on the Web:

- [www.motorola.com/recycling](http://www.motorola.com/recycling)
- [www.rbrc.org/call2recycle/](http://www.rbrc.org/call2recycle/) (in English only)

**Disposal:** Promptly dispose of used batteries in accordance with local regulations. Contact your local recycling center or national recycling organizations for more information on how to dispose of batteries.



**Warning:** Never dispose of batteries in a fire because they may explode.

## install the battery

1

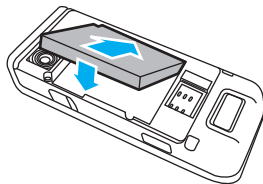

2

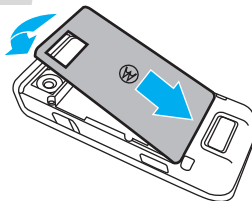



## remove the battery

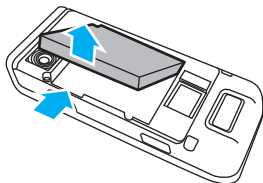

**Note:** Your battery is intentionally tight fitting to ensure consistent connection.

## charge the battery

New batteries are not fully charged. Plug the battery charger into your phone and an electrical outlet. Your phone might take several seconds to start charging the battery. The phone shows **Battery Full, Unplug** when finished.

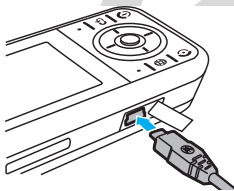

**Tip:** Motorola batteries have circuitry that protects the battery from damage from overcharging.

**Tip:** You can also use a PC USB port to charge your phone battery. Before connecting your phone to your PC, download and install the charging software driver from [www.motorola.com/support](http://www.motorola.com/support).

## turn it on & off

**To turn on your phone,** press and hold  for a few seconds or until the display turns on.

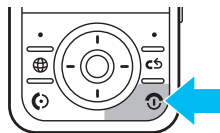

If prompted, enter your four-digit unlock code. Your phone's four-digit **unlock code** is originally set to **1234** or the last four digits of your phone number (see page 32).

**To turn off your phone,** press and hold  for a few seconds.

## make a call

Enter a phone number and press  to make a call. See page 40 for more calling features.

To “hang up,” press .

**Tip:** Is your caller saying they can’t hear you? Make sure your finger is not covering the microphone (see page 2).

## answer a call

When your phone rings and/or vibrates, press  to answer. See page 36 for answer options.

To “hang up,” press .

## adjust volume

You can adjust the volume during a call by pressing the up or down volume keys on the side of the phone (see

page 2), or by pressing  up or down. To mute a call, press **Options** > **Mute**.

## change ring alert

**Find it:**  >  **Settings** > **Ring Styles**

Available options are **Loud**, **Soft**, **Vibrating**, **Vibrate & Ring**, or **Silent** (see page 35).

## store a phone number

You can store up to 1000 phone numbers in **Phonebook** (see page **xx** for more phonebook features):

- 1 Enter a phone number in the home screen, and press **Save**.
- 2 Enter a name and other details for the phone number.
- 3 Press **Save** to store the number.

## call a stored phone number

**Find it:**  >  Phonebook

- 1 Scroll to the entry.
- 2 Press  to call the entry.

**Shortcut:** In **Phonebook**, enter the first letters of an entry to get to it quickly.

**Tip:** Set the **Phonebook** icon as a **Home Screen** navigation key for even faster access (see page 35).

## lock and unlock keypad

The keypad will automatically lock **when the slider is closed**, if the **Keypad Lock Timer** is **On**.

To turn the timer on, press **Settings > Security > Keypad Lock > Timer > On**.

To unlock your keypad, press any key and select **Unlock > OK**.

To lock your keypad **with the slider open**, press and hold .

# basics

---

See page 2 for a basic phone diagram.

## home screen

When you turn on your phone, the *home screen* displays. To dial a number from the home screen, press number keys and .

**Note:** Your home screen might look a little different from this example.

*Soft key labels* show the current soft key functions. For soft key locations, see page 2.

Press the *navigation key*  up, down, left, or right to select items in the home screen.

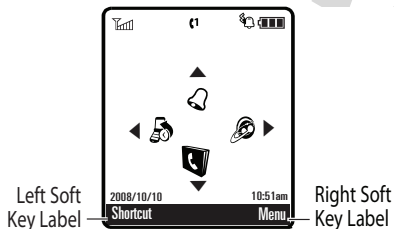

## status indicators

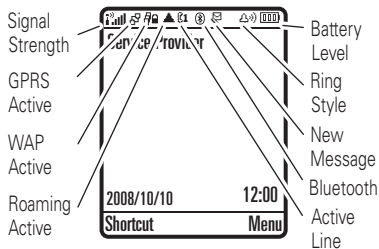

Status indicators are displayed at the top of the phone's display:

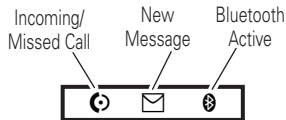

## external indicators

The following indicators can appear on the top of the phone:



indicator	
 <b>Bluetooth Status</b>	Shows when Bluetooth is on and active.
 <b>New Messages</b>	Appears when you receive a new SMS, MMS or voicemail message.
 <b>Incoming Calls</b>	Appears when you receive an incoming call or have a missed call.

## enter text

Some screens allow you to use the keypad to enter text, such as when you compose a message:



## set entry modes

Multiple text entry modes make it easy for you to enter names, numbers, and messages:



### entry mode

<b>Primary</b>	Enter text using a method that you set.
<b>Secondary</b>	

### entry mode

<b>Number</b>	Enter numbers only (see page 31).
<b>Symbol</b>	Enter symbols only (see page 31).

### To assign a Primary or Secondary text entry mode:

- 1 In a text entry screen, press **Options**.
- 2 Scroll to **Input Setup** and press .
- 3 Scroll to **Primary** or **Secondary** and press .
- 4 Scroll to one of the following choices and press .

### options

<b>iTAP™</b>	Let the phone predict each word as you press keys.
<b>TAP</b>	Enter letters and numbers by pressing a key one or more times.

## To change the text entry mode

Press **#** in the text entry screen to change the text entry until the desired mode is displayed.

## To select or edit a text entry mode

Press **Options** in any text entry screen, scroll to and select **Input Mode**, then scroll to and select the desired entry mode.







### capitalisation

Press **0** in any text entry screen to change the text case. These indicators show capitalisation status:

indicator	
<b>ab</b>	no capital letters
<b>AB</b>	all capital letters
<b>Ab</b>	capitalise next letter only

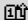
## text entry mode indicators

When you select the **Primary** or **Secondary** text entry mode, the following indicators identify the text entry setting:

primary	secondary	
<b>1</b>	<b>2</b>	Tap, no capital letters
<b>1↑</b>	<b>2↑</b>	Tap, capitalise next letter
<b>1↑</b>	<b>2↑</b>	Tap, all capital letters
		iTAP™, no capital letters
		iTAP, capitalise next letter
		iTAP, all capital letters

These indicators identify **Numeric** or **Symbol** entry mode:

indicator	
<b>12</b>	number mode
<b>@</b>	symbol mode

## tap method

This is the standard method for entering text on your phone.

Regular **Tap** method cycles through the letters and numbers of the key you press. The **Tap Extended** method cycles through letters, numbers, **and** symbols.



- 1 Press a key one or more times to cycle through its characters.
- 2 Repeat the step above to enter all characters.

**Tip:** Press  to insert a space.

In a text entry screen you can press  to switch entry modes. If **Tap** or **Tap Extended** is not available as the **Primary** or **Secondary** entry mode, see page 28.

## iTAP™ method



The iTAP software combines your single key presses into common words, and predicts each word as you enter it. This can be faster than the **Tap** method.

- 1 Press  right or left to scroll through the possible letter combinations, and highlight the combination you want.
- 2 Press  to enter the highlighted combination.

You can press keys to add more letters to the end of the combination.

**or**

Press  to enter the highlighted combination and insert a space.

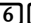
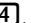
For example, if you press    , your phone displays the corresponding letter combinations:





Press **.⦿.** up to accept **program.**

Press **.⦿.** right or left to see other word suggestions.

## numeric method

In a text entry screen, press **#** to switch entry methods until your phone displays the **12** (numeric) indicator.

Press keypad keys to enter numbers. When finished, press **#** to switch entry modes.

## symbol method

In the text entry screen, press **#** to switch entry methods until your phone displays the **@** (symbol) indicator.

- 1 Press a key one or more times to show possible symbol combinations at the bottom of the screen.
- 2 Scroll left or right to highlight a symbol and press **⦿** to enter it.

## delete letters & words

Move the cursor to the right of the text you want to delete and then:

- Press **⌫** to delete one letter at a time.
- Press and hold **⌫** to delete the entire message.

## volume keys

Press the volume keys on the side of the phone to:

- Change earpiece or speakerphone volume during a call
- Change volume for a song

## handsfree

You can use your phone's handsfree speaker to make calls without holding the phone to your ear. To turn the speaker on during a call, press **Speaker**. To turn the speaker off, press **Speaker** again.

You can also use an optional 2.5 mm wired headset to go handsfree.

**Note:** Mini USB headsets are not supported.

## codes & passwords

Your phone's four-digit **unlock code** is originally set to **1234** or to the last four digits of your phone number. The six-digit **security code** is originally set to **000000**.

Your service provider may reset these codes. If not, you should change them to protect your personal information. The unlock code must contain four digits. The security code must contain six digits.

**To change a code or password:**

**Find it:**  >  Settings > Security > New Passwords

**Note:** If you forget your security code, contact your service provider.

## lock & unlock phone

You can lock your phone with a four-digit code to keep others from using it.

**Note:** You can make emergency calls on a locked phone (see page 42). A locked phone still rings or vibrates for incoming calls or messages, **but you need to unlock it to answer.**

**To lock your phone:**

**Find it:**  >  Settings > Security > Phone Lock > Lock Now or Automatic Lock

Enter the four-digit unlock code and press **OK**. Your phone first displays **Phone Locked**, and then shows **Enter Unlock Code** until the next time you unlock your phone.

**To unlock your phone**, enter your four-digit code and press **OK**.



**change phone lock code**

**Find it:**  >  Settings > Security > New Passwords > Phone Lock Code

## memory card



You can store multimedia content, such as songs, photos and video clips, on your phone's internal memory or on an optional memory card (see page 66).



**Note:** You cannot download a copyrighted file and store it on your memory card.

To access music or pictures stored on your microSD memory card, press  >  Multimedia > Pictures or Media Finder and then press Options > Switch Storage. If there are no files stored on your memory card then your phone will automatically switch to its internal memory.

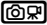
# tips & tricks

From the home screen (page 26), you can use shortcuts:

To...	Do this...
<b>take a photo</b>	Press  to activate the camera.
<b>record a video</b>	Press  > Options > Go to Video Mode to activate the video recorder. <b>Shortcut:</b> Press and hold  to access video mode.
<b>see recently dialled numbers</b>	Press  .

To...	Do this...
<b>use application shortcuts</b>	Press the left and right soft keys or the navigation key  .
<b>access voicemail</b>	Press and hold the  key to access your voicemail messages.
<b>change ring style</b>	Press and hold the  key to change ring styles.

# customise

---

## change home screen shortcuts

**Find it:**  >  Settings > Personalise > Home Screen  
> Home Keys



options	
<b>Show Icons</b>	Show or hide the home screen shortcut icons.
<b>Up, Down, Left, Right</b>	Choose the features that open when you press the navigation key (  ) up, down, left, or right in the home screen.

## ring styles & alerts

Your phone rings and/or vibrates to notify you of an incoming call or to signal certain other events. This ring or vibration is called an *alert*.

### set a style



**Find it:**  >  Settings > Ring Styles

- 1 Select **Style** by pressing .
- 2 Scroll to a ring style and press .

### set alerts

Set alerts for different events, such as getting a message in your inbox or receiving a call.

**Find it:**  >  Settings > Ring Styles

- 1 Scroll to *Style Detail* and press .
- 2 Scroll to an alert type and press .
- 3 Scroll to the desired detail setting and press .

**Note:** Your phone plays a sample of each highlighted setting. Ringtones play through the speakerphone, unless you're using a headset.

## answer options

Set your phone to **Anykey Answer**.

**Find it:**  >  **Settings** > **In-Call Setup** > **Anykey Answer**

## slide closed

Set your phone to continue or end a task when the slide is closed:



**Find it:**  >  **Settings** > **Initial Setup** > **Slide Closed**

## wallpaper

Set a picture as a wallpaper (background) image in your home screen.

**Find it:**  >  **Settings** > **Personalise** > **Wallpaper**

### To select a wallpaper image:

- 1 Scroll to **Picture** and press .
- 2 Scroll to the picture you want and press .

**or**

Select **Off** to turn off wallpaper.

### To adjust wallpaper image layout:

- 1 Scroll to **Layout** and press .
- 2 Scroll to **Tile**, **Centre** or **Fit-to-screen**, and press .

## screen saver

Set a picture as a screen saver image. The screen saver displays when there is no phone activity.

**Find it:**  >  Settings > Personalise > Screen Saver



**To select a screen saver:**

- 1 Scroll to **Picture** or **Photo Album** and press .
- 2 Scroll to the picture you want and press .

or



Select **Off** to turn off the screen saver.

**To specify how long your phone must be inactive before it displays the screen saver:**



- 1 Scroll to **Delay** and press .
- 2 Select a time period and press .

**Note:** To conserve battery life, turn off the screen saver.

## colour style

To choose a **Colour Style** (or skin) that sets the look and feel of your phone's display, press  >  Settings > Personalise > Colour Style.

## backlight

To select a time period that the backlight remains on, press  >  Settings > Initial Setup > Backlight.

## more customising features

features

ring volume

 >  Settings > Ring Styles > *Style Detail* > Ringing Volume

## features

### slide tone

 >  Settings > Personalise > Slide Tone

### keypad volume

 >  Settings > Ring Styles > *Style* Detail > Key Tone Volume

### anykey answer

 >  Settings > In-Call Setup > Anykey Answer

### reminders

Set your phone to play reminder alerts for unread messages, missed calls, or voicemail messages that you receive:

 >  Settings > Ring Styles > *Style* Detail > Reminders



### set time and date

 >  Settings > Initial Setup > Time and Date

## features

### change home screen navigation keys



 >  Settings > Personalise > Home Screen > Home Keys > Up, Down, Left or Right

### text layout

Set home screen text to be **Left Justified**, **Centered** or **Off**:

 >  Settings > Personalise > Home Screen > Layout

### clock view

Show or hide a digital clock on the home screen:

 >  Settings > Personalise > Home Screen > Clock

### show or hide menu icons

Show or hide menu feature icons in the home screen:

 >  Settings > Personalise > Home Screen > Home Keys > Show or Hide



**features**

---

**menu language**

⦿ > Settings > Initial Setup > Language



DRAFT

# calls

---

To make and answer calls, see page 24.

## redial a number

- 1 From the home screen, press  to see a list of recently dialled calls.
- 2 Scroll to the entry you want to call and press .

## recent calls

Your phone keeps lists of the calls you recently received and dialled, even if the calls didn't connect. The lists are sorted from newest to oldest calls. The oldest calls are deleted as new calls are added.

**Find it:**  >  **Recent Calls** > **Received Calls** or **Dialled Calls**

- 1 Scroll to an entry.

**Note:** A ✓ next to a call means the call connected.

- 2 Press  to call the number.



To see call details (such as time and date), press **Options** > **View**.

Press **Options** while viewing a list of recent calls to see these options:

option	
<b>View</b>	View the entry.
<b>Delete</b>	Delete the entry.
<b>Call</b>	Call the entry.

option	
Send Message	Create a new text message with the number in the <b>To</b> field.
Save	Save the entry in the <b>Phonebook</b> .

## return a missed call

When you miss a call, your phone plays an alert, displays the  (missed call) indicator on the home screen and displays the  indicator on the external display on the top of your phone. Press **View** to see the details and press  to call the number.

To view your missed calls at any time:

**Find it:**  >  **Recent Calls > Received Calls**

To hear a voicemail message, see page 47.

## call waiting



If you **receive a second call** while you are already on a call:



- To answer the second call and put the first call on hold, press , or the left soft key, **Answer**. To switch between the calls, press **Switch** again.
- To send the second call to your voicemail, press **Ignore**.

## quick dial

Your phone can store nine phone numbers that you can call with a single key press. To **store** a quick dial phone number:

 >  **Settings > Personalise > Quick Dial**

To **call** a quick dial phone number, press and hold the single-digit quick dial number from the home screen.

## notepad

The most recent set of digits that you entered are stored in your phone's *notepad* memory.

**To retrieve a number in the notepad:**

**Find it:**  >  Recent Calls > Notepad

Press  to call the number or press **Save** to store the number in **Phonebook**.

## emergency calls

Your service provider programs emergency phone numbers, (such as 112 or 911), that you can call under any circumstances, even when your phone is locked.

- 1 Enter the emergency number.
- 2 Press .

**Note:** Emergency numbers vary by country. Your phone's pre-programmed emergency number(s) may

not work in all locations, and sometimes an emergency call cannot be placed due to network, environmental, or interference issues.



## call times

**Network connection time** is the elapsed time from the moment you connect to your service provider's network to the moment you end the call by pressing . This time includes busy signals and ringing.

**The amount of network connection time you track on your resettable timer may not equal the amount of time for which you are billed by your service provider. For billing information, please contact your service provider directly.**

### features

#### set in-call timer

 >  Settings > In-Call Setup > In-Call Timer



## features

### call cost setup



> Settings > In-Call Setup > Call Cost Setup

### view call times

> Recent Calls > Call Time

Scroll to Last Call, Dialed Calls, Received Calls, All Calls, or Lifetime, and press Select.

## in call menu

During a call you access the in call menu by pressing Options.

## features

### access a list of available phone lines

Options > My Tel Numbers

Scroll to a line and press Select.

## features

### hold the call

Options > Hold

### mute the call

Options > Mute

### turn speakerphone on/off

Options > Spkrphone On or Off

### access list of contacts

Options > Phonebook

### make another call



Options > New Call

### access list of dialed calls

Options > Dialed Calls

### access list of received calls

Options > Received Calls

## features

### access messages

Options > Messages

### Use Bluetooth

Options > Bluetooth

## features

### change volume

Press up or down on the volume keys on the side of the phone to change the headset volume during a call.

## headset

## features

### auto answer

Automatically answer calls when connected to a headset:

 >  Settings > Headset & Car Setting > Auto Answer

**Note:** Both mono and stereo headsets are supported for voice only.



## advanced calling

## features

### international calls

If your phone service includes international dialling, press and hold  to insert your local international access code (indicated by +). Then, press the keypad keys to dial the country code and phone number.



## features

### call forward



Set up or cancel call forward:

 >  Settings > Call Forward

### speed dial

Each **Phonebook** entry you store is assigned a unique speed dial number. To display the speed dial number allocated to a contact number:

 >  Phonebook > [Entry] > 



To speed dial a number, simply enter the speed dial number and press  then .

## features

### restrict calls



Restrict outgoing or incoming calls:

 >  Settings > Security > Call Barring

Select **Outgoing Calls**, **Incoming Calls** or **Cancel All** and press **Select**.

When prompted, enter the unlock code (supplied by your service provider) and press **OK**.

# messages

---

You can send and receive SMS/EMS and MMS multimedia messages as well as access your voicemail from the Messages feature. Each message type allows you to attach different objects. The available options are displayed in the **Insert** menu.



**Note:** Your phone can store a maximum of 750 messages, shared between the **Inbox**, **Outbox** and **Draft** folders.

## send a message

**Find it:**  >  Messages > Create Message

- 1 Select a message type and enter the message text.
- 2 To insert a picture, sound, or other object, press **Options > Insert**.

- 3 When you finish the message, press **Send**. Choose one or more people to send to.
- 4 Press **Options > Send**.

## receive a message

When you receive a message, your phone plays an alert and flashes the  (new message) external indicator on the top of the phone, and displays a new message notification on the home screen. Press the **Read** softkey to read the message immediately, or save it in your message inbox for viewing later. To read messages in your message inbox:

**Find it:**  >  Messages > Message Inbox



Scroll to the message you want to read. Press **Select** to open the message. For MMS messages, your phone displays the media object, then the message.

## voicemail

Your network stores the voicemail messages you receive.



When you **receive** a voicemail message, your phone shows an indicator and **New Voicemail**. Press **Call** to call your voicemail.

**To check your voicemail messages at any time:**

**Find it:**  >  Messages > Voicemail > 

**Note:** Your service provider may have assigned speed dial number **1** for calling voicemail and may provide additional information about using voicemail.



## more message features

### features

#### send text message

 >  Messages > Create Message > New Short Msg

Press **Options** > **Insert** to view insert options.

You can also select a contact first. Press  >  Phonebook > [Entry] > Options > Send Message to compose a message.

#### use MMS template

Select a multimedia template with preloaded media:

 >  Messages > MMS Templates

#### view sent, received and draft messages

 >  Messages > Outbox, Message Inbox, or Drafts

## features



### erase messages

Delete all messages or only messages from one folder:

 >  Messages > Options > Cleanup Messages



Select All, Inbox, Outbox, or Drafts.

### set up voicemail

 >  Messages > Options > Voicemail Setup



### view the message memory status

 >  Messages > Options > Memory Meter > SMS Status or MMS Status

# entertainment

## photos



Your camera lens is on the back of your phone (see page 3). **To get the clearest pictures, wipe the lens clean with a soft dry cloth before you take a picture.**

## camera key

The camera key  gives you quick access to the camera from the home screen.

**Tip:** Sliding your phone closed or open rotates the camera screen controls 90 degrees.

## take a photo

Press  to access the camera and then press  again to capture your image.

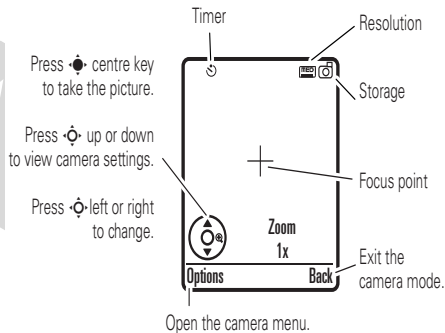

## photo features

Before you capture your photo, you can press **Options** to open the camera menu:

options	
<b>Go to Picture</b>	Switches to the <b>Pictures</b> menu.
<b>Go to Video Mode</b>	Switches the viewfinder to <b>Video Mode</b> .
<b>Auto-Timed Capture</b>	Turn the auto-timed capture to <b>5 sec</b> or <b>10 sec</b> .
<b>Camera Setup</b>	Set the <b>Resolution</b> , <b>Quality</b> , <b>Auto save</b> , <b>Shutter Sound</b> or <b>Status Icon</b> settings.
<b>Switch Storage</b>	Switch between the <b>Phone Memory</b> and <b>Mass Storage</b> or memory card.
<b>Free Space</b>	Shows the <b>Total Space</b> , <b>Used Space</b> and <b>Free Space</b> on your storage device.

Before you capture your photo, you can use the navigation keys to change the **Zoom**, **Exposure**, **Lighting** and **Condition Style** settings:

options	
<b>Zoom</b>	Set the zoom for your photo ( <b>1x</b> , <b>2x</b> , <b>3x</b> or <b>8x</b> ).
<b>Exposure</b>	Change the exposure of your photo ( <b>-2</b> , <b>-1</b> , <b>0</b> , <b>+1</b> or <b>+2</b> ).
<b>Lighting Condition</b>	Change the lighting setting to <b>Indoor (Home)</b> , <b>Indoor (Office)</b> , <b>Night</b> , <b>Automatic</b> , <b>Sunny</b> or <b>Cloudy</b> .
<b>Style</b>	Change the effect of your photo ( <b>Colour</b> , <b>B &amp; W</b> , <b>Contrast</b> , <b>Sunset</b> , <b>Cold</b> , <b>Antique</b> , <b>Blue</b> , <b>Red</b> or <b>Green</b> ).

After you capture your photo, press the right soft key to **Send** your picture in a message. You can also press **Options** to open the **Picture Options** menu:



options	
Store Only	Saves the photo in the <b>Pictures</b> menu.
Discard	Discard the photo and return to viewfinder.
Apply as	Set the photo as a wallpaper (background) image in your home screen.
Detail	Shows the photo <b>File Type</b> , <b>File Size</b> and <b>Resolution</b> settings.

**Tip:** You can also press  to return to the viewfinder.

## video recorder

Your camera lens is on the back of your phone (see page 4). **To get the clearest video clips, wipe the lens clean with a soft dry cloth before you use the camcorder.**

### record a video

**Find it:**  > Options > Go To Video Mode.

**Shortcut:** Press and hold  to access video mode quickly.

Press  to start and recording, press the left soft key to **Stop**.

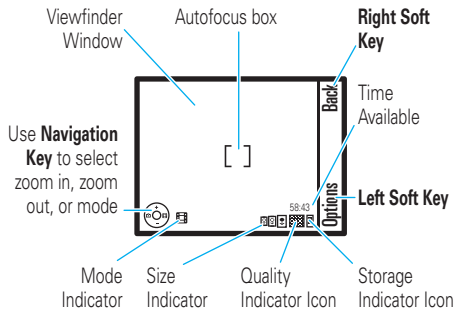

## video features

Before you capture your video, you can press **Options** to open the video recorder menu:

options	
<b>Image mode</b>	Switches the viewfinder to <b>Camera mode</b> .
<b>Torch</b>	Set your torch to <b>On</b> or <b>Off</b> (primary camera only).
<b>Modes</b>	Change the mode of your video ( <b>Normal, Indoor, Outdoor, Sports, Portrait, Night, and Backlight</b> ).
<b>Style</b>	Change the effect of your video ( <b>Colour, Black &amp; White, Contrast, Sunset, Cold, Antique, Blue, Red, and Green</b> ).
<b>Video Size</b>	Adjust your video size between <b>Small (SQCIF)</b> and <b>Medium (QCIF)</b> .



options	
Video Quality	Adjust your video quality between <b>Good</b> , <b>Better</b> , and <b>Best</b> .
Settings	Set more video features.

After you record your video, you can use the navigation keys:



keys	
centre	Play/Pause (preview) the video.
up	Go to the <b>Media Gallery</b> .
down	Go to <b>Send as</b> menu.
left	Return to viewfinder.
right	Discard and return to viewfinder.

Press **Options** > **Store Only** to save your video clip.

## FM radio

**Find it:**  >  > **FM Radio**

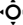
To use the **FM Radio** you need to connect a stereo headset to the 2.5 mm headset jack.

- Press  up or down to change the frequency.
- Press  left or right to scan for preset radio stations.
- Press the up or down volume keys on the side of the phone to adjust the volume.
- Press  to mute the radio.

### use the radio presets

- 1 Tune in the desired frequency by pressing  up or down, or press **Options** > **Scan** to scan for all available radio stations.

- 2 Press and hold a number key to save that number as the preset.

## radio presets



From the main FM radio screen press a key pad number to jump to a preset station.

To manage your station presets:

- 1 Press **Options** > **Manage Presets** to store, rename or delete radio presets.
- 2 Press  up or down to select a preset.

## music player

Use your phone to play iMelody, MIDI, MP3, and WAV music file types:

**Find it:**  >  > **Music Library**

**Note:** Your phone may not play MP3 files that have a bit rate higher than 320 kbps. If you try to download or

play one of these files, your phone may display an error message or ask you to delete the file.

**Tip:** Connect a stereo headset for high quality music playback.







From the Music Library, open one of the following:

tab	
<b>Artists</b>	Select an artist to show or play their songs.
<b>Albums</b>	Select an album to show or play its songs.
<b>Genres</b>	Select a genre of music to show or play its songs.
<b>Playlists</b>	Play and manage your playlists.
<b>All Songs</b>	Select a track to show or play songs.
<b>Now Playing</b>	Select the track that is currently playing.



## music player controls

Once the music player is displayed:



function	
<b>scroll through song list</b>	Before music playback, press  up or down.
<b>play</b>	Press <b>Play</b> .
<b>pause/resume</b>	Press  .
<b>fast forward</b>	Press & hold  right (for at least two seconds).
<b>skip to next song</b>	Press & release  right.
<b>rewind</b>	Press & hold  left (for at least two seconds).
<b>return to last song</b>	Press & release  left.
<b>turn off</b>	Press <b>Back</b> .

**Tip:** You can listen to music as you travel. Use Bluetooth® A2DP enabled devices, such as stereo headphones, for enhanced music quality and use Bluetooth AVRCP enabled devices, such as car stereos, to control playback.

**Note:** The Music Library is used to play music or videos. You cannot play both at the same time.

## playlists

**Find it:**  >  > Music Library > Playlists

- To create a new playlist, press  > **Create New Playlist**.
- To edit an existing playlist, press  > **All > playlist > Edit**
- To select and play a playlist, scroll to the playlist and press **Play**.

## music playlist options

option	
Play	Play a track or playlist.
Apply to Playlist	Add a track/s to an existing playlist.
Send	Send a track using Bluetooth.
Filter By	Filter your tracks by <b>Album</b> , <b>Genre</b> or <b>Playlists</b> .
Apply As	Use a track as your ringtone.
Manage	<b>Delete</b> , <b>Move</b> or <b>Copy</b> a track.
Select Multiple To	Select multiple tracks to <b>Add to Playlist</b> , <b>Delete</b> , <b>Move</b> , <b>Copy</b> or <b>Send via Bluetooth</b> .
Properties	View the property details for a track
Refresh	Refresh your music library.

## get music

Copy music to your phone's memory card.

### Connect:

- 1 With a memory card inserted and your phone in the home screen, insert the USB cable in your phone and your Windows PC.

**Note:** Your phone supports Microsoft® Windows Vista and Windows XP™. Other operating systems may not be compatible with your phone.

**Note:** For USB cable connection details, see page 69.

- 2 Now you've connected, use Windows Media Player or USB drag and drop to copy your music.

## Windows Media Player:

- 1 On your Windows PC, open Microsoft® Windows® Media Player 11.  
**Note:** The first time you connect your phone, Windows Media Player® will start a **Device Setup** procedure to name your phone (**ZN200 Mobile**) and configure the **Sync** options.
- 2 With Windows® Media Player 11 open, select **Sync > ZN200 Mobile > Advanced Options**.
- 3 Check the **Create folder hierarchy on device** box, and click **OK**.
- 4 Drag the music files over to the **Sync List** and click **Start Sync**.

## USB drag and drop:

- 1 Use the My Computer window to find Removable Device. The **mobile** folder is automatically available.



- 2 Drag and drop your music, photos, videos and other stuff that you want to copy into the **mobile** folder.  
Three more folders are available in **mobile**: **Melody**, **Picture** and **Video**. To help manage your music, you can create more folders in the **Melody** folder.
- 3 When you're done, use the **Safely Remove Hardware** feature to finish.

## voice notes

**Find it:**  >  > Voice Notes

Use the **Voice Notes** feature to record messages and reminders to yourself.

## my picture

**Find it:**  >  > My Picture

Use the **My Picture** feature to edit or crop your photos.

## edit pictures

**Find it:**  >  > My Picture > Editor

options	
<b>Open</b>	Open an existing picture or take a new one.
<b>Save</b>	Save your image with a unique file name.
<b>Pen Attribution</b>	Change the pen mode ( <b>mode, color, size, Sports, and step</b> ).
<b>Zoom In</b>	Zoom in on an area of your image.
<b>Zoom Out</b>	Zoom out to see more of your image.
<b>Stamp Options</b>	

### options

**Rotate** Rotate your image (**Clockwise 90°, Counterclockwise 90° or 180°**).

**Picture Size** Set the dimensions of your image.

**Clear Screen** Remove the current image from the screen.

## crop photos

**Find it:**  >  > My Picture > Cropper

### options



**Open** Open an existing picture or take a new one.

**Save** Save your image with a unique file name.

options	
Crop size	Change the size of the crop area.
Crop shape	Set the type of crop shape (Rectangle, Round rectangle, Square, Oval, Circle, Arc, Heart, Star, Diamond).

## WebAccess

Use your phone to access Web pages.

**Find it:**  >  WebAccess

### WebAccess options

option	
Browser	Open the Web browser.
Web Shortcuts	Access a preset shortcut to a Web page.

option	
Go to URL	Enter a Web page URL.
History	Access a list of recently viewed Web sites.
Web Sessions	Access a stored Web session.
Web Settings	Clear history, reset cache or clear cookies.

### open a Web page

- 1 Press **Options** > **Go to web page** and enter the Web address, such as **www.motorola.com**.
- 2 If necessary, select **Options** > **Open in new page**.
- 3 Press **Options** > **Open**.

## manage bookmarks

To see your bookmarks press **Options** > **Bookmarks**. To manage your bookmarks press **Options** to open the bookmarks menu:

options	
Open	Opens your bookmarked Web page.
Add bookmark	Add a bookmark.
Edit bookmark	Edit a bookmark.
Delete	Delete a bookmark.
Send bookmark as	Send bookmark in an MMS message or via Bluetooth.
Open in new page	Opens your bookmarked Web page in a new page.

## fun & games

### features

#### play a game

 >  Games

#### manage pictures



 >  Multimedia > Pictures

#### manage sounds

 >  Multimedia > Media Folder

#### manage ringtones

 >  Settings > Ring Styles

**Note:** To access music or pictures stored on your microSD memory card, press  >  Multimedia > Pictures or Media Finder and press **Options** > **Switch Storage**. If there are no files stored on your memory card then

your phone will automatically switch to its internal memory.

DRAFT

# tools

## personal organiser

### features

#### add calendar event

 >  Tools > Calendar

Scroll to the desired day and press , then scroll to **[Add New]** and press **Select**.

#### view calendar event

View or edit event details:

 >  Tools > Calendar

Scroll to the desired day and press , then scroll to the event and press **Select**.

### features

#### event reminder

When an event reminder occurs, press  to view it. Press **Exit** to dismiss it.

#### copy calendar event

Copy a datebook event to another date and/or time:

 >  Tools > Calendar

Scroll to the desired day and press **Select**, then scroll to the event and press . Scroll to **Copy** and press **Select**.



## features

### set alarm

 >  Alarm Clock

**Note:** You can set the FM radio as your alarm device by selecting **Alert** > **Radio** from the **Alarm Details** menu.

### calculator

Calculate numbers:

 >  Tools > Calculator

### convert currency

 >  Tools > Calculator

Press **Options** and select **Convert**.

# phonebook



## features

### create entry

 >  Phonebook > [New Entry]

### edit entry

 >  Phonebook

Scroll to the entry and press **Options** > **Edit** to edit the entry. Scroll up or down and press  to edit fields. Press  to save your changes.

### delete entry

 >  Phonebook

Scroll to the entry and press **Options** > **Delete**

## network

### features

#### network settings

View network information and adjust network settings:

 >  Settings > Network

#### select a band

 >  Settings > Network > Network Setup > Band



## USB

### features

#### USB setting

Set your phone's mini USB connection to function as a modem or storage device:

 >  Settings > USB > USB Modem or USB Disk

**Note:** Your USB connection must be set to USB Disk before copying files from your PC to your phone. (see page 69).

## master clear

### features

#### master clear

Reset all options except unlock code, security code, and lifetime timer, and clear all user settings and entries.

**This option erases all user-entered information stored in your phone memory, including Contacts entries and downloaded files.** Once you erase the information, it cannot be recovered. It resets all options to their factory settings except for the unlock code, security code, and lifetime timer.

•📶 > ⚙️ Settings > Initial Setup > Master Clear

To reset all options, you need to enter the **Security Code (000000)**.

## master reset

### features

#### master reset

Reset all options except unlock code, security code, and lifetime timer:

•📶 > ⚙️ Settings > Initial Setup > Master Reset

To reset all options, you need to enter the **Security Code (000000)**.

# connections

---

## Bluetooth® wireless

Your phone supports Bluetooth wireless connections with audio devices, such as a handsfree headset or music system.

**Note:** The use of wireless phones while driving may cause distraction. Discontinue a call if you can't concentrate on driving. Additionally, the use of wireless devices and their accessories may be prohibited or restricted in certain areas. Always obey the laws and regulations on the use of these products.

**For maximum Bluetooth security**, you should always connect Bluetooth devices in a safe, private environment.

## connect to an audio device

**Before you try to connect your phone with an audio device**, make sure the device is **on** and **ready** in *pairing* or *bonding* mode (see the user's guide for the device).

**Find it:**  >  Settings > Bluetooth > Add Audio Device 

If Bluetooth is off, you will be prompted to turn it on. Your phone lists the devices it finds within range:

- 1 Scroll to a device in the list and press the *centre key* .
- 2 If necessary, press the **Yes** or **OK** key to connect to the device.

- 3 If necessary, enter the device passkey (such as 0000) and press the **OK** key.

When your phone is connected, the Bluetooth indicator  is highlighted in the status bar and displayed on the top of the phone.

**Shortcut:** When your phone's Bluetooth power is on, your phone can automatically connect to a handsfree device you have used before. Just turn on the device, or move it near the phone. If the device doesn't connect, turn it off and back on.

## send files to another device

You can send a media file, contacts entry, agenda event and more from your phone to a computer or other device.



**Note:** You can't copy some copyrighted objects.

- 1 On your phone, scroll to the object that you want to copy to the other device.

- 2 Press **Options > Copy to Bluetooth Device**.
- 3 Select a recognised device name, or **New Device** to search for the device where you want to copy the file.



**If your phone could not send the file to the other device**, make sure the device is **on** and **ready** in *discoverable* mode (see the user's guide for the device). Also, make sure the device is not busy with another similar Bluetooth connection.

**Note:** Once you connect your phone to a Bluetooth device, that device can start similar Bluetooth connections with your phone. When your phone is connected, the Bluetooth indicator  is highlighted in the status bar and displayed on the top of the phone.



## receive files from another device

If you do not see the Bluetooth indicator  in the status bar, turn on your



phone's Bluetooth feature by pressing  >  **Settings**  
> **Bluetooth** > **Power On**.

- 1 Place your phone near the device, and send the file from the device.









If your phone and the sending device don't recognise each other, place your phone in discoverable mode so the sending device can locate it:. Press  >  **Settings** > **Bluetooth** > **Find Me**.





- 2 Press the **Accept** key on your phone to accept the file from the other device.

Your phone notifies you when file transfer is complete.

## advanced Bluetooth features

**Note:** A device is *recognised* after you have paired or bonded with it (see page 66).

features	
<b>change your phone's name</b>	
 >  <b>Settings</b> > <b>Bluetooth</b> > <b>Setup</b> > <b>Name</b>	
<b>make phone visible to other devices</b>	
Allow a Bluetooth device to discover your phone:	
 >  <b>Settings</b> > <b>Bluetooth</b> > <b>Find Me</b> .	
<b>connect to recognised device</b>	
Connect your phone to a recognised device:	
 >  <b>Settings</b> > <b>Bluetooth</b> > <b>Setup</b> > <i>device name</i>	

features	
<p><b>disconnect a headset or handsfree device</b> </p> <p> &gt;  Settings &gt; Bluetooth &gt; Setup</p> <p>Scroll to the device name and press Options &gt; Disconnect.</p>	
<p><b>switch to headset or handsfree device during call</b> </p> <p>During a call, press Options &gt; Audio &gt; <i>device name</i>, to switch to a recognised headset or car kit.</p>	
<p><b>copy multimedia object to device</b> </p> <p>Scroll to the object, press Options &gt; Copy to Bluetooth Device &gt; Look for Devices, select the device name.</p> <p>You cannot copy some copyrighted files.</p>	

## cable connections

You can use your phone's mini USB port to connect to a computer.

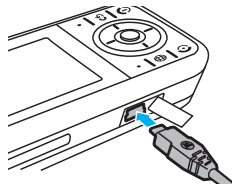

**Note:** Motorola Original™ USB data cables and supporting software may be sold separately. You can download software and buy a cable from Motorola Phone Tools at [direct.motorola.com/hellomoto/phonetools](http://direct.motorola.com/hellomoto/phonetools).

If you use a USB cable connection:

- Be sure to connect the phone to a high-power USB port **on your computer** (not a low-power one, such as the USB port on your keyboard or bus-powered USB hub).

**Note:** If you connect your phone to a low-power USB port, the computer may not recognise your phone.

- Make sure both your phone and the computer are turned on and the phone is in the home screen.

**Note:** When your phone is plugged into a computer and is being used for mass storage, it cannot be used for anything else. To restore the phone to normal use, disconnect it from the PC.

- Make sure your phone's **USB** setting is **USB**

**Disk:**  >  **Settings** > **USB** > **USB Disk**

- Your phone currently supports Microsoft® Windows® 2000 and Windows XP™. Other operating systems may not be compatible with your phone.

Attach the Motorola Original USB cable to the mini USB port on your phone and to an available USB port on your computer.

**Note:** The battery will start charging.

On your computer:

- 1 Open your “My Computer” window, where your phone’s memory card shows as a “Removable Disk” icon.
- 2 Click on the “Removable Disk” icon to access the memory card.
- 3 If necessary, in the “Removable Disk” (memory card) window, create one or more folders for the files you will copy onto the memory card.
- 4 To copy files between your computer and phone, drag and drop into the appropriate folders.
- 5 When you’re finished, remove the device by selecting the “Safely Remove Hardware” icon at the bottom of your computer screen, then select “USB Mass Storage Devices” and “Stop”.

Use these folders on your memory card for the file types indicated:



**Note:** To help manage your files, you can also create new folders in the existing folders.

- music files (iMelody, MIDI, MP3 and WAV,): **Mobile\Melody**. (see page 56. 
- picture files (JPG, PNG, or BMP): **Mobile\Picture**.
- video file **Mobile\Video**.

**Note:** The maximum single picture file size is 600 kB.

# service & repairs

---

If you have questions or need assistance, we're here to help.

Go to [www.motorola.com/support](http://www.motorola.com/support), where you can select from a number of customer care options. You can also contact the Motorola Customer Support Center at 1-800-331-6456 (United States), 1-888-390-6456 (TTY/TDD United States for hearing impaired), or 1-800-461-4575 (Canada).

# Specific Absorption Rate Data

---

## This model wireless phone meets the government's requirements for exposure to radio waves.

Your wireless phone is a radio transmitter and receiver. It is designed and manufactured not to exceed limits for exposure to radio frequency (RF) energy set by the Federal Communications Commission (FCC) of the U.S. Government and by the Canadian regulatory authorities. These limits are part of comprehensive guidelines and establish permitted levels of RF energy for the general population. The guidelines are based on standards that were developed by independent scientific organizations through periodic and thorough evaluation of scientific studies. The standards include a substantial safety margin designed to assure the safety of all persons, regardless of age or health.

The exposure standard for wireless mobile phones employs a unit of measurement known as the Specific Absorption Rate, or SAR. The SAR limit set by the FCC and by the Canadian regulatory authorities is 1.6 W/kg.<sup>1</sup> Tests for SAR are conducted using standard operating positions accepted by the FCC and by Industry Canada with the phone transmitting at its highest certified power level in all tested frequency bands. Although the SAR is determined at the highest certified power level, the actual SAR

level of the phone while operating can be well below the maximum value. This is because the phone is designed to operate at multiple power levels so as to use only the power required to reach the network. In general, the closer you are to a wireless base station, the lower the power output.

Before a phone model is available for sale to the public in the U.S. and Canada, it must be tested and certified to the FCC and Industry Canada that it does not exceed the limit established by each government for safe exposure. The tests are performed in positions and locations (e.g., at the ear and worn on the body) reported to the FCC and available for review by Industry Canada. The highest SAR value for this model phone when tested for use at the ear is **0.64 W/kg**, and when worn on the body, as described in this user guide, is **0.85 W/kg**. (Body-worn measurements differ among phone models, depending upon available accessories and regulatory requirements).<sup>2</sup>

While there may be differences between the SAR levels of various phones and at various positions, they all meet the governmental requirements for safe exposure. Please note that improvements to this product model could cause differences in the SAR value for later products; in all cases, products are designed to be within the guidelines.

# Hearing Aid Compatibility with Mobile Phones

---

Some Motorola phones are measured for compatibility with hearing aids. If the box for your particular model has "Rated for Hearing Aids" printed on it, the following explanation applies.

When some mobile phones are used near some hearing devices (hearing aids and cochlear implants), users may detect a buzzing, humming, or whining noise. Some hearing devices are more immune than others to this interference noise, and phones also vary in the amount of interference they generate.

The wireless telephone industry has developed ratings for some of their mobile phones, to assist hearing device users in finding phones that may be compatible with their hearing devices. Not all phones have been rated. Phones that are rated have the rating on their box or a label on the box.

The ratings are not guarantees. Results will vary depending on the user's hearing device and hearing loss. If your hearing device happens to be vulnerable to interference, you may not be able to use a rated phone successfully. Trying out the phone with your hearing device is the best way to evaluate it for your personal needs.

**M-Ratings:** Phones rated M3 or M4 meet FCC requirements and are likely to generate less interference to hearing devices than phones that are not labeled. M4 is the better/higher of the two ratings.

**T-Ratings:** Phones rated T3 or T4 meet FCC requirements and are likely to be more usable with a hearing device's telecoil ("T Switch" or "Telephone Switch") than unrated phones. T4 is the better/higher of the two ratings. (Note that not all hearing devices have telecoils in them.)

Hearing devices may also be measured for immunity to this type of interference. Your hearing device manufacturer or hearing health professional may help you find results for your hearing device. The more immune your hearing aid is, the less likely you are to experience interference noise from mobile phones.

# Information from the World Health Organization

---

Present scientific information does not indicate the need for any special precautions for the use of mobile phones. If you are concerned, you may want to limit your own or your children's RF

exposure by limiting the length of calls or by using handsfree devices to keep mobile phones away from your head and body.

Source: WHO Fact Sheet 193

Further information: <http://www.who.int/peh-emf>

## Product Registration

---

Online Product Registration:

[direct.motorola.com/hellomoto/Motosupport/source/registration.asp](http://direct.motorola.com/hellomoto/Motosupport/source/registration.asp)

Product registration is an important step toward enjoying your new Motorola product. Registering helps us facilitate warranty service, and permits us to contact you should your product require an update or other service. Registration is for U.S. residents only and is not required for warranty coverage.

Please retain your original dated sales receipt for your records. For warranty service of your Motorola Personal Communications Product you will need to provide a copy of your dated sales receipt to confirm warranty status.

Thank you for choosing a Motorola product.

# Privacy and Data Security

---

Motorola understands that privacy and data security are important to everyone. Because some features of your mobile device may affect your privacy or data security, please follow these recommendations to enhance protection of your information:

- **Monitor access**—Keep your mobile device with you and do not leave it where others may have unmonitored access. Lock your device's keypad where this feature is available.
- **Keep software up to date**—If Motorola or a software/application vendor releases a patch or software fix for your mobile device which updates the device's security, install it as soon as possible.
- **Erase before recycling**—Delete personal information or data from your mobile device prior to disposing of it or turning it in for recycling. For step-by-step instructions on how to delete all personal information from your device, see the section entitled "master clear" or "delete data" in this user's guide.

**Note:** For information on backing up your mobile device data before erasing it, go to [www.motorola.com](http://www.motorola.com) and then navigate to the "downloads" section of the consumer Web page for "Motorola Backup" or "Motorola Phone Tools."

- **Understanding AGPS**—In order to comply with emergency caller location requirements of the FCC, certain Motorola mobile devices incorporate *Assisted Global Positioning System* (AGPS) technology. AGPS technology also can be used in non-emergency applications to track and monitor a user's location—for example, to provide driving directions. Users who prefer not to permit such tracking and monitoring should avoid using such applications.

If you have further questions regarding how use of your mobile device may impact your privacy or data security, please contact Motorola at [privacy@motorola.com](mailto:privacy@motorola.com), or contact your service provider.

# Smart Practices While Driving

## Drive Safe, Call Smart

**Check the laws and regulations on the use of mobile devices and their accessories in the areas where you drive. Always obey them. The use of these devices may be prohibited or restricted in certain areas -- for example, handsfree use only. Go to [www.motorola.com/callsmart](http://www.motorola.com/callsmart) (in English only) for more information.**

Your mobile device lets you communicate by voice and data—almost anywhere, anytime, wherever wireless service is available and safe conditions allow. When driving a car, driving is your first responsibility. If you choose to use your mobile device while driving, remember the following tips:

- **Get to know your Motorola mobile device and its features such as speed dial and redial.** If available, these features help you to place your call without taking your attention off the road.
- **When available, use a handsfree device.** If possible, add an additional layer of convenience to your mobile device with one of the many Motorola Original handsfree accessories available today.
- **Position your mobile device within easy reach.** Be able to access your mobile device without removing your



eyes from the road. If you receive an incoming call at an inconvenient time, if possible, let your voicemail answer it for you.

- **Let the person you are speaking with know you are driving; if necessary, suspend the call in heavy traffic or hazardous weather conditions.** Rain, sleet, snow, ice, and even heavy traffic can be hazardous.
- **Do not take notes or look up phone numbers while driving.** Jotting down a “to do” list or going through your address book takes attention away from your primary responsibility—driving safely.
- **Dial sensibly and assess the traffic; if possible, place calls when your car is not moving or before pulling into traffic.** If you must make a call while moving, dial only a few numbers, check the road and your mirrors, then continue.
- **Do not engage in stressful or emotional conversations that may be distracting.** Make people you are talking with aware you are driving and suspend conversations that can divert your attention away from the road.
- **Use your mobile device to call for help.** Dial 911 or other local emergency number in the case of fire, traffic

accident, or medical emergencies.\*

- **Use your mobile device to help others in emergencies.** If you see an auto accident, crime in progress, or other serious emergency where lives are in danger, call 911 or other local emergency number, as you would want others to do for you.\*
- **Call roadside assistance or a special non-emergency wireless assistance number when necessary.** If you see a broken-down vehicle posing no serious hazard, a broken traffic signal, a minor traffic accident where no one appears injured, or a vehicle you know to be stolen, call roadside assistance or other special non-emergency wireless number.\*

---

\* Wherever wireless phone service is available.



# index

---

- A**
  - add calendar event 62
  - adjust volume 24
  - advanced
    - Bluetooth features 68
    - calling 44
  - alarm set 63
  - alerts 35
  - answer
    - anykey 38
    - automatic 44
    - call 24
    - options 36
- B**
  - backlight 37
  - band selection 64
  - battery 20
    - charge 23
    - install 22
    - remove 23
  - Bluetooth 44
    - advanced features 68
    - change your phone's name 68
    - connect to a recognised device 68
    - connection
      - description 66
      - indicator 67
    - copy multimedia 69
    - disconnect a headset or handsfree device 69
    - make phone visible to other devices 68
  - receive files 67
  - send files 67
  - status indicator 27
  - switch audio during a call 69
- bookmarks 60
- C**
  - cable connections 69
  - calculator 63
  - calendar event
    - add 62
    - copy 62
    - reminder 62
    - view 62
  - call
    - advanced 44
    - answer 24

end 24  
international 44  
make 24  
recent 40  
restrict 45  
stored number 25  
times 42  
view times 43  
waiting 41  
camera key 2, 49  
capitalise text 29  
centre key 2  
change  
    ring alert 24  
    volume 44  
charge battery 23  
clear 65  
clear/back key 2  
closed slide 36  
codes 32

colour setting 37  
contacts 63  
    create entry 63  
    delete entry 63  
    edit entry 63  
    list 43  
controls, music player 55  
convert currency 63  
copy  
    calendar event 62  
    files 67  
    music 56  
costs, tracking 43  
currency converter 63  
customise 35

## D

date 38  
delete text 31  
dial a phone number 24  
dialled calls 40

list 43  
digital clock 38  
display 26  
drag and drop files 57

## E

edit pictures 58  
emergency number 42  
end a call 24  
end key 2, 24  
erase messages 48  
external display 27

## F

FM radio 53  
    preset stations 53

## G

games 60  
get music 56

## H

- handsfree 32
- headset 44
- hold call 43
- home screen 26
  - navigation keys 38
  - shortcuts 35

## I

- in call
  - cost 43
  - menu 43
  - timer 42
- incoming call indicator 27
- indicator
  - Bluetooth 67
  - Bluetooth status 27
  - incoming call 27
  - lights 2
  - new message 27

- status 27
- text entry mode 29

## install

- battery 22
- memory card 19
- international access code 44
- iTAP text entry method 30

## K

- keypad
  - lock and unlock 25
  - volume 38

## L

- language menu 39
- layout text 38
- linking. See Bluetooth connection
- lock
  - keypad 25
  - phone 32

## M

- make a call 24
- make a second call 43
- manage
  - pictures 60
  - ringtones 60
  - sounds 60
- master
  - clear 65
  - reset 65
- memory card 33
  - install 19
  - remove 20
- menu
  - icons, show or hide 38
  - language 39
- messages
  - access 44
  - delete text 31
  - erase 48

- iTap entry method 30
- MMS 47
- numeric entry 31
- receive 46
- send 46
- set entry mode 28
- symbol entry 31
- tap text entry 30
- text capitilisation 29
- text entry 28
- text entry mode indicators 29
- text message 47
- text template 47
- view sent message 47
- microphone 2
- Missed Calls message 41
- MMS 47
- modem 64
- music
  - copy 56

- player 54
  - controls 55
  - playlist 55
  - playlist 56
- mute 43
- my picture 57

## N

- navigation key 2, 26
- network settings 64
- new message indicator 27
- notepad 42
- number redial 40
- numeric entry method 31

## O

- object exchange 67
- open web page 59
- options, music playlist 56

## P

- pairing. See Bluetooth connection
- passwords. See codes
- personal organiser 62
- phone lines 43
- phone lock
  - change code 33
- phone number store 24
- phonebook 63
  - create entry 63
  - delete entry 63
  - edit entry 63
- photos 49
- pictures 60
  - edit 58
- playlists 55
- power key 2, 23
- preset radio stations 53
- primary text entry mode 28

## R

- radio 53
  - preset stations 53
- receive a message 46
- received calls 40
  - list 43
- recent calls 40
- record a video 51
- redial 40
- reminder 38, 62
- remove
  - battery 23
- reset 65
- restrict calls 45
- return a call 41
- ring
  - alert 24
  - style
    - set 35
  - volume 37

ringtones 60

## S

- screen saver 37
- secondary text entry mode 28
- security codes 32
- select network band 64
- send
  - key 2, 24
  - message 46
  - text message 47
- set
  - alarm 63
  - alerts 35
  - colour 37
  - reminder 38
  - screen saver 37
  - style 35
  - time & date 38
  - wallpaper 36
- shortcuts 34

SIM

- install 19
- skin 37
- slide
  - closed 36
  - tone 38
- soft keys 2, 26
- sound 60
- speaker
  - handsfree 32
- speakerphone 43
- speed dial 45
- status indicators 27
- storage 33, 64
- stored
  - files 60
  - phone number 24
    - call 25
- style setting 35
- symbol entry method 31

## T

- take a photo 49
- tap text entry method 30
- template 47
- text
  - delete 31
  - entry 28
    - capitalisation 29
    - mode indicators 29
  - layout 38
- text entry
  - set mode 28
- time 38
- tips & tricks 34
- turn on/off 23

## U

- unlock
  - code 32
  - keypad 25

phone 32

## USB

- cables 69
- drag and drop 57
- function
  - modem 64
  - storage 64

## V

- video recorder 51
- view
  - calendar event 62
  - messages 47
- voice notes 57
- voicemail
  - message indicator 47
  - setup 48
- volume
  - adjust 24
  - change 44
  - keypad 38

keys 2

ring 37

## W

- wallpaper 36
- web access key 2
- WebAccess 59
- Windows Media Player 57

US patent Re. 34,976



[www.motorola.com](http://www.motorola.com)

