



want. If you need help or have questions about Android Market, press Menu  > **Help**.

BROWSE & INSTALL APPS

Tip: Choose your apps and updates carefully, from trusted sites like  **Market**, as some may impact your phone's performance—see “**CHOOSE CAREFULLY**” on page 37.

Find it:  >  **Market**

Select a category or touch **Search** to find the app you want. Then, touch **Install** (if app is free) or **Buy**.

When installing an app, make sure you read the alerts that tell you what information the app will access. If you don't want the app to have access to this information, cancel the installation.

MANAGE & RESTORE APPS

Find it:  >  **Market** > **My apps**

There are lots of apps available and many are free. So you might find that you have downloaded and installed lots of apps on your phone. That's fine, but you may want to uninstall apps that you no longer use.

To uninstall touch an app in the list, and then touch **Uninstall**.

To restore an app, touch the app in the list. The **My apps** list shows previously installed apps.

For other app management features including clearing app data and cache, press Menu  > **Settings** > **Applications** > **Manage applications**, then touch an app in the list.

CHOOSE CAREFULLY

Apps are great. There's something for everyone. Play, communicate, work, or just for fun. But remember, choose your apps carefully. Here's a few tips to help:

- To help prevent spyware, phishing or viruses affecting your phone or privacy, use apps from trusted sites, like  **Market**.
- In **Market**, check the apps' ratings and comments before installing. This will help you choose the best ones for you.
- If you doubt the safety of an app, don't install it.
- Like all apps, downloaded apps will use up memory, data, battery, and processing power—some more than others. For example, simple settings widget will use less than a streaming music player app. After installing an app, if you're not happy with how much memory, data, battery or processing power it's using, uninstall it. You can always install it again later.

CONNECTIONS

The MOTOROLA PHOTON 4G has a dual core 1GHz processor, 1GB of RAM, and 16GB of internal memory.





You can share media over a DLNA wireless connection. Or:





- An optional **Lapdock™** opens the webtop application and includes a display, full keyboard, and touchpad.
- An optional **HD Multimedia Dock** opens the webtop application and lets you connect your HDMI display, keyboard, and mouse.

You can do more with other docks too:

- A **Standard Dock** shows an alarm and shortcuts you can set for each dock, plus it lets you connect headphones or speakers.
- A **Vehicle Dock** shows shortcuts you can set to maps, navigation, and Internet services like voice search and radio.

CONNECTIONS QUICK REFERENCE

Follow the references to find out how to use a USB , HDMI , Wi-Fi , or Bluetooth  connection.

To...				
transfer files	46	-	46	41
hear music	-	38	40	41
play videos	-	38	40	41
show pictures	-	38	40	-
make handsfree calls	-	-	-	41
remote control	-	-	-	41
use controllers and keyboards	-	-	-	41
manage contacts and more	46	-	46	41

WEBTOP APPLICATION

CONNECT THE WEBTOP APPLICATION

The webtop application lets you browse, or use web apps, on a large screen in a full Firefox browser. Create and share documents, spreadsheets, and presentations, with online tools like Google Docs.

- 1 Connect your phone to a TV or computer with an optional dock.
- 2 Choose **webtop**.

When you're done using the webtop application, just disconnect your phone from the cable or dock.

CONTROL THE WEBTOP APPLICATION

If you connect your phone to a TV or computer with an optional **HD Multimedia Dock**, you can connect your HDMI display, plus your USB keyboard and mouse. An optional **Lapdock** includes a full display, keyboard, and touchpad.



To navigate the webtop application display:

- In the **Phone** window, you can open your phone apps.
- At the bottom of the screen, you'll see **App Shortcuts**.

You can open multiple Firefox browsers 🌐.

- In the top right of the screen, you'll see icons for status and ⚙️ **Settings**.

For help in the webtop application, open ⚙️ **Settings** > **Help** in the top right of the screen.

DIGITAL LIVING

connect and enjoy

Note: Copyright—do you have the right? Always follow the rules. See “Content Copyright” in your legal and safety information.

SHARE, COPY, & PLAY MEDIA

Share your photos, videos, and songs with friends and family easily.

Find it:  >  **DLNA**

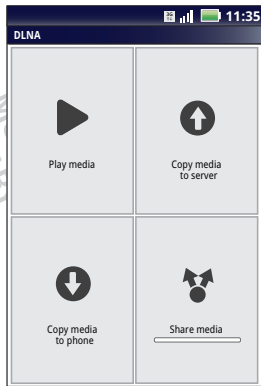

Note: Connect to a Wi-Fi network or use your own Wi-Fi hotspot (see “**WI-FI**” on page 43). You’ll need to allow access to other devices to download media from your phone and to share your files. If you want to access media files on other devices, they must allow access.



- **Play media**—Select media for playback on another device in a Wi-Fi network.
- **Copy media to server**—Sync the media files on your phone with other devices.
- **Copy media to phone**—Copy a picture from one phone to another.
- **Share media**—Allow other devices to access media files on your phone. Without downloading any media from your phone, other people can view your pictures or videos, or play your songs, on their own devices.

HD VIEWING

You can create your own HD videos (see “**HD VIDEOS**” on page 25) to view on your wide screen HDTV or monitor.

- 1 Adjust the viewable area on the HDMI screen by touching  >  **Settings** > **HDMI**.
- 2 Connect an HDMI cable (sold separately) from the HDMI port on your phone (see “**YOUR PHONE**” on page 2) to an HDMI port on the TV monitor.

MIRROR MODE

Connect your phone to your TV, monitor, or projector so you can view and interact with your phone on the big screen. Show off your photos, videos, and downloaded movies. Enjoy the big screen for gaming, movies, the web, and more. Just attach an HDMI cable (sold separately) to your phone and plug it into your big screen.

Note: You cannot play DRM-protected files in mirror mode.

BLUETOOTH™ WIRELESS



lose the wires

QUICK START: BLUETOOTH WIRELESS

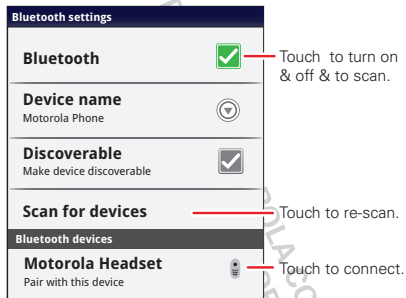
Find it:  >  **Settings** > **Wireless & networks** > **Bluetooth settings**



TURN BLUETOOTH POWER ON OR OFF

Find it:  >  **Settings** > **Wireless & networks** > **Bluetooth**

Note: To extend battery life, turn Bluetooth power off when not in use.

Tip: Turn off Bluetooth power to extend battery life or stop connections. To add a quick switch, touch and hold a blank spot on your home screen, then touch **Motorola Widgets** > **Bluetooth Toggle**.





CONNECT NEW DEVICES

Note: This feature requires an optional accessory. To connect with a new device, you need to pair with it. You only need to do this once for each device—to connect again, just turn on the device.

- 1 Make sure the device you are pairing with is in discoverable mode.

Note: Refer to the guide that came with the device for details.

- 2 Touch  >  **Settings** > **Wireless & networks** > **Bluetooth settings**.
- 3 Touch **Bluetooth** to turn on and scan. If Bluetooth power is already on, touch **Scan for devices**.
- 4 Touch a device to connect.
- 5 If necessary, touch **OK**, or enter the device passkey (like **0000**) to connect to the device. When the device is connected, the Bluetooth indicator  appears in the status bar.

Note: Using a mobile device or accessory while driving may cause distraction and may be illegal. Always obey the laws and drive safely.

RECONNECT DEVICES

To automatically reconnect your phone with a paired device, simply turn on the device.

To manually reconnect your phone with a paired device, touch the device name in the **Bluetooth devices** list.



CHANGE DEVICE NAME

Touch  >  **Settings** > **Wireless & networks** > **Bluetooth settings** > **Device name**. Enter a name and touch **OK**.

WI-FI

home, office, or hotspot

QUICK START: WI-FI

Find it:  >  **Settings** > **Wireless & networks**
> **Wi-Fi settings**

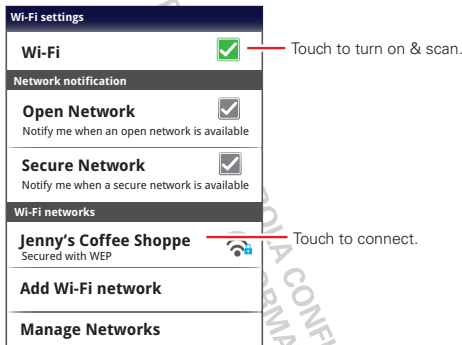

TURN WI-FI ON OR OFF

Find it:  >  **Settings** > **Wireless & networks**
> **Wi-Fi**





Note: To extend battery life, turn off Wi-Fi power when not in use.

Turn off Wi-Fi power to extend battery life or stop connections. Turn it off and on to search for networks. To add a quick switch, touch and hold a blank spot on your home screen, then touch **Motorola Widgets** > **WiFi Toggle**.



WI-FI SEARCH & CONNECT

To find networks in your range:

- 1 Touch  >  **Settings** > **Wireless & networks**
> **Wi-Fi settings**.
- 2 Touch **Wi-Fi** to turn on and scan. If Wi-Fi is already on, touch Menu  > **Scan**. Your phone lists the networks it finds within range.
Tip: To see your phone's MAC address or other Wi-Fi details, touch Menu  > **Advanced**.
- 3 Touch a network to connect.
- 4 If necessary, enter **Network SSID**, **Security**, and **Wireless password**, and touch **Connect**. When your

phone is connected to the network, the wireless indicator  appears in the status bar.

Tip: When you are in range and Wi-Fi is on, you will automatically reconnect to available networks you've connected to before.

WI-FI HOTSPOT

Note: You need to subscribe to Wi-Fi hotspot service to use this feature. Contact your service provider.

You can set up your phone as a Wi-Fi hotspot to provide portable, convenient internet access to other Wi-Fi enabled devices.

ACTIVATE HOTSPOT

Find it:  >  **Mobile Hotspot** > **Mobile Hotspot**

When your Wi-Fi hotspot is active, other Wi-Fi enabled devices can connect by entering your hotspot's **SSID**, selecting a **Security** type, and entering the correct **Wireless password**,

SETUP

Note: Risks can be associated with connecting to the public internet. It is highly recommended that you take steps to protect your computer from unauthorized access. To add encryption to your Wi-Fi hotspot:

Find it:  >  **Mobile Hotspot** > **Configure Mobile Hotspot**

Touch a setting to modify it:

- **Network SSID**—Enter a unique name for your hotspot and touch **Next**.
- **Security**—Select the type of security you want, and touch **Save**: **WEP**, **WPA**, or **WPA2**. Enter a unique password. Other users can access your Wi-Fi hotspot only if they enter the correct password.

Note: **WEP** is the weakest option because it is highly vulnerable to hacking. **WPA2** is recommended by IEEE.

- **Broadcast Channel**—Select a channel that minimizes potential interference. You may need to try different channels after your hotspot is active for a time.

Touch **Save** when the settings are complete.

MEMORY CARD & FILE MANAGEMENT

copy photos, music, and more

MEMORY CARD

Note: Your music, photos, and other files are automatically stored on your phone's internal memory. You can purchase a memory card separately.

DELETE OR SHARE FILES ON YOUR PHONE

Find it:  >  **Files** > **Internal phone storage** or **SD card**

Touch a file or folder to open, then touch and hold a file to **Delete** or **Share**.

REMOVE OR FORMAT YOUR MEMORY CARD

Note: Do not remove your memory card while your phone is using it or writing files on it.

Before you remove or format your memory card you need to unmount it. Touch  >  **Settings** > **SD card & storage** > **Unmount SD card**.

To format your memory card, touch **Format SD card**.

Warning: All data on your memory card will be deleted.

VIEW & TRANSFER FILES

You can use Motorola Phone Portal to connect your phone and computer with a cable or a Wi-Fi network.

When you connect your phone or type the Phone Portal URL into your computer's browser, you'll see the Phone Portal home screen.

Open your recent activity (**Home**), **Contacts**, **Photos**, **Settings**, **File Manager**, or **Support**.

Open details about your phone's network signal, battery, or memory.

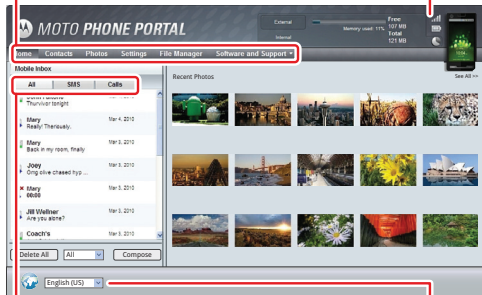

Show **All** recent activity, or only your **SMS** (text messages) or **Calls**.

Choose your language.

Note: Phone Portal works best with Internet Explorer 7 or newer, with Java script and cookies enabled.

CONNECT THROUGH A WI-FI NETWORK

Note: Most public Wi-Fi networks (like the ones at coffee shops) don't let devices connect to each other. In that case, you need a USB cable connection.

1 Touch  >  **Phone Portal**

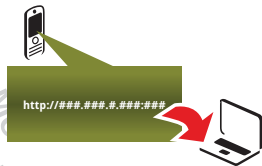

2 If your phone is connected to a Wi-Fi network, it shows a URL. Use a computer on the network to enter the URL in a browser. It opens the Phone Portal home screen.



Tip: When your phone's Wi-Fi is on, it automatically reconnects to nearby networks it has used. To turn Wi-Fi on or off, touch  >  **Settings > Wireless & networks > Wi-Fi.**

If your phone is not connected to a Wi-Fi network, it asks you to connect. Touch **OK** to open the Wi-Fi settings screen, then turn on **Wi-Fi** and touch a network to connect.

For network passwords, ask other network users or administrators. For your phone's MAC address and Wi-Fi details, touch Menu  > **Advanced.**

When your phone is connected ( appears in the status bar), touch Back  to close the settings. Soon, Phone Portal shows a URL at the bottom of your screen. Using a computer on the same Wi-Fi network, just type the URL into the browser to open the Phone Portal home screen.

CONNECT THROUGH A USB CABLE

1 Turn on your phone and computer, and connect them with a USB-to-micro USB cable.

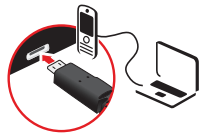

If your computer needs to download drivers for your phone, visit www.motorola.com/support. If a camera connection window opens, just close it.

2 Once your computer has the correct Motorola drivers, it opens the Phone Portal home page in your browser. A Motorola icon  appears in your task bar, in the lower right of your computer screen.

If you have Motorola Media Link, it will launch instead of Phone Portal. To use Phone Portal, right-click  in your task bar, select "when the phone connects, launch," and choose MPP.