

8. Melon (cont'd)

With the wired/wireless integrated service provided by Melon, you can search content, streams or downloads MP3 music content.

Melon (Cont'd)

2 Buttons while playing music content



Searching music



1 Searching Melon mobile

- You can search content with a keyword, view information on the content, and download and play the content.

2 Searching Melon box

- You can search content in the phone with a keyword by genre.

Melon



Menu description

Melon home : You can search content in Melon, and stream or download MP3 content.

Cart : You can pay for the selected content at a time. You can download or stream the selected content.

My page : You can check the user data in relation with Melon, including cash payment and history.

Gift box : You can view and download the list of content you have received or sent.

Download history : You can check the list of the downloaded content.

Melon free zone : You can download hot music videos, music dramas, and hot content free of charge.

Preference



Menu description

Play Setting : You can set various types of environment for content play.

Screen : You can select the skin and lyrics and lyrics image.

Memory : You can check the total space, used space, and free space of internal/external memory.

Genre icon help : You can check the icon names by genre.

8. Melon (cont'd)

With the wired/wireless integrated service provided by Melon, you can search content, streams or downloads MP3 music content.

Melon MP3

You can download 'Melon Player' program from SKT, save, play, send and manage MP3 files. Contact the service provider or visit Melon homepage (www.melon.com) for further information of 'Melon Player'.

About SKT Melon Player?

Melon player is the free exclusive PC software operating in PC. You can download, save, play, send or manage MP4 files (DCF files).

1 Downloading Melon Player

- 1) Access Motorola (<http://www.mymotorola.co.kr>), subscribe, and log in.
- 2) Select the Download Center in 'MOTOPRODUCT Product Information', and click Melon MP3 Player.
- 3) If there is no USB driver program installed in the PC, click 'USB Driver Download' on the MP3 Player installation Guide. (Make sure to connect the phone with PC before installing the USB driver.)

Click **DOWNLOAD** of the model ▶ Click **Save** on the file downloading message box ▶ Select a folder and click **Save** ▶ Execute the file in the folder and click install ▶ Click OK on the installation complete window

※ An error may occur when installing a USB driver depending on the environment of PC. Click **Error in Driver Installation** on the installation guide window and check the description.

- 4) Connect the phone with PC with the 5PIN USB data cable.

※ The PC will automatically recognize the phone and install the program. If an error occurs in recognizing the phone, click **Error in Driver Installation** on the installation guide window and check the description.

- 5) Contact the Melon homepage (<http://www.melon.com>), download a Melon player program, and install it on PC.

※ Click 'DOWNLOAD start' in Melon MP3 Player on the Motorola homepage.

Click **DOWNLOAD Start** ▶ Click **Save** on the file downloading message box ▶ Select a folder and click **Save** ▶ Click the file in the saved folder ▶ Click **Execute** on the file open window ▶ Install Melon Player ▶ Finish installation

2 Downloading MP3 files

- 1) Access the Melon homepage (www.melon.com) and subscribe to it as a member.
 - 2) In case of saving an MP3 file in the mobile phone, make sure to turn on the mobile phone, and connect it to PC via a 5PIN USB data cable before executing the Melon Player.
 - 3) After executing the Melon Player, try log-in.
 - 4) After selecting a desired song, you can enjoy music with an MP3 player or send this MP3 file to the mobile phone.
- ※ To send file to the phone, SKT integrated USB driver is required. (See Melon homepage Customer Center for further information.)
- ※ When sending an MP3 file to the phone via PC, do not remove the 5PIN USB data cable by force. Such act may cause malfunction of the phone.
- ※ Service fee is charged for downloading MP3 files to PC or saving MP3 files to the phone. The fee will be charged based on SKT's Melon.

3 Playing MP3 files

- You can check the MP3 file downloaded to the phone via 'Melon box'. (Melon Contents, see p70)
- Only MP3 files with extension 'DOF' can be played in the phone.
- ※ This service is available for the customers who have an integrated ID issued from SKT membership site T-World (<http://www.tworld.co.kr>)
- ※ In case of downloading or listening MP3 files on PC, it is not necessary to connect the phone.
- ※ It is possible to send PC-downloaded MP3 files to the phone again. However, it is impossible to send files from the phone to PC again.
- ※ To send MP3 files to the phone, make sure that you have an MP3-only phone and have the mobile phone authorized. (Contact the service provider or see Melon homepage Customer Center for further information.)

9. T MAP

With the satellite-based GPS function, you can use various navigations services including traffic information, location and route guide, and other driver convenience services.

Before Using T MAP

Press ► Select T MAP

- You can move to T MAP by pressing and holding  button on standby screen.
- You can use the T MAP service on the electronic map.
- The phone may fail to detect the accurate location in the underground or thnel where GPS signal is blocked.
- If the vehicle vibrates severely, there can be a vibration on the screen.







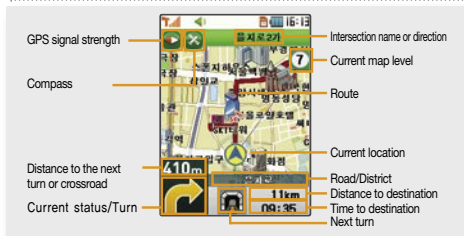

Note

- It is dangerous to use the phone while driving a car. Make sure to check the navigation information before driving a car.
- If the information from T MAP service is different from that on the road, make sure to follow the traffic regulations and actual road situation.
- A service fee is charged when you use the T MAP service. Contact the service provider or visit T MAP homepage (<http://tmap.tworld.co.kr>) for service and other further information.

T MAP navigation screen



T MAP buttons

-  (Left) [Menu] : Select
-  : Select/Reselect
-  : Fix map (original position)
-  : Zoom in map
-  : T MAP (Press - T MAP menu, Press & Hold - Start navigation)
-  (Right) : Previous menu
-  : Turn map (counterclockwise)
-  : Turn map (clockwise)
-  : Zoom out map

T MAP menu description



Find route	The phone searches the routes to the destination.
Recent route	The phone shows the recently used routes.
Safe driving	The phone provides supplementary information for safe driving.
Find friend	The phone shows the current location of a friend or family member.
T MAP life	The phone provides real time traffic information on highway/national road/metropolitan area
Traffic information	You can receive real time information on the traffic status of expressways/national roads/metropolitan area.
Safety	The phone provides the location of users for safety.
Travel & Location WAP	The phone provides variety of information on travel and navigation service. You can receive information from the navigation service internet sites.

Note

- The map data takes approx. 63MB of memory, and is subject to change according to upgrade.
- If you delete the map data, you can use as much as memory space. You can enter in the password and delete the map data by pressing  (Left)[Menu] ►  (Preference) ►  (Reset) ►  (T MAP reset). (Reset, see p.183)
- Navigation program can be deleted in @Playon. You can re-download the map by pressing  on the standby screen. A data service fee is charged for downloading the map.

9. T MAP (Cont'd)

With the satellite-based GPS function, you can use various navigations services including traffic information, location and route guide, and other driver convenience services.

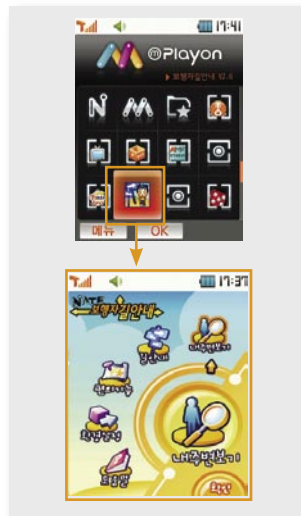

NATE Pedestrian Navigation

Press **More** on the standby screen ► **Playon** ► Select navigation for pedestrian

- The service provides the route to the destination on the map in the phone.
 - The service is not available if you are in the building or underground.
- ※ See HELP for a service fee and further information.

Menu description

My location : Your current location is displayed on the electronic map.
Navigation : You can use various search menu to find the route to the destination.
Convenience : You can use building information, marathon assistance, biorhythm, calorie calculator, daily exercise log, and other convenience functions.
Preference : You may change various settings of the navigation service.
Help : You can use variety of information on pedestrian navigation service.



Emergency Call

If an emergency occurs, a notice is sent to the designated number.

Press and hold **More** on the standby screen ► The mobile security screen is displayed after a vibration ► Connect to the designated number

- To cancel the call, press **More**. Try again if a failure message is displayed.
 - You cannot delete the default mobile security number.
- ※ See Help for more informations and service rate fee.

How to subscribe for mobile security

Register Mobile Security

Press **More** ► Press T MAP ► Press Safety ► Select GPS



Note
• A data call rate is charged for accessing GPS exclusive menu. See the rate system service guide or visit GPS emergency call service homepage (<http://soscall.nate.com>).

10. WINC(Mobile address)

You can easily access a wireless internet site by entering numbers instead of a complex domain address.



Press **More on** on the standby screen ▶ **Playon** ▶ Select WINC

- You can access the wireless internet site by pressing **More on** on standby screen.
- List of recommended phone pages may vary depending on the circumstances of the service provider.

※ Contact the service provider or visit WINC homepage (<http://www.winc.or.kr>) for further information.

Recommended phone page

Site	Mobile address	Site	Mobile address
SKTelecom	11	Lotte M Mall	452
Daum	3355	Seoul Metropolitan Government	702
Naver	369	Korea Tourist Organization	1330
Yahoo Korea	9090	Seoul Bus Information	287
SBS M	727	National Internet Development Korea	6432
GS eshop	4747	Korea E-government	6468
CJ Mall	2525	Incheon International Airport	247

11. NATE Phone P

You can use Mobile Cyworld on your phone.

Enter the phone number on the standby screen ▶ Press **More on**



→ Select a mobile number in the phonebook, press **(Left)[Menu]**, and select 'Cyworld'.

※ Contact the service provider or visit Cyworld Mobile homepage (<http://cmobile.cyworld.com>) for a service fee and further information.

12. T Interactive

You can use the frequently used phone functions/ contact information and mobile internet services from the standby screen.

On the standby screen, press **←/i**

- On the T Interactive service screen, press **More on** to move to the service you want.
- If you install the T interactive service, the service initial screen is activated automatically on the standby screen. If you don't want the service to be automatically started, press **(Left)[Menu]**, and release the setting in preferences.
- ※ A service fee is charged when you use the service. Contact the service provider or visit T-interactive homepage (www.tinteractive.co.kr) for application for the service and further information.

MEMO

A large, light green rounded rectangular area with ten horizontal dotted lines for writing.



05 Sounds

01 Ringtone Style	84
02 Download Ringtone	84
03 Vibrate Style	85
04 Call Alert Style	85
05 Volume	86
06 Operation Effects	87
07 Reminder Alerts	87
08 System Alerts	88
09 Time Alerts	88
10 My Etiquette	89

1. Ringtone Style

You can set a ringtone for incoming calls.

Press (Left) ▶ Press ▶ Press



- You can connect to NATE and download a ringtone.
- If you press , the ringtone types are displayed.
- If you press (Right)[Connect] in 'Live ringtone' or 'My ringtone', you can download ringtones from NATE.
- When the etiquette mode is released, you can use (Volume key) to adjust the volume.
- You can manage live ringtones in 'Live Box' menu of 'Contents'. (Live Box, see p.108)



Note

- In addition to the default ringtones stored in your phone, you can download various ringtones from the melody downloading service of your service provider.

2. Download Ringtone

You can download a ringtone from NATE.

Press (Left) ▶ Press ▶ Press



- Depending on the type of the ringtone downloaded, it saved in 'My ringtone' or 'Live ringtone'
- You can also find the downloaded ringtones in the 'Ringtone Box' menu of 'Contents' (Ringtone Box, see p.100)
- You can release the etiquette mode when pressing and holding in NATE. (except My Etiquette Mode)

1 Downloading ringtones from 700 service

Enter 700 service number ▶ Press

- Select a ringtone according to the voice service. Open the message received from 700 service, and press to downloaded the ringtone.

3. Vibrate Style

You can set various vibrate style.

Press (Left) ▶ Press ▶ Press



- You can select different types of rhythm and vibration interval.

4. Call Alert Style

You can set the ring/vibrate for incoming calls, alarms or alerts.

Press (Left) ▶ Press ▶ Press



- If the Etiquette mode is on, the phone vibrates for receiving calls even if you change the setting in 'Call Alert Style'. When the Etiquette mode is released, the phone returns to the latest setting.
- The message alert tone is depending on the message alert setting.

Menu description

	Ring		Vibrate		Ring & Vibrate
	Vibrate then Ring		Ring Louder		Silent

4. Call Alert Style (Cont'd)

You can set the ring/vibrate for incoming calls, alarms or alerts.

1 Setting Etiquette mode

Press and hold on the standby screen (Press and hold again to release the mode)

- is displayed on the standby screen.
- You can use the Etiquette mode in a public place. You can still hear ring through the stereo earset if it is connected to the phone.
- The etiquette mode is maintained when you switch off/on the phone as the etiquette mode is on.

Menu description

Vibration : Power on, ring, alarm (except morning call), message alert (except when 'Message alert' is off)

Mute : Call connect tone, power off, dialog box tone, out of SVC coverage alert (out of phone service area), menu tone, key tone, low battery alert, shuttle tone, 1 min time alert tone

Emergency alarm : Emergency message alert
-Emergency message is transmitted when there's emergency situation in a specific area so that the users can take the appropriate action

Sound : Photo/Video tone, morning call

5. Volume

You can control volume for each function.

Press (Left) ▶ Press ▶ Press

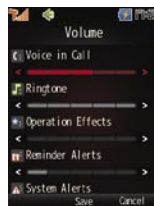

→ Adjust the volume with , and press to save the setting.

Note

- If the live screen is selected, the effect tone is depending on june preference (Live screen sound, see p.178).
 - If the live screen tone is off, no sound is heard.

Menu description

Voice in Call : Control the earpiece volume

Ringtone : Control incoming call volume

Operation Effects : Control phone operating effect tone

Reminder Alerts : Control volumes of various information alerts

System Alerts : Control volumes of various alert tones

Alarms : Control volumes for alarm

Wallpaper : Control volumes of movie and downloaded contents

Playon : Control volume for Playon menu

6. Operation Effects

You can select the effect tones for operation of the phone.

Press (Left) ▶ Press ▶ Press



Note

- You can set the effect tone with (Volume key) on the standby screen. If the volume is not higher than step 1 or if the Etiquette mode or My Etiquette mode is on no effect tone is heard.

Menu description

Operation Effects : You can select a theme package or custom theme.

Power On/Off : Effect tone for power on/off

Key Tone : Effect tone for key action

Folder Sound : Effect tone for folder opening/closing

Confirm Box : Effect tone for pop-up window

Main Menu : Effect tone for menu selection

7. Reminder Alerts

You can set alert tones for various information of the phone.

Press (Left) ▶ Press ▶ Press



Menu description

Reminder Alerts : Select the theme package or custom theme

Missed Call : Set the missed call alert tone

Repeat : Set the repeat count of the missed call alert tone

Schedule : Select the schedule alarm tone

Anniversary : Select the anniversary alarm tone

D-day : Select the D-day alert tone

Meeting Planner : Select the meeting planner alarm tone

8. System Alerts

The phone notifies you of any error on the system or any incident set by the user.

Press **[Left]** ▶ Press **[Z]** ▶ Press **[8]**



Menu description

- Connect tone :** When the call is connected
- Disconnect tone :** When the call is disconnected
- 1min timer :** At every minute since the call is connected
- Out of SVC alert :** When the phone is out of the service coverage
- Low battery alert :** When the battery is low

9. Time Alert

The phone alarms when you press the volume key, open the folder or at every hour.

Press **[Left]** ▶ Press **[Z]** ▶ Press **[9]**



- You cannot set time alert when the start time is the same with the end time.
- If you have set the alert option as volume key, you can press and hold **[Volume Key]** (Volume key) to check the time even the folder is closed.

10. My Etiquette

Regardless of ring setting in the phone, the ring switches into the Etiquette mode (depending on cycle and ring/vibrate setting) at the designated time. (The Etiquette mode has the priority over the My Etiquette mode)

Press **[Left]** ▶ Press **[Z]** ▶ Press **[0]**



- **[0]** is displayed on the standby screen during the selected time for My Etiquette mode.
- If the stereo earset is connected, you can hear the ring through the earset.
- You cannot set My Etiquette mode if the start time is the same with content.
- My Etiquette mode may not be applied to some of the supplementary content.
- My Etiquette mode is not applied to morning call emergency message alert and photo/video shutter tone.

Ring/Vibrate Setting

- All vibrate :** Same as the Etiquette mode (Setting Etiquette mode, see p.86)
- Alarm & Alert only :** The ring/vibrate setting is applied to alarm bell, anniversary, D-day, Meeting Planner alarm only. (Call Alert Style, see p.85)
- All ring/vibrate off :** Silent Mode (no ring & no vibrate)

MEMO

A large, light green rounded rectangular area with horizontal dashed lines for writing.



06 Display

01 Main Display	92
02 External Display	93
03 Download wallpaper	94
04 Download Font Mate	94
05 Menu Type	95
06 Screen Design	95
07 Dialing Font	96
08 Backlight Control	97
09 Visual Expression	97

1. Main Display

You can change and set the graphics on standby screen.

Press (Left) ▶ Press ▶ Press

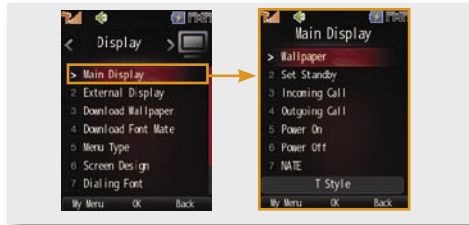

- Scroll up/down and set the main display by pressing .
- Move left/right and select the wallpaper by pressing .
- You can select from default screen, flash screen, color, my gallery, photo, video, live screen.
- You can check various graphics by pressing .
- You can manage the live screen with 'Live Box' menu in 'Contents'.
(Live Box, see p.108)

Standby screen

Press (Left) ▶ Press ▶ Press ▶ Press

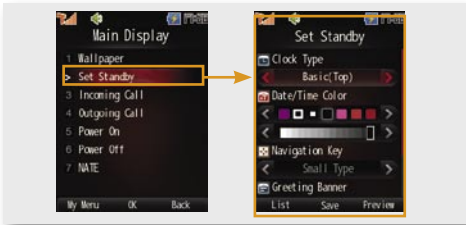

- You can preview the screen by pressing .
- You can set 'Clock Type', 'Date/Time Color', 'Navigation Key', 'Greeting Banner' and 'Banner Position' be displayed on the standby screen.
- If you select a flash (flash clock 1~7) for the standby screen in the standby screen setting menu, the clock type is automatically set to the flash clock.
- You cannot use this function if a phone theme is selected.

2. External Display

You can change and set the graphics on external screen.

Press (Left) ▶ Press ▶ Press

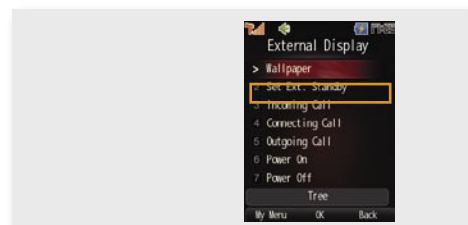

- Scroll up/down and set the main display by pressing .
- Move left/right and select the wallpaper by pressing .
- You can select from default screen, flash screen, color, and my gallery.
- You can check various graphics by pressing .
- You can manage the live screen with 'Live Box' menu in 'Contents'.
(Live Box, see p.108)

Menu description

Clock Type : You can set the type of date, clock, and calendar to be displayed on the standby screen.

Date/Time Color : You can select the color for the date and time to be displayed on the standby screen.

Navigation Key : You can set the display of the hot connect keys to be displayed on the standby screen.

Greeting Banner : You can write a banner to be displayed on the standby screen
– D-day/Network signal(SK Telecom) setting

Banner Position : You can select the position of the banner or D-day on the standby screen.

3. Download Wallpaper

You can download various graphics from NATE.

Press **Left** ▶ Press **3** ▶ Press **3**



- You can download graphics from NATE.
- You can find the downloaded graphics in 'Wallpaper Box' of 'Contents' or in 'Phone Theme' of '@Playon'.



Note

- After connecting to NATE, you can download until the memory gets full. (NATE, see p.63)
- It may take some time to load up the graphic depending on the size of the downloaded graphics.

4. Download Font Mate

You can connect to NATE and download all types of font (size and font type) and display on the screen.

Press **Left** ▶ Press **3** ▶ Press **4**

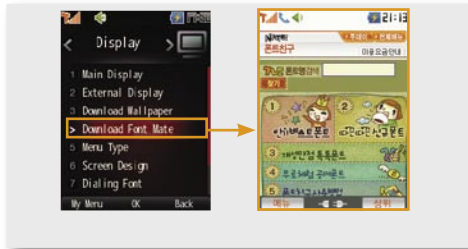

- Downloaded font is saved in 'Font Box' of 'Contents'. (Font Box, see p.101)
- Font type applies as soon as you download the font and you can use it until the expire date (extension is possible).

5. Menu Type

You can set the style of menu displayed on the screen.

Press **Left** ▶ Press **3** ▶ Press **4**

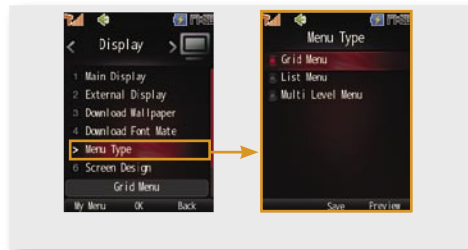

- You can preview the menu type by pressing **Right**.
- You can change the menu type by pressing **Left** and then **Left** on the standby screen.

6. Screen Design

You can set 'Style', 'Font Type', 'Font Size', 'Font Color', 'Screen Background', 'BG Transparency', and 'Ctrl Transparency' of the phone screen.

Press **Left** ▶ Press **3** ▶ Press **4**

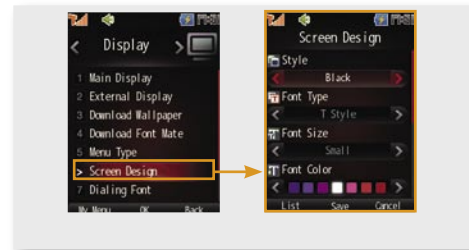

- When setting the style, press **Left** to check the list of the sub menu.
- In the sub menu, press **Right** to move left/right and select the font you want.

Font Type

- Base Font** : Font stored in the phone.
- Font Mate** : Font downloaded from NATE.
- Download Font** : Font downloaded from Motorola's homepage

6. Screen Design (Cont'd)

You can set 'Style', 'Font Type', 'Font Size', 'Font Color', 'Screen Background', 'BG Transparency', and 'Ctrl Transparency' of the phone screen.

How to download Menu Type(Flash Menu) or My Moto Font(Vector Font).

- 1) Download the PC sync program from Motorola home (www.mymotorola.co.kr), and install the program in the PC.
- 2) Run the PC sync program, select Personalize, and click Flash Menu or Vector Font.
- 3) Select a Flash Menu or Vector Font and click [Send To Phone]. The selected data is stored in the phone.



Note

- When setting up the font size, it applies to start-up screen. Even if you set up the font size big, its maximum font size is normal.
- Visit Motorola's homepage (www.mymotorola.co.kr) and you can download various Flash Menu and Vector Font.

7. Dialing Font

When you enter numbers on the standby screen, you can set their style on the screen.

Press (Left) ▶ Press (Left) ▶ Press (Left)

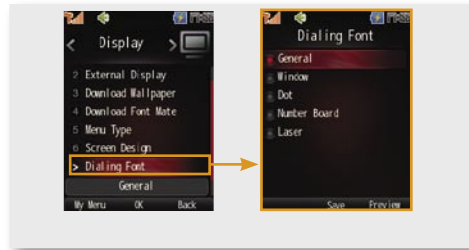

- ➔ If you press (Right) during setting, you can check number styles to set in advance.
- ➔ You can change numeric styles by pressing (Camera button), when you enter a number on the standby screen.

8. Backlight Control

You can set the lighting for the main display, backlight in call, main LCD brightness, sub LCD brightness, keypad, and keypad brightness.

Press (Left) ▶ Press (Left) ▶ Press (Left)

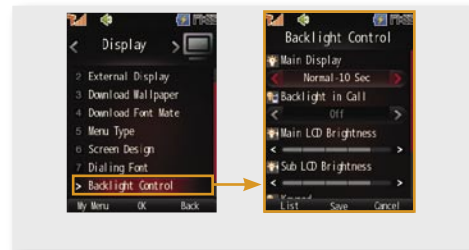

- ➔ If you do not use the phone within the configured lighting time after opening folder, the screen goes to the screen saver mode and the light turns off. (Powersave, see p.179)
- ➔ If the backlight in call is set to 'general', the screen dims during the call. If you set it 'off', the backlight turns off in 10seconds after the call is connected.

9. Visual Expression

When you place a video call, you can use and select from various options.

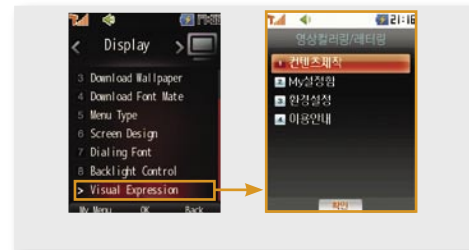

- ➔ When you place a video call, you can display the predefined image or characters and emoticon on the receiver's phone.
- ➔ When you place a call, you can display the predefined name or nickname on the receiver's phone.

9. Visual Expression (Cont'd)

When you place a video call, you can use and select from various options.

1 Contents

You can edit contents such as photo and video.

Press  (Left) ▶ Press  ▶ Press  ▶ Press 

2 My Setting

You can custom setting the image call or lettering plus.

Press  (Left) ▶ Press  ▶ Press  ▶ Press 

3 Preferences

You can change the preferences of the image call or lettering plus.

Press  (Left) ▶ Press  ▶ Press  ▶ Press 

4 Information

You can check the information of the image call or lettering plus.

Press  (Left) ▶ Press  ▶ Press  ▶ Press 



07 Contents

01	Ringtone Box	100
02	Wallpaper Box	100
03	Font Box	101
04	Photo/Movie Album	101
05	MMS Contents Box	102
06	@Playon	103
07	june Contents Box	105
08	Live Box	108
09	VTC Contents Box	108
10	Flashcon Contents Box	109
11	Memory Manager	109

1. Ringtone Box

You can save the ringtones downloaded from NATE and check the default ringtone settings.

Press **←** (Left) ▶ Press **4** **☰** ▶ Press **1** **☰**

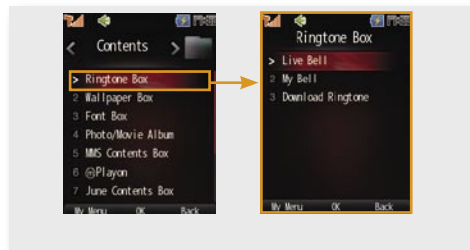

- If you press **←** in Live Bell or My Bell, you can download ringtones from NATE.
- You can set and view the information of the ringtones by pressing **←**.
- You can manage live ringtones in the 'Live Box' menu of 'Contents'. (Live Box, see p.108)

2. Wallpaper Box

You can check the downloaded Wallpaper from NATE.

Press **←** (Left) ▶ Press **4** **☰** ▶ Press **2** **☰**

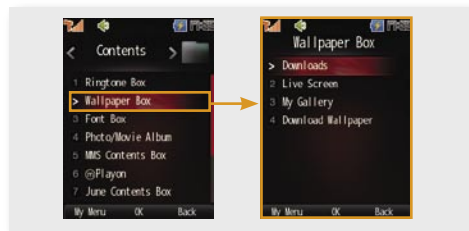

- If you press **←** (Right) in Downloads or Live Screen, you can download wallpaper from NATE.
- You can set a wallpaper, view pictures and delete a picture, by pressing **←**.
- If you select My Gallery, you can edit the saved pictures into the folder and set as wallpaper.
- The flash pictures downloaded from Nate can be checked in the Theme folder of @Playon menu.
- You can manage Live Screen in the 'Live Box' menu of 'Contents'. (Live Box, see p.108)

3. Font Box

You can save the fonts downloaded from NATE or Motorola homepage.

Press **←** (Left) ▶ Press **4** **☰** ▶ Press **3** **☰**

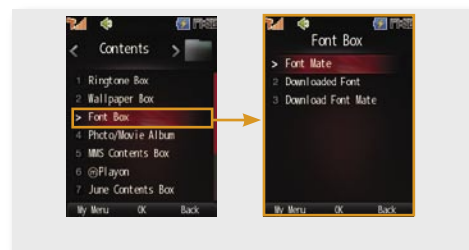

- **Font Mate** : You can manage downloaded font (font type and size) from NATE. (Download Font Mate, see p.94)
- You can connect to NATE and download the font by pressing **←** (Right).
- **Downloaded Font**: You can manage the fonts downloaded from Motorola homepage.[Menu Type (Flash Menu) or My Moto Font (Vector Font) Download Font, see p.44]

4. Photo/Movie Album

You can view the photos/movies taken with the phone or attached to the MMS message.

1 Photo Album

Press **←** (Left) ▶ Press **4** **☰** ▶ Press **4** **☰** ▶ Press **1** **☰**

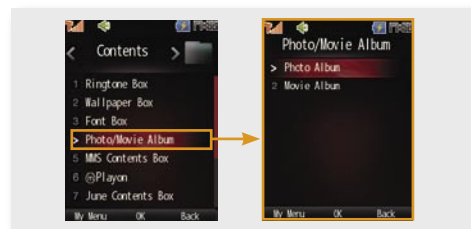

- You can view the photos/videos downloaded through PC Sync program. (Photo Album, see p.116, Movie Album, see p.122)
- Select Photo box 1~2 or External memory photo folder, and press **←** (Left). You can select/delete all, manage the folder, and view/sort the file.
- Select the photo and press **←** (Left) to use various menu such as Send message, it's box, Visual Expression, Create Slide, Move/Copy, Protect/Lock, Unselect All, Delete, and Send via Bluetooth.

4. Photo/Movie Album (Cont'd)

You can view the photos/movies taken with the phone or attached to the MMS message.

Movie Album

Press **Left** ▶ Press **4** (GH) ▶ Press **4** (GH) ▶ Press **2** (L.O) (ABC)

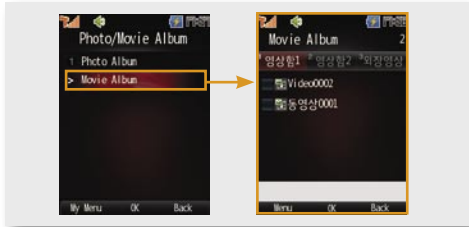

- Select Movie box 1~2 or External memory photo folder, and press **Left**. You can select/delete all, manage the folder, and view/sort the file.
- Select the movie and press **Left** to use various menu such as i's box, Visual Expression, Create Slide, Move/Copy, Protect/Lock, Unselect All, Delete, and Send via Bluetooth.
- If a movie file is lower than 950kbyte or set as movie mail, you can send as a MMS message.
-In this case, data fee is charged.

5. MMS Contents Box

The content available for attachment to messages are stored.

Press **Left** ▶ Press **5** (J.H) ▶ Press **4** (C.B) (GH)

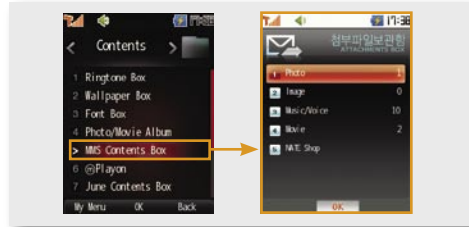

- You can check photos, pictures, music, and video content in the attachment file box, or download new content from NATE content shop. (Contents Box, see p.165)

6. @Playon

You can use the downloaded content without reconnecting NATE.

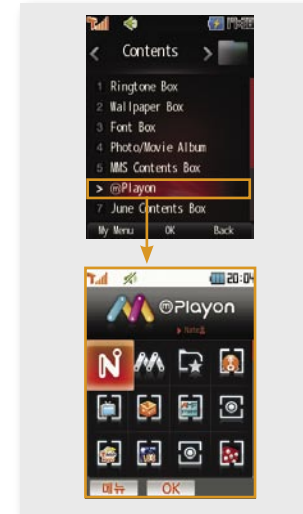

Press **Left** ▶ Press **4** (C.B) (GH) ▶ Press **6** (L.T) (MNO)

- If the phone is set to mute in preferences of @Playon, the phone makes no sound when you move between the @Playon folder menu.
- If you have no sufficient free space in the memory, you can download the content by deleting the content stored in the phone.
- You can answer a call while you use the content, and return to the content after the call.

Menu description

- NATE Home** : Move to NATE menu / **@Playon** : Access the @Playon service
- Phone theme** : Wallpaper content are stored / **Cyworld** : Connect to the mobile Cyworld
- Real-TV** : Watch ground wave and cable real-TV / **i's box** : Make and manage UCC, and upload
- T MAP** : T MAP navigation service / **Visual Expression** : Video coloring/lettering
- Navigation for pedestrian** : Access NATE navigation for pedestrian /
- JukeBox31nl** : Connect to Game service



NOTE

- If you downloaded @Playon content when you have no sufficient free space in the memory, TSM (memory manager) is started. You can download the content by deleting the content stored in the phone (excluding protected jun contents, live bell, and live screen content).
- * TSM (Memory Manager) function that manages the memory and asks you if you wish to delete the existing content.
- If you delete all content from @Playon, the content stored in Game box are also deleted.
- If you download content from @Playon, a call rate and an information service fee are charged.

6. @Playon (Cont'd)

You can use the downloaded content without reconnecting NATE.

Using downloaded content menu



Manage	You can modify (rename) the selected content, move the content, move the folder, and check the information.
Delete	You can delete the selected content.
Add folder	You can create a folder to manage the content.
Delete all	You can delete all the downloaded content. (If you select Delete all, all the content in Game Box content are also deleted.)
Preferences	You can check the memory and set the volume and auto sorting order of the downloaded content.

7. june Contents Box

You can save, manage, and play the music content downloaded or received through internet.

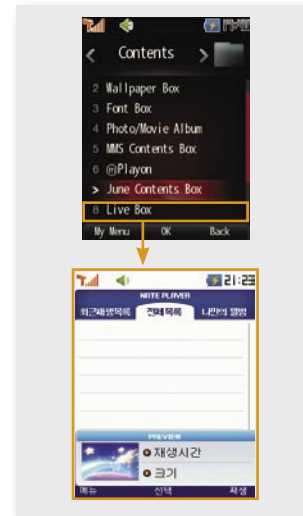

Press **Left** ▶ Press **4** ▶ Press **7**

- You can select the content you want to play by pressing **Nice on**.
- You can download the music content as long as the memory capacity allows.
- You cannot play the content which is not completely downloaded. You can resume downloading by pressing **Right**.
- You can receive a call while playing the music content. The phone returns to the music play mode after the call.
- You can control volume with **Volume key** as the content is being played. The phone continues playing music even if you close the folder.
- You can select a section to be repeated by pressing **Repeat**. If you press **Repeat** again, the selected section is repeated (for vertical play).
- If you press **Left**, you can use the multi-tasking function to change settings, to access wireless internet, or to manage text messages while playing music content.
- You can change the settings for the music content stored in the june contents box with NATE player preferences menu. (june setting, see p.176)



Note

- If you download content from wireless internet (NATE, june, @Playon, Game Box, etc.) when you have no sufficient free space in the memory, the 'lack of memory' message is displayed. You can download the content by executing the memory manager and deleting the content stored in the phone.
- You can listen to music content with bluetooth. See bluetooth and the user manual of the device. (Bluetooth, see p.127)

7. june Contents Box (Cont'd)

You can save, manage, and play the music content downloaded or received through internet.

1 NATE player screen and keys

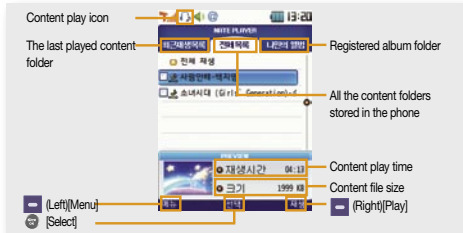

Using menu on the NATE Player window

Delete	You can delete the selected content.
Add to my album	You can save the selected content in My album.
Sort	You can change the order of content to be played.
Manage content/ lyrics	You can rename title, set/release protection, view content information, and update lyrics.
Sort content	You can change the order of content by type or by date.
Wireless Internet	You can download content via june or NATE.
Manage message	You can write a message or manage received/sent messages.
Delete all	You can delete all the content.

Using menu while playing the music content (for vertical play)

Play mode	You can select the play option (Once, random, repeat, repeat random).
Wireless internet	You can download content via june or NATE.
Manage message	You can write a message or manage, receive/sent messages.

2 Keys while playing music content

For vertical play

Select content in NATE Player screen ▶ Press (Right)



For horizontal play

In the vertical view ▶ Press

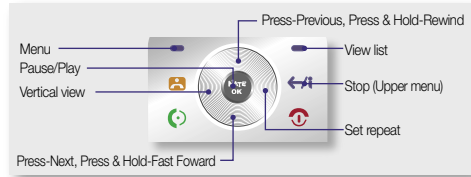
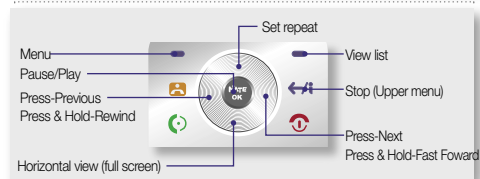
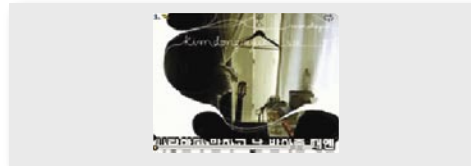

- You can adjust volume during vertical/horizontal play by pressing (Volume key).
- You can release the lock setting by pressing down the lock button.

8. Live Box

You can manage the downloaded live bell or live screen content downloaded from NATE.

Press **Left** ▶ Press **4** (GHI) ▶ Press **B** (TUV)

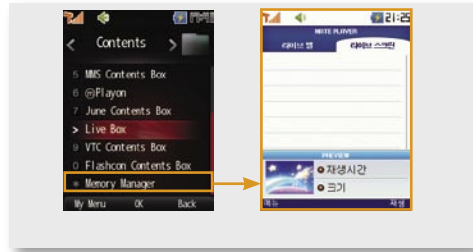

- You can set live bell/screen, delete, manage content and delete all by pressing **Left**.
- You can play the selected content by pressing **Right**.
- You can access wireless internet or manage text message by pressing **Left** while playing content.

9. VTC Contents Box

In Video call, you can use video chatting function and save the real time chatting message.

Press **Left** ▶ Press **4** (GHI) ▶ Press **1** (MNO)

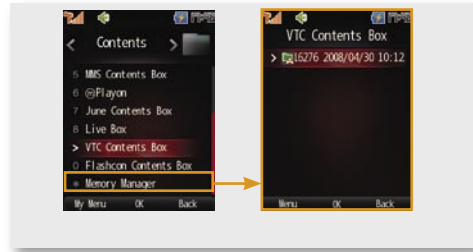

- You can select and press **Move OK** to check the selected file information.
- You can delete or protect/lock the file by pressing **Left**.

10. Flashcon Contents Box

You can use moving emoticon in messenger and video call.

Press **Left** ▶ Press **4** (GHI) ▶ Press **0** (PQRS)



- Move and select the menu with **Move OK**, and press **Move OK** to see the detail.
- You can set image as default or view the file info. by pressing **Left**. (Chg_Img setting, see p.43)
- Press **Right** to connect to NATE and download Flashcon.

11. Memory Manager

You can manage the memory in the phone, external memory, and USIM card.

Press **Left** ▶ Press **4** (GHI) ▶ Press ***** (WXYZ)

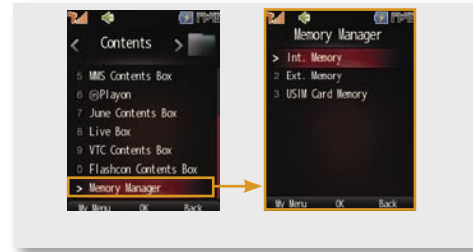

- Select one of the memory information, and press **Move OK** to display the menu for the selected item. (excluding june contents box, map, USIM's phone number/message and others)