

7. World Time

You can check a current time of world main cities (50 countries) and city information, and set various functions.

Press **Left** ▶ Press **MNO 6** ▶ Press **MNO 6**



→ Press **MNO** to display the country, country code, area code, emergency number/information of the selected cities.

Menu description

Summer Time(DST)	You can set summer time periods by cities.
World Clock	<ul style="list-style-type: none">The local time of your area and the selected city are displayed on the standby screen.You can change the clock type on the standby screen, and you can see preview by pressing Right. (However you cannot use this function if a phone theme or flash is selected.)
City Info.	You can check desired city information.

10 Message

01 Message Box	156
02 New Message	160
03 Mobile Messenger	163
04 e-mail	163
05 Report Spam/Service	164
06 Contents Box	165
07 Settings	166

1. Message Box

You can view and manage the received messages.



Press **Left** ▶ Press **7** (PQRS) ▶ Press **1** (123)

- When you receive the message, the icon is displayed on the standby screen.
 - The information on the latest message received is shown at the top.
- When you receive the message with the phone number shown on the screen, press **Call** to make a call to the person who sent the message.
- If you press **Call** when receiving a voice message, you are connected to the voice mailbox, and you can listen to the recorded voice message.
- When checking the message, press **Left** to move to the previous or the next message.
 - When checking the message, press **Right** to move to the other message box.
 - When checking the text message, press **Volume** (Volume key) to zoom in/out the screen.



Note

- If the capacity for received message is exceeded, the oldest message deleted first
- You can check the received message in the standby screen using the Message Alarm and Preview. (Settings, see p.166)

INBOX

Press **Left** ▶ Press **7** (PQRS) ▶ Press **1** (123) ▶ Select INBOX

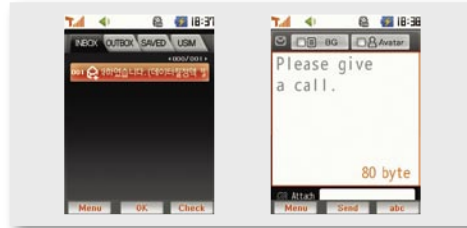

- You can check and manage the received messages. (Including voice messages)
- Select a message and press **View** to read the message.
- The content attached to the multi-mail is automatically played.

Icon description

	unconfirmed SMS Message		confirmed SMS Message
	unconfirmed MMS Message		confirmed MMS Message
	unconfirmed Movie Message		confirmed Movie Message

Menu description

- Reply** : You can reply the message to the sender.
- Delete** : You can delete the selected message.
- Forward** : You can forward the received message to other person.
- Save Number** : You can save the phone number indicated in the message in the phonebook.
- Save Message** : You can save the selected message in SAVED box.
- Save to USIM** : If the selected message is SMS, you can save the message in USIM box.
- Add to Spam List** : Register a selected message as a spam number to block the message.
- Sort Message** : You can sort the message into name/time/size order.
- Message Search** : You can search and find the message by name/number/string.
- Delete All** : You can delete all saved message in the inbox.

1. Message Box (Cont'd)

You can view and manage the received messages.

OUTBOX

Press **Left** ▶ Press **7** (OUT) ▶ Press **1** (OUT) ▶ Select **OUTBOX**



- You can manage sent message, draft message, and failed message.
- Select the message and press **Menu** to check the content of the message.
- While writing the message, press **Left** to save the message.
- You can press **Menu** to continue and rewrite the message.

Icon description

	Temporary saved message
	SMS sent message
	MMS sent message

Menu description

- Delete** : You can delete the selected message.
- Forward** : You can forward the received message to other person.
- Save Number** : You can save the phone number indicated in the message in the phonebook.
- Save Message** : You can save the selected message in SAVED box.
- Delete All** : Delete All : You can delete all saved message in the inbox.

SAVED

Press **Left** ▶ Press **7** (OUT) ▶ Press **1** (OUT) ▶ Select **SAVED**

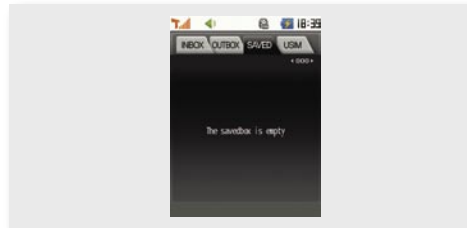

- You can move the selected messages from the inbox or outbox to the saved box.
- For outbox message, press **Left** to delete, forward, save number, save message, and delete all.
- For inbox message, press **Left** to reply, delete, forward, save number, save message, save to USIM, add to spam list, sort message, message search, and delete all.

USIM

Press **Left** ▶ Press **7** (OUT) ▶ Press **1** (OUT) ▶ Select **USIM**

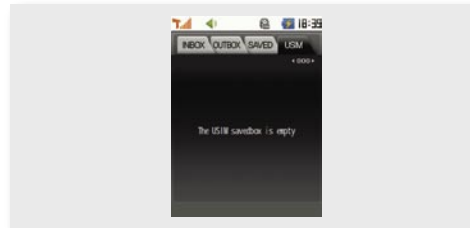

- You can manage and save the message by selecting a message in the inbox, and select the menu 'Save to USIM'.

2. New Message

The integrated MMS function enables you to attach content to the long text message and send to the mobile phone or e-mail address.

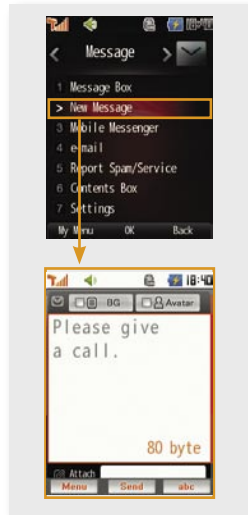

Press **⏪** (Left) ▶ Press **7** ▶ Press **2**

- ➔ A message can be sent to upto 20 people at a time.
- ➔ You can answer a call while you are writing a message, and return to the message screen after the call.
- ➔ You can send 3 image files (photo or picture) and 1 music and movie file.
- ➔ After writing a message, you can preview the message with **⏩** (Right).
- ※ **MMS is an SKT's new multimedia transmission service integrating the text message function and the color mail function.**



Cautions in writing messages

- Messages are sent as SMS in default. However In the following cases, they are changed to MMS and additional data fee is charged: message exceeding 40 Korean letters/80 English letters, font color changed, emoticon added, avatar added, paper set, content attached (photo, movie, background music, etc.).
- If a message is changed to MMS, a message 'Converted to MMS' is displayed on the message window.

MMS fee

- The same information fee is charged for long text message, changed font color, paper set, avatar set, and emoticon added between MMS and SMS.
- Additional service fee is charged. No data call fee is charged for sending and receiving MMS. Visit SKT T-World homepage (<http://www.tworld.co.kr>) or contact SKT Customer Center for further information.

Letter Paper

You can select the various background.

Select **Ⓜ** **Ⓜ** **Ⓜ** ▶ Press **None OK**

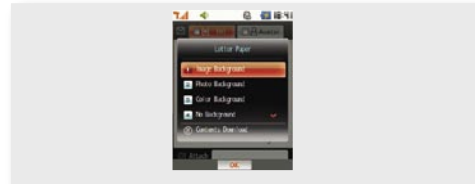

Image Background : You can select a image stored in the phone and set the image as a background.

Photo Background : You can select a photo stored in the photo album and set the photo as a background. (Press **Ⓜ** to select.)

Color Background : You can select the background color of the letter paper. (Note that the content might not be identified if the letters are written on the paper of the same color.)

No Background : You can set the background as a white paper.

Contents Download : You can connect to NATE content shop and download the latest contents.

Avatar

The character or the photo of the sender is displayed on the message receiver's phone.

Select **Avatar** ▶ Press **None OK**



Character Avatar : You can set a character in the photo album as a avatar.

Photo Avatar : You can set the photo in the photo album as a avatar. (Press **Ⓜ** to select.)

No Avatar : No avatar is displayed on the receiver's phone.

An Avatar? : Description on avatar is displayed.

Contents Download : You can connect to NATE content shop and download the latest contents.

2. New Message (Cont'd)

The integrated MMS function enables you to attach content to the long text message and send to the mobile phone or e-mail address.

Using menu in the message writing field

Press **⏪** (Right) to change the writing mode (Korean, Symbol, Number, English upper/lower case).

Menu description

Set Text Color	Use or to set the color of the text.
Picture Emoticon	Press to move page, and press the number key pad to select the emoticon.
Text Emoticon	Press to move page, and press the number key pad to select the emoticon.
Add Number	Select the phone number in the phonebook and press to input the phone number automatically.
Used word	You can store and use the frequently used word. - You can edit the word in settings. (Settings, see p.166)
Save to Draft box	You can save the draft message in the outbox. (OUTBOX, see p.158)

Using menu in the attachment field

Press **⏪** (Left) in the **Attach** (Attachment) field

- If you select and press , you can connect to NATE content shop and download the most latest contents.
- You can check and manage contents in Attachment box.
(Contents Box, see p.165) Press **⏪** (Left) on the window.

Menu description

Attach Photo	You can attach the photo stored in the attachment box.
Attach Video	You can attach the video stored in the attachment box.
Attach Music/Voice	You can attach the music or voice stored in the attachment box.
Attach Image	You can attach the image downloaded from NATE.
Take Photo	You can take a photo and attach in the message.
Record Video	You can take a video and attach in the message.
Record Voice	You can record a voice and attach in the message.

Using menu in the receiver field

You can use the various functions such as search by name, recent addresses, add group, enter e-mail, read-reply rqst, send receiver's list by pressing **⏪** (Left).

3. Mobile Messenger

You can use the real time messenger function without registering friends.

Press **⏪** (Left) ▶ Press **7** ▶ Press **3**

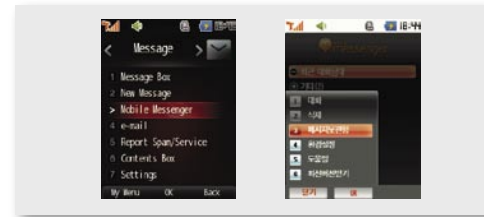

- If you press **⏪** (Right), you can add an entry by searching name/number or entering number.
- If you press **⏪** (Left), you can use talk, delete, message box, settings, help, update functions.



- The mobile messenger service is charged with the fixed service fee per message, and no data fee will be charged.
 - Use Help or visit the messenger homepage (<http://mm.nate.com>) for further information.

4. e-mail

Using the phone, you can manage inbox and outbox of the e-mail.

Press **⏪** (Left) ▶ Press **7** ▶ Press **4**

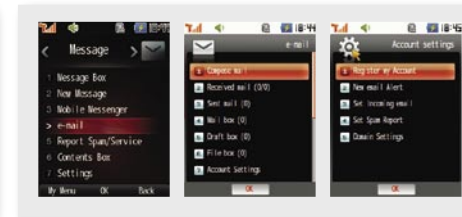

- When writing the email, you can attach the photo.
- You can check received contents, images, attachments.



- In order to use e-mail service, you have to register and make a e-mail account. Additional service fee is charged.

5. Report Spam/Service

To promote convenience of the user and to prevent damage caused by illegal spam, you can report the received spam messages to the spam handling center of Korea Information Security Agency.

Press **⏪** (Left) ▶ Press **7** 스팸 신고 ▶ Press **5** 이동 안내

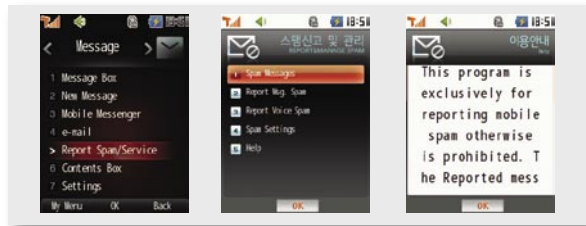

Menu description

Spam Messages	You can check received spam messages.
Report Msg. Spam	You can report spam by selecting the spam message and press ⏪ (Right).
Report Voice Spam	You can report spam by selecting the spam number and press ⏪ (Right).
Spam Settings	You can block the number or message to set as a spam.
Help	You can check the guide for spam report.



Note

• Visit the spam handling center of Korea Information Security Agency (www.spamcop.or.kr) for further information.

6. Contents Box

You can manage and check attachment of the received MMS.

Press **⏪** (Left) ▶ Press **7** 스팸 신고 ▶ Press **6** 첨부와 정보관리

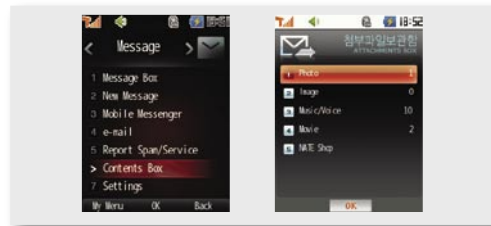

Menu description







Photo	You can view and manage the attachable photos.
Image	You can store and manage the images downloaded from NATE.
Music/Voice	You can view and manage the attachable music, and voice files.
Movie	You can view and manage the attachable movie files.
Nate Shop	You can connect to NATE content shop and download the latest contents.

- If you select **최신 인기 컨텐츠** and press **⏪**, you can connect to NATE content shop and download the latest contents.
- Press **⏪** (Left) to use Send MMS, Set Background, Rename, Delete, Protect/Release, and Delete All functions.

7. Settings

▮ You can set preferences for the message functions.

Press  (Left) ▶ Press  ▶ Press 

- MMS Settings** : You can select and set various contents when writing messages.
- **Background Settings** : You can select the background of the message. (Letter Paper, see p.161)
 - **Avatar Settings** : You can send the character or photo with the message. (Avatar, see p.161)
 - **Font Color Settings** : You can select the font color. (Press  or  to select font color.)
 - **Photo Size Settings** : You can set the size of photos transmitted from the phone via wireless Web (Internet).
 - **Set Name Card** : You can determine whether to attach your phone name card to all the messages.
 - **MMS mode change** : You can set alarm when switching SMS to MMS message.
- Signature Settings** : You can attach the designated sentence at the end of the message.
- **Edit Signature** : You can change font color or enter emoticon by pressing  (Left), and change letter input mode by pressing  (Right).
 - **Signature Setting** : You can set the designated sentence at the end of the message.
- MSG Noti. Setting** : You can set ring volume, alarm type, and alarm on calls.
- Msg. Notification** : You can set to display the message on the standby screen when a message is received.
- Sent Msg. Auto Save** : You can set auto save option on/off for sent messages.
- Spam Settings** : You can block the message from the designated phone number and string.
- **Number Block** : You can check the number, or cancel block, add, or delete all by pressing  (Left).
 - **String Block** : You can check the blocked phone number and use cancel block, add, delete all by pressing  (Left).
 - **Spam Setup/Release** : You can set to block spam number or sentence.
- Phrase Settings** : You can set the frequently used phrase.



11 Phonebook

- 01 Search Number 168
- 02 Add New Contact 170
- 03 Edit Group 171
- 04 Edit Speed Dial 171
- 05 Call History/Time 172
- 06 Block Calls 172
- 07 Memory Usage 173
- 08 Automatic Backup 173
- 09 Word Dial 174
- 10 My Number 175

1. Search Number

You can search the saved phone number list.

Press **⏪** (Left) ▶ Press **8** [▲] _▼ ▶ Press **1** [▲] _▼



- You can check or edit phone numbers.
- If you press **⏪** (Right) on the standby screen, 'Search All', 'Group', 'Speed Dial', and 'Number' are displayed.
- Select a phone number and press **☎** to place a call to the number.
- You cannot delete the default mobile security number.



Note

- You can see the phone number and group saved in USIM card only when USIM card is mounted in the phone.

1 Search All

Press **⏪** (Left) ▶ Press **8** [▲] _▼ ▶ Press **1** [▲] _▼ ▶ Press **1** [▲] _▼

- Phone numbers beginning with the entered character are listed.
- If you enter the first sound of a name, all the names starting with the sound are searched.

2 Group

Press **⏪** (Left) ▶ Press **8** [▲] _▼ ▶ Press **1** [▲] _▼ ▶ Press **2** [▲] _▼

- It is displayed in the order of groups. You can search for the phone number by moving to a group you want.
- If you enter the first sound of a name, all the names starting with the sound are searched.

3 Speed Dial

Press **⏪** (Left) ▶ Press **8** [▲] _▼ ▶ Press **1** [▲] _▼ ▶ Press **3** [▲] _▼

- Saved speed dial number is searched when entering speed dial key.

4 Number

Press **⏪** (Left) ▶ Press **8** [▲] _▼ ▶ Press **1** [▲] _▼ ▶ Press **4** [▲] _▼

- Pressing the number you want to search for displays the phone number including the number you entered.

Menu description

New Message	Send message to selected number.
@Messenger	Real-time messenger service. (@Messenger, see p.163)
Video Call	Place a video call to selected number.
Cyworld	Connect to the mobile homepage. (NATE Mobile Homepage, see p.81)
Send/Connect	Use e-mail, Voice Message Call, Call Me Free, Number Via Message, and Via Bluetooth functions for selected number.
Add New Contact	Save the phone number in the phonebook, if it's not saved in the USIM card.
Add Speed Dial	Assign selected number as a speed dial.
Set as Primary #	Assign a specific number as a primary number.
View	Set view of the number saved in the phone or USIM card. (This will affect search all and number screen.)
Move/Copy to USIM	Copy or move the saved phone number in USIM card to the phone. (You can only save the phone number and email information when copy/move USIM file. – Depends on the USIM card capacity, some data may not be stored due to available space.)
Delete	Delete all or delete the selected number.

2. Add New Contact

You can save phone numbers in the phone or USIM card.

Save by phone

Press **Left** ▶ Press **8** ▶ Press **Z**

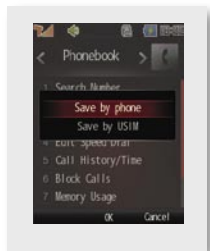

- Including mobile security numbers, you can save up to 2000 numbers.
- When saving as a new contact, you can select the saving location (phone, USIM card).
- If you select 'Add to Contact' when saving phone number on the standby screen, you can add or modify the existing phone number of the phonebook.

→ Press **Left** to set the primary number, and **Right** to assign as a speed dial number.

Icon description

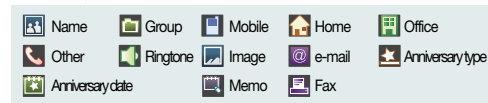

Save by USIM

Press **Left** ▶ Press **8** ▶ Press **Z**

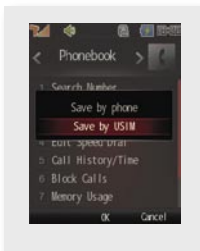

- You can save the phone number up to USIM card capacity.
- When saving as a new contact, you can select the saving location (phone, USIM card).
- If you select 'Add to Contact' when saving phone number on the standby screen, you can add or modify the existing phone number of the phonebook.

→ Press **Left** to set the primary number, and **Right** to assign as a speed dial number.

→ When saving by USIM, you can save name, group, mobile1, mobile2, and e-mail. Depends on the USIM card capacity, some data may not be stored due to available space.



• You can visit Motorola homepage (www.mymotorola.co.kr), download PC Sync program, and save, edit, and send phone number to PC.

3. Edit Group

You can manage the groups in the phonebook.

Press **Left** ▶ Press **8** ▶ Press **3**

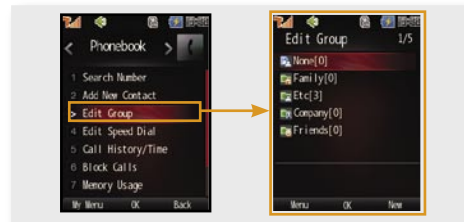

- Press **Right** to select the saving location (by phone or by USIM) and add a group.
- If you press **Left**, you can use 'Edit', 'Move Members', 'Move/Copy to USIM', and 'Delete Members'.
- If you delete a group, the phone numbers in the group are moved to 'Other' group. For group saved in USIM, numbers are moved to 'None'.
- You cannot delete or rename the default groups.
 - Phone: Family, Other, Office, Friend
 - USIM: None

4. Edit Speed Dial

You can assign speed dial numbers to the frequently used phone numbers.

Press **Left** ▶ Press **8** ▶ Press **4**

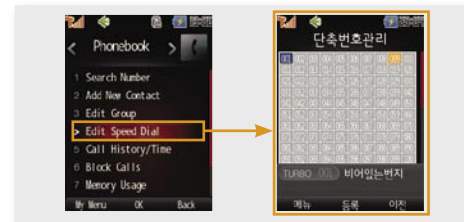

- On the standby screen, if you press the registered speed dial number, holding the last digit, the phone dials the registered phone number. (Placing a call with speed dial, see p.46)
- You can store up to 200 speed dial numbers (including mobile security numbers) in the phonebook.
- If you press **Left**, you can use 'Edit Speed Dial', 'Change Speed Dial', 'View List', and 'Delete'.
- You cannot delete the mobile security number.

5. Call History/Time

▮ You can view the call history and time.

Press **←** (Left) ▶ Press **8** (8) ▶ Press **5** (5)



- If you press **←** (Left) while viewing the call time, the call time is reset to zero.
- The call time is counted from the point the ringer is generated, and charging begins after the call is connected.

6. Block Calls

▮ You can register a phone number you want to block.

Press **←** (Left) ▶ Press **8** (8) ▶ Press **6** (6)

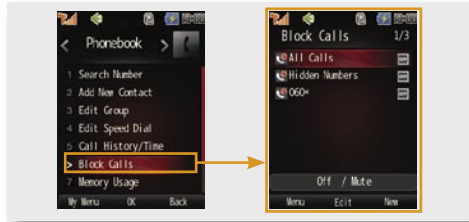

- Press **←** (Right) to add a phone number to the block phone number list.
- Press **Ⓜ** to set/release and edit block calls.

Menu description

All Calls : You can block all incoming calls.

Hidden Numbers : You can block all restricted calls.

060* : You can block calls starting with 060 numbers.

7. Memory Usage

▮ You can check the memory status of the phonebook.

Press **←** (Left) ▶ Press **8** (8) ▶ Press **7** (7)



- Press **←** (Left) to reset memory.
 - All phone numbers in the phone except mobile security are deleted.

8. Automatic Backup

▮ The phone updates the phonebook everyday to the server.

Press **←** (Left) ▶ Press **8** (8) ▶ Press **8** (8)



8. Automatic Backup (Cont'd)

Menu description

Upload Address Book : You can view changed address and upload to the server.

Download Address Book : You can download saved address in the server. (Additional fee is charged when downloading.)

Address Book Info : You can check the information of the most recent saved address book to the server.

Move to NATE : You can view phonebook saved in the phone or NATE web phonebook. The phonebook in the phone is synchronized with NATE.

Settings : You can set various preferences such as password, phonebook automatic backup, time, delete, and update.

Help : You can view guidelines on the phone automatic backup services.



Note

- In order to use automatic backup service, you have to register first and additional service fee is charged. Contact SKT Customer Center for further information.

9. My Number

You can view your own number.

Press (Left) ▶ Press ▶ Press

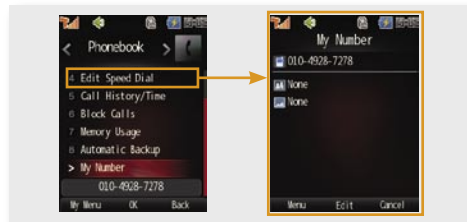

→ Press to register user information in the phone.

→ Press (Left) to send via message or send via bluetooth. (Bluetooth, see p.127)

12

Settings

01 Phone Settings	178
02 Call Settings	179
03 NATE Settings	180
04 Powersave	181
05 USIM Setting	181
06 Set Time	182
07 Lock/Password	183
08 언어/Language	184
09 Reset	185
10 Moto Customer Service	185
11 About	186

1. Phone Settings

Integrated menu for phone setting.

Sounds

You can set the sound functions in the sound menu.

Press (Left) ▶ Press ▶ Press ▶ Press

→ (Sound, see p.84)

Display

You can set the display functions in the display menu.

Press (Left) ▶ Press ▶ Press ▶ Press

→ (Display, see p.92)

Message

You can set the message functions in the message menu.

Press (Left) ▶ Press ▶ Press ▶ Press

→ (Settings, see p.166)

Camera

You can set the camera functions in the camera menu.

Press (Left) ▶ Press ▶ Press ▶ Press

→ (Camera, see p.112)

June Setting

You can set the june contents box functions in the june contents box menu.

Press (Left) ▶ Press ▶ Press ▶ Press

Play Setting : You can set the preference for content play.

Display : You can change settings for skin, preview, or recommended content.

Live screen sound : You can select the background sound when a live screen is set in the standby screen.

Memory : You can check the total space, used space, and free space of internal/external memory.

Bluetooth

You can set the bluetooth functions in the bluetooth menu.

Press (Left) ▶ Press ▶ Press ▶ Press

→ (Preference, see p.132)

T Live

You can set the T Live functions in the T Live menu.

Press (Left) ▶ Press ▶ Press ▶ Press

→ (T LIVE Settings, see p.41)

2. Call Settings

Integrated menu for call setting.

Answer Options

You can set the call answer mode.

Press (Left) ▶ Press ▶ Press ▶ Press

Open Phone : Receive a call when opening the folder.

Any Key : Receive a call when pressing any buttons except .

[Send] Key Only : Press to receive calls.

After 3 Seconds : The call is connected automatically in 3 seconds after the ringtone.

Auto Area Code

You can set an area code that you use frequently.

Press (Left) ▶ Press ▶ Press ▶ Press

→ If you enter a number starting with '0' on the standby screen after setting an auto area code, the area code is not displayed and only the number you entered is displayed. (Ex : Mobile phone number, international call number, and other area codes)

→ If you select 'Off' in area code list, the area code display will be cleared.

→ You can enter upto 5 numbers for auto area code.

2. Call Settings (Cont'd)

Integrated menu for call setting.

Airplane Mode

You can use all the mobile phone functions (MP3, game, organizer).

- Except the communication services (sending/receiving call/message, network communication including internet).

Press **[Left]** ▶ Press **[9]** ▶ Press **[2]** ▶ Press **[3]** ▶ Password

→ Press **[Left]** to see the description on the plane mode.

Network Settings

You can use this setting only in international roaming.

Press **[Left]** ▶ Press **[9]** ▶ Press **[2]** ▶ Press **[4]**

→ You can edit/change network setting to use the phone in the foreign contry.

→ You can have difficulties of using the phone regarding of phone call services if you change it within your own discretion.

3. NATE Settings

You can change NATE preferences.

Press **[Left]** ▶ Press **[9]** ▶ Press **[3]**

NATE Setting Menu

Home URL : You can set the initial access address for wireless internet.

Proxy : If the service provider extends the proxy, and adds or deletes address, you can set the proxy at your own discretion.

Reset : If you correct Home URL and Proxy, you can recover them to the factory-set default.



Note

- Proxy is the server located between the user and the service server to speed up data transmission. When the user request a specific data, the data in the proxy, rather than the concerned server, are sent to the user.

4. Powersave

When the folder is opened without using it, backlight turns off and change to powersave mode.

Press **[Left]** ▶ Press **[9]** ▶ Press **[4]**

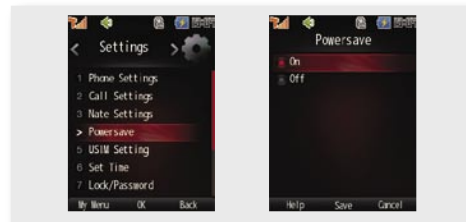

→ Powersave mode manages backlight of display and keypad to increase battery life.

→ You can press **[Left]** to move and select on/off by pressing **[Enter]**.

5. USIM Setting

To prevent loss of information when lost or stolen the phone, you can set lock and PIN.

Press **[Left]** ▶ Press **[9]** ▶ Press **[5]**

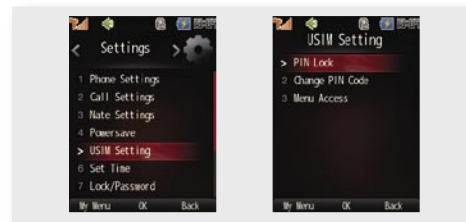

PIN Lock : You can set PIN code when turning on/off the mobile phone.

Change PIN Code : You can change PIN code.

Menu Access : You can lock the menu when USIM card is not mounted in the phone.

5. USIM Setting (Cont'd)

To prevent loss of information when lost or stolen the phone, you can set lock and PIN.



Note

- If you have entered in wrong PIN code for 3 times, it turns to PIN unlock code (PUK). If you have entered in wrong PUK code 10 times, you have to replace USIM card.
 - PIN(Personal Identification Number) Code : This is to prevent others from using your phone. (Upon purchasing the product, the password is '0000'.)
 - PUK(PIN Unlock Key) Code : This code is 8 digit number to reset USIM code, if you have entered in wrong PIN code for 3 times. This number can be found on the USIM card envelope or card holder.
- If you have lost PIN/PUK code, visit SKT retail center to reset the password.

6. Set Time

You can set current time in the phone.

Press **[Left]** ▶ Press **[WVZ 9]** ▶ Press **[MNO 6]**

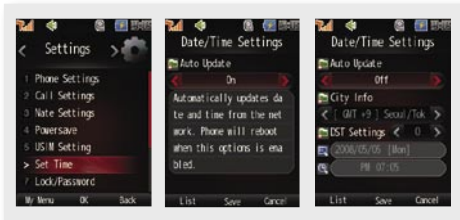

- ➔ If you set to manual, you have to input the time or select city info and summer time(DST).

Auto : Set the time automatically from service provider.
Manual : The user inputs the information manually.

7. Lock/Password

You can set the password of the phone to prevent unapproved use. (The default password is '0000')

Phone Lock

All the phone functions are locked. (except receiving the call)

Press **[Left]** ▶ Press **[WVZ 9]** ▶ Press **[POR 7]**
Input Password ▶ Press **[1]**

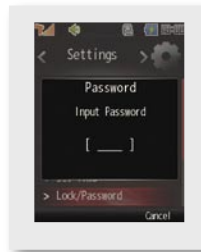

- ➔ You can set phone lock by pressing and holding **[*#]** on the standby screen.
 - You can still receive the call even when the phone is locked.
- ➔ The phone maintains the lock even if you switch on/off the phone.
- ➔ You can still place the emergency calls (111, 112, 113, 119, 125, 127) or use the Speed Dial 1 and 9 (Mobile Security) even when phone is locked.

- ➔ When you receive a call, the lock mode is released temporarily, and the phone returns to the lock mode after the call.
- ➔ In order to release the lock mode completely, press and hold **[*#]** and enter the password, or select 'Unlock' in the Phone Lock menu.

Privacy Lock

You can select the menu and set lock.

Press **[Left]** ▶ Press **[WVZ 9]** ▶ Press **[POR 7]**
Input Password ▶ Press **[2]**

- ➔ If you set lock for a menu, you need to enter the password to use the selected function. This will protect your privacy.
- ➔ Press **[Left]** to select all and lock all menu. In order to unlock the menu press **[Left]** again.
- ➔ Press **[Right]** to select and lock several menu. In order to unlock the menu press **[Right]** again.
- ➔ If you select 'Hide Phonebook Name', sender names stored in phonebook are not displayed. However the calling number is displayed. (When a message is received, the 'Hide Phonebook Name' function is not applied.)

Service Key Lock

When connecting to wireless internet, you have to input the password.

Press **[Left]** ▶ Press **[WVZ 9]** ▶ Press **[POR 7]**
Input Password ▶ Press **[3]**

- ➔ You need to enter the password to use the one-touch dial button (NATE, W, T MAP, GXG, @Playon, etc). This will protect your privacy, and prevent from paying additional fee for unwanted wireless internet service.

7. Lock/Password (Cont'd) 8. Language

You can set the password of the phone to prevent unapproved use. (The default password is '0000')

Restrict Call

You can restrict origination to overseas of 700/060 numbers.

Press **Left** ▶ Press **9** ▶ Press **7**
Input Password ▶ Press **4**

Change Password

You can change the password.

Press **Left** ▶ Press **9** ▶ Press **7**
Input Password ▶ Press **5**

- Be sure not to forget your password.
 - If you lose your password, you have to visit the service center in person with the ID card.
- Motorola takes no responsibility for any damage caused by leakage of password.

You can select the language to be used in the phone.
(Language : Korean/English)

Press **Left** ▶ Press **9** ▶ Press **8**

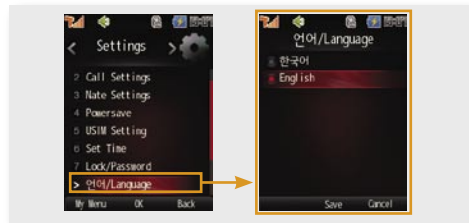

→ Even if you select English, some functions are displayed in Korean.

9. Reset

You can reset the phone to default setting.

Press **Left** ▶ Press **9** ▶ Press **9**

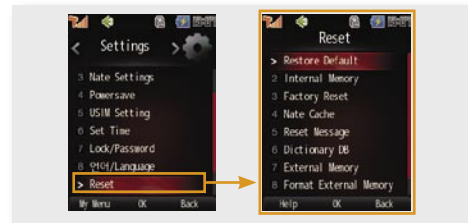

- To reset the phone, you need to input the password.
- The phone gets automatically switched off and rebooted.
 - If the phone fails to reboot, press **Power** to turn on the power.
- You can view function description of the item you wish to reset by pressing **Left**.

10. Moto Customer Service

You can receive the service guide about the phone.

Call Center

Representative number and business hours of Motorola Customer Call Center is displayed.

Press **Left** ▶ Press **9** ▶ Press **0** ▶ Press **1**



→ Press **Call** to place a call to the customer center.

10. Moto Customer Service (Cont'd)

You can receive the service guide about the phone.

Search Service Center

You can check the local customer center number and how to get there.

Press (Left) ▶ Press ▶ Press ▶ Press

- Press to place a call to the customer center.
- Press (Left) to save the local customer center number.

Troubleshooting

You can check the solution against phone failure.

Press (Left) ▶ Press ▶ Press ▶ Press

11. About

You can check the S/W version of the phone.

Press (Left) ▶ Press ▶ Press

S/W upgrade

If you wish to upgrade the software to the recent version, or if you need to upgrade software due to a bug, you can visit Motorola homepage (www.mymotorola.co.kr) and easily upgrade it with the Moto Upgrade program without having to visit a Motorola service center.

- Visit the Motorola homepage, sign up and log in.
- Select 'MOTOPRODUCT INFORMATION' and click Version Upgrade.
- Before starting the Moto Upgrade program, make sure to read 'Prerequisites', and run the program in accordance with the procedure. (Some software versions require you to visit the service center for upgrade. If you visit the nearest Motorola service center for free Moto Upgrade.

Contact the Motorola Customer Center (1588-6633) for details.

13

Appendix

01 Accessories.....	186
02 Troubleshooting.....	186
03 Spec and Feature.....	187
04 Authentication label.....	187
05 Specific Absorption Rate.....	188
06 Collecting wasted-mobile phones..	189