



| DRAFT - MOTOROLA CONFIDENTIAL
& PROPRIETARY INFORMATION

Congratulations

Your MOTOROLA **COMMAND ONE™** headset provides the ultimate handsfree experience. Now, you can manage calls and texts from your headset.

With your Command One, you can:

- Hear and reply to text messages with MotoSpeak™.
- Hear the caller's name and use your voice to answer and ignore calls.
- Stream music from your phone.
- Hear voice prompts to guide you on connections, battery level, and other functions.
- Simultaneously connect with two phones.

We've crammed all of the main features of your headset into this handy guide, and in a

matter of minutes we'll show you just how easy your headset is to use.

So go on, check it out.

more information

on the Web: www.motorola.com/support

Caution: Before using your headset for the first time, please read the important **Safety, Regulatory & Legal** information at the back of this guide.



Your headset

the important parts

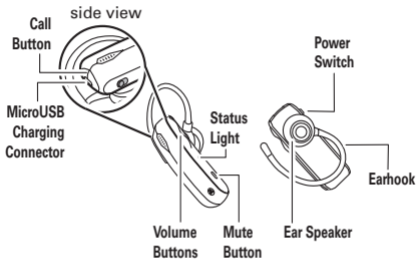

CONFIDENTIAL INFORMATION



Charge it

let's get you up and running

Status Light

Red/Yellow = charging

Green = fully charged

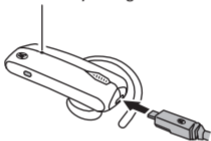

While your headset is charging, you won't be able to use it.

Note: Your battery is designed to last the life of your product. It should only be removed by a recycling facility. Any attempt to remove or replace your battery will damage your headset.



Basics

a few essentials to get you started

Turn it on & off

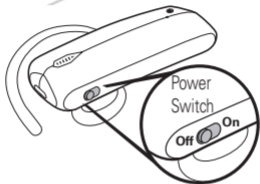

Wear it

- 1 Rotate and turn your ear hook for left or right ear use.

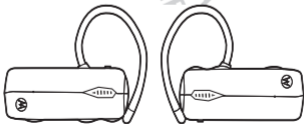

- 2 Try out all the supplied ear cushions. If using an ear loop type, be sure to place the loop in the bend of your ear as shown.



- 3 Flex the ear hook and loop it over your ear, and point the headset microphone towards your mouth.

Listen to music

Note: This feature is phone dependent.

Bluetooth® music can be streamed from your phone. Start and control music playback from your phone.

While a call is active, music pauses. When the call ends, music resumes playing.

Enhanced call features

Tell headset to answer or ignore calls

Use your voice to answer or ignore an incoming call:

- say "*answer*" to answer the call
- say "*ignore*" to ignore the call

Note: This feature does not work for second incoming calls.

Hear caller's name

If your phone knows your caller's name, then you hear "*call from <name>*" on an incoming call.

Pair & connect

connect and go

Note: The voice prompts are only in English.

Pair & connect with your phone

- 1 Turn off any Bluetooth devices previously paired with your headset.
- 2 Turn on the Bluetooth feature on your phone.
- 3 Put the headset on your ear (see “Wear it” on page 5).
- 4 Turn on your headset (see “Turn it on & off” on page 5).

The status light becomes steadily lit in blue and you hear “*ready to pair*”.

- 5 Follow the voice prompts to connect your phone to your headset.

Note: When prompted for the passkey, enter **0000**.

When your headset successfully pairs with your phone, you hear *"pairing complete"*.

For daily use, make sure your headset is turned on, and your phone's Bluetooth feature is on. Your headset and phone connect automatically.

Pair & connect a second phone

- 1** Turn off first phone and any other Bluetooth devices previously paired with your headset.
- 2** Turn your headset off.
- 3** Turn on the Bluetooth feature on your phone.
- 4** Put the headset on your ear.
- 5** Turn on your headset.

The status light becomes steadily lit in blue and you hear *"ready to pair"*.

- 6** Follow the voice prompts to connect your phone to your headset.



Note: When prompted for the passkey, enter **0000**.

When your headset successfully pairs with your phone, you hear *"pairing complete"*.

To connect to both phones, turn on the first phone while the second phone is connected. When you hear *"<phone 1 name> connected"*, your headset is connected to both phones.

Tip: You have 20 seconds to turn on your first phone. If reconnection fails, turn your headset off and on.

Test your call connection

- 1 Place the headset on your ear.
- 2 On your phone, dial a phone number and press the **Call/Send** key.

If your phone and headset are successfully connected, you hear ringing on the headset.

Calls

it's good to talk

Note: Some features are phone/network dependent.

To...	
answer call	Say " <i>answer</i> " or press the Call button.
reject call	Say " <i>ignore</i> " or press and hold a Volume button until you hear a tone.
make a voice dial call	Press the Call button and you hear a tone.
redial last call	Press and hold the Call button until you hear a tone.
mute or unmute a call	Press the Mute button.

To...	
end a call	Press the Call button.
answer second incoming call	Press the Call button.
reject second incoming call	Press and hold a Volume button until you hear a tone.

Tip: When connected to two phones, follow the voice prompts to perform functions such as voice dial and redial on the desired phone.

Talk time

check your chat time

Note: The voice prompts are only in English.

Press both Volume buttons while not on a call.

if light shows...	and/or you hear...	your remaining talk time is..
red	<i>"battery level is low"</i>	less than 1.5 hours
yellow	<i>"battery level is medium"</i>	between 1.5 to 3.5 hours
green	<i>"battery level is high"</i>	more than 3.5 hours

To save battery power, turn off the headset when not using it.

Status light

know your headset

If light shows...	your headset is...
three blue flashes	powering on/off
steady blue	in pairing/connect mode
rapid blue/purple flashes	connecting to your phone
quick blue flash	receiving or making a call on phone 1
quick purple flash	receiving or making a call on phone 2
slow blue pulse	on a call
slow blue flash	in standby (not on a call—connected to one phone)



If light shows...	your headset is...
slow green flash	in standby (not on a call—connected to two phones)
slow red flash	idle (not connected to a phone)
slow red pulse	muting the call
steady red	trying to connect to your phone
quick red flash	in a low battery state

Note: After 1 minute on a call or 20 minutes of inactivity, the light stops flashing to conserve power, but the headset remains on.

Settings

make some changes

Note: The voice prompts are only in English.

Press and hold the Call button while turning on the headset to turn these features on/off:

- Reset to factory default

Caution: This action erases all pairing information stored in your headset.

- Caller ID
- Voice prompts
- Multipoint (two phone) connections

Follow the voice prompts to make changes to these settings.

Problems?

we've got solutions

Note: The voice prompts are only in English.

My headset will not enter pairing mode

Make sure that any devices previously paired with the headset are turned off. If the status light is not steadily lit in blue, turn off both the other device and headset, wait 10 seconds, then turn headset back on. Wait for the status light to become steadily lit in blue, indicating the headset is now in pairing mode.

My phone doesn't find my headset when searching

Make sure the status light on your headset is steadily lit in blue when your phone is searching for devices. If not, power cycle (turn off and on) the headset. You hear "*ready to pair*" and see the status light steadily lit in blue.

My headset worked before but now it's not working

Make sure your phone is on and the Bluetooth feature is turned on in your phone. If the Bluetooth feature was turned off or was turned on only temporarily, you may need to restart the Bluetooth feature and pair your phone and headset again (see “Pair & connect” on page 8).

Support

we're here to help

If you have questions or need assistance, contact us at **1-877-MOTOBLU**, or visit us at www.motorola.com/Bluetoothsupport or www.motorola.com/bluetoothconnect.

DRAFT - MOTOROLA CONFIDENTIAL
PROPRIETARY INFORMATION