

Meet your phone.

verizon

Para la versión en español, visite Verizon-Wireless.com/Support



About your phone



NOTE: Devices and software are constantly evolving—the screen images and icons you see here are for reference only.

Setting up your phone

Your phone already has a SIM card installed.

Optional: Insert the microSD card.

1. With the phone facing down, insert the tool that comes with your phone into the small hole on the card tray and pop out the tray.



2. Insert the microSD card with the gold contacts facing up.



NOTE: The microSD card is sold separately.

3. Carefully insert the tray back in the phone and make sure it closes securely.



Charge your phone

Before turning on your phone, charge it fully.

Insert the small end of the USB-C cable into the charger port. Insert the other end into the power adapter, and plug the power adapter into an electrical outlet.

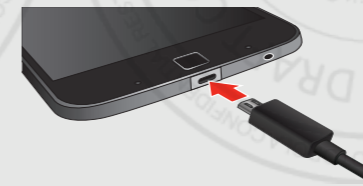

WARNING! Only use approved chargers with your device. Incompatible chargers or tampering with the charger port could damage your device and void the warranty.

Using your phone

Turning your phone on/off

To turn your phone on, press and hold the **Power/Lock** button on the phone until the screen turns on.

To turn your phone off, press and hold the **Power/Lock** button and then tap **Power off**.

Locking/unlocking the screen

To turn on your screen, press the **Power/Lock** button. Then drag the lock icon to unlock it.

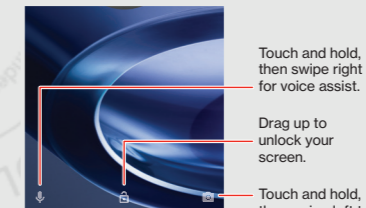

To turn off your phone and prevent accidental key presses, press the **Power/Lock** button. Your phone will also lock automatically if you don't use it for awhile.

Home screen

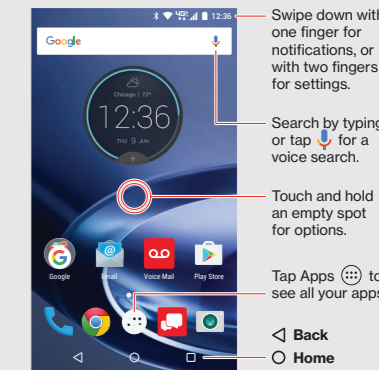

Using your phone (cont.)

Moto Mods™

Transform your phone into a movie projector, a boombox, a battery powerhouse, and more. Swap out Moto Mods throughout the day to get the performance you need when you want it, and add new Moto Mods to your collection at any time.

NOTE: Enjoy the Moto Style Shell included with your phone. Moto Mods are sold separately. Learn more about Moto Mods at [VerizonWireless.com](#) or [Motomods.com](#)

CAUTION: Remove the Moto Style Shell or other Moto Mod before adding a case that covers the back of the phone.

Advanced Calling

You can make high-definition voice and video calls, and surf the web while you talk on the phone, when you add Advanced Calling to your line. To learn how, visit

[VerizonWireless.com/AdvancedCalling](#)

Copying content from your old phone

For help transferring contacts, photos, and other content from your old phone, visit

[VerizonWireless.com/Cloud](#)

Learning more



The **Help** app gives you tips, videos and other information on how to use your phone, including:



Making calls



Voice mail



Sending texts



Getting apps



Taking photos



Accessibility settings



From your computer, visit [VerizonWireless.com/Support](#)



Download a User Guide from [VerizonWireless.com/Support](#) or call **800.922.0204** to order a copy.

Managing your account

My Verizon Mobile app

Manage your account, track your usage, edit account information, pay your bill and more.

International travel

For features and rates when outside the US, visit [VerizonWireless.com/International](#)

Customer service

Call **800.922.0204**
Twitter [@VZWSupport](#)

Legal, safety and warranty information

To see legal, safety and warranty information for this phone, tap **Apps** > **Settings** > **Legal information** and select a topic. Or visit [Motorola.com/Device-Legal](#)

Additional information

Your wireless device and third party services

Verizon Wireless is the mobile carrier associated with this wireless device, but many services and features offered through this wireless device are provided by or in conjunction with third parties. Verizon Wireless is not responsible for your use of this wireless device or any non-Verizon Wireless applications, services and products, including any personal information you choose to use, submit or share with others. Specific third-party terms and conditions, terms of use and privacy policies apply. Please review carefully all applicable terms, conditions and policies prior to using this wireless device and any associated application, product or service.

Hearing aid compatibility information

This phone has been tested and rated for use with hearing aids for some of the wireless technologies that it uses. However, there may be some newer technologies that have not been tested yet for use with hearing aids. It is important to try the different features of this phone thoroughly and in different locations, using your hearing aid or cochlear implant, to determine if you hear any interfering noise. Ask your service provider or the manufacturer of this phone for information on hearing aid compatibility. If you have questions about return or exchange policies, ask your service provider or phone retailer.

FCC and IC Compliance

This device complies with part 15 of the FCC rules. Operation is subject to the following two conditions: (1) this device may not cause harmful interference, and (2) this device must accept any interference received, including interference that may cause undesired operation. This device complies with Industry Canada license-exempt RSS standard(s). Operation is subject to the following two conditions: (1) this device may not cause interference, and (2) this device must accept any interference received, including interference that may cause undesired operation.

Electronic Label

Your mobile device may use an electronic label that provides some regulatory information about the device. To see the electronic label, tap **Apps** > **Settings** > **About phone** > **Regulatory information**.

Battery Safety

Before assembling, charging or using your mobile device for the first time, please read the important product safety and legal information provided with your product.

If your mobile device becomes unresponsive, try a reboot—press and hold the Power button until the screen goes dark and your device restarts.

For your safety, the battery in your mobile device should only be removed by a Motorola approved service center or independent qualified professional. Don't try to remove or replace the battery yourself—doing so may damage the battery and could cause burning and injury. Don't crush, bend, or expose your mobile device to heat or liquid. This may damage the battery and may cause burning and injury.

Caution about High Volume Usage

WARNING! To prevent possible hearing damage, do not listen at high volume levels for long periods.



Disposal & Recycling

Help do your part! Please don't dispose of mobile devices or electrical accessories (such as chargers, headsets, or batteries) with your household waste. Product packaging and product guides should only be disposed of in accordance with national collection and recycling requirements. For details on approved national recycling schemes and Motorola recycling activities, go to: [Motorola.com/Recycling](#)



Usage

This phone supports apps and services that may use a lot of data, so make sure your data plan meets your needs. Contact your service provider for details. Certain apps and features may not be available in all countries.

Regulatory Information

To view the Regulatory ID (such as FCC ID) for this device, on the phone, go to **Settings** > **Legal information** > **Regulatory ID/Markings**, or visit [Motorola.com/Device-Legal](#)

Warranty

This product is covered by Motorola's limited warranty. To review the warranty on your phone, go to **Settings** > **Legal information** > **Warranty** or visit [Motorola.com/Device-Legal](#). You may also obtain a copy of the warranty by contacting Motorola at: Motorola Mobility LLC, Attention Customer Service--Warranty Request, 222 West Merchandise Mart Plaza, Suite 1800, Chicago, IL 60654.

Arbitration & opt-out

Any controversy or claim arising out of or relating to any Motorola product will be resolved by binding arbitration, instead of in court, unless you opt-out. To opt-out, send a written rejection notice within 30 days of purchase that includes your name, address, phone number, device, and device serial number, and tells Motorola that you are rejecting this Arbitration provision to: Motorola Mobility LLC, 222 West Merchandise Mart Plaza, Suite 1800, Attn: Arbitration Provision Opt-Out, Chicago, IL 60654 or arbitrat@motorola.com. For more information on this arbitration provision, on your phone, go to **Settings** > **Legal information** > **Arbitration and Opt-out**, or visit [Motorola.com/Device-Legal](#)

Copyright & trademarks

MOTOROLA and the Stylized M Logo are trademarks or registered trademarks of Motorola Trademark Holdings, LLC. Android, Google and other trademarks are owned by Google Inc. The Android robot is reproduced or modified from work created and shared by Google and used according to terms described in the Creative Commons 3.0 Attribution License. The microSD logo is a trademark of SD-3C, LLC. DROID is a trademark of Lucasfilm Ltd. and its related companies. Used under license. All other product or service names are the property of their respective owners.

© 2016 Motorola Mobility LLC.

Product ID: Moto Z PLAY DROID (Model XT1635-01)

Manual Number: 68018248001-A

© 2016 Verizon Wireless. All Rights Reserved



This product meets the applicable national or international RF exposure guidance (SAR guideline) when used normally against your head or, when worn or carried, at a distance of 1.0 cm from the body. The SAR guideline includes a considerable safety margin designed to assure the safety of all persons, regardless of age and health.

To view the SAR values for your phone, visit [Motorola.com/Sar](#). To view additional SAR information on your phone, tap **Apps** > **Settings** > **Legal information** > **RF information**. To view the information on the web, visit [Motorola.com/RFhealth](#)

