



MOTOSTART

H5 Bluetooth® Handsfree Headset

Get Connected in 4 Quick Steps



- 1 - CHARGE
- 2 - START BLUETOOTH FEATURE
- 3 - PAIR
- 4 - TEST AND USE



BEFORE YOU BEGIN

Before using this product, read the Important Safety and Legal Information pamphlet and follow its instructions.

Take a moment before you get started to familiarize yourself with your new H5 Headset.

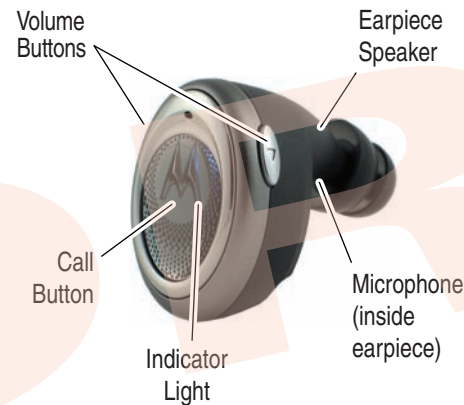

CHARGE Your Headset's Battery

- 1 Plug Motorola power supply into charger port on charger base. The charger battery indicator light turns on ().

- 2 Insert headset snugly into charger base.

The headset battery indicator light turns on () to indicate the headset is charging. It may take up to 1 minute for the indicator light to turn on. When headset's battery is fully charged (about 2 hours), the headset battery indicator light turns off.

Note: Headset is not functional while charging.

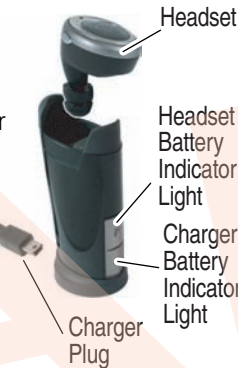

- 3 When charged, remove headset from charger base.

Note: The charger base battery remains charging while plugged into the power supply.



START BLUETOOTH FEATURE Your Phone

Your phone's Bluetooth feature is off by default. To use your headset, you must turn on the Bluetooth feature in your phone.

For most Motorola phones:

- 1 Press **(Menu) > Settings > Connection > Bluetooth Link > Setup.**

- 2 Scroll to **Power.**

- 3 Select **Change.**

- 4 Scroll to **On.**

- 5 Press **Select** to turn on the Bluetooth feature. The Bluetooth feature remains on until you turn the feature off.

Note: These steps are for most Motorola phones. For other phones, see your phone's user's guide.



PAIR Your Headset

Before you can use your headset, you must pair (link) it with your phone.

Step A - PUT THE HEADSET IN PAIRING MODE



- 1 Ensure the headset is turned off (indicator light not blinking).

Note: See "Turning On and Off" on the reverse side of this guide for details on turning off your headset.

- 2 Press and hold the Call button for 6 to 10 seconds. The indicator light will initially flash, but continue to hold down the button until the indicator light is steadily lit.

If the indicator light is flashing or not steadily lit when releasing the button, repeat **both steps 1 and 2** on this page.



PAIR CONTINUED Your Phone

Step B - SET YOUR PHONE TO LOOK FOR YOUR HEADSET

For most Motorola phones:

- 1 On your Motorola phone, press **(Menu) > Settings > Connection > Bluetooth Link > Handsfree > Look for Devices.**

The phone lists Bluetooth devices it finds.

- 2 Select **Motorola H5.**
- 3 Select **OK** or **Yes** to pair your headset with your phone.
- 4 Enter the passkey: **0000**
- 5 Select **OK.**

When your headset successfully pairs with your phone, the indicator light changes from steadily lit to flashing.

Note: These steps are for most Motorola phones. For other phones, see your phone's user's guide.



TEST AND USE

Your phone and headset are now paired and ready to make and receive calls. To make a call:

- 1 Place the headset in your ear. The earpiece should be inserted so that the headset feels comfortable and forms a seal in the ear.
- 2 On your phone, dial the number you want to call and press the **SEND** key.
- 3 If your phone and headset are successfully paired, you will hear ringing on the headset.

After you have successfully paired your phone and headset, you don't need to repeat these steps. For daily use, ensure that your headset is turned ON and that your phone's Bluetooth feature is ON.

USING YOUR H5

See **Features and Functions Guide** on the reverse side for information on using your H5.



TROUBLESHOOTING

My phone doesn't find my headset.

Make sure the indicator light on your headset is on and steady when your phone is searching for devices (see step 3).

My headset worked before but now it's not working.

Make sure your phone is on and the Bluetooth feature is turned on in your phone (see step 2). If the Bluetooth feature was turned off or was turned on only temporarily, you may need to restart the Bluetooth feature (see step 2) and pair your phone and headset again (see step 3).

Support.

If you need more help, contact us at **1-877-MOTOBLU.**

FOR DETAILS ABOUT YOUR HANDSFREE DEVICE

See the user's guide or visit us at www.hellomoto.com/bluetooth and click **Support.**

Motorola, Inc.
Consumer Advocacy Office
1307 East Algonquin Road
Schaumburg, IL 60196

www.hellomoto.com
1-877-MOTOBLU
1-888-390-6456 (TTY/TDD United States for hearing impaired)

Guide Number: 6809495A89-O

MOTOROLA and the Stylized M Logo are registered in the US Patent & Trademark Office. The use of wireless devices and their accessories may be prohibited or restricted in certain areas. Always obey the laws and regulations on the use of these products. The Bluetooth trademarks are owned by their proprietor and used by Motorola, Inc. under license. All other product or service names are the property of their respective owners.

© Motorola, Inc. 2006.

Features and Functions Guide

H5 Bluetooth® Handsfree Headset

IMPORTANT:
Be sure to first follow the **Quick Start Guide** on the reverse side to complete initial setup of your H5.

TURNING ON AND OFF

To turn your headset on, press and hold the Call button until the indicator light flashes.

To turn your headset off, press and hold the Call button until the indicator light flashes rapidly and then turns off.

To conserve battery power, turn off your headset when you don't plan to use it for a while.



INSTALLING EARTIP

Your headset is supplied with both flanged and foam eartips. To install these eartips:

FLANGED EARTIP:

- 1 Pull back largest flange on eartip.
- 2 Twist eartip onto earpiece starting at an angle and pushing onto headset.

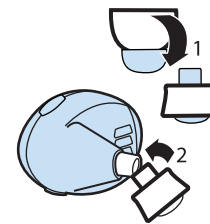

FOAM EARTIP:

- Twist eartip onto earpiece starting at an angle and pushing onto headset.

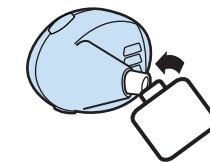

WEARING HEADSET

FLANGED EARTIP:

- 1 Pull upward slightly on top of your ear.
- 2 Place the earpiece speaker into your ear.

The eartip should form a comfortable seal in your ear.

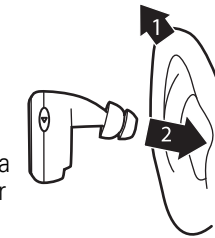

FOAM EARTIP:

- 1 Roll foam between thumb and forefinger to compact.
- 2 Pull upward slightly on top of your ear.
- 3 Place the earpiece speaker into your ear and hold for 5 seconds while

The eartip should form a comfortable seal in your ear.

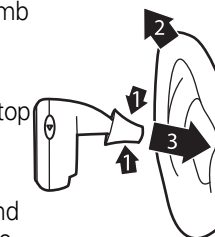

MAKING CALLS

Function	Action
Make a voice dial call	Tap the Call button and speak the name after the tone
End a call	Tap the Call button
Receive a call	Tap the Call button
Reject a call	Press and hold the Call button until you hear a medium beep
Redial last call	Press and hold the Call button until you hear a medium beep
Answer a second incoming call	Press and hold the Call button until you hear a medium beep (places first call on hold)

Note: Your H5 supports both Handsfree and Headset Profiles. Accessing call functions depends upon which profile your phone supports. See your phone's user's guide for more information.

MAKING CALLS *CONTINUED*

Function	Action
Toggle between two active calls	Press and hold the Call button until you hear a medium beep
Join a 3-way call	Press and hold both Volume buttons until you hear a medium beep
Put an active call on hold or resume a call on hold	Press and hold the Call button until you hear a medium beep
Transfer a call from the phone to the headset	Tap the Call button
Disable or enable the indicator light	Press and hold both Volume buttons until you hear a low beep
Mute or unmute a call	Tap both Volume buttons

Note: Some features are phone/network dependent.

INDICATOR LIGHTS

Indicator lights provide information about your headset (and charger base) status.

Charger Base

Indicator	Status
Charger Battery (On)	Charging
(Off)	Charging complete
Headset Battery (On)	Charging
(Off)	Charging complete

Headset

Indicator	Status
Off	Power off
On (steady)	Pairing mode
10 rapid flashes	Pairing successful
Slow pulse	Connected (on a call)
Quick flash	Standby (not on call)

Note: After 5 minutes of inactivity, the light stops flashing to conserve power, but the headset remains in standby mode.

AUDIO TONES

The audio tones provide information about your headset's status.

Audio Tone	Headset Status
Single high tone when pressing Volume button	Volume at minimum or maximum
Five rapid high tones repeated every 60 sec.	Low battery
No audio indications; deteriorating quality	Out of range
Ring tone	Incoming call
Single very high tone	All calls ended
Single high tone	Entering pairing mode
	Tapping Call button or both Volume buttons
Single medium tone	Pressing Call button or both Volume buttons
Single low tone	Pressing and holding Call button or both Volume buttons

AUDIO TONES *CONTINUED*

Audio Tone	Headset Status
Single high tone repeated every 5 sec.	Phone network not available
Two ascending tones	Mute enabled
Two descending tones	Mute disabled
Four ascending tones	Headset powering on
Four descending tones	Headset powering off

VOLUME BUTTONS

Volume button orientation can be changed on your headset as follows:

- 1 Turn your headset off
- 2 Press both Call button and the Volume button you want to assign as the "volume up" button until the indicator light flashes twice. The headset power turns on.