

MOTOROKR EQ7 Bluetooth Speaker Quick Start Guide

DRAFT 4 - 12/3/07

Dummy Page - To be discarded before printing

use this template with A6MotoQSGPortraitTemplate StructApps



MOTOROKRTMEQ7

Quick Start Guide



welcome

The **MOTOROKR™** EQ7 High Fidelity Bluetooth® Stereo Speaker lets you enjoy your music in crystal clear JBL® audio. The EQ7 not only delivers wireless music in elegant sound and style, it doubles as a speakerphone for phone calls—all at an extended range.

- **Wireless music in premium sound**—Motorola wireless technology coupled with powerful JBL speakers and acoustics design.
- **Intuitive controls**—music controls that light up during wireless audio connection, and indicators that provided status for Bluetooth connection, audio mute, and power.
- **Wireless range beyond the walls**—take your music with you with the extended wireless range up to 100m/330ft.

Note: Before using your speaker for the first time, be sure to review the important safety and legal pamphlet and follow instructions. Periodically review this information so you remember how to safely use your speaker.

Note: Your EQ7 is a Class 1-capable Bluetooth device. Bluetooth features and Bluetooth Class 1 power levels are not allowed for outdoor operation in France. To avoid unlawful interference with radio signals, do not use the Bluetooth features in France unless you are indoors.

before you begin

Take a moment before you get started to familiarize yourself with the components of your speaker.



powering your speaker

batteries

You can power your speaker using 4 AA batteries. Remove the battery door, then insert batteries in compartment as shown.



power adapter

You can power your speaker using the included Motorola power adapter. Plug connector into the Power port as shown, then plug power supply into a wall outlet.



getting the party started

To turn your speaker on and off, press the Power button on the rear. The Power indicator light is steadily lit when the speaker is on.



connecting wirelessly

To listen to your music via Bluetooth wireless connection, as well as make and receive handsfree calls, you need to pair (link) it with your Bluetooth phone and/or music device.

- ➊ Turn off any Bluetooth devices previously paired with speaker.
- ➋ Turn on the Bluetooth feature on your Bluetooth phone or music device.
- ➌ Turn on your speaker.

The Bluetooth indicator flashes to indicate the EQ7 is in discoverable mode.

- ➍ Place phone or music device in Bluetooth search mode.

The phone or music device searches for your speaker.

- ➎ Select **Motorola EQ7** from search results on your phone or music device.
- ➏ Select **OK** or **Yes** to pair your speaker with your phone or music device.
- ➐ If prompted, enter **0000** for passkey.

When your speaker successfully pairs and connects with your phone or music device, the Bluetooth indicator changes from flashing blue to steadily lit. Music playing from your connected music source is heard on your speaker.

After you have successfully paired your speaker and Bluetooth device, you don't need to repeat these steps. For each use, ensure that your speaker is turned ON and that your device's Bluetooth feature is ON.

connecting wirelessly

a note on wireless streaming music

You can listen to wireless streaming music received from a Bluetooth phone or music device that supports the A2DP Bluetooth profile.

You can also control music playback from your speaker when the streaming music connection provides Bluetooth AVRCP capabilities. If AVRCP capabilities are supported by your music player, music control buttons are lit up on your speaker (see “controlling your tunes wirelessly” on page 9 for details). If AVRCP capabilities are not supported by your music player, the EQ7 simply acts as a speaker for the wireless streaming audio.

connecting with wires

To listen to your music via wired connection, connect your music device to the Audio port on your speaker using a 3.5mm cable (not included).



Music playing on your connected music source is heard on your speaker.

controlling your tunes

Playback controls provided on your speaker can be used when listening to Bluetooth wireless streaming music with remote control capabilities. When remote control capabilities are available, music control buttons are lit.



Tap—skip to next track
Press and hold—fast-forward track

Tap—play/pause music
Press and hold—stop music

Tap—skip to previous track
Press and hold—rewind track

cranking it up

To adjust music volume, use the Volume buttons on your speaker.



When maximum or minimum volume is reached on your speaker, you'll hear a tone.

Note: To achieve desired volume, it may be necessary to adjust the volume on your music player.

handsfree calls

To make and receive calls, the speaker must be turned on, and a Bluetooth handsfree (HFP) connection must be established with your phone (see “connecting wirelessly” on page 6 for details).

You'll use these controls and indicators on your speaker when making and receiving handsfree calls.

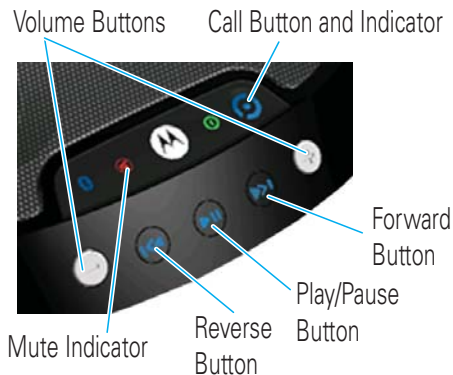

receiving calls

When there's an incoming call, the Call button flashes on your speaker and you hear ringing. If wireless streaming music is playing when a call is received, it is paused until the call ends. If music is playing via wired connection, it is muted when a call is received.

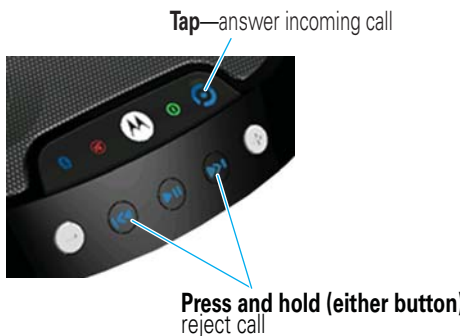

during calls

When a call is active, the Call button is steadily lit on your speaker.

Tap—mute call (mute indicator is lit when mute)

Tap—end call



Tap—adjust volume up/down one step

Press and hold—adjust volume up/down continuously

during calls

When there's a second incoming call, the Call button flashes in blue on your speaker and you hear ringing.

Tap—answer incoming call/
end active call (and resume call on hold)/
resume call on hold (when remote caller hangs up)



Press and hold (either button)—
reject second incoming call

making calls

To make a call, you redial the last dialed number or make a voice dial call (if your phone supports this feature). When making a voice dial call, the microphone on the speaker is enabled and you hear a prompt from your phone.

Tap—make a voice dial call (you hear prompt from your phone)

Press and hold—redial last number



TBD

TBD

European Union Directives Conformance Statement



Hereby, Motorola declares that this product is in compliance with:

- The essential requirements and other relevant provisions of Directive 1999/5/EC.
- All other relevant EU Directives.

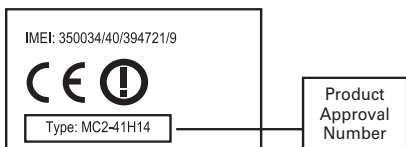

The above gives an example of a typical Product Approval Number.

You can view your product's Declaration of Conformity (DoC) to Directive 1999/5/EC (to R&TTE Directive) at www.motorola.com/rtte. To find your DoC, enter the product Approval Number from your product's label in the "Search" bar on the web site.

Motorola, Inc.
Consumer Advocacy Office
1307 East Algonquin Road
Schaumburg, IL 60196

www.hellomoto.com

www.hellomoto.com/Bluetoothsupport

1-877-MOTOBLU (Motorola Bluetooth Support)

1-800-331-6456 (United States)

1-888-390-6456 (TTY/TDD United States for hearing impaired)

1-800-461-4575 (Canada)

The use of wireless devices and their accessories may be prohibited or restricted in certain areas. Always obey the laws and regulations on the use of these products. MOTOROLA and the Stylized M Logo are registered in the US Patent & Trademark Office. JBL is a registered trademark of Harman International Industries, Incorporated. The Bluetooth trademarks are owned by their proprietor and used by Motorola, Inc. under license. All other product and service names are the property of their respective owners.

© Motorola, Inc. 2007.

Manual Number: 6809517A58-X