



# MOTOPURE™ Hxx (Shasta)

## Getting Started Guide

Motorola, Inc.  
Consumer Advocacy Office  
1307 East Algonquin Road  
Schaumburg, IL 60196

www.motorola.com  
1-877-MOTOBLU  
1-888-390-6456 (TTY/TDD United States for hearing impaired)

Guide Number: 68000201945-A (DRAFT 1)

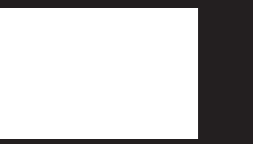

Bluetooth QD ID: Bxxxxxx  
MOTOROLA and the Stylized M Logo are registered in the US Patent & Trademark Office. The use of wireless devices and their accessories may be prohibited or restricted in certain areas. Always obey the laws and regulations on the use of these products. The Bluetooth trademarks are owned by their proprietor and used by Motorola, Inc. under license. All other product or service names are the property of their respective owners.

### congratulations!

Congratulations on your purchase of the cool MOTOPURE™ Hxx Bluetooth® Handsfree Headset. Instead of traditional microphone technology, your MOTOPURE™ Hxx captures bone vibrations in the ear canal when you talk and transforms them into audible sound while reducing background noises in the environment.

Whether you use one or two phones, the MOTOPURE™ Hxx can also connect to both simultaneously. With the use of voice prompts, operating your headset is easy.

First follow the easy steps in this guide to get your handsfree headset charged and talking to your phone. Then learn how to wear and use your handsfree headset with this handy guide that's easy to take along with you.

If you'd like even more information about how to use your new MOTOPURE™ Hxx Bluetooth® Handsfree Headset, visit [www.motorola.com/Bluetoothsupport](http://www.motorola.com/Bluetoothsupport).

So, let's go!

**Caution:** Before using your headset, read the important safety and legal information pamphlet and follow its instructions.

### your headset



### put it on

#### choose an ear

Your headset comes ready for the right ear. To change for the left ear:

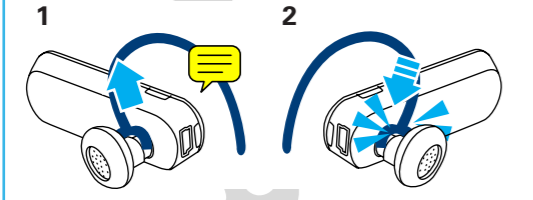

#### wear it

- 1 Insert headset earpiece into your ear canal.

- 2 Ensure bone conduction microphone is in contact with your ear canal.



- 3 Flex the ear hook and loop it over your ear.

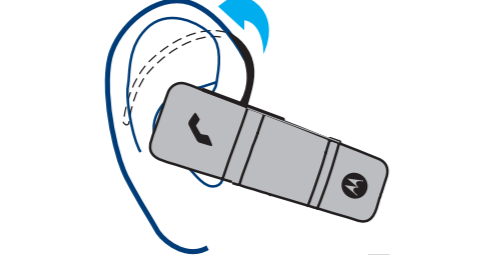

**Tip:** For optimal audio performance and comfort, be sure to point the headset as shown.

### charge it

You'll need to charge your headset before using it. Plug the charger into the charging port on your headset and a wall outlet.



The indicator light will turn red or yellow while charging. When the battery is fully charged, the indicator light turns green.

Disconnect the headset from your charger when charging is complete.

**Note:** Your battery is designed to last the life of your headset. It should only be removed by a recycling facility. Any attempt to remove or replace your battery will damage your headset.

### pair & connect

Once charged, get your headset connected to up to two phones.

#### connect with your first phone "phone 1"

- 1 Turn off any Bluetooth devices previously paired (linked) with your headset.
- 2 Turn on the Bluetooth feature on your phone.
- 3 Turn on your headset by sliding the Power switch to ON (orange not showing). The indicator light becomes steadily lit in blue and you hear "ready to pair".

When your headset successfully pairs with your phone, you hear "pairing complete". When connected, you hear "phone 1 connected" and see the indicator light rapidly flash in red and purple.

#### connect with your second phone "phone 2" (optional)

- 1 Turn off first phone and any other Bluetooth devices previously paired (linked) with your headset.
- 2 Turn your headset off by sliding the Power switch to OFF (orange showing).
- 3 Turn on the Bluetooth feature on your phone.
- 4 Turn on your headset by sliding the Power switch to ON (orange not showing). The indicator light becomes steadily lit in blue.
- 5 Follow voice prompts to connect your phone to your headset.

When your headset successfully pairs and connects with your phone, you hear "pairing complete". When connected, you hear "phone 2 connected" and see the indicator light rapidly flash in red and purple.

#### am i connected?

To confirm connection to your phones:

- 1 Place the headset over your ear (see "put it on" for help).
- 2 One phone at a time, dial the number you want to call and press Call or Send key on your phone.

If your phone and headset are successfully paired, you will hear ringing on the headset.

#### will I need to do this every time?

No. After initially pairing your phone(s) and headset, you don't need to do it again.

For daily use, just make sure that your headset is ON and that your phone's Bluetooth feature is ON. Your headset and phone will connect automatically!

### problems?

#### My headset will not enter pairing mode.

Make sure that any devices previously paired with your headset are turned off. If the indicator light is flashing in blue, first turn off the other device, then turn the headset off and on. The indicator light becomes steadily lit in blue and you hear "ready to pair".

#### My phone doesn't find my headset when searching.

Make sure the indicator light on your headset is steadily lit in blue when your phone is searching for devices. If not, press and hold the Call button and both Volume buttons until you hear "ready to pair" and see the indicator light steadily lit in blue.

#### My headset will not pair with my phone.

If the indicator light is not steadily lit in blue when your phone is searching for your headset, you can reset the headset by pressing and holding the Call button and both Volume buttons until the indicator

light is steadily lit in blue. Then follow the pair & connect instructions in this guide.

#### My headset connected before, but now it's not.

Make sure the indicator light on your phone is searching for devices. If not, press and hold the Call and both Volume buttons until you hear "ready to pair" and see the indicator light steadily lit in blue.

**Support.** If you need more help, contact us at 1-877-MOTOBLU or visit us at [www.motorola.com/Bluetoothsupport](http://www.motorola.com/Bluetoothsupport).

### basics

#### turn on & off

Slide the Power switch. When the headset is turned on, no orange is shown under the switch.

#### check battery level

Press both Volume buttons while not on a call.

indicator light	voice prompt	available talk time
Red	"battery level is low"	less than 2 hours
Yellow	"battery level is medium"	between 2 and 4.5 hours
Green	"battery level is high"	more than 4.5 hours

#### turn voice prompts on & off

Press either Volume button and the Call button while not on a call. You hear the current voice prompt status ("voice prompt on" or "voice prompt off").

### receive calls

When you receive a call, the indicator light flashes in blue (for phone 1) or purple (for phone 2), and you hear call on phone 1 (or "phone 2") and a ringtone over your headset.

#### answer a call

Press the Call button.

#### reject a call

Press and hold either Volume button. You hear "call ignored".

### make calls

#### make a voice dial call

Press the Call button and you hear "voice dial". You are prompted on how to make the call:

- "press Call button for phone 1"
- "press Call button and either Volume button for phone 2"

- 2 Press the button(s) as prompted. For phone 2, make sure to press the Call button and either Volume button at the same time.

- 3 After the tone, clearly speak the name of the contact you want to call.

#### redial last call

Press and hold the Call button and you hear "last number redial". You are prompted how to make the call:

- "press Call button for phone 1"
- "press Call button and either Volume button for phone 2"

- 2 Press the button(s) as prompted. For phone 2, make sure to press the Call button and either Volume button at the same time.

### while on a call

#### mute & unmute a call

Press and hold both Volume buttons until you hear "mute on" or "mute off".

#### end a call

Press the Call button. If a call is on hold, you hear "phone 1 (or "phone 2") audio retrieved" and the call is reconnected to your headset.

#### second incoming call

- To answer, press the Call button. You hear "phone 1 (or "phone 2") audio placed on hold" and the active call is placed on hold.
- To ignore, press and hold either Volume button until you hear a tone.
- To retrieve a call on hold, press the Call button. You hear "retrieve held call", then "press Call button for phone 1" and "press Call button and either Volume button for phone 2". Press the button(s) as prompted. For phone 2, make sure to press the Call button and either Volume button at the same time.

#### turn bone conduction feature on & off

Press Noise Reduction button while on a call. You hear the current feature status ("bone conduction on" or "bone conduction off").

### headset status

indicator light	status
Off	Power off
Three blue flashes	Powering on/off
Steady blue	Pairing mode
Quick blue flash	Incoming call on phone 1
Quick purple flash	Incoming call on phone 2
Slow blue pulse	On a call
Slow blue flash	Standby (connected to one phone)
Slow green flash	Standby (connected to two phones)
Slow red flash	Idle (not connected to any phone)
Slow purple pulse	Call muted
Quick red flash	Low battery





MOTOPURE™  
Hxx (Shasta)

Getting Started Guide

Motorola, Inc.  
Consumer Advocacy Office  
1307 East Algonquin Road  
Schaumburg, IL 60196

www.motorola.com  
1-877-MOTOBLU  
1-888-390-6456 (TTY/TDD United States for  
hearing impaired)

Guide Number: 68000201945-A (DRAFT 1)



Bluetooth QD ID: Bxxxxx

MOTOROLA and the Stylized M Logo are registered in the US  
Patent & Trademark Office. The use of wireless devices and their  
accessories may be prohibited or restricted in certain areas.  
Always obey the laws and regulations on the use of these  
products. The Bluetooth trademarks are owned by their  
proprietor and used by Motorola, Inc. under license. All other  
product or service names are the property of their respective  
owners.

© 2009 Motorola, Inc. All rights reserved.



congratulations!

your headset

DRAFT

DRAFT

charge it

DRAFT

pair & connect

DRAFT

DRAFT

DRAFT

problems?

DRAFT

DRAFT

put it on

DRAFT

DRAFT

basics

DRAFT

receive calls

DRAFT

make calls

DRAFT

while on a call

DRAFT

headset status

DRAFT

DRAFT

DRAFT

## **FCC statement in User's Manual (for class B)**

### **"Federal Communications Commission (FCC) Statement**

This Equipment has been tested and found to comply with the limits for a class B digital device, pursuant to Part 15 of the FCC rules. These limits are designed to provide reasonable protection against harmful interference in a residential installation. This equipment generates, uses and can radiate radio frequency energy and, if not installed and used in accordance with the instructions, may cause harmful interference to radio communications. However, there is no guarantee that interference will not occur in a particular installation. If this equipment does cause harmful interference to radio or television reception, which can be determined by turning the equipment off and on, the user is encouraged to try to correct the interference by one or more of the following measures:

- Reorient or relocate the receiving antenna.
- Increase the separation between the equipment and receiver.
- Connect the equipment into an outlet on a circuit different from that to which the receiver is connected.
- Consult the dealer or an experienced radio/TV technician for help.

### FCC Caution:

1. The device complies with Part 15 of the FCC rules. Operation is subject to the following two conditions:
  - (1) This device may not cause harmful interference, and
  - (2) this device must accept any interference received, including interference that may cause undesired operation.
  
2. This device and its antenna(s) must not be co-located or operating in conjunction with any other antenna or transmitter.
  
3. Changes or modifications to this unit not expressly approved by the party responsible for compliance could void the user authority to operate the equipment.