

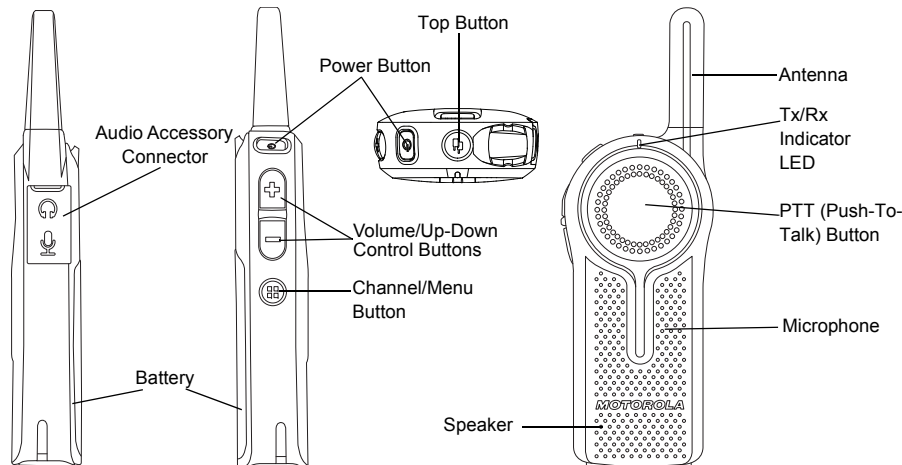

QUICK REFERENCE GUIDE DLR SERIES TWO-WAY RADIO



Congratulations on your new Digital Radio!

Please fully charge the battery before first use.
Refer to www.motorolasolutions.com/DLR for information on product details, brochures, CPS software and approved accessories.

A GETTING STARTED

1. INSTALL THE BATTERY

- Slide the latch at the top of the battery door to the unlock position and lift up the battery door at the center recess.
- Align the battery contacts with the tabs in the battery compartment. Insert the contact side of the battery first, then press the battery down to secure in place.
- Put the battery door back on the radio. Slide the latch to the lock position .

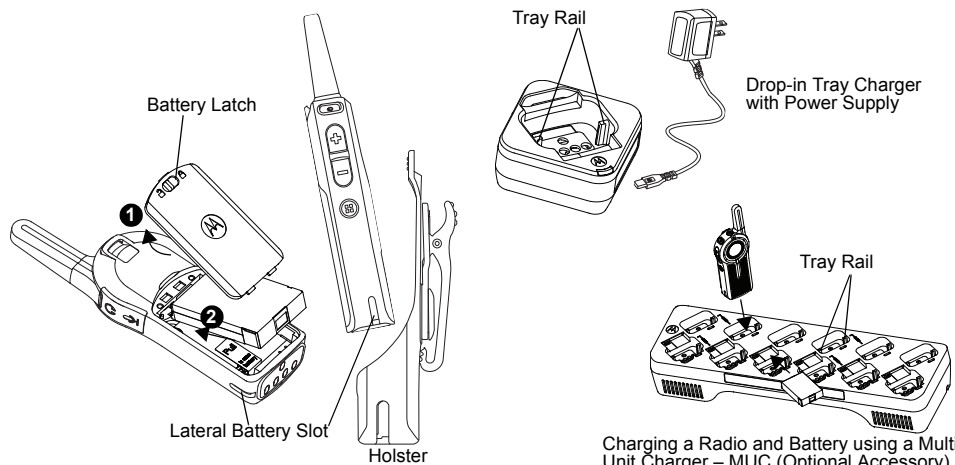

2. CHARGE THE BATTERY

- Connect the power supply to the drop-in charger tray or a power cord to the multi-unit charger and insert the radio into the tray, make sure that the lateral battery slots are inserted in the tray rails. The charger LED flashes a few times (to indicate the current battery charge) when the radio is inserted into the charger. The light on the charger is

RED when the radio is charging. It turns to GREEN once the radio is fully charged (Fast blinking RED LED indicates a fault condition).

3. TURN THE RADIO ON/OFF

- To turn ON the radio, long press the Power button (~3 seconds) until the radio plays the power up tone and the radio Transmit/Receive (Tx/Rx) Indicator LED begins to blink. To turn the radio OFF, long press and hold the Power button until the radio Tx/Rx Indicator LED turns OFF and power down tone is heard.

Tip: Every time the radio powers ON, a voice prompt announces the current channel and battery level.

IMPORTANT!

NON-INTERFERENCE/PRIVACY FEATURE

The DLR Series provides an easy way to ensure non-interference and improved private communications. Follow the simple steps below to select your own 4 digit radio **PROFILE ID Number** (different from the default "0000"). Make sure ALL your radios are configured with the same number.

- With the radio turned OFF, **Hold down PTT, (+) and Power buttons** at the same time until you hear the radio power up and announces "**Programming Mode**".
- Press **Channel/Menu** button and you will hear "**Current PROFILE ID <Number>**".
- Use the **(+)** and **(-)** buttons to change each **PROFILE ID digit** and **Menu** to move from one digit to the next.
- Once all **PROFILE ID digits** have been changed, the entire new number will be announced. To exit, **long press the PTT** button.

Important: Make sure ALL your radios are configured with the same PROFILE ID or they will not communicate.

Tip: Select a PROFILE ID that is easy to remember, for example a store number or street address number. For more information, refer to the User Guide full instructions posted in www.motorolasolutions.com/DLR.

B TRANSMITTING AND RECEIVING

- Press the **(+)** button to increase the volume, or the **(-)** button to decrease the volume.
- To receive, listen through the speaker. To respond, press **FIRMLY** the PTT (Push to Talk) and **WAIT** to hear the **Talk Permit Tone** (a quick double beep) **BEFORE** you start speaking. Hold the radio vertically 1 to 2 inches (2.5cm to 5cm) from mouth when talking. Release the PTT to listen.
- The RED Tx/Rx Indicator blinks slowly when on standby. When the radio is transmitting, the Tx/Rx Indicator is solid RED.
- When the radio is receiving, the RED Tx/Rx Indicator LED blinks quickly.

C HOW TO CHANGE CHANNELS

To change channel, press the Channel/Menu Button. The radio announces the current channel. Press **(+)** or **(-)** button to change the channel. The radios will guide you through the channel changes with voice prompts. Short press PTT to exit.

Tip: It is not necessary to wait for the voice prompt to be completed before continuing with next button press.

D BATTERY STATUS

Short press the Power Button to check battery status.

E PRIVATE REPLY

The Top Button is set to Private Reply Feature by default. Press the Top Button to reply privately to the person currently talking to a group (Top button LED will blink ORANGE). Once the person finishes transmitting, press the PTT button to talk one-on-one (the Top Button LED will illuminate solid ORANGE). Both parties will hear voice prompts to announce the beginning and end of the private transmission. Once the private conversation is over, the Top Button LED will be OFF.

Important: The radio times out Private transmissions after 10 seconds of inactivity.

Tip: If you want to talk privately to someone, simply call the name of the person. When the person responds, press the Top Button and then press the PTT button to talk privately.

F ADVANCED CONFIGURATION MODE/OTHER FEATURES

DLR Series allows for other special features (like Radio PROFILE ID, Maximum Channels, Top Button programming, Home Channel and Instant Mute) through Advanced Configuration Mode. To enter this mode, Power Up while pressing the PTT and **(+)** buttons and voice prompts will guide you. For more details go to www.motorolasolutions.com/DLR.

For product-related questions, please call: 1-800-448-6686.

ATTENTION!

Before using this product, read the RF Energy awareness and Acoustic Safety information and operating instructions contained in the Safety and RF Energy Exposure Booklet enclosed with your radio package.

This device complies with Part 15 of the FCC rules and Industry Canada's license-exempt RSS's per following conditions:--(1) This device may not cause harmful interference (2) This device must accept any interference received, including interference that may cause undesired operation (3) Changes or modifications made to this device, not expressly approved by Motorola, could void the authority of the user to operate this equipment

DLR Series operates in the license-free 900 MHz ISM Band (902 – 928 MHz).

The AMBE+2™ voice compression software included in this product is protected by intellectual property rights including patent rights, copyrights and trade secrets of Digital Voice Systems, Inc. This voice compression technology is licensed solely for use as is within the Communications Equipment. US Patent Nos.: #8,595,002 B2, #8,359,197, #8,315,860, #8,200,497, #7,970,606, #6,912,495 B2, #6,199,037 B1, #5,826,222, #5,754,974, #5,701,390, and #5,715,365.

MOTOROLA, MOTO, MOTOROLA SOLUTIONS and the Stylized M logo are trademarks or registered trademarks of Motorola Trademark Holdings, LLC and are used under license. All other trademarks are the property of their respective owners.

© 2015 Motorola Solutions, Inc.
All rights reserved.
Printed in China



MN001133A01-AD