



Mission Critical Wireless RCU Key Fob PMLN6233



68012007013-B

EN

MOTOROLA, MOTO, MOTOROLA SOLUTIONS and the Stylized M Logo are trademarks or registered trademarks of Motorola Trademark Holdings, LLC and are used under license. All other trademarks are the property of their respective owners. © 2012 Motorola Solutions, Inc. All rights reserved.



FOREWORD

Product Safety and RF Exposure Compliance

Caution Before using this product, read the operating instructions for safe usage contained in the Product Safety and RF Exposure booklet enclosed with your radio.

ATTENTION!

The radio is restricted to occupational use only to satisfy ICNIRP/FCC RF energy exposure requirements. Before using this product, read the RF energy awareness information and operating instructions in the Product Safety and RF Exposure booklet enclosed with your radio (Motorola Publication part number 6881095C98 (US) or 6864117B25 (EMEA)) to ensure compliance with RF energy exposure limits.

This device complies with part 15 of the FCC Rules and Industry Canada licence-exempt RSS standard(s). Operation is subject to the following two conditions: (1) this device may not cause interference, and (2) this device must accept any interference, including interference that may cause undesired operation of the device.

Le présent appareil est conforme aux CNR d'Industrie Canada applicables aux appareils radio exempts de licence. L'exploitation est autorisée aux deux conditions suivantes: (1) l'appareil ne doit pas produire de brouillage, et (2) l'utilisateur de l'appareil doit accepter tout brouillage radioélectrique subi, même si le brouillage est susceptible d'en compromettre le fonctionnement.

Any changes or modifications not expressly approved by Motorola may void the user's authority to operate this device.

Battery Information:

Battery is shipped with a nominal charge between 30% and 50%. Battery should be stored between -10 °C (14 °F) and 30 °C (86 °F) to minimize permanent capacity loss.

Caution: Storing your fully charged accessory in high-temperature conditions may permanently reduce the life of the internal battery.

Note: The battery is not a user replaceable part.

Important Information:

- Do not charge your accessory in temperatures below 0 °C (32 °F) or above 45 °C (113 °F). Do not store your accessory in direct sunlight or where expected temperatures can exceed this range such as inside a parked car.
- Storing your fully charged accessory in high-temperature conditions may permanently reduce the life of the internal battery. Battery life may temporarily shorten in low-temperature conditions.

INTRODUCTION

The PMLN6233 Mission Critical Wireless RCU Key Fob is compatible with APX 2000, 3000, 4000, 5000, 6000, 7000 radios with firmware SR7.13 and above. Refer to the APX radio's user manual for approved body-worn accessories.

KEY FOB OVERVIEW

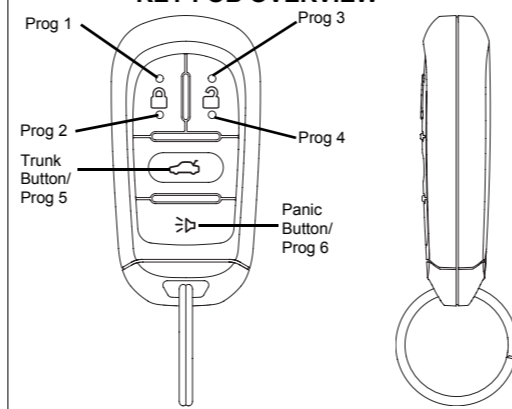

CAP OPENING/CLOSING

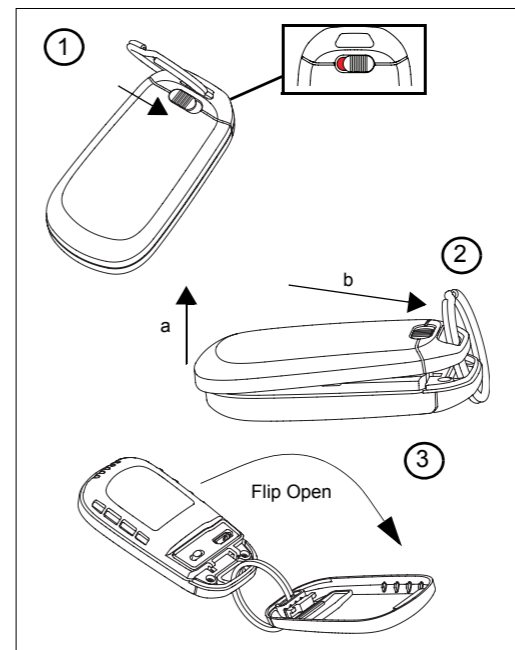

INTERNAL FEATURE LAYOUT

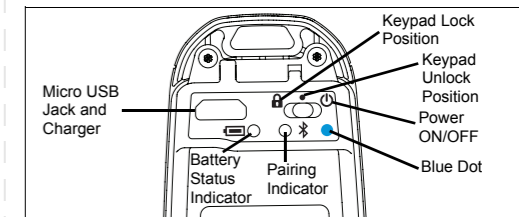

CHARGING YOUR KEY FOB

Charge key fob 3 hours before using.

State	LED Indication
Low Charge	Red LED
90% Charge	Green LED with 90% indicator
Full Charge	Green LED

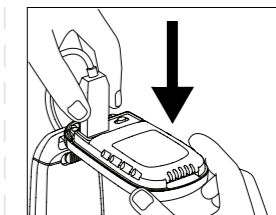

Note: Key fob should be switched off during charging operations. Use only Motorola-approved supplied charger.

POWERING ON KEY FOB

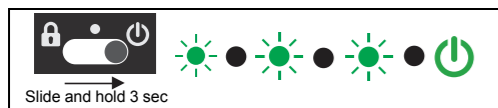

POWERING OFF KEY FOB

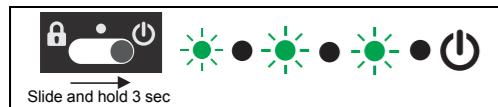

PAIRING YOUR KEY FOB

First time connection steps:

- Verify that both the radio and the key fob are powered ON and in pairing mode.
- To enter pairing mode on the key fob, press and hold the Trunk button while powering up the key fob.
- Place the Blue Dot (touch pairing spot) of the key fob on the Blue Dot on the radio.
- Wireless Link Connected with radio indication is provided upon successful link establishment (refer to Subsequent Connection table).
- Your key fob is now ready to be used.

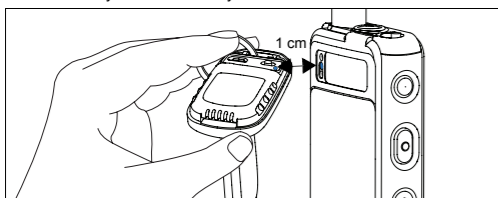

SUBSEQUENT CONNECTION

Same Radio:

If the Bluetooth link is lost, connection will be automatically re-established when the radio and key fob come within range. The minimum line-of-sight range for the key fob is 30 feet. However, the body tends to obstruct the signal, therefore the normal usage range is 6 feet around your body.

New Radio:

Put the key fob in Pairing Mode by powering ON while pressing Trunk button simultaneously. Follow steps from Pairing Your Key Fob.

State	LED Indication
Not Paired	Blue LED 1000 ms on, 100 ms off
Paired Successfully	Blue LED 2 sec
Wireless Link Connected with Radio	Blue LED 50 ms on, 4000 ms off
Wireless Link Disconnected from Radio	Blue LED 2 sec

PROGRAMMABLE BUTTON CONTROL

Refer radio CPS for button assignment. Once the key fob connects with the Radio, the Programmable Button will operate as defined in the radio CPS setting.

SURVEILLANCE MODE (DARK MODE)

After Connection with the Radio, if the Radio is in the Surveillance Mode the key fob shall also enter Surveillance Mode.

- The key fob will display LED indication before it gets Connected to the Radio and will enter Surveillance Mode 20 seconds after connection is established.
- The key fob will not show LED indication on Link Lost if Radio is in Surveillance Mode.

FEATURE LOCK

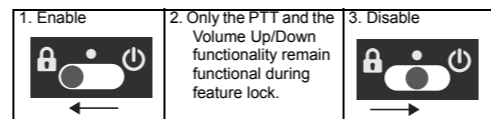

BATTERY ALERTS

State	LED Indication	Remaining Battery Life
10% Charge	Red LED 50 ms on, 4000 ms off	30 minutes
3% Charge	Red LED 100 ms on, 200 ms off	5 minutes

ERROR INDICATOR



TROUBLESHOOTING

If at any time the wireless connection cannot be re-established, or the key fob is operating incorrectly:

- Power Cycle the key fob and the radio. The connection should re-establish.
- If the problem continues; Refer to Pairing Your Key Fob to repeat the connection process.

REPLACEMENT PART

The following replacement part is available for the PMLN6233 Mission Critical Wireless RCU Key Fob:

Part Number	Description
PMLN6475_	ASSY, BACK COVER

Please contact your local Motorola Representative or Dealer for details.

SOFTWARE UPGRADES

Please go to the respective regional MOL links below:

- EMEA - <https://emeaonline.motorola.com>
- LACR/NA - <https://motonline.mot.com>
- APAC - <https://asiaonline.mot.com>

OPEN SOURCE SOFTWARE LEGAL NOTICES

This Motorola Product contains Open Source Software. For information regarding licenses, acknowledgements, required copyright notices, and other usage terms, refer to the documentation for this Motorola Product at the respective regional MOL links as above.

SUPPORT

Please contact Motorola Customer Care at 1-800-422-4210 (US only), +44 2030277499 (EMEA), (5) 257-6700, (571) 602-1111 (LACR) or 1-800-88-0089 (APAC); for ordering or any technical troubleshooting assistance.

WARRANTY

Motorola offers a standard one year warranty. Contact your Motorola dealer for detailed information on the standard warranty. **Note:** Warranty is void after customer replacement of any parts other than replacement parts listed.

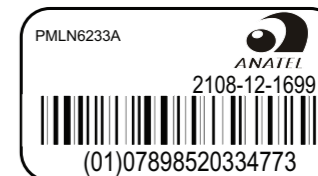

This equipment operates as a secondary user, so it is not entitled to protection from harmful interference, even if generated by similar equipment, and it may not cause harmful interference on systems operating as primary users.