



MOTOROLA

Start Here >>>

MOTOSTART

H500

Bluetooth®

Handsfree Headset

**Get Connected in
4 Quick Steps**

- 1 - CHARGE**
- 2 - START
BLUETOOTH
FEATURE**
- 3 - PAIR**
- 4 - TEST AND USE**



BEFORE YOU BEGIN



Before using this product, read the Important Safety and Legal Information pamphlet and follow its instructions.

Take a moment before you get started to familiarize yourself with your new H500 Handsfree Headset.

Earhook

Volume Buttons

Call Button

Blue Indicator Light

Microphone



1



CHARGE

Your Headset's Battery

Charge your headset's battery for 2 hours:



- 1** Plug the Motorola charger into the end of the headset.

The blue indicator light turns on when the battery is charging. It may take up to 1 minute for the light to turn on. When the headset's battery is fully charged (about 2 hours), the blue indicator light turns off.

- 2** Unplug the charger from the headset.

Note: Headset is not functional while charging.

2



START BLUETOOTH

Feature On Your Phone

Your phone's Bluetooth feature is off by default. To use your headset, turn on the Bluetooth feature in your phone.

For most Motorola phones:

- 1 Select  (**Menu**) > **Settings** > **Connection** > **Bluetooth Link** > **Setup**.
- 2 Scroll to **Power**.
- 3 Press **Change**.
- 4 Scroll to **On**.
- 5 Press **Select** to turn on the Bluetooth feature. Bluetooth feature remains on until you turn it off.

Note: These steps are for most Motorola phones. For other phones, see your phone's user's guide.

TROUBLESHOOTING

My phone does not find my headset.

Make sure the blue light on your headset is steadily lit when your phone is searching for devices (see step 3).

My headset worked before but now it's not working.

Make sure your phone is on and the Bluetooth feature is turned on in your phone (see step 2). If the Bluetooth feature has been turned off or was turned on only temporarily, you may need to restart the Bluetooth feature (see step 2). If you have confirmed the Bluetooth feature is on in your phone, pair your phone and headset again (see step 3).

Support.

If you need more help, contact us at

1-877-MOTOBLU or visit us at

www.hellomoto.com/bluetooth and click

Support.

Motorola, Inc.
Consumer Advocacy Office
1307 East Algonquin Road
Schaumburg, IL 60196

www.hellomoto.com
1-877-MOTOBLU
1-888-390-6456 (TTY/TDD United States for
hearing impaired)

Guide Number: 6809494A56-C

MOTOROLA and the Stylized M Logo are registered in the US Patent & Trademark Office. The use of wireless devices and their accessories may be prohibited or restricted in certain areas. Always obey the laws and regulations on the use of these products. The Bluetooth trademarks are owned by their proprietor and used by Motorola, Inc. under license. All other product or service names are the property of their respective owners.

© Motorola, Inc. 2006.

3



PAIR Your Headset

Step A - PUT HEADSET IN PAIRING MODE

Before you can use your headset, you must pair (link) it with your phone.

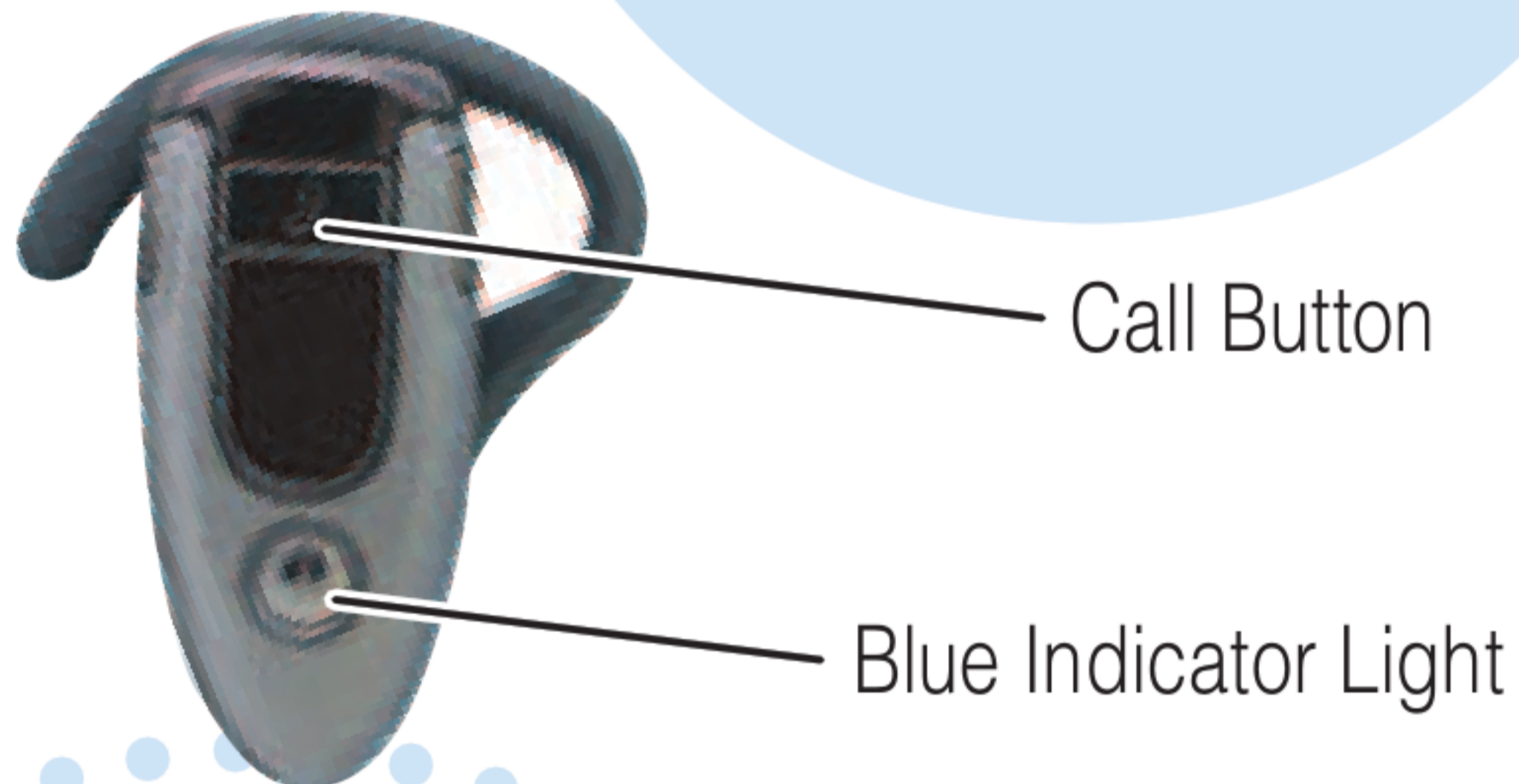

- 1** With the headset power off, press and hold the Call button for 6 to 10 seconds until the blue indicator light turns on and remains steadily lit. (The light will flash while you hold the Call button.)
- 2** If the indicator light is flashing or does not remain steadily lit, turn off the headset and repeat step 1.

Note: To turn off headset, see "Turning On and Off" on the reverse side of this guide.



PAIR

Your Phone

Step B - SET THE PHONE TO LOOK FOR YOUR HEADSET

For most Motorola phones:

- 1 Select  (**Menu**) > **Settings** > **Connection** > **Bluetooth Link** > **Handsfree** > **Look for Devices**.

The phone lists all Bluetooth devices it finds.

- 2 Select **Motorola H500**.
- 3 Press **OK** or **Yes** to pair (link) the handsfree device.
- 4 Enter the passkey **0000** and press **OK**.

Note: Passkey cannot be changed from 0000.

When your headset is successfully paired with your phone, the blue indicator light changes from steadily lit to flashing.

Note: These steps are for most Motorola phones. For other phones, see your phone's user's guide.

4

TEST AND USE

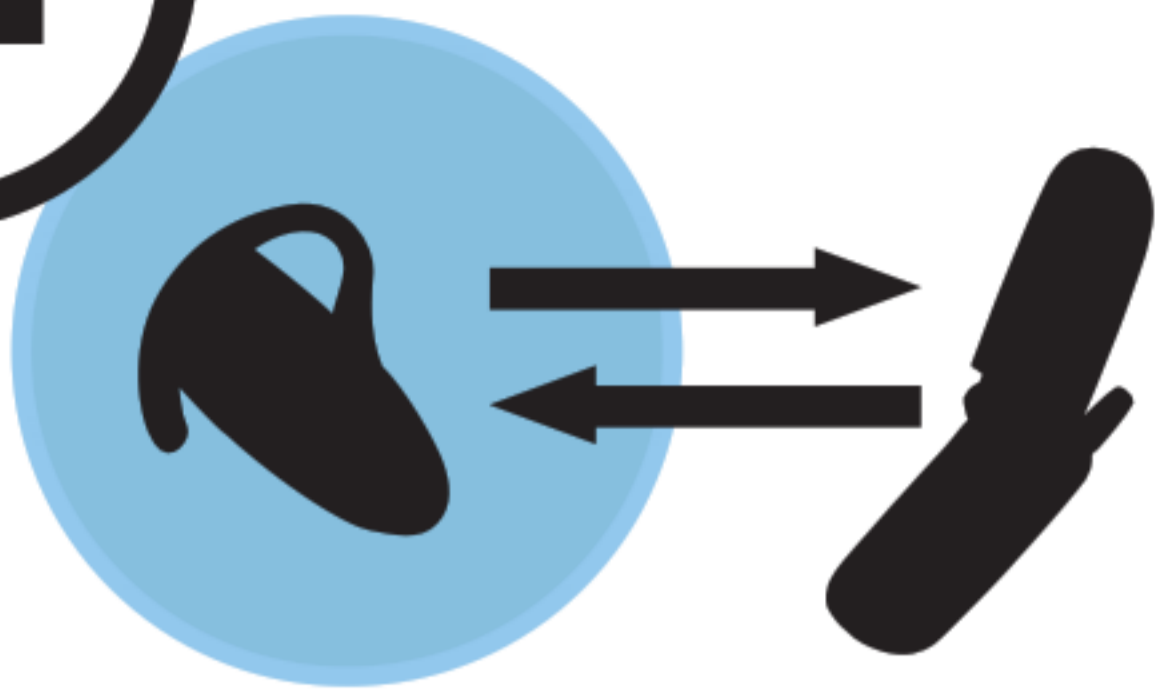

Your phone and headset are now paired and ready to make and receive calls. To confirm they are operating properly, make a call:

- 1** Place the headset over your ear. See "Wearing the Headset" on the reverse side of this guide.
- 2** On your phone, dial the number you want to call and press the **Send** key.
- 3** If your phone and headset are successfully paired, you will hear ringing on the headset.

After you have successfully paired your phone and headset, you do not need to repeat these initial setup steps each time you use the headset.

USING YOUR H500

See **Features and Functions Guide**
on the reverse side
of this guide
for information on
using your H500.



Features and Functions Guide

H500 Bluetooth® Handsfree Headset



IMPORTANT:

Be sure to first follow the

MOTOSTART

Quick Start Guide

on the reverse side
of this guide

to complete initial setup
of your H500.

TURNING HEADSET ON/OFF

To turn your headset on, press and hold the Call button until the indicator light flashes. Then, release the button.

Note: Headset may take up to 4 to 5 seconds to turn on.

To turn your headset off, press and hold the Call button until the indicator light flashes rapidly and then turns off.



Call
Button

WEARING THE HEADSET

- 1** Open the earhook.
- 2** Loop the earhook over your ear.
- 3** Press the headset to your ear.

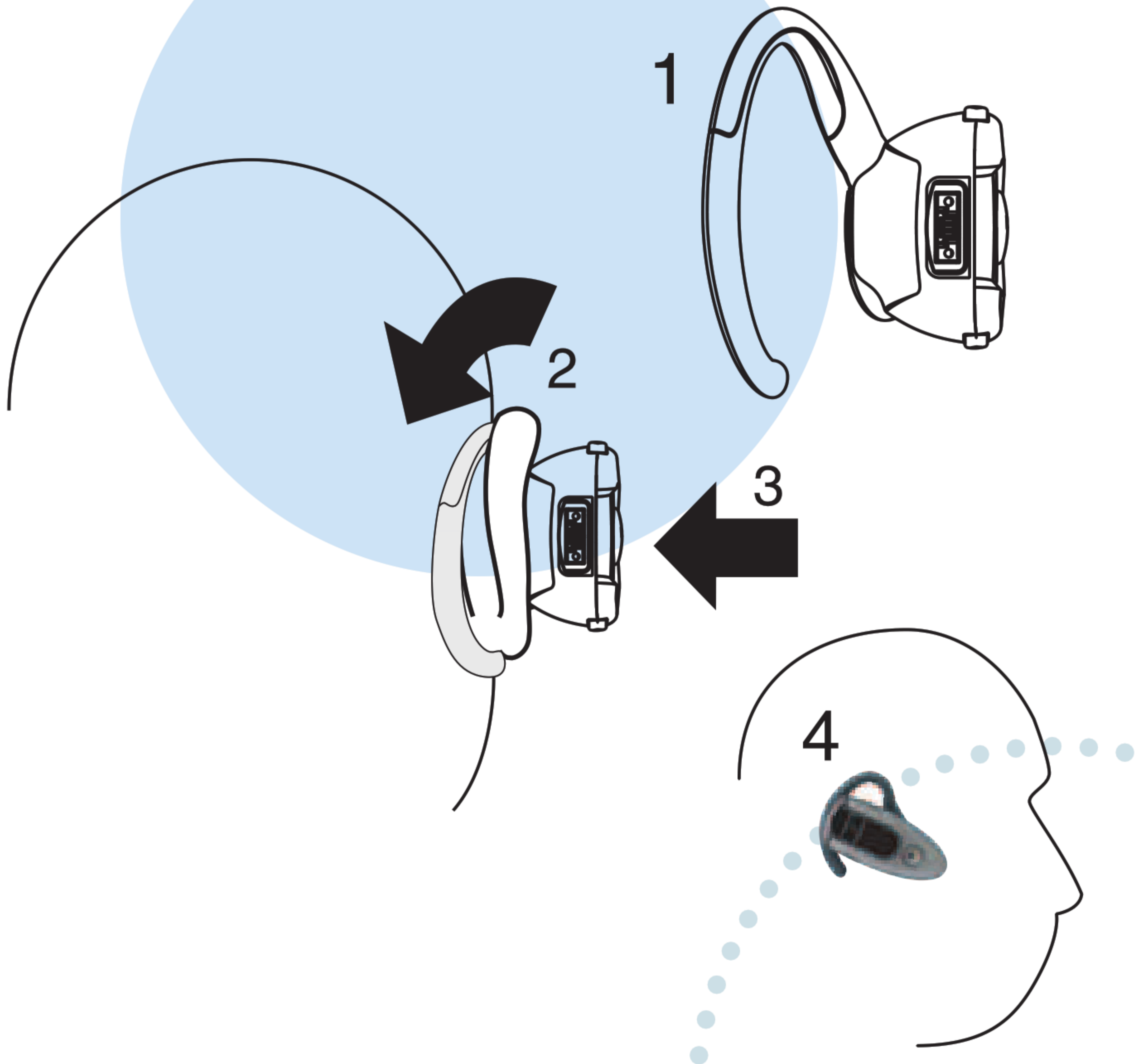

CHANGING FOR USE ON OTHER EAR

You can wear your H500 headset on your left or right ear. The headset comes ready for the right ear. To change the headset for the left ear:

- 1** Open the earhook 90 degrees from the headset.
- 2** Gently lift and pull the top of the earhook up and off the upper hinge pin. Then, pull it away to remove it.
- 3** Flip the headset over.
- 4** Hook the bottom of the earhook onto the lower hinge pin, then lift and pull the top of the earhook over the upper hinge pin.

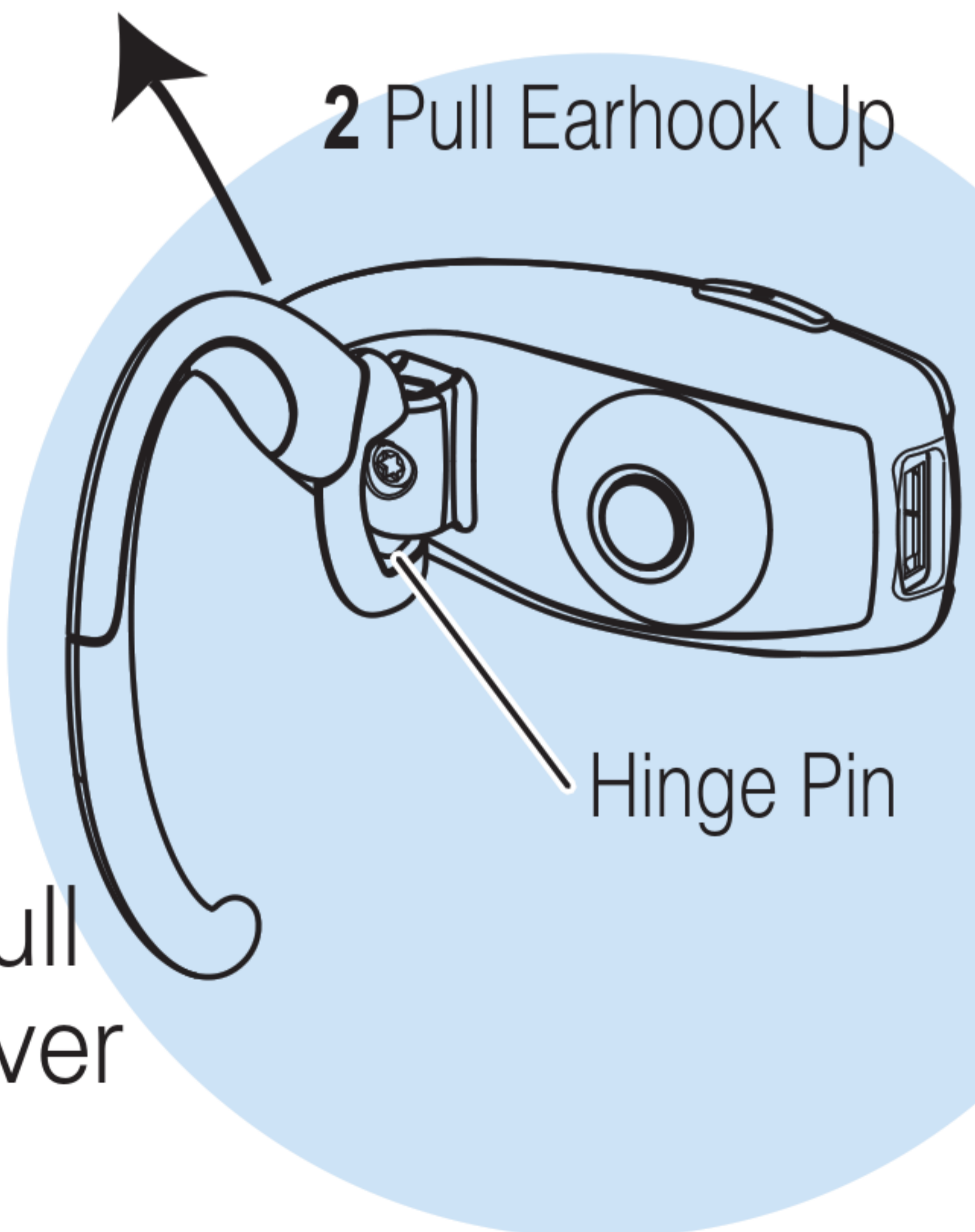
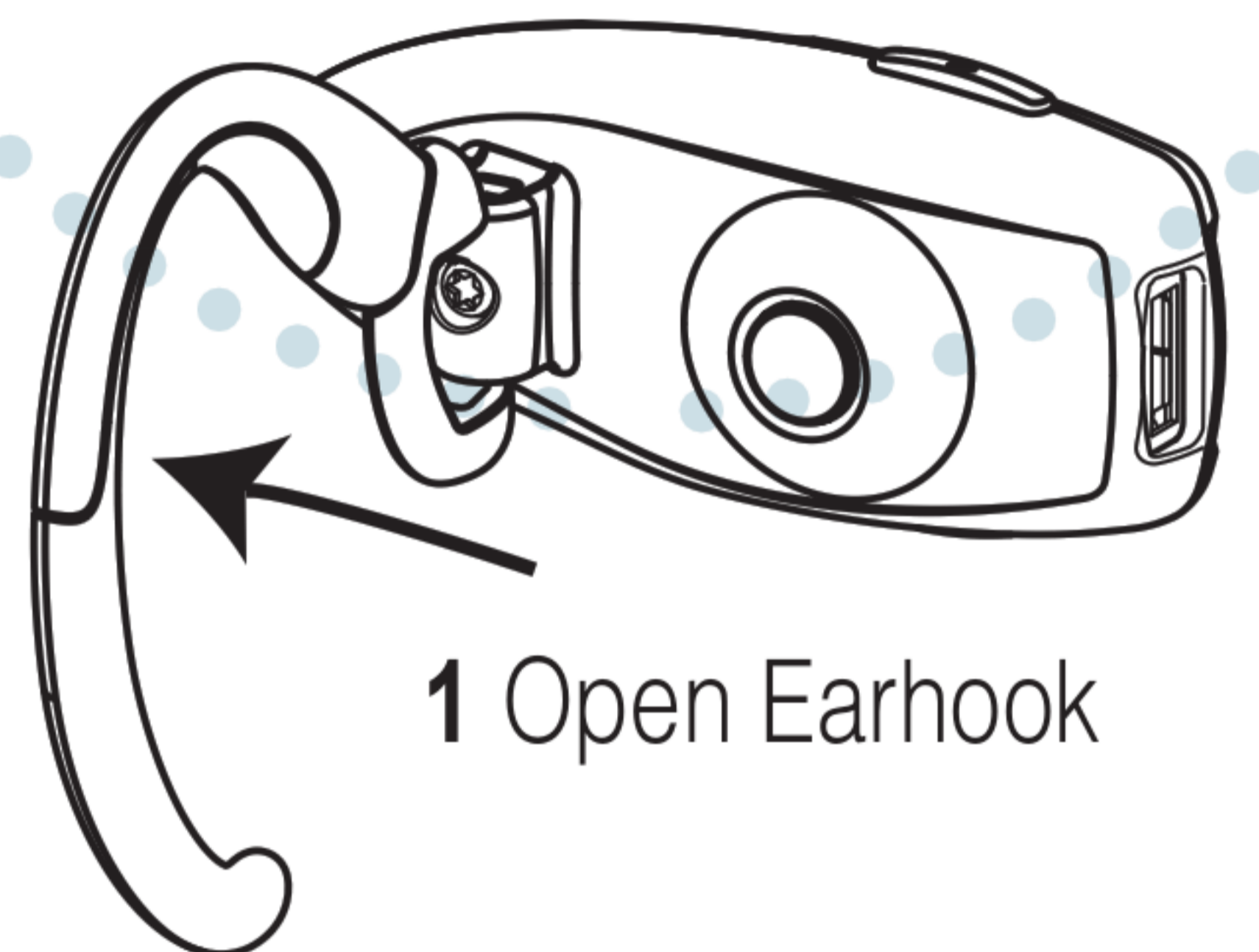

CHANGING VOLUME BUTTON ORIENTATION

If you change your headset to wear on the other ear, you can also change the orientation of the volume buttons.

- 1** Turn the headset power off.
- 2** Press the Call button and the volume button you want to assign as the "volume up" button until the indicator light flashes twice.

The headset power turns on.

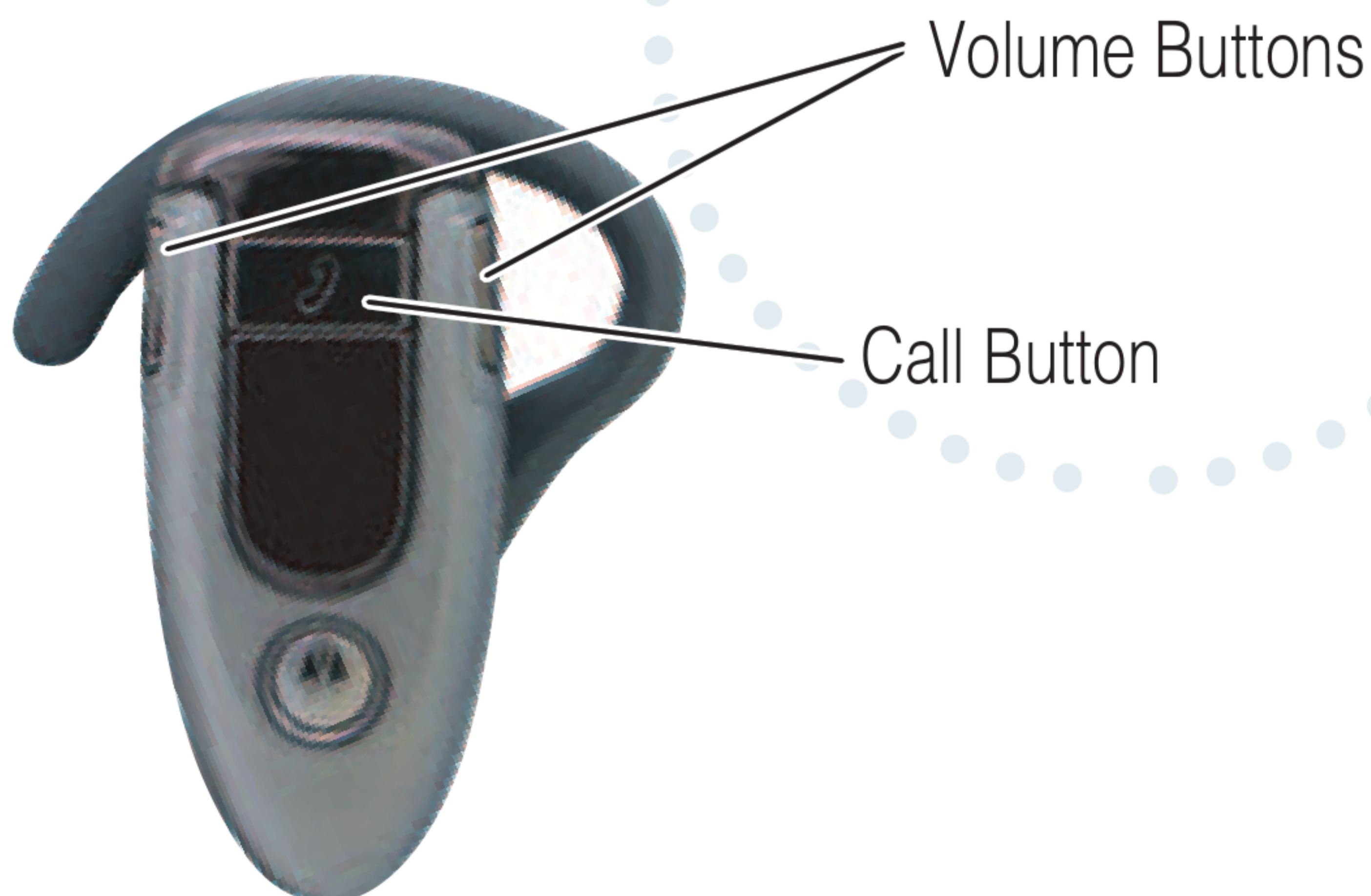

European Union Directives Conformance Statement



Hereby, Motorola declares that this product is in compliance with:

- The essential requirements and other relevant provisions of Directive 1999/5/EC.
- All other relevant EU Directives.

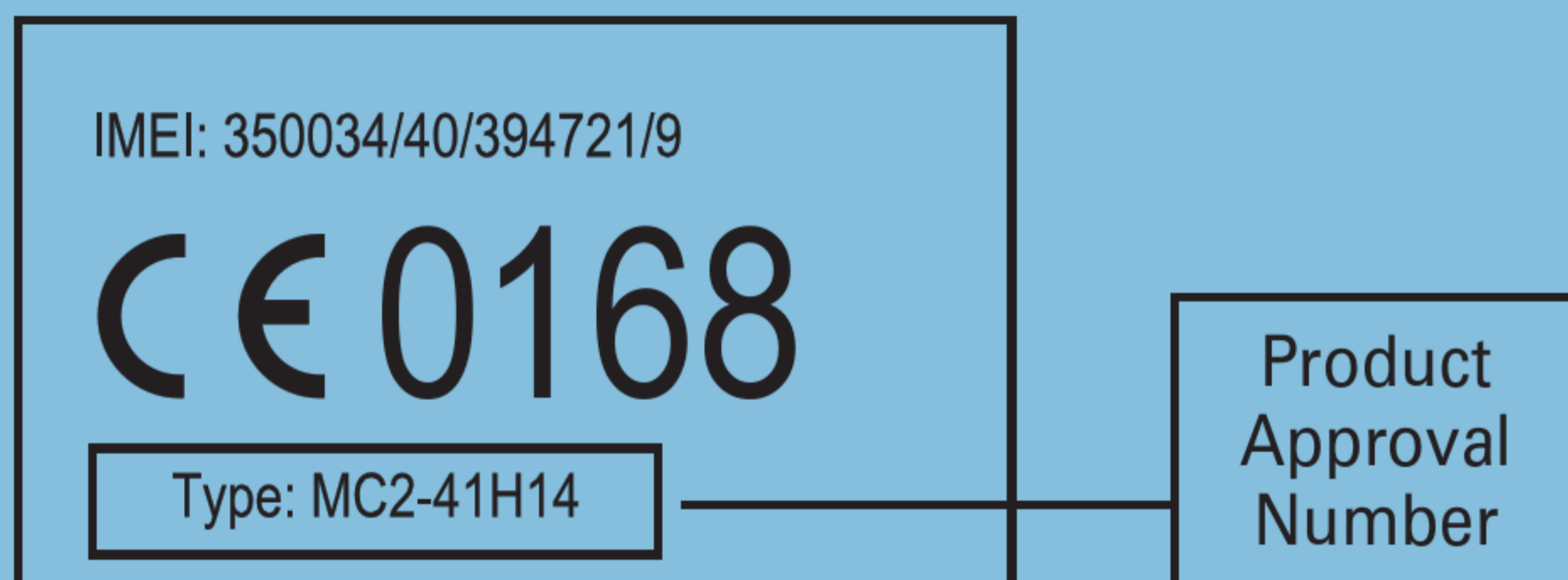

The above gives an example of a typical Product Approval Number.

You can view your product's Declaration of Conformity (DoC) to Directive 1999/5/EC (to R&TTE Directive) at www.motorola.com/rtte. To find your DoC, enter the product Approval Number from your product's label in the "Search" bar on the web site.

MAKING CALLS

Function

Action

Make a voice dial call

Tap the Call button and speak the name after the tone

End a call

Tap the Call button

Receive a call

Tap the Call button

Reject a call

Press and hold the Call button until you hear a beep

Redial last call

Press and hold the Call button until you hear a beep

Answer a second incoming call

Press and hold the Call button (places first call on hold)

Note: Your H500 supports both Handsfree and Headset Profiles. Accessing call functions depends upon which profile your phone supports. See your phone's user's guide for more information.

MAKING CALLS *CONTINUED*

Function	Action
Toggle between two active calls	Press and hold the Call button
Join a 3-way call	Press and hold both Volume buttons
Put an active call on hold or resume a call on hold	Press and hold the Call button until you hear a beep
Disable or enable the indicator light	Press and hold both Volume buttons for 3 to 4 seconds
Mute or unmute a call	Tap both Volume buttons

Note: Some features are phone/network dependent.

INDICATOR LIGHTS

The indicator light provides information about your headset status.

With the Charger Plugged In

Headset Indicator	Headset Status
On (steady)	Charging
Off	Charging complete

With No Charger Plugged In

Headset Indicator	Headset Status
Off	Power off
On (steady)	Pairing mode
10 rapid flashes	Pairing successful
Slow pulse	Connected (on a call)
Quick flash	Standby (not on call)

Note: After 5 minutes of inactivity, the light stops flashing to conserve power, but the headset remains in standby mode.

AUDIO TONES

The audio tones provide information about your headset status.

Audio Tone

Headset Status

Single high tone when pressing volume button

Volume at minimum or maximum

Five rapid high tones repeated every 60 sec.

Low battery

No audio indications; deteriorating quality

Out of range

Ring tone

Incoming call

Single high tone

Pairing confirmation

Single low tone

Voice activation

Dual high/low tone

Voice tag not recognized

Single high tone

End call

Low to high tone

Phone network not available

Two ascending tones

Mute enabled

Two descending tones

Mute disabled