

GBC Cool Touch Laminator

User's Manual



Provided By

MyBinding.com®
When Image Matters.

GBC®

COOL touch™

COLD LAMINATOR

For laminating heat-sensitive materials, inks, photos, and glossy materials. Enhance, protect and preserve any printer output, color copies, photos or other paper materials.

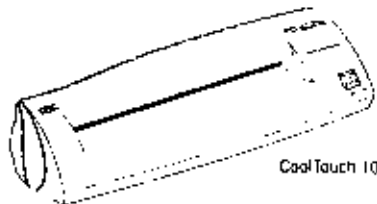
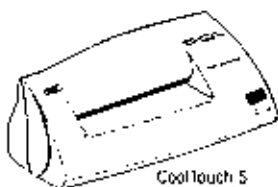

⚠ The safety alert symbol precedes each safety message in this instruction manual. This symbol indicates a potential personal safety hazard that could hurt you or others, as well as cause product or property damage.

⚠ Your safety as well as the safety of others is important to GBC. In this instruction manual and on the product are important safety messages. Read these carefully. The following warning is found on the bottom of the product.



This safety message means that you could be seriously hurt or killed if you open the product and expose yourself to hazardous voltage.

The following symbols appear on this unit



Off



Power

GENERAL SAFEGUARDS

- 1 Use the unit only for its intended purposes.
- 2 Do not place anything in the throat opening of the unit other than pouches/documents.
- 3 Place unit on a secure, stable work area to prevent the unit from falling and possibly causing personal injury and damage to the unit.
- 4 Follow all warnings and instructions marked on the unit.
- 5 This unit has a polarized plug (one blade is wider than the other). To reduce the risk of electrical shock, this plug is intended to fit in a polarized outlet only one way. If the plug does not fit fully in the outlet, reverse the plug. If it still does not fit contact a qualified electrician. Do not modify the plug in any way.
- 6 The socket outlet shall be installed near the equipment and shall be easily accessible.

ELECTRICAL SAFEGUARDS

- 1 The unit must be connected to a supply voltage corresponding to the electrical rating.
- 2 Unplug the unit before moving it, or when it is not in use for an extended period of time.
- 3 Do not operate with a damaged supply cord or plug, if it is damaged, or malfunctions.
- 4 Do not overload electrical outlets beyond their capacity. Fire or electrical shock could result.
- 5 The unit is intended for indoor use only.
- 6 Do not spill liquid of any kind on this product.

CLEANING

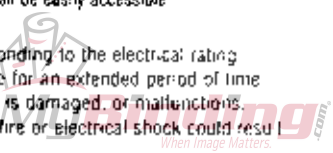

CLEANING

CAUTION: Unplug this unit before cleaning. Wipe exterior only with a damp cloth. Do not use detergents or solvents.

SET-UP AND OPERATION

1. Connect power cord to appropriate power source.
2. Open the CoolTouch™ (No-Heat™) pouch and position the item to be laminated so its backside is against the non-sticky side of the pouch (see Fig. 1).
3. Insert the pouch into the machine and drape the film with the liner over the top of the machine and remove the liner (see Fig. 2).
4. Turn the machine "ON" and insert the pouch until the rollers start to pull the pouch. Hold the film slightly so it does not suddenly drop onto the material being laminated (see Fig. 3).
5. Remove finished document from the rear of the machine.
6. For other CoolTouch™ supplies, please refer to the instructions on that package.

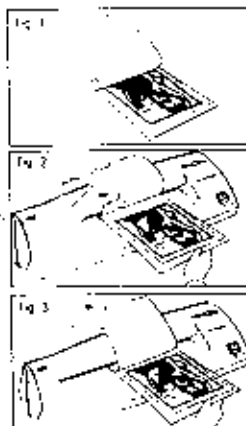

SPECIFICATIONS:	CoolTouch 5	CoolTouch 10
Voltage/Hz	120/60 (230/50)	120/60 (230/50)
Amps*	33mA (17mA)	33mA (17mA)
Watts*	3 (3)	3 (3)