



# SMILE

Portable transmitter  
User manual

NE41 14002-02 v1.0

Draft, not for public use Output date: 2015-12-14

Information in this User manual is subject to change without notice.

NEAT Electronics AB reserves the right to change or improve their products and to make changes to the content without obligation to notify any person or organization of such changes or improvements.

NEAT Electronics AB is not responsible for any loss of data, income or any consequential damage whatsoever caused.

For more information, details and descriptions, visit our web site:

[www.neat-group.com/se/en](http://www.neat-group.com/se/en)

## EU Notes

NEAT Electronics declares that this mobile device, type SMILE, is in compliance with the essential requirements and other relevant provisions:

### Directive:

1999/5/CE (RTTE), 2004/108/EC (EMC), 2006/95/EC (LVD)

### Standards:

EMC:

EN 301 489-1 V1.8.1 (2008)

EN 301 489-3 V1.4.1 (2002)

Radio:

EN 300 220-2 V2.3.1 Category III

Low Voltage:

EN 60950-1:2006+A11:2010



## US Notes

FCC ID: 2AGLF1400304

Changes or modifications not expressly approved by the party responsible for compliance could void the user's authority to operate the equipment.

This device complies with part 15 of the FCC Rules. Operation is subject to the following two conditions: (1) This device may not cause harmful interference, and (2) this device must accept any interference received, including interference that may cause undesired operation.

NOTE: This equipment has been tested and found to comply with the limits for a Class B digital device, pursuant to part 15 of the FCC Rules. These limits are designed to provide reasonable protection against harmful interference in a residential installation. This equipment generates, uses and can radiate radio frequency energy and, if not installed and used in accordance with the instructions, may cause harmful interference to radio communications. However, there is no guarantee that interference will not occur in a particular installation. If this equipment does cause harmful interference to radio or television reception, which can be determined by turning the equipment off and on, the user is encouraged to try to correct the interference by one or more of the following measures:

- Reorient or relocate the receiving antenna.
- Increase the separation between the equipment and receiver.
- Connect the equipment into an outlet on a circuit different from that to which the receiver is connected.
- Consult the dealer or an experienced radio/TV technician for help.



Ulrik Lundberg  
Managing director

© NEAT Electronics AB 2015  
All rights reserved.

Document number: NE41 14002-02 v1.0

Revision date: 2015-12-14

NEAT Electronics AB  
Varuvägen 2  
SE-24642 Löddeköpinge  
Sweden

Phone: +46 (0)46 707065

Fax: +46 (0)46 707087

[www.neat-group.com/se/en](http://www.neat-group.com/se/en)  
[infosweden@neat-group.com](mailto:infosweden@neat-group.com)

## Contents

Intended use

General functions

SMILE Parts

Handling and operation

Mounting

Mounting/unmounting the PIN/necklace

Mounting the wristband

Mounting the CLIP

Mounting the HAPA

Important

Safety Notes

Use

Cleaning

Disposal

Technical Data

## Intended use

SMILE is intended for use in homes and wardens to provide a feeling of security with the possibility to dispatch alarms in the event of an accident.

## General functions

SMILE is a portable trigger which must be connected to a receiver (e.g. NEO Homecare Phone, T Rex2G Portable Transceiver, D-TECT and D-SERVER System) to be able to send alarms.

The alarm is triggered by a light touch on the red alarm button and the alarm is acknowledged by blinking green.

## SMILE Parts

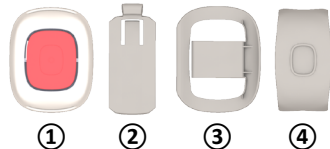

#	Denomination
①	SMILE Unit (with red alarm button)
②	SMILE PIN (with latch and necklace)
③	SMILE CLIP (Optional)
④	SMILE Handicap Adaptor (Optional)
	SMILE Wristband (not displayed)
	SMILE Berlock

The SMILE Unit, Wristband and Pin are included in a standard SMILE Kit while the CLIP and HAPA are optional accessories.

## Handling and operation

Press the red alarm button to transmit an alarm.

### Mounting

#### Mounting/unmounting the PIN/necklace

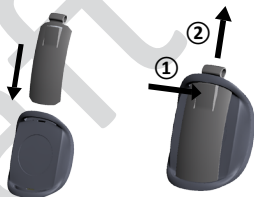

Thread the pin into the holes and press until the latch clicks into place.

Release the pin by pressing the latch ① and then pulling it upwards ②.

#### Mounting the wristband

Thread the wristband through the holes and attach on arm.

## Mounting the CLIP



Fix CLIP on the back of the SMILE, thread the PIN through the holes on the SMILE until the latch clicks in place.

To detach the CLIP, press the PIN latch and remove the PIN.

## Mounting the HAPA



Gently press the HAPA to the front of the SMILE.

To detach, use a thin blade (e.g. a table knife or similar) insert under the HAPA and gently bend the hooks from SMILE.



*Do not use excessive force or the hooks may break.*

*This section intentionally left blank*

## Important

### Safety Notes

- Read instructions prior to use
- Always test the system per instructions prior to use and always check the function of the product after making adjustments. This product may not be suitable for all persons.
- This product should not be a substitute for the routine visual monitoring protocol by caregiver and must not be used in situations where a delay in the arrival of appropriate medical care, could lead to a potentially life-threatening situation.
- Our units are NOT intended for any life support device, thus intending a device whose malfunction may result in damage to a life.
- Check the device regularly and replace when necessary.
- Do not integrate to other systems other than those specified in this document.
- The product will not cause electromagnetic disturbances under normal working conditions.
- The product can be placed near other products or devices as long as mechanical vibration is not present.

### Use

- Use only original parts.
- Keep away from dust, moist and dirt.
- Do not drop, knock, twist or shake the device.
- Do not warm up the device or use it near fire.
- The product may not be painted.
- For repairs, contact a NEAT dealer.

### Cleaning

- All parts in the product kit can be cleaned with a mild soap solution and a damp cloth. Dry with a dry cloth.
- Strong chemicals, grease and other harsh substances must not be used when cleaning or handling the parts in the product kit.
- After cleaning, control that the product works properly by sending a test alarm to the alarm receiver/central.

### Disposal

At the end of the product's use life, please dispose of it at appropriate collection points provided in your country. For disposal or recycling information, please contact your local authorities or the Electronic Industries Alliance (EIA, [www.eiae.org](http://www.eiae.org)). In the European Union, the bin label indicates that this product should not be disposed of with household waste. It should be deposited at an appropriate facility to enable recovery and recycling or returned to NEAT Electronics.

## Technical Data

Measure	34 x 42 x 15 mm	
Weight (incl. battery)	14 g	
RF Frequency	EU	US
	869.2 MHz (Social alarms)	916.2 MHz
Battery life	TBD	
IP Class	TBD	
Temperature range	+5- +55 °C	
Approvals	TBD	

[www.neat-group.com/se/en](http://www.neat-group.com/se/en)