

Quick Start



NEC TBD

Getting to Know Your Phone



Topview



Charging the phone

- Connect the enclosed microUSB cable to the covered microUSB port.
- Plug in the supplied power adapter to an electrical outlet to begin charging.

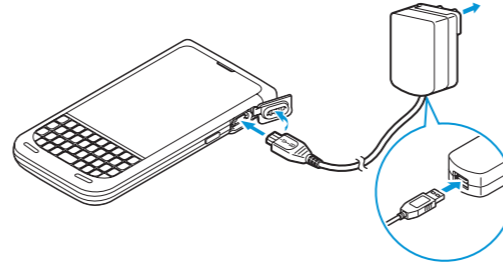

Note: In order to ensure that this product is waterproof, make sure that port and jack cover are completely closed and sealed.

Talking on the Phone

Calling

- From the Home screen, tap
- Enter a phone number or select a contact from the list.
- Tap located in the center at the bottom of your screen.
- Tap to end the call.

Make a call.

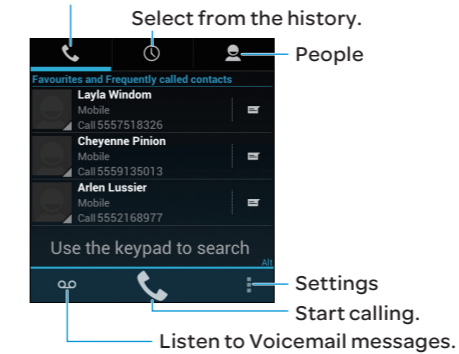

Voicemail

- From the Home screen, tap
- Tap to be connected to your voicemail.
- Follow the voice prompts.

Personalization

Customize your phone with the applications and widgets that you use most often. Access them right from the Home screen.

- From the Home screen, tap
- Touch and hold the application or widget you want to make a shortcut.
- Drag it to the Home screen you prefer.
- To create a folder to organize shortcuts, touch and hold a shortcut, and then drag it to another shortcut.
- To remove a shortcut, touch and hold it, and then drag it to **X Remove**.



Find More Information

On the Web

- For information about your wireless account or network, visit att.com/wireless.

On the Phone

- Dial 611 for assistance with AT&T service or phone.
- Call AT&T Customer Care at 1-800-331-0500.

Optional Accessories

AT&T has accessories for productivity, convenience, and fashion. You can also shop for accessories at att.com/WirelessAccessories.

NEC is a Trademark of NEC Corporation.

Android is a trademark of Google, Inc.

Service provided by AT&T Mobility. © 2013 AT&T Intellectual Property. All rights reserved. AT&T, AT&T logo, and all other AT&T marks contained herein are trademarks of AT&T Intellectual Property and / or AT&T affiliated companies. All other marks contained herein are property of their respective owners.

Setting Up Your Phone

- Slide latch to the left. Then remove the cover and then the battery.

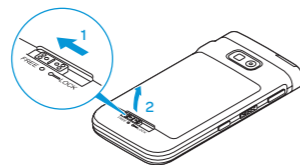

- Install the SIM card (and microSD card if applicable). Replace the battery and then back cover.

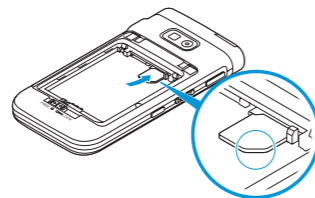

- Ensure the back cover is completely seated and re-sealed. Then slide latch to the right to lock.

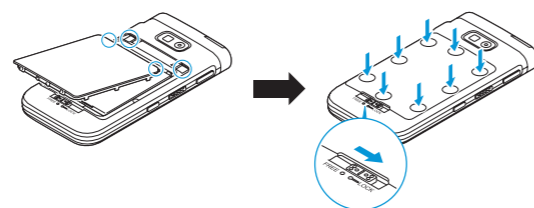

Text Messaging

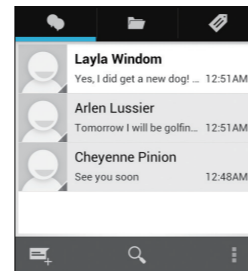

- From the Home screen, tap
- Tap
- Tap , or enter the contact directly. You can add more than one recipient.
- Tap the message field, and then enter your message.
- To add an attachment, tap , and then select the file.
- To send your message, tap

Phone Basics

Lock: Briefly press the power switch.

Unlock: Briefly press the power switch, and then Tap twice to unlock.

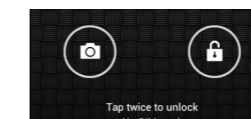

Navigation & Touch screen

Your phone features a touch screen that makes navigation quick and easy.

- Use your fingertip to lightly tap the screen.
- Swipe your finger on the touch screen to scroll up / down and left / right.
- Tap to return to the Home screen.
- Tap to return to the previous screen.
- Tap to see all apps that you have recently used.
- Swipe the Home screen left or right to access your other screens.
- Tap to open the option menu for the current screen.

People

Keep in touch with your favorite people by adding them to your contact list.

Set up group contacts.

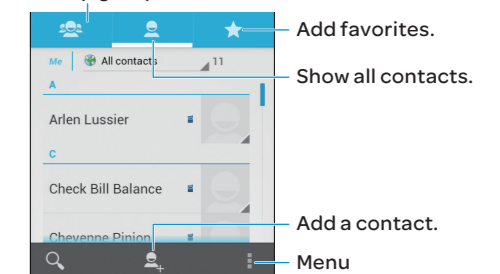

Find a contact.

Adding a new contact

- From the Home screen, tap
- Tap
- Enter all contact information.
- Tap

Email



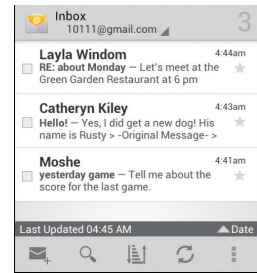

Access your Gmail, corporate email and personal email anywhere.

Account Set up

- 1 From the Home screen, tap .
- 2 Enter your email and password, and then tap **Next**.
- 3 Follow the on-screen instructions to complete the set up.





Sending an Email

- 1 From the Home screen, tap .
- 2 Tap .
- 3 Select recipients from contacts, or enter the email address directly. You can add more than one recipient. Tap  when finished.
- 4 Tap the title and message fields, and then type your title and message.
- 5 To add an attachment, tap  and "Attach file", and then select the file.
- 6 To send your email, tap .

Bluetooth & WI-FI

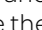

Connecting to Bluetooth

You can connect wirelessly to compatible devices, such as phones, computers, headsets and car kits.

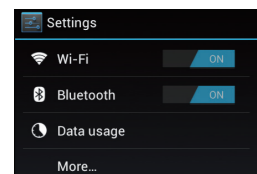
- 1 From the Home screen, tap .
- 2 Find and tap .
- 3 Slide the Bluetooth bar to the right to turn on .
- 4 Tap on 'Bluetooth' to search for devices.
- 5 Select the desired device. A password may be required to activate.





Connecting to Wi-Fi

- 1 From the Home screen, tap .
- 2 Find and tap .
- 3 Slide the Wi-Fi bar to the right to turn on .
- 4 Tap on 'Wi-Fi' to search for networks.
- 5 Select the desired network to connect to.

Note: Secured networks will require a password.

Internet

Browsing the Web

- 1 From the Home screen, tap .
- 2 Enter the website in the address bar, and then press  on the keypad, or select a recent address in the drop down menu.
- 3 To zoom in or out, use your fingers to pinch or spread the screen.
- 4 To bring up the address bar, swipe slightly between the notification bar and the screen.

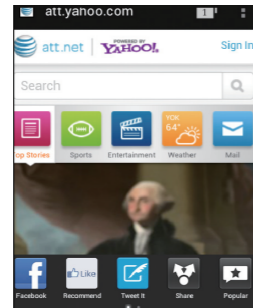

Browser Bar

You can access quick links like Facebook, Twitter, Sports, Entertainment, News and more.

- 1 To bring up shortcuts and favorites bar, swipe  in an upward motion.
- 2 Swipe left or right and tap your selection.

Push To Talk (PTT)

Enhanced Push to Talk (PTT) is available from AT&T and connects work groups with direct communications.

Setting up PTT

Making a PTT Call

Press and hold the **PTT** key, wait for the beep, and start speaking. To listen to others speak, release the key.

Push To Talk (PTT)

Adding a PTT Contact

Google Play Store™

From the Application list screen, tap  **Play Store**.

Use your existing Google account or create one following the steps on the screen.

Navigating Play Store

From the Play Store, you will have multiple options to select and search for apps and games.

- Tap **Apps** to access apps by category.
- Tap **Games** to access games by category.
- Tap **Movies** to access books by category.



Follow the instructions to install. Once completed, the application will appear in the **Notification Bar**.

Note: A Google Checkout payment method is required to purchase apps.



Camera & Video



Taking a Picture

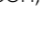

- 1 From the Home screen, tap .
- 2 Tap  to take a photo.
- 3 Select **Save** or **Discard**.

Taking a video

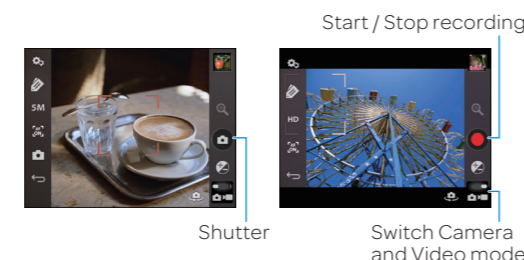
- 1 From the camera screen, tap  to switch to video recorder.
- 2 To start recording, tap .
- 3 Press  to stop recording.



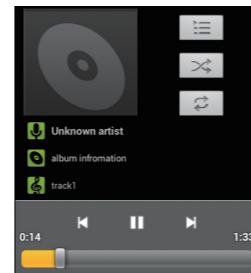

Music

- 1 From the Home screen, tap .
- 2 Tap .
- 3 Select the category you want to browse, Artist, Albums, Songs, or Playlist.
- 4 While browsing your collection, tap a song to play.
- 5 Use the on-screen icons to control music playback, Repeat Play and more.

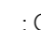

Network Indicators

Your 4G LTE wireless device will display one of the following network indicators to let you know which of AT&T's wireless networks you are connected to.

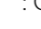
-  : Connected to AT&T's 4G LTE network.
-  : Connected to AT&T's HSPA+ network.
-  : Connected to AT&T's EDGE / 2G network.

Limited 4G LTE availability in select markets. 4G speeds delivered by LTE, or HSPA+ with enhanced backhaul, where available. Compatible data plan required. LTE is a trademark of ETSI. Learn more at att.com/network.

A network indicator does not necessarily mean that you will experience any particular upload or download data speeds. Actual upload and download data speeds depend upon a variety of factors, including the device, network utilization, file characteristics, terrain, etc. Learn more at: wireless.att.com/learn/articlesresources/wireless-terms.jsp.

Your AT&T Wireless Customer Agreement, Section 3.2 Where and How Does AT&T Service Work?

AT&T Services

- **AT&T Code Scanner:** Reads UPC, QR, and Data Matrix barcodes, Scan, Shop & Save.
- **AT&T Navigator®:** Get voice-guided, turn-by-turn, driving directions, and traffic updates.
- **Live TV:** Watch live TV using your AT&T U-verse® account.
- **YPMobile:** Search to find businesses and events near your location.

Some services may require subscription and incur data usage. AT&T U-verse Live TV requires mobile broadband service. Service not available in all areas. Programming subject to blackout restrictions. Download and watch capability available for select content, requires Wi-Fi connections and is available for viewing for limited time periods.